

READ AND UNDERSTAND THESE INSTRUCTIONS BEFORE PROCEEDING.
RETAIN THESE INSTRUCTIONS FOR MAINTENANCE REFERENCE.

This fixture is intended for installation in accordance with the National Electrical Code and local regulations. To assure full compliance with local codes and regulations, check with your local electrical inspector before installation. To prevent electrical shock, turn off electricity at electrical panel before proceeding.

DO NOT INSTALL THIS SYSTEM IN A WET OR DAMP LOCATION.
DO NOT ENERGIZE ANYTHING OTHER THAN THE FIXTURES IN THE SYSTEM.
DO NOT OVERLOAD FEED CABLE, 10 AMP MAX FOR SJT 18-3 AND 7 AMP MAX FOR SJT 18-4 & 18-5.

CONTRACTOR IS RESPONSIBLE FOR ADEQUATELY REINFORCING CEILING TO SUPPORT FIXTURE WEIGHT.

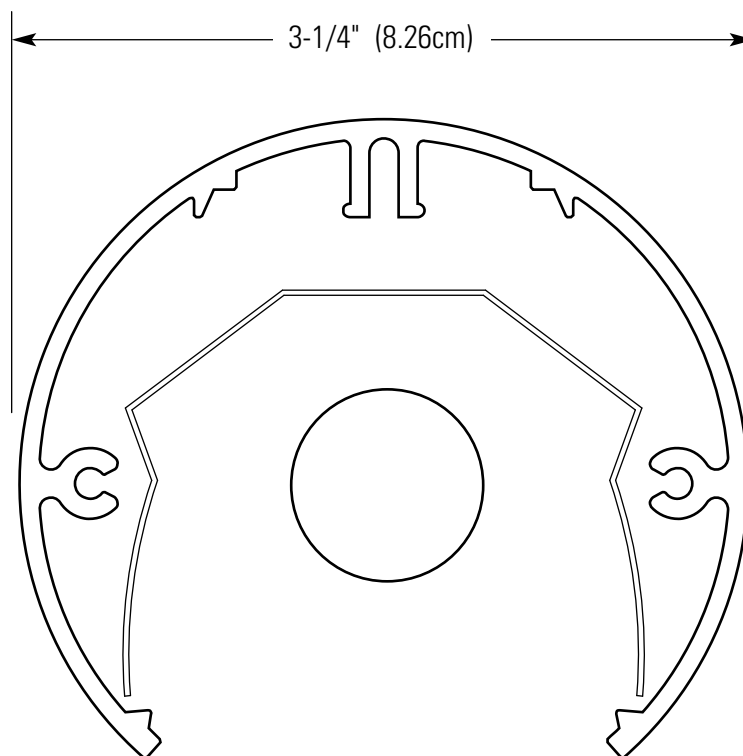

CABLE MOUNT

Step 1. Unpack

Remove fixture and cable kit.

Step 2. Install MOUNTING STRAP to J-BOX

Fasten 1/4" 20 threaded stud to MOUNTING STRAP and tighten securely with HEX NUT. Approximately 1/4" of threads should be exposed. Fasten MOUNTING STRAP to J-BOX with two (2) 8-32x1" Screws (by others).

Step 3. Mark Off Mounting Center (Fig. 1)

Mark required distance from J-BOX CENTER to MOUNTING CENTER.

Step 4. Attach Cable Assemble to FIXTURE

Remove BALLAST COVER and SOCKET COVER. Place END COVER onto END PLATE. Slip END NIPPLE thru center hole in END PLATE. Place NYLON WASHER onto END NIPPLE with two (2) HEX NUTS. Leave loose. Make required electrical connections. Firmly tighten STRAIN RELIEF 1" away from 1/4" 20 STUD. (Fig. 1)

Step 5. Install FIXTURE

Make required electrical connections per local codes. Cover J-BOX with CANOPY. Raise COUPLING against CANOPY and tighten with SET SCREW. Secure CANOPY to ceiling. Fasten COUPLING securely.

Step 6. Adjustment

Turn FIXTURE (rotatable) to desired lamp direction and firmly fasten HEX NUTS. Replace BALLAST COVER and SOCKET COVER. (Fig. 1)

CABLE MOUNT (CONT'D)

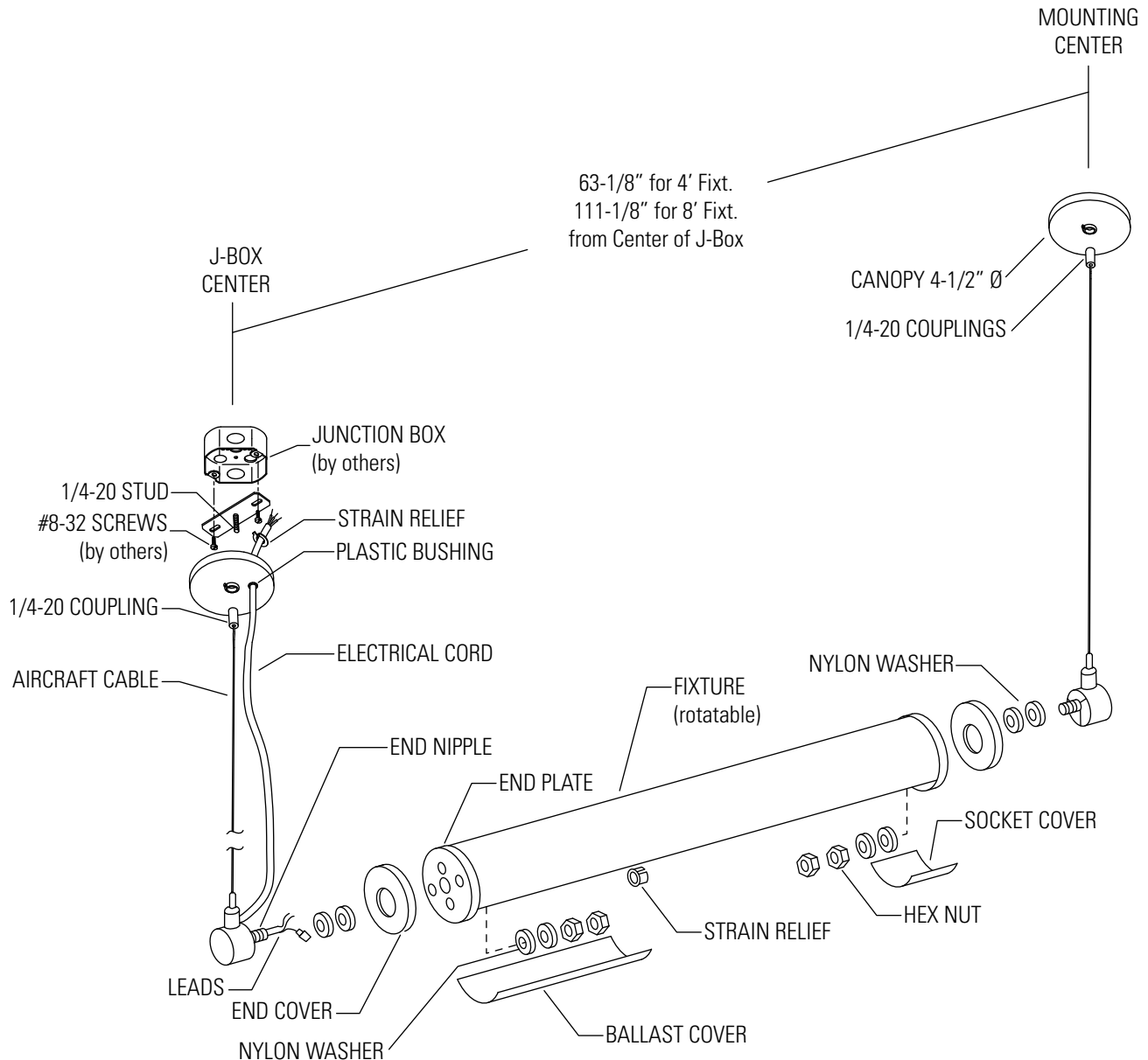

Figure 1

TANDEM MOUNT FIXTURE FOR CABLE

Step 1. IMPORTANT! BE SURE ELECTRICAL POWER IS OFF

Step 2. Attach NIPPLE to FIXTURES

Straighten TABS on RING COVER and remove. Attach shorter end of THREADED NIPPLE to RING. Fasten securely.

Step 3. Mount Cable Assembly to FIXTURES

Remove SOCKET COVERS. Slip THREADED NIPPLE from CABLE ASSEMBLY thru END COVER and END PLATE. Slip NYLON WASHERS over THREADED NIPPLE and fasten with two (2) HEX NUTS. Leave loose. Turn FIXTURES to desired lamp direction and firmly fasten HEX NUTS. Replace SOCKET COVERS.

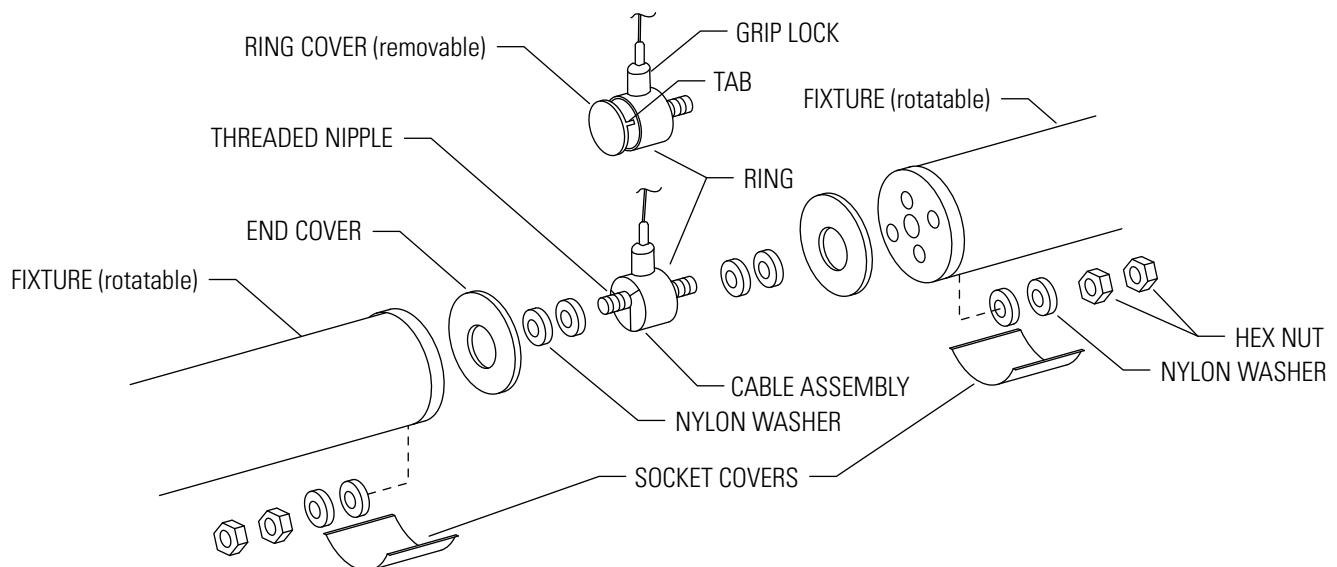

Figure 2

STEM MOUNT

Step 1. Unpack

Remove fixture and stem kit.

Step 2.

Install MOUNTING PLATE to J-BOX using two (2) 8-32x1" SCREWS (by others).

Step 3. Mark Off MOUNTING CENTER (Fig. 3)

Mark required distance from J-BOX CENTER to MOUNTING CENTER and drill two (2) 3/4"Ø HOLES as required. (Fig. 3)

Step 4. Install MOUNTING PLATE at MOUNTING CENTER

Attach TOGGLE BOLTS (by others) to MOUNTING PLATE, fasten TOGGLE WING NUT (by others) to TOGGLE BOLTS and slip TOGGLE WING NUTS thru 3/4"Ø HOLES in ceiling. Fasten securely. (Fig. 3)

Step 5. Attach STEMS to FIXTURE

Remove BALLAST COVER and SOCKET COVER. Place END COVER onto END PLATE. Slip NIPPLE thru center hole in END PLATE. Place NYLON WASHER onto NIPPLE and fasten with two (2) HEX NUTS. Leave loose. Make required electrical connections. (Fig. 3)

Step 6. Install FIXTURE

Slip COLLAR and CANOPY over STEM. Seat STEMS into opening on MOUNTING PLATES and secure firmly with two (2) SET SCREWS. Make required electrical connections per local codes. Slip CANOPY over MOUNTING PLATE and fasten COLLAR to MOUNTING PLATE. Rotate FIXTURE to desired direction and firmly tighten two (2) HEX NUTS on inside of FIXTURE. Replace BALLAST COVER and SOCKET COVER. (Fig. 3)

STEM MOUNT (CONT'D)

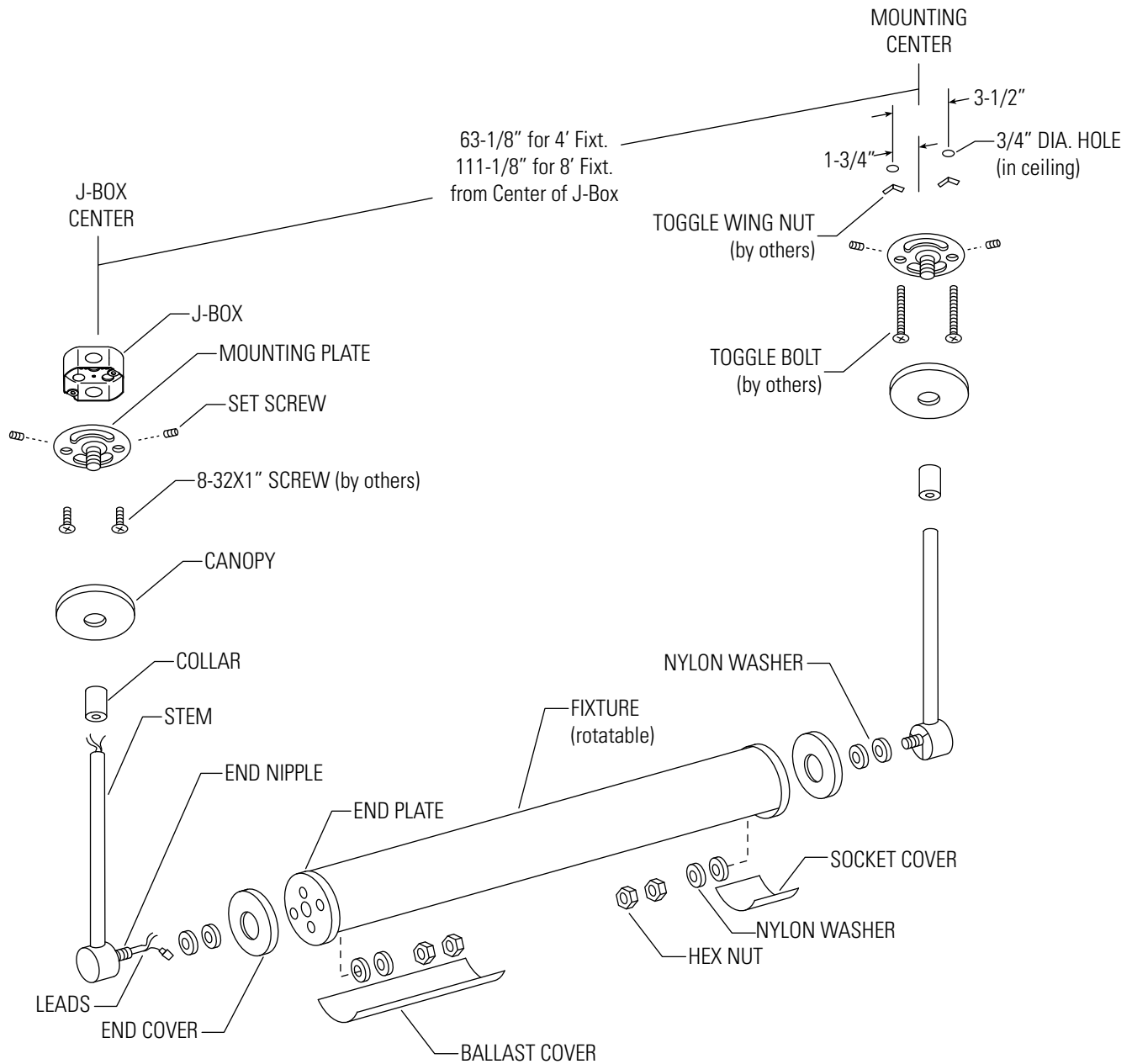

Figure 3

TANDEM MOUNT FIXTURE FOR STEM

Step 1. IMPORTANT! BE SURE ELECTRICAL POWER IS OFF

Step 2. Attach NIPPLE to Stem Kit

Straighten TABS on RING COVER and remove. Attach shorter end of THREADED NIPPLE to RING. Fasten securely.

Step 3. Mount STEM to FIXTURES

Remove SOCKET COVERS. Slip NIPPLE on RING thru END COVER and END PLATE. Slip NYLON WASHERS over NIPPLE and fasten securely with two (2) HEX NUTS. Make required electrical connections. Replace SOCKET COVERS.

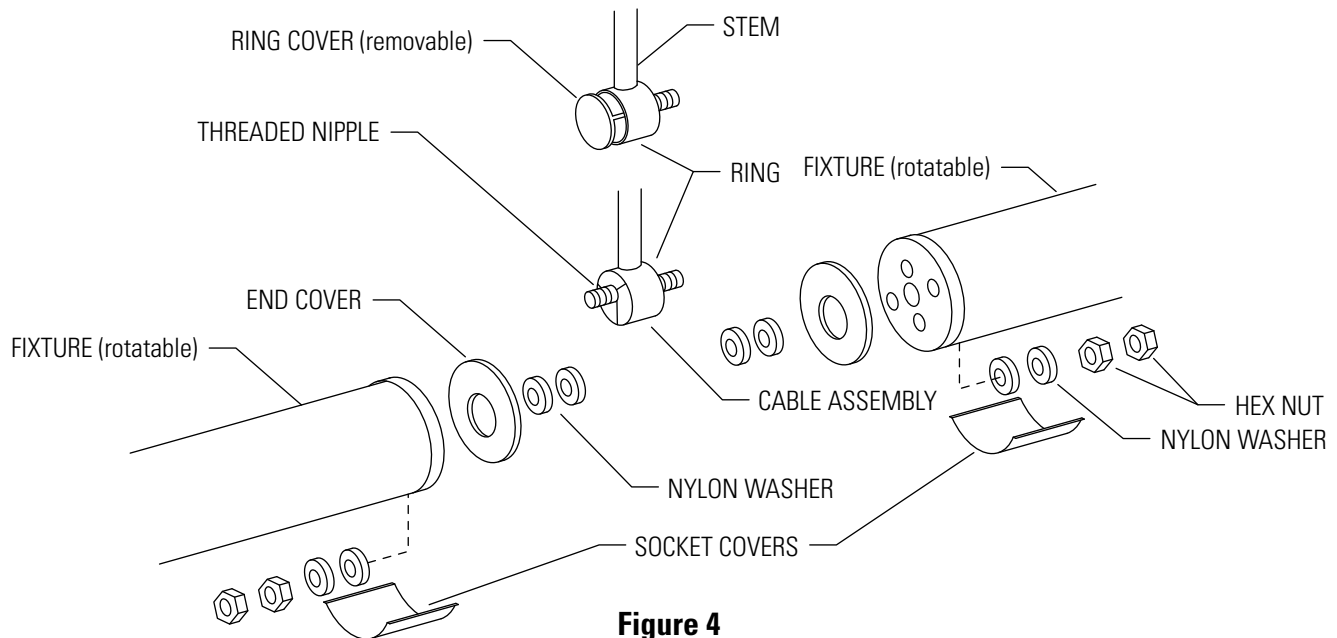

Figure 4

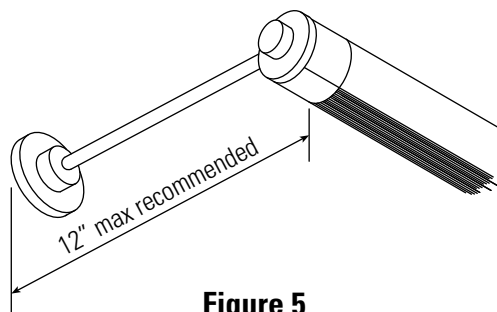

Figure 5

CAUTION: Recommended maximum length for Wall Mounting is 12" overall. (Fig. 5)