

READ AND UNDERSTAND THESE INSTRUCTIONS BEFORE INSTALLING LUMINAIRE

This luminaire is intended for installation in accordance with the National Electrical Code and local regulations.

To assure full compliance with local codes and regulations, check with your local electrical inspector before installation. To prevent electric shock, turn off electricity at fuse box before proceeding.

Retain these instructions for maintenance reference.

INSTRUCTION SHEET NO.

IS: C3FTA

A1104

Page 1 of 1

INSTALLATION PROCEDURE FOR CALCULITE® EVOLUTION: C3FTA SERIES FLUSH MOUNT RING FOR FLANGELESS TRIMS

C3FTA FLUSH MOUNT RING INSTALLATION

NOTE: Photos shown here have the frame already installed. This is not required if there is access above the ceiling after the ceiling is finished.

1. Using a hole-saw, cut a 3-5/8" hole in the desired location.
2. Fig. 1 Bring Flush-mount RING to the ceiling line and install into ceiling by pushing the ring up into the ceiling while rotating clockwise, ensuring the LIP is flush to the ceiling line.
3. With ring installed, prepare plaster/compound. Very little plaster/compound is needed to create a smooth transition.
4. Fig. 2 Bring plaster/compound up to the ceiling line using the tool of choice. Starting at the outside of the BORDER EDGE, evenly build up the plaster/compound around the entire RING LIP perimeter.
5. Feather the plaster/compound out away from the RING until the transition is smooth and acceptable. Sand away blemishes in the surface if necessary, prior to finishing.

Note: The installed Reflector Trim will still rotate freely 360+ degrees even after plaster/compound is installed. Additionally, the ring can be used on all ceiling thicknesses listed for each trim.

Fig. 1

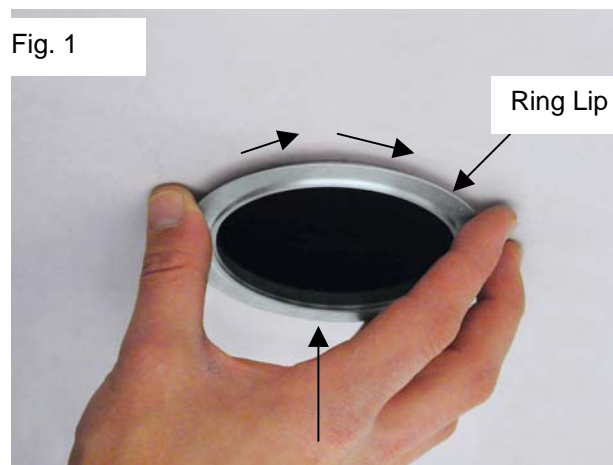

Fig. 2

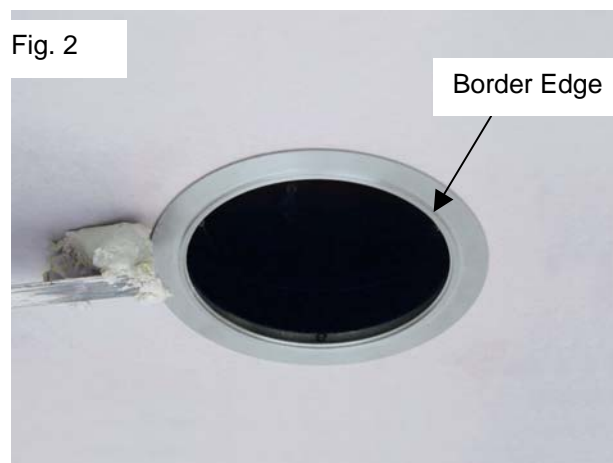
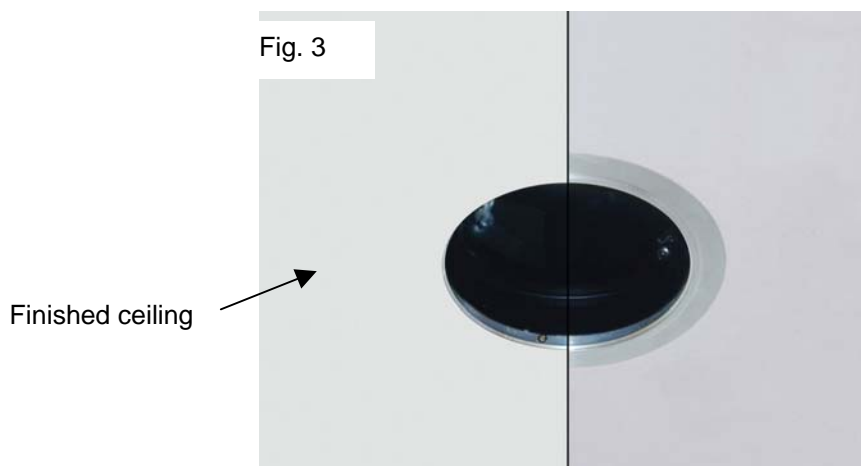

Fig. 3



U.S. AND FOREIGN PATENTS PENDING

LIGHTOLIER®

LIGHTOLIER A GENLYTE COMPANY
631 Airport Road, Fall River, MA 02720