

READ AND UNDERSTAND THESE INSTRUCTIONS BEFORE INSTALLING LUMINAIRE

This luminaire is intended for installation in accordance with the National Electrical Code and local regulations. To assure full compliance with local codes and regulations, check with your local electrical inspector before installation. To prevent electric shock, turn off electricity at fuse box before proceeding.

Retain these instructions for maintenance reference.

INSTRUCTION SHEET NO.

IS:4AWA142

A0201

Page 1 of 1

INSTRUCTIONS FOR INSTALLATION OF PENDALUX™ ADA WALL SERIES

Note: This instruction sheet covers several luminaire (fixture) styles.

INSTALLATION (Fig. 1):

1. Remove three HEX NUTS from front of BACKPLATE and remove WALL PLATE.
2. Using appropriate slots, secure WALL PLATE to OUTLET BOX using OUTLET BOX SCREWS (provided with OUTLET BOX).
3. While supporting BACKPLATE make connections: Black luminaire lead to hot supply lead; white luminaire lead to neutral (white) supply lead. Uninsulated luminaire lead is a ground wire and must be connected to grounding terminal or ground lead inside OUTLET BOX. Green luminaire lead(s) must also be connected to grounding terminal or ground lead inside OUTLET BOX. Use WIRE NUTS (local hardware item). Push supply wires and connections back into OUTLET BOX.
4. Align holes in BACKPLATE over WALL PLATE MOUNTING STUDS. Secure BACKPLATE to WALL PLATE using HEX NUTS from step 1.
5. Install DIFFUSER following steps outlined below.
6. Install recommended lamp.
7. Position COVER SHIELD over TABS on HOLDER BRACKET. Secure in place using COVER SHIELD SCREWS.

Installation of Decorative Trim (optional):

Note: Use only Lightolier Pendalux 4F, 4K or 4R Series Decorative Trims.

1. Gently slide DIFFUSER down into DECORATIVE TRIM as shown in Fig. 1. Align top edge of DIFFUSER with top edge of DECORATIVE TRIM.
2. Follow steps for DIFFUSER installation below.
3. Install two TRIM SCREWS into HOLDER BRACKET. Tighten TRIM SCREWS securing SUPPORT BAR in position.

Diffuser Installation:

1. Position four holes in DIFFUSER over four DIFFUSER MOUNTING STUDS. For DECORATIVE TRIM option, hook SUPPORT BAR behind HOLDER BRACKET prior to positioning four holes in DIFFUSER over four DIFFUSER MOUNTING STUDS.
2. Secure DIFFUSER in place by tightening four BATTERY NUTS onto DIFFUSER MOUNTING STUDS.

Diffuser Cleaning:

1. Remove COVER SHIELD SCREWS and remove COVER SHIELD.
2. Remove four BATTERY NUTS from DIFFUSER MOUNTING STUDS and remove DIFFUSER.
3. Remove DIFFUSER from DECORATIVE TRIM if supplied.
4. Clean DIFFUSER using a damp cloth.

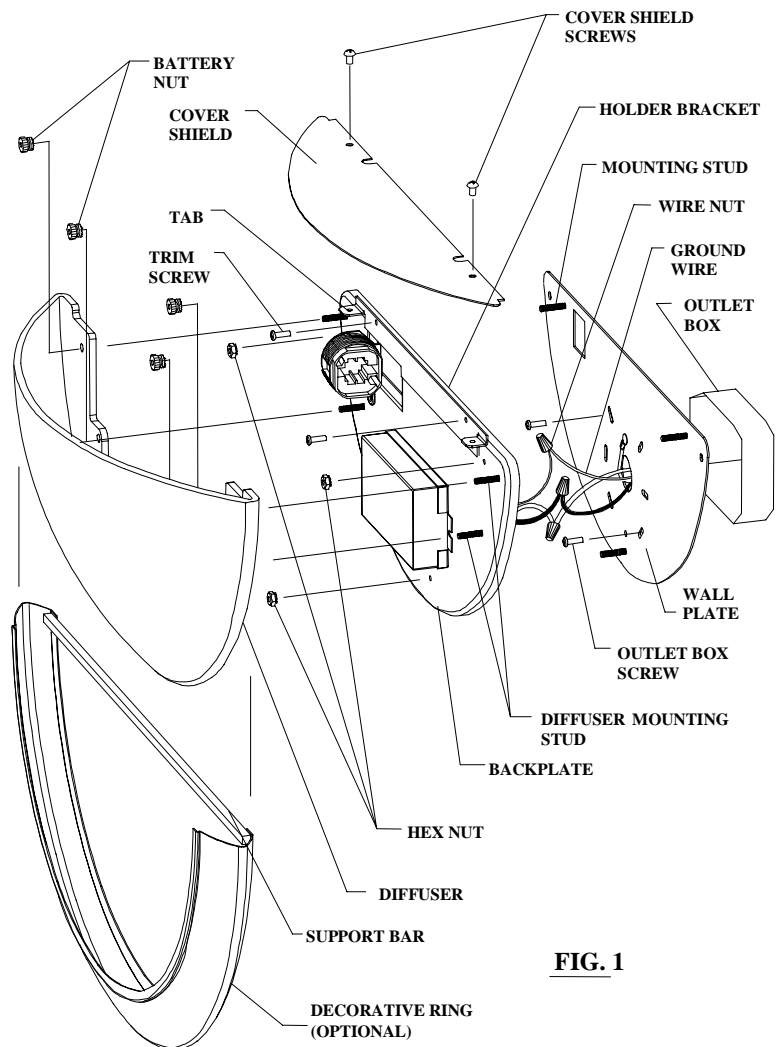
**FIG. 1**

CAUTION: USE LAMP WATTAGE AND TYPE AS MARKED ON LUMINAIRE

LIGHTOLIER®

LIGHTOLIER A GENETE THOMAS COMPANY
631 Airport Road, Fall River, MA 02720