

Read and understand these instructions before installing luminaire (fixture) .

This luminaire is intended for installation in accordance with the National Electrical Code and local regulations. To assure full compliance with local codes and regulations, check with your local electrical inspector before installation. To prevent electrical shock, turn off electricity at fuse box before proceeding. Allow fixture to cool before handling.

Retain these instructions for maintenance reference.

INSTRUCTIONS FOR REFLECTORS 23MHR5, 23MHRNF, 23MHRF, 23MHRSCCZ, 23MHRNFCCZ, 23MHRFCCZ

COMPATIBILITY	
REFLECTOR NUMBER	LUMINAIRE CATALOG NUMBER. NUMBER WILL BE FOLLOWED WITH A FINISH SUFFIX SUCH AS WH, BK, AL TO NAME A FEW.
23MHR5, 23MHRNF, 23MHRF, 23MHRSCCZ, 23MHRNFCCZ, 23MHRFCCZ	23S20T4, 23C20T4, 23S20BT, 23C20BT, 23S35BT, 23C35BT, 23S39T4, 23C39T4

REFER TO INSTRUCTION SHEET INCLUDED WITH LUMINAIRE FOR LAMPING AND LUMINAIRE OPERATION.

INSTRUCTIONS FOR INSTALLING THE REFLECTOR.

1. Turn off power to TRACK and put SWITCH in off position.
2. Place reflector in CYLINDER OR STEP SPOT HOUSING and secure into position by snapping RETAINING RING into GROOVE.

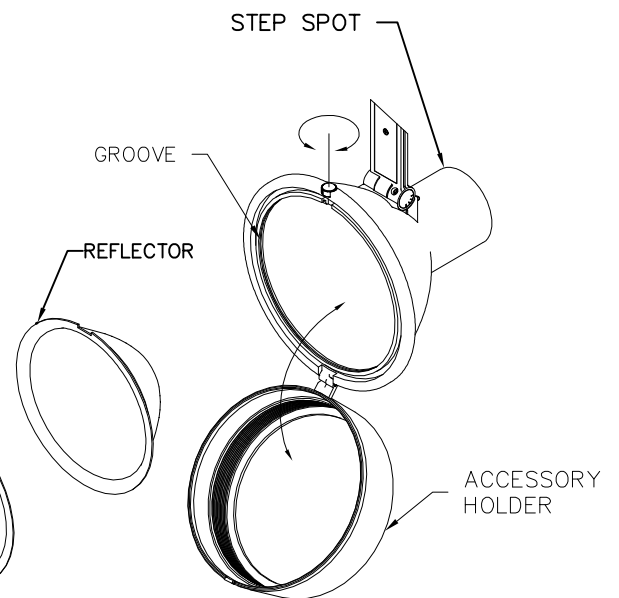
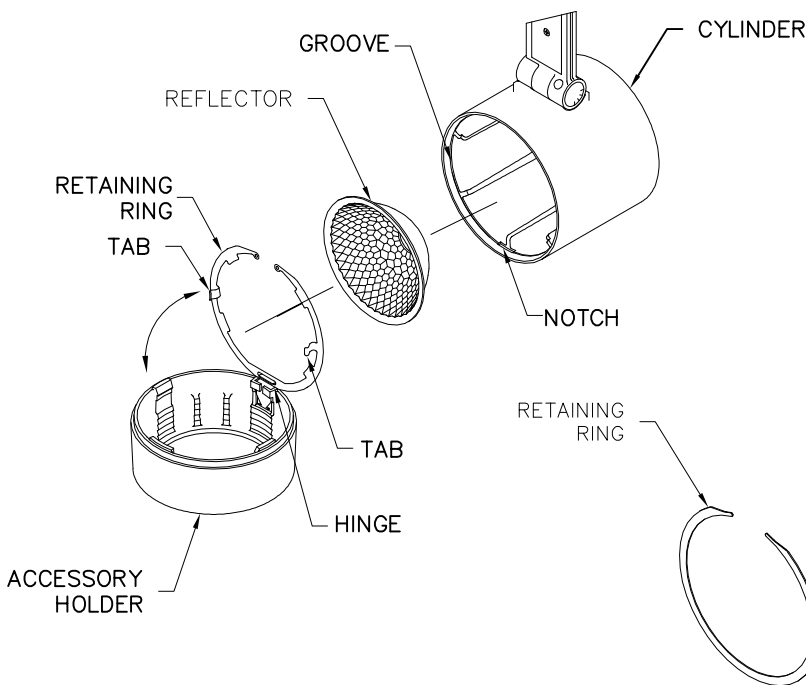
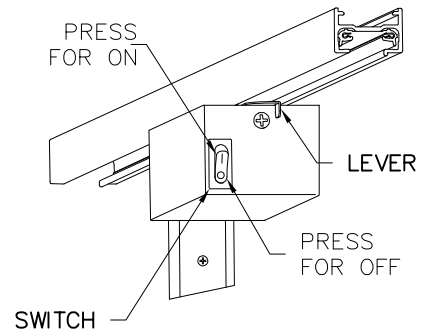

631 Airport Road, Fall River, MA 02720 • (508) 679-8131 • Fax (508) 674-4710
 We reserve the right to change details of design, materials and finish.
www.lightolier.com © 2008 Philips Group • B0608