

INSTALLATION OF CALCULITE REFLECTOR TRIMS**INSTRUCTION SHEET FOR ITEMS:****A7053, A7701, A7058, B7054, B7705, B7760, B7780, C7055, C7709, D7707****READ AND UNDERSTAND THESE INSTRUCTIONS BEFORE INSTALLING FIXTURE.**

This fixture is intended for installation in accordance with the National Electrical Code and local or federal code specifications. To prevent electrical shock, turn off electricity at fuse box before proceeding.

Retain these instructions for maintenance reference.

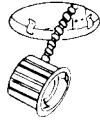

FIG. 1
A. FRAME-IN

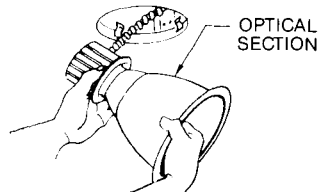

FIG. 2
B. SNAP-IN



FIG. 3
C. PUSH-IN

WARNING—(RISK OF FIRE) DO NOT INSTALL INSULATION WITHIN 3 INCHES OF FIXTURE SIDES OR WIRING COMPARTMENT, NOR ABOVE FIXTURE IN SUCH A MANNER SO AS TO ENTRAP HEAT.

A. FRAME-IN (FIG. 1)

See Frame-In-Kit Instruction Sheet (No. IS:A400) for installation procedure.

B. SNAP-IN (FIG. 2)

NOTE: For Overlapping Trim installation slip WHITE TRIM RING on over OPTICAL SECTION, as shown on Fig. 4 and 5, before Snap-in. For Flangeless Trim installation, WHITE TRIM RING is not required. Fasten ADJUSTABLE SOCKET HOUSING to OPTICAL SECTION (reflector or baffle by: (1) aligning the SPRING with CUTOUT on top (Fig. 6); (2) pushing ADJUSTABLE SOCKET HOUSING onto OPTICAL SECTION for engagement. If SLOTS are provided on OPTICAL SECTION for vertical adjustment, engage SPRING to desired lamp/wattage position (see label on inside and outside to neck of REFLECTOR/HOUSING). See Fig. 6 and 7.

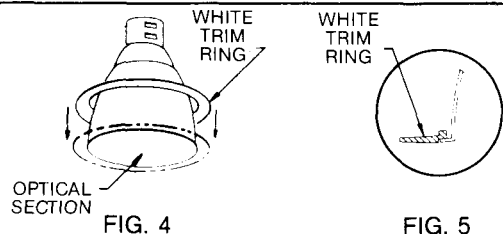

FIG. 4

FIG. 5

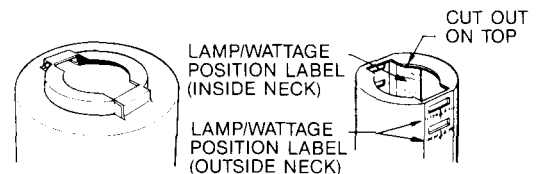

FIG. 6

C. PUSH-IN (FIG. 3)

Push OPTICAL SECTION straight up into MOUNTING FRAME until tight against finished ceiling. RETAINING SPRINGS on MOUNTING FRAME (Fig. 1) will secure OPTICAL SECTION (reflector or baffle) in place.

NOTE: To remove OPTICAL SECTION, use FINGER HOLE (Fig. 7) provided on upper part for sure grip; turn OPTICAL SECTION counterclockwise while pulling downward. After starting, use both hands to remove. See Fig. 8.

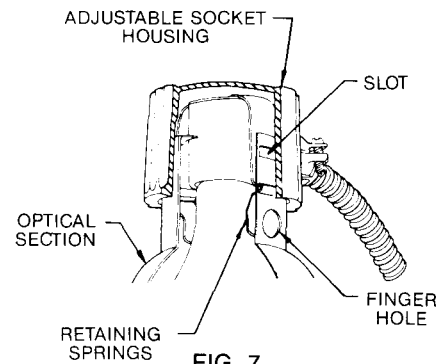

FIG. 7

TO REMOVE

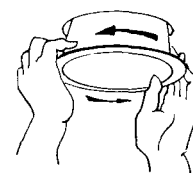

FIG. 8

U.S. Pat. No. 4,039,822

CARE AND MAINTENANCE OF "ALZAK" REFLECTOR

If handling of reflectors with anodized or Alzak finish is required, the use of clean white or plastic film gloves is recommended to avoid fingerprints.

Anodized or Alzak surfaces can be cleaned by the following methods:

1. Wipe off with a soft, clean, dry, lint-free cloth.
2. Wipe off with a clean cloth dampened in mild detergent solution. Rinse, then wipe dry with lint-free cloth or paper towel.
3. Wipe off with a clean cloth dampened with a solution of wetting agent and water (such as 2 oz. per gallon "Pluronic L62-LF by Wyandotte Products), or a liquid wax such as Glass Wax®. Then wipe dry. Avoid gritty cleaning agents.