

6. Shielding Pattern

## Ordering Information

Family	Series	Type	Lamps	Color	Wattage	Voltage	Length
<b>FW7</b>	<b>2</b>	<b>4</b>	<b>1</b>				
	2 = Oval	4 = Louver	1 = 1 Lamp	AL = Aluminum WH = White	1 = 28W 2 = 54W 3 = 28W Dimming 4 = 28W EM 5 = 54W Dimming 6 = 54W EM	1 = 120v 2 = 277v	4 = 4' (121.92cm) 8 = 8' (243.84cm)

Complete Ordering Instructions below.

## Features for Wall Modules

- Housing:** Single piece of high purity extruded aluminum, a portion from recycled material.
- Housing End:** Die-cast aluminum, welded in place.
- End Cap:** Die-cast aluminum. Encloses the end of the run.
- Lamps:** F28T5 or F54T5HO as specified. By others. Installed from the ceiling side of the luminaire.
- Ballast:** Electronic. Meets ANSI starting, end-of-life protection and sound rating specifications. Low THD.
- Shielding:** Integral, regressed flat louver blades punched and formed from fixture housing, finished to match, no light leaks. Blades are .56" (1.42cm) high on .75" (1.91cm) centers.

## Electrical

**Connections:** Pre-wired with 18 gauge wires and polarized cannon plug connectors for simultaneous mechanical/electrical connection.

**Emergency Battery Pack:** 90 minute operation, 700 lumens for 54W and 520 lumens for 28W.

**Dimming:** Advance Mark X standard (no additional wires required); use compatible dimmer. Dimming ballasts using additional control wires (eg Lutron Hi-Lume or ECO-10, Osram) can be used; consult factory and use X4 or X5 power feeds with additional leads, as appropriate. Ballast not to exceed 1.25" (3.18cm) wide by 1.20" (3.05cm) high.

**iGEN:** F7000 accepts iGEN (DALI) with supplemental 2-wire control technology. Use with X5 power feed.

**Power Tray:** Code-gauge, die-formed steel, pre-paint white enamel finish; secured by quarter-turn fasteners for easy access to wiring. Holds ballasts, sockets, and wiring. Accepts ballasts up to 1.25" (3.18cm) wide by 1.20" (3.05cm) high.

Factory installed ballast disconnect allows the ballast to be disconnected from and reconnected to incoming power under load without turning the entire circuit off.

## Finish

Powder-coated, baked enamel, white or aluminum, as specified.

## Mounting for Wall Modules

Each module includes two wall-mounting brackets. Bracket hole pattern accommodates junction box (single gang box rotated 90 degrees) or other appropriate mounting method using customer supplied fasteners.

## Labels

UL, cUL and I.B.E.W.

## Ordering Instructions for Wall Modules

### Individual Fixtures:

- Order one MODULE.
- Order one END SET.

### Continuous Rows:

- Order the appropriate number of MODULES for the complete run.
- Order one END SET.

## Job Information

## Type:

**Job Name:**

**Cat. No.:**

**Lamp(s):**

**Notes:**

## Performance

### CANDLEPOWER CURVE

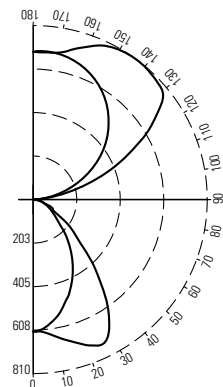

REPORT NO.: ITL54691.IES  
LAMPS: 1-F54T5  
LUMENS: 5000 each  
EFFICIENCY: 74.2%  
CAT. NO.: FW7241WH214

### CANDLEPOWER

ZONE DEG.	0	22	45	67	90
CANDELAS					
0	615	615	615	615	615
5	621	623	618	607	600
15	683	660	607	550	524
25	747	691	578	474	425
35	604	584	532	375	311
45	354	355	358	264	195
55	191	189	181	178	117
65	101	95	94	96	75
75	48	51	50	50	39
85	14	14	12	12	8
90	6	5	3	2	0
95	42	43	48	66	35
105	237	251	262	269	150
115	480	488	488	402	275
125	708	705	628	513	397
135	799	769	699	584	496
145	810	788	732	626	579
155	790	771	721	653	641
165	725	712	694	678	678
175	688	684	687	690	693
180	688	688	688	688	688

### COEFFICIENTS OF UTILIZATION

#### % EFFECTIVE CEILING CAVITY REFLECTANCE

ROOM CAVITY RATIO	% EFFECTIVE CEILING CAVITY REFLECTANCE								
	80%			70%			50%		
	50	30	10	50	30	10	50	30	10
0	77	77	77	69	69	69	55	55	55
1	67	65	62	61	59	56	48	47	46
2	59	55	51	53	50	47	43	41	38
3	52	48	43	48	43	40	38	35	32
4	47	41	37	42	37	34	34	30	29
5	42	36	31	38	33	29	30	28	25
6	37	31	28	34	29	26	28	24	22
7	33	29	24	30	26	23	25	22	19
8	30	25	21	28	23	20	23	19	17
9	28	23	19	26	21	18	21	17	15
10	26	20	17	24	19	16	19	16	13

#### 20% FLOOR CAVITY REFLECTANCE

#### DISTRIBUTION

Zone	Lumens	% Lamp	% Luminaire
0 - 90	1207	23.8	32.0
90 - 180	2505	50.4	68.0
0 - 180	3712	74.2	100.0

## Fixture Lengths & Mounting Reflected (Plan View)

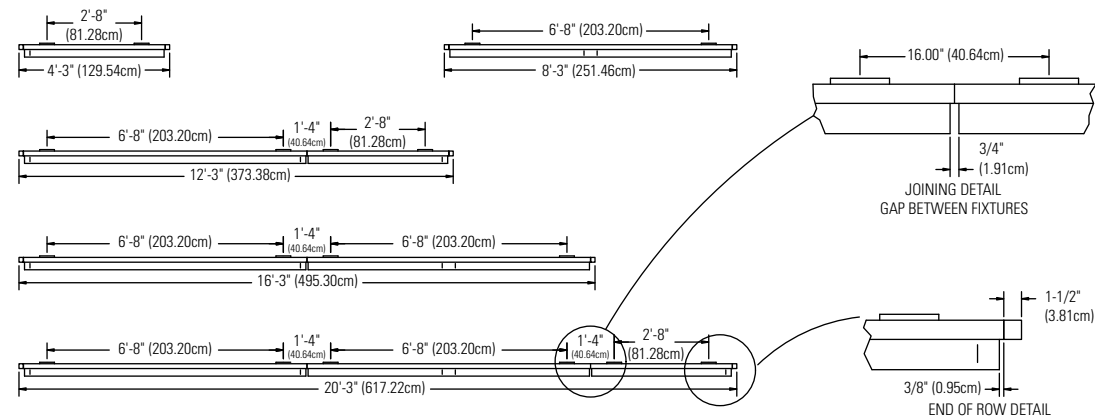

Recommended mounting is a single gang outlet box rotated 90 degrees at the feed point. Remaining mounting points could be outlet boxes as well, or a couple of holes per mounting point spaced 3-1/4" (8.26cm) at 1-3/4" (4.45cm) above the bottom of fixture.

## Mounting Accessories

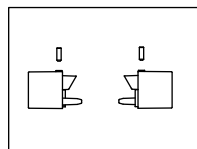

Wall Mount End Set  
FW7EWH = White  
FW7EAL = Aluminum

### Job Information

### Type:

631 Airport Road, Fall River, MA 02720 • (508) 679-8131 • Fax (508) 674-4710  
We reserve the right to change details of design, materials and finish.  
www.lightolier.com © 2008 Philips Group • E0808