

## Ordering Information

Family	Series	Type	Lamps	Color	Wattage	Voltage	Length
<b>FW7</b>	<b>5</b> 5 = Curved	<b>1</b> 1 = Solid	<b>1</b> 1 = 1 Lamp	<b>AL</b> = Aluminum <b>WH</b> = White	<b>1</b> = 28W <b>2</b> = 54W <b>3</b> = 28W Dimming <b>4</b> = 28W EM <b>5</b> = 54W Dimming <b>6</b> = 54W EM	<b>1</b> = 120v <b>2</b> = 277v	<b>4</b> = 4' (121.92cm) <b>8</b> = 8' (243.84cm)

Complete Ordering Instructions below.

## Features

- Housing:** Single piece of high purity extruded aluminum, a portion from recycled material.
- Housing End:** Die-cast aluminum, welded in place.
- End Cap:** Die-cast aluminum. Encloses the end of the run.
- Lamps:** F28T5 or F54T5HO as specified. By others. Installed from the ceiling side of the luminaire.
- Ballast:** Electronic. Meets ANSI starting, end-of-life protection and sound rating specifications. Low THD.

## Electrical

**Connections:** Pre-wired with 18 gauge wires and polarized cannon plug connectors for simultaneous mechanical/electrical connection.

**Emergency Battery Pack:** 90 minute operation, 700 lumens for 54W and 520 lumens for 28W.

**Dimming:** Advance Mark X standard (no additional wires required); use compatible dimmer. Dimming ballasts using additional control wires (eg Lutron Hi-Lume or ECO-10, Osram) can be used; consult factory and use X4 or X5 power feeds with additional leads, as appropriate. Ballast not to exceed 1.25" (3.18cm) wide by 1.20" (3.05cm) high.

**iGEN:** F7000 accepts iGEN (DALI) with supplemental 2-wire control technology. Use with X5 power feed.

**Power Tray:** Code-gauge, die-formed steel, pre-paint white enamel finish; secured by quarter-turn fasteners for easy access to wiring. Holds ballasts, sockets, and wiring. Accepts ballasts up to 1.25" (3.18cm) wide by 1.20" (3.05cm) high. Factory installed ballast disconnect allows the ballast to be disconnected from and reconnected to incoming power under load without turning the entire circuit off.

## Finish

Powder-coated, baked enamel, white or aluminum, as specified.

## Mounting

Each module includes two wall-mounting brackets. Bracket hole pattern accommodates junction box (single gang box rotated 90 degrees) or other appropriate mounting method using customer supplied fasteners.

## Labels

UL, cUL and I.B.E.W.

## Ordering Instructions

### Individual Fixtures:

- Order one MODULE.
- Order one END SET.

### Continuous Rows:

- Order the appropriate number of MODULES for the complete run.
- Order one END SET.

Job Information	Type:
<b>Job Name:</b>	
<b>Cat. No.:</b>	
<b>Lamp(s):</b>	
<b>Notes:</b>	

631 Airport Road, Fall River, MA 02720 • (508) 679-8131 • Fax (508) 674-4710  
We reserve the right to change details of design, materials and finish.  
www.lightolier.com © 2008 Philips Group • E0808

## Performance

### CANDLEPOWER CURVE

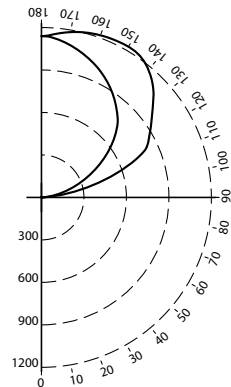

REPORT NO.: ITL54694.IES  
LAMPS: 1-F54T5  
LUMENS: 5000 each  
EFFICIENCY: 75.3%  
CAT. NO.: F7511WH214

### CANDLEPOWER

ZONE DEG.	0	22	45	67	90
CANDELAS					
90	0	0	0	0	0
95	69	79	93	120	53
105	434	454	461	374	243
115	814	780	673	598	439
125	949	925	875	775	621
135	1113	1094	1037	911	788
145	1218	1191	1119	1022	926
155	1226	1204	1159	1097	1034
165	1206	1195	1175	1141	1108
175	1160	1157	1157	1151	1143
180	1139	1139	1139	1139	1139

### COEFFICIENTS OF UTILIZATION

#### % EFFECTIVE CEILING CAVITY REFLECTANCE

ROOM CAVITY RATIO	% EFFECTIVE CEILING CAVITY REFLECTANCE								
	80%			70%			50%		
	50	30	10	50	30	10	50	30	10
0	72	72	72	61	61	61	42	42	42
1	62	60	57	53	51	49	36	35	34
2	54	50	47	47	43	40	32	30	28
3	48	43	39	41	37	34	28	26	24
4	42	37	32	36	32	28	25	22	20
5	37	32	27	32	27	24	22	19	17
6	33	27	23	28	24	20	20	17	14
7	30	24	20	25	21	18	18	15	12
8	27	21	17	23	18	15	16	13	11
9	24	19	15	21	16	13	14	11	9
10	22	17	13	19	15	12	13	10	8

#### 20% FLOOR CAVITY REFLECTANCE

### DISTRIBUTION

Zone	Lumens	% Lamp	% Luminaire
0 - 90	0	0.0	0.0
90 - 180	3763	75.0	100.0
0 - 180	3763	75.0	100.0

## Fixture Lengths & Mounting Reflected (Plan View)

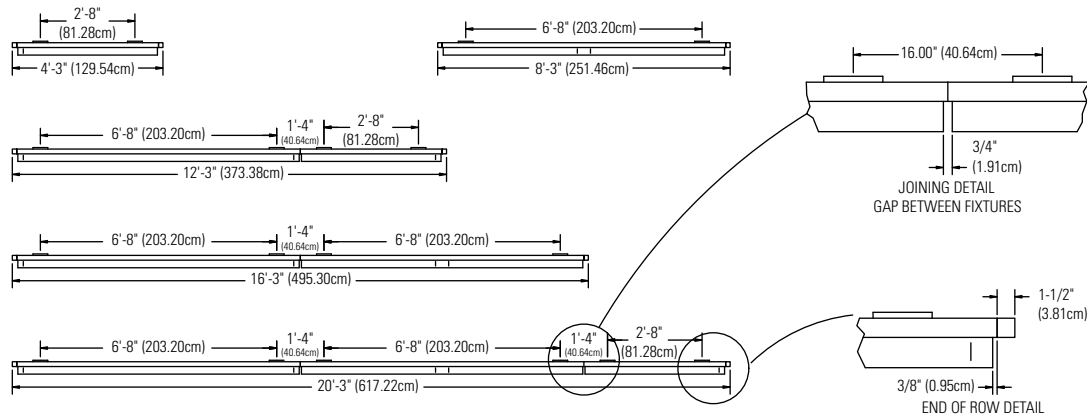

Recommended mounting is a single gang outlet box rotated 90 degrees at the feed point. Remaining mounting points could be outlet boxes as well, or a couple of holes per mounting point spaced 3-1/4" (8.26cm) at 1-3/4" (4.45cm) above the bottom of fixture.

## Mounting Accessories

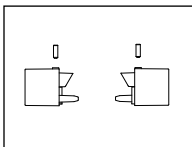

**Wall Mount End Set**  
FW7EWH = White  
FW7EAL = Aluminum

### Job Information

### Type:

631 Airport Road, Fall River, MA 02720 • (508) 679-8131 • Fax (508) 674-4710  
We reserve the right to change details of design, materials and finish.  
www.lightolier.com © 2008 Philips Group • E0808