

The C1 Series incorporates a contemporary, low profile design with low maintenance and quick installation features. The unit is completely self-contained, and is ideal for sheetrock applications.

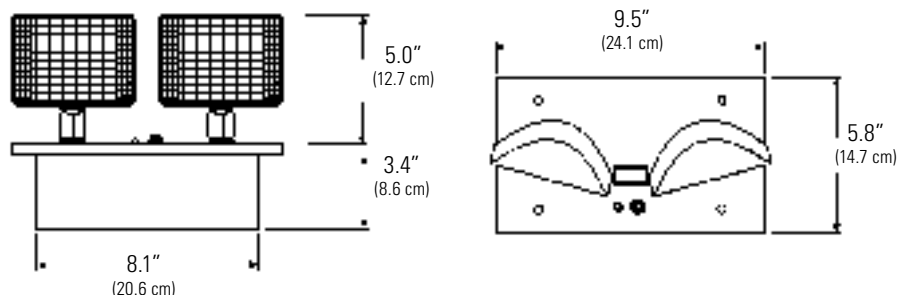

## How to Specify:

C1				
<b>SERIES</b>	<b>DC VOLTAGE</b>	<b>BATTERY</b>	<b># OF HEADS</b>	<b>LAMP HEADS</b>
C1 = Recessed Emergency Lighting Unit	Blank = 6 volt 2 = 12 volt	<u>6V, Lead Calcium</u> 18L = 18W Unit 25L = 25W Unit <u>6V, Nickel Cadmium</u> 14N = 14W Unit 28N = 28W Unit <u>12V, Lead Calcium</u> 50L = 50W Unit 75L = 75W Unit	Blank = No Heads 1 = One Head 2 = Two Heads	Rectangular Wedge Base S6 = 5.4W Tungsten (6V only) S7 = 7.2W Tungsten (6V only) S9 = 9W Tungsten S12 = 12W Tungsten (12V only) S18 = 18W Tungsten (12V only)

## Features

- 1. Illumination:** Provided by two adjustable lamp heads. Choose from round or rectangular thermoplastic heads with Par 36 sealed beam tungsten or halogen, or wedge base tungsten or halogen lamps.
- 2. Housing:** Faceplate constructed of impact resistant, UL 94 V-0, 5 VA white thermoplastic. Backbox constructed of 20 gauge galvanized steel with 1/2" conduit. Fully recessed assembly for ceiling or wall installation. An optional bar hanger kit is available for mounting in suspended ceilings.
- 3. Electronics:** 120/277 VAC dual voltage input with surge-protected, solid-state circuitry. Charging system is complete with low voltage disconnect, AC lockout, brownout protection, AC indicator lamp and test switch.
- 4. Battery:** Maintenance-free, sealed, lead calcium battery has an estimated service life of 5 years, and an operating temperature range of 65°F (19°C) to 85°F (30°C). Maintenance-free, sealed nickel cadmium battery has an estimated service life of 10 years, and an operating temperature range of 20°F (-7°C) to 95°F (35°C).
- 5. Input Power Requirements:** 120 VAC/6V: 0.07 amps, 7.3 watts; 277 VAC/6V: 0.03 amps, 7.3 watts; 120 VAC/12V: 0.29 amps, 30 watts; 277 VAC/12V: 0.13 amps, 30 watts

## Code Compliance

UL 924 listed.

## Options

V = Voltmeter

DL = Damp Location Listing (12V, 50W units only)

C128N cannot accommodate a voltmeter.

## Accessories

BHK1 = Bar Hanger Kit

PCS1 = Polycarbonate Vandal Shield

Job Information	Type:
<b>Job Name:</b>	
<b>Cat. No.:</b>	
<b>Lamp(s):</b>	
<b>Notes:</b>	

631 Airport Road, Fall River, MA 02720 • (508) 679-8131 • Fax (508) 674-4710  
We reserve the right to change details of design, materials and finish.  
www.lightolier.com © 2008 Philips Group • E0308

## Lamp Head Photometrics

**S6- 6 Volt, 5.4 Watt, Tungsten**

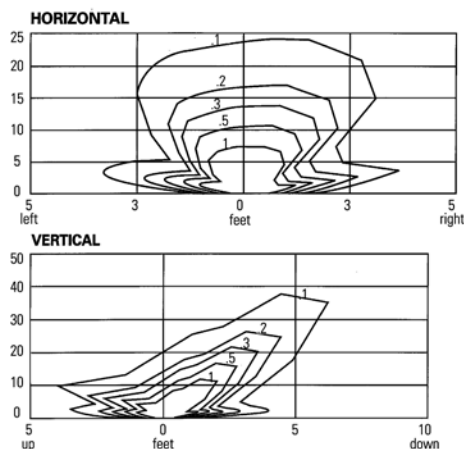

**S7- 6 Volt, 7.2 Watt, Tungsten**

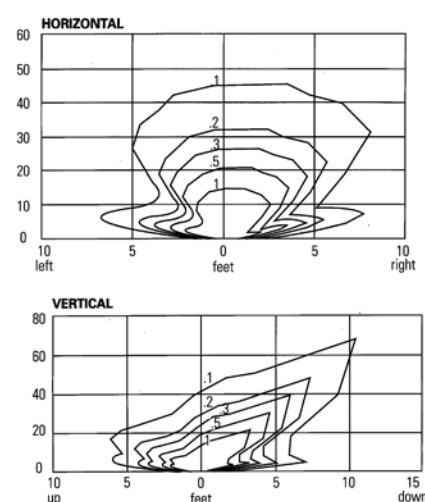

**S9- 6 Volt, 9 Watt, Tungsten**

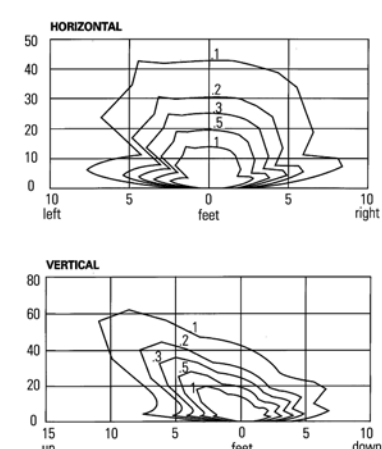

**S9- 12 Volt, 9 Watt, Tungsten**

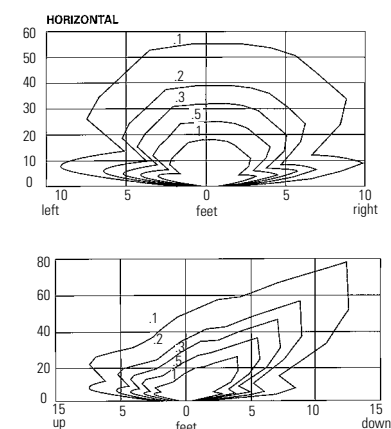

**S12- 12 Volt, 12.5 Watt, Tungsten**

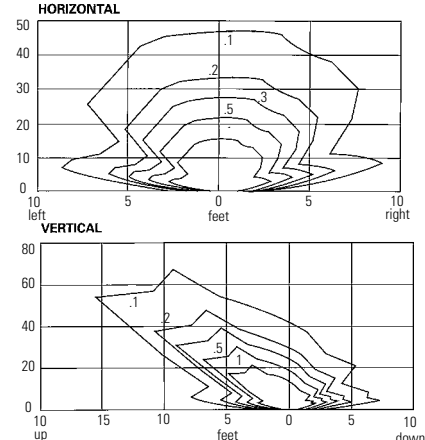

**S18- 12 Volt, 18 Watt, Tungsten**

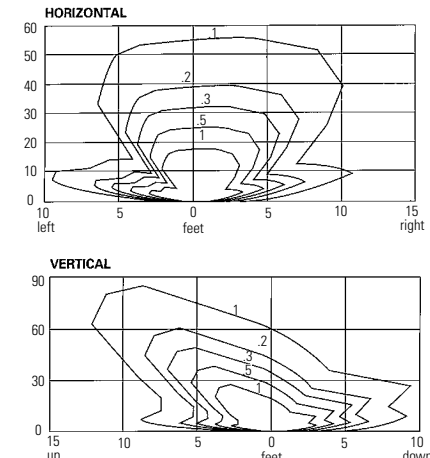

## Unit Battery Capacity

DC Voltage	Unit	Suggested Lamp Head	Watts to 87% of Rated Voltage*			
			1½ hrs.	2 hrs.	4 hrs.	8 hrs.
6	C118L	S9	18	13.5	7	—
	C125L	S9	25	19	9.5	—
	C114N	S6	14	10.5	—	—
	C128N	S9	28	21	10.5	5.4
12	C1250L	S9	50	37.5	19	10
	C1275L	S9	75	59.8	33.3	14.4

\* Per NEC Specifications

## Warranty

Electronics: 3 years

Battery: 1 year full, 4 years pro-rata (lead calcium);

5 year full, 5 years pro-rata (nickel cadmium)

## Job Information

## Type:

631 Airport Road, Fall River, MA 02720 • (508) 679-8131 • Fax (508) 674-4710

We reserve the right to change details of design, materials and finish.

www.lightolier.com © 2008 Philips Group • E0308