

COOPER LIGHTING - METALUX®

DESCRIPTION

The GR8 is a T8-dedicated lensed troffer designed to offer premium performance in a low profile housing. T8 dedication and optimized lamp to lens spacing provides the best in energy efficiency and optical control. The GR8's shallow, low profile housing is compatible with even highly restrictive plenums. Luminaires are compatible with today's popular ceiling systems.

The GR8 offers great performance and great quality. The series is an excellent choice for commercial offices, schools, hospitals, retail merchandising and many other applications.

Catalog #		Type
Project		
Comments		Date
Prepared by		

SPECIFICATION FEATURES

A ... Construction

Low profile recessed housing is die formed of code gauge prime cold rolled steel with full length stiffeners and mechanical endplate attachment for added strength. Ballast cover is easily removed without tools. Die formed captive lampholder bracket fully encloses lampholder wiring for easy lampholder replacement. Ample KOs are provided for continuous row wiring. Built-in grid-lock feature for safety and convenience.

B ... Electrical**

Ballasts are CBM/ETL Class "P" and are positively secured. Pressure lock lampholders. UL/CUL listed. Suitable for damp locations.

C ... Finish

Multistage, iron phosphate pretreatment ensures maximum bonding and rust inhibition. Lighting grade baked white enamel finish with premium reflectance for high efficiency.

D ... Hinging/Latching

Positive cam action steel latches and integral safety hinges provide secure, high quality door fit and allow hinging and latching from either side.

E ... Frame/Shielding

Heavy gauge flat steel door is die formed with reinforced mitered corners. Housing and door frame assemblies incorporate full length and width mechanical light traps. Light stabilized, acrylic prismatic lens.

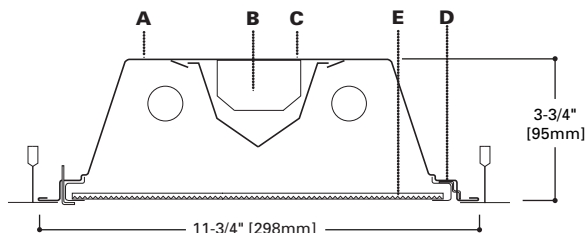

MOUNTING DATA

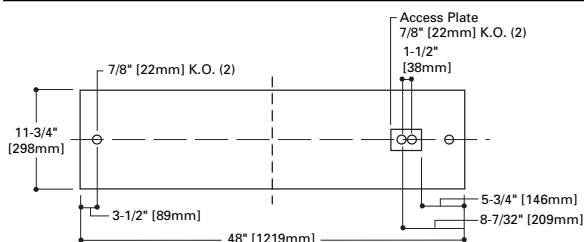

DOOR FRAMES

GR8
Flat, White
Steel (White Latches)



LAMP CONFIGURATIONS

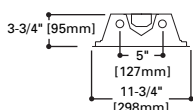

CEILING COMPATIBILITY

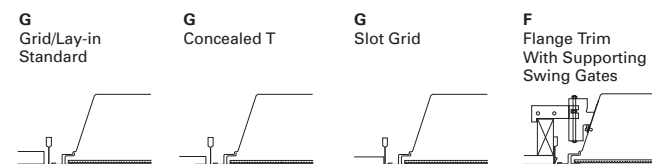

Ceiling Type	Trim Type
Exposed Grid	G
Concealed T	G
Slot Grid	G
Flange	G***

(Verify compatibility/consult factory.)

ENERGY DATA

Input Watts:

EB Ballast & STD Lamps
232 (61)

ES Ballast & STD Lamps
232 (71)

Luminaire Efficacy Rating

LER = FL-58

Catalog Number: GR8-232A

Yearly Cost of 1000 lumens,
3000 hrs at .08 KWH = \$4.14

*Standard G (Grid) Type Fixtures can be field converted by adding trim kits. See Compatibility Section or Consult Factory.

**Reference the lamp/ballast data in the Technical Section for specific lamp/ballast requirements.

***Order FCS-14W-U Flange Kit for installation in drywall ceiling. See options and accessories compatibility section.

LAMPS CONTAIN MERCURY. DISPOSE ACCORDING TO LOCAL, STATE OR FEDERAL LAWS

LINEAR DISCONNECT
Safe and convenient means of disconnecting power



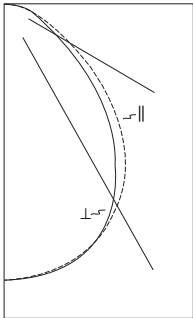

GR8-232A
 Electronic Ballast
 F32T8/35K lamps
 2800 lumens
 Spacing criterion:
 (||) 1.2 x mounting
 height, (⊥) 1.2 x
 mounting height
 Efficiency 68.2%
 Test Report:
 GR8232A.IES
 LER = FL-58
 Yearly Cost of 1000
 lumens, 3000 hrs at
 .08 KWH = \$4.14

Coefficients of Utilization

Effective floor cavity reflectance										20%																			
rc	80%					70%					50%					30%					10%					0%			
rw	70	50	30	10	70	50	30	10	50	30	10	50	30	10	50	30	10	50	30	10	0								
RCR																													
0	81	81	81	81	79	79	79	79	76	76	76	73	73	73	70	70	70	68											
1	75	73	70	68	74	71	69	67	68	66	65	66	64	63	63	62	61	60											
2	70	65	61	58	68	64	60	57	61	58	56	59	57	55	57	55	53	52											
3	65	59	54	50	63	58	53	50	56	52	49	54	51	48	52	49	47	46											
4	60	53	47	43	58	52	47	43	50	46	43	49	45	42	47	44	42	40											
5	55	47	42	38	54	47	41	38	45	41	37	44	40	37	43	39	36	35											
6	51	43	37	33	50	42	37	33	41	36	33	40	36	33	39	35	32	31											
7	47	39	33	29	46	38	33	29	37	33	29	36	32	29	35	32	29	27											
8	44	35	30	26	43	35	29	26	34	29	26	33	29	25	32	28	25	24											
9	40	32	26	23	39	31	26	22	30	26	22	30	25	22	29	25	22	21											
10	38	29	24	20	37	28	23	20	28	23	20	27	23	20	27	23	20	19											

Zonal Lumen Summary

Zone	Lumens	%Lamp	%Fixture
0-30	1322	23.6	34.6
0-40	2104	37.6	55.1
0-60	3301	58.9	86.4
0-90	3821	68.2	100.0
0-180	3821	68.2	100.0

Typical VCP Percentages

Room Size (Ft.)	Height Along		Height Across	
	8.5'	10.0'	8.5'	10.0'
20 x 20	61	64	62	67
30 x 30	54	58	54	59
30 x 60	45	48	44	47
60 x 30	56	60	57	61
60 x 60	46	49	45	48

Candlepower

Angle	Along	45°	Across ⊥
0	1704	1704	1704
5	1695	1701	1699
10	1674	1683	1685
15	1637	1650	1652
20	1583	1597	1595
25	1511	1519	1496
30	1418	1405	1357
35	1300	1260	1199
40	1158	1089	1030
45	988	902	854
50	795	718	677
55	619	550	508
60	462	393	369
65	332	264	272
70	235	175	211
75	167	129	172
80	123	107	132
85	65	60	72
90	0	0	0

ORDERING INFORMATION

Sample Number: 2GR8-232A-120V-EB81-U

Width

= 1' width

Trim Type

G: Grid/Lay-in (Standard)

Series

R8: General Purpose¹ T8 Commercial Troffer

Number of Lamps²

2: 2 Lamps (Not Included)

Wattage

32: 32W T8 (48")

Shielding

A: # 12 Acrylic Pattern

A125: #12 Pattern Acrylic (.125" Thickness)

Voltage³

120V: 120 Volt

277V: 277 Volt

347V: 347 Volt

UNV: Universal Voltage 120-277⁴

Options

GL: Single Element Fuse

GM: Double Element Fuse

Lamps: Lamps Installed

Flex: Flex Installed

Emergency: EM Installed

Ballast Type³

EB: Electronic Instant Start

ER: T8 Electronic Program Rapid Start. Total Harmonic Distortion < 10%

DLS: Digital Lighting System Dimming

Lamp Size

8: T8

Number of Ballasts

1: 1 Ballast

2: 2 Ballast

Options

/PLUS: Higher Ballast Factor > 1.13. Total Harmonic Distortion < 20%

FR: Fire Rated Label

Packaging

U: Unit Pack

- Notes: 1 An EQ Grid Clip is recommended for all 9/16" ceiling systems.
 2 Standard off-center ballast on 3 lamp fixtures.
 3 Products also available in non-US voltage and frequencies for international markets
 4 Not Available when specifying emergencies, voltage must be specific

ACCESSORIES

EQ = T-Bar Safety Earthquake Clips¹
 FCS-XXW-U = Field Installed Flange Kit

SHIPPING INFORMATION

Catalog No.	Wt.
GR8-232A	19 lbs.