

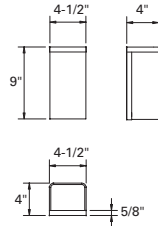

632-WP SERIES

632-WP Luminous Shield is economical and is ADA compliant.



Sample Number: 632-WP-CFL/1/26-277V-GM

Series	Lamp	Voltage	Finish ²
632-WP = Luminous Shield	CFL/1/13	120V	BK, WH (standard),
	CFL/1/26	277V ¹	BM, CC, DP, GM,
	INC/1/60	347V ¹	GRM, GY, SM

Notes:

- 1 Available with CFL only.
- 2 Premium TGIC polyester powder coat paint, 2.5 mil nominal thickness for superior protection against fade and wear.

MATERIAL

Solid aluminum construction with a matte white acrylic diffuser. Open bottom and enclosed top.

BALLAST

Integral electronic HPF multi-volt 120/277V (347V Canada), thermally protected with end-of-life circuitry to accommodate 13W or 26W lamps.

INSTALLATION

Supplied with a universal circular strap for a standard 4" J-box or plaster ring.

LAMP/SOCKET

One (1) 13W (2GX7) 4-pin low wattage CFL or 26W (G24q-3) 4-pin quad tube CFL lamp, or one (1) 60W A-19 lamp. CFL socket injection molded plastic. INC socket fired ceramic rated for 660W-250V. Lamps furnished by others.

FINISH AND OPTIONS

See page 1020 for finish details and options.



633-WP SERIES

633-WP Traditional Lantern is available in two styles and offers four diffuser options.

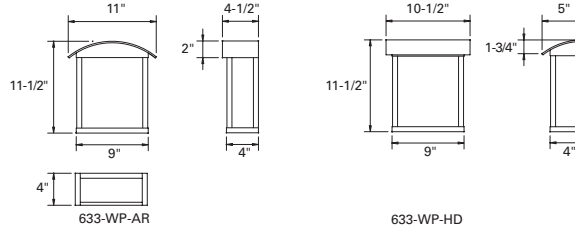

Sample Number: 633-WP-AR-CFL/2/13-277V-GM

Series	Style	Lamp	Voltage	Finish ^{2,3}	Options
633-WP = Traditional Lantern	AR = Arch	CFL/2/13	120V	NBZ (standard),	OGD
	HD = Hood	CFL/2/26	277V ¹	BK, BM, CC, DP,	SGD ⁴
		INC/2/60	347V ¹	GM, GRM, GY, SCL, SM, SNL, VG, WH	VRD

Notes:

- 1 Available with CFL only.
- 2 Premium TGIC polyester powder coat paint, 2.5 mil nominal thickness for superior protection against fade and wear.
- 3 Bronze and copper will weather to a dark bronze patina.
- 4 For use with decorative incandescent lamps only.

MATERIAL

Solid bronze frame with a 3/16" solid copper hood or arch. White acrylic diffuser or optional Vandal Resistant 1/8" White Acrylic Diffuser (VRD), Clear Seedy Glass Diffuser (for use with decorative incandescent lamps only) (SGD) or White Opal Glass Diffuser (OGD).

BALLAST

Integral electronic HPF, multi-volt 120/277V (347V Canada), thermally protected with end-of-life circuitry to accommodate the specified lamp wattage.

INSTALLATION

Supplied with a mounting back for a standard 4" J-box or stucco ring.

LAMP/SOCKET

Two(2) 13W (2GX7) 4-pin low wattage or 26W (G24q-3) quad CFL lamps or two (2) 60W T-10 lamps. CFL socket injection molded plastic. INC socket fired ceramic rated for 660W-250V. Lamps furnished by others.

FINISH AND OPTIONS

See page 1020 for finish details and options.



641-WP SERIES

641-WP Quarter Sphere Wall Sconce features indirect illumination.

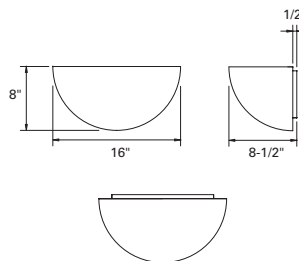

Sample Number: 641-WP-MH/1/70-277V-GM

Series	Lamp	Voltage	Finish ^{3,4}	Options
641-WP = Quarter Sphere	CFL/1 (26/32/42W-Triple)	120V	NBZ (standard),	C
	INC/1/150	277V ¹	BK, BM, CC, DP,	
	MH/1/50	347V ²	GM, GRM, GY,	
	MH/1/70		SCL, SM, SNL, VG, WH	

Notes:

- 1 CFL and MH only.
- 2 Available with CFL only.
- 3 Premium TGIC polyester powder coat paint, 2.5 mil nominal thickness for superior protection against fade and wear.
- 4 Bronze will weather to a dark bronze patina.

MATERIAL

Painted aluminum or solid bronze. Internal lamp assembly is cast aluminum with clear acrylic lens for CFL and tempered clear lens for incandescent and metal halide.

BALLAST

Integral electronic HPF, multi-volt 120/277V (347V Canada), thermally protected with end-of-life circuitry to accommodate the specified lamp wattage. Metal halide ballasts are electronic HPF, multi-volt 120/277V for the specified lamp wattage. 347V ballast for metal halide - Contact factory.

INSTALLATION

Supplied with a universal circular strap for a standard 4" J-box or stucco ring. Optional rear (through wall) feed conduit mounting.

LAMP/SOCKET

One (1) 26W, 32W (GX24q-3) or 42W (GX24q-4) 4-pin triple tube CFL lamp, one (1) 50W, 70W, 100W metal halide ED-17 lamp, or one (1) 150W A-21 lamp. CFL socket injection molded plastic. INC socket fired ceramic rated for 660W-250V. Metal halide socket is ceramic pulse-rated, 4KV. Lamps furnished by others.

FINISH AND OPTIONS

See page 1020 for finish details and options.