

VERTICAL 6" OPEN, CFL

6

Dimensions	Length	Width	Height	Cutout
Standard Housing	12-7/8"	10-5/8"	8-7/8"	6-1/4"
EM Housing	17-1/4"	10-5/8"	8-7/8"	

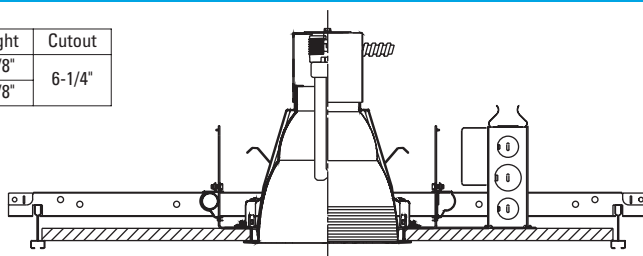

PD6 PD7 Open Vertical CFL

STANDARD (Frame, socket adapter and reflector ship separately.)

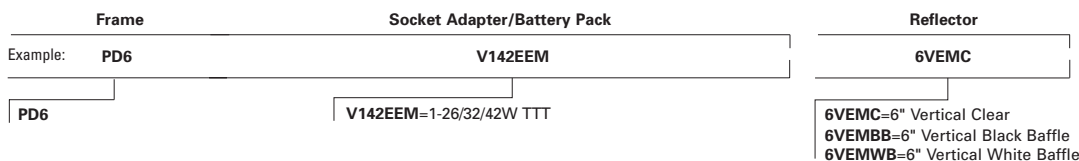
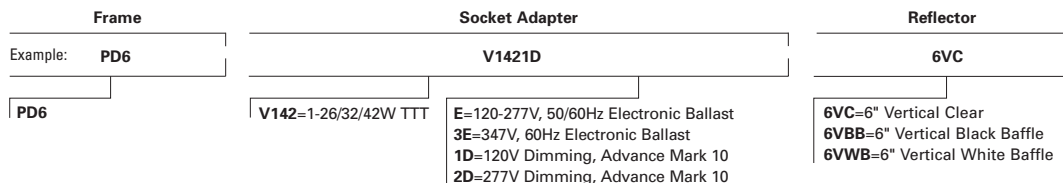

Other Standard, Dimming and EM ballasts available. Consult factory.

- Low iridescent, clear reflector
- White painted self flange
- Torsion springs pull reflector to ceiling
- One piece folded metal socket cap
- Universal voltage ballast
- 120V & 277V Advance Mark 10 dimming
- Universal 4-pin socket
- Galvanized steel frame with 1/2" plaster lip
- Accommodates ceilings up to 2" thick
- Bar hangers lock to T-bar with screwdrivers or pliers
- Galvanized J-box with multiple KO's, listed for twelve #12AWG 90C conductors
- cUL listed, damp location
- "EM" fixtures use internally mounted test switch/indicator light

VERTICAL 7" OPEN, CFL

7

Dimensions	Length	Width	Height	Cutout
Standard Housing	15-5/8"	13-1/2"	10"*	6-1/4"
EM Housing	17-1/4"	13-1/2"	10"*	

*26W/32W 9-1/2"

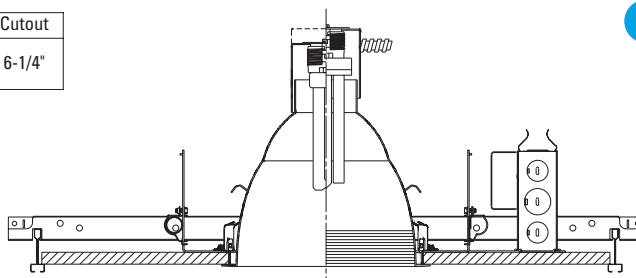

STANDARD (Frame, socket adapter and reflector ship separately.)

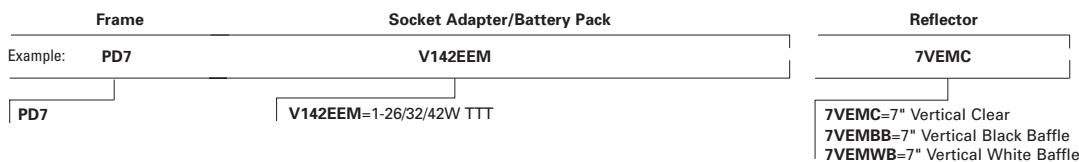
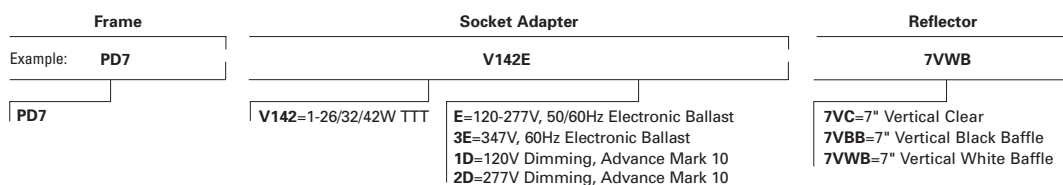

Other Standard, Dimming and EM ballasts available. Consult factory.



by Portfolio™

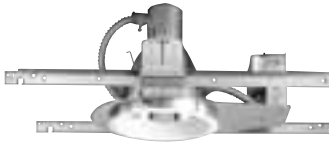

PD6
PD7
Lensed
Vertical
CFL



- Low iridescent, clear reflector
- White painted self flange
- Torsion springs pull reflector to ceiling
- One piece folded metal socket cap
- Universal voltage ballast
- 120V & 277V Advance Mark 10 dimming
- Universal 4-pin socket
- Galvanized steel frame with 1/2" plaster lip
- Accommodates ceilings up to 2" thick
- Bar hangers lock to T-bar with screwdrivers or pliers
- Galvanized J-box with multiple KO's, listed for twelve #12AWG 90C conductors
- cUL listed, wet location
- "EM" fixtures use internally mounted test switch/indicator light

VERTICAL 6" LENS, CFL

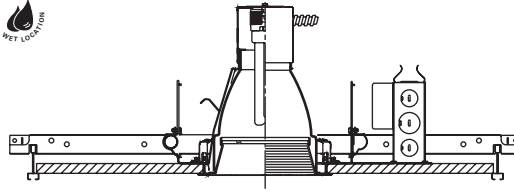

Dimensions	Length	Width	Height	Cutout
Standard Housing	12-7/8"	10-5/8"	9-13/16"	6-1/4"
EM Housing	17-1/4"	10-5/8"	9-13/16"	

STANDARD (Frame, socket adapter and reflector ship separately.)

Frame	Socket Adapter	Reflector
Example: PD6	V142E	6VL4C
PD6	V142=1-26/32/42W TTT	<ul style="list-style-type: none"> 6VL1BB=6" Vertical Prismatic Acrylic Black Baffle 6VL2BB=6" Vertical Prismatic Glass Black Baffle 6VL4BB=6" Vertical Fresnel Glass Black Baffle 6VL1WB=6" Vertical Prismatic Acrylic White Baffle 6VL2WB=6" Vertical Prismatic Glass White Baffle 6VL4WB=6" Vertical Fresnel Glass White Baffle 6VL1C=6" Vertical Prismatic Acrylic Clear Cone 6VL2C=6" Vertical Prismatic Glass Clear Cone 6VL4C=6" Vertical Fresnel Glass Clear Cone

Ballast Options:
E=120-277V, 50/60Hz Electronic Ballast
3E=347V, 60Hz Electronic Ballast
1D=120V Dimming, Advance Mark 10
2D=277V Dimming, Advance Mark 10

EMERGENCY (Frame and socket adapter/battery pack ship together. Reflector ships separately.)

Frame	Socket Adapter/Battery Pack	Reflector
Example: PD6	V142EEM	6VL1EMBB
PD6	V142EEM=1-26/32/42W TTT	<ul style="list-style-type: none"> 6VL1EMC=6" Vertical Prismatic lens, Clear 6VL1EMBB=6" Vertical Prismatic lens, Black Baffle 6VL1EMWB=6" Vertical Prismatic lens, White Baffle 6VL2EMC=6" Vertical Prismatic Glass lens, Clear 6VL2EMBB=6" Vertical Prismatic Glass lens, Black Baffle 6VL2EMWB=6" Vertical Prismatic Glass lens, White Baffle 6VL4EMC=6" Vertical Fresnel lens, Clear 6VL4EMBB=6" Vertical Fresnel lens, Black Baffle 6VL4EMWB=6" Vertical Fresnel lens, White Baffle

Other Standard, Dimming and EM ballasts available. Consult factory.

VERTICAL 7" LENS, CFL

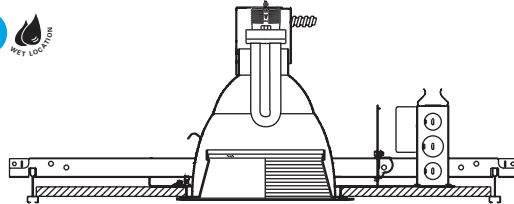

Dimensions	Length	Width	Height	Cutout
Standard Housing	15-5/8"	13-1/2"	10"	8"
EM Housing	17-1/4"	13-1/2"	10"	8"

STANDARD (Frame, socket adapter and reflector ship separately.)

Frame	Socket Adapter	Reflector
Example: PD7	V1422D	7VL2BB
PD7	V142=1-26/32/42W TTT	<ul style="list-style-type: none"> 7VL1BB=6" Vertical Prismatic Acrylic Black Baffle 7VL2BB=6" Vertical Prismatic Glass Black Baffle 7VL4BB=6" Vertical Fresnel Glass Black Baffle 7VL1WB=6" Vertical Prismatic Acrylic White Baffle 7VL2WB=6" Vertical Prismatic Glass White Baffle 7VL4WB=6" Vertical Fresnel Glass White Baffle 7VL1C=6" Vertical Prismatic Acrylic Clear Cone 7VL2C=6" Vertical Prismatic Glass Clear Cone 7VL4C=6" Vertical Fresnel Glass Clear Cone

Ballast Options:
E=120-277V, 50/60Hz Electronic Ballast
3E=347V, 60Hz Electronic Ballast
1D=120V Dimming, Advance Mark 10
2D=277V Dimming, Advance Mark 10

EMERGENCY (Frame and socket adapter/battery pack ship together. Reflector ships separately.)

Frame	Socket Adapter/Battery Pack	Reflector
Example: PD7	V142EEM	7VL2EMC
PD7	V142EEM=1-26/32/42W TTT	<ul style="list-style-type: none"> 7VL1EMC=7" Vertical Prismatic Acrylic lens, Clear 7VL1EMBB=7" Horizontal Prismatic Acrylic lens, Black Baffle 7VL1EMWB=7" Horizontal Prismatic Acrylic lens, White Baffle 7VL2EMC=7" Vertical Prismatic Glass lens, Clear 7VL2EMBB=7" Vertical Prismatic Glass lens, Black Baffle 7VL2EMWB=7" Vertical Prismatic Glass lens, White Baffle 7VL4EMC=7" Vertical Fresnel lens, Clear 7VL4EMBB=7" Vertical Fresnel lens, Black Baffle 7VL4EMWB=7" Vertical Fresnel lens, White Baffle

Other Standard, Dimming and EM ballasts available. Consult factory.

HORIZONTAL 6" OPEN, CFL

6

Dimensions	Length	Width	Height	Cutout
Standard Housing	12-7/8"	10-5/8"	5-3/4"	6-1/4"
EM Housing	17-1/4"	10-5/8"	5-3/4"	

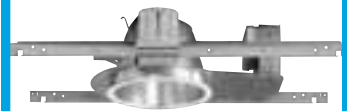
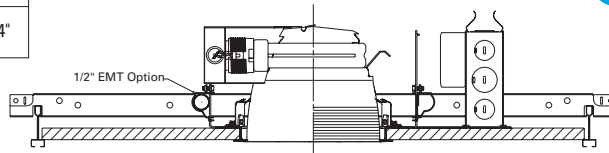

STANDARD (Frame, socket adapter and reflector ship separately.)

Frame	Socket Adapter	Reflector
Example: PD6	H2263E	6HC
PD6	H118 =1-18W DTT H126 =1-26W DTT H142 =1-26/32/42W TTT H218 =2-18W DTT H226 =2-26W DTT	E =120-277V, 50/60Hz Electronic Ballast 3E =347V, 60Hz Electronic Ballast 1D =120V Dimming, Advance Mark 10 2D =277V Dimming, Advance Mark 10
		6HC =6" Horizontal Clear 6HBB =6" Horizontal Black Baffle 6HWB =6" Horizontal White Baffle

EMERGENCY (Frame and socket adapter/battery pack ship together. Reflector ships separately.)

Frame	Socket Adapter/Battery Pack	Reflector
Example: PD6	H118EEM	6HEMC
PD6	H118EEM =1-18W DTT H126EEM =1-26W DTT H142EEM =1-26/32/42W TTT H218EEM =2-18W DTT H226EEM =2-26W DTT	6HEMC =6" Horizontal Clear 6HEMBB =6" Horizontal Black Baffle 6HEMWB =6" Horizontal White Baffle

Other Standard, Dimming and EM ballasts available. Consult factory.

PD6 PD7 Open Horizontal CFL

- Low iridescent, clear reflector
- White painted self flange
- Torsion springs pull reflector to ceiling
- One piece folded metal socket cap
- Universal voltage ballast
- 120V & 277V Advance Mark 10 dimming
- Universal 4-pin socket
- Galvanized steel frame with 1/2" plaster lip
- Accommodates ceilings up to 2" thick
- Bar hangers lock to T-bar with screwdrivers or pliers
- Galvanized J-box with multiple KO's, listed for twelve #12AWG 90C conductors
- cUL listed, damp location
- "EM" fixtures use internally mounted test switch/indicator light

HORIZONTAL 7" OPEN, CFL

7

Dimensions	Length	Width	Height	Cutout
Standard Housing	15-5/8"	13-1/2"	5-7/8"	8"
EM Housing	17-1/4"	13-1/2"	5-7/8"	8"

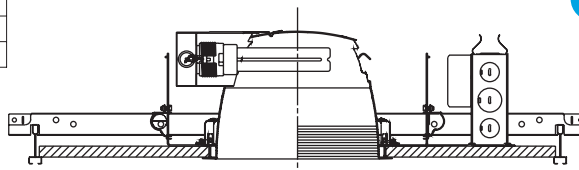

STANDARD (Frame, socket adapter and reflector ship separately.)

Frame	Socket Adapter	Reflector
Example: PD7	H1421D	7HC
PD7	H118 =1-18W DTT H126 =1-26W DTT H142 =1-26/32/42W TTT H218 =2-18W DTT H226 =2-26W DTT	E =120-277V, 50/60Hz Electronic Ballast 3E =347V, 50/60Hz Electronic Ballast 1D =120V Dimming, Advance Mark 10 Powerline 2D =277V Dimming, Advance Mark 10 Powerline
		7HC =7" Horizontal Clear 7HBB =7" Horizontal Black Baffle 7HWB =7" Horizontal White Baffle

EMERGENCY (Frame and socket adapter/battery pack ship together. Reflector ships separately.)

Frame	Socket Adapter/Battery Pack	Reflector
Example: PD7	H118EEM	7HEMBB
PD7	H118EEM =(1) 18W DTT H126EEM =(1) 26W DTT H142EEM =1-26/32/42 TTT H218EEM =(2) 18W DTT H226EEM =(2) 26W DTT	7HEMC =7" Horizontal Clear 7HEMBB =7" Horizontal Black Baffle 7HEMWB =7" Horizontal White Baffle

Other Standard, Dimming and EM ballasts available. Consult factory.



**PD6
PD7**
Lensed
Horizontal
CFL

- Low iridescent, clear reflector
- White painted self flange
- Torsion springs pull reflector to ceiling
- One piece folded metal socket cap
- Universal voltage ballast
- 120V & 277V Advance Mark 10 dimming
- Universal 4-pin socket
- Galvanized steel frame with 1/2" plaster lip
- Accommodates ceilings up to 2" thick
- Bar hangers lock to T-bar with screwdrivers or pliers
- Galvanized J-box with multiple KO's, listed for twelve #12AWG 90C conductors
- cUL listed, wet location
- "EM" fixtures use internally mounted test switch/indicator light

HORIZONTAL 6" LENS, CFL

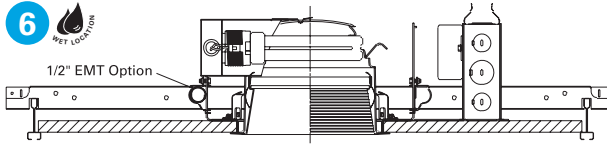

Dimensions	Length	Width	Height	Cutout
Standard Housing	12-7/8"	10-5/8"	5-3/4"	6-1/4"
EM Housing	17-1/4"	10-5/8"	5-3/4"	

STANDARD (Frame, socket adapter and reflector ship separately.)

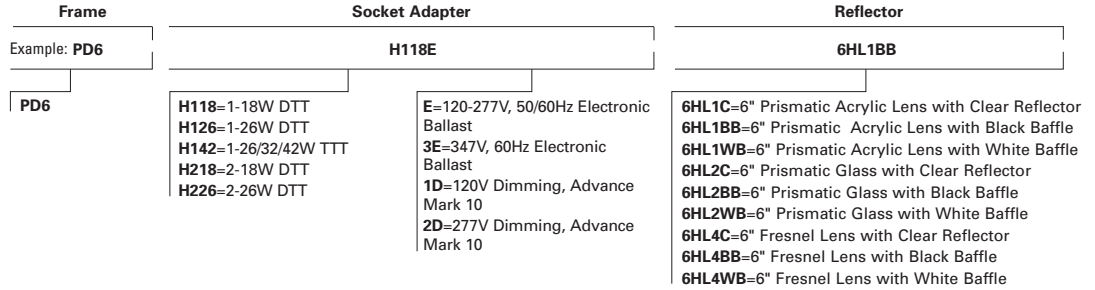

EMERGENCY (Frame and socket adapter/battery pack ship together. Reflector ships separately.)

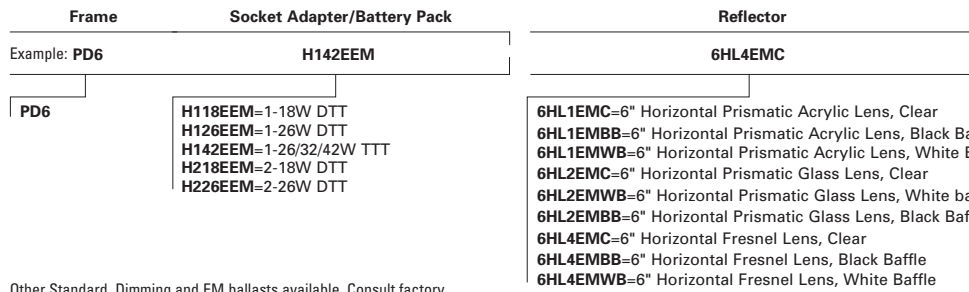

Other Standard, Dimming and EM ballasts available. Consult factory.

HORIZONTAL 7" LENS, CFL

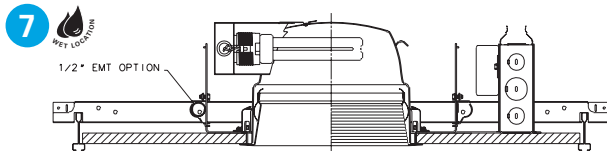

Dimensions	Length	Width	Height	Cutout
Standard Housing	15-5/8"	13-1/2"	5-7/8"	8"
EM Housing	17-1/4"	13-1/2"	5-7/8"	

STANDARD (Frame, socket adapter and reflector ship separately.)

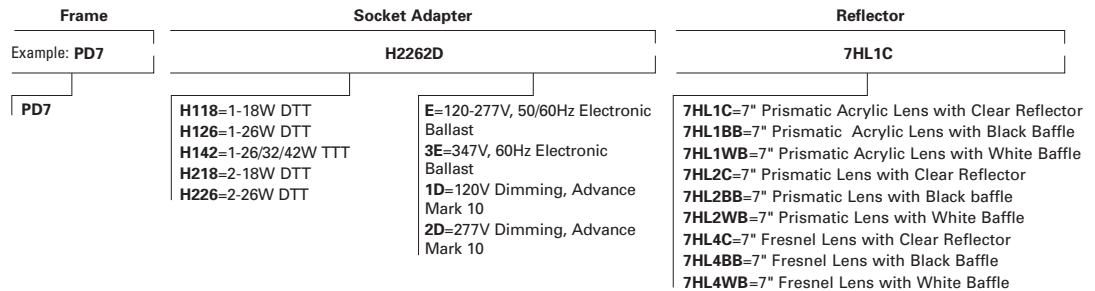

EMERGENCY (Frame and socket adapter/battery pack ship together. Reflector ships separately.)

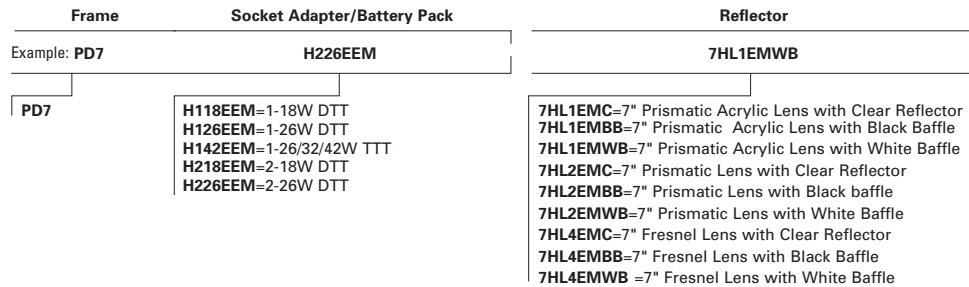

Other Standard, Dimming and EM ballasts available. Consult factory.



by Portfolio™

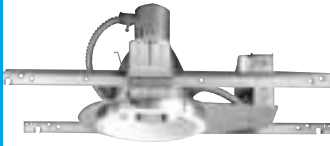

**PD6
PD7
Open
Incandescent**

- Low iridescent, clear reflector
- White painted self flange
- Torsion springs pull reflector to ceiling
- One piece folded metal socket cap
- Galvanized steel frame with 1/2" plaster lip
- Accommodates ceilings up to 2" thick
- Bar hangers lock to T-bar with screwdrivers or pliers
- Galvanized J-box with multiple KO's, listed for twelve #12AWG 90C conductors
- cUL listed, damp location

6" OPEN, A21 - 150W MAX

6

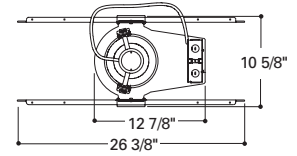
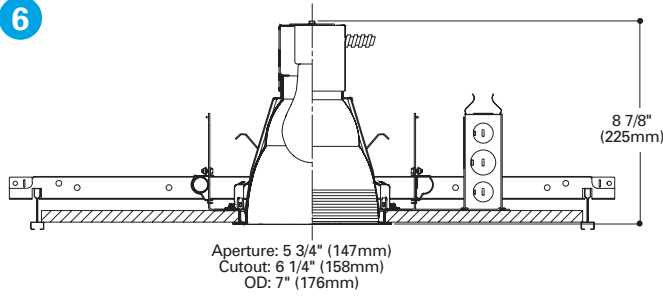

Frame, socket adapter and reflector ship separately.

Frame	Socket Adapter	Reflector
Example: PD6	V120	6VC
PD6	V120=E26 Medium Base Incandescent	Fixture Reflector Accommodates PAR30 long neck version only 6VC=6" Vertical Clear 6VBB=6" Vertical Black Baffle 6VWB=6" Vertical White Baffle

7" OPEN, A21 - 150W MAX

7

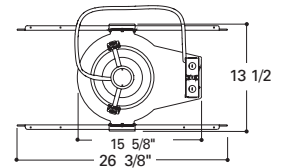
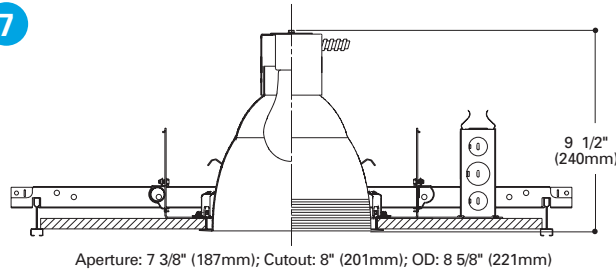

Frame, socket adapter and reflector ship separately.

Frame	Socket Adapter	Reflector
Example: PD7	V120	7VC
PD7	V120=E26 Medium Base Incandescent	7VC=7" Vertical Clear 7VBB=7" Vertical Black Baffle 7VWB=7" Vertical White Baffle

7" OPEN, PAR38, INCANDESCENT - 90W PAR38, Q150 PAR38

7

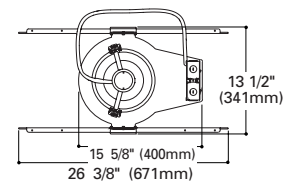
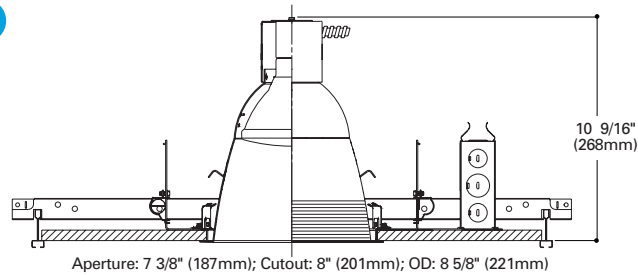

Frame, socket adapter and reflector ship separately.

Frame	Socket Adapter	Reflector
PD7	V120	7VP38C
Frame PD7	Socket Adapter V120=E26 Medium Base Incandescent	Reflector 7VP38C=7" Vertical Clear 7VP38BB=7" Vertical Black Baffle 7VP38WB=7" Vertical White Baffle

150W MAX - 6" LENS, A19

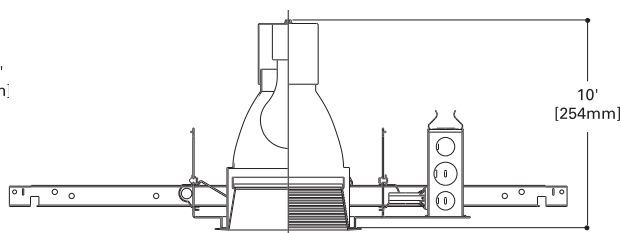
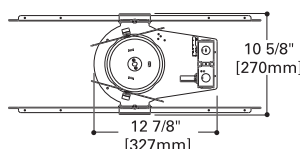

Aperture: 5 5/8" (143mm)
Cutout: 6 1/4" (158mm)
OD: 7" (176mm)



**PD6
PD7**
Lensed
Incandescent

Frame, socket adapter and reflector ship separately.

Frame	Socket Adapter	Reflector
Example: PD6	V120	6VL2WB
PD6	V120 =E26 Medium Base Incandescent	6VL2C =6" Vertical Prismatic Glass lens, clear 6VL2BB =6" Vertical Prismatic Glass lens, Black Baffle 6VL2WB =6" Vertical Prismatic Glass lens, White Baffle 6VL4EC =6" Vertical Fresnel lens, Clear 6VL4EBB =6" Vertical Fresnel lens, Black Baffle 6VL4EWB =6" Vertical Fresnel lens, White Baffle

- Low iridescent, clear reflector
- White painted self flange
- Torsion springs pull reflector to ceiling
- One piece folded metal socket cap
- Galvanized steel frame with 1/2" plaster lip
- Accommodates ceilings up to 2" thick
- Bar hangers lock to T-bar with screwdrivers or pliers
- Galvanized J-box with multiple KO's, listed for twelve #12AWG 90C conductors
- cUL listed, wet location

150W MAX - 7" LENS, A21

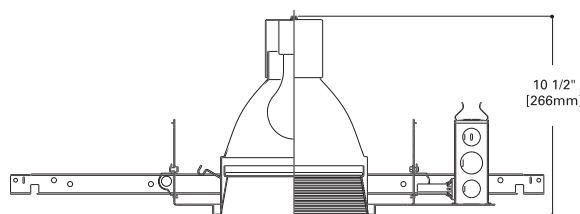
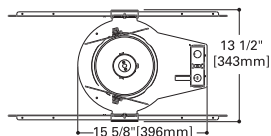

Aperture: 7 1/4" (184mm)
Cutout: 8" (201mm)
OD: 8 5/8" (221mm)

Frame, socket adapter and reflector ship separately.

Frame	Socket Adapter	Reflector
Example: PD7	V120	7VL2WB
PD7	V120 =E26 Medium Base Incandescent	7VL2C =7" Vertical Prismatic Glass lens, Clear 7VL2BB =7" Vertical Prismatic Glass lens, Black Baffle 7VL2WB =7" Vertical Prismatic Glass lens, White Baffle 7VL4C =7" Vertical Fresnel lens, Clear 7VL4BB =7" Vertical Fresnel lens, Black Baffle 7VL4WB =7" Vertical Fresnel lens, White Baffle



by Portfolio™

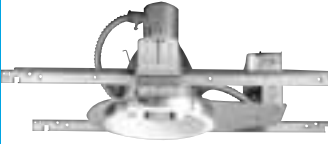

PD6
PD7
Open
Metal Halide

- Low iridescent, clear reflector
- White painted self flange
- Torsion springs pull reflector to ceiling
- One piece folded metal socket cap
- Galvanized steel frame with 1/2" plaster lip
- Accommodates ceilings up to 2" thick
- Bar hangers lock to T-bar with screwdrivers or pliers
- Galvanized J-box with multiple KO's, listed for twelve #12AWG 90C conductors
- cUL listed, damp location

6" OPEN, ED17P MH

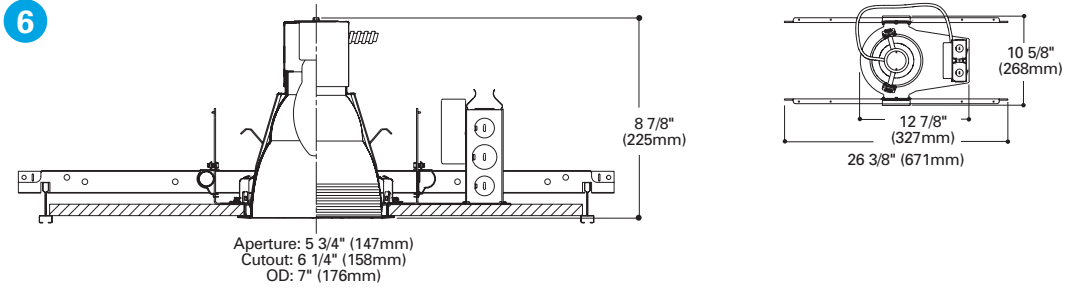

Frame, socket adapter and reflector ship separately.

Frame	Socket Adapter	Reflector
PD6	V1001E	6VBB
PD6	V501E=50W MH, 120V Electronic V701E=70W MH, 120V Electronic V1001E=100W MH, 120V Electronic V502E=50W MH, 277V Electronic V702E=70W MH, 277V Electronic V1002E=100W MH, 277V Electronic	6VC=Vertical Clear 6VBB=Vertical Black Baffle 6VWB=Vertical White Baffle

7" OPEN, ED17P MH

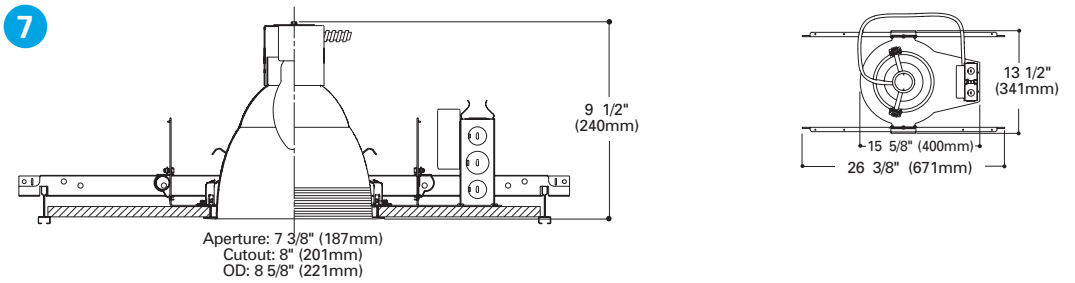

Frame, socket adapter and reflector ship separately.

Frame	Socket Adapter	Reflector
PD7	V502E	7VC
PD7	V501E=50W MH, 120V Electronic V701E=70W MH, 120V Electronic V1001E=100W MH, 120V Electronic V502E=50W MH, 277V Electronic V702E=70W MH, 277V Electronic V1002E=100W MH, 277V Electronic	7VC=7" Vertical Clear 7VBB=7" Vertical Black Baffle 7VWB=7" Vertical White Baffle

7" OPEN, PAR38 MH

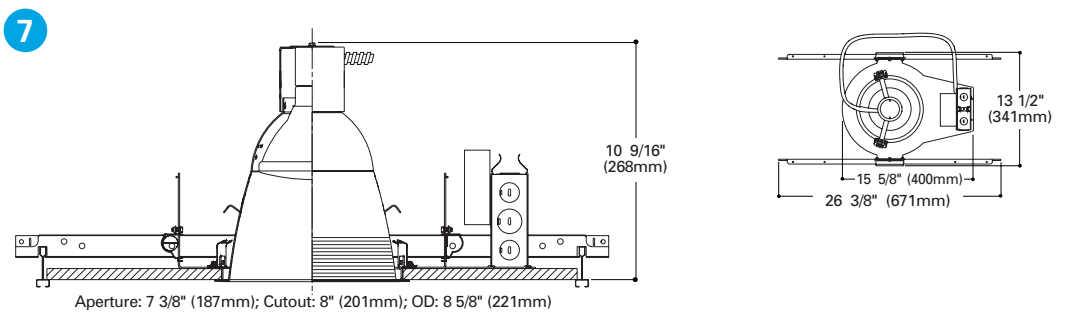

Frame, socket adapter and reflector ship separately.

Frame	Socket Adapter*	Reflector
PD7	V70X2E	7VP38BB
PD7	V70X1E =70W MH, 120V Electronic Ballast V100X1E=100W MH, 120V Electronic Ballast V70X2E=70W MH, 277V Electronic Ballast V100X2E=100W MH, 277V Electronic Ballast	7VP38C=7" Vertical Clear 7VP38BB=7" Vertical Black Baffle 7VP38WB=7" Vertical White Baffle

*4KV Medium Base Screw Shell Socket-PAR38 Lamps Only

6" LENS, ED17 MH

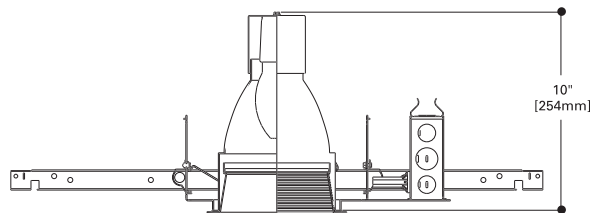
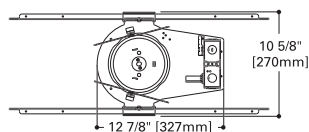

Aperture: 5 5/8" (143mm)
Cutout: 6 1/4" (158mm)
OD: 7" (176mm)

Frame, socket adapter and reflector ship separately.

Frame	Socket Adapter	Reflector
PD6	V502E	6VL4C
PD6	V501E=50W MH, 120V Electronic V701E=70W MH, 120V Electronic V502E=50W MH, 277V Electronic V702E=70W MH, 277V Electronic	6VL2C=6" Vertical Prismatic Glass lens, clear 6VL2BB=6" Vertical Prismatic Glass lens, Black Baffle 6VL2WB=6" Vertical Prismatic Glass lens, White Baffle 6VL4C=6" Vertical Fresnel lens, Clear 6VL4BB=6" Vertical Fresnel lens, Black Baffle 6VL4WB=6" Vertical Fresnel lens, White Baffle

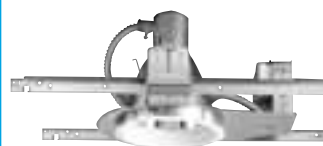

Wet Location
**PD6
PD7**
Lensed
Metal Halide

- Low iridescent, clear reflector
- White painted self flange
- Torsion springs pull reflector to ceiling
- One piece folded metal socket cap
- Galvanized steel frame with 1/2" plaster lip
- Accommodates ceilings up to 2" thick
- Bar hangers lock to T-bar with screwdrivers or pliers
- Galvanized J-box with multiple KO's, listed for twelve #12AWG 90C conductors
- cUL listed, wet location

7" LENS, ED17 MH

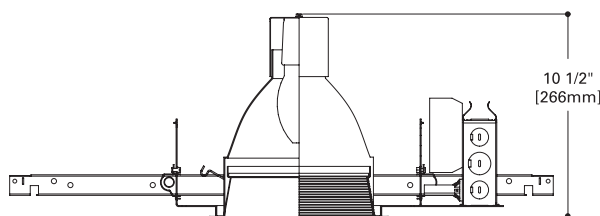
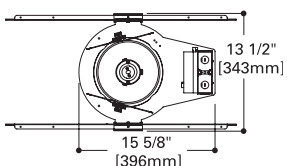

Aperture: 7 1/4" (184mm)
Cutout: 8" (201mm)
OD: 8 5/8" (221mm)

Frame, socket adapter and reflector ship separately.

Frame	Socket Adapter	Reflector
PD7	V701E	7VL2C
PD7	V501E=50W MH, 120V Electronic V701E=70W MH, 120V Electronic V1001E=100W MH, 120V Electronic V502E=50W MH, 277V Electronic V702E=70W MH, 277V Electronic V1002E=100W MH, 277V Electronic	7VL2C=7" Vertical Prismatic Glass lens, Clear 7VL2BB=7" Vertical Prismatic Glass lens, Black Baffle 7VL2WB=7" Vertical Prismatic Glass lens, White Baffle 7VL4C=7" Vertical Fresnel lens, Clear 7VL4BB=7" Vertical Fresnel lens, Black Baffle 7VL4WB=7" Vertical Fresnel lens, White Baffle

*Other Standard, Dimming and EM ballasts available. Consult factory.