

# NEO-RAY™



7

## DIRECT-INDIRECT

- Direct light distribution.
- T5 and T8 lamping.
- Die formed steel housing.
- Extruded aluminum ceiling trims with 2" regress and mitered corners.
- Fixtures can be mounted in patterns (specify prior to release of order).

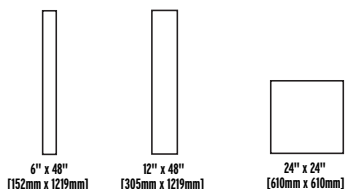
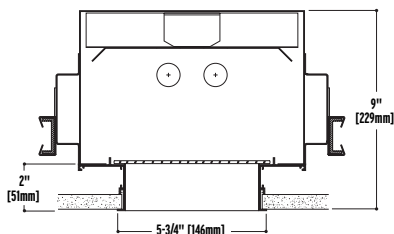

## Construction

20-gauge steel housing.

## Shielding

White acrylic lens.

## Electrical

120, 277, 347 or Universal Voltage electronic ballast. Fixtures and electrical components certified to UL and CUL standards.

## Trim

Extruded aluminum regressed trim with mitered corners.

## Finish

Durable, low gloss, white, powder coated acrylic finish.

## Mounting

Recessed.

Note: Must be installed prior to ceiling.

## ORDERING INFORMATION:

Sample number: 7-124R-2T8-STG-2EB-SI-S46

## Series

7

## Fixture Size

648=6" x 48"	248=24" x 48"	124=12" x 24"
336=36" x 36"	148=12" x 48"	448=48" x 48"
224=24" x 24"		

[Consult factory for custom sizes]

## Mounting

R=Recessed

## Number of Lamps <sup>1</sup> (not included)

1=1 Lamp	2=2 Lamps	3=3 Lamps
4=4 Lamps	5=5 Lamps	6=6 Lamps

## Lamp Type <sup>1</sup>

T8	T5	T5HO
----	----	------

## Ceiling Type

ETG=Exposed T-Grid	SR=Sheet Rock (Flanged)
--------------------	-------------------------

## Voltage

1=120V	2=277V	3=347V	U=Universal
--------	--------	--------	-------------

## Ballast

EB=Electronic Ballast (Standard)	DB=Dimming Ballast
----------------------------------	--------------------

## Switching

SI=Single Switching	DU=Dual Switching
---------------------	-------------------

## Emergency

EM=Emergency Pack (Consult Factory)

## Fusing

GLR	GMF
-----	-----

## Shielding

S46=Structural Acrylic (Matte white finish)

<sup>1</sup> Due to various constraints, some options may not be combined with others.

## SHIELDING OPTIONS



S46 Structural Acrylic

## MOUNTING INFORMATION

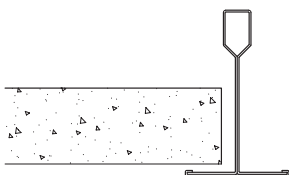

ETG  
EXPOSED TEE GRID

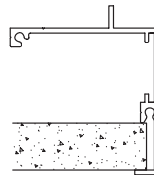

SR  
SHEET ROCK

NOTES: For complete product data, refer to the Neo-Ray Specification Binder. Specifications and dimensions subject to change without notice. Products may be modified for use in international markets. Please contact your Cooper Lighting Sales Representative for availability and ordering information.