

COOPER LIGHTING - METALUX®

DESCRIPTION

The accord(TM) redefines fluorescent lighting by improving on aesthetics, comfort and energy savings. The accord(TM) provides the right amount of light while eliminating surface shadows commonly found in parabolics. Therefore, accord(TM) increases the comfort level while providing significant energy savings.

The accord(TM) is the ideal solution for offices, schools, hospitals, retail and other applications.

Catalog #		Type
Project		
Comments		Date
Prepared by		

SPECIFICATION FEATURES

A ... Construction

Shallow 3-1/4" deep housing is die formed of code gauge, prime cold rolled steel. Heavy gauge end plates are securely attached with screws for strength and rigidity and the elimination of gaps. Four auxiliary fixture end suspension points are provided. Large access plate for supply connection.

B ... Electrical*

Ballasts are Class "P" and are positively secured. Rotor-lock lampholders ensure positive lamp retention. UL/CUL listed. Suitable for damp locations.

C ... Ballast Access

Ballast is mounted on a heavy gauge access plate and can be accessed from above the ceiling line.

D ... Finish

Durable cold rolled steel with multistage, iron phosphate pretreatment and white enamel finish to ensure maximum bonding and rust inhibition.

E ... Reflectors

Reflector has high reflectance baked matte white enamel finish for luminous uniformity.

F ... Shielding

Positively retained frosted acrylic profile lenses provide a soft but effective distribution of light.



AC
128T5
154T5

T5 LAMP
1' X 4' Recessed
Troffer Series

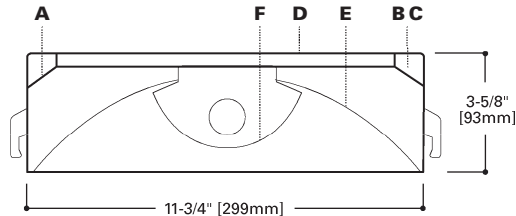

MOUNTING DATA

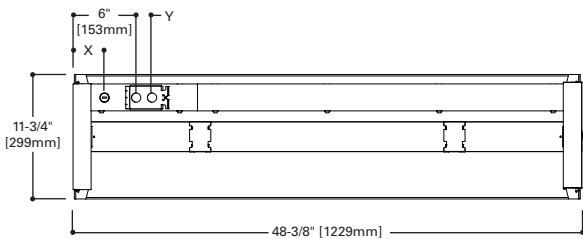

LAMP CONFIGURATIONS

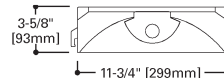

ENERGY DATA

Input Watts:

EB Ballast & STD Lamps @ 277V
128T5 (34)

Luminaire Efficacy Rating
LER =FL64 LPW

Catalog Number: AC-128T5

Yearly Cost of 1000 lumens,
3000 hrs at .08 KWH = \$3.88

*Reference the lamp/ballast data in the Technical Section for specific lamp/ballast requirements.

**Consult Pre Sales Technical Support.

***See Drywall Frame Kit Accessory

CEILING COMPATIBILITY

G
Grid/Lay-in
Standard

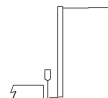

F
Drywall Frame
Kit

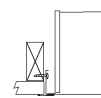

Ceiling
Type**

Exposed Grid
Concealed T
Slot Grid
Flange

Trim
Type

G
G or T
G or T

LAMPS CONTAIN MERCURY. DISPOSE ACCORDING TO LOCAL, STATE OR FEDERAL LAWS

LINEAR DISCONNECT
Safe and convenient means of disconnecting power



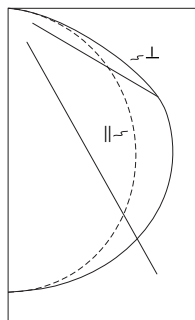

AC-128T5
 Electronic Ballast
 F28T5/835 Lamps
 2600 Lumens
 Spacing criterion:
 (H) 1.2 x mounting
 height, (L) 1.4 x
 mounting height
 Efficiency 87.4%
 Test Report:
 241P113
 LER = FL62
 Yearly Cost of 1000
 lumens, 3000 hrs at
 .08 KWH = \$3.88

Candlepower

Angle	Along H	45°	Across L
0	738	738	738
5	734	736	736
10	723	730	732
15	705	718	725
20	679	701	715
25	647	679	702
30	609	654	685
35	565	623	663
40	517	588	635
45	465	548	601
50	411	502	559
55	354	452	511
60	295	396	443
65	236	334	334
70	175	248	221
75	115	154	133
80	60	75	63
85	18	15	11
90	0	1	1

Coefficients of Utilization

rc	Effective floor cavity reflectance																							
	80%				70%				50%				30%				10%				0%			
rw	70	50	30	10	70	50	30	10	50	30	10	50	30	10	50	30	10	50	30	10	50	30	10	0
RCR																								
0	104	104	104	104	102	102	102	102	97	97	97	93	93	93	89	89	89	87						
1	95	91	87	84	93	89	86	83	85	82	80	82	80	77	79	77	75	73						
2	86	79	73	68	84	77	72	67	74	70	66	71	68	64	69	66	63	61						
3	78	69	62	56	76	68	49	56	65	59	55	63	58	54	60	56	53	52						
4	72	61	53	47	70	60	43	47	58	51	46	56	50	46	54	49	45	43						
5	66	54	46	40	64	53	38	40	51	45	40	50	44	39	48	43	39	37						
6	61	49	41	35	59	48	34	35	46	40	35	45	39	34	43	38	34	32						
7	56	44	36	31	55	43	31	31	42	35	30	41	35	30	40	34	30	28						
8	52	40	33	27	51	40	28	27	38	32	27	37	31	27	36	31	27	25						
9	49	37	29	25	47	36	25	24	35	29	24	34	28	24	33	28	24	22						
10	46	34	27	22	44	33	23	22	33	26	22	32	26	22	31	26	22	20						

Zonal Lumen Summary

Zone	Lumens	%Lamp	%Fixture
0-30	585	22.5	25.8
0-40	973	37.4	42.8
0-60	1788	68.8	78.7
0-90	2271	87.4	100.0
0-180	2271	87.4	100.0

Luminance Data

Angle in Deg	Average 0-Deg cd/sm	Average 45-Deg cd/sm	Average 90-Deg cd/sm
45	1768	2084	2285
55	1659	2119	2395
65	1501	2125	2125
75	1195	1600	1382
85	555	463	339

ORDERING INFORMATION

SAMPLE NUMBER: AC-128T5-UNV-EBT1NDIM

<p>Rating Blank=Standard NY=New York Rated ATW-SW4=Chicago Rated</p> <p>Width⁽⁶⁾ Blank=1' Width</p> <p>Series AC=Accord Series</p>	<p>Number of Lamps (Not included) 1=1 Lamp</p> <p>Wattage (Length) 28T5=28W T5 (48") 54T5=54W T5HO (48")</p>	<p>Shielding Blank=Frosted Acrylic (standard)</p> <p>Voltage⁽¹⁾ UNV=Universal Voltage 120-277</p> <p>Options GL=Single Element Fuse GM=Double Element Fuse Flex=Flex installed EL=Emergency Installed</p>	<p>Lamps L5835=T5 Lamp, 3500K L5841=T5 Lamp, 4100K L5835HL=T5 Lamp, 28W, 3500K, 2900 Lumens L5841HL=T5 Lamp, 28W, 4100K, 2900 Lumens</p>	<p>Ballast Type EBT =T5 Linear Electronic Program Rapid Start Total Harmonic Distortion < 10%</p> <p>No. of Ballast 1 or 2</p> <p>Ballast Factor/Type (For 28W T5 Lamp Only) N=Normal Light Output .95 BF⁽²⁾ H=High Light Output 1.15 BF^{(2),(4)} NDIM=Normal .95-1.0 BF Step Dimming⁽³⁾ HDIM=High 1.15 BF Step Dimming^{(3),(4)}</p>	<p>Packaging U=Unit Pack PALC=Job Pack, in carton</p>
-----------------------------------------------------------------------------------------------------------------------------------------------------------------------------------------------------------------------------------------------------------------------------	----------------------------------------------------------------------------------------------------------------------------------------------------------------------------------------------------------------	-------------------------------------------------------------------------------------------------------------------------------------------------------------------------------------------------------------------------------------------------------------------------------------------------------------------------------------------------------------------------	-------------------------------------------------------------------------------------------------------------------------------------------------------------------------------------------------------------------------------------	-----------------------------------------------------------------------------------------------------------------------------------------------------------------------------------------------------------------------------------------------------------------------------------------------------------------------------------------------------------------------------------------------------------------------------------------------------------------------------------------------------------------------------	--------------------------------------------------------------------------------------------------------

NOTES: ⁽¹⁾ Products also available in non-US voltages and frequencies for international markets. ⁽²⁾ .95 and 1.15 ballast factor available for 28W T5 lamps only. ⁽³⁾ Step Dimming ballast available for 28W T5 lamps only. ⁽⁴⁾ 1-Lamp ballast in the High Ballast factor not available. 2-Lamp ballast will not operate 1-Lamp. ⁽⁵⁾ 1' x 4' Accord is not designed for continuous row mount applications. For complete product data, reference the Fluorescent Specification binder. Specifications & dimensions subject to change without notice. Consult your Cooper Lighting Representative for availability and ordering information.

SHIPPING INFORMATION

Catalog No.	Wt.
AC-128T5	22 lbs.
AC-154T5	22 lbs.