

# INVUE™ INSTALLATION INSTRUCTIONS

## VISION WALL (VWS/VWM) WIRE GUARD

2/17/04

IMI-508

**IMPORTANT:** Read carefully before installing fixture. Retain for future reference.

**General:** Upon receipt of fixture thoroughly inspect for any freight damage, which should be brought to the attention of the delivery carrier. Compare the catalog description listed on the packing slip with the fixture label on the housing to assure you have received the correct merchandise.

**Safety:** This fixture must be wired in accordance with the national electrical code and applicable local codes and ordinance. Proper grounding is required to insure personal safety. Carefully observe grounding procedure under installation section. All work should be done by a qualified electrician.

**WARNING:** Make certain power is OFF before starting installation or attempting any maintenance.

1. Make certain all power is OFF before starting installation.
2. Loosen and remove the existing component  
(4) 1/4-20 socket head cap screws,  
(4) teflon washers and (4) o-rings.  
**RETAIN FOR FUTURE REFERENCE.**
3. Assembly bag consist of the following:
  - a. Vision Wall Small (VWS)  
(4) 1/4-20 lock nuts  
(4) molded washer bushings  
(4) 1/4-20 x 1.75" socket head cap screws  
(4) 1/4-20 flat washer stainless steel.
  - b. Vision Wall Medium (VWM)  
(4) 1/4-20 lock nuts  
(4) molded washer bushings  
(4) 1/4-20 x 2" socket head cap screws  
(4) 1/4-20 flat washer stainless steel
4. **THE DOOR SHOULD NOT BE REMOVED DURING INSTALLATION.**
5. Take all (4) 1/4 -20 socket head cap screws with washer, and insert them into the wire guard then add the (4) molded bushings to the opposite side of the 1/4-20 socket head cap screws. **(SEE FIG 1)**
6. Angle the door about 40° inward. Then, line up the wire guard using the 1/4-20 screws and the 1/4-20 flat washer with the holes in the door and pull the 1/4-20 screws through. Next, take the 1/4-20 lock nuts and hand tighten to the door.
7. Close the door and tighten (4) 1/4-20 screws until the door has been secured
8. To remove wire guard reverse steps starting with #7.

Fig. 1

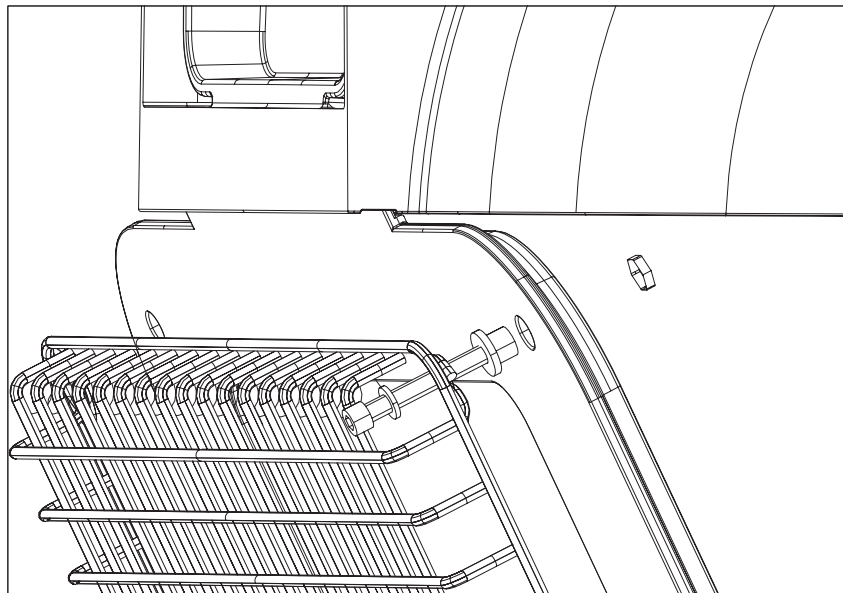

These instructions do not claim to cover all details or variations in the equipment, procedure, or process described, nor to provide directions for meeting every possible contingency during installation, operation or maintenance. When additional information is desired to satisfy a problem not covered sufficiently for user's purpose, please contact your nearest representative.