

## DESCRIPTION

658 features a luminous shield with a modern die-cast base and is ADA compliant.

Catalog #		Type
Project		
Comments		Date
Prepared by		

## SPECIFICATION FEATURES

### Material

Painted or plated solid die-cast aluminum with a 1/8" matte white acrylic shield.

### Finish

Standard: Matte White (MW).  
Premium: Satin Chrome (SC), Polished Chrome (PC), Satin Brass (SB), Polished Brass (PB), Lacquered Satin Aluminum (SAL) Satin Copper (SCP), Polished Copper (PCP), (NA) Natural Aluminum, (SAL) Lacquered Satin Aluminum, Satin Nickel (SN), Polished Nickel (PN), Lacquered Satin Chrome (SCL), Lacquered Satin Nickel (SNL) or Custom Color (CC).

### Optics

Refer to [www.shaperlighting.com](http://www.shaperlighting.com) for complete photometrics.

### Ballast

Integral electronic HPF, multi-volt 120/277V (347V Canada), thermally protected with end-of-life circuitry to accommodate the specified lamp wattage.

### Lamp/Socket

10": Two (2) 13W (GX7) low wattage CFL, two (2) 26W (G24q-3) 4-pin quad CFL lamps or two (2) 40W frosted T-10 lamps.

14": Two (2) 27W (2G11) high lumen CFL lamps. CFL socket injection molded plastic. INC socket fired ceramic rated for 660W-250V. Lamps furnished by others.

### Installation

Supplied with a universal circular strap for a standard 4" J-box or plaster ring.

### Options

Hand Painted Faux Alabaster Diffuser (FD), MRI Applications (INC only) - Contact factory, Remote Emergency Battery - Supplied by others (REM). MRI options - Contact factory. Damp Location (DL): All Painted Finishes, Lacquered Satin Chrome (SCL) and Lacquered Satin Nickel (SNL) finishes only. Energy Star Rating - Consult factory.

### Labels

U.L. and C.U.L approved for indoor and damp location. See options for damp location finishing requirements. ADA compliant.

### Modifications

Shaper's skilled craftspeople with their depth of experience offer the designer the flexibility to modify standard wall luminaires for project specific solutions. Contact the factory regarding scale options, unique finishes, mounting, additional materials/colors, or decorative detailing.



## 658 SERIES

Interior Wall Luminaire  
Wall Sconce  
Luminous Shield



## ORDERING INFORMATION

Sample Number: 658-10-INC/2/40-120V-PCP

Series	Size	Lamp	Voltage	Finish	Options
658 =Luminous Shield	10 =10" 14 =14"	CFL/2/13 <sup>1</sup> CFL/2/26 <sup>1</sup> CFL/2/27 <sup>2</sup> INC/2/40 <sup>1</sup>	120V 277V <sup>3</sup> 347V <sup>3</sup>	<u>Standard</u> MW=Matte White <u>Premium</u> CC=Custom Color PB=Polished Brass PC=Polished Chrome PCP=Polished Copper PN=Polished Nickel SAL=Lacquered Satin Aluminum SB=Satin Brass SC=Satin Chrome SCL=Lacquered Satin Chrome SCP=Satin Copper SN=Satin Nickel SNL=Lacquered Satin Nickel	DL=Damp Location REM=Remote Emergency Battery <sup>4</sup> FD=Hand Painted Faux Alabaster Diffuser

### Notes:

- <sup>1</sup> Available in 10".
- <sup>2</sup> Available in 14".
- <sup>3</sup> Available with CFL only.
- <sup>4</sup> Supplied by others.

**ADA** AMERICAN DISABILITIES ACT (ADA)

Shaper offers a large selection of ADA interior and exterior wall luminaires. ADA requires all fixtures below 68" to have a maximum projection of 4".

**SUSTAINABLE DESIGN**

Shaper has a long-standing history of offering environmentally-friendly fixtures. The copper and bronze alloys used in our exterior luminaires feature up to 98% recycled content, contribute less undesirable air emissions compared to painted aluminum and are easy to recycle.

**MRI** MAGNETIC RESONANCE IMAGING (MRI)

Lighting fixtures for MRI facilities are specialized and unique, requiring non-ferrous construction. Fluorescent fixtures cannot be used due to the ferrous parts in ballasts and lampholders. Modified incandescent fixtures meet the requirements.

**ENERGY STAR**

Shaper now offers a wide variety of fixtures that can be provided with an Energy Star Rating.

Refer to the Icon Legend  
Link on [shaperlighting.com](http://shaperlighting.com).

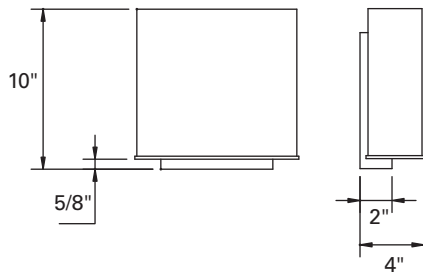

**10" STANDARD**

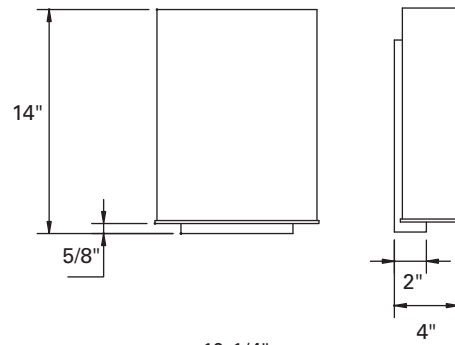

**14" STANDARD**