

NEO-RAY™



FENESTRA 204 202 114 112

DIRECT-INDIRECT

112/114 features

- Direct - ambient wall wash light distribution.
- Flush side basket design.
- T5 and long twin tube lamping.
- Soft diffused wall wash lighting free of striations.
- 2 to 1 spacing to wall ratio.
- Air return [one side only] and Chicago plenum options available.
- Housings fit all ceiling types with ultra minimal exposed trim.
- Tannenbaum ribbed aluminum reflector option available.

202/204 features

- Direct - ambient light distribution.
- T5, long twin tube and T8 lamping.
- Low direct glare illumination.
- Air return and Chicago plenum options available.

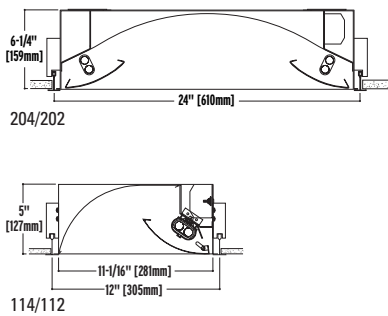

Construction

20-gauge steel housing. (1'x2', 1'x4', 2'x2' or 2'x4')

Shielding

Perforated metal panels backed by a white acrylic diffuser.

Electrical

120, 277, 347 or Universal Voltage electronic ballast. Fixtures and electrical components certified to UL and CUL standards.

Finish

Durable, low gloss, white, powder coated acrylic finish.

Mounting

Recessed.

ORDERING INFORMATION:

Sample number: 202R-2BX40W-ETG-1EB-SI

Series

112=1'x2' 114=1'x4' 202=2'x2' 204=2'x4'

Options ²

A=Air Return T=Tannenbaum Reflector
C=Chicago Plenum

Mounting

R=Recessed

Number of Lamps (not included)

1=1 Lamp (112, 114) 2=2 Lamps (202, 204)

Lamp Type ¹

T8 (202 & 204 only) T5 T5HO BX40W BX50W

Ceiling Type

ETG=Exposed T-Grid STG=Slot T-Grid (Sheet Metal)
SR=Sheet Rock (Flanged)

Voltage ¹

1=120V 2=277V 3=347V U=Universal

Ballast

EB=Electronic Ballast (Standard) DB=Dimming Ballast

Switching

SI=Single Switching DU=Dual Switching

Emergency

EM=Emergency Pack (Consult Factory)

¹ Due to various constraints, some options may not be combined with others.
² Can be left blank or more than one option may be available, consult factory.

STANDARD LUMINAIRE PLAN - VIEW

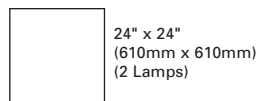

202

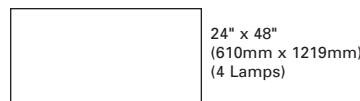

204

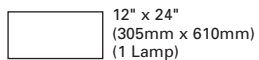

112



114

MOUNTING INFORMATION

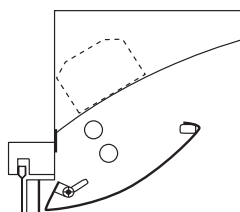

ETG
EXPOSED TEE GRID

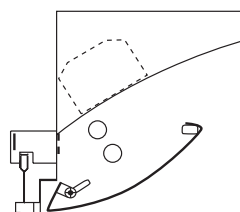

STG
SLOT TEE GRID

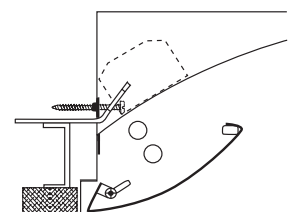

SR
SHEET ROCK

NOTES: For complete product data, refer to the Neo-Ray Specification Binder. Specifications and dimensions subject to change without notice. Products may be modified for use in international markets. Please contact your Cooper Lighting Sales Representative for availability and ordering information.