

DESCRIPTION

The VRVT2 Series is an energy efficient industrial Vaportite fixture that features rugged and durable construction. The VRVT2 incorporates a full metal fixture liner inside a reinforced fiberglass housing with a high impact diffuser. This Vaportite series is suitable for interior and exterior applications and can be surface or chain mounted.

The rugged, durable VRVT2 is perfect for coolers, car washes, breeze/walkways, canopies and other outdoor or indoor areas where environmental abuse is a problem.

SPECIFICATION FEATURES

A ... Construction

Fiberglass housing is reinforced polyester and self-extinguishing (ASTM-D635-74) plastic of a permanent pearl gray color. Top of housing has nine embossments (4' unit) and thirteen embossments (8' unit), providing mounting flexibility on uneven surfaces. A watertite hub for 1/2" conduit entry is provided at each end of housing (standard) for continuous feed. Polyurethane gasketing is formed in the housing providing a continuous seamless seal for the diffuser. Six sturdy cam latches with integral stainless steel TORX screws clamp diffuser tightly for a positive seal between housing, gasket and diffuser.

B ... Electrical*

Unit has full metal liner (channel) secured by brass internal/external mounting studs for positive grounding, maximum protection and rigidity. Ballasts are CBM/ETL Class "P" certified suitable to minus 20°F. Spring loaded lampholders. Electrical components and fixtures are UL/CUL listed for Wet Locations.** IP65 approved.

C ... Reflectors

"DR" - Clear low brightness pattern acrylic with 15% high impact additive.
"DR-100" - Clear low brightness pattern acrylic with 100% high impact additive.
Example: VRVT2-248HODR-100
"LEX" - High impact clear low brightness pattern polycarbonate.
LEXAN
Example: VRVT2-248HOLEX.

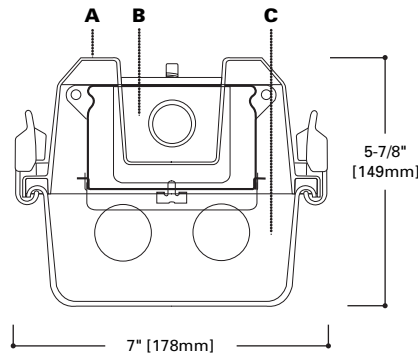

VRVT2
148HO
248HO
148T8HO
248T8HO

4' INDUSTRIAL
1 OR 2 LAMPS
HIGH OUTPUT, 800MA
Vandal Resistant Luminaire

LAMP CONFIGURATIONS

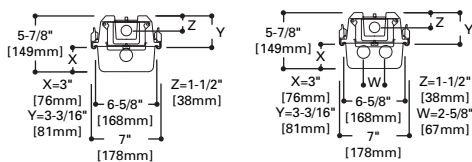

MOUNTING DATA

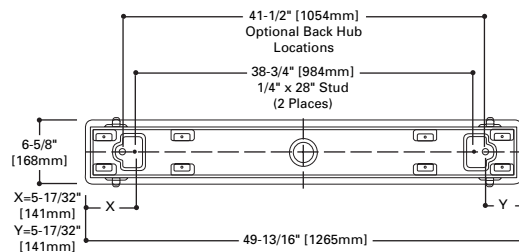

INSTALLATION DATA

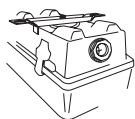

MOUNTING BRACKETS
Furnished
Two per 2' and 4' Unit
Four per 8' Unit

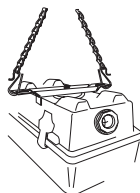

OPTIONAL CHAIN HANGING SET
(VT2-CHAIN/SET-U)
Includes 6 ft. of chain, 4 large S-Hooks and 4 small S-Hooks
Order One (1) Kit for each 2' or 4' Fixture
Two (2) Kits Recommended For 8' Fixture

ENERGY DATA

Input Watts:
STD Ballast & STD Lamps
148HO (82)
248HO (145)
148T8HO (57)
248T8HO (99)

Luminaire Efficacy Rating
LER = FI-36
Catalog Number: VRVT2-248HO DR-WL

Yearly Cost of 1000 lumens,
3000 hrs at .08 KWH = \$6.67

*Reference the lamp/ballast data in the Technical Section for specific lamp/ballast requirements.

**Not Suitable for Wet Locations if EL4 Option is added. Consult Pre Sales Technical Support.

PHOTOMETRICS

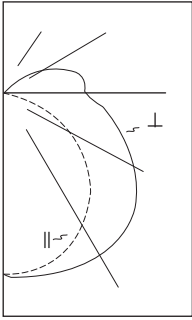
VRVT2-248HO DR-WL
 Electronic Ballast

F48T12/CW/HO
Lamps
4050 Lumens

Spacing criterion:
(II) 1.3 x mounting
height, (⊥) 1.5 x
mounting height

Efficiency 62.8%

Test Report
#ITL44660

LER = FI-36

Yearly Cost of 1000
lumens, 3000 hrs at
.08 KWH = \$6.67

Coefficients of Utilization

		Effective floor cavity reflectance										20%									
		80%				70%				50%				30%				10%			
rc	rw	70	50	30	10	70	50	30	10	50	30	10	50	30	10	50	30	10	50	30	10
RCR																					
0	72	72	72	72	72	70	70	70	70	64	64	64	59	59	59	55	55	55	53		
1	64	60	57	54	54	61	58	55	52	53	51	49	49	47	45	45	44	42	40		
2	58	52	47	43	43	55	50	45	41	46	42	39	42	39	36	39	36	34	32		
3	52	45	39	35	35	50	43	38	34	40	35	32	37	33	30	34	31	28	26		
4	47	39	33	29	29	45	38	32	28	35	30	27	32	28	25	30	26	24	22		
5	43	35	29	24	24	41	33	28	24	31	26	23	29	25	21	26	23	20	19		
6	40	31	25	21	21	38	30	24	20	28	23	20	26	22	19	24	20	18	16		
7	37	28	22	18	18	35	27	22	18	25	20	17	23	19	16	22	18	15	14		
8	34	25	20	16	16	33	25	19	16	23	18	15	21	17	14	20	16	14	12		
9	32	23	18	14	14	30	23	18	14	21	17	13	20	16	13	18	15	12	11		
10	30	21	16	13	13	29	21	16	13	19	15	12	18	14	12	17	14	11	10		

Zonal Lumen Summary

Zone	Lumens	%Lamp	%Fixture
0-30	876	10.8	17.2
0-40	1483	18.3	29.1
0-60	2833	35.0	55.7
0-90	4273	52.8	84.0
90-180	815	10.1	16.0
0-180	5088	62.8	100.0

Candela

Angle	Along II	45°	Across ⊥
0	1070	1070	1070
10	1060	1066	1077
20	999	1047	1086
30	903	1001	1084
40	772	935	1061
50	601	833	996
60	404	693	880
70	218	557	754
80	85	440	621
90	13	308	478
100	16	287	480
110	9	209	394
120	3	110	258
130	1	43	130
140	1	14	44
150	1	4	14
160	1	1	3
170	0	0	0
180	0	0	0

ORDERING INFORMATION

SAMPLE NUMBER: VRVT2-248HO DR-WL

Tandem	Series	No. of Lamps	Wattage (Length)	Wattage (Length)	Lens	Voltage	Voltage ²	Ballast Type	Options (add as suffix)
VRVT2	VRVT2	1 or 2 lamps (Not included)	48=60W (48") SL	HO=High Output (800 MA)	DR=Internal Prismatic Lens/15% DR High Impact Additive (Standard) DR-100=100% High Impact Additive LEX=High Impact Clear Polycarbonate LEXAN Lens/Low Brightness Pattern	LTS=Low Trigger Start (20 Watt) HTS=High Trigger Start (20 Watt)	120=120V 277=277V 347=347V	Standard Magnetic Ballast Leave Blank (Biax & LTS) LE3= Energy Saving Magnetic Ballast EB= Generic Electronic Ballast No. of Ballasts 1 or 2 Lamp Size 2=T12 8=T8 (For Specific Electronic Ballast Specify Brand and Catalog Number)	GL=Internal Single Element Fusing GM=Dual Element Fusing EL4=Emergency Lighting self-contained. RIF1=Radio Interference Suppressor TH ³ =(2) Top Watertite Hubs ³ TEH ³ =(2) Top & (2) End Watertite Hubs (All Watertite ³ Hubs Have 1/2" Conduit Entry) TILW=Tandem In-Line Wiring Option (Consult TILW Option Catalog Page) PI/CPI=Plug-In Option

NOTE For additional options, consult Cooper Lighting Representative. Specifications and Dimensions subject to change without notice.

¹Standard Ballast (Non-LE3).

²Contact Pre Sales Technical Support.

³Optional VT2 1/2" stem bushing available²

⁴Ambient Thermal Conditions: Operating Ambient Temperature Limitations Are Applicable. Contact Sales Engineering for Full "Operating Temperature Range" of Specific Fixture.

DL=Damp Location Labeled
WL=Wet Location Labeled

SHIPPING INFORMATION

Catalog No.	Wt.
VRVT2-148HO DR-WL	20 lbs.
VRVT2-248HO DR-WL	20 lbs.