

Vault

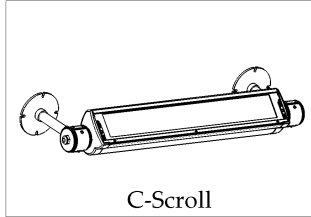

C-Scroll

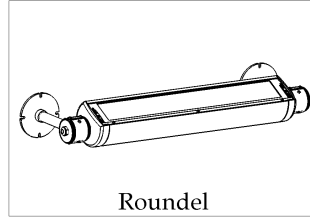

Roundel

These installation instructions are valid with the above Ametrix styles.

Small, OUTDOOR CYI (Continuous, Yoke mount, Integral ballast) Visor and Non-Visor

Warning: Before starting any work ensure that all sources of power are turned off. All work must meet local/national codes and be performed by a certified electrician. **Do not** mount fixtures vertically.

Part call-out

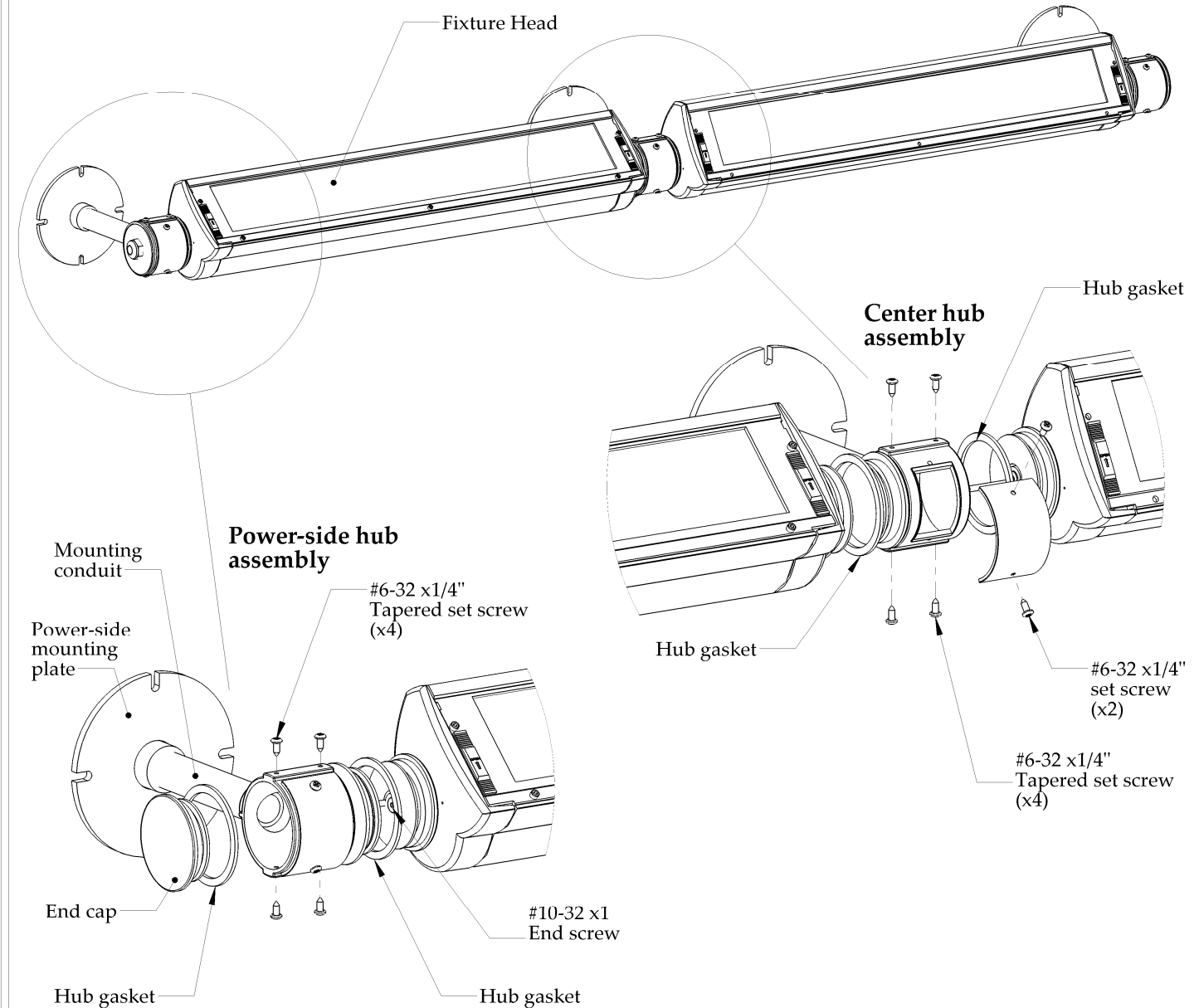

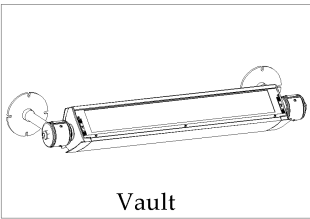

Vault

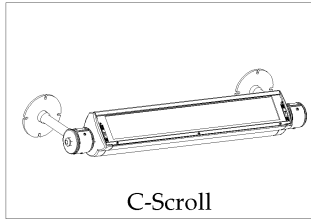

C-Scroll

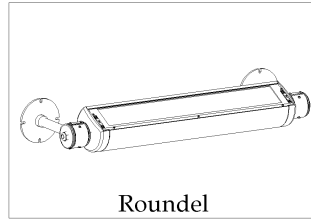

Roundel

These installation instructions valid with the above Ametrix styles.

Small, OUTDOOR CYI (Continuous, Yoke mount, Integral ballast) Visor and Non-Visor

Warning: Before starting any work ensure that all sources of power are turned off. All work must meet local/national codes and be performed by a certified electrician.

1

Mounting the fixture brackets

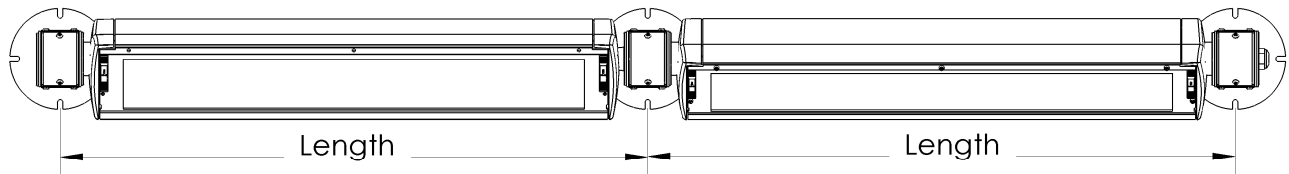

Available Wattages	Available Lamp Types	Mounting plate centers in(mm)
14W	(T5)	30 19/32 (711.2)
17W	(T8)	
24W	(T5 HO)	

21W	(T5)	42 1/2 (1016)
25W	(T8)	
39W	(T5 HO)	

28W	(T5)	54 19/32 (1320.8)
32W	(T8)	
54W	(T5 HO)	

Prior to roughing in J-boxes:

1. Determine the number of fixtures and brackets in each run.
2. Install outdoor rated J-boxes(by others) at the beginning of each run of outdoor fixtures.
3. Using the dimensions provided, mount at least two hub assemblies on center before mounting any fixture heads. To minimize spacing error, it is not recommended to mount more than four brackets at one time before securing fixture heads.

2

Mounting the power-side hub assembly

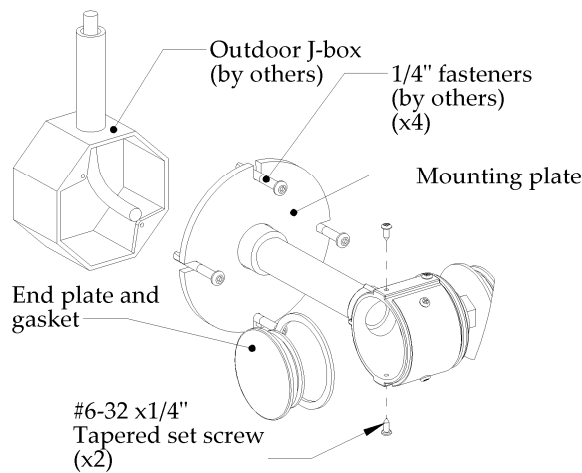

1. To run wiring through hub assembly, remove end plate by unscrewing both #6-32 x 1/4" tapered set screws. Feed wiring from outdoor J-box through powerside hub assembly. Using appropriate 1/4" fasteners, secure mounting plate to outdoor surface over j-box. (If necessary, use additional bracing to support brackets).

3

Mounting fixture to power-side hub assembly

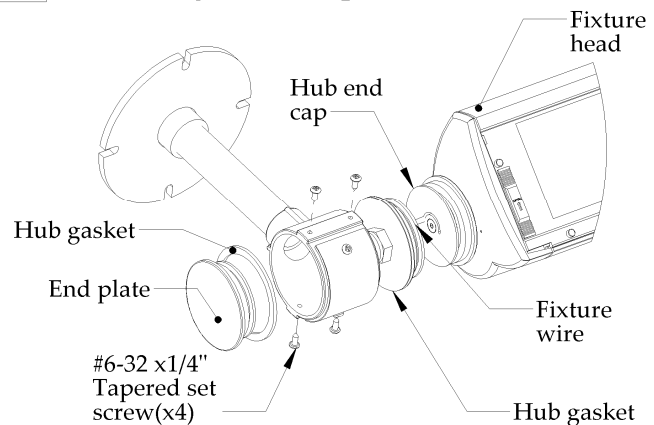

1. Feed wires from fixture head into powerside hub assembly.
2. Attach fixture head to powerside hub assembly by inserting hub end cap into hub and securing with both #6-32 x 1/4" tapered set screws. Ensure gasket is in place and compressed.
3. Attach wires from fixture head to wires in hub assembly. Ensure all connections are properly matched.
4. Check aiming of fixture and tighten both #6-32 x 1/4" tapered set screws to secure to position of the fixture.

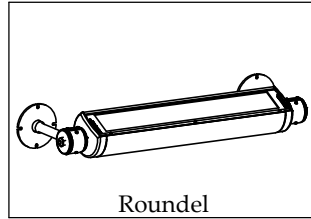
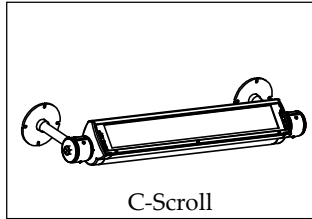
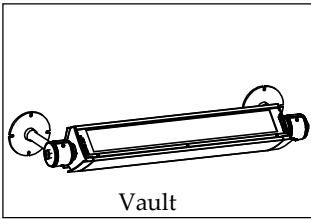

These installation instructions valid with the above Ametrix styles.

Small, OUTDOOR CYI (Continuous, Yoke mount, Integral ballast) Visor and Non-Visor

Warning: Before starting any work ensure that all sources of power are turned off. All work must meet local/national codes and be performed by a certified electrician.

4 Attaching fixture to center hub assembly

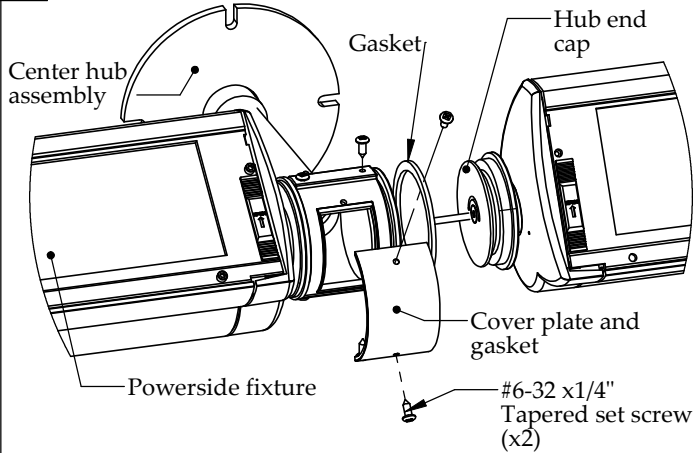

1. Remove gasket and cover plate from center hub assembly.
2. Feed wire from new fixture into center hub assembly.
3. Secure fixture head with both #6-32 x1/4" tapered set screws.
4. Attach all wires and ensure all connections are properly matched.
5. Hide wires in hub assembly and re-attach cover plate and gasket.

5 Attaching fixture to end hub assembly

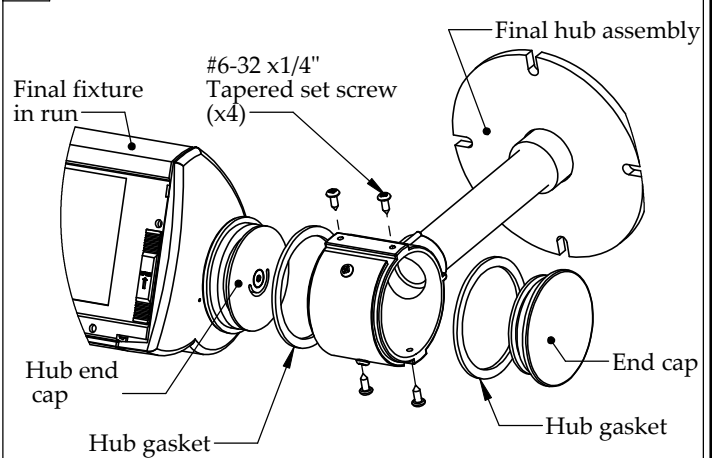

1. To end run, secure fixture head to end hub assembly inserting hub cap and securing both #6-32 x1/4" tapered set screw end screw.
2. Replace end cap and gasket and secure with #6-32 x1/4" tapered set screws.

6 Ensuring the fixtures are sealed for outdoor use

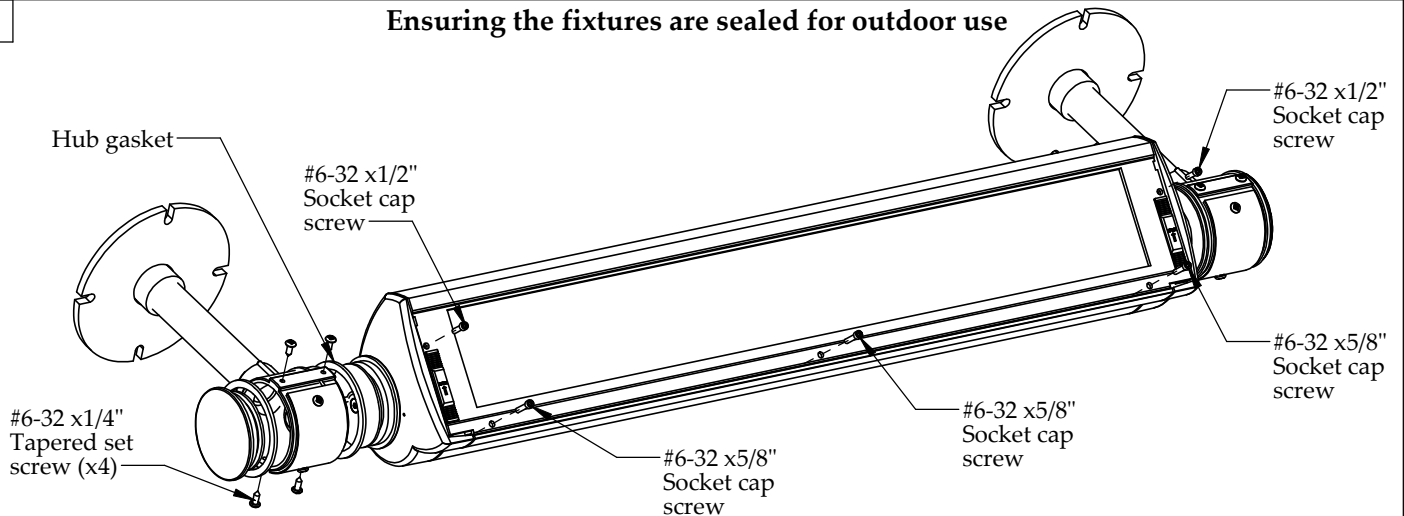

1. Ensure all socket cap screws are tightened to 10 in/lbs. (For proper torque sequence refer to supplemental page)
2. Ensure all hub caps are secured with two #6-32 x.25 tapered set screws to ensure proper compression of the hub gaskets.
3. Ensure a proper seal between the hub assembly mounting plate and the outdoor surface.

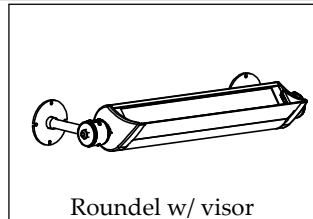
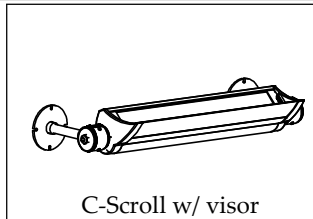
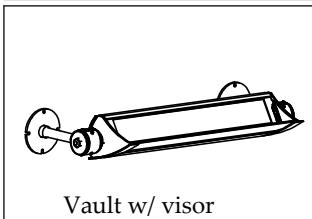

These installation instructions are valid with the above Ametrix styles

Small, OUTDOOR CYI (Continuous, Yoke mount, Integral ballast) Visor and Non-Visor

Warning: Before starting any work ensure that all sources of power are turned off. All work must meet local/national codes and be performed by a certified electrician. **Do not** mount fixtures vertically.

Mounting Plate Dimensions in [mm] (Dimensions are valid for both power, end and center(shown) hub mounting plates)

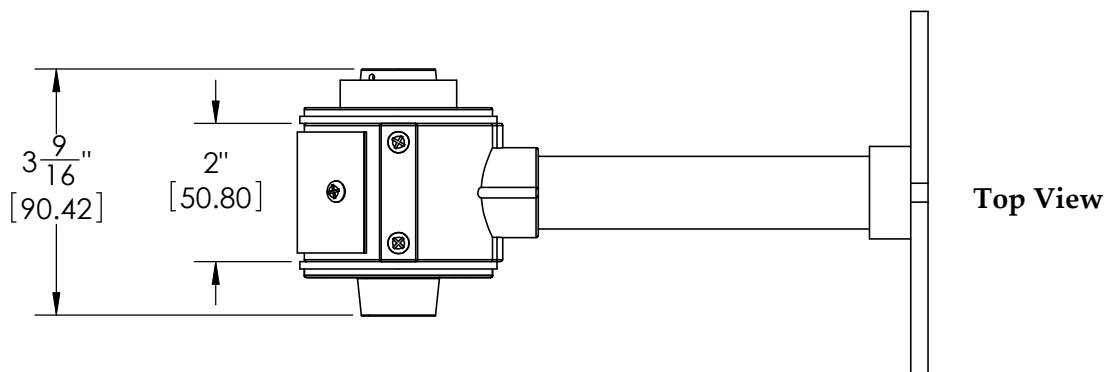
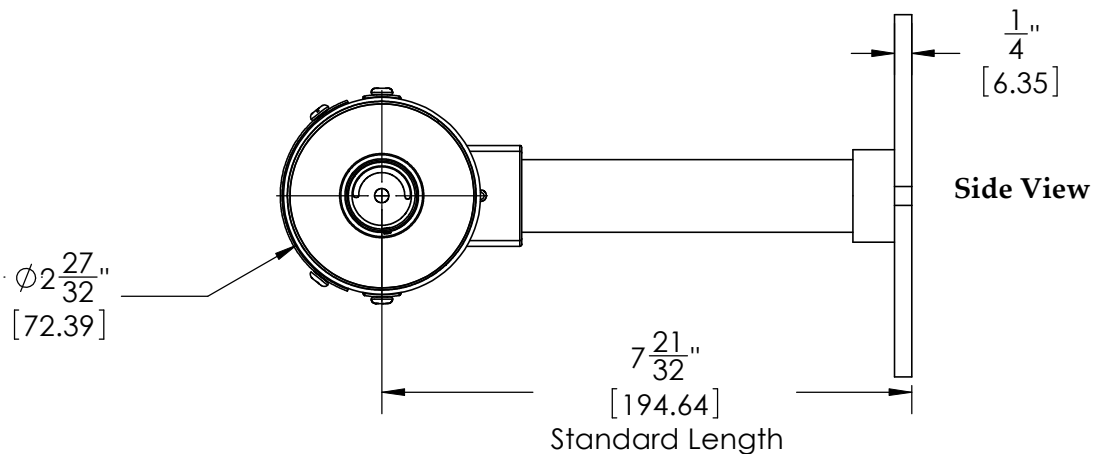
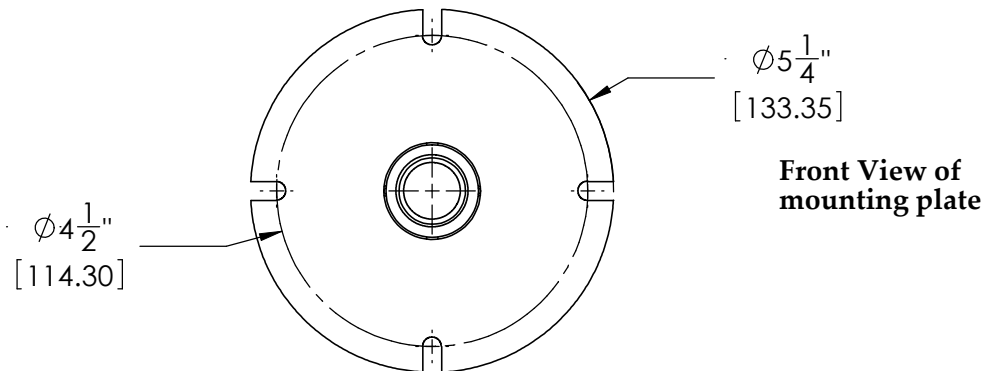



Vault w/ visor

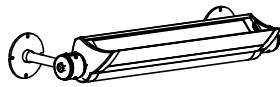

C-Scroll w/ visor

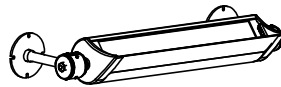

Roundel w/ visor

These installation instructions are valid with the above Ametrix styles

Small, OUTDOOR CYI (Continuous, Yoke mount, Integral ballast) Visor and Non-Visor

Warning: Before starting any work ensure that all sources of power are turned off. All work must meet local/national codes and be performed by a certified electrician. **Do not** mount fixtures vertically.

Continuous Row Layouts

Nominal Row Length (ft)	Actual Overall Row Length: Outdoor (ft)	Row Breakdown/ Installation Sequence
3	2.6	2C
4	3.6	3C
5	4.6	4C
6	5.1	2C,2C
7	6.1	2C,3C
8	7.1	3C,3C
9	8.1	3C,4C
10	9.1	4C,4C
11	10.7	3C,3C,3C
12	11.7	4C,2C,4C
13	12.7	4C,3C,4C
14	13.7	4C,4C,4C
15	14.2	3C,3C,3C,3C
16	15.2	3C,3C,3C,4C
17	16.2	3C,4C,4C,3C
18	17.2	4C,4C,4C,3C
19	18.2	4C,4C,4C,4C
20	19.8	4C,3C,3C,3C,4C
21	20.8	3C,4C,4C,4C,3C
22	21.8	4C,4C,3C,4C,4C
23	21.8	4C,4C,3C,4C,4C
24	23.4	2C,4C,4C,4C,4C,2C
25	23.4	2C,4C,4C,4C,4C,2C
26	25.4	3C,4C,4C,4C,4C,3C

Nominal Row Length (ft)	Actual Overall Row Length: Outdoor (ft)	Row Breakdown/ Installation Sequence
27	25.4	3C,4C,4C,4C,4C,3C
28	27.4	4C,4C,4C,4C,4C,4C
29	28.9	4C,4C,3C,3C,3C,4C,4C
30	29.9	3C,4C,4C,4C,4C,4C,3C
31	30.9	4C,4C,4C,3C,4C,4C,4C
32	31.9	4C,4C,4C,4C,4C,4C,4C
33	31.9	4C,4C,4C,4C,4C,4C,4C
34	32.5	2C,4C,4C,4C,4C,4C,4C,2C
35	34.5	3C,4C,4C,4C,4C,4C,4C,3C
36	35.5	4C,4C,4C,4C,3C,4C,4C,4C
37	36.5	4C,4C,4C,4C,4C,4C,4C,4C
38	38.0	4C,4C,4C,3C,3C,3C,4C,4C,4C
39	39.0	3C,4C,4C,4C,4C,4C,4C,4C,3C
40	39.0	3C,4C,4C,4C,4C,4C,4C,4C,3C
41	40.0	4C,4C,4C,4C,3C,4C,4C,4C,4C
42	41.0	4C,4C,4C,4C,4C,4C,4C,4C,4C
43	42.6	4C,4C,4C,4C,3C,3C,3C,4C,4C,4C
44	43.6	3C,4C,4C,4C,4C,4C,4C,4C,4C,3C
45	44.6	4C,4C,4C,4C,4C,3C,4C,4C,4C
46	45.6	4C,4C,4C,4C,4C,4C,4C,4C,4C,4C
47	46.1	3C,3C,4C,4C,4C,4C,4C,4C,4C,3C,3C
48	47.1	4C,4C,4C,4C,3C,3C,3C,4C,4C,4C,4C
49	48.1	3C,4C,4C,4C,4C,4C,4C,4C,4C,4C,3C
50	49.1	4C,4C,4C,4C,4C,3C,4C,4C,4C,4C,4C