

American Standard

Installation Instructions 2086

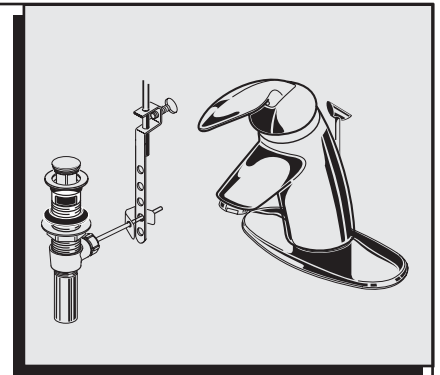

Certified to comply with ANSI A112.18.1
M968712 REV. 1.2

TENDENCE SINGLE LEVER LAVATORY FAUCET

Thank you for selecting American-Standard...
the benchmark of fine quality for over 100 years.

To ensure that your installation proceeds smoothly—
please read these instructions carefully before you begin.

TOOLS REQUIRED



Channel Locks



Adjustable Wrench

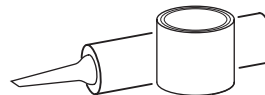

Plumbers' Putty or Caulking



3/32" Hex Key

1

FAUCET INSTALLATION

CAUTION Turn off water at
main supply.

- For 3-hole (4" centers) installation, apply Putty to underside of Escutcheon (4) and place over holes in lavatory sink with tab towards back.
- Feed faucet tubes through Rubber Ring (2) and through hole in Escutcheon (4) or mounting surface. Make sure Rubber Ring (2) is seated in groove in base of Faucet (1). Escutcheon (4) is optional on single hole lavatories.
- From below, push Mounting Gasket (5) and Mounting Washer (6) over Stud (3) and secure with Nut (7), pushing Faucet (1) to back of sink, so Stud (3) rests against sink hole. Before final tightening, adjust Faucet (1) and Escutcheon (4) so that they are centered.
- Carefully bend and/or cut supply tubes and connect left tube to HOT water and right tube to COLD water supply using appropriate connectors.

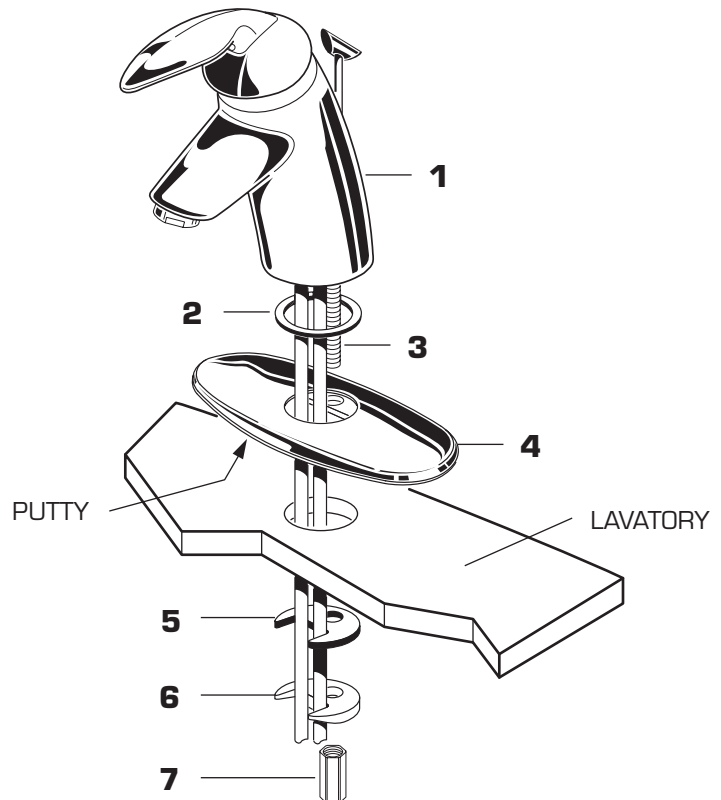

2 INSTALL POP-UP DRAIN

- Push Tail piece **(11)** down into Trap **(C)** (**threaded end up**).
- Thread Locknut **(5)**, Washer **(4)** and Gasket **(3)** (Bevel side up) onto Drain Body **(10)**.
- Apply a bead of Putty **(D)** to underside of Flange **(2)**.
- Feed Drain Body **(10)** up through Sink **(A)** and thread the Flange **(2)** fully onto Drain Body **(10)**.
- Tighten Locknut **(5)** firmly using channel locks, keeping the pivot rod hole pointed towards the back of the sink.
- Assemble Pivot Rod **(9)** as shown in Figure-2B. Notice the position of the Concave Washer **(G)**.
- Insert Pivot Rod **(9)** into Drain Body **(10)** and tighten Pivot Nut **(F)**.
- Push Tailpiece Insert **(12)** into Tailpiece **(11)** and push Tailpiece up and thread tightly into Drain Body **(10)**.
- Position Extension Rod **(7)** onto Pop-Up Rod **(E)** and tighten Thumbscrew **(6)**.
- Remove one end of Clip **(8)** from Pivot Rod **(9)** by squeezing ends together while sliding.
- Insert Pivot Rod **(9)** into second or third hole in Extension Rod **(7)** and reassemble Clip **(8)**.
- Drop Stopper **(1)** into Drain Body **(10)**.
- Adjust stopper height by repositioning Extension Rod **(7)** and tightening Thumbscrew **(6)**.

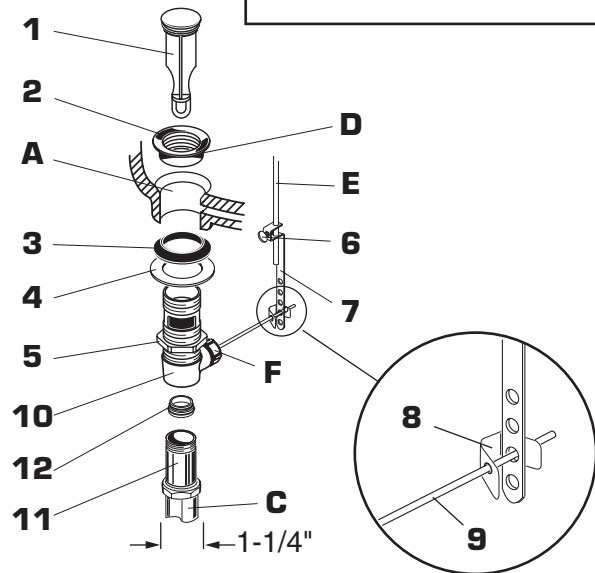

3 TEST FAUCET

- Remove Aerator.
- Turn on water supplies and check for leaks.
- Operate Handle up and down, and left and right and check for proper operation.
- Flush lines and reinstall Aerator.

4 ADJUST HOT LIMIT STOP

- Turn on valve and allow water supply temperatures to stabilize. Move HANDLE to full HOT setting. Check water temperature.
- To decrease hot limit temperature setting:
 - Pull out Plug Button **(1)**, loosen Handle Set Screw **(2)** and remove Handle **(3)** from Cartridge Stem **(5)**. Remove Cartridge Cover **(4)**.
 - Lift Setting Insert **(6)**, rotate counterclockwise one notch and replace. Check water temperature and repeat if necessary. Unit is factory set at "0" (full HOT water). As the setting number increases, the more cold water is supplied in the full HOT handle position.
 - Replace Cartridge Cover **(4)**. Align Handle **(3)** and tighten Set Screw **(2)**. Replace Plug Button **(1)**.

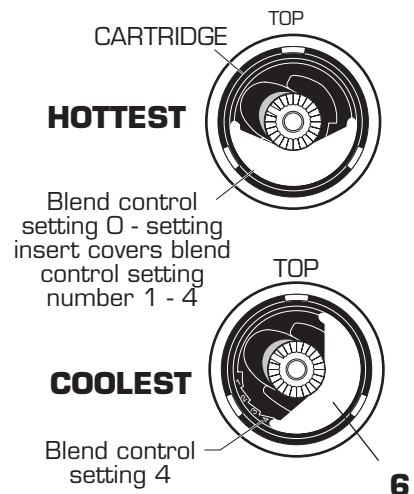
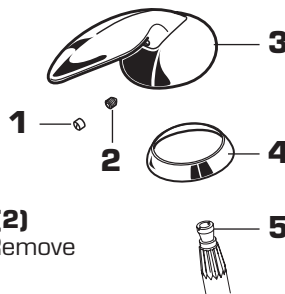

5 CARE INSTRUCTIONS:

DO: SIMPLY RINSE THE PRODUCT CLEAN WITH CLEAR WATER. DRY WITH A SOFT COTTON FLANNEL CLOTH.
DO NOT: DO NOT CLEAN THE PRODUCT WITH SOAPS, ACID, POLISH, ABRASIVES, HARSH CLEANERS, OR A CLOTH WITH A COARSE SURFACE.