

SAVONA TOILET MODEL NUMBER

2095.012 ROUND FRONT * DISCONTINUED
2097.014 ELONGATED FRONT

American Standard

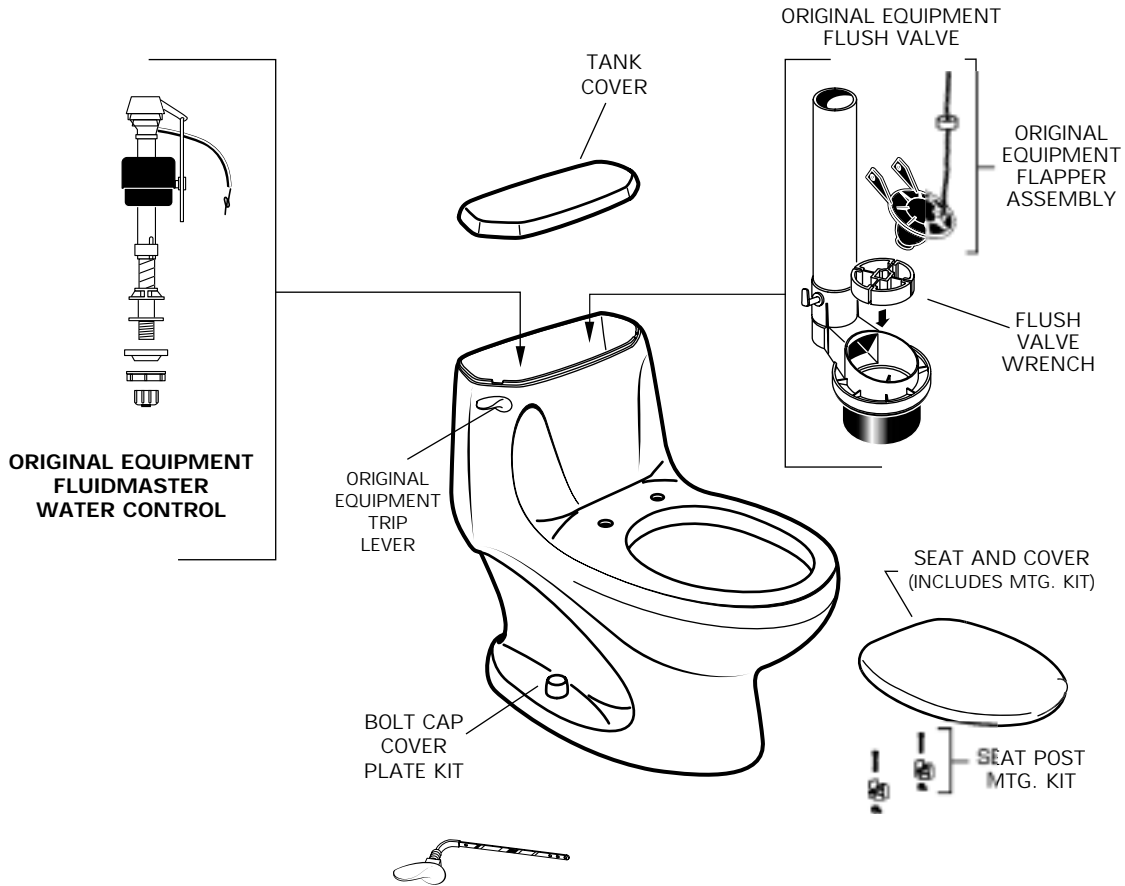

★ Replace XXX with Fixture Color Code, YYY with Trim Finish

REPLACEMENT BRASS ARM TRIP LEVER
LEFT HAND ONLY 738899-0020A CHROME
AVAILABLE IN THE 738899-0200A WHITE
FOLLOWING COLORS: 738899-0990A POLISHED BRASS

DESCRIPTION	COMPONENT	PKG QTY
★ Tank Cover	735069-400.XXX	1
★ Seat and Cover - Round Front	5347.015.XXX	1
★ Seat and Cover - Elongated	5349.019.XXX	1
★ Seat Post Mtg. Kit	760030-100.XXX	1
Seat Assembly Tool (Not Shown)	738371-100	1
ORIGINAL EQUIPMENT REPAIR PARTS	PART NUMBER	PKG QTY
★ Bolt Cap Kit	034783-XXX0A	2
★ Trip Lever (Color)	047242-XXX0A	1
★ Trip Lever (Finish)	047242-YYY0A	1
Flush Valve	738378-0070A	1
Flapper Assembly	738380-0070A	1
Water Control Assembly	738565-411.0070A	1
Flush Valve Wrench	738304-0070A	1

▷ FOR COMPONENT PART ORDERING SEE CURRENT PRODUCT SELECTOR AND PRICING GUIDE.

* DISCONTINUED MODEL HOWEVER REPAIR PARTS ARE AVAILABLE.