

ORIGINAL EQUIPMENT
WATER CONTROL

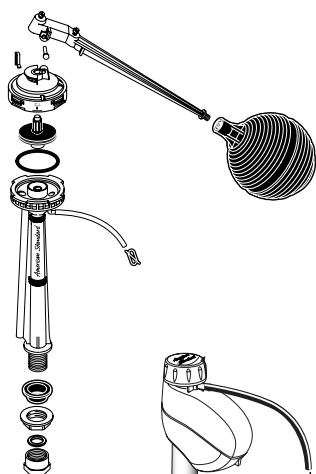

**REPLACEMENT
SMART VALVE
3198.000-B**

TANK COVER

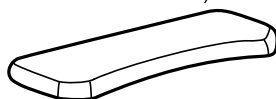

ORIGINAL EQUIPMENT
FLUSH VALVE

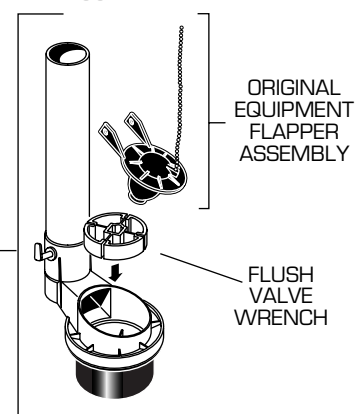

ORIGINAL
EQUIPMENT
FLAPPER
ASSEMBLY

FLUSH
VALVE
WRENCH

ORIGINAL
EQUIPMENT
TRIP
LEVER

BOLT
CAPS

SEAT AND COVER
(INCLUDES MTG. KIT)

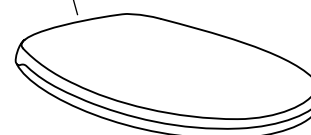

SEAT POST
MTG. KIT



REPLACEMENT BRASS ARM TRIP LEVER
LEFT HAND ONLY 8098.002 CHROME
AVAILABLE IN THE 8098.020 WHITE
FOLLOWING COLORS: 8098.099 POLISHED BRASS

*Replace XXX with
Fixture Color Code,
YYY with Trim Finish
Code: see page VII

DESCRIPTION	▷ COMPONENT	PKG QTY
★ Tank Cover only	735042-400.XXX	1
★ Seat and Cover	5324.019.XXX	1
★ Seat Post Mtg. Kit	760030-100.XXX	1
ORIGINAL EQUIPMENT REPAIR PARTS	PART NUMBER	PKG QTY
★ Bolt Cap Kit	034783-XXX0A	2
★ Trip Lever (Colors)	047242-XXX0A	1
★ Trip Lever (Finish)	047242-YYY0A	1
Water Control Assy (with Float Ball)	738466-0070A	1
Flush Valve	738109-0070A	1
Flapper Assembly	738151-0070A	1
Flush Valve Wrench	738304-0070A	1

▷ FOR COMPONENT PART ORDERING SEE CURRENT PRODUCT SELECTOR
AND PRICING GUIDE.