

# American Standard

## COMPACT EL SPACE SAVER 1.6 G.P.F. TOILET

MODEL NUMBER

2149.012 ELONGATED FRONT

ORIGINAL EQUIPMENT  
WATER CONTROL

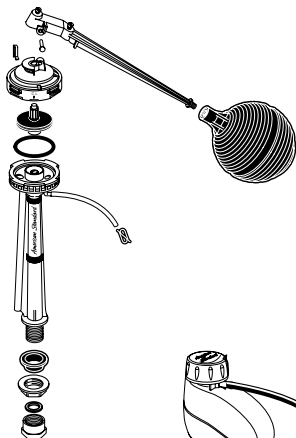

**REPLACEMENT  
SMART VALVE  
3198.000-B**

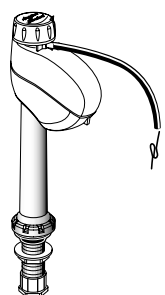

TANK  
COVER



ORIGINAL  
EQUIPMENT  
TRIP  
LEVER

BOLT  
CAPS

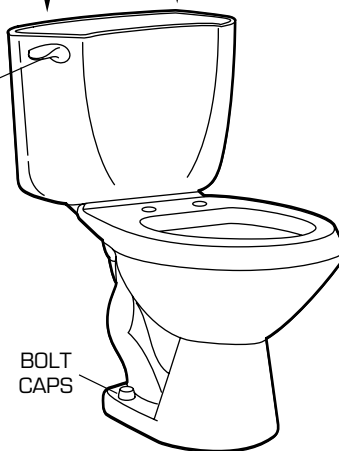

ORIGINAL EQUIPMENT  
FLUSH VALVE



ORIGINAL  
EQUIPMENT  
FLAPPER  
ASSEMBLY



### REPLACEMENT BRASS ARM TRIP LEVER

LEFT HAND ONLY  
AVAILABLE IN THE  
FOLLOWING COLORS:

8098.002 CHROME  
8098.020 WHITE  
8098.099 POLISHED BRASS

★ Replace XXX with  
Fixture Color Code,  
YYY with Trim Finish

DESCRIPTION	▷ COMPONENT	PKG QTY
★ Elongated Bowl only w/(2) Bolt Caps	3027.012.XXX	1
★ Tank w/Fittings & Cover (12" R.I.)	4010.010.XXX	1
★ Tank Cover only	735018-410-XXX	1
ORIGINAL EQUIPMENT REPAIR PARTS	PART NUMBER	PKG QTY
Water Control Assembly (with Float Ball)	738145-0070A	1
Flush Valve	738138-0070A	1
★ Trip Lever	047242-XXX0A	1
★ Bolt Cap Kit	034783-XXX0A	2
Coupling Kit, Bowl-to-Tank	047188-0070A	1
Flapper Assembly	738159-0070A	1

▷ FOR COMPONENT PART ORDERING SEE CURRENT PRODUCT SELECTOR  
AND PRICING GUIDE.