

Register your product and get support at
www.philips.com/welcome

SWW1800/27



Quick Start Guide

- 1 Connect
- 2 Install
- 3 Enjoy

PHILIPS

What's in the box



Remote control



Transmitter

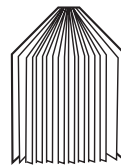

User manual



Receiver

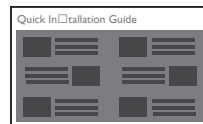

Quick Start Guide



Power adaptor x 2

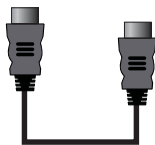

HDMI cable

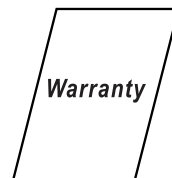

Warranty

Note

- Make sure you have all these items in the box. Contact your dealer for any missing or damaged items.

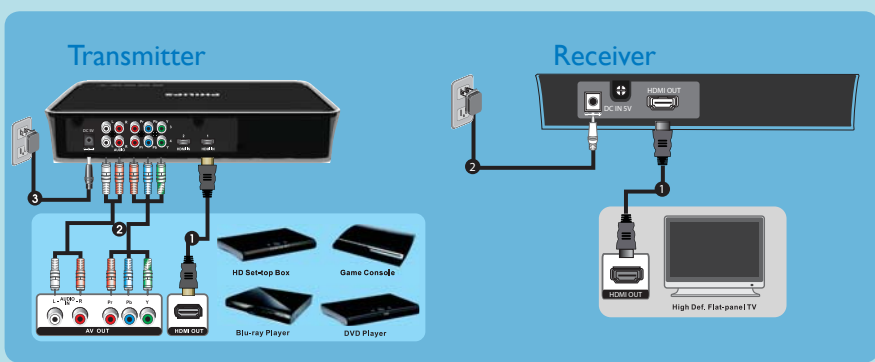

Connect the transmitter to your HD devices

- 1 Connect video source to the transmitter using the HDMI cable
 - Connect one end of the HDMI cable (included) to the HDMI connector of the transmitter.
- 2 Connect the video source to the transmitter using the component cables
 - Connect one end of the RCA (green, blue and red) cables to the Y/Pb/Pr IN connectors of the transmitter. Connect the other end of the RCA cables to the corresponding Y/Pb/Pr OUT connectors of your HD devices.
 - Connect one end of the set of audio cables to the AUDIO L/R IN connectors of the transmitter. Connect the other end to the corresponding AUDIO L/R OUT connectors of your HD devices.
- 3 Connect the power adaptor to the transmitter
 - Connect one end of the power adaptor (included) to the DC IN connector of the transmitter. Connect the other end of the power adaptor to a power socket.
 - ↳ The power LED indicator lights up in solid red.
 - ↳ The HDMI devices and analog devices with the component and stereo RCA start connecting.

Connect the receiver to your HDTV set

- 1 Connect the receiver with an additional HDMI cable (not included):
 - Connect one end of the HDMI cable to the receiver.
 - Connect the other end to the HDMI OUT connector of your HDTV.
- 2 Connect the power adaptor to the receiver:
 - Connect one end of the power adaptor (included) to the DC IN connector of the receiver.
 - Connect the other end of the power adaptor to a power socket.

2 Install

Install remote control batteries

- 1 Open the battery compartment.
- 2 Insert two AAA batteries with correct polarity (+/-) as indicated.
- 3 Close the battery compartment.



3 Enjoy

Turn on the power of your HDTV

- 1 Go to the source menu under the settings menu of your HDTV.
- 2 Select the HDMI input to which the receiver is connected.

Note

- You cannot control the receiver with the supplied remote control and the receiver follows the transmitter's status to enter/exit the standby mode.
- The synchronization of standby between the HDTV and the receiver depends on the capability of the HDTV.



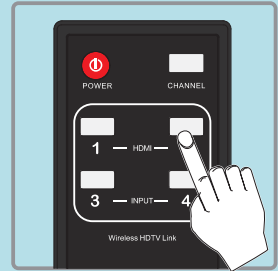
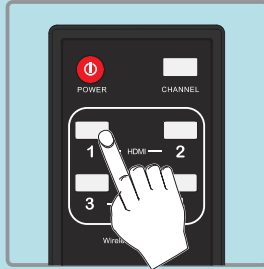

Switch on the transmitter

Press  on the remote control or transmitter in standby mode to turn it on.

Select the source on the transmitter

Press the source buttons: 1 HDMI, 2 HDMI, 3 INPUT, 4 INPUT on the remote control or transmitter until you see the available video from your device.

Note

- In standby mode, a red power LED displays on the transmitter.
- Depending on equipment and the input selected, between input selection/start-up and being able to see the image on your TV can take up to 15 seconds.



Wallmount the receiver

You can either place the receiver near the HDTV or mount it on the wall.

- 1 Choose a spot near the TV.
- 2 Drill two holes in the wall. Ensure the distance between the two holes is 4.5mm.
- 3 Punch the supplied plastic wall anchors into the two holes on the wall.
- 4 Put the two screws into the plastic wall anchors and leave 3.2mm to mount the receiver on.
- 5 Hook the receiver on the wall.

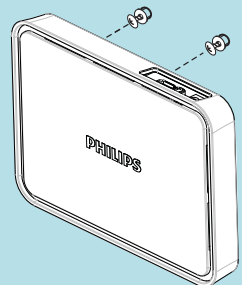
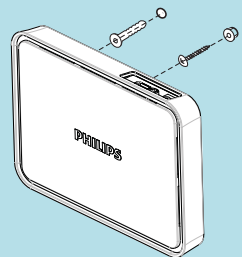

Troubleshooting

There is no video displayed on my TV screen.

- Verify the POWER LED and SOURCE LED indicator on the transmitter:

I cannot hear any sound or the sound is poor, what do I do?

- Ensure the TV volume control is adjusted correctly.
- Ensure the TV volume is not set to minimum or the sound is not muted.
- Ensure the audio cables of the transmitter are connected correctly.
- Ensure the Audio format is recognized/supported.

Long switching time due to the channel switching on a satellite/cable set-top box.

- Select video scaling if your set-top box supports this feature so as to keep the output resolution constant.

Tip

- For more information, see the user manual.

Welcome to Philips

Register your product at www.philips.com/welcome

Need help?

User Manual

Refer to the User Manual that came with your SWW1800.

Online help

www.philips.com/support

© 2009 Koninklijke Philips Electronics N.V. All rights reserved. Reproduction in whole or in part is prohibited without the written consent of the copyright owner.

Trademarks are the property of Koninklijke Philips

Electronics N.V. or their respective owners.



Be responsible
Respect copyrights



CE 0682

Printed in Taiwan

SWW1800_27_EN_QSG_V1.1