



3500 Pelco Way
Clovis, CA 93612-5699
USA

In North America & Canada:
Tel (800) 289-9100
FAX (800) 289-9150

International Customers:
Tel +1 (559) 292-1981
FAX +1 (559) 348-1120

www.pelco.com

C2415M (11/99)

BK4000 Series Blower Kit

HK4000 Series Heater Kit

IMPORTANT SAFEGUARDS AND WARNINGS

Prior to installation and use of this product, the following WARNINGS should be observed.

1. Installation and servicing should only be done by qualified service personnel and conform to all local codes.
2. Unless the unit is specifically marked as a NEMA Type 3, 3R, 3S, 4, 4X, 6, or 6P enclosure, it is designed for indoor use only and it must not be installed where exposed to rain and moisture.
3. Only use replacement parts recommended by Pelco.
4. After replacement/repair of this unit's electrical components, conduct a resistance measurement between line and exposed parts to verify the exposed parts have not been connected to line circuitry.

Please thoroughly familiarize yourself with the information in this manual prior to installation and operation.

MODELS

- BK4000 Blower kit for EH4014/EH4018 Series Enclosure, 120 VAC, 4 watts
BK4024 Same as BK4000 except for 24 VAC, 3 watts
BK4220 Same as BK4000 except for 230 VAC, 4.8 watts
HK4024 Heater kit, thermostatically controlled, 24 VAC, 40 watts, for EH4014/EH4018 Series Enclosure, activates ON at 40°F (4.44°C) and OFF at 60°F (15.56°C)
HK4220 Same as HK4024 except for 230 VAC, 30 watts

CAUTION: When using a single power source for both the camera and accessories, the camera power consumption must be taken into consideration when determining wire gauge.

INSTALLATION

The following cable sizes are the minimum recommended for use with the combination of blower/heater/camera.

Table A. Power Requirements and Recommended Cable Sizes

| Power Model Number | Input Voltage | Consumption | Cable Size | Cable Distance |
|-----------------------|---------------|-------------|--------------------------------------|---|
| EH4014-1/ EH4018-1 | 120 VAC | 44 watts | 22 AWG 20 AWG 18 AWG 16 AWG | 1,013 ft (308.8 m) 1,612 ft (491.3 m) 2,564 ft (781.5 m) 4,070 ft (1,240.5 m) |
| EH4014-2/ EH4018-2 | 24 VAC | 43 watts | 20 AWG 18 AWG 16 AWG 14 AWG | 65 ft (19.8 m) 100 ft (30.48m) 165 ft (50.3 m) 265 ft (80.8 m) |
| EH4014-3/ EH4018-3 | 230 VAC | 34.8 watts | 20 AWG 18 AWG 16 AWG 14 AWG | 7,488 ft (2,282 m) 11,913 ft (3631 m) 18,906 ft (5,763 m) 30,161 ft (9,193 m) |
| BK4000 | 120 VAC | 4 watts | 22 AWG 20 AWG 18 AWG 16 AWG | 11,152 ft (3,399.1 m) 17,733 ft (5,405.0 m) 28,213 ft (8,599.3 m) 44,776 ft (13,647.7 m) |
| BK4024 | 24 VAC | 3 watts | 20 AWG 18 AWG 16 AWG 14 AWG | 945 ft (288.0 m) 1,500 ft (457.2 m) 2,385 ft (726.9 m) 3,805 ft (1,159.8 m) |
| BK4220 | 230 VAC | 4.8 watts | 20 AWG 18 AWG 16 AWG 14 AWG | 54,289 ft (16,547.5 m) 86,370 ft (26,326 m) 137,075 ft (41,780 m) 218,667 ft (66,650 m) |
| HK4014 | 120 VAC | 40 watts | 22 AWG 20 AWG 18 AWG 16 AWG | 1,115 ft (339.9 m) 1,770 ft (539.5 m) 2,820 ft (859.5 m) 4,475 ft (1364.0 m) |
| HK4024 | 24 VAC | 40 watts | 20 AWG 18 AWG 16 AWG 14 AWG | 70 ft (21.3 m) 110 ft (33.5 m) 175 ft (55.3 m) 285 ft (86.9 m) |
| HK4220 | 230 VAC | 30 watts | 20 AWG 18 AWG 16 AWG 14 AWG | 8,686 ft (2,647 m) 13,819 ft (4,212 m) 21,932 ft (6,685 m) 34,986 ft (10,664 m) |

Blower Kit

If you are installing the blower kit in conjunction with a heater kit, skip this section and refer to *Blower and Heater Kits (Dual Installation)*.

To install a blower kit, perform the following steps:

1. Attach the blower assembly onto the bracket at the rear of the camera sled using the hardware provided (see Figure 1).
2. Wire as shown in Figure 2. Refer to Table A for cable size.

Heater Kit

If you are installing the heater kit in conjunction with a blower kit, skip this section and refer to *Blower and Heater Kits (Dual Installation)*.

Perform the following steps to complete the heater kit installation:

1. Attach the PC board assembly onto the bracket at the rear of the camera sled (refer to Figure 1).
2. Attach the heater assembly onto the front of the camera sled.
3. Route the wiring from the heater assembly along the side of the camera sled.
4. Wire the heater to power. Refer to Figure 2 and Table A.

Blower and Heater Kits (Dual Installation)

1. a. **BK4000 and BK4024** - Remove the PC board from the heater assembly. Attach the PC board to the top bracket of the blower assembly.
b. **BK4220** - The blower and heater assemblies are both factory assembled with a PC board. Only one PC board assembly is required. Remove the PC board from the blower assembly and replace it with the PC board from the heater assembly.
2. Attach the PC board and blower assembly onto the bracket at the rear of the camera sled (refer to Figure 1).
3. Attach the heater assembly onto the front of the camera sled.
4. Route the wiring from the heater assembly along the side of the camera sled.
5. Wire the fan and power to the PC board. Refer to Figure 2 and Table A.

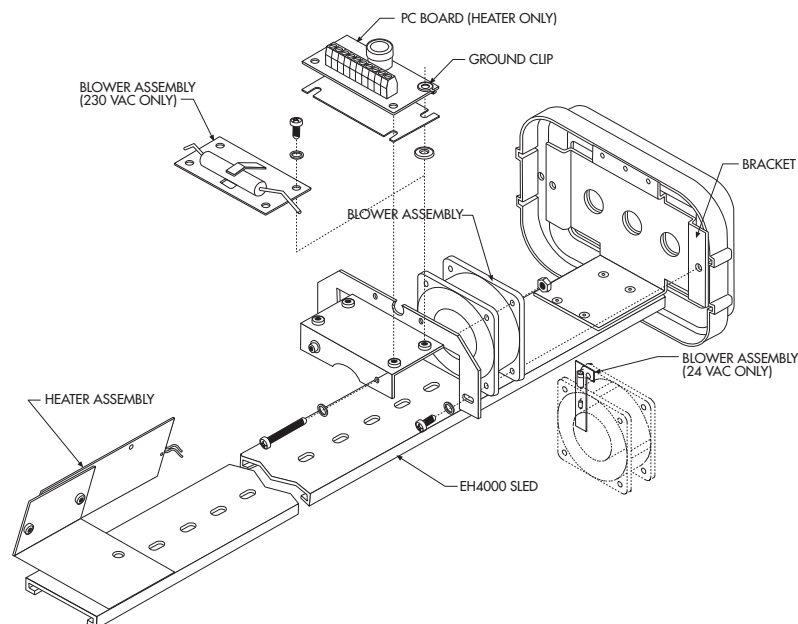

Figure 1. Blower/Heater Kit Installation

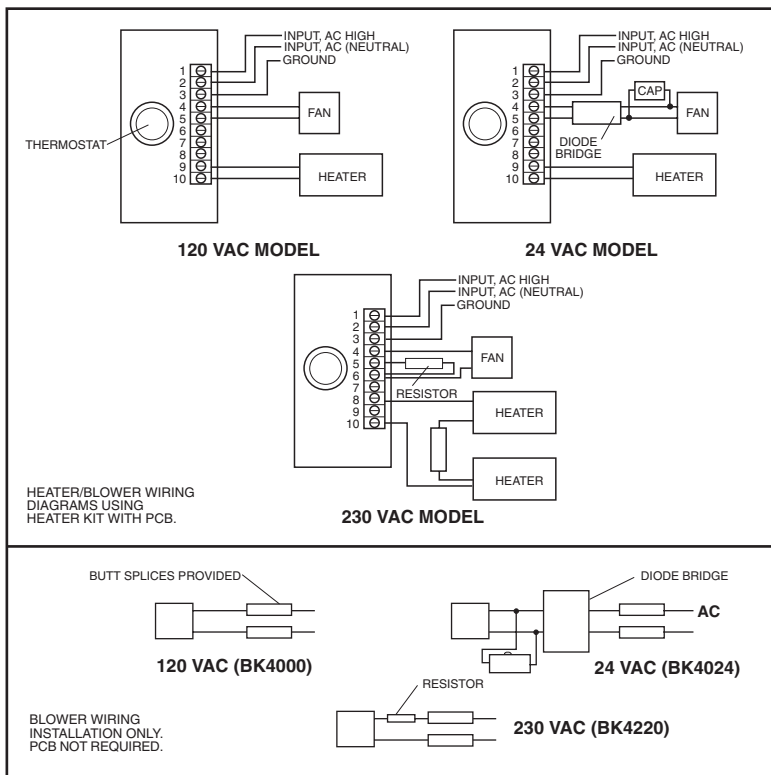

Figure 2. Blower/Heater Kit Wiring Diagram (All Models)

SERVICE MANUAL

If you need to order replacement parts, obtain a service manual in one of the following ways:

- Go to Pelco's web site at www.pelco.com and find service manual C2415SM.
- Contact Pelco's Literature Department and request service manual C2415SM.

PRODUCT WARRANTY AND RETURN INFORMATION

WARRANTY

Pelco will repair or replace, without charge, any merchandise proved defective in material or workmanship **for a period of one year** after the date of shipment.

Exceptions to this warranty are as noted below:

- Five years on FT/FR8000 Series fiber optic products.
- Three years on Genex® Series products (multiplexers, server, and keyboard).
- Three years on Camclosure® and fixed camera models, except the CC3701H-2, CC3701H-2X, CC3751H-2, CC3651H-2X, MC3651H-2, and MC3651H-2X camera models, which have a five-year warranty.
- Two years on standard motorized or fixed focal length lenses.
- Two years on Legacy®, CM6700/CM6800/CM9700 Series matrix, and DF5/DF8 Series fixed dome products.
- Two years on Spectra®, Esprit®, ExSite™, and PS20 scanners, including when used in continuous motion applications.
- Two years on Esprit® and WW5700 Series window wiper (excluding wiper blades).
- Eighteen months on DX Series digital video recorders, NVR300 Series network video recorders, and Endura™ Series distributed network-based video products.
- One year (except video heads) on video cassette recorders (VCRs). Video heads will be covered for a period of six months.
- Six months on all pan and tilts, scanners or preset lenses used in continuous motion applications (that is, preset scan, tour and auto scan modes).

Pelco will warrant all replacement parts and repairs for 90 days from the date of Pelco shipment. All goods requiring warranty repair shall be sent freight prepaid to Pelco, Clovis, California. Repairs made necessary by reason of misuse, alteration, normal wear, or accident are not covered under this warranty.

Pelco assumes no risk and shall be subject to no liability for damages or loss resulting from the specific use or application made of the Products. Pelco's liability for any claim, whether based on breach of contract, negligence, infringement of any rights of any party or product liability, relating to the Products shall not exceed the price paid by the Dealer to Pelco for such Products. In no event will Pelco be liable for any special, incidental or consequential damages (including loss of use, loss of profit and claims of third parties) however caused, whether by the negligence of Pelco or otherwise.

The above warranty provides the Dealer with specific legal rights. The Dealer may also have additional rights, which are subject to variation from state to state.

If a warranty repair is required, the Dealer must contact Pelco at (800) 289-9100 or (559) 292-1981 to obtain a Repair Authorization number (RA), and provide the following information:

1. Model and serial number
2. Date of shipment, P.O. number, Sales Order number, or Pelco invoice number
3. Details of the defect or problem

If there is a dispute regarding the warranty of a product which does not fall under the warranty conditions stated above, please include a written explanation with the product when returned.

Method of return shipment shall be the same or equal to the method by which the item was received by Pelco.

RETURNS

In order to expedite parts returned to the factory for repair or credit, please call the factory at (800) 289-9100 or (559) 292-1981 to obtain an authorization number (CA number if returned for credit, and RA number if returned for repair).

All merchandise returned for credit may be subject to a 20% restocking and refurbishing charge.

Goods returned for repair or credit should be clearly identified with the assigned CA or RA number and freight should be prepaid. Ship to the appropriate address below.

If you are located within the continental U.S., Alaska, Hawaii or Puerto Rico, send goods to:

Service Department
Pelco
3500 Pelco Way
Clovis, CA 93612-5699

If you are located outside the continental U.S., Alaska, Hawaii or Puerto Rico and are instructed to return goods to the USA, you may do one of the following:

If the goods are to be sent by a COURIER SERVICE, send the goods to:

Pelco
3500 Pelco Way
Clovis, CA 93612-5699 USA

If the goods are to be sent by a FREIGHT FORWARDER, send the goods to:

Pelco c/o Expeditors
473 Eccles Avenue
South San Francisco, CA 94080 USA
Phone: 650-737-1700
Fax: 650-737-0933

REVISION HISTORY

| Manual # | Date | Comments |
|----------|-------|-------------------|
| C2415M | 11/99 | Original version. |