

# **FARADAY STAR**

## **PERPETUAL FLASHLIGHT**

**IMPORTANT : FARADAY STAR must be fully charged for the first use**

Modern technology and Faraday's Law of Inductance join forces to create a virtually indestructible flashlight that has no need for batteries or bulbs.

Shaking the torch causes a high strength magnet to pass back and forth between a wire coil giving charge to the flashlight's capacitor that can be stored for months.

Just 30 seconds of shaking can generate up to 2 minutes of light and the super bright LED can be seen for up to a mile and never needs to be replaced.

Faraday Star is an indispensable accessory.

Ideal for any outdoor activity including camping, hiking, boating as well as general emergency situations.

### **Using the Faraday Star**

The Faraday Star is charged by shaking, no batteries are needed, just shake vigorously side to side for around 30 seconds. (See fig.1) Press the switch to turn on and release to turn off. (See fig.2)

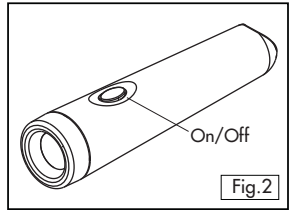
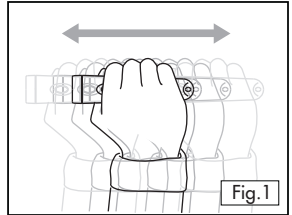

### **Duration**

The Faraday Star provides up to 2 minutes of continuous use when charged for 30 seconds.

If it is completely drained of energy or used for the first time the Faraday Star should be turned off and shaken vigorously to fully charge the capacitor.

### **Cautions**

1. There is a strong magnetic field surrounding the Faraday Star. **DO NOT** place the Faraday Star within 30cm of cassette tapes, computer floppy disc, video tapes, credit cards, pacemakers, televisions, monitors or any other magnetic storage device or device affected by a magnetic field.
2. Do not attempt to remove the LED or any internal part.

### **Care and maintenance**

- Clean with damp cloth
- Clean the lens with standard glass cleaning products
- Do not use petroleum based liquids such as gasoline or kerosene or solvents such as acetone to clean any part of the flashlight

# Contents

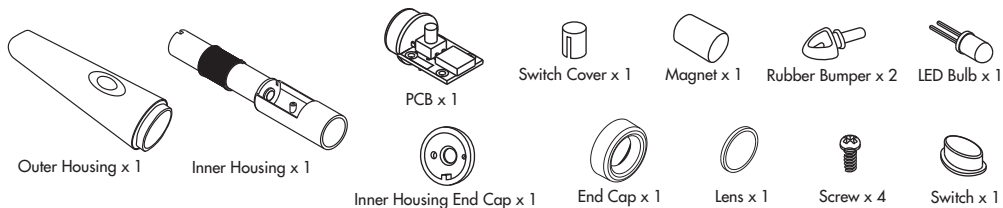

## Assembly

1. Insert Rubber Bumper in Inner Housing End Cap and pull to snap in place.

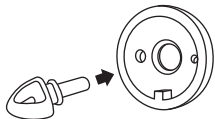

2. Cut off excess rubber from Rubber Bumper.

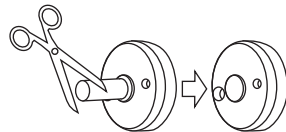

3. Insert second Rubber Bumper into Inner Housing and pull using pliers to snap in place.

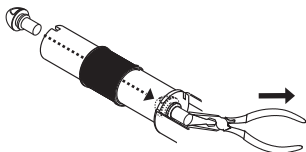

4. Cut off excess rubber.

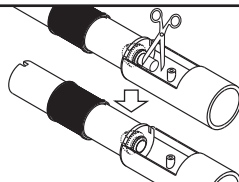

5. Screw PCB onto Inner Housing making sure wires are connected as shown.

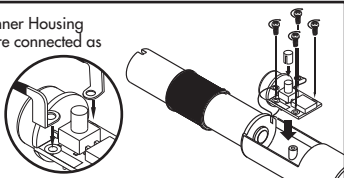

6. Insert L.E.D. and into Inner Housing and make sure L.E.D. is pushed fully into place. Make sure the flat side of the L.E.D. lines up with the flat side of the L.E.D. socket.

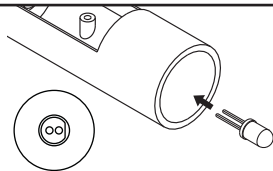

7. Insert Magnet into Inner Housing and push Inner Housing End Cap into place.

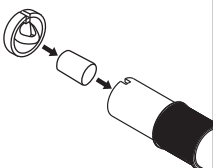

8. Locate switch in hole in Flashlight Body.

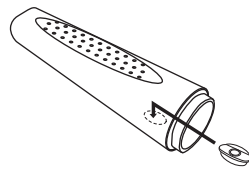

9. Keeping Outer Housing in same position as in step 8 carefully insert Inner Housing and rotate until it fits fully inside.

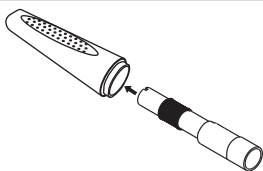

10. Place Lens in place with domed side facing up and screw shut with End Cap.

