

Important:

Used wisely, your new sound equipment will provide years of enjoyment. Noise-induced hearing loss is preventable but often undetected until it is too late. Westone and the Electronic Industries Association's Consumer Electronics Group recommend you avoid prolonged exposure to excessive noise. Used responsibly, your CR-1 earphones can help prevent noise-induced hearing loss. If you have questions, contact your audiologist or hearing care professional.

Be sure to observe the following guidelines:

- Do not turn up the volume so high that you can't hear what's around you.
- You should use extreme caution or temporarily discontinue use in potentially hazardous situations.
- Do not use while operating a motorized vehicle as it may create a traffic hazard and is illegal in many areas.

If you would like more information or would like to purchase other Westone products and accessories, please call: 1-800-525-5071 or visit us at: www.westone.com

© Westone Laboratories, Inc. PN 98976 6/07

CR-1 Limited Warranty Information

Limited Product Warranty

Westone warrants this product to be free of defects in material or workmanship for a period of one year from the date of original retail purchase. If the product components are found to be defective during the warranty period, Westone will, at its sole option, either repair or replace the defective components.

The warranty period for fit of custom earphones is ninety days from the date of original purchase. Westone will adjust or remake the earphones to resolve fit issues during this warranty period.

This limited warranty does not apply to any defects attributable to damage beyond the reasonable control of Westone including damage caused by abuse, misuse, misapplication or modifications performed by anyone other than Westone.

Requesting a Warranty Repair

If your product is not functioning properly, first ensure that the sound bore is not blocked by earwax and that the unit is completely dry. Performing these simple troubleshooting steps could solve the problem and eliminate the need for a repair. If it is necessary to return your product for warranty or post-warranty service, please return the product to the retailer and include a description of the problem.

Limitation of Liability

Westone disclaims any and all implied warranties, warranties of merchantability and fitness for a particular purpose to the maximum extent permissible by law. Westone shall not be liable for any special, incidental or consequential damages caused by the use, misuse, or inability to use this product. If purchased under a government contract, those contract terms supersede terms stated herein.

At Westone, we value your satisfaction. If you have any questions, please contact us at 800-525-5071 or via email at: westone@westone.com.

CR-1

Owner's Manual



General Information

Care & Maintenance

Warranty

Hearing Care Information

 **Westone**[®]

Congratulations and thank you for your purchase of the Westone CR-1. The information in this booklet will help you get the best possible listening enjoyment from your CR-1 earphones and keep them in top condition for years of use.

Caring for your CR-1 Earphones

Here are a few simple guidelines that can greatly increase your listening enjoyment and lifespan of your Westone CR-1 earphones.

- Always store your earphones in the provided case.
- In case of poor sound quality due to earwax in the sound bore, use the included wax removal loop to carefully remove the earwax. Never use any other object to attempt to remove the earwax as this may result in damage to the earphone and will void the warranty.
- Do not use the cord to remove the earphones from your ears. This may cause damage to the cord and result in poor performance. Damage of this nature is not covered by the warranty.
- Do not expose your earphones to temperature extremes. Avoid strong impacts to your earphones.
- Wipe down earphones after each use and never immerse them in water.

Insertion and Removal Instructions

Identify the left and right CR-1 earphones. The red dot indicates the right earphone while the blue is for the left. With your right hand, hold the right earphone so that the cable points toward the back of your head. Use your left hand to pull up the outer ear while inserting the canal tip of the earphone into your ear canal. Slowly rotate the earphone counter clockwise into place.

A light coating of Westone Oto-Ease[®] on the canal tip of the earphone will ease insertion. The earphone should almost seem to snap into place. Insert the left earphone in the same manner, but rotate it clockwise into place.

Reverse these steps to remove the CR-1's. For the right ear, pull back on the outer ear with your left hand to break the seal, then turn the earphone clockwise to remove it. Rotate counter clockwise for your left ear.

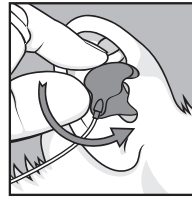
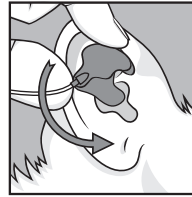

Right ear shown

Please Note

These CR-1 earphones were made specifically to fit your ears. Their performance depends on a snug fit and firm acoustic seal. Please be advised that any significant change in your weight (gain or loss) can result in changes to the shape and/or size of your ears and ear canals. This will affect the performance of your CR-1s, not only in sound quality, but also in the amount of hearing protection afforded.

If you experience this type of problem, see your hearing care provider or dealer to have new impressions taken. Your earphones can then be re-manufactured from the existing components to address the fit issue. Charges will apply.

Moisture in your earphones can cause temporary performance issues. Do not insert your earphones if your ears are wet. Always dry your ears completely before inserting your earphones. Should you inadvertently allow water or perspiration into the earphones and they quit working, allow to dry completely before attempting to use again. Minor moisture build-up should dry out and not affect long-term performance. Extended exposure to moisture or submersion will result in permanent damage (not covered by the warranty).

Important Hearing Care Information

If, after using your Westone CR-1 Earphones, everything sounds muffled, or if you hear ringing or buzzing, your ears are trying to give you a warning! These symptoms are normally associated with a condition known as Temporary Threshold Shift and are an indication of conditions that could lead to permanent hearing loss.

While no two individuals' hearing sensitivity is exactly the same, there are established safety guidelines for sound levels versus time of exposure. The following chart is based on OSHA's (Occupational Health and Safety Administration) exposure information for industry. Remember that these guidelines are based on average hearing sensitivity, your sensitivity may be above or below these levels.

dB level	Maximum exposure time
85	8 hr.
90	4 hr.
95	2 hr.
100	1 hr.
105	30 min.
110	15 min.
115	7.5 min.

The use of any earphone offers benefits and risks. Westone CR-1 Earphones can lower ambient sound levels approximately 25dB when properly worn. However, the performance capabilities of the earphones can allow the user to negate the benefits of hearing protection from ambient sound. We want you listening for a lifetime!

Remember, personal hearing protection is your responsibility!