

# HP921: Quick Start Guide



slick®

HP921

## WIRELESS HEADPHONES Quick Start Guide

### Using your wireless headphones

• Turning on/off: Slide the **[POWER]** switch of the **Wireless Transmitter** to the "ON" position, and then slide the **[AUDIO SELECTOR]** of the headphones to either "R" for FM radio or "H" to listen to audio received from the **Wireless Transmitter**.

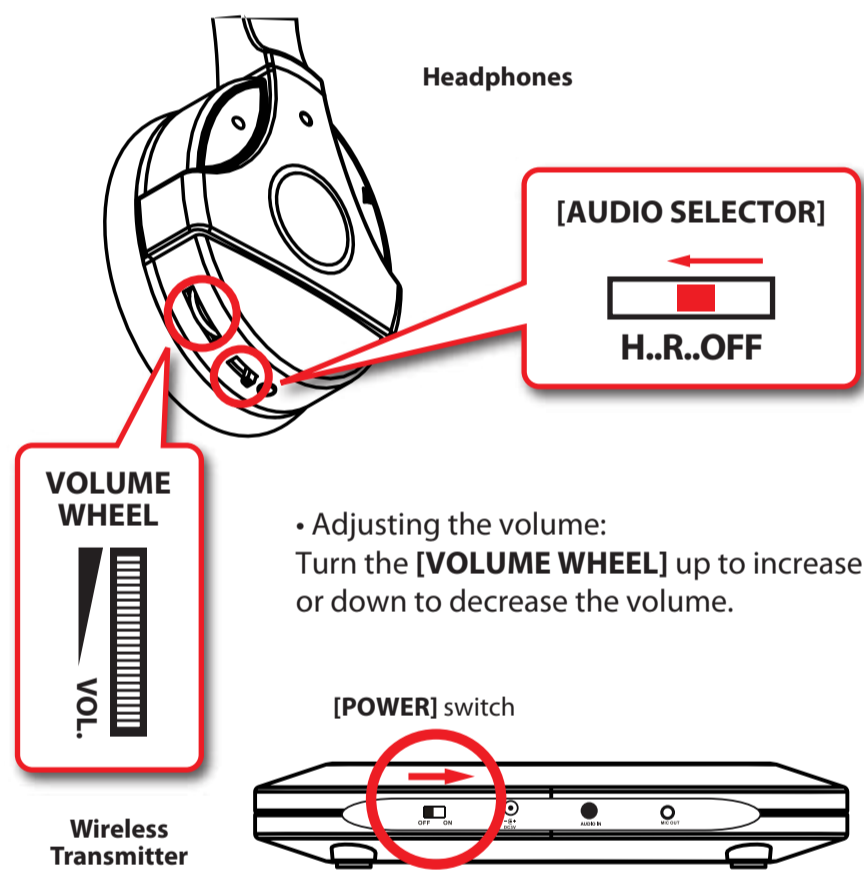

### Connecting to a television

1) Connect the single green plug of the provided **AUDIO CABLE** to the "AUDIO IN" jack of the **Wireless Transmitter**.

2) Connect the red and white plugs to the matching output jacks of your television, or if you receive Cable or Satellite service- connect the red and white plugs to the matching output jacks of the Cable or Satellite box.

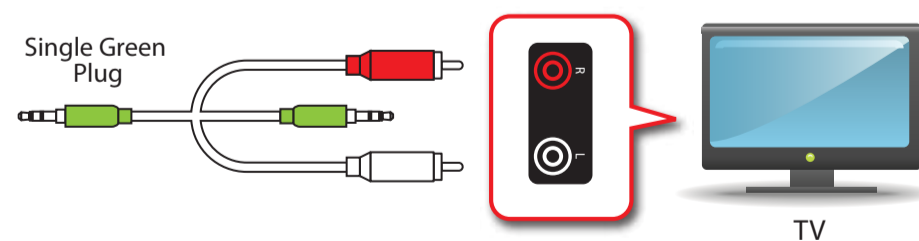

3) Slide the **[POWER]** switch of the **Wireless Transmitter** to the "ON" position.

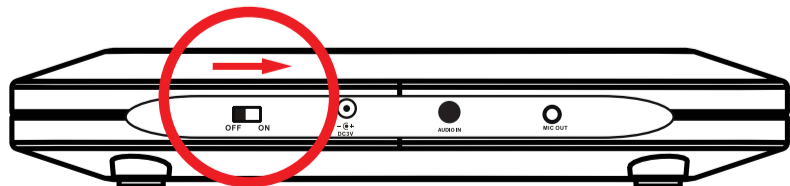

English side



slick®

HP921

## CASQUE SANS FIL Guide de démarrage rapide

### Utilisation d'un casque sans fil

• Activation / désactivation: Faites glisser le commutateur **[POWER]** du transmetteur sans fil sur "ON" position, puis faites glisser le **[AUDIO SELECTOR]** du casque soit "R" pour la radio FM ou "H" pour écouter le son reçu de la Transmetteur sans fil.

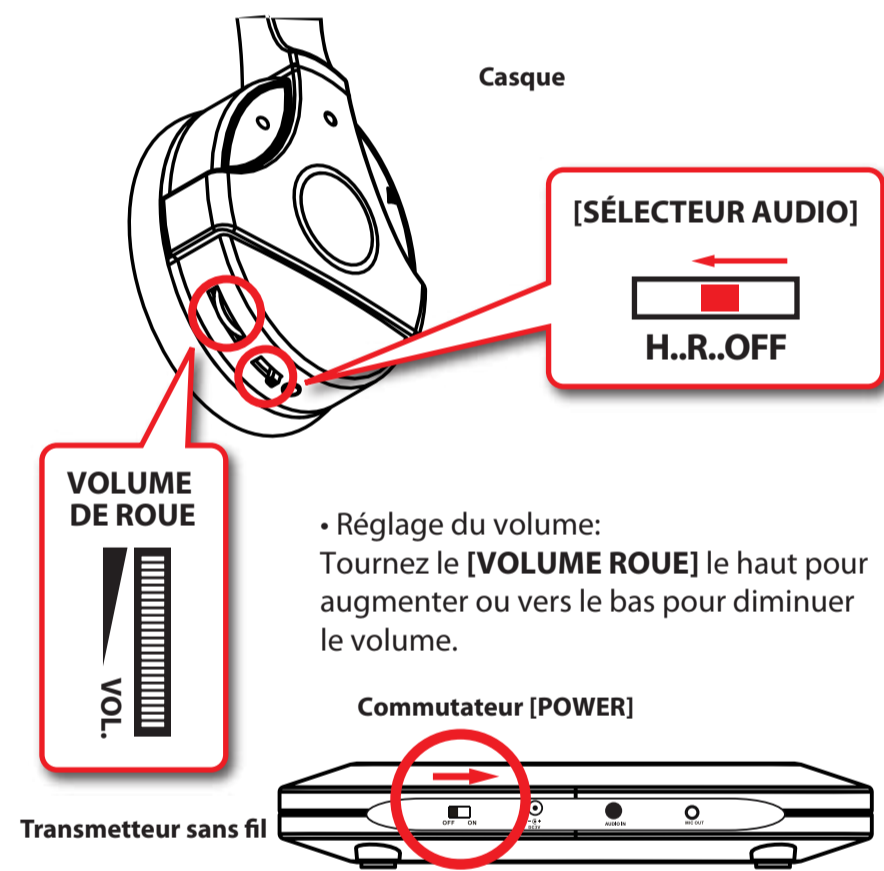

### Connexion

1) Connectez la fiche verte du câble fourni à **AUDIO "AUDIO IN"** de l'émetteur sans fil.

2) Reliez les fiches rouge et blanc aux prises de sortie correspondant à des votre téléviseur, ou si vous recevez câble ou satellite- servicecommuniquer l' fiches rouge et blanche aux prises de sortie correspondant du câbleou satellite boîte.

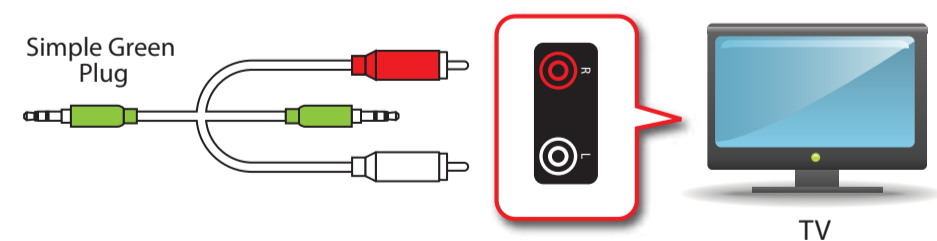

3) Faites glisser le commutateur **[POWER]** de l'émetteur sans fil à l'aposition "ON".

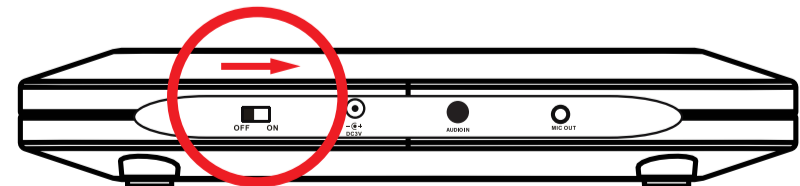

French side