



© 2005 Hutchison Harbour Ring Enterprises Limited  
All rights in this publication are reserved and no part may be reproduced without the prior written permission of the publisher. The contents of this publication are believed to be correct at the time of going to press, but any information, specifications, products or services mentioned may be modified, supplemented or withdrawn without further notice.

The Stylized i.Tech logos are trademarks owned by Hutchison Harbour Ring Enterprises Limited or its affiliates.

Bluetooth® and the Bluetooth logos are trademarks owned by Bluetooth SIG, Inc, USA and licensed to i.Tech Dynamic Limited.

[www.itchedynamic.com](http://www.itchedynamic.com)

Printed in China

01/2006



This device complies with Part 15 of the FCC Rules. Operation is subject to the following two conditions:  
(1) this device may not cause harmful interference, and  
(2) this device must accept any interference received, including interference that may cause undesired operation.  
Caution: Changes or modifications not expressly approved by the party responsible for compliance could void the user's authority to operate the equipment.

i.Tech declares under our sole responsibility that the headset is in conformity with the provisions of the following Council Directives: 1999/5/EC



Dispose of the packaging and this product in accordance with the latest provisions.

P/N S3J-51A05053-01A



## i.Tech Arrow II



### User Guide





Providing a simple wireless connection to your Bluetooth-enabled mobile handset, i.Tech Arrow II headset offers you the freedom to make and receive calls while on the move or at the office.

The i.Tech Arrow II headset is compatible with mobile handsets that support the Bluetooth Headset and Handsfree Profiles to create voice communication via Bluetooth technology.

## Declaration of Conformity ( DoC )

We, i.Tech Dynamic Ltd., declare that the following product:

Product Name: i.Tech Arrow II

Model No.: C51-A05053-XX

Is in conformity with the following essential requirements of Council Directive 1999/5/EC ( referred to as R&TTE Directive ) : Article 3.1a, 3.1.b and 3.2. and the product is manufactured in accordance with Annex II of above directive.

A copy of the Declaration of Conformity can be found at:

<http://www.itechdynamic.com>

## Table of Contents

i.Tech Arrow II Overview.....	2
Getting Started.....	2
Charging Your Headset.....	3-4
Normal Charging Time.....	4
Talk and Stand-by Time.....	4
Low Battery.....	4
Turning your Headset On and off.....	5
Turning the headset on.....	5
Turning the headset off.....	5
Pairing Your Headset.....	6-7
Using Your Headset.....	8
Answering a Call.....	8
Ending a Call.....	8
Rejecting a Call.....	8
Dialing from Your Mobile Handset.....	8
Voice Dialing from Your Headset.....	9
Last Number Redialing from Your Headset.....	9
Adjusting the Volume.....	10
Resetting/ Removing the Pairing .....	10
Care and Maintenance.....	11
Headset.....	11
Built-in Battery.....	12
Charger.....	12
Safety Information.....	13
Troubleshooting.....	14
Product Specifications.....	15
Declaration of Conformity (DoC).....	16

## i.Tech Arrow II Overview

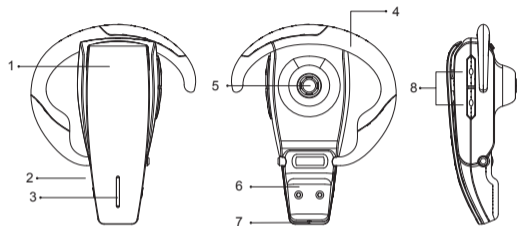

- |                          |                                  |
|--------------------------|----------------------------------|
| 1. Multi-function Button | 5. Speaker                       |
| 2. Charging Socket       | 6. Built-in Rechargeable Battery |
| 3. Status Indicator      | 7. Microphone                    |
| 4. Ear Hook              | 8. Volume Keys                   |

(fig. 1)

## Getting Started

To use your i.Tech Arrow II ("the headset"), please follow these simple steps:

- Charge your headset
- Pair your headset with a Bluetooth-enabled mobile handset

## Product Specifications

<b>Bluetooth Specification:</b>	Version 1.2 Class 2
<b>Bluetooth Profile Supported:</b>	Headset and Handsfree
<b>Range of Frequency:</b>	2.4GHz Spectrum
<b>Reception distance:</b>	10 metres
<b>Normal Charging Time:</b>	Within 10 hours
<b>Talk Time*:</b>	Up to 6 hours
<b>Standby Time*:</b>	Up to 200 hours
<b>Dimensions:</b>	59 (L) x 25 (W) x 23 (H) mm
<b>Weight:</b>	15.5 grams

\* May vary due to users' operation mode and mobile phone settings

## Troubleshooting

If you are unable to connect your headset and mobile handset, please try the following:

- Ensure your headset is turned off and is properly charged.
- Ensure the headset is paired with your mobile handset.
- Ensure your mobile handset's Bluetooth feature is activated. Please refer to your mobile handset user guide for specific instruction.
- Ensure the headset is within a maximum of 10 metres of your mobile handset and there are no obstructions, such as walls or other electronic devices in between.

If the above steps do not solve your problem, please recharge the headset and remove your mobile handset's battery for a while.

The i.Tech Arrow II Headset is compliant with and adopts the Bluetooth Specification 1.2. However, interoperability between the device and other Bluetooth-enabled products is not guaranteed because it depends on compatibility. For more information on the compatibility between the device with other Bluetooth-enabled products, please check with the manufacturer or browse

<http://www.itechdynamic.com>

## Charging Your Headset

The Headset comes with a built-in rechargeable battery. Prior to using the headset for the first time, it is recommendable to charge the battery fully.

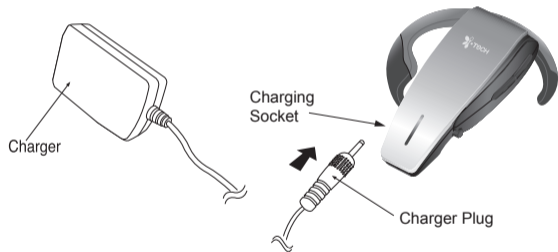

(Fig. 2)

## Charging Your Headset

Connect the charger to an AC wall outlet and the charger plug to the headset's charging socket (fig.2). The **LED** will be red while charging.

**IMPORTANT** Charging indication will be delayed for a few seconds if the headset has not been used for a long time or the battery is drained.

### Normal Charging Time

It takes about three hours to fully charge the battery. When the battery is fully charged, the **LED** will turn blue and remains on. Disconnect the charger from AC wall outlet and the headset. Press and hold the MFB (fig.1) to turn the headset on, please refer to "Turning Your Headset On and Off".

### Talk & Standby Time

The fully charged battery offers up to 6 hours talk time and up to 200 hours standby time. When no calls are in progress, the headset remains turned on in standby mode.

### Low Battery

When the headset is on and the battery becomes low, the status indicator flashes red and the headset emits a beep every 1 minute. Please recharge the battery as described above.

## Safety Information

- Check local laws regarding use of a mobile handset and headset while driving. If you use the headset while driving, ensure your attention and focus remains on the road. It is your responsibility to drive safely.
- Never allow children to play with the headset - small parts may be a choking hazard.
- Observe all signs that require an electrical device or RF radio product to be switched off in designated areas. These could include hospitals, blasting areas, and potentially explosive atmospheres.
- Turn off your headset prior to boarding an aircraft. Do not use your headset inside an aircraft.
- Never mount or store your headset over any air bag deployment area as serious injury may result when an air bag deploys.
- Do not open or mutilate the built-in battery.
- Dispose of batteries according to local regulations. Do not dispose as household waste.
- Dispose of the packaging and this product in accordance with the latest provisions.

### Built-in Battery

- Do not attempt to replace the headset's battery yourself as it is built-in and is not changeable
- Charge the battery in accordance with the instructions supplied with this user guide.
- Only use the manufacturer supplied charger when charging the headset.

### Charger

- Only use the manufacturer supplied charger when charging the headset.
- Do not disassemble the charger as it may expose you to dangerous voltages or other risks. Incorrect reassembly can cause electric shock when the headset is subsequently used.
- Do not use the charger outdoors or in damp areas.
- Only charge the headset's built-in battery in accordance with the instructions in this user guide.
- Avoid charging the headset in extremely high and low temperatures.

## Turning Your Headset On and Off

### Turning On the Headset

Press and hold the MFB (Fig.1) until you hear a short beep. The status indicator will start flashing blue.

**IMPORTANT** Press the MFB again each time you turn on the headset to reactivate pairing so that the connection between the headset and the mobile handset is resumed. For pairing, please refer to "Pairing Your Headset" on page 6-7.

### Turning Off the Headset

Press and hold the MFB (Fig. 1) until you hear a long beep. The Status indicator will stop flashing.

**IMPORTANT** To disconnect the Bluetooth connection, please firstly turn off your headset by pressing the MFB.

## Pairing Your Headset

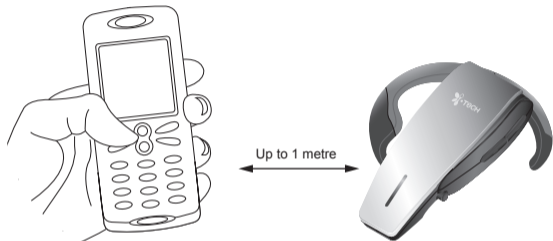

Prior to using your headset for the first time, you must pair it with a Bluetooth-enabled mobile handset.

The information on the next page describes pairing instruction for a typical Bluetooth-enabled mobile handset. Headset pairing procedure is subject to different models of mobile handsets.

## Care and Maintenance

### Headset

- Consider turning your headset off before placing it in your pocket or bag. If the **MFB** is accidentally depressed, your mobile handset may place an unintended call.
- Do not expose the headset to liquid, moisture or humidity as it is not waterproof.
- Do not use abrasive cleaning solvents to clean the headset.
- Do not expose the headset to extremely high or low temperatures.
- Do not dispose of the headset in a fire as it will result in an explosion.
- Do not bring your headset into contact with sharp objects as this will cause scratches and damage.
- Do not stick anything inside the headset as this may damage internal components.
- Do not attempt to disassemble the headset as it does not contain serviceable components.
- If you do not use the headset for long periods, be sure to store it in a dry place, free from extreme temperatures and dust.



## Adjusting the Volume

Press the **Volume Key** repeatedly until you reach the desired volume level.



## Resetting / Removing the Pairing

You may want to reset the headset to its original settings. This also clears all current pairings.

1. Ensure the headset is OFF.
2. Press and hold one of the **Volume Key's** until the status indicator alternately flashes blue and red rapidly.
3. Release the **Volume Key**.
4. Press and hold one of the **Volume Key's** again until you hear 2 beeps.
5. Recharge the headset for a few seconds.

The headset is turned off and returns to the original settings. All current pairings are cleared.

## Pairing Your Headset

1. Place the headset and the mobile handset where they are easily viewable and no more than 1 metre apart.
2. Ensure the headset is OFF. (No flashing on the Status Indicator).
3. Press and hold the **MFB (Fig. 1)** until the headset status indicator alternately flashes blue and red.
4. Activate your mobile handset's Bluetooth function by referring to your mobile handset user guide for details.
5. Set the mobile handset to search for Bluetooth devices within 1 metre as instructed in the mobile handset user guide and select "i.Tech Arrow II" from the list.
6. Enter the pre-programmed passkey "0000" and press "OK" to pair your headset and mobile handset. When the pairing is completed, the headset **status indicator** will flash blue rapidly for 5 times followed by a long beep.
7. Go back to your mobile handset's main menu. For certain mobile handset models, a headset icon will be shown on the screen. You should now be able to make and receive calls using your headset.

**IMPORTANT** If the pairing cannot be completed within 2 minutes while the pairing mode is activated, the headset status indicator flashes purple red with 3 beeps and the headset is turned off. Please repeat Steps 2 to 7 to pair the headset and the mobile handset again.

## Using Your Headset

### Answering a Call

When there is an incoming call, you will hear ringing through the speaker. Press the **MFB** to accept the call or answer the call via your mobile handset in the normal way.

### Ending a Call

Press the **MFB** to end your call or end the call via your mobile handset in the normal way.

### Rejecting a Call

To reject an incoming call during ringing of the headset, press and hold one of the **Volume Keys** for 2 seconds until you hear 2 beeps.

### Dialing from Your Mobile Handset

Simply make calls on your mobile handset in the normal way.

## Using Your Headset

### Voice Dialling from Your Headset

If your mobile handset is equipped with a voice dialling function, simply press the **MFB** on your headset and when you hear a beep, say the voice tag.

**IMPORTANT** Please make sure to record voice tags into the mobile handset first before using voice dialling function.

### Last Number Redialling from Your Headset

Press the **MFB** on your headset twice.

**IMPORTANT** The above functions are only applicable to mobile handsets with Bluetooth Handsfree Profile. Functionality varies depending on the mobile handset model you have. Please refer to your mobile handset user guide for additional information.