

Weather Station
with FM PLL Radio
Model: BARM688

USER MANUAL

CONTENTS

Introduction	2	Temperature	7
Overview	2	Radio	7
Front View.....	2	Sleep Timer	7
Back View	2	Backlight	8
LCD.....	3	Reset	8
Remote Sensor.....	3	Precautions	8
Getting Started	4	Specifications	9
Adapter	4	About Oregon Scientific	9
Batteries.....	4	EU-Declaration of Conformity	9
Remote Sensor	4		
Sensor Data Transmission.....	5		
Light Touch Key-Lock	5		
Clock	6		
Clock Reception.....	6		
Manually Set Clock.....	6		
Alarm	6		
Weather Forecast	7		

INTRODUCTION

Thank you for selecting the Oregon Scientific™ Weather Station with FM PLL Radio. Please keep this manual for instructions and information you should know about.

OVERVIEW

FRONT VIEW



1. **SNOOZE:** Activate snooze; set sleep-timer when Radio is ON
2. **RADIO:** Turn radio ON / OFF
3. **VOL ▲ / ▼:** Increase / decrease volume

4. **(STATION):** Toggle between 8 preset radio channels; save a channel
5. **MODE:** Change setting / display
6. **TUNE ▲ / ▼:** Increase / decrease setting; activate / deactivate clock reception signal; change radio frequency
7. **ALARM:** View alarm status; set alarm

BACK VIEW

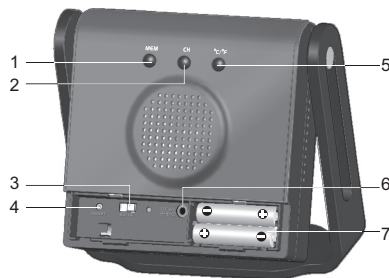

1. **MEM:** View current, maximum and minimum temperature
2. **CH:** Switch remote sensor display
3. **EU / UK:** Select clock signal
4. **RESET:** Reset unit to default settings
5. **°C / °F:** Select temperature unit
6. Adapter socket
7. Battery compartment

LCD

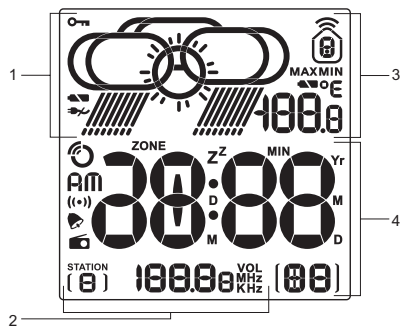

1. Weather forecast area
2. Radio area
3. Temperature area
4. Clock / alarm area

REMOTE SENSOR

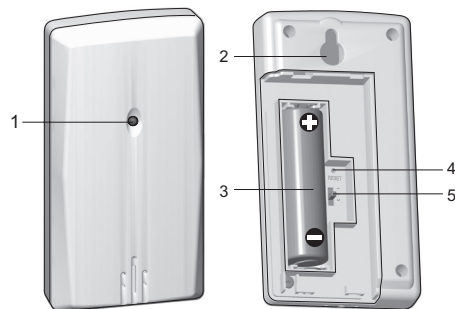

1. LED transmission indicator
2. Wall mount
3. Battery compartment
4. **RESET** switch
5. **CHANNEL** switch

GETTING STARTED

ADAPTER

Plug adapter into main unit. Make sure the adapter socket is easily accessible to the unit.

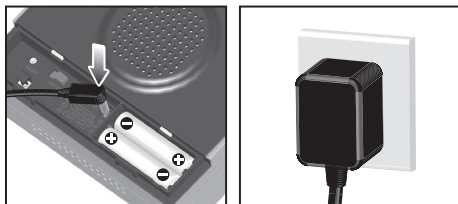

 shows when the adapter is not connected.

NOTE This product may malfunction when radio interference appears on the AC power line. The unit will revert to normal operation when interference stops.

BATTERIES

Insert the batteries, matching the polarities (+/-) as shown.

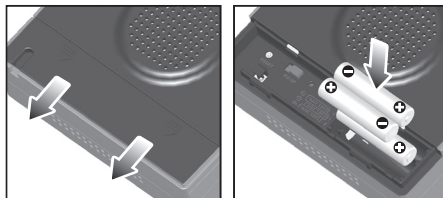

 shows when the battery is low.

UNIT	 LOCATION
Main	Weather forecast area
Remote	Temperature area

REMOTE SENSOR

The main unit can collect data from up to 3 sensors.

To set up the sensor:

1. Open the battery compartment.
2. Insert battery, matching the polarity (+ / -).
3. Select a channel, then press **RESET**.
4. Close the battery door.

5. Place the sensor within 30 m (98 ft) of the main unit using the table stand or wall mount.

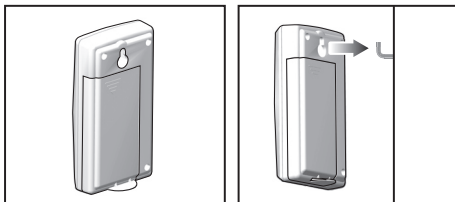

The transmission range may vary depending on many factors. You may need to experiment with various locations to get the best results.

NOTE We recommended that you use alkaline batteries with this product for longer usage and consumer grade lithium batteries in temperatures below freezing.

SENSOR DATA TRANSMISSION

To search for a sensor:

Simultaneously, press and hold **MEM** and **CH** for 2 seconds.

The reception icon shown in the outdoor temperature area shows the status.

ICON	DESCRIPTION
	Main unit is searching for the sensor(s)
	Sensor 1 data received
	The sensor cannot be found

NOTE If the sensor is not found, check the batteries, obstructions, and remote unit location.

For best results:

- Place the sensor out of direct sunlight and moisture.
- Position the sensor facing main unit, minimizing obstructions.
- Place the sensor in a location with a clear view to the sky, away from metallic or electronic objects.
- Position the sensor close to the main unit during cold winter months.

LIGHT TOUCH KEY-LOCK

When no key has been pressed for 1 minute,  appears to indicate key-lock is activated. Press any key to disable.

CLOCK

CLOCK RECEPTION

This product is designed to synchronize its clock automatically with a clock signal.

To select clock signal:

Slide **EU / UK** to select the signal received.

- EU: DCF-77 signal: within 1500 km (932 miles) of Frankfurt, Germany.
- UK: MSF-60 signal: within 1500 km (932 miles) of Anthorn, England.

To enable / disable signal reception:

Press and hold **TUNE** ▲ to enable or **TUNE** ▼ to disable signal reception.

NOTE Reception takes 2-10 minutes. If the signal is weak, it can take up to 24 hours to get a valid signal.

Clock signal reception indicator:

STRONG SIGNAL	WEAK SIGNAL	NO SIGNAL
		

MANUALLY SET CLOCK

1. Press and hold **MODE** for 2 seconds.
2. Press **TUNE** ▲ / ▼ to change the settings.

3. Press **MODE** to confirm.
4. The setting sequence is: time zone offset, 12 / 24 hour format, hour, minute, year, day / month format, month, day, and display language.

TIPS Time zone offset sets the clock +/- 23 hours from the received clock signal time. The language options are (E) English, (F) French, (D) German, (I) Italian, and (S) Spanish.



To select clock display mode:

Press **MODE** to toggle between:



- Clock with seconds
- Clock with weekday
- Calendar

ALARM

To set the alarm:

1. Press **ALARM** to view the alarm. ((•)) will show on the display.
2. Press and hold **ALARM** for 2 seconds.
3. Press **TUNE** ▲ / ▼ to change the hour, minute, beep () or radio () alarm. If you select the radio alarm, press  to select the radio station to be played and **VOL** ▲ / ▼ to set the volume.
4. Press **ALARM** to confirm.

To activate or deactivate the alarm:





Press **ALARM** when in alarm display.  or  appears when the alarm is set.

To silence the alarm:

- Press **SNOOZE** to silence it for 8 minutes.
- OR
- Press any key except **SNOOZE** to turn the alarm off and activate it again after 24 hours.

WEATHER FORECAST

This product forecasts the weather for the next 12 to 24 hours within a 19-31 mile (30-50 km) radius, with 70 to 75 percent accuracy.

SUNNY	PARTLY CLOUDY	CLOUDY	RAINY
			

TEMPERATURE**To select temperature unit:**

Press **°C** / **°F**.

To view outdoor sensor(s) temperature readings:

Press **CH**.  shows which remote sensor's data you are viewing.

To auto-scan between sensors:

Press and hold **CH** for 2 seconds. Each sensor's data is displayed for 3 seconds.

To end, press **CH** or **MEM**.

To toggle between current, minimum and maximum records for the selected sensor:

Press **MEM** repeatedly.

To clear the records:

Select the channel to clear the memory, then press and hold **MEM** for 2 seconds. The indoor memory record will also be cleared.

RADIO





You can save up to 8 radio stations.

To turn the Radio ON / OFF:

Press **RADIO**.

NOTE Plug in the adapter when using the radio.

To save a station:

1. Press **RADIO** to turn the radio **ON**.
2. Press **TUNE**  /  to manually fine-tune or press and hold **TUNE**  /  to activate auto-search.
3. Press and hold  to save the station.

SLEEP TIMER**To turn the sleep timer ON:**

1. Press **SLEEP** once to activate the last setting used.

2. Press **SLEEP** to set radio sleep timer duration (120, 90, 60, 30, 15 or 0 minutes). Select "0" to disable the sleep timer.
3. Press **VOL** ▲ / ▼ to change the volume.

NOTE "Z" flashes when the sleep timer is activated.

BACKLIGHT

To activate the backlight for 8 seconds:

Press any key.

To activate / deactivate continuous backlight:

Press and hold **SNOOZE** for 2 seconds.

RESET

Press **RESET** to return to the default settings.

PRECAUTIONS

- Do not subject the unit to excessive force, shock, dust, temperature or humidity.
- Do not cover the ventilation holes with any items such as newspapers, curtains etc.
- Do not immerse the unit in water. If you spill liquid over it, dry it immediately with a soft, lint-free cloth.
- Do not clean the unit with abrasive or corrosive materials.
- Do not tamper with the unit 's internal components. This invalidates the warranty.

- Only use fresh batteries. Do not mix new and old batteries.
- Images shown in this manual may differ from the actual display.
- When disposing of this product, ensure it is collected separately for special treatment.
- Placement of this product on certain types of wood may result in damage to its finish for which Oregon Scientific will not be responsible. Consult the furniture manufacturer's care instructions for information.
- The contents of this manual may not be reproduced without the permission of the manufacturer.
- Do not dispose old batteries as unsorted municipal waste. Collection of such waste separately for special treatment is necessary.
- Please note that some units are equipped with a battery safety strip. Remove the strip from the battery compartment before first use.

NOTE The technical specifications for this product and the contents of the user manual are subject to change without notice.

SPECIFICATIONS

TYPE	DESCRIPTION
Main unit	
Dimensions (L x W x D)	145 x 134.5 x 55 mm (5.7 x 5.3 x 2.2 in)
Weight	300g (10.6 ounces) without battery
Indoor range	-5°C to 50°C (23°F to 122°F)
Resolution	0.1°C (0.2°F)
Synchronization	Auto or disabled
Power	6V adapter and/or 3 x UM-4 (AAA) batteries
Remote unit (THN132N)	
Dimensions (L x W x D)	92 x 22 x 50 mm (3.6 x 0.9 x 2.0 in)
Weight	46 g (1.62 lbs) without battery
Temperature range	-30°C to 60°C (-22°F to 140°F)
Channel no.	1, 2 or 3
Power	1 x UM-3 (AA) 1.5V battery

ABOUT OREGON SCIENTIFIC

Visit our website (www.oregonscientific.com) to learn more about Oregon Scientific products. If you're in the US and would like to contact our Customer Care department directly, please visit:

<http://www2.oregonscientific.com/service/default.asp>
OR

Call 1-800-853-8883.

For international inquiries, please visit:

www2.oregonscientific.com/about/international.asp

EU-DECLARATION OF CONFORMITY

Hereby, Oregon Scientific, declares that this Weather Station (model: BARM668) is in compliance with the essential requirements and other relevant provisions of Directive 1999/5/EC. A copy of the signed and dated Declaration of Conformity is available on request via our Oregon Scientific Customer Service.



COUNTRIES RTTE APPROVAL COMPLIED

All EU countries, Switzerland 
and Norway 