



# MODEL G2527

## 1/3 HP ELECTRIC MOTOR

### INSTRUCTION SHEET

#### Model G2527 Specifications

Power ..... 1/3 HP  
 Cycle.....60Hz  
 Voltage .....110/220V  
 Rewired ..... 110V  
 Amps .....5.3/2.7A  
 RPM..... 1725  
 Phase ..... Single  
 Class..... E  
 Start Capacitor .....200MFD 125VAC  
 Dimensions..... 1 1/2"D x 2 3/8"L

#### Electrical Safety

If you are unsure how to attach wires to terminals, DO NOT continue. Contact a qualified electrician for assistance. Connecting wires improperly may cause them to come loose or contact other wires, which can cause electrocution, fire, or a short.

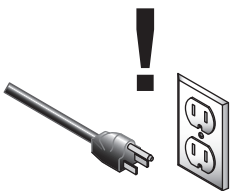

**⚠️ WARNING**  
 Disconnect power when replacing motor. Failure to do this may result in serious personal injury.



**⚠️ WARNING**  
 Electrocution or fire could result if this motor is not grounded correctly or if your wire connections do not comply with local and state codes. Ensure compliance by checking with a qualified electrician!

#### Replaceable Parts

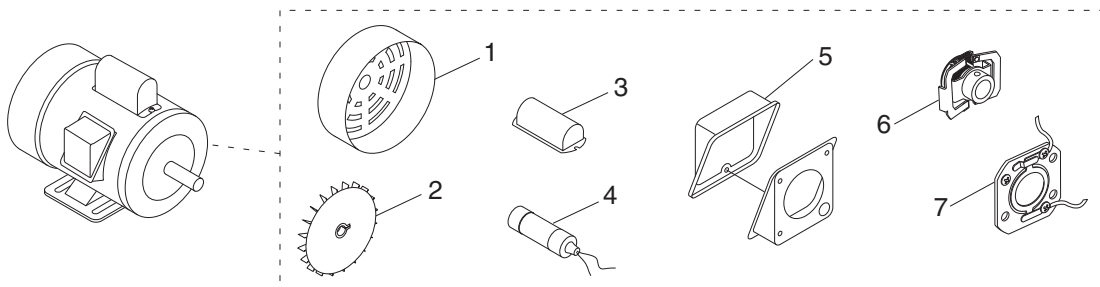

REF	PART #	DESCRIPTION
1	P2527001	MOTOR FAN COVER
2	P2527002	MOTOR FAN
3	P2527003	S CAPACITOR COVER
4	PC200C	S CAPACITOR 200M 125V 1-1/2 X 2-3/8

REF	PART #	DESCRIPTION
5	P2527005	JUNCTION BOX
6	P2527006	CENTRIFUGAL SWITCH
7	P2527007	CONTACT PLATE

COPYRIGHT © DECEMBER, 2007 BY GRIZZLY INDUSTRIAL, INC.  
**WARNING: NO PORTION OF THIS INSTRUCTION SHEET MAY BE REPRODUCED IN ANY SHAPE OR FORM WITHOUT THE WRITTEN APPROVAL OF GRIZZLY INDUSTRIAL, INC.**  
 #JB10228 PRINTED IN TAIWAN

# G2527 Wiring Diagram

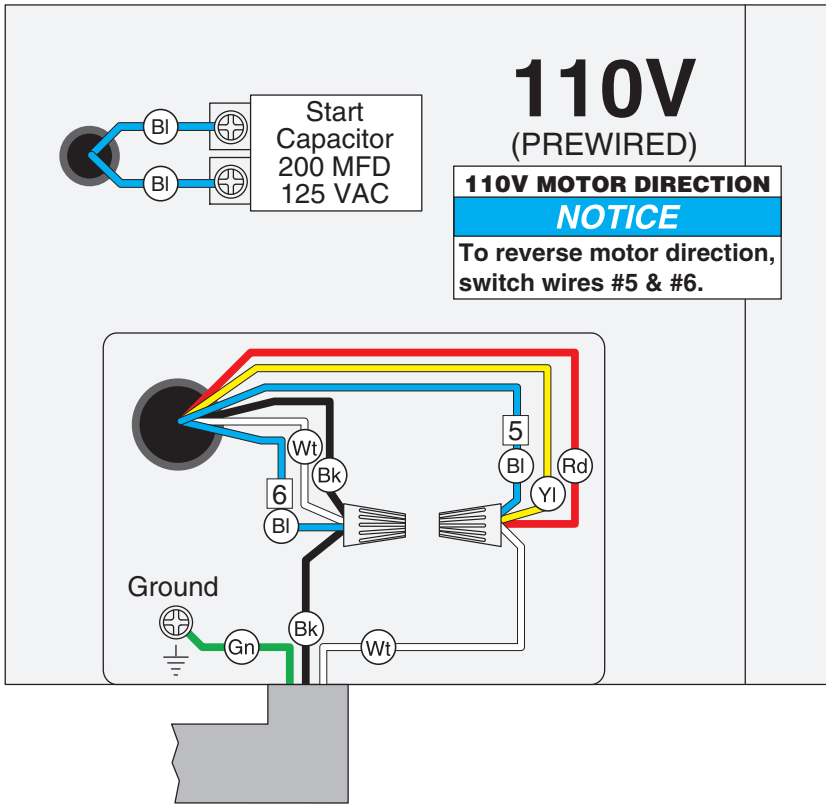

View this page in color at [www.grizzly.com](http://www.grizzly.com).

**COLOR KEY**

BLACK	Bk
WHITE	Wt
GREEN	Gn
RED	Rd
YELLOW	Yl
BLUE	Bl

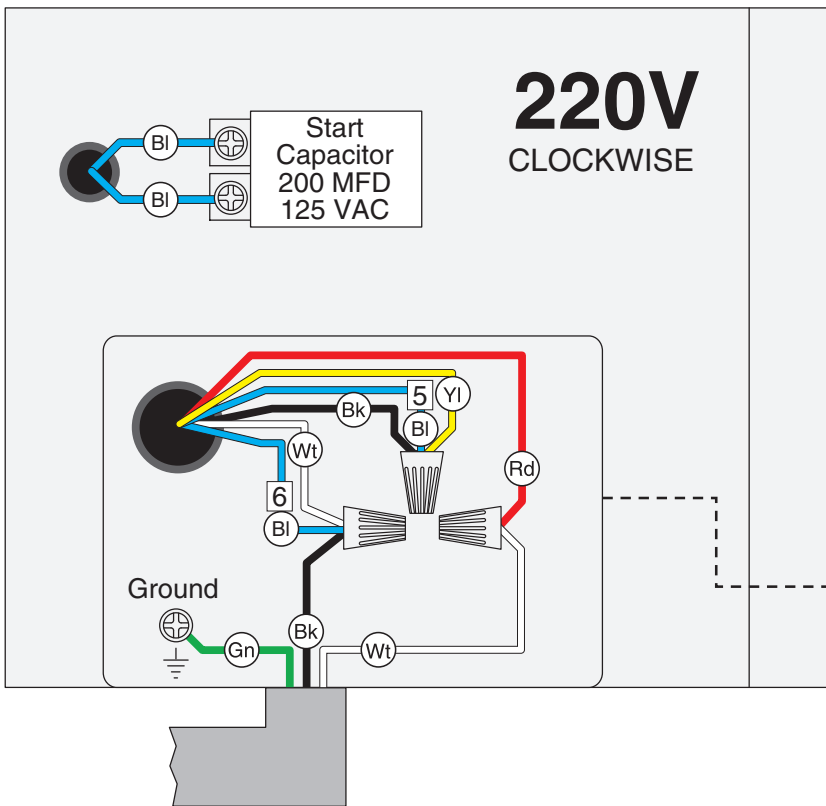

**NOTICE**  
The motor wiring shown here is current at the time of printing, but it may not match your machine. Always use the wiring diagram inside the motor junction box.

