

# 48 inch Farm Jack

## Item 06530



### Specifications

Lifting capacity:	7000 lb (3175 kg) (rating established at a height of 1 ft)
Maximum height:	48 in (122 cm)
Minimum height:	6 in (15 cm)
Net weight:	30 lb (14 kg)

Read these instructions before using the tool, and refer to them as needed while using the tool. Store this manual in a safe, dry place, and keep it for future reference. Keep your invoice with this manual, and write the invoice number on the inside front cover of this manual.

---

General safety instructions .....	page 2
Safely operating the tool.....	page 2
Before using the Farm Jack.....	page 3
Lifting a load .....	page 4
Lowering a load .....	page 5
Maintaining the Farm Jack .....	page 5
Exploded view .....	page 6
Parts list.....	page 7

---

**Distributed exclusively by Harbor Freight Tools®**

3491 Mission Oaks Blvd., Camarillo, CA 93011

Copyright 1997 by Harbor Freight Tools®. All rights reserved. No portion of this manual or any artwork contained herein may be reproduced in any shape or form without the express written consent of Harbor Freight Tools.

For technical questions and replacements, call 1-800-444-3353

Item 06530 - September 1997 REV 07i

## General safety instructions

---

**WARNING:** When using tools, basic safety precautions should always be followed to reduce the risk of personal injury.

---

- **Read all instructions before using this tool.**
- **Keep your work area clean.** Cluttered areas invite injuries.
- **Consider your work environment.** Do not use the jack in damp, wet, or poorly lit locations. Keep your work area well lit. Do not expose the jack to rain.
- **Be aware of other people.** Do not use the tool near children or animals. Keep children and animals away. Keep all visitors (including children and animals) away from the work area. Do not let visitors handle tools.
- **Do not operate the tool if you are under the influence of alcohol or drugs.** Read warning labels on prescription and non-prescription medications to determine if a medication impairs your judgment or reflexes. If you have any doubts, do not attempt to use the tool.
- **Stay alert.** Pay attention to what you are doing, and use common sense. Do not operate the tool when you are tired.
- **Dress properly.** Do not wear loose clothing or jewelry. They can be caught in moving parts. Gloves and non-skid footwear are recommended when working outdoors. Wear protective hair covering to contain long hair.
- **Use safety glasses.** To prevent eye injuries, the tool operator and all persons in the work area must wear safety glasses with permanently attached, rigid, plastic, side shields. These safety glasses must conform to ANSI 287.1 requirements.
- **Do not alter the tool.** Any alterations or modifications to this tool may result in dangerous conditions. Remember this tool is precision built to perform specific operations. Any alterations will void the warranty.

## Safely operating the tool

---

**WARNING:** When using the Farm Jack, these safety precautions also should be followed to reduce the risk of personal injury.

---

- **Do not overreach.** Keep proper footing and balance at all times.
- **Do not over-extend or over-work the tool.** The tool does a better and safer job at the rate for which it was intended.

**Write your invoice number here:** \_\_\_\_\_

- **Use the correct tool.** Do not force a small tool or an attachment to do the work of a larger industrial tool. Do not use a tool for a purpose for which it was not intended.
- **Never stand on the tool.** Standing on the tool could cause an injury if the tool is tipped.
- **Inspect the tool.** Before using the tool, check for damaged parts. A damaged handle or other part should be carefully checked to determine if it will keep the tool from operating properly and performing its intended function. Check for alignment and binding of moving parts, broken parts, mounting, and other conditions that may affect its operation.
- **Maintain tools with care.** Keep tools clean for better and safer performance. Follow the instructions for lubricating, cleaning, and replacing parts and accessories. Keep handles dry, clean, and free from oil and grease.
- **Use proper replacement parts.** When servicing the tool, only use identical replacement parts.
- **Store tools not being used.** When tools are not being used, store them in a dry and high or locked place—out of children’s reach.

## Before using the Farm Jack

---

**CAUTION:** Improperly using this jack is highly hazardous. Read these instructions before using the jack.

---

Make sure to:

- Visually inspect the jack. Check that all moving parts mate correctly and that no visible cracks or bends are present on the handle or rail.
- Stabilize the load to be lifted because the Farm Jack does not stabilize the load.
- Keep all visitors and children clear of the load being raised, lowered, or pulled.

Important: Do not use a handle extender. All warranties are void if an extender is used on the handle.

## Lifting a load

### CAUTION:

(Refer to Step 5)  
Dynamic Loading may under certain circumstances create a situation where the actual weight being held or lifted is far in excess of jack or bolt capacity. DO NOT drop weight onto the lifting nose, or allow sudden motion of the jack lifting nose, as this may shear the 1/2" bolt or cause the jack to fail.

Refer to figure 1 while following these steps:

- Step 1.** Place the jack on a stable area to prevent shifting or slipping.
- Step 2.** Put the reversing switch in the up position to raise loads.
- Step 3.** Place the jack's lifting nose completely under the object you want to lift. The ratcheting mechanism lets the lifting nose rise, saving you from having to pump the handle.
- Step 4.** Slowly pump the handle to raise the load. Always keep a firm grip on the handle while operating the jack.
- Step 5.** After the load is raised to the desired height, insert the 1/2 inch bolt (sold separately) through the hole in the steel rail immediately below the lifting mechanism.
- Step 6.** Insert additional supports to make sure the load is properly supported at the lift point to prevent shifting.

**Figure 1 - Lifting and lowering loads with the Farm Jack**

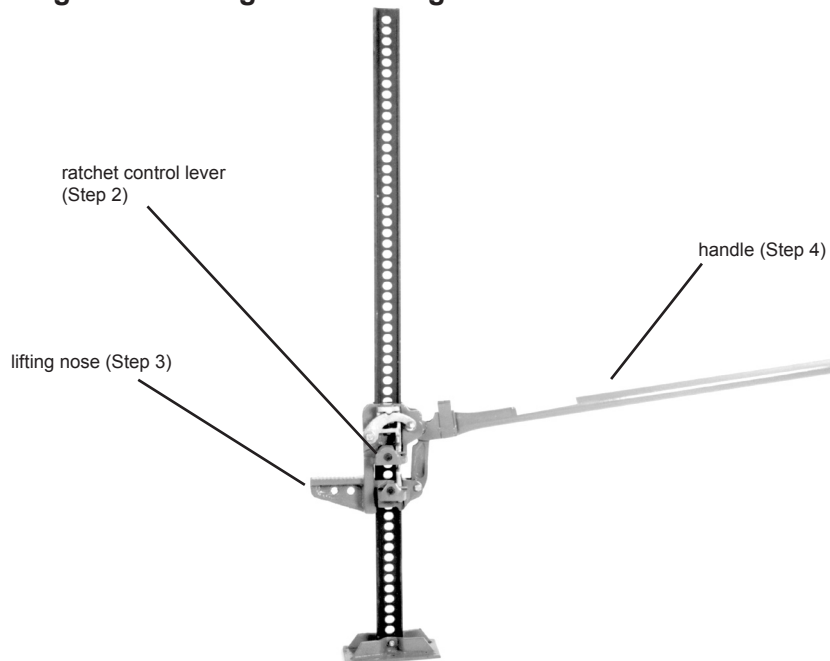

**CAUTION:** Follow these precautions while working with raised loads:

- Never work under a raised load.
- Never push a lifted load off the jack.
- Never attempt to repair the jack when it is under a load.

## Lowering a load

---

**WARNING:** When using tools, basic safety precautions should always be followed to reduce the risk of personal injury.

---

**Step 1.** Put the handle in the upright position before tripping the reversing latch to lower the load.

**Step 2.** Place the reversing switch in the down position.

**Step 3.** Slowly pump the handle to lower the load.

Note: To lower loads one raised level at a time, the jack must be loaded with 110 lb (50 kg) or more. Otherwise, the lifting nose will drop.

## Maintaining the Farm Jack

- Keep the jack clean and oiled. The front and back of the rail must be kept rust free.
- If any part of the jack fails, do not use until it is completely repaired and checked by a professional.

# Exploded view

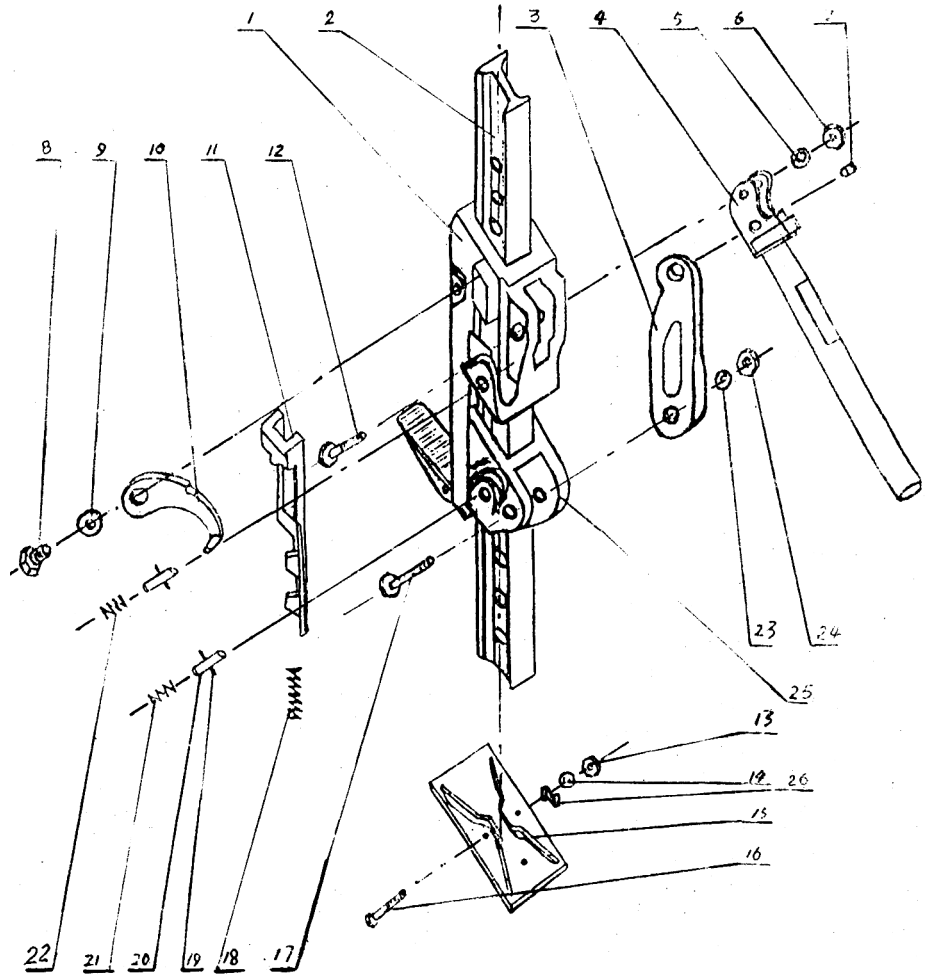

<b>No.</b>	<b>Name</b>	<b>Quantity</b>
1	Large Runner	1
2	Steel Bar	1
3	Connecting Rod	1
4	Rocker	1
5	Washer	1
6	Nut	1
7	Pin	1
8	Screw	1
9	Washer	1
10	Reversing Latch	1
11	Reversing Switch	1
12	Screw Bolt	1
13	Nut	1
14	Washer	1
15	Base	1
16	Screw Bolt	1
17	Screw Bolt	1
18	Spring	1
19	Pin	2
20	Reverse Rod	2
21	Spring	1
22	Spring	1
23	Washer	1
24	Nut	1
25	Small Runner	1
26	Spring Washer	1