

banks

with Installation Instructions
Owner's Manual

**Banks Split-Dual
Monster[®]
Exhaust System
Quad-Tip**

**2008 Ford Power Stroke 6.4L
Turbo-Diesel F250/F350 Trucks**

THIS MANUAL IS FOR USE WITH SYSTEM 49786 & 49787

Gale Banks Engineering
546 Duggan Avenue • Azusa, CA 91702
(626) 969-9600 • Fax (626) 334-1743

Product Information & Sales: (800) 438-7693
Customer Support: (888) 839-5600

bankspower.com

BANKS

General Installation Practices

Dear Customer,

If you have any questions concerning the installation of your Banks Power System, please call our Technical Service Hotline at (888) 839-2700 between 7:00 am and 5:00 pm (PT). If you have any questions relating to shipping or billing, please contact our Customer Service Department at (888) 839-5600.

Thank you.

- 1.** Before starting work, familiarize yourself with the installation procedure by reading all of the instructions.
- 2.** The exploded view (**Figure 1**, pages 4-5) provides only general guidance. Refer to each step and section diagram in this manual for proper instruction.
- 3.** Throughout this manual, the left side of the vehicle refers to the driver's side, and the right side to the passenger's side.
- 4.** Disconnect the negative (ground) cable from the battery (or batteries, if there are two) before beginning work.

5. Route and tie wires and hoses a minimum of 6" away from exhaust heat, moving parts, and sharp edges. Clearance of 8" or more is recommended where possible.

6. When raising the vehicle, support it on properly weight-rated safety stands, ramps or a commercial hoist. Follow the manufacturer's safety precautions. Take care to balance the vehicle to prevent it from slipping or falling. When using ramps, be sure the front wheels are centered squarely on the topsides. When raising the front of the vehicle, put the transmission in park (automatic) or reverse (manual), set the parking brake, and block the rear wheels. When raising the back of the vehicle, be sure the vehicle is on level ground and the front wheels are blocked securely.

Caution! Do not use floor jacks to support the vehicle while working under it. Do not raise the vehicle onto concrete blocks, masonry or any other item not intended specifically for this use.

7. During installation, keep the work area clean. Do not allow anything to be dropped into intake, exhaust, or lubrication system components while performing the installation, as foreign objects will cause immediate engine damage upon start-up.

Tools Required:

- 1/2" and 3/8" drive ratchets with inch and metric sockets and 1/2" and 3/8" drive extension
- Inch and metric combination or open-end wrenches
- Standard screwdriver
- Clean shop towels or rags
- Pry-bar
- Reciprocating saw

Highly recommended tools and supplies:

- Foot-pound torque wrench
- Penetrating oil or light lubricant spray

Figure 1

General Assembly Diagram

Item	Description	P/N	Qty.
1	Intermediate Pipe	53990	1
*2	Intermediate Pipe Extension	53987	1
3	Y-Pipe	53993	1
4	Tail Pipe, Left	53994	1
5	Tail Pipe, Right	53995	1
6	Exhaust Clamp, 3.5"	52468	3
*7	Exhaust Clamp, 4"	52470	1
*8	Hanger Clamp, Intermediate	53986	1
9	Hanger Clamp, Rear	53989	1
10	Frame Hanger Bracket	53566	1
11	Nylock Nuts, 7/16"-20	91617	2
12	Washers, 7/16"	91603	4
13	Hex Bolt, 7/16"-20 x 1"	91627	2
14	Rubber Insulator	53732	1
15	Black 5" Cable Tie	62001	3
16	Banks Urocals	96009	2

* For Crew Cab Long Bed only

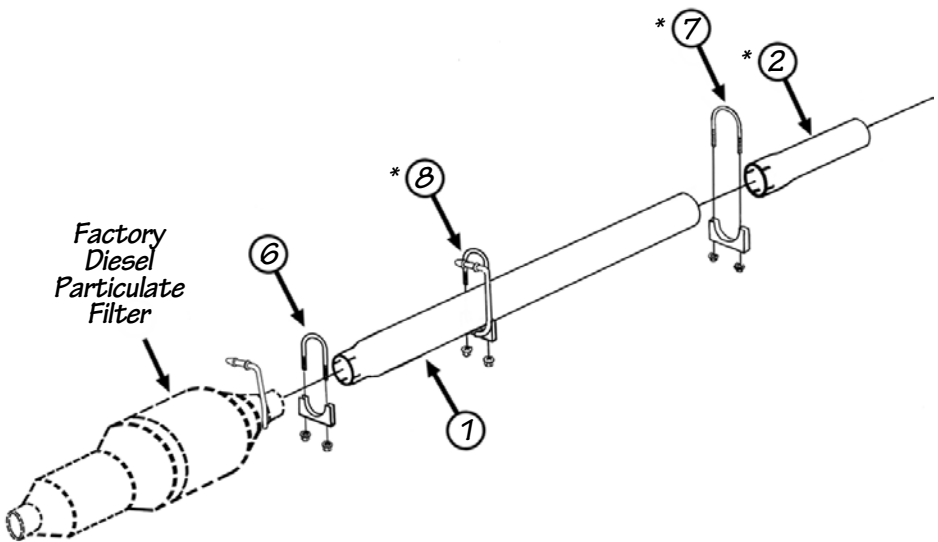

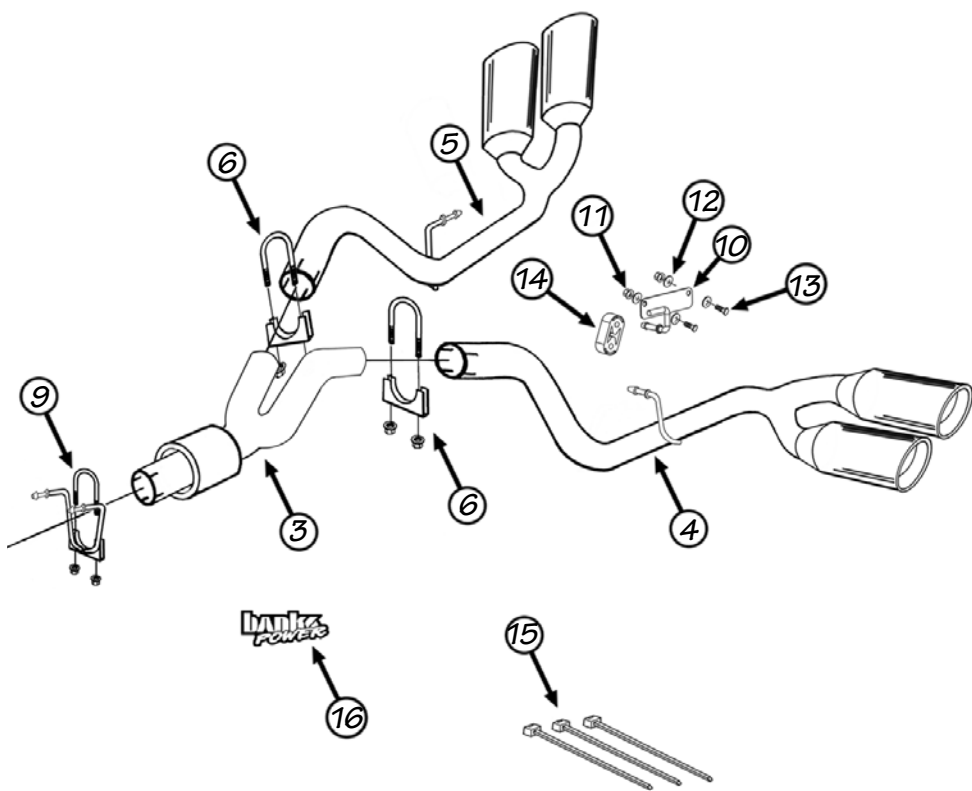

Monster Exhaust System Installation

1. As a precaution, disconnect the ground of the battery (if there is more than one battery, disconnect both).
2. Raise the vehicle and support it with properly weight rated safety stands, ramps or a commercial hoist. Follow the manufacturer's safety precautions. Take care to balance the vehicle to prevent it from slipping or falling. When using ramps, be sure the front wheels are centered squarely on the topsides; place the transmission in park; set the parking brake and place blocks behind the rear wheels.

CAUTION: DO NOT WORK UNDER ANY VEHICLE SUPPORTED ONLY BY A JACK. SEVERE INJURY MAY RESULT.

WARNING! The following step may require the use of a torch and/or saw. Proper safety equipment should be used. Failure to use proper safety equipment may result in severe injury.

3. Starting at the rear of the vehicle, remove the tailpipe near the intermediate pipe clamps by cutting through the connection or by removing the clamps and heating the joints with an oxy-acetylene torch to allow crimped pipes to separate. Remove the tailpipe from the vehicle.
4. Remove the clamps on the Diesel Particulate Filter to intermediate pipe. **TAKE CAUTION TO NOT CUT OR DAMAGE DIESEL PARTICULATE FILTER TUBING DURING THE REMOVAL PROCESS.** Separate the intermediate pipe to Diesel Particulate Filter connection.

Note: the use of an oxy-acetylene torch may be necessary. Remove the intermediate pipe hanger pins from the rubber hangers with a pry bar (Spray lubricant will ease hanger removal) and remove the intermediate pipe assembly from the vehicle.

5. Locate the supplied intermediate pipe and cut the intermediate pipe based on the following configurations. See **Table 1**. Cut the NON-swaged end of the intermediate pipe. See **Figure 2**.

6. Install a 3½" exhaust clamp onto the front of the Banks intermediate pipe. Install the intermediate pipe onto the Diesel Particulate Filter outlet. Loosely snug the 3½" clamp.

7. For Crew Cab Long Bed Models Only, all other models skip to step 9.

Slide the supplied hanger clamp onto the intermediate pipe. Insert the hanger pin into the factory rubber hanger. See **Figure 1**.

8. Locate the supplied intermediate pipe extension. Install supplied 4" exhaust clamp onto the inlet of the pipe extension. Install extension pipe onto the intermediate pipe and loosely snug the exhaust clamp.

9. Install the rear hanger clamp onto the intermediate pipe outlet with the hanger pins facing the front of the vehicle. Insert the two (2) hanger pins into the rear rubber hangers and adjust the hanger clamp to a position that best supports the intermediate pipe. (see **Figure 3**).

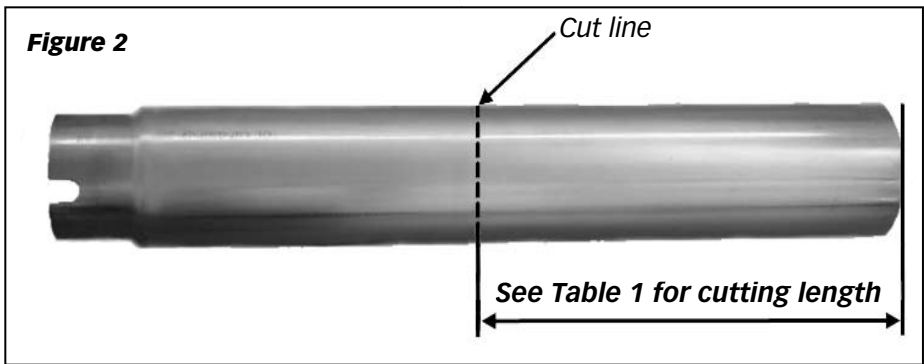

Table 1

2008 Ford Power Stroke 6.4L		
	Wheel Base	Cut this length from the Intermediate Pipe. See Figure 2 .
Super Cab/ Short Bed	141.8"	20"
Crew Cab/ Short Bed	156.2"	No Cut
Crew Cab/ Long Bed	172.4"	No Cut

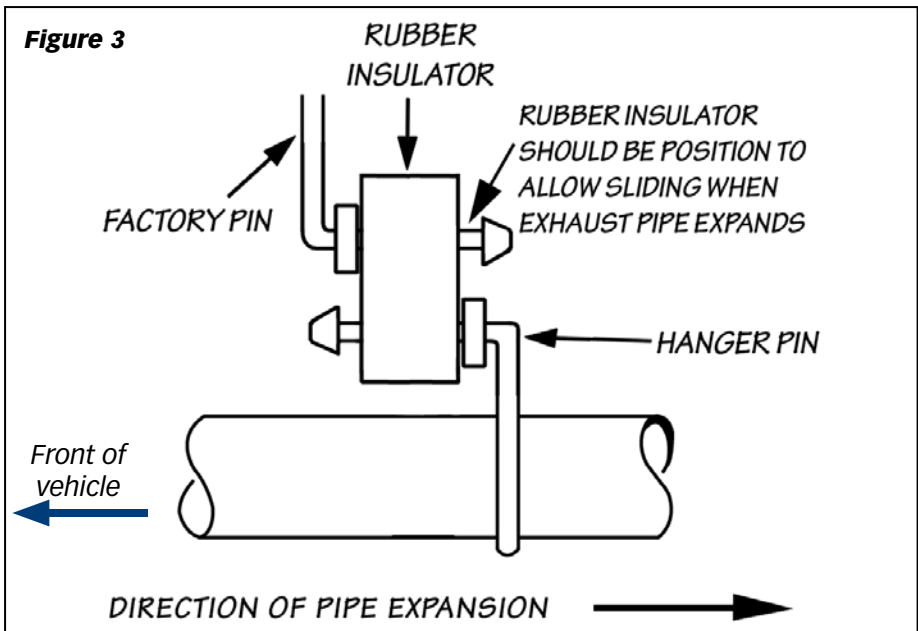
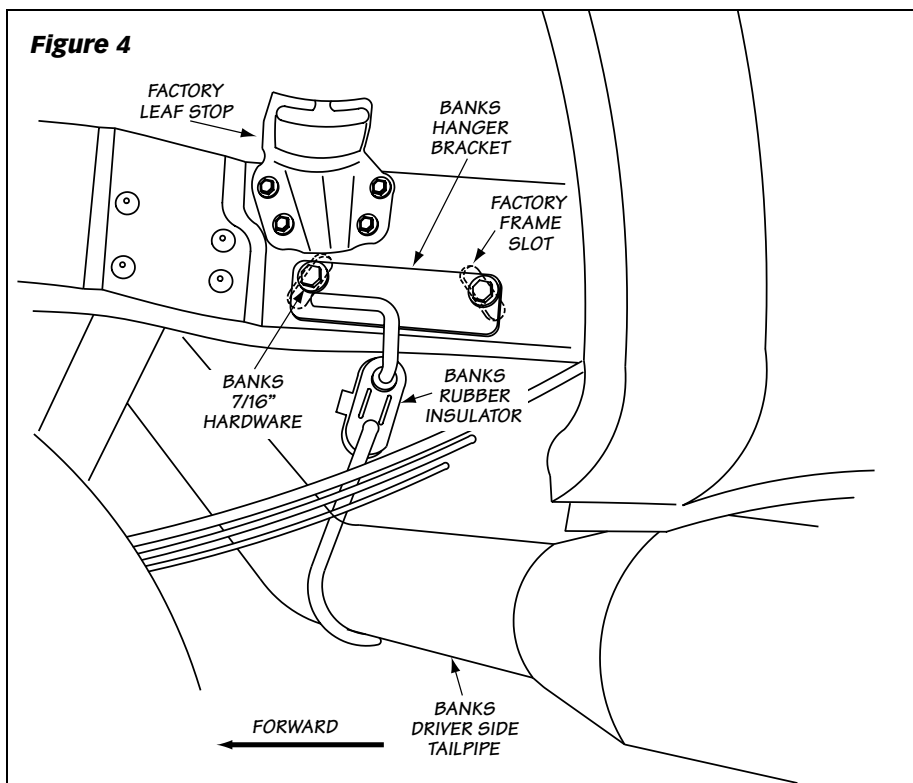

Figure 4



10. Install the Y-pipe over the intermediate pipe as shown in **Figure 1**. Install clamps onto each Y-pipe outlet.

11. Locate the two slots on the rear diverside frame rail and install the supplied Banks hanger bracket using the supplied hardware. Be sure the hanger pin is align parallel to the frame rail and torque the hardware to 48ft-lb. See **Figure 4**.

12. Install the supplied rubber insulator onto the Banks hanger bracket.

13. Install the driver-side tailpipe onto the left Y-pipe outlet. Install the driver-side tailpipe hanger into the vehicle rubber insulator. Position the rubber insulator as shown in **Figure 5**.

14. Install the passenger-side tailpipe onto the right Y-pipe outlet. Install the passenger-side tailpipe hanger into the vehicle rubber insulator. Position the rubber insulator as shown in **Figure 3**.

15. Loosen and move the spare-tire to the rear of the vehicle and center between the dual tailpipes. Securely tighten the spare tire so that it is retained in place see **Figure 6**.

Figure 5

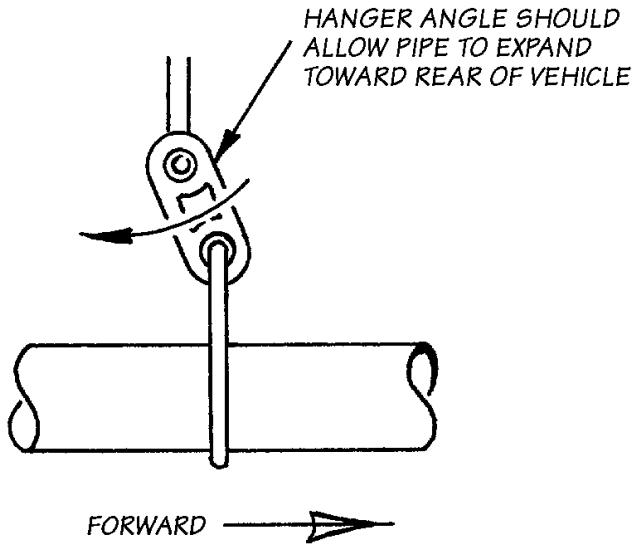

Figure 6

ADJUST SO THAT SPARE TIRE TO HEAT SHIELD CLEARANCE IS WITHIN 1/2"

MOVE SPARE TIRE TOWARDS REAR OF VEHICLE

BANKS DRIVER SIDE TAILPIPE

ZIP TIE ON VENT HOSE & BRAKE LINE

BANKS PASSENGER SIDE TAILPIPE

Figure 7 Placement of template on Passenger side rear undercarriage lining.



16. Adjust the Tailpipe Tips under the rear fender such that the tip position is aesthetically pleasing.

17. Use **Template 1** and/or **2** on page 14 & 15 to trim the rear undercarriage fender lining as shown in **Figure 7** for the LEFT and RIGHT side of the vehicle.

18. With everything positioned properly, begin to tighten the clamps starting with the ones closest to the turbo and working your way back. Evenly torque the exhaust clamps to 35 ft-lbs. Make sure that each slip is fully inserted (+/- 1/4 inch).

19. Remove the protective covering from the tailpipe tip.

Caution: The protective covering may ignite and burn if not removed prior to running the engine.

20. Re-route any vent hose or brake

lines away from the tailpipe using the supplied Cable ties.

21. Your system includes two “Banks Power” logos designed to complement the Ford badging on your truck. Use the provided measurements (see **Figure 8**) to position the logos for a clean factory look.

22. Re-connect battery terminals. Start the engine and listen for exhaust leaks. Tighten the exhaust clamps as necessary. Whenever possible, tack weld slip connections to prevent disengagement is recommended.

23. The Banks Monster Exhaust installation is now complete.

Figure 8

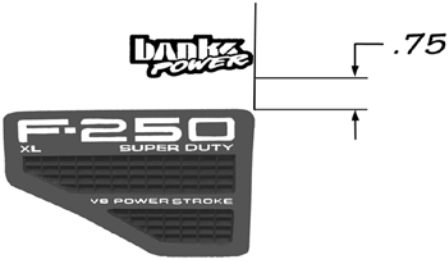

TYPICAL LEFT FENDER

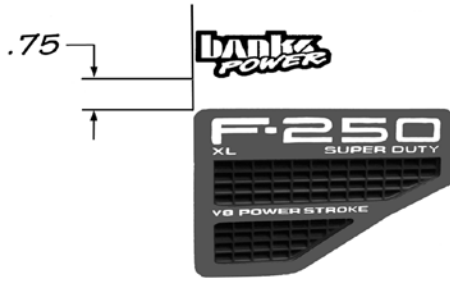

TYPICAL RIGHT FENDER

2008 Ford F-250/F-350 6.4L Power Stroke Banks Split-Dual Monster Exhaust Quad Tip



Page Left Intentionally Blank

Template 1 For Right Side of undercarriage fender

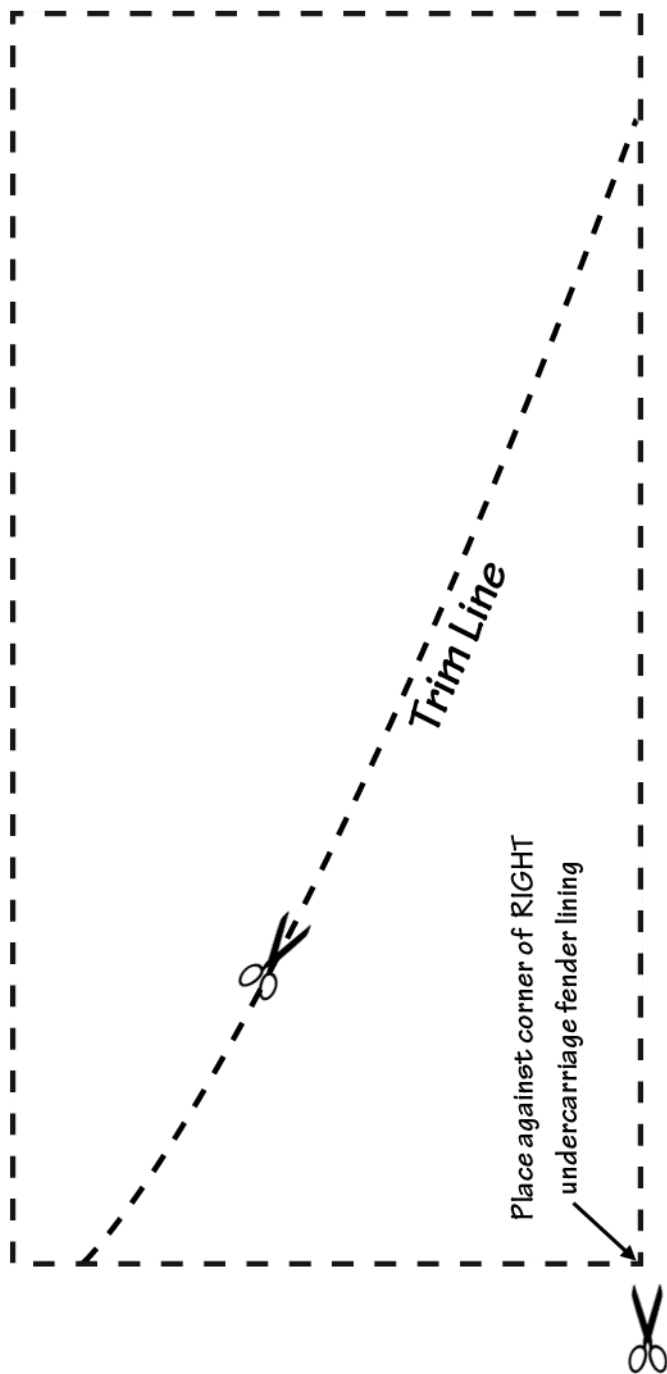

Template 2 For Left Side of undercarriage fender

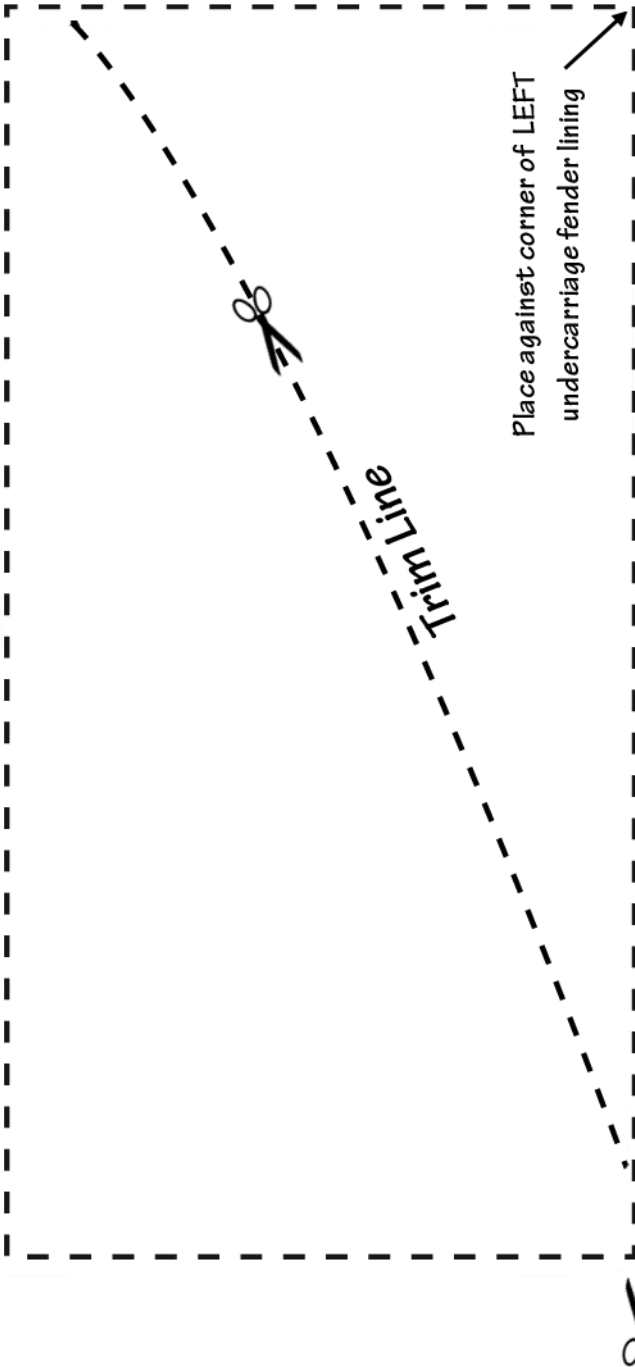

Gale Banks Engineering
546 Duggan Avenue • Azusa, CA 91702
(626) 969-9600 • Fax (626) 334-1743

Product Information & Sales: (800) 438-7693
Customer Support: (888) 839-5600

bankspower.com