

Blueair
500/600 Series
User Manual

Contents

2	Welcome
3	Getting started
4	Getting the most from your Blueair system
6	Changing the filters
7	Filters

Welcome

Thank you for choosing Blueair. Before you start using your Blueair air purifier, take a few minutes to become familiar with the basics.

Filter replacement

Be sure to change your Blueair filters according to the recommended filter replacement schedule. This helps keep your Blueair air purifier running in top condition. See page 7.

Extend your warranty

Complete and send your warranty card to Blueair today to extend your limited warranty.

Help keep the planet healthy, too

Blueair air purifiers provide maximum improvement of indoor air quality with minimum impact on the environment. The entire unit can be recycled, down to its polypropylene filters.

Getting started

General safety instructions

The Blueair 500/600 Series air purifier is an electrical appliance. Please read the safety instructions before use and take the necessary precautions to reduce the risk of fire, electric shock or injury. **The Blueair Limited Warranty applies only if the unit is used according to these instructions.**

- Use the grounded three-prong power cable provided with your Blueair unit. The plug fits into a grounded three-prong outlet. Do not alter the plug in any way.
- Use the cable provided to plug the Blueair unit directly into an appropriate electrical outlet (please refer to the voltage label on your unit). The cable is packaged beneath the unit.

Placement

Place the unit in a location that allows air to circulate freely in, out and around the unit. The minimum acceptable distance from another object is 4" or 10 cm. Use only genuine Blueair filters. **Do not place the unit:**

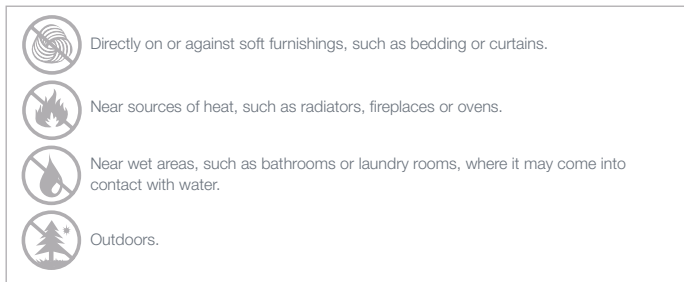

Settings*

Plug the cable into a grounded three-prong wall outlet and turn on your Blueair unit. The blue light-emitting diode indicates that the unit is working. Set the control knob to maximum speed, which is recommended for fast initial cleaning, daytime use, or very polluted air. After a few minutes, adjust the control to the desired speed. Minimum speed is generally recommended for nighttime use.

* For Blueair E Series units (250E, 450E, 550E, 650E), please refer to the separate sheet included with your unit for instructions on settings.

Care and maintenance

Blueair air purifiers feature award-winning Swedish design, materials and workmanship. To keep your unit in top condition, we recommend routine cleaning.

- Vacuum the air intake grille from the inside when you remove the filters to replace them.
- Vacuum the small inlets with a soft brush attachment.
- Wipe the exterior of the unit with a soft, clean, damp cloth.
- Never clean with gasoline, chemical solvents or corrosive material also as these agents may damage the surface.
- Do not allow foreign objects to enter the ventilation or exhaust openings. This may cause electric shock or damage the unit.
- Do not try to repair or adjust any of the electrical or mechanical functions on your Blueair unit yourself. Contact your local dealer or Blueair for warranty information.

How it works

The filters effectively capture larger airborne particles as the fan motor draws air into the unit. Air passes through an ion chamber where airborne particles are charged with negative ions. Charged particles are drawn to the HEPASilent™ filter surface. Purified air, which is virtually contaminant-free is re-circulated into the room.

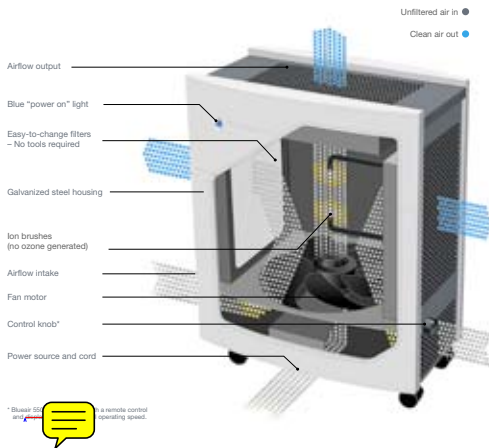

Getting the most from your Blueair system

The Blueair system is easy to use. Make sure your unit is the right size for your room, and change the filters according to recommended filter replacement schedule. Remember that, just as air conditioners and heaters have limits to the volume of air they can cool or heat, every air purification system has limits to the volume of air it can clean. Follow these common-sense guidelines.

Close your windows

You wouldn't throw open your windows on a hot summer day and expect your air conditioner to work efficiently, because you can feel the hot air coming in and the cool air going out. Even though you can't see the contaminated air coming in and the clean air going out, the same logic applies to your air purifier.

Close your doors, too

Just as you might seal off part of your house on a cold winter night to keep your heater working more efficiently, seal off the room in which your system is working for best results. This is especially important for people using a Blueair system to ease nighttime asthma or allergy attacks.

Run your system 24 hours per day

For best results, run your Blueair unit 24 hours a day, 7 days a week. Round-the-clock operation ensures that a continuous supply of clean, filtered air constantly circulates throughout the room. Blueair systems are designed for phenomenally low power usage. In fact, it costs about the same to power a Blueair air purifier as it does to power a single light bulb, depending on the unit and the operating speed.

Changing the filters

Step 1

Unplug the unit and lift the lid from the top of the unit.

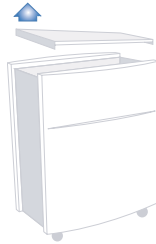

Step 2

Remove the filter on top.

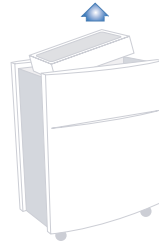

Step 3

Remove the filters on each side. Vacuum the grille from the inside.

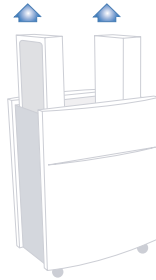

Step 4

Guide the first and second replacement filters into the side slots. Ensure that the side with the words "facing out" is turned toward the outer wall of the unit.

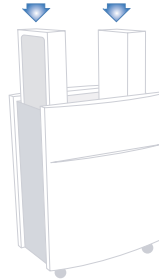

Step 5

Place the third filter on top of the unit and ensure that the side with the words "facing out" is facing upwards.

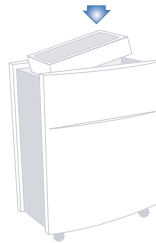

Step 6

Snap the lid back into place.



Filters

Patented HEPASilent™ technology makes the Blueair 500/600 Series incredibly quiet. The unit comes with a complete set of three HEPASilent™ filters already installed.

Particle Filter Kit. Includes three particle filters that remove dust, pollen, bacteria, pet dander, mold spores and other airborne particles. The particle filter is made of polypropylene, which help mechanically filter out airborne particles. To maximize filter effectiveness, particles are negatively charged by the Blueair unit before reaching the filters.

Smokestop™ Filter Kit. Includes three filters with enhanced active carbon to remove gaseous pollutants such as cigarette and cigar smoke or other VOCs (volatile organic compounds, including household paints and other chemicals). You may notice a slight odor from the enhanced active carbon when the filter is first used; this will quickly dissipate.

For optimal performance, Blueair recommends that you replace filters every six (6) months.

We offer a convenient Filter Subscription Program in some countries. Contact your local dealer or Blueair to find out whether the program is available to you.

IMPORTANT! Use only genuine Blueair filters to ensure proper function of your unit and to qualify for full warranty coverage.

Customer's record

The model number and serial number of this product can be found on the bottom of the unit. Please note them in the space provided below and keep for future reference.

Model number	Dealer's name
Serial number	Dealer's address
Date of purchase	Telephone number



Our philosophy

Blueair believes in cleaner indoor air for everyone. Removing air impurities down to the tiniest particle requires a deep commitment to continuous innovation and a greener global environment. Our fresh air solutions are not only inventive, but extremely effective, energy efficient and ecofriendly. At Blueair we believe that clean air is a human right.

www.blueair.com

Blueair Inc.

17 N. State, Suite 1830, Chicago, IL 60602
Phone: (888) blueair (1-888-258-3247), Fax: (312) 727-1153
info@blueair.com

Blueair AB

Danderydsgatan 11, SE-114 26 Stockholm, Sweden
Tel: +46-8-679 45 00, Fax: +46-8-679 45 45
info@blueair.se