



Stereo LCD TV

Owner's Manual

Manual Del Propietario

Manuel d'instructions

"Read this manual before assembling (or using) this product."

ENGLISH

Table of Contents 3

ESPAÑOL

Contenido 22

FRANÇAIS

Table des matières 43

Welcome to the World of Sanyo

Thank you for purchasing a Sanyo Stereo LCD Television. You made an excellent choice for Performance, Styling, Reliability, and Value. The TV is designed with easy to use on-screen set-up instructions and operating features.

Need assistance? Visit our Web site at www.sanyoctv.com or call toll free 1-800-877-5032.

Model No.:
No. de Modelo:
No de modele:

CLT1554
CLT2054



CLT1554

CLT2054



ENHANCED DEFINITION TELEVISION
ENHANCED DEFINITION TELEVISION (EDTV)



"As an ENERGY STAR® Partner, Sanyo Manufacturing Corporation has determined that this product meets the ENERGY STAR® guidelines for energy efficiency."

Importado Por :
Comercializadora México Americana, S. DE R.L. DE C.V.
Nextengo N° 78
Col. Santa Cruz Acayucan
Del. Azcapotzalco, México D.F. C.P.
02770, RFC CMA 9109119L0
Telefono: 55-5328-3500

Printed in U.S.A. SMC, May 2005
Impreso en U.S.A. SMC, Mayo 2005
Imprimé aux É.-U. SMC, mai 2005
Part No. / No. de Parte /
No de pièce : **1AA6P1P4697B-**
Service Code/Código de Servicio/
Code de service : 610 318 4272

CAUTION

RISK OF ELECTRIC SHOCK DO NOT OPEN

CAUTION: TO REDUCE THE RISK OF ELECTRIC SHOCK, DO NOT REMOVE COVER (OR BACK). NO USER-SERVICEABLE PARTS INSIDE. REFER SERVICING TO QUALIFIED SERVICE PERSONNEL.

THIS SYMBOL INDICATES THAT DANGEROUS VOLTAGE CONSTITUTING A RISK OF ELECTRIC SHOCK IS PRESENT WITHIN THIS UNIT.



THIS SYMBOL INDICATES THAT THERE ARE IMPORTANT OPERATING AND MAINTENANCE INSTRUCTIONS IN THE LITERATURE ACCOMPANYING THIS UNIT.



WARNING: TO REDUCE THE RISK OF FIRE OR ELECTRIC SHOCK, DO NOT EXPOSE THIS APPLIANCE TO RAIN OR MOISTURE.

IMPORTANT SAFETY INSTRUCTIONS

Important Safety Instructions for LCD TV

1. Read these instructions.
2. Keep these instructions.
3. Heed all warnings.
4. Follow all instructions.
5. Do not use this apparatus near water.
6. Clean only with dry cloth.
7. Do not block any ventilation openings. Install in accordance with the manufacturer's instructions.
8. Do not install near any heat sources such as radiators, heat registers, stoves, or other apparatus (including amplifiers) that produce heat.
9. Do not defeat the safety purpose of the polarized or grounding-type plug. A polarized plug has two blades with one wider than the other. A grounding-type plug has two blades and a third grounding prong. The wide blade or the third prong are provided for your safety. If the provided plug does not fit fully into your outlet, consult an electrician for replacement of the obsolete outlet.
10. Protect the power cord from being walked on or pinched particularly at plugs, convenience receptacles, and the point where they exit from the apparatus.
11. Only use attachments/accessories specified by the manufacturer.
12. Use only with the cart, stand, tripod, bracket, or table specified by the manufacturer, or sold with the apparatus. When a cart is used, use caution when moving the cart/apparatus combination to avoid injury from tip-over.
13. Unplug this apparatus during lightning storms or when unused for long periods of time.
14. Refer all servicing to qualified service personnel. Servicing is required when the apparatus has been damaged in any way, such as power-supply cord or plug is damaged, liquid has been spilled or objects have fallen into the apparatus, the apparatus has been



exposed to rain or moisture, does not operate normally, or has been dropped.

15. If an outside antenna is connected to the television equipment, be sure the antenna system is grounded so as to provide some protection against voltage surges and built up static charges. In the U.S. Selection 810-21 of the National Electrical Code provides information with respect to proper grounding of the mast and supporting structure, grounding of the lead-in wire to an antenna discharge unit, size of grounding conductors, location of antenna discharge unit, connection to grounding electrodes, and requirements for the grounding electrodes.
16. An outside antenna system should not be located in the vicinity of overhead power lines or other electrical light or power circuits, or where it can fall into such power lines or circuits. When installing an outside antenna system, extreme care should be taken to keep from touching such power lines or circuits as contact with them might be fatal.
17. The AC Adapter power supply should not be placed in a confined area. Proper ventilation is required to ensure reliable operation and to protect it from overheating

EXAMPLE OF ANTENNA GROUNDING ACCORDING TO NATIONAL ELECTRICAL CODE, ANSI/NFPA 70

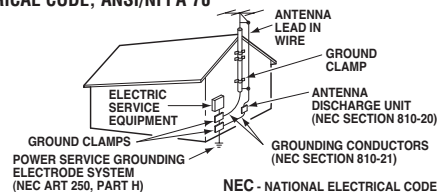

"Note to CATV system installer:

This reminder is provided to call the CATV system installer's attention to Article 820-40 of the NEC that provides guidelines for proper grounding and, in particular, specifies that the cable ground shall be connected to the grounding system of the building, as close to the point of cable entry as practical."

18. "Apparatus shall not be exposed to dripping or splashing and no objects filled with liquids, such as vases, shall be placed on the apparatus."

CONTENTS

Important Safety Instructions	2	Using the Remote Control	10
Care and Cleaning	3	TV Adjustment and Setup	11 ~ 14
Features	4	How to Operate the On-Screen Menu	12
Specifications	4	Adjusting Picture: Auto / Game / Manual	12
Getting Started	5 ~ 6	Adjusting Sound: Audio / Bass / Treble /	
Positioning the LCD TV	5	Surround	12
Using the Tilt Stand	5	Adjusting the Channel: Antenna / CH. Search /	
Removing the TV Tilt Stand	5	CH. Memory	13
Power Connection	5	Selecting a Display Language	14
Installing Batteries in the Remote Control	6	Set Up: Color Enhancer / Aspect Ratio /	
Connecting Cable, RF Antenna, or a Satellite		Backlight	14
Receiver to the TV 75-Ohm jack	6	Closed-Captioning	15
Top and Back Panel	7	V-Guide Operation (Parental Control)	16 ~ 18
Optional Feature – Wall Mounting	7	Helpful Hints (Problems / Solutions)	19
Using the Component Video and		Warranty (Mexico)	20
Audio Input Jacks	8	Warranty (U.S.A. and Canada)	21
Connecting a DVD Player	8	Child Safety Matters	Back cover
Using the Audio / Video Input Jacks	9		
Connecting a VCR or DVD Player	9		

CARE AND CLEANING

The surface of the cabinet can be damaged if not properly maintained. Many common household aerosol sprays, cleaning agents, solvents, and polishes will cause permanent damage to the fine surface.

- 1. Unplug the power cord before cleaning the television.**
2. Clean the screen and cabinet with a soft dry cloth.

Note: *Never* spray liquids on the screen because it can run down and drip onto the chassis. This may cause component failure not covered under Warranty.



FEATURES

- ◆ 15 inch & 20 inch flat-screen
- ◆ Detachable tilt Stand—tilts TV down 5° up 10°
- ◆ Wall Mountable
- ◆ 3-DY/C Digital Comb Filter
- ◆ AC Adaptor
- ◆ Power Saving Mode (Back Light function)
- ◆ V-chip for Movies and TV guidelines rating limits
- ◆ Closed-Captioning
- ◆ MTS stereo/SAP decoder
- ◆ Integrated front speaker 5 x 9 cm (two)
- ◆ Surround Sound
- ◆ Bass / Treble
- ◆ Picture adjustments—Aspect Ratio: 4:3 and 16:9 format
- ◆ Factory preset adjustments for Picture
- ◆ Automatic Channel Search
- ◆ Color Enhancer
- ◆ Receives 181 Channels: VHF 2~13;UHF 14~69; Cable TV 1, 14~125
- ◆ Component video input for the best picture signal from your VCR or DVD
- ◆ Rear AV input (2 sets R/L)
- ◆ S-Video Input
- ◆ Trilingual Menu Options
- ◆ Sleep Timer
- ◆ 24-Key Remote Control

SPECIFICATIONS

LCD Panel Size (Measured Diagonally):

CLT155415-inch flat screen EDTV monitor
CLT2054 20-inch flat screen EDTV monitor

Picture Resolution: CLT1554—1024x768 (XGA)
CLT2054—640x480 (VGA)

Scanning Format 480p
(All signals are converted to 480p)

Jacks and Connectors:

RF Antenna Input (75 ohm)
AV1 Input: S-Video, Composite, Audio L/R
AV2 Input: Composite, Audio L/R
AV3 Input: Component (Y/Pb/Pr), Audio L/R
DC power input

Antenna Input UHF/VHF/CATV 75 ohm

Power Requirement Source: AC 120V, 60Hz
AC Power Consumption (average) CLT1554—23 watts
CLT2054—34 watts

Size and Weight (approximately):

CLT1554 Horizontal Dim. (Width) 19.7 in. (500mm)
Vertical Dim. (Height) 12.9 in. (328mm)
Depth Dim. (Thickness) 7.2 in. (184mm)
CLT2054 Horizontal Dim. (Width) 23.8 in. (604mm)
Vertical Dim. (Height) 16.3 in. (413mm)
Depth Dim. (Thickness) 7.2 in. (184mm)
Weight: CLT1554 12.7 (lbs), 5.8 (Kg)
CLT2054 20.3 (lbs), 9.2 (Kg)

Specifications are subject to change without notice.

CAUTION: FCC Regulations state that improper modifications or unauthorized changes to this unit may void the user's authority to operate the unit.



This symbol on the nameplate means the product is Listed by Underwriters' Laboratories Inc. It is designed and manufactured to meet rigid U.L. safety standards against risk of fire, casualty and electrical hazards.

GETTING STARTED

POSITIONING THE LCD TV

Always use an appropriate table or stand when positioning your TV. Allow enough space to tilt the TV. For best viewing, avoid locating the TV where direct sunlight or indoor lighting will fall on the screen. (Note: CLT1554 measurements are in the parenthesis.)

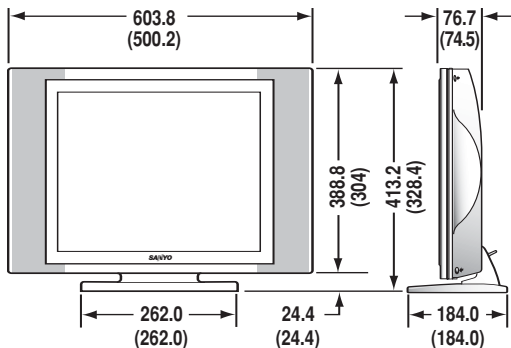

USING THE DETACHABLE TV TILT STAND

To change the viewing angle of your LCD TV, position your hand on the top and hold the stand firmly, then tilt the LCD screen forward or backward. **CAUTION:** Do not position hand under the screen while tilting the TV forward.

Note: Maximum tilt is 5° to the front and 10° to the back.



REMOVING THE TV TILT STAND

Tools Needed: Phillips screwdriver

Important Note: Position TV face down on a padded or cushioned surface to protect the screen and finish.

- 1 Remove the screw from the stand back cover.
- 2 Remove four (4) screws from the metal bracket. **CAUTION:** Hold the stand firmly as you remove the last screw.
- 3 Carefully remove the TV stand.

POWER CONNECTION

- 1 Insert AC Adaptor into the DC input terminal on the TV.
- 2 Insert AC power cord into Adaptor; then insert the plug fully into a 120V, 60Hz, AC power outlet.

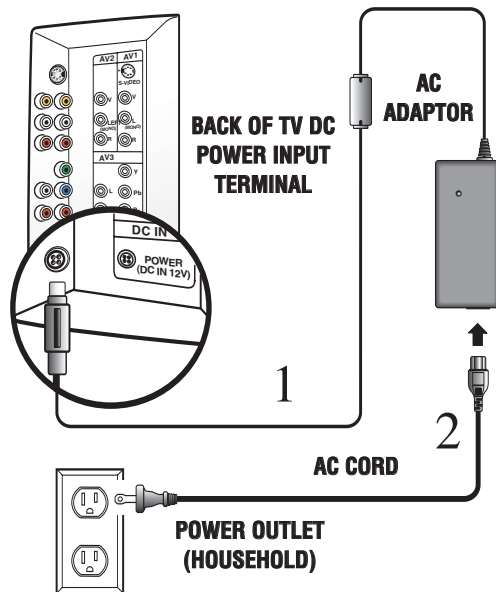

Warning: This 12V AC/DC product is intended for indoor home use only. It is not to be exposed to high outdoor ambient temperatures found in automotive, marine, and aviation environments.

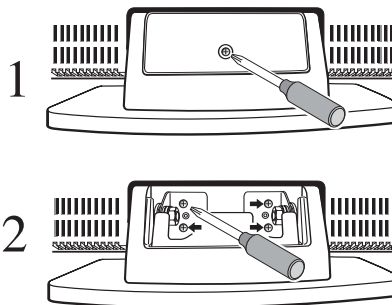

GETTING STARTED

INSTALLING BATTERIES IN THE REMOTE CONTROL

Use 2 “AAA” batteries (Not supplied).

Be sure batteries are installed correctly.

Note: Do not mix old batteries with new ones or mix different types of batteries together.

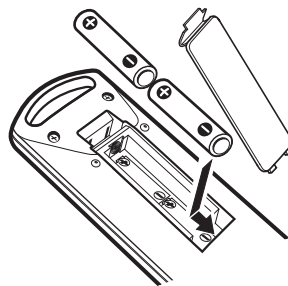

CONNECTING CABLE SERVICE, RF ANTENNA, OR SATELLITE RECEIVER TO THE TV

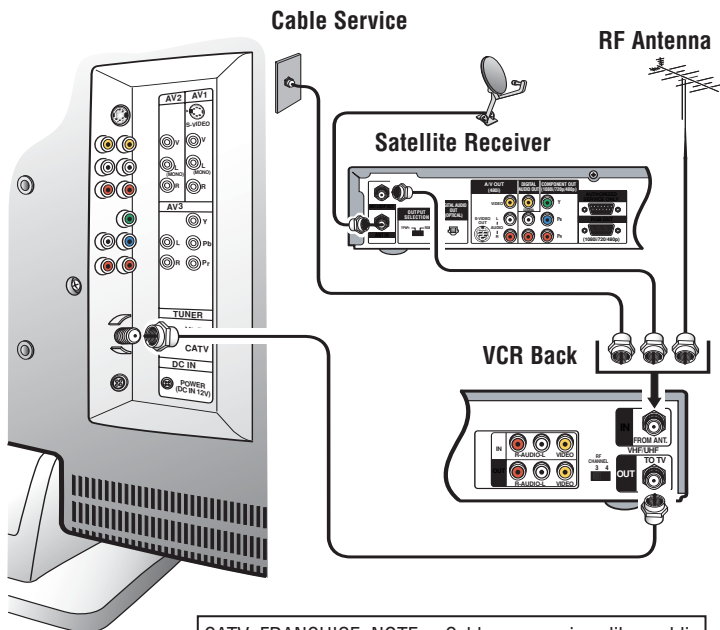

TV Back

CATV FRANCHISE NOTE: Cable companies, like public utilities, are franchised by local government authorities. To receive cable programs, even with equipment which is capable of receiving cable channels, the consumer must subscribe to the cable company's service.

Operational Tip for No Signal Connection:

If the TV is used as a monitor only, with a DVD player or some other type of external equipment, and no cable or antenna signal is available, the following setup is necessary:

Your TV is designed to automatically search for available channels. Therefore, the initial start up requires that you press the **MENU** key, enabling the TV to automatically go through the channel search process before you can operate the TV. After the initial channel search is completed, you must press the **MENU** key again to complete the channel search process. This may take several minutes.

After the channel search process is complete (2 searches), you can press the **INPUT** key on the remote control to use the TV as a monitor.

Quick Tips

- TV will automatically select the correct Antenna mode for the type of Analog RF signal connected automatically.

Use “Antenna Selection” in the Setup menu to change the Antenna Mode.

- TV will switch off automatically after 15 minutes if there is no signal reception (cable out or station not broadcasting).

Exception—When the Video mode is selected, the TV will not automatically switch off when signal reception has stopped for 15 minutes.

- If you move the TV to a new location, press the **RESET** key twice after connecting the signal and turning on the TV.

TOP AND BACK PANEL

TOP VIEW

Note: The Channel ▲ (up) / ▼ (down), Volume + (up) / - (down), and Power keys function exactly like the keys on your remote control.

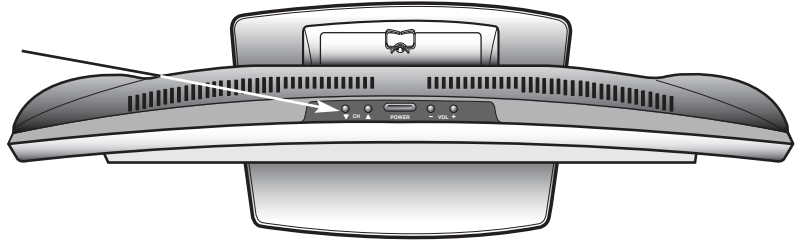

BACK VIEW

S-Video Input Jack

To enhance video detail use the S-Video AV1 jack instead of the Video jack, if available on your external equipment. (S-Video connections will override connections to the AV1 input jacks.) (See page 9.)

Antenna Input Terminal

Connect an RF antenna, cable, or satellite receiver to this jack as shown on page 6.

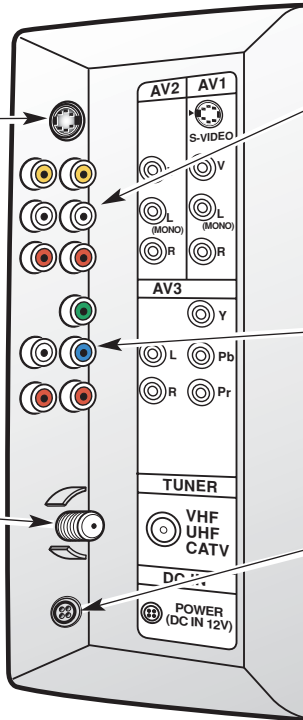

Audio/Video Input Jacks (AV1/AV2)

Connect video equipment here (see page 9).

Note: S-Video connection overrides the AV1 video connection.

480i/p Component Video / Audio Input Jacks (AV3)

Connect external equipment to the Y, Pb, Pr and Audio L/R jacks. (See page 8.)

DC Power Input Jack

Connect AC Adaptor to this terminal.

Optional Accessories: Extra cables are needed for advance connections. Reference the connections accessories list on pages 8~9.

OPTIONAL FEATURE—WALL MOUNTING

This LCD TV is designed so that it may be mounted on a wall, if desired. Use the slots on the back of your TV to secure it using a wall mounting kit.

Note: Wall Mounting kit is not supplied, check with your local electronic supply store.

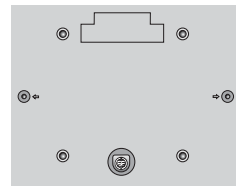

Back View

USING THE COMPONENT AUDIO/VIDEO INPUT JACKS

CONNECTING A DVD PLAYER OR OTHER EQUIPMENT

Switch off TV and external equipment before connecting cables. (*Cables are not supplied.*)

- 1 Connect a DVD Player or other equipment's Component Video Out to the TV Component Video In (Y-Pb-Pr) Jacks.
- 2 Connect the DVD Player's Audio Out to the TV Component L/R Jacks.
- 3 Press **POWER** to turn on the TV. Turn on external equipment also.
- 4 Press the **INPUT** key to select COMPONENT3.

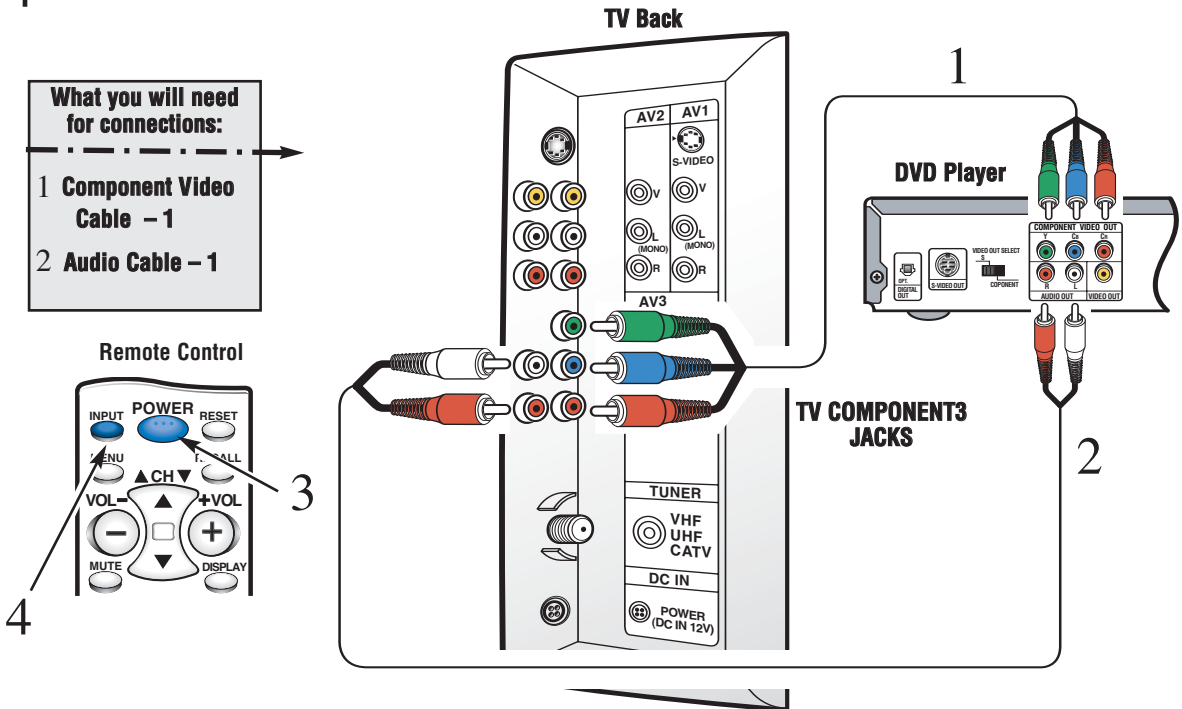

Quick Tips

- A solid Blue screen with **COMPONENT3** displayed means that the Video mode is selected, but no signal is being detected at the Component jacks. Check connection, and turn on external equipment.
- Press the **INPUT** key after connecting cables to access the A/V Inputs. There is **NO** need to tune to a blank channel.

USING THE AUDIO/VIDEO INPUT JACKS

CONNECTING A VCR OR DVD PLAYER

Switch off TV and external equipment before connecting cables. (*Cables are not supplied.*)

1 Connect VCR, DVD Player, or other equipment's Audio Video Out to the TV Audio Video Input.

For Mono VCR (Single Audio Jack) connect VCR Audio Out to TV Audio (L) Input.

Optional (1 / 2)

Connect DVD Player or other equipment's S-Video Out to the TV S-Video In Jack.

Using the S-Video jack overrides the Video (AV1) jack.

Connect DVD Player or other equipment's Audio Out to the TV Audio In Jacks.

2 Press **POWER** to turn on the TV. Turn on external equipment also.

3 Press the **INPUT** key to select VIDEO1 or VIDEO2.

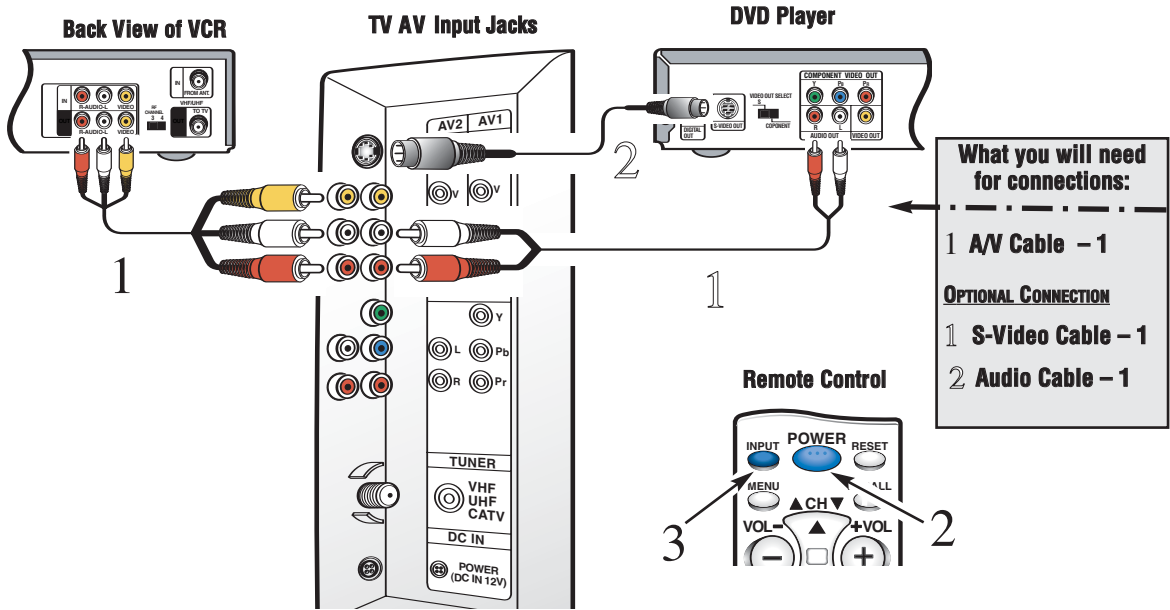

Quick Tips

- Press the **INPUT** key after connecting cables to access the A/V Inputs. There is **NO** need to tune to a blank channel.
- Make sure all cable connectors are fully seated on jacks.
- Always match A/V cables according to the colors; red for right audio, white for left audio and yellow for video.
- A solid Blue screen with the word VIDEO1 or VIDEO2, displayed means that the Video mode is selected, but no signal is being detected at the Video jacks. Check connections, turn on external equipment.

USING THE REMOTE CONTROL

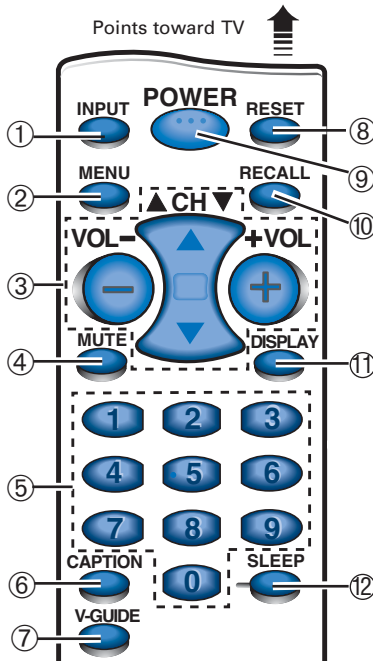

- ① **Input Key**—Press to select the program source to watch: TV signal or signal from the DVD Player or other equipment you have connected to the A/V jacks.
- ② **Menu Key**—Use this key with the ▲/▼ and -/+ keys to navigate and adjust features of the on-screen menu system (see pages 11 ~ 13).
- ③ **Channel Scanning (CH ▲/▼) and Volume (VOL -/+) Keys**—Press to scan through the channels in memory and to adjust the volume.
- ④ **Mute Key**—Press once to minimize the volume. Press again to restore. *Note:* When using the audio out jacks this key will not mute the sound.
- ⑤ **Number Keys**—Two keys must be pressed to select a channel. *Example:* Press **0** then **6** to select channel 6. For cable channels 100 through 125, press and hold the **1** key until C1-- appears. Then press the other two numbers.
- ⑥ **Caption Key** (See page 15.)

- ⑦ **V-Guide Key** (See page 16 ~ 18.)
- ⑧ **Reset Key**—Press this key **twice** to restore factory settings. The TV will automatically start Channel Search and clear all customized settings. These features will automatically reset:
 - Picture Controls: Auto, Game, and Manual: Color, Tint, Contrast, Brightness, and Sharpness
 - Sound Controls: Audio, Bass, Treble, and Surround
 - Channel Controls: Antenna, CH. Search and CH. Memory
 - Set Up Controls: Color Enhancer, Aspect Ratio, and Backlight
 - Caption to OFF
 - V-Guide to OFF
 - Language to English
 - Sleep Timer (if previously set)
 - Video to TV (if previously set)If desired, personal settings can be made again using the menu options.
- ⑨ **Power Key**—Press to turn TV on or off.
- ⑩ **Recall Key**—Select a channel then select another channel using the number keys. Press **Recall** to switch between the channels.
- ⑪ **Display Key**—Press once to display the channel number. Press again to remove the display.
- ⑫ **Sleep Key**—Press this key, then press the “**0**” key to set the Sleep Timer. The desired time can be set from 30 minutes up to 3 hours in 30 minutes increments. Sleep Timer will switch off the TV automatically. *Note:* The Sleep Timer cancels when the TV is turned off or if a power failure occurs.

Quick Tips

- Be sure batteries are installed correctly.
- Point the remote control toward the TV you want to operate. Objects between the remote control and the TV may cause misoperation of the remote control function.

TV ADJUSTMENT AND SETUP

The on-screen menu provides the viewer with easy access to adjustments and settings. The LCD menu is displayed in colorful screen icons that identifies each adjustable option. Just use the keys on the remote control and follow the on-screen instructions.

HOW TO OPERATE THE ON-SCREEN MENU

- 1 Press **MENU** key to display main menu options.
- 2 Use the **-/+** keys to choose desired option. (Selected item is highlighted in **YELLOW**.)
- 3 Use the **▼** key and to select the desired option sub-menu feature.
- 4 Use the **▲/▼** and **-/+** keys to select and adjust sub-menu options (→ red arrow indicates selected item.)
- 5 Press the **MENU** key to select other options from the main menu or to exit.

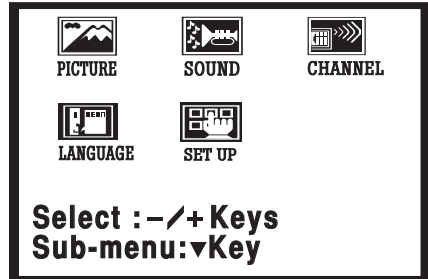

ADJUSTING PICTURE

SELECTING PRESET PICTURE AUTOMATICALLY

Choose Auto from the Picture menu options.

FOR AUTOMATIC GAME SETTING

- 1 Choose **Game** from the Picture options. The screen will automatically change to factory preset settings.
- 2 Press the **MENU** key to exit.

Note: Select the input jacks by pressing the INPUT key on the remote control.

ADJUST PICTURE MANUALLY

- 1 Choose **Manual** from the Picture menu options.
- 2 Press **+** key to access the sub-menu options.
- 3 Use the **▲/▼** keys to select the picture setting you want to change.
- 4 Use the **-/+** keys to adjust settings.

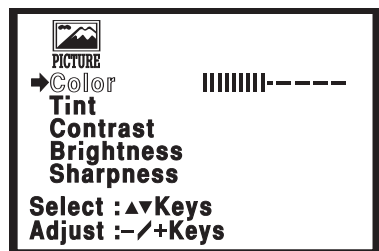

(Continued on page 12.)

Quick Tips

- The menu will display on the screen for approximately 20 seconds. Press **MENU** again to redisplay.
- Use the Channel **▲ / ▼** keys and the Volume **-/+** keys to navigate through the menus and to make selections from the menus.

TV ADJUSTMENT AND SETUP (Continued)

ADJUSTING SOUND

Select desired sound setting: Audio, Bass, Treble or Surround.

- 1 Choose **Audio** from the Sound menu options.
- 2 Use the **▲/▼** keys to select the sound setting you want to change.
(Red **➔** arrow indicates selected highlighted option.)
- 3 Use the **-/+** keys to adjust settings: Stereo, Mono or SAP.

Notes: Stereo and SAP must be part of the broadcast signal. The TV will automatically reset to stereo if unplugged or a power failure occurs.

- 4 To adjust the other sound features: Bass, Treble, or Surround, simply follow steps 2~3 above.



ADJUSTING THE CHANNEL TUNING

RESETTING THE ANTENNA MODE AND CHANNEL SEARCH

Resetting the Antenna or CH. (Channel) Search is required only if additional channels become available, such as moving to another city or having a cable service installed.

- 1 Choose **Antenna** or **CH. Search** from the Channel menu options. (Red **➔** arrow indicates selected menu option.)
- 2 Use the **-/+** keys to change Antenna settings: Cable or UHF/VHF. For CH. Search, press the **+** key. The TV will automatically start searching for your channels. It will take the TV several minutes to complete the search.

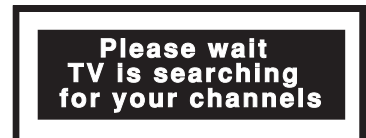
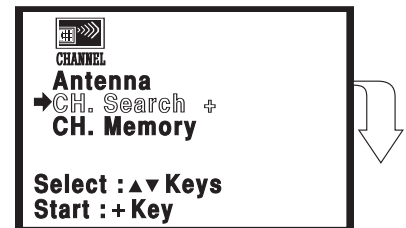

ADDING OR DELETING CHANNELS

- 1 Choose CH. Memory from the Channel menu options. (Red arrow indicates selected highlighted option.)
- 2 Press the **+** key to select the channel number entry area.
- 3 Enter the channel number you want to add or delete (example): C34. For cable channels above 99, press and hold the **1** key until **C1-** appears. Then enter the other two numbers.
- 4 Press the **+** key to change the present setting. Example: Added will change to Deleted. This takes about three seconds. During that time, the word “Added” or “Deleted” will become white.
- 5 Use the **0~9** or **▲/▼** keys to choose other channels to delete or add, or press **MENU** key to exit.

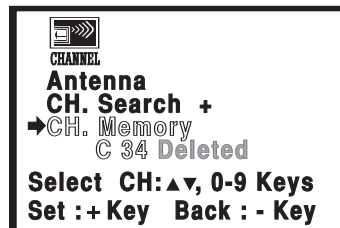
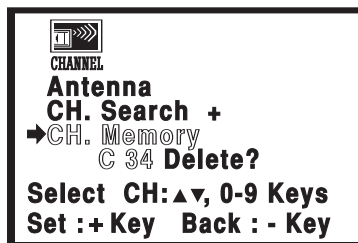

Quick Tips

- Under weak stereo signal conditions, you may receive better quality sound in the “Mono” position.
- Surround sound expands the sound effect while receiving MTS stereo signals.
- Pressing the **RESET** key will clear all customized settings. The TV will automatically start Channel Search and clear settings.
- Channels deleted from scan memory can be selected with the number keys.
- Restoring deleted channels, use the on-screen menu to manually add channels or start CH. Search from the menu. It may take a few minutes to search through the available channels. or press the **RESET** key.

SELECTING THE DISPLAY LANGUAGE

- 1 Choose English, Francais (French), or Espanol (Spanish) from the Language menu options.
- 2 Use the ▲/▼ keys to select the desired language.



TV SET-UP

Use the following features to customize your LCD TV according to your personal preference:

MENU ITEM FUNCTION

Color Enhancer Normal—highlights the picture flesh tones and color highlights.

Warm—deepens the picture red tints.

Cool—highlights the picture blue tints.

Aspect Ratio Use this feature when equipment is connected to the component input jacks:

The 4:3 setting is for normal viewing.

The 16:9 setting changes the picture image to wide-screen viewing with minimal portion of top and bottom compressed.

Back Light Power (energy) saving function—The picture image and background automatically changes as follows:

Bright—High Power (default setting)

Middle—Mid Power

Dark—Lower Power

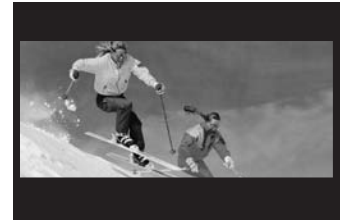

16:9 Screen Format

ADJUSTING THE SET UP FEATURES

- 1 Choose **Color Enhancer**, **Aspect Ratio**, or **Back Light** menu options.
- 2 Use the ▲/▼ keys to select the setting you want to change.
- 3 Use the -/+ keys to adjust settings.



Captioning is text information transmitted along with the picture and sound so it can be displayed on the TV screen. Because different types of captions can be transmitted with the TV signal, separate captioning modes are provided. The captioning modes recognized by this model are: Caption1 and Caption2. Local broadcasters decide which caption signals to transmit.

CAPTION1: This is the main mode used for program captioning (words match the program you are watching). These captions are generally one or two lines.

CAPTION2: This is an alternative mode for program captioning. Caption2 may be used by the broadcaster to provide captions in another language, such as, Spanish or French.

QUIKCAP: Allows captions to toggle on and off with the Mute function. Press the **MUTE** key on the remote control to block the TV sound; the captions display automatically. Press the **MUTE** key again to restore the sound, the captions will disappear. Quikcap displays program captions in the Caption1 mode.



Caption1/ 2

SETTING CAPTIONS

- 1 Press the **Caption** key on the remote control.
- 2 Press the **0** key to select options: **OFF**, **CAPTION1**, **CAPTION2**, or **Quikcap**.

Note: Channel number will not display continuously when captioning is on.

V-GUIDE (PARENTAL CONTROL) INFORMATION

NOTE: THIS FEATURE IS DESIGNED TO COMPLY WITH THE UNITED STATES OF AMERICA'S FCC V-CHIP REGULATIONS. THEREFORE, IT MAY NOT FUNCTION WITH BROADCASTS THAT ORIGINATE IN OTHER COUNTRIES.

This Sanyo television is equipped with an electronic V-Chip to interpret MPAA (Motion Picture Association of America) and TV Parental Guidelines rating codes. When these codes are detected, the TV will automatically display or block the program, depending upon choices you make when setting up the V-Guide system.

The V-Guide system contains both age-based and content-based settings. This gives parents discretionary ways of choosing appropriate material for their children to view.

Content ratings are represented by the initials D (Suggestive Dialog), L (Adult Language), S (Sexual Situations), V (Violence), and FV (Fantasy Violence). When programming contains any or all of these conditions, these letters become part of the icon that is displayed on the TV screen.

A rating icon will generally appear in the upper left hand corner of the TV screen (see page 18.)

V-GUIDE OPERATION

Use this feature to supervise television viewing for young children. This television can be set to automatically block programs with content you deem as inappropriate for your children to view.

The ability of the television to block the reception of specific programming content depends upon several conditions: 1) The program must be rated, 2) Networks must broadcast the rating code data, 3) Cable companies must transmit the rating code signal, and 4) The TV must be properly setup to decode the signal.

SETTING A RATING

- 1 Press the **V-GUIDE** key on the remote control to display menu.
- 2 Press the **-/+** keys to switch V-Guide ON.
- 3 Press the **+** key to access Ratings: MPAA Ratings or TV Ratings.
(⇒ Arrow indicates selection.)

V-Guide System
V-Guide
→ **MPAA Ratings +**
TV Ratings +

Select : ▲▼ Keys
Set : -/+ Keys

Quick Tips

- When in the V-Guide menu system, the **-/+** keys allow you to navigate between the ratings and the options menu.
- Blocking TVY7 does not block higher ratings.
- You can block a content rating such as TVPG-V and still be able to watch TVPG programs with ratings of S-L-D provided TVPG is unblocked (U).
- To temporarily unblock or view Blocked (B) programs, set V-Guide to OFF, or press the RESET key twice to clear all Blocked (B) ratings and other customized settings.

SETTING A MPAA MOVIE RATING

4 Use the ▲/▼ keys to block ratings: G, PG, PG-13, R, NC-17, and X.

5 Press the + key to set the BLOCKED rating. (✓ Check mark indicates Blocked rating.)

Note: The TV will automatically block (B) ratings above or unblock (U) ratings below selection. For example, if you block rating R, NC17 and X will be blocked as well.

MPAA Ratings	
<input type="checkbox"/>	Clear
<input type="checkbox"/>	G
<input type="checkbox"/>	PG
<input type="checkbox"/>	PG-13
<input checked="" type="checkbox"/>	R
<input checked="" type="checkbox"/>	NC-17
<input checked="" type="checkbox"/>	X
Select : ▲▼Keys	
Set : + Key	

TO CLEAR MPAA MOVIE RATINGS

(Repeat Steps 1 and 3 to display V-Guide menu, if needed.)

6 Use the ▲ / ▼ keys to highlight Clear.

7 Press the + key to clear all blocked ratings.

MPAA Ratings	
<input checked="" type="checkbox"/>	Clear
<input type="checkbox"/>	G
<input type="checkbox"/>	PG
<input type="checkbox"/>	PG-13
<input type="checkbox"/>	R
<input type="checkbox"/>	NC-17
<input type="checkbox"/>	X
Select : ▲▼Keys	
Set : + Key	

SETTING TV RATINGS

(Repeat Steps 1 and 3 to display V-Guide menu, if needed.)

8 Use the ▲ / ▼ keys to block TV ratings: TV-Y, TV-Y7, TV-G, TV-PG, TV-14, TV-MA, or Content.

9 Press the + key to set the BLOCKED rating. (✓ Check mark indicates Blocked rating.)

V-Guide System	
V-Guide	
MPAA Ratings +	
→TV Ratings +	
Select : ▲▼Keys	
Set : + Keys	

SETTING CONTENT-BASED GUIDELINES

(Repeat Steps 1 and 3 to display V-Guide menu, if needed.)

10 Use the ▲ / ▼ keys to highlight Content options.

11 Press the + key to display the TV and Content Rating Options: Fantasy Violence, Violence, Sexual Situations, Adult Language, Suggestive Dialog.

12 Use the ▲ / ▼ keys to highlight the TV Rating (highlighted in yellow). Then press the + key to block the content category (highlighted in white). Press + key again to Block or Unblock rating. Use the ▲ / ▼ keys to highlight another rating.

13 Press the - key to return to the TV and Content Rating to block or unblock other categories. Repeat step 11 to change other ratings.

TV Ratings						
<input type="checkbox"/>	Clear	F	V	S	L	D
<input type="checkbox"/>	TV-Y					
<input type="checkbox"/>	TV-Y7					
<input type="checkbox"/>	TV-G					
<input type="checkbox"/>	TV-PG					
<input checked="" type="checkbox"/>	TV-14	<input type="checkbox"/>	<input type="checkbox"/>	<input type="checkbox"/>	<input type="checkbox"/>	<input type="checkbox"/>
<input checked="" type="checkbox"/>	TV-MA	<input type="checkbox"/>	<input type="checkbox"/>	<input type="checkbox"/>	<input type="checkbox"/>	<input type="checkbox"/>
Content						
Select : ▲▼Keys						
Set : + Key						

Content			
TV-Y	Fantasy	V	-
TV-Y7	Violence	B	B
TV-G	Sexual	B	B
TV-14	Language	B	B
TV-MA	Dialog	B	B
Select : ▲▼Keys			
Set :- Key Back :- Key			

Note: Networks and local stations may or may not include the content ratings portion of the TV Parental Guidelines.

V-GUIDE OPERATION (Continued)

TO CLEAR TV/CONTENT-BASED RATINGS

(Repeat Steps 1 and 3 to display V-Guide menu, if needed.)

14 Use the ▲ / ▼ keys to highlight Clear.

15 Press the + key to clear all blocked ratings.

TV Ratings						
<input checked="" type="checkbox"/>	Clear	F	V	S	L	D
<input type="checkbox"/>	TV-Y					
<input type="checkbox"/>	TV-Y7	<input type="checkbox"/>				
<input type="checkbox"/>	TV-G					
<input type="checkbox"/>	TV-PG	<input type="checkbox"/>	<input type="checkbox"/>	<input type="checkbox"/>	<input type="checkbox"/>	
<input type="checkbox"/>	TV-14	<input type="checkbox"/>	<input type="checkbox"/>	<input type="checkbox"/>	<input type="checkbox"/>	<input type="checkbox"/>
<input type="checkbox"/>	TV-MA	<input type="checkbox"/>	<input type="checkbox"/>	<input type="checkbox"/>	<input type="checkbox"/>	
Content						
Select : ▲▼Keys						
Set : + Key						

TURNING OFF THE V-GUIDE

1 Press the V-GUIDE key.

2 Use the ▲ / ▼ keys to select V-Guide. Then press -/+ keys to select OFF.

TV RATINGS (AGE/CONTENT-BASED)



ALL CHILDREN—Program is designed to be appropriate for children ages 2-6.



DIRECTED TO OLDER CHILDREN—Program is designed for children 7 and above. Material may include mild fantasy violence (FV) or comedic violence.



GENERAL AUDIENCE—Program suitable for all ages. Contain little or no violence, no strong language or sexual dialogue or situations.



PARENTAL GUIDANCE SUGGESTED—Program contains material that may be unsuitable for younger children. Material contains one or more for the following: moderate violence (V), some sexual situations (S), infrequent coarse language (L), or some suggestive dialogue (D).



PARENTS STRONGLY CAUTIONED—Some material is unsuitable for children under 14 years of age. Parents are strongly urged to use cautions against letting children that 14 watch unattended. Material contains intense violence (V), intense sexual situations (S), strong coarse language (L), or intensely suggestive dialogue (D).



MATURE AUDIENCE ONLY—Program is designed to be viewed by adults and therefore may be unsuitable for children under 17 years of age.

MPAA MOVIE RATINGS (AGE-BASED)

G GENERAL AUDIENCES—All ages admitted.

PG PARENTAL GUIDANCE SUGGESTED—Some material may not be suitable for children.

PG-13 PARENTAL GUIDANCE CAUTIONED—Some material may be inappropriate for children under 13.

R RESTRICTED—Under 17 requires accompanying parent or adult guardian

NC17 NO ONE 17 AND UNDER ADMITTED

HELPFUL HINTS (Problems/Solutions)

Because of the Quality we build into our product, very few problems are actual TV defects. Most problems only involve simple hookup or setup changes that can be solved by the customer. Please check the chart below and try the solutions listed for your problem. If the problem still persists, **before returning your TV**, visit our website at www.sanyoctv.com or call us toll free at **1.800.877.5032**.

Problem:	Check these Conditions:	Try these Solutions:	Page No.
TV turns off automatically.	<ul style="list-style-type: none"> • Check signal (Cable/Ant.) connection. • Power surge protection feature. 	<ul style="list-style-type: none"> • Press POWER key. • The sleep timer may have been set. • Unplug TV momentarily. 	5
No picture, poor picture, or wavy lines in picture.	<ul style="list-style-type: none"> • Check antenna connections. • May be station trouble. • Brightness or Contrast misadjusted. • Possible interference from household appliance. 	<ul style="list-style-type: none"> • Adjust antenna. • Try a different channel. • Select AUTO from Picture/Sound on-screen menu or press RESET key. • Turn off Mixer, Drill, Blender, etc. 	6, 11
No sound, poor sound. No sound on some channels.	<ul style="list-style-type: none"> • May be station trouble. • May be MUTE function. • Check Audio/Video connections 	<ul style="list-style-type: none"> • Try a different channel. • Adjust Volume. 	8~9 11
Picture too Bright or too Dark.	<ul style="list-style-type: none"> • Check Backlight (power energy saving) settings. 	<ul style="list-style-type: none"> • Select Set-up Menu to set BACK LIGHT option to Middle setting. 	14
Cannot display picture on a full screen.	<ul style="list-style-type: none"> • Check if Aspect Ratio setting is 16:9. 	<ul style="list-style-type: none"> • Select Set-up Menu to set ASPECT RATIO option to 4:3 normal setting. 	14
No Captioning.	<ul style="list-style-type: none"> • Check if station is broadcasting a Closed-Caption signal. 	<ul style="list-style-type: none"> • Press CAPTION key to select Captioning. 	15
Poor color or no color.	<ul style="list-style-type: none"> • Check if program is in color. • Check antenna connections. • Color or Tint misadjusted. • May be station trouble. 	<ul style="list-style-type: none"> • Try a different channel. • Adjust antenna. • Press RESET key to restart channel search. 	11
Blue Screen with Video1, Video2, or Component3 displayed.	<ul style="list-style-type: none"> • Check Audio/Video connections. • Check external equipment. • Check external equipment setting. • check DVD setting. 	<ul style="list-style-type: none"> • Press INPUT key. • Switch on external equipment. • Set external equipment output connections to match input connections. 	8~10
No TV Stereo or SAP sound.	<ul style="list-style-type: none"> • Check if station is broadcasting a true MTS stereo signal or a SAP signal. 	<ul style="list-style-type: none"> • Select STEREO or SAP from Audio on-screen menu. 	12
Cannot select or scan some channels.	<ul style="list-style-type: none"> • Channel may be removed from memory. • Check antenna connections. • V-Guide is set to block programming. 	<ul style="list-style-type: none"> • Select CH. SCAN MEMORY and manually add channels or start CH. (channel) search. • Set V-GUIDE to OFF or press RESET key to clear all setting. 	13 16~18
Remote Control will not work TV.	<ul style="list-style-type: none"> • Check batteries. • Check if TV is plugged in. 	<ul style="list-style-type: none"> • Check external equipment. • Replace batteries. • Aim remote control at front of TV. 	6, 10
Menu System words seem misspelled.	<ul style="list-style-type: none"> • May be a different language is selected. 	<ul style="list-style-type: none"> • Reselect menu language choice using the on-screen menu. 	14
Cabinet makes popping sound.	<ul style="list-style-type: none"> • This is a normal condition during warm-up and cool down of the plastic cabinet parts. 		

MEXICO GUARANTEE

IMPORTADOR:

COMERCIALIZADORA MEXICO
AMERICANA, S.DE R.L. DE C.V.
AV. NEXTENGO N° 78
COL. SANTA CRUZ ACAYUCAN
DEL. AZCAPOTZALCO, MÉXICO, D.F. C.P. 02770
RFC: CMA9109119L0

DESCRIPTION: Television
BRAND: SANYO
MODELS: CLT1554
CLT2054

GUARANTEE

THE APPARATUS THAT YOU HAVE ACQUIRED HAS A ONE YEAR GUARANTEE FOR MANUFACTURING DEFECTS AND A ONE YEAR SERVICE WARRANTY FROM THE DATE OF PURCHASE GRANTED BY:

COMERCIALIZADORA MEXICO-AMERICANA, S. DE R.L. DE C.V.

UNDER THE FOLLOWING CONDITIONS:

1. TO MAKE THE GUARANTEE EFFECTIVE, SIMPLY SHOW THIS POLICY FILLED OUT BY THE STORE OR SUPPLIER UNIT OR THIS SALES INVOICE, WITH THE APPARATUS IN ANY OF THE SERVICE CENTERS INDICATED ON THIS GUARANTEE.
2. IF THE FAULT IS ATTRIBUTED TO A MANUFACTURING DEFECT, THE APPARATUS WILL BE REPLACED OR YOUR MONEY REFUNDED. DURING THE 30 DAYS SUBSEQUENT TO THE PURCHASE THE GUARANTEE WILL BE VALID AT THE STORE WERE THE APPARATUS WAS PURCHASED, PRESENTING THE ABOVE DOCUMENTS.
3. REPAIR TIME WILL NEVER BE MORE THAN 30 DAYS. IF THIS TIME HAS ELAPSED, AND THE PRODUCT ISN'T REPAIRED, COMERCIALIZADORA MEXICO AMERICANA, S. DE R.L. DE C.V. WILL PROCEED TO EFFECTUATE THE EXCHANGE FOR AN EQUIVALENT APPARATUS OR THE RETURN OF THE BUYING-SALE COST RESPECTIVELY.
4. THIS GUARANTEE WILL COVER ITS TOTALITY OF PIECES, COMPONENTS AND SERVICE REPAIR OF PRODUCT, AND THE RESPECTIVE COST OF TRANSPORTATION.

THIS GUARANTEE WILL BE NULL AND VOID IN THE FOLLOWING CIRCUMSTANCES:

- * WHEN PRODUCT HAS BEEN USED IN A DIFFERENT CONDITION THAN ITS NORMAL USE.
- * WHEN PRODUCT HASN'T BEEN OPERATING CORRECTLY ACCORDING TO THE INSTRUCTIONS IN THIS MANUAL.
- * WHEN PRODUCT HAS BEEN CHANGED OR REPAIRED BY PERSONS NOT AUTHORIZED FROM THE MANUFACTURER, IMPORTER, OR MERCHANT RESPONSIBLE RESPECTIVE.

CENTRO DE SERVICIO Y LUGAR DONDE OBTENER PARTES, COMPONENTES, CONSUMIBLES Y ACCESORIOS:

SUCURSAL VALLEJO
Poniente 126 N° 288 B
Col. Nueva Vallejo
México, D.F.
Tels. 5567-5378
5368-0105, 8589-8033

SUCURSAL MINERVA
Silos N° 135, Col. Minerva
Deleg. Iztapalapa
México, D.F. 09810
Tels. 5646-4551
5646-4550

STAMP, DATE AND SIGNATURE
OF
STORE

DESCRIPTION: _____ BRAND: _____ MODEL: _____

CLIENT'S NAME: _____

ADDRESS: _____

EXTERIOR NUMBER: _____ INTERIOR NUMBER: _____

SUB DIVISION: _____ STATE/DELEGATION: _____

TELEPHONE: _____

UNITED STATES AND CANADA WARRANTY

ONE-YEAR LIMITED WARRANTY

THIS LIMITED WARRANTY IS VALID ONLY ON SANYO TELEVISIONS PURCHASED AND USED IN THE UNITED STATES OF AMERICA, CANADA, AND PUERTO RICO, EXCLUDING THE UNITED STATES' OTHER TERRITORIES AND PROTECTORATES. THIS LIMITED WARRANTY APPLIES ONLY TO THE ORIGINAL PURCHASER, AND DOES NOT APPLY TO PRODUCTS USED FOR INDUSTRIAL OR COMMERCIAL PURPOSES.

FOR ONE YEAR from the date of purchase, Sanyo Manufacturing Corporation will replace any defective TV.

To insure proper warranty exchange, keep the original sales receipt for evidence of purchase. Return the defective TV to the retailer along with the receipt and the included accessories, such as the remote control. The defective TV will be exchanged for the same model, or a replacement model of equal value, if necessary. Replacement model will be contingent on availability and at the sole discretion of Sanyo Manufacturing Corporation.

THE FOREGOING WARRANTY IS EXCLUSIVE AND IN LIEU OF ALL OTHER WARRANTIES OF MERCHANTABILITY OR FITNESS FOR A PARTICULAR PURPOSE.

OBLIGATIONS

For one year from the date of purchase, Sanyo Manufacturing Corporation warrants this product to be free from defects in material and workmanship under normal use and conditions. Should replacement be necessary under this warranty for any reason due to manufacturing defect or malfunction during the first year from date of original purchase, Sanyo Manufacturing Corporation will provide a new TV via exchange at the retailer.

For customer assistance, whether during or out of the warranty period, call toll free 1-800-877-5032.

Weekdays 7:30 AM – 7:00 PM Central Time

Saturday 7:30 AM – 4:00 PM Central Time

This warranty expresses specific contractual rights; retail purchasers may have additional statutory rights which vary from state to state.

(EFFECTIVE: August 1, 2002)

For your protection in the event of theft or loss of this product, please fill in the information requested below and **KEEP IN A SAFE PLACE FOR YOUR OWN PERSONAL RECORDS.**

Model No. _____ Date of Purchase _____

Serial No. _____ Purchase Price _____

(Located on back of unit)

Where Purchased _____



Sanyo Manufacturing Corp.
3333 Sanyo Road, Forrest City, AR 72335

Need help? Visit our Web site at www.sanyoctv.com or Call **1-800-877-5032**