



SAMSUNG

PLASMA DISPLAY



ELECTRONICS

Samsung Electronics America inc.
105 Challenger Road, Ridgefield Park, N.J. 07660-0511, U.S.A

SERVICE DIVISION
TEL: 1-800-SAMSUNG (1-800-726-7864)
www.samsungsupport.com

Owner's Instructions
PPM42S2





Warning! Important Safety Instructions



CAUTION: TO REDUCE THE RISK OF ELECTRIC SHOCK, DO NOT REMOVE COVER (OR BACK). NO USER SERVICEABLE PARTS INSIDE. REFER SERVICING TO QUALIFIED SERVICE PERSONNEL.



This symbol indicates high voltage is present inside. It is dangerous to make any kind of contact with any inside part of this product.



This symbol alerts you that important literature concerning operation and maintenance has been included with this product.

Note to CATV system installer: This reminder is provided to call CATV system installer's attention to Article 820-40 of the National Electrical Code (Section 54 of Canadian Electrical Code, Part I), that provides guidelines for proper grounding and, in particular, specifies that the cable ground shall be connected to the grounding system of the building as close to the point of cable entry as practical.

Caution: FCC/CSA regulations state that any unauthorized changes or modifications to this equipment may void the user's authority to operate it.

Caution: To prevent electric shock, match the wide blade of plug to the wide slot, and fully insert the plug.

Attention: pour éviter les chocs électriques, introduire la lame la plus large de la fiche dans la borne correspondante de la prise et pousser jusqu'au fond.

Important: One Federal Court has held that unauthorized recording of copyrighted TV programs is an infringement of U.S. copyright laws. Certain Canadian programs may also be copyrighted and any unauthorized recording in whole or in part may be in violation of these rights.

TO PREVENT DAMAGE WHICH MAY RESULT IN FIRE OR ELECTRIC SHOCK HAZARD, DO NOT EXPOSE THIS APPLIANCE TO RAIN OR MOISTURE.

FOR COMMERCIAL USE ONLY

If this equipment is used at 240V ac, a suitable plug adapter should be used.

Thank You for Choosing Samsung

Thank you for choosing Samsung! Your new Samsung product represents the latest in monitor technology. We designed it with easy-to-use on-screen menus, making it one of the best products in its class. We are proud to offer you a product that will provide convenient, dependable service and enjoyment for years to come.

Important Safety Information

Always be careful when using your Monitor. To reduce the risk of fire, electrical shock, and other injuries, keep these safety precautions in mind when installing, using, and maintaining your machine.

- Read all safety and operating instructions before operating your Monitor.
- Keep the safety and operating instructions for future reference.
- Heed all warnings on the Monitor and in the operating instructions.
- Follow all operating and use instructions.
- Unplug the Monitor from the wall outlet before cleaning. Use a damp cloth; do not use liquid or aerosol cleaners.
- Never add any attachments and/or equipment without approval of the manufacturer. Such additions can increase the risk of fire, electric shock, or other personal injury.
- Do not use the Monitor where contact with or immersion in water is a possibility, such as near bath tubs, sinks, washing machines, swimming pools, etc.
- Do not place the Monitor on an unstable cart, stand, tripod, bracket, table, or floor where it can fall. A falling Monitor can cause serious injury to a child or adult, and serious damage to the appliance. Use only with a cart, stand, tripod, bracket, or table recommended by the manufacturer or sold with the Monitor. Follow the manufacturer's instructions when mounting the unit, and use a mounting accessory recommended by the manufacturer. Move the Monitor and cart with care. Quick stops, excessive force, and uneven surfaces can make the unit and cart unsteady and likely to overturn.
- Provide ventilation for the Monitor. The unit is designed with slots in the cabinet for ventilation to protect it from overheating. Do not block these openings with any object, and do not place the Monitor on a bed, sofa, rug, or other similar surface. Do not place it near a radiator or heat register. If you place the Monitor on a rack or bookcase, ensure that there is adequate ventilation and that you've followed the manufacturer's instructions for mounting.
- Operate your Monitor only from the type of power source indicated on the marking label. If you are not sure of the type of power supplied to your home, consult your appliance dealer or local power company.
- Use only a grounded or polarized outlet. For your safety, this Monitor is equipped with a polarized alternating current line plug having one blade wider than the other. This plug will fit into the power outlet only one way. If you are unable to insert the plug fully into the outlet, try reversing the plug. If the plug still does not fit, contact your electrician to replace your outlet.



FCC Information

- Protect the power cord. Power supply cords should be routed so that they won't be walked on or pinched by objects placed on or against them. Pay particular attention to cords at plugs, convenience receptacles, and the point where they exit from the unit.
- Unplug the Monitor from the wall outlet and disconnect the antenna or cable system during a lightning storm or when left unattended and unused for long periods of time. This will prevent damage to the unit due to lightning and power-line surges.
- Avoid overhead power lines. An outside antenna system should not be placed in the vicinity of overhead power lines or other electric light or power circuits or where it can fall into such power lines or circuits. When installing an outside antenna system, be extremely careful to keep from touching the power lines or circuits. Contact with such lines can be fatal.
- Do not overload the wall outlet or extension cords. Overloading can result in fire or electric shock.
- Do not insert anything through the openings in the unit, where they can touch dangerous voltage points or damage parts. Never spill liquid of any kind on the Monitor.
- Ground outdoor antennas. If an outside antenna or cable system is connected to the Monitor, be sure the antenna or cable system is grounded so as to provide some protection against voltage surges and built-up static charges. Section 810 of the National Electrical Code, ANSI/NFPA No. 70-1984, provides information about proper grounding of the mast and supporting structure, grounding of the lead-in wire to an antenna discharge unit, size of grounding conductors, location of antenna discharge unit, connection to grounding electrodes, and requirements for the grounding electrode.
- Do not attempt to service the Monitor yourself. Refer all servicing to qualified service personnel. Unplug the unit from the wall outlet and refer servicing to qualified service personnel under the following conditions:
 - when the power-supply cord or plug is damaged
 - if liquid has been spilled on the unit or if objects have fallen into the unit
 - if the Monitor has been exposed to rain or water
 - if the Monitor does not operate normally by following the operating instructions
 - if the Monitor has been dropped or the cabinet has been damaged
 - when the Monitor exhibits a distinct change in performance
- If you make adjustments yourself, adjust only those controls that are covered by the operating instructions. Adjusting other controls may result in damage and will often require extensive work by a qualified technician to restore the Monitor to normal.
- When replacement parts are required, be sure the service technician uses replacement parts specified by the manufacturer or those that have the same characteristics as the original part. Unauthorized substitutions may result in additional damage to the unit.
- Upon completion of any service or repairs to this Monitor, ask the service technician to perform safety checks to determine that the Monitor is in a safe operating condition.
- The PDP can properly operate within the temperature range of 32~104°F and humidity less than 80%. Do not use in a hot and humid place.

User Instructions

The Federal Communications Commission Radio Frequency Interference Statement includes the following warning:

NOTE: This equipment has been tested and found to comply with the limits for a Class A digital device, pursuant to part 15 of the FCC Rules. These limits are designed to provide reasonable protection against harmful interference when the equipment is operated in a commercial environment. This equipment generates, uses, and can radiate radio frequency energy and, if not installed and used in accordance with the instruction manual, may cause harmful interference to radio communications. Operation of this equipment in a residential area is likely to cause harmful interference in which case the user will be required to correct the interference at his own expense.

User Information

Changes or modifications not expressly approved by the party responsible for compliance could void the user's authority to operate the equipment. If necessary, consult your dealer or an experienced radio/television technician for additional suggestions. You may find the booklet called How to Identify and Resolve Radio/TV Interference Problems helpful. This booklet was prepared by the Federal Communications Commission. It is available from the U.S. Government Printing Office, Washington, DC 20402, Stock Number 004-000-00345-4.

Warning

User must use shielded signal interface cables to maintain FCC compliance for the product. Declaration of conformity for products marked with FCC Logo. This device complies with Part 15 of the FCC Rules. Operation is subject to the following two conditions:
 (1) this device may not cause harmful interference, and
 (2) this device must accept any interference received, including interference that may cause undesired operation.

The party responsible for product compliance: SAMSUNG ELECTRONICS CO., LTD

America QA Lab of Samsung
 3351 Michelson DR. Suite 290
 Irvine, CA 92612 U.S.A

Tel) 949-975-7310
 Fax) 949-975-7328

Provided with this monitor is a detachable power supply cord with IEC320 style terminations. It may be suitable for connection to any UL Listed personal computer with similar configuration. Before making the connection, make sure the voltage rating of the computer convenience outlet is the same as the monitor and that the ampere rating of the computer convenience outlet is equal to or exceeds the monitor voltage rating. For 110 Volt applications, use only UL Listed detachable power cord with NEMA configuration 5-15P type (parallel blades) plug cap. For 230 Volt applications use only UL Listed Detachable power supply cord with NEMA configuration 6015P type (tandem blades) plug cap.

IC Compliance Notice

This Class A digital apparatus complies with Canadian ICES-003.

Notice de Conformité IC

Cet appareil numérique de la classe A est conforme à la norme NMB-003 du Canada.

European Notice

Products with the CE Marking comply with both the EMC Directive (89/336/EEC), (92/31/EEC), (93/68/EEC) and the Low Voltage Directive (73/23/EEC) issued by the Commission of the European Community. Compliance with these directives implies conformity to the following European Norms:

- EN55022 : 1998 Class A
- EN55024 : 1998
- EN61000-3-2 : 1995
- EN61000-3-3 : 1995

User Instructions

Screen Image retention

Do not display a still image (such as on a video game or when hooking up a PC to this Monitor) on the plasma monitor panel for more than several minutes as it can cause screen image retention. This image retention is also known as "screen burn". To avoid such image retention, refer to page 26 of this manual to reduce the degree of brightness and contrast of this screen when displaying a still image.

Cell Defect

The plasma display panel consists of fine cells. Although the panels are produced with more than 99.9 percent active cells, there may be some cells that do not produce light or remain lit.

Altitude

The PDP will not operate normally at altitude above 6500 ft.

Warranty

Warranty Period: One year starting from the purchase of your Monitor.
Warranty does not cover any damage caused by image retention.

Table of Contents

Setup

Your New Plasma Display Panel	10
Remote Control Buttons	12
Wall Installation Instructions	14
Turning the Monitor(PDP) On and Off	18

Connection (Connecting Speakers / Receiver)

Connecting Speakers	22
Connecting a VCR/Cable Box	23
Connecting a DVD/Set-Top Box	24

Picture Control

Customizing the Picture	26
Using Automatic Picture Settings	27
Viewing the Picture-in-Picture	28
Changing the Screen Size	33
Freezing the Picture.....	34

Sound Control

Customizing the Sound	38
Using Automatic Sound Settings	39
Using the Surround	40

Time Setting

Setting the Clock	42
Setting the Sleep Timer	43
Setting the Timers	44

Connecting PC and Operation

Connecting to a PC.....	48
Adjusting the PC Screen	52
Changing the Position of the Image.....	53
Enlarging the Image (Zoom).....	54
Moving the Zoom Picture	55
Changing the Size of the Image	56
Picture Quality Adjustment	57
Power Saver (RGB mode only)	60

Function Description

Selecting a Menu Language	62
Setting the Multi Control	63
Digital Noise Reduction	64
Auto Power On	65
Using the Panel Lock	66
Setting up Your Remote Control	67

Multiple Display Control

Introduction	70
Installation	71
Main Screen	74
Beginning	75
Power Control	77
Input Source Control	79
Aspect Ratio Control	81
Time Control	83
Settings Control	84
Troubleshooting	89
Display setup value for display method when there are several Displays	90

Appendix

Troubleshooting	92
Care and Maintenance	93
Specifications.....	94

SAMSUNG

P L A S M A D I S P L A Y P A N E L

Setup



Your New Plasma Display Panel	10
Remote Control Buttons	12
Wall Installation Instructions	14
Turning the Monitor(PDP) On and Off	18



Your New Plasma Display Panel

Front Panel

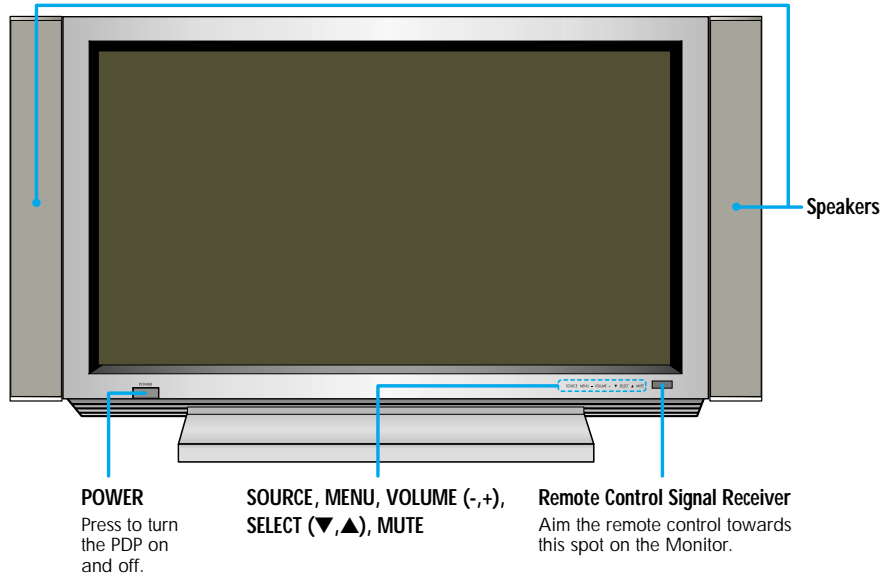

Checking Parts

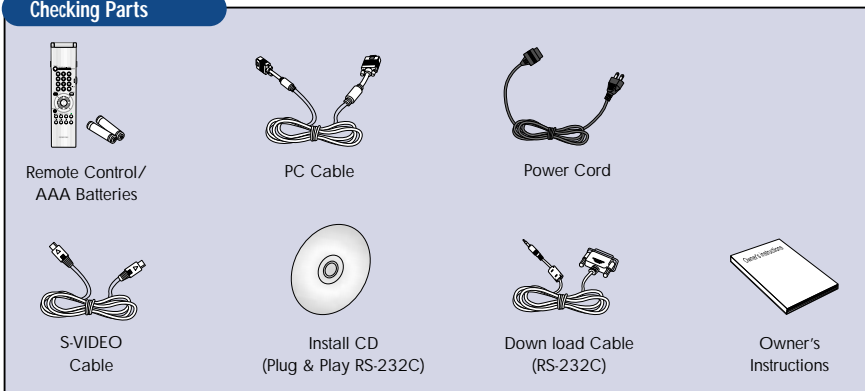

Rear Panel

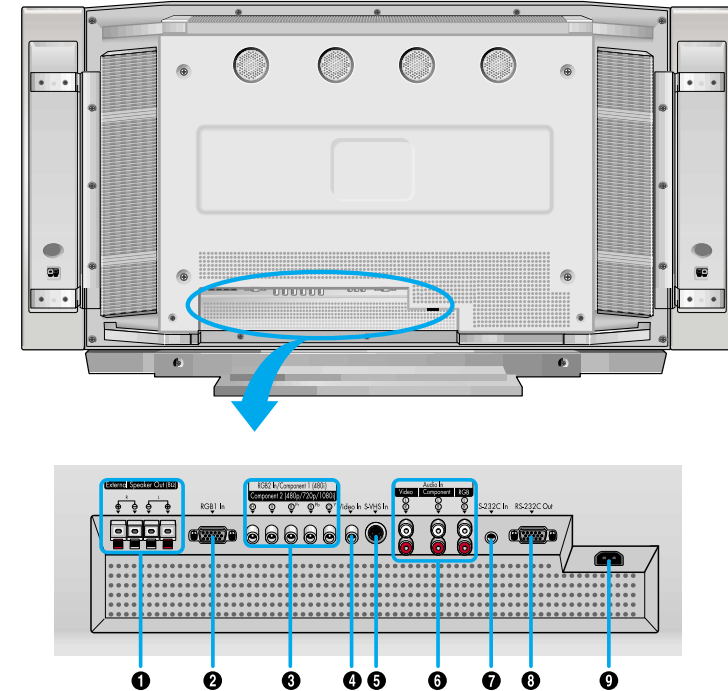

- 1 External Speaker Out jacks**
Connect external speakers.
- 2 RGB Input 1 jack (15pin)**
Connect to the video output jack on your PC.
- 3 RGB Input 2/Component Video Input jacks (H/V/R/B/G, Y/P_b/P_r)**
RGB input2/Component video input jacks are BNC connectors.
- 4 Video Input jack**
Connect a video signal from external sources such as VCRs or DVD players.
- 5 S-VHS Input jack**
Connect a S-Video signal from an S-VHS VCR or DVD player.
- 6 Audio Input (Video/Component/RGB) jacks**
Connect a audio signal from external sources such as VCRs, PC or DVD players.
- 7 RS-232C Input jack**
Connect the RS-232C input jack to your PC.
- 8 RS-232C Output jack**
Connect the RS-232C output jack to another PDP.
- 9 Power Input jack**
Connect the supplied power cord.



Remote Control Buttons

Remote Control

Flip the cover open in the arrow direction.



- 1 Power button**
Turns the PDP on and off.
- 2 Number buttons**
- 3 Display button**
Press to display information on the PDP screen.
- 4 Menu button**
Displays the main on-screen menu.
- 5 CH (Channel) and VOL (Volume) buttons**
Channel buttons : Not available for this Monitor.
Volume buttons : Press to control the Volume.
- 6 Mute button**
Press to mute the PDP sound.
- 7 P.Mode button**
Adjust the PDP picture by selecting one of the preset factory settings (or select your personal, customized picture settings.)
- 8 Aspect button (Not available in PC Mode)**
Press to change the screen size.
- 9 Mode button**
Selects a target device to be controlled by the Samsung remote control (i.e., VCR, Cable, or DVD players).
- 10 Clock Display button**
Press to display clock on the PDP screen.
- 11 Source button**
Press to display all of the available video sources (i.e., Video, S-Video, Component1, Component2, RGB1, RGB2).
- 12 Joystick button**
Use to highlight on-screen menu items and change menu values.
- 13 Still button**
Press to pause the current screen.
- 14 PIP button**
Activates picture in picture.
- 15 Source selection buttons**
Press to directly select Video, S-Video, Component1, Component2 or RGB1, RGB2.

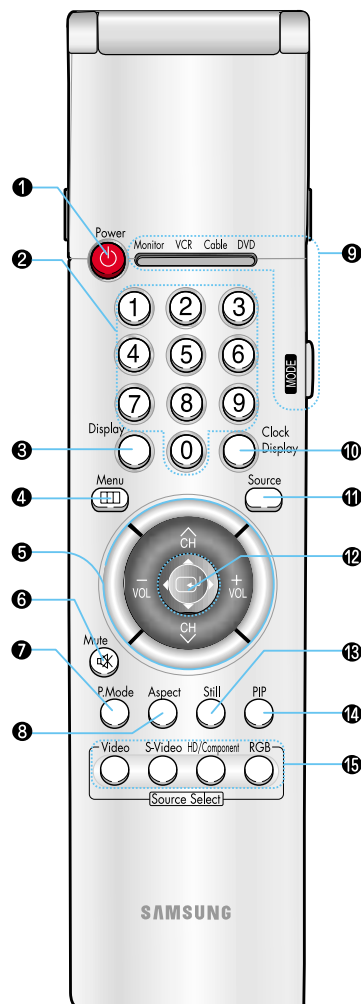

16 VCR control buttons

Controls VCR tape functions: Stop, Rewind, Play/Pause, Fast Forward.

17 Set button

Used during set up of this remote control, so that it will work compatibly with other devices (VCR, cable box, DVD, etc.)

18 Clock set button

Press to set clock.

19 PIP control buttons

Source : Press to select one of the available signal sources for the PIP window.

Swap : In Video and S-Video mode, press to exchange to video signal that is currently displayed on the main screen with the signal in the PIP window.

Size : Press to make the PIP window larger or smaller.

Locate : Press to move the PIP window to any on the four corners of the screen.

20 PC control buttons

Auto Adjust
Scaling
Zoom

21 Sleep button

Press to select a preset time interval for automatic shutoff.



Installing the Batteries in Your Remote Control

- 1** Slide the back cover to open the battery compartment of the remote control

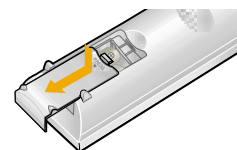

- 2** Install two AAA size batteries. Make sure to match the "+" and "-" ends of the batteries with the diagram inside the compartment.

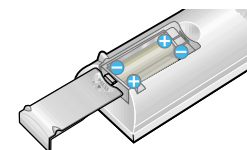

- 3** Slide the cover back into place.

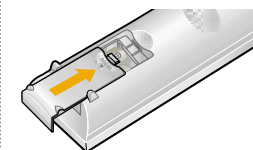

Remote Control Operation Range.

You can use your remote control within a distance of 23 feet and an angle of 30 degrees from the left and right sides of the remote control receiver of the monitor.



Wall Installation Instructions

Installation Notes

- 1 Do not install the PDP in any location other than vertical walls.
- 2 To protect the performance of the PDP and prevent problems, avoid the following places.
 - Do not install next to smoke and fire detectors.
 - Do not install in an area subjected to vibration.
 - Do not install in an area subjected to high voltage.
 - Do not install near or around any heating apparatus.
- 3 Use only recommended parts and components.

Parts (Wall attachment panel is sold separately. Check with your dealer or Samsung)

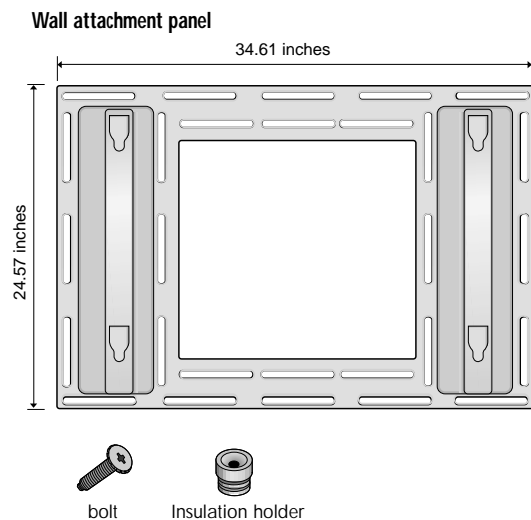

Installing the Display on the Wall Attachment Panel

- 1 See the drawing of the wall attachment panel shown in page 14 to check for the stability of the wall where the PDP is to be installed. If the wall is not strong enough to support the PDP, strengthen the wall before installation.
- 2 Fix the wall attachment panel on the wall using bolts as shown in the following figure: Fixing bolts must protrude from the wall approx. 0.6 inches.

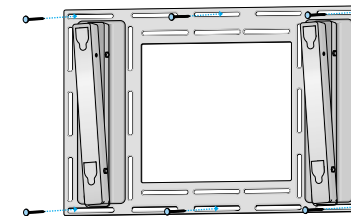

- 3 Using the wall attachment panel, you may adjust the angle of the display from 0 to 20 degrees. The angle can be set in 5 stages with 5 degrees of distance each, using the angle control holes on the sides of the panel.

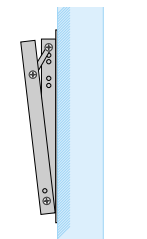

When the angle has been set to 5 degrees.

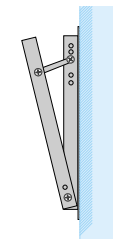

When the angle has been set to 15 degrees.

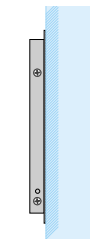

When the panel hasn't been tilted.

Angle control holes

- 5 degrees of tilt
- 10 degrees of tilt
- 15 degrees of tilt
- No tilt
- 20 degrees of tilt

Continued...

- 4 Remove four large screws from the rear side of the display.

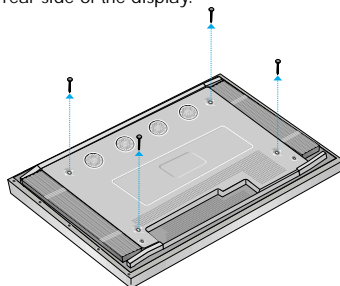

- 5 Insert the bolts and insulations into the four screwholes as shown in the following figure:

- 1 Bolt
- 2 Insulation holder

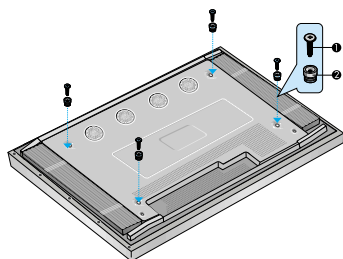

- 6 Put the insulation rubber point protruding from the rear top of the display in the groove on the top of the wall attachment panel. Lift up the display a little bit so that the insulation rubber point at the bottom of the rear side of the display is put in the groove at the bottom of the wall attachment panel. (Do not lift the display with any pressure. The insulation rubber at the top may be taken off.)

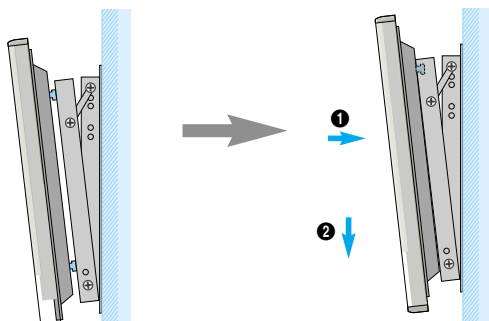

● Separating the Display from the Wall Attachment Panel

Remove the fixing bolts from both sides (left and right) of the wall attachment panel. Lift and pull the bottom of the display a small amount, to separate the insulation holder point from the bottom of the wall attachment panel.

Lift the display and separate the insulation holder point from the groove on top of the wall attachment panel.

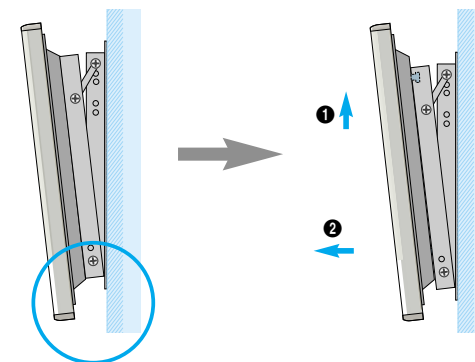



Turning the Monitor(PDP) On and Off

Turning the Monitor(PDP) On and Off

Press the Power button on the remote control. The PDP will be turned on and you will be ready to use it's features.

You can also use the Power button on the front of the PDP.

Notes:

- If your Monitor isn't turned on when the power button is pressed: Press the MODE button to check if the Monitor mode has been chosen ().

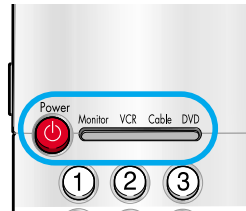

Displaying Status Information

Press the Display button on the remote control. The PDP will display the Screen size, Resolution, Current time, and screen mode.

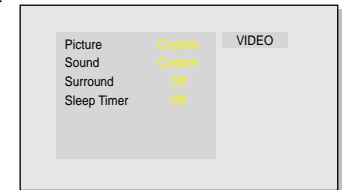

Displaying Clock

Press the Clock Display button on the remote control. The Current time will be displayed on the screen.

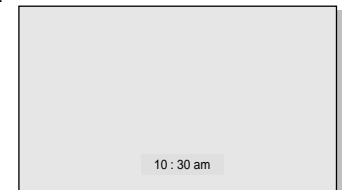

Viewing the Menus and Displays

Your PDP has a simple, easy-to-use menu system that appears on the PDP screen. This system makes it convenient and fast to use features on the PDP. Your PDP also lets you display the status of many of your PDP's features.

Viewing the Menus

- With the power on, press the Menu button on the remote control. The main menu appears on the screen. The PICTURE menu is selected.

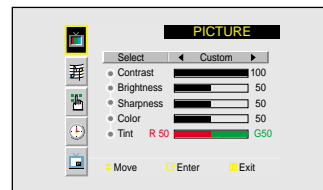

- Use the joystick (up, down) button to move items in the menu. Use the joystick (left, right) button to display, change, or use the selected items. Use the joystick (center) button to enter items in the menu. On screen menus disappear from the screen automatically after about thirty seconds, or you can press the Menu button on your remote control to exit the menu.

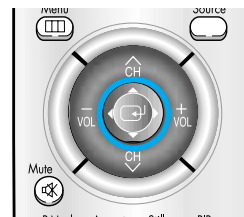

P L A S M A D I S P L A Y P A N E L

Connections
(Connecting Speakers / Receiver)



Connecting Speakers	22
Connecting a VCR/Cable Box	23
Connecting a DVD/Set-Top Box	24



Connecting Speakers

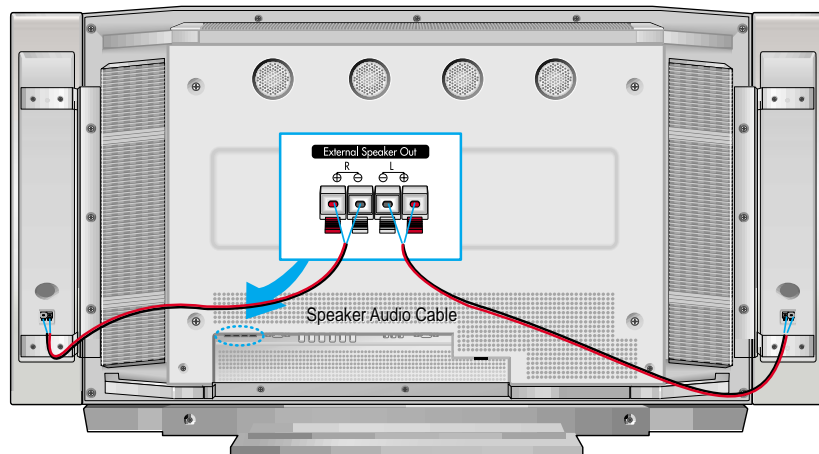

★ External speakers MUST have a power handling capability of 7 watts minimum (impedance 8 ohm).

How to Connect

Connect the speaker audio cable to the external speaker output jack on the rear of the PDP matching the "+" and "-" ends of the cable with the diagram on the PDP.

Connecting PDP and Speakers / Stand and Speakers

- 1 Fix the bracket onto the guide pole located on the rear of speaker and fasten the screws.
- 2 After removing the three screws on the PDP, clamp the speaker and the PDP together and fasten the screws.

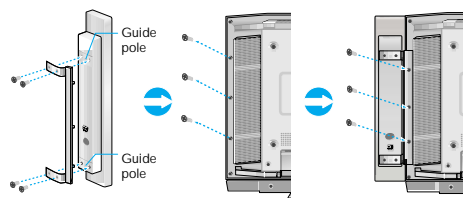

- Connecting speakers to stands.

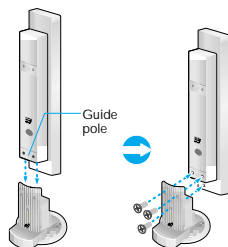

Plasma Display Connecting a VCR/Cable Box

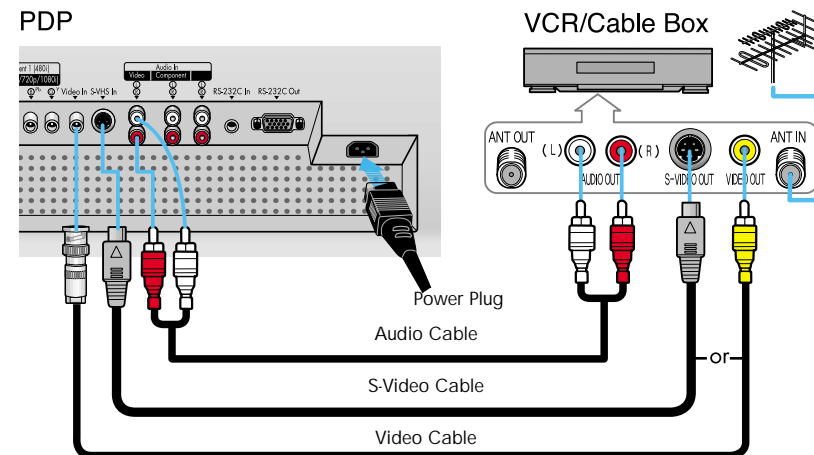

How to Connect

- 1 Connect Video/S-Video cable between the Video/S-Video Output jack on the VCR/Cable box and the Video Input jack on the PDP.
 - For better video, use an S-Video cable.
- 2 Connect an Audio cable between the Audio Output jacks on the VCR/Cable box and the Audio Input jacks (Video) on the PDP.

Videotape Playback:

1. Turn on PDP and press the Video or S-Video(if S-Video jack is connected.) button on your remote control.
2. Turn on your VCR, insert a videotape and press the Play button.



Connecting a DVD/Set-Top Box

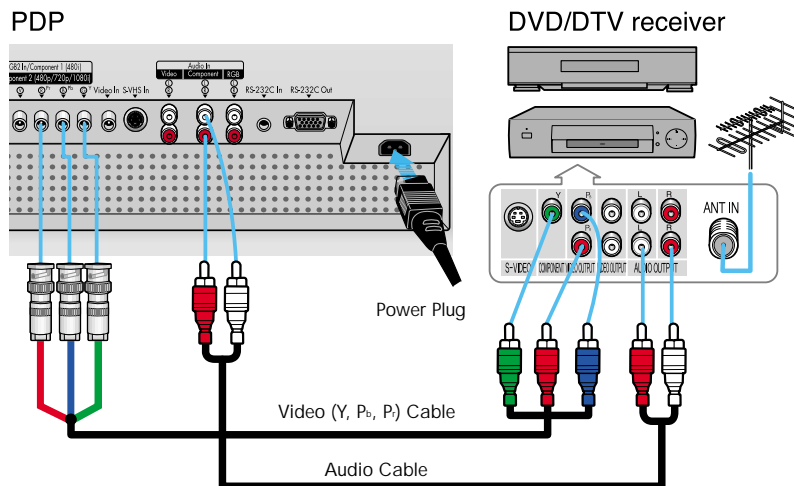

How to Connect

- 1 Connect a Video cable between the DVD/Set-Top Box (Y,Pb,Pr) Output jacks on the DVD/Set-Top Box and the Component1/2 Video Input (Y,Pb,Pr) Input jacks on the PDP.
- 2 Connect an Audio cable between the Audio Output jacks on the DVD/Set-Top Box and the Audio Input jacks (Component) on the PDP.

To Play DVD:

1. Turn on PDP and press the Component button to select the Component1 mode(480i).
2. Turn on your DVD, insert a DVD disc and press the Play button.

To Watch DTV:

1. Turn on PDP and press the Component button to select the Component2 mode(480p, 720p, 1080i).
 2. Turn on your DTV receiver.
 3. When the position and size of DTV screen are distorted, adjust the screen correctly referring to "Picture Automatic Adjustment" in page 57.
- For an explanation of Component video, see your DVD/DTV receiver owner's instructions.

P L A S M A D I S P L A Y P A N E L

Picture Control



Customizing the Picture	26
Using Automatic Picture Settings	27
Viewing the Picture-in-Picture.....	28
Changing the Screen Size	34
Freezing the Picture	35



Customizing the Picture

You can use the on-screen menus to change the Brightness, Contrast, Sharpness, Color, and Tint settings of your PDP.

- 1 Press the Menu button, then press the joystick to enter.

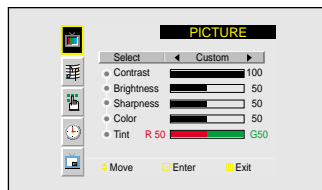

- 2 Move the joystick left or right to select "Custom". You will also see the items "Contrast", "Brightness", "Sharpness", "Color" and "Tint".

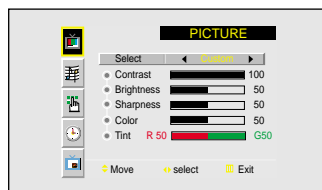

- 3 Move the joystick up or down to select the item you wish to change.

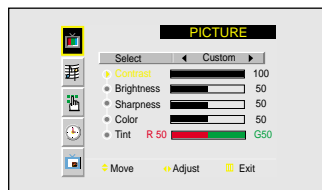

- 4 Move the joystick left or right to change the value of the item.



- 5 Press the Menu button to exit.

Note

- In the RGB mode, you can't adjust the sharpness, color and Tint.



Plasma Display Using Automatic Picture Settings

Your PDP has automatic picture settings that allow you to adjust the video display easily.

- 1 Press the Menu button, then press the joystick to enter.

Quick way to access the picture setting: Just press "P.Mode" on the remote control.

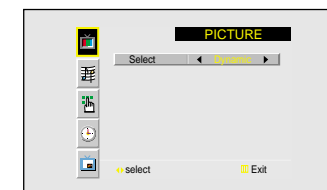

- 2 Move the joystick left or right to select "Dynamic", "Standard", "Movie" or "Custom" picture setting.
 - You can select brightness as "High", "Middle", "Low", or "Custom" in RGB mode.

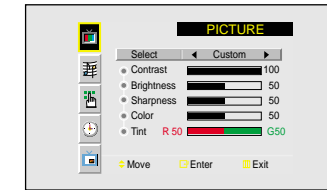

- 3 Press the Menu button to exit.



Viewing the Picture-in-Picture

Selecting the PIP Screen

- 1 Press the Menu button. Move the joystick up or down to select "PIP", then press the joystick to enter.

Quick way to access the PIP: Just press "PIP" on the remote control.

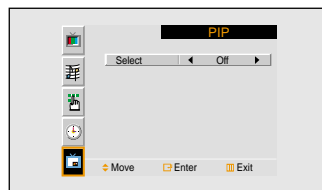

- 2 Move the joystick left or right to select "On". The PIP image will appear in the corner of the screen.

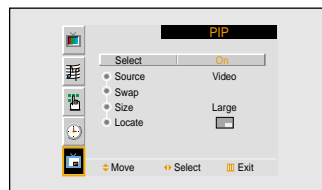

- 3 Press the Menu button to exit.

Note

- The PIP function not operates in Component mode.

Selecting an External Signal

You can use PIP to view a signal from an external source, such as a VCR.

- 1 Press the Menu button. Move the joystick up or down to select "PIP", then press the joystick to enter.

Quick way to access the PIP source: Just press "Source" in the cover on the remote control.

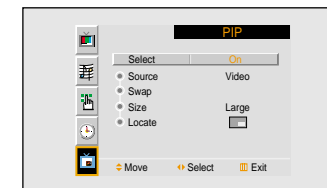

- 2 Move the joystick up or down to select "Source".

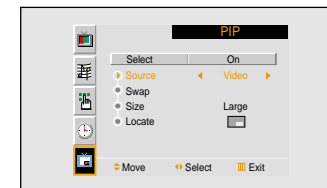

- 3 Move the joystick left or right to select "Video". You will also see the items "Video" and "S-Video".

The signal from these inputs will not appear if you have not connected any equipment to the PDP's input jacks.

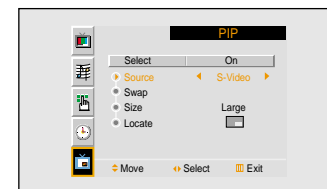

- 4 Press the Menu button to exit.

Swapping the Contents of the PIP Image and Main Image (Video and S-Video mode)

- 1 Press the Menu button. Move the joystick up or down to select "PIP", then press the joystick to enter.

Quick way to access the Swap: Just press "Swap" in the cover on the remote control.

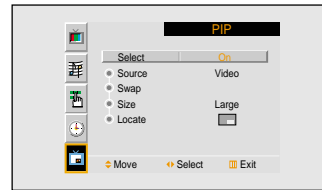

- 2 Move the joystick up or down to select "Swap".

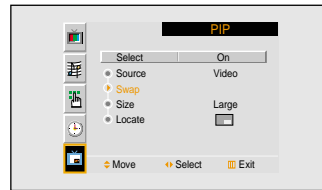

- 3 Move the joystick left or right. The image in the PIP window will appear on the main screen, and vice versa.

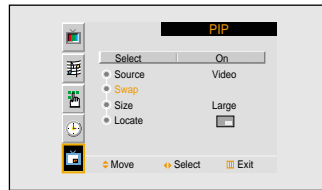

- 4 Press the Menu button to exit.

Note

- The Swap function operates in Video or S-Video mode.

Selecting the Sound Source (RGB mode)

You can select the sound source of speaker when PIP runs. When Main is selected, you can hear the RGB input sound. When Sub is selected, you can hear the PIP sound.

- 1 Press the Menu button. Move the joystick up or down to select "PIP", then press the joystick to enter.

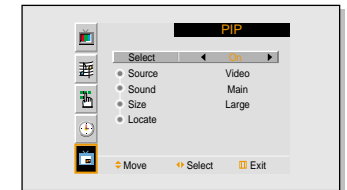

- 2 Move the joystick up or down to select "Sound".



- 3 Move the joystick left or right to select "Main" or "Sub".

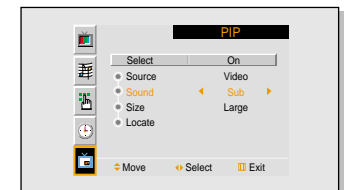

- 4 Press the Menu button to exit.

Note

- The function operates in RGB mode only.

Changing the Size of the PIP Image

- 1 Press the Menu button. Move the joystick up or down to select "PIP", then press the joystick to enter.

Quick way to access the PIP size: Just press "Size" in the cover on the remote control.

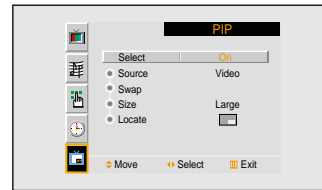

- 2 Move the joystick up or down to select "Size".



- 3 Move the joystick left or right to select "Large" or "Small".



- 4 Press the Menu button to exit.

Changing the Location of the PIP Image

- 1 Press the Menu button. Move the joystick up or down to select "PIP", then press the joystick to enter.

Quick way to access the PIP location: Just press "Locate" in the cover on the remote control.

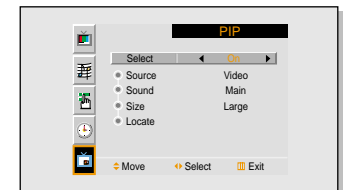

- 2 Move the joystick up or down to select "Locate".

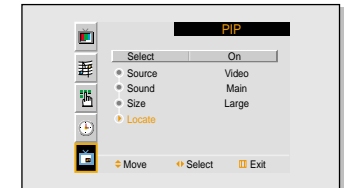

- 3 Move the joystick to move the PIP screen where you want.

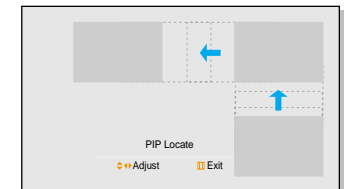

- 4 Press the Menu button to exit.

Note

- In the Video and S-Video mode, when you press Locate button repeatedly, the PIP window moves from corner to corner on the PDP screen.



Changing the Screen Size

(When entering the Video mode)

When you press the Aspect or Scaling(RGB mode) button on the remote control, the PDP's screen mode should appear in sequence. The screen displays in this order: Wide, Panorama, Zoom1, Zoom2, Stretch, 4:3.

Wide

Sets the picture to 16:9 wide mode.

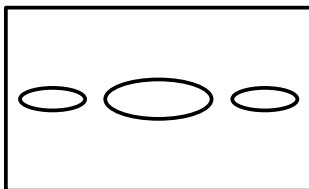

Panorama

Use this mode for the wide aspect ratio of a panoramic picture.

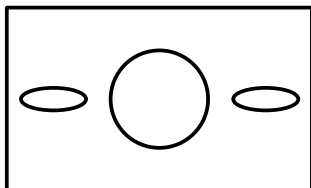

Zoom1

Magnifies the size of the picture vertically on screen.

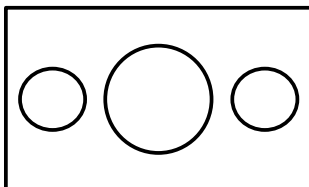

Zoom2

Magnifies the size of the picture more than Zoom1.

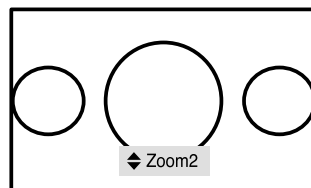

Stretch

Using this mode, magnify the picture vertically and horizontally to be bigger than the picture in Zoom2.

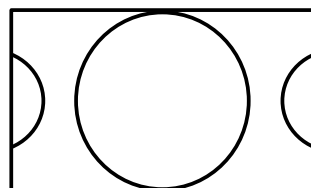

4:3

Sets the picture to 4:3 normal mode. This is a standard PDP screen size.

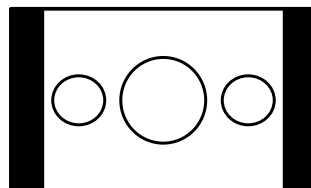

Note

- If you watch a still image or the 4:3 mode for a long time (over 2 hours), an image may be burned onto the screen, view the monitor in wide or panorama mode as much as possible.
- In VIDEO, S-VIDEO and Component1 modes, all screen modes can be selected.
(Wide → Panorama → Zoom1 → Zoom2 → Stretch → 4:3).
- In RGB mode, Wide and 4:3 screen modes can be selected.
- The 4:3 mode does not work with input signals from Component2 sources (Set-top box or DVD players-480p/720p/1080i).



Freezing the Picture

Still

Press the Still button on the remote control to freeze a moving picture. Press again to cancel.

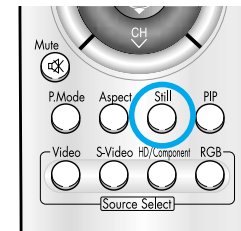

Sound Control



Customizing the Sound	38
Using Automatic Sound Settings	39
Using the Surround	40



Customizing the Sound

- 1 Press the Menu button. Move the joystick up or down to select "SOUND", then press the joystick to enter.

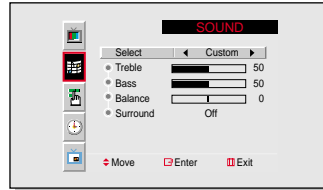

- 2 Move the joystick left or right to select "Custom". You will also see the items "Treble", "Bass", "Balance" and "Surround".

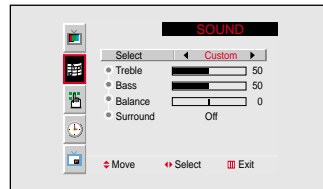

- 3 Move the joystick up or down to select the item you wish to change.

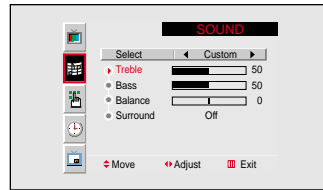

- 4 Move the joystick left or right to change the value of the item.

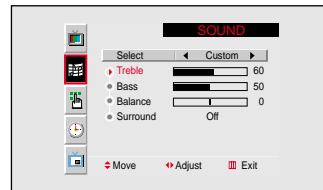

- 5 Press the Menu button to exit.



Using Automatic Sound Settings

- 1 Press the Menu button. Move the joystick up or down to select "SOUND", then press the joystick to enter.

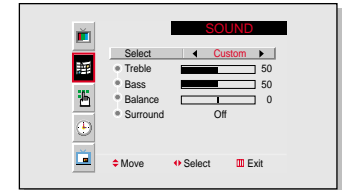

- 2 Move the joystick left or right to select "Custom", "Standard", "Music", "Movie" or "Speech" sound setting.

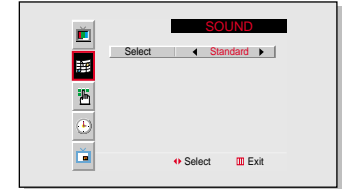

- 3 Press the Menu button to exit.



Using the Surround

- 1 Press the Menu button. Move the joystick up or down to select "SOUND", then press the joystick to enter.

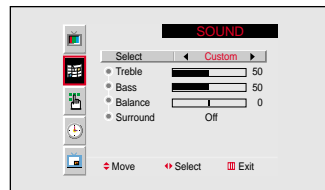

- 2 Move the joystick up or down to select "Surround", then move the joystick left or right to select "Concert", "Hall" or "Stadium".

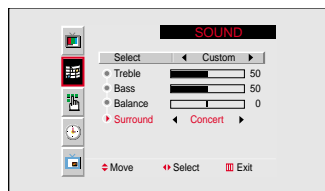

- 3 Press the Menu button to exit.

P L A S M A D I S P L A Y P A N E L

Time Setting

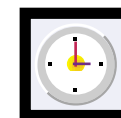

Setting the Clock	42
Setting the Sleep Timer	43
Setting the Timers	44



Setting the Clock

This PDP has a built-in clock that will appear on screen when you press the Clock Display button on the remote control.

- 1 Press the Menu button. Move the joystick up or down to select "TIME", then press the joystick to enter.

Quick way to access the Clock set : Just press "Clock Set" in the cover on the remote control.

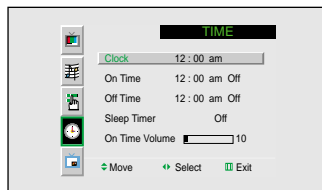

- 2 Move the joystick left or right to select hour, then move the joystick up or down to select the correct hour.

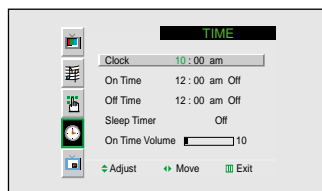

- 3 Move the joystick left or right to select minute, then move the joystick up or down to select the correct minute.

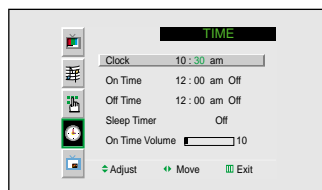

- 4 Move the joystick left or right to select "am", then Move the joystick up or down to select "am" or "pm".

- If you want to display the Clock on screen, press "Clock Display" on the remote control.

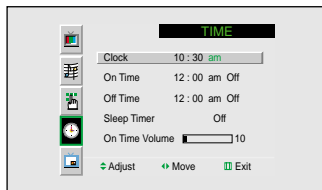

- 5 Press the Menu button to exit.



Setting the Sleep Timer

You can set your PDP to automatically turn off after a preset interval.

- 1 Press the Menu button. Move the joystick up or down to select "TIME", then press the joystick to enter.

Quick way to access the sleep timer: Just press "Sleep" in the cover on the remote control.

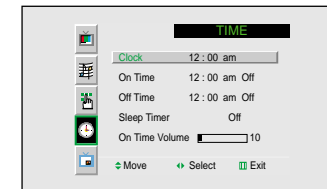

- 2 Move the joystick up or down to select "Sleep Timer".

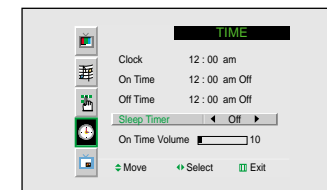

- 3 Move the joystick left or right to select the time interval for the PDP to stay on. The interval ranges from 10 to 360 minutes.

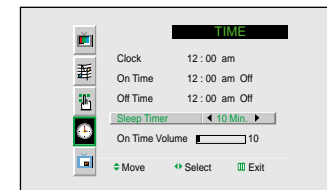

- 4 Press the Menu button to exit.



Setting the Timers

This PDP can be set to turn on or off automatically at specific times that you choose. Before using the timers, you must set the PDP's clock, as described previously.

Setting the On/Off Timer

- 1 Press the Menu button. Move the joystick up or down to select "TIME", then press the joystick to enter.

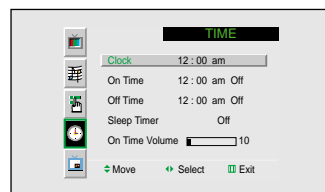

- 2 Move the joystick up or down to select "On time".

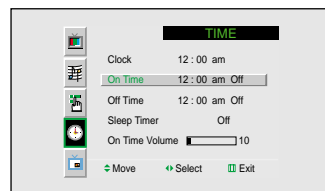

- 3 Move the joystick left or right to select hour, then move the joystick up or down to select the correct hour.

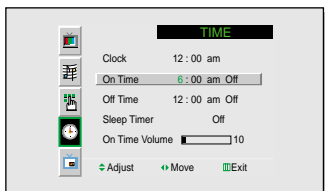

- 4 Move the joystick left or right to select minute, then move the joystick up or down to select the correct minute.

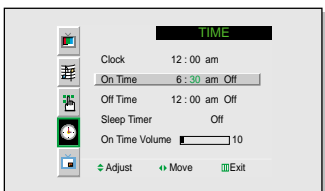

- 5 Move the joystick left or right to select "am", then move the joystick up or down to select "am" or "pm".

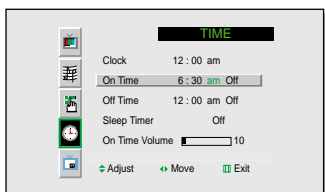

- 6 Move the joystick left or right to select "Off", then move the joystick up or down to select "On".

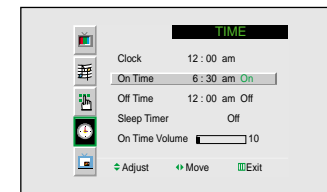

- 7 If you want to set the Off Time, move the joystick down to select "Off Time". Set the "Off Time" just as you set "On Time".

- If you want to set the volume level when the PDP turns on, move the joystick down to select "On time volume". Move the joystick right to set the volume level you want when the PDP turns on.

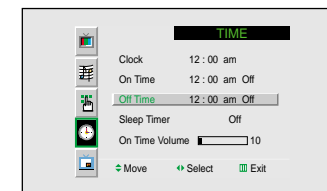

- 8 Press the Menu button to exit.

Connecting PC and Operation



Connecting to a PC	48
Adjusting the PC Screen	52
Changing the Position of the Image	53
Enlarging the Image (Zoom)	54
Moving the Zoom Picture	55
Changing the Size of the Image	56
Picture Quality Adjustment	57
Power Saver (RGB mode only)	60



Connecting to a PC

This PDP is not compatible with Macintosh PC.

PDP

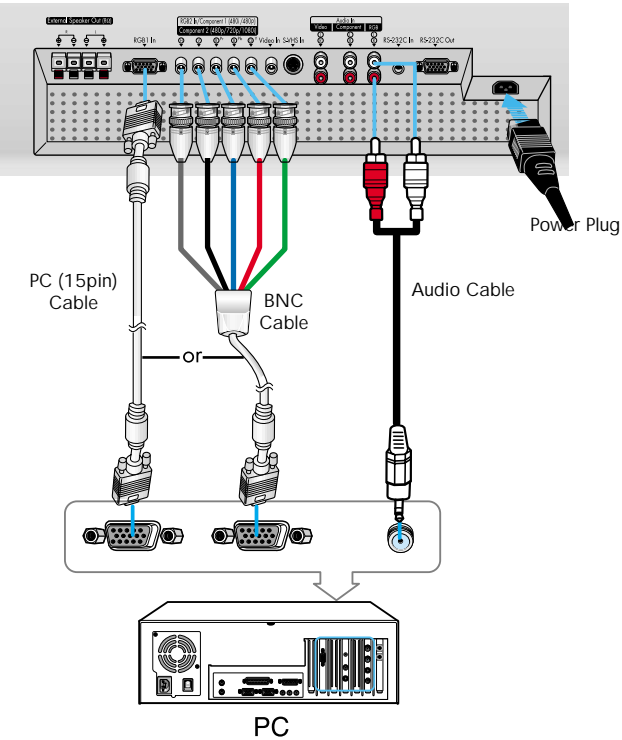

Pin Configuration

- 15Pin Signal Cable (based on protruded pin)

Pin No.	PC IN	PC OUT
1	Red (R)	Red (R)
2	Green (G)	Green (G)
3	Blue (B)	Blue (B)
4	Grounding	Grounding
5	Grounding (DDC)	Grounding (DDC)
6	Red (R) Grounding	Red (R) Grounding
7	Green (G) Grounding	Green (G) Grounding
8	Blue (B) Grounding	Blue (B) Grounding
9	Reserved	Reserved
10	Sync Grounding	Sync Grounding
11	Grounding	Grounding
12	Data (DDC)	Data (DDC)
13	Horizontal sync.	Horizontal sync.
14	Vertical sync.	Vertical sync.
15	Clock (DDC)	Clock (DDC)

Setting up Your Monitor (Plug and Play)

Our adoption of the new VESA® Plug and Play solution eliminates complicated and time consuming setup. It allows you to install your monitor in a Plug and Play compatible system, without the usual setup hassles and confusion. Your PC system can easily identify and configure itself for use with your display. This monitor automatically tells the PC system its Extended Display Identification data (EDID) using Display Data Channel (DDC) protocols.

Connecting a PC to the PDP

- 1 Connect a PC (15pin) or BNC cable between the Video Output jack on the PC and the RGB1 (15p D-SUB) or RGB2 on the PDP.
 - For an explanation of Component video, see your PC owner's instructions.Connect a Audio cable between the Audio Output jack on the PC and the Audio Input (PC) on the PDP.
- 2 To watch the PC screen:
 1. Turn on PDP and press the RGB button on the remote to select the RGB mode.
 2. Turn on PC and check for PC system requirements.
(Refer to pages 50 and 51 for PC system requirements.)
 3. Adjust the PC screen. (Refer to page 52.)

How to Set up Your PC Software (Windows only)

The plasma panel of this monitor is composed 852 pixels and 480 lines. That is the best resolution of this monitor is 852 X 480. Thus, select 852 X 480 resolution is same way as below when you control the display setting. If your video card does not support 852 X 480 resolution, the resolution of 848 X 480 or 640 X 480 is recommended. If you select one of resolutions above, you can use this monitor in best condition.

The Windows display-settings for a typical computer are shown below. But the actual screens on your PC will probably be different, depending upon your particular version of Windows and your particular video card. But even if your actual screens look different, the same, basic set-up information will apply in almost all cases. (If not, contact your computer manufacturer or Samsung Dealer.)

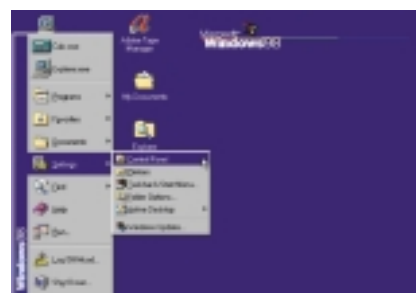

On the windows screen, select in the following sequence : Start → Settings → Control Panel.



When the control panel screen appears, click on "Display" and a display dialog-box will appear.

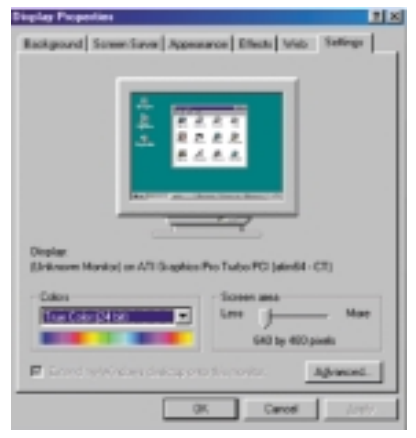

Select the "Settings" tab in the display dialog-box.

The two key variables that apply the PDP-PC interface are "resolution" and "colors." The correct settings for these two variables are:

- Size (sometimes called "resolution"): 640 x 480 pixels.
- Color: "24-bit" color (might also be expressed as "16 million colors") Shown at left is a typical screen for "Display" dialog box.

If a vertical-frequency option exists on your display settings dialog box, the correct value is "60" or "60 Hz." Otherwise, just click "OK" and exit the dialog box.

Notes:
Both screen position and size will vary, depending on the type of PC monitor and its resolution. The table below shows all of the display modes that are supported:

Video signal	Dot X Line	Vertical Frequency (Hz)	Horizontal Frequency (KHz)	Vertical polarity	Horizontal polarity
IBM PC / AT Compatible	640 X 350	70.086	31.469	N	P
		85.080	37.861	N	P
	640 X 400	85.080	37.861	P	N
		85.039	37.927	P	N
	640 X 480	59.940	31.469	N	N
		72.809	37.861	N	N
		75.000	37.500	N	N
		85.008	43.269	N	N
	848 X 480	60.000	29.800	N/P	N/P
	852 X 480	60.000	31.731	N	N
	800 X 600	56.250	35.156	N/P	N/P
		60.317	37.879	P	P
		72.188	48.077	P	P
		75.000	46.875	P	P
	1024 X 768	85.061	53.674	P	P
		60.004	48.363	N	N
		70.069	56.476	N	N
		75.029	60.023	P	P
		84.997	68.677	P	P

- The interlace mode is not supported.
- The PDP operates abnormally if a non-standard video format is selected.

Notes:

- When this PDP is used as a PC display, 24-bit color is supported (over 16 million colors).
- Depending on the manufacturer, your PC display screen might appear different. (and depending on your particular version of Windows).
Check your PC instruction book for information about connecting your PC to a PDP.
- If a vertical and horizontal frequency-select mode exists, select 60Hz (vertical) and 31.5kHz (horizontal).
- In some cases, abnormal signals (such as stripes) might appear on the screen when the PC power is turned off (or if the PC is disconnected). If so, press the Source button to enter the VIDEO mode. Also, make sure that the PC is connected.
- Connect only a PC monitor to the monitor output port while viewing the PC screen. (Otherwise, random signals might appear).

PC Adjusting the PC Screen

Adjusting the R.G.B

Preset:

- Press the RGB button to select the RGB mode.

1 Press the Menu button, then press the joystick to enter.

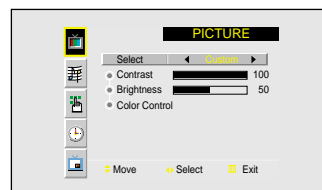

2 Move the joystick up or down to select "Color Control", then move the joystick left or right to enter.

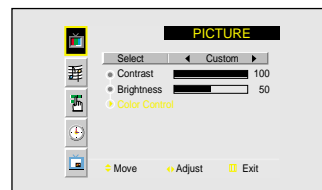

3 Move the joystick up or down to select the item you want to change.

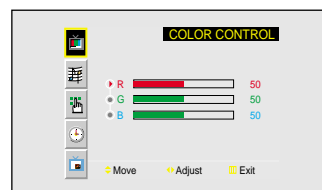

4 Move the joystick right or left to change the value of the item, using the on-screen gauge as your guide.

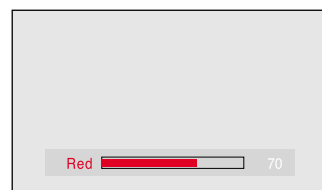

5 Press the Menu button to exit.

Plasma Display PC Changing the Position of the Image

After connecting the PDP to your PC, adjust the position of the screen if it is not well-aligned.

Preset:

- Press the RGB button to select the RGB mode.

1 Press the Menu button. Move the joystick up or down to select "SETUP", then press the joystick to enter.

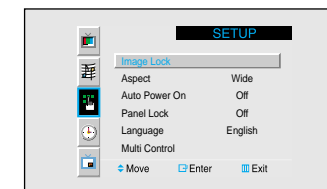

2 Press the joystick to enter.

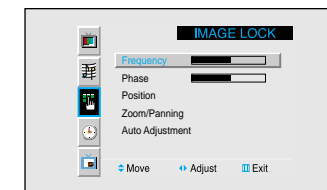

3 Move the joystick up or down to select "Position", then press the joystick to enter.

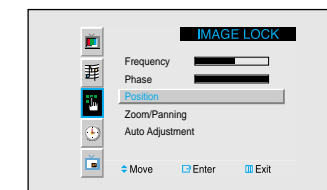

4 Move the joystick left or right to select "Position", then adjust the position of screen by using the joystick button.

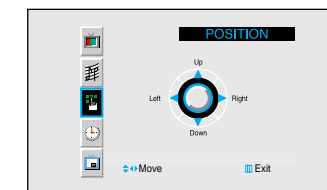

3 Press the Menu button to exit.



Enlarging the Image (Zoom)

Preset:

- Press the RGB button to select the RGB mode.

- Press the Menu button. Move the joystick up or down to select "SETUP", then press the joystick to enter.

Quick way to access the Zoom: Just press "Zoom" in the cover on the remote control.

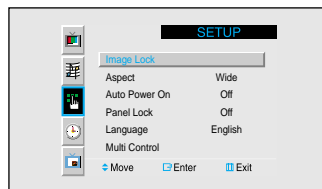

- Press the joystick to enter.

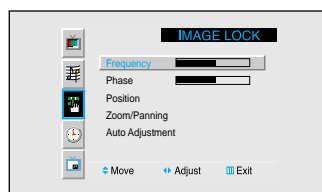

- Move the joystick up or down to select "Zoom/ Panning", then press the joystick to enter.

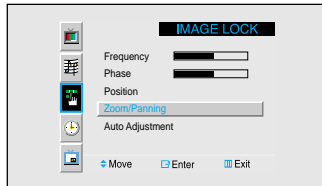

- Move the joystick left or right to enlarge the image.
 - The picture can be expanded 0 to 10 in Zoom mode.

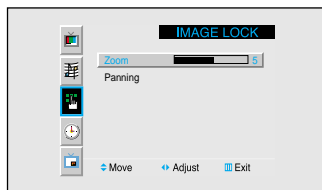

- Press the Menu button to exit.



Moving the Zoom Picture

Preset:

- Press the RGB button to select the RGB mode.

- Press the Menu button. Move the joystick up or down to select "SETUP", then press the joystick to enter.

Quick way to access the Panning: Just press "Zoom" in the cover on the remote control.

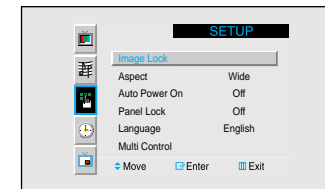

- Press the joystick to enter.

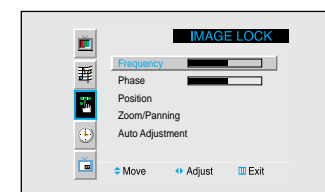

- Move the joystick up or down to select "Zoom/ Panning", then press the joystick to enter.

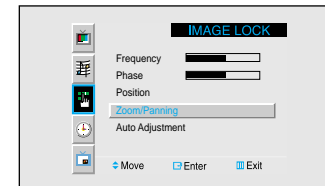

- Move the joystick up or down to select "Panning", then move the joystick left or right to enter.
 - The Panning feature operates only when the picture is in Zoom mode.

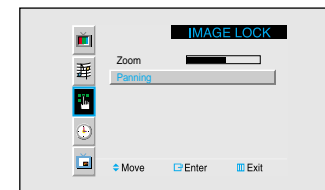

- Press the Menu button to exit.

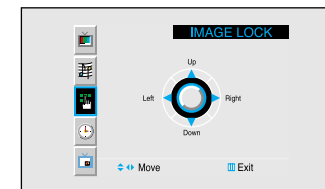

PC Changing the Size of the Image

Preset:

- Press the RGB button to select the RGB mode.

1 Press the Menu button. Move the joystick up or down to select "SETUP", then press the joystick to enter.

Quick way to access the Size: Just press "Scaling" in the cover on the remote control.

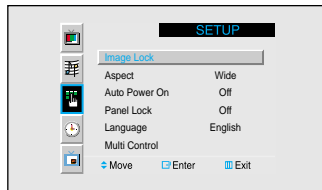

2 Move the joystick up or down to select "Aspect", then move the joystick left or right to select "Wide" or "4:3".

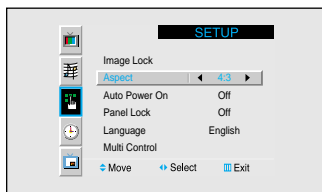

3 Press the Menu button to exit.

PC Picture Quality Adjustment

Picture Automatic Adjustment On/Off

Preset:

- Press the RGB button to select the RGB mode.

1 Press the Menu button. Move the joystick up or down to select "SETUP", then press the joystick to enter.

Quick way to access the Auto Adjust: Just press "Auto Adjust." in the cover on the remote control.

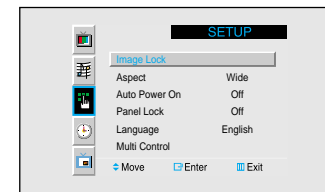

2 Press the joystick to enter.

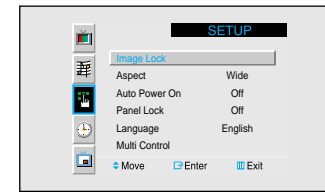

3 Move the joystick up or down to select "Auto Adjust", then press the joystick to enter. The message "Auto in progress" appears on the screen and the picture adjustments are automatically activated.

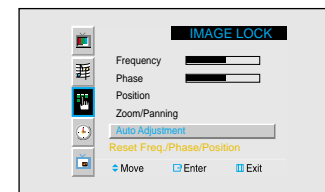

4 Press the Menu button to exit.

Frequency Adjustment

Preset:

- Press the RGB button to select the RGB mode.

1 Press the Menu button. Move the joystick up or down to select "SETUP", then press the joystick to enter.

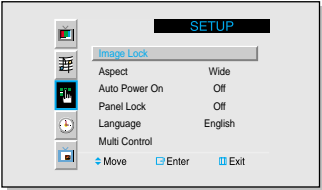

2 Press the joystick to enter.

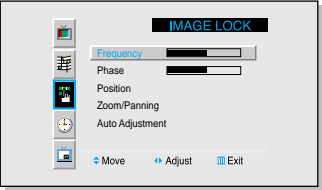

3 Remove picture noise (vertical stripes) on the screen by moving the joystick left or right. (If frequency is not set properly, vertical stripes will appear on the screen.)

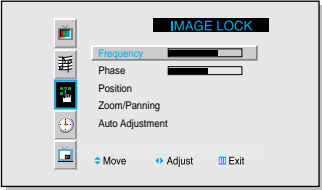

4 Press the Menu button to exit.

Fine Tuning (Phase)

Preset:

- Press the RGB button to select the RGB mode.

1 Press the Menu button. Move the joystick up or down to select "SETUP", then press the joystick to enter.

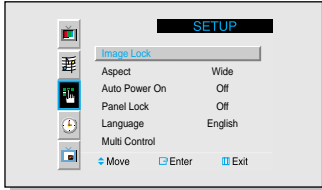

2 Press the joystick to enter.

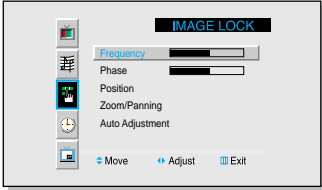

3 Move the joystick up or down to select "Phase". Remove picture noise (vertical stripes) on the screen by moving the joystick left or right. (If phase is not set properly, the picture may be blurry.)

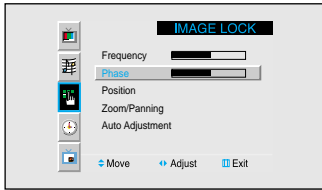

4 Press the Menu button to exit.

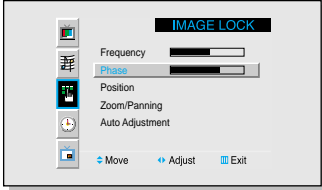



Power Saver (RGB mode only)

This monitor has a built-in power management system called Power Saver. This power management system saves energy by switching your monitor into a low-power mode when it has not been used for a certain amount of time. This power management system operates with a VESA DPMS compliant video card installed in your computer. You use a software utility installed on your computer to set up this feature. See the table below for details.

Table 1. Power-saving modes

State	Normal Operation	Power-saving Function Mode		
		Standby Mode	Suspend Mode Position A1	Power-off Mode Position A2
Horizontal Sync	Active	Inactive	Active	Inactive
Vertical Sync	Active	Active	Inactive	Inactive
Video	Active	Blanked	Blanked	Blanked
Power Indicator	Green	Red Blinking (1 sec Interval)	Red Blinking (1 sec Interval)	Red Blinking (1 sec Interval)

Notes:

- This monitor automatically returns to normal operation when horizontal and vertical sync return.
- This occurs when moving the computer's mouse or pressing a key on the keyboard.
- For energy conservation, turn your monitor OFF when it is not needed, or when leaving it unattended for long periods.

P L A S M A D I S P L A Y P A N E L

Function Description

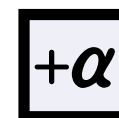

Selecting a Menu Language	62
Setting the Multi Control	63
Digital Noise Reduction	64
Auto Power On	65
Using the Panel Lock	66
Setting up Your Remote Control	67



Selecting a Menu Language

- 1 Press the Menu button. Move the joystick up or down to select "SETUP", then press the joystick to enter.

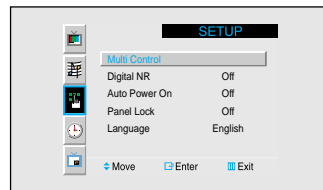

- 2 Move the joystick up or down to select the "Language".

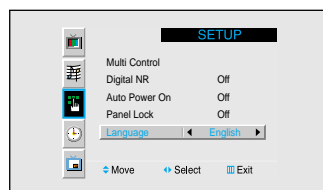

- 3 Move the joystick left or right to select the appropriate language: English, Spanish, or French.

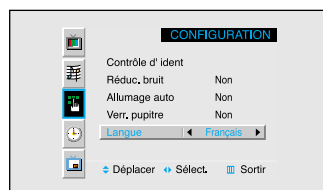

- 4 Press the Menu button to exit.

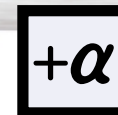

Setting the Multi Control

- 1 Press the Menu button. Move the joystick up or down to select "SETUP", then press the joystick to enter.

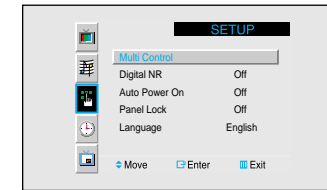

- 2 Press the joystick to enter.

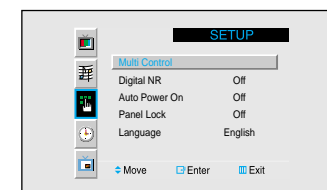

- 3 Enter ID setup number. The ID Setup operates by using only the joystick.

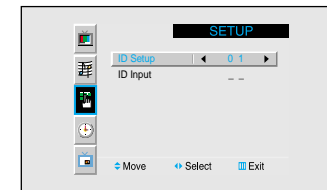

- 4 Move the joystick up or down to select "ID Input", The ID Input operates by using only the numeric buttons.

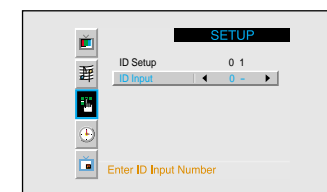

- 5 Enter ID Input and the screen with the set ID number will be switched to the Menu screen.

Note

- To operate the multi control function, PDP1 and PDP2 should be set in the ID Setup mode. When entering the ID Input number of PDP1 while the PDP is set in the ID Input mode, only PDP1 is switched to the Menu screen and you can operate the remote control. At this time, PDP2 doesn't operate with the remote control and displays the standby mode of ID Input. (See the figure of step 4.)



Digital Noise Reduction

If the broadcast signal received is weak, you can activate the Digital Noise Reduction feature to help reduce any static and ghosting that may appear on the screen.

- 1 Press the Menu button. Move the joystick up or down to select "SETUP", then press the joystick to enter.

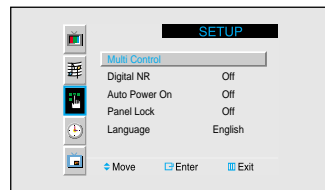

- 2 Move the joystick up or down to select "Digital NR", then move the joystick left or right to select "On" or "Off".

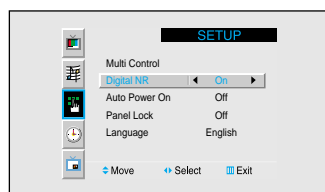

- 3 Press the Menu button to exit.

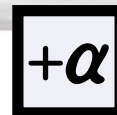

Auto Power On

When you disconnect the power cord and re-connect it, the PDP will be powered on automatically. You don't need to press the 'POWER' button on the front panel or remote control.

- 1 Press the Menu button. Move the joystick up or down to select "SETUP", then press the joystick to enter.

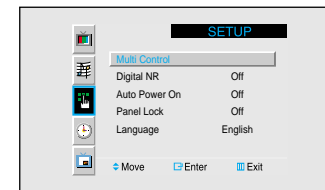

- 2 Move the joystick up or down to select "Auto Power On", then move the joystick left or right to select "On" or "Off".

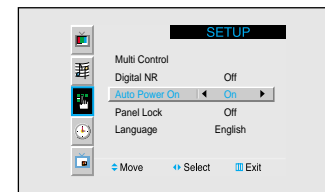

- 3 Press the Menu button to exit.

+α Using the Panel Lock

When Panel Lock is set to ON, the buttons (SOURCE, MENU, VOLUME, SELECT, MUTE, POWER) on the front of the PDP will not operate. However, these buttons will operate when setting Key Lock OFF.

- 1 Press the Menu button. Move the joystick up or down to select "SETUP", then press the joystick to enter.

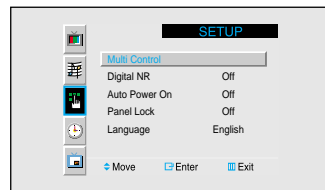

- 2 Move the joystick up or down to select "Panel Lock", then move the joystick left or right to select "On" or "Off".

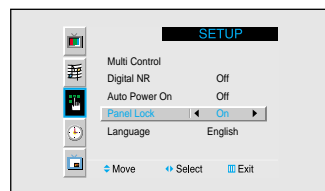

- 3 Press the Menu button to exit.

+α Setting up Your Remote Control

This PDP's remote control can operate almost any VCR, cable box, or DVD. After it has been set up properly, your remote control can operate in four different modes :Monitor, VCR, Cable, or DVD. Pressing the corresponding button on the remote control allows you to switch between these modes, and control whichever piece of equipment you choose.

Note: The remote control may not be compatible with all DVD Players, VCRs, Cable boxes.

Setting Up the Remote to Operate Your VCR, Cable box, or DVD players

- 1 Turn off your VCR. (or Cable box, DVD player.)

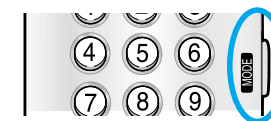

- 2 Press the MODE button and make sure that the VCR (or Cable box, DVD) LED is illuminated.



- 3 Press the Set button on your PDP's remote control.

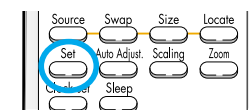

- 4 Using the number buttons on your remote control, enter three digits of the VCR (or Cable box, DVD) code listed on page 68 of this manual for your brand of VCR (or Cable box, DVD player). Make sure you enter three digits of the code, even if the first digit is a "0".
(If more than one code is listed, try the first one.)



- 5 Press the Power button on the remote control. Your VCR (or Cable box, DVD player) should turn on if your remote is set up correctly. If your VCR (or Cable box, DVD player) does not turn on after set up, repeat steps 2, 3, and 4, but try one of the other codes listed for your brand of VCR (or Cable box, DVD player).
If no other codes are listed, try each code, 000 through 089 (or Cable box: 0000 through 077, DVD player: 000 through 008).

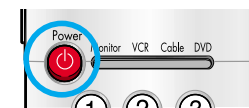

Notes

- When your remote control is in "VCR" mode, the VCR control buttons (Stop, REW, Play/Pause, FF) still operate your VCR.
- When your remote control is in "Cable box" or "DVD" mode, the VCR control buttons (Stop, REW, Play/Pause, FF) still operate your VCR.

S
A
M
S
U
N
G

Remote Control Codes

VCR Codes

Admiral 006, 079	KLH 073	RCA 000, 005, 007, 008, 028, 035, 037, 054, 069
Aiwa 015	LG 009, 014, 046, 060	Samsung 007, 013, 022, 032, 042, 077
Akai 017, 022, 023, 027, 030	Lloyd 015	Sansui 016
Audio Dynamics 014, 016	Logik 031	Sanyo 002, 012
Bell & Howell 002	LXI 015	Scott 013, 041, 049, 068
Broksonic 010	Magnavox 008, 029, 053, 056	Sears 002, 005, 009, 012, 018, 019, 035, 043, 048
Candle 007, 009, 013, 045, 046, 052	Marantz 002, 008, 014, 016, 029, 030, 046, 061	Sharp 006, 027, 039, 045
Cannon 008, 053	Marta 009	Shintom 017, 026, 031, 055
Citizen 007, 009, 013, 045, 046, 052	MEI 008	Signature 015
Colortyme 014	Memorex 008, 009, 012, 015	Sony 017, 026, 038
Craig 007, 012	MGA 027	Sylvania 008, 015, 029, 053, 056
Curtis-Mathes 000, 007, 008, 014, 015, 046, 053, 064, 067	Midland 032	Symphonic 015
Daewoo 013, 045, 076	Minota 005, 035	Tandy 002, 015
DBX 014, 016	Mitsubishi 005, 027, 035, 040	Tashiko 009
Dimensia 000	Montgomery ward 006	Tatung 030
Dynatech 015	MTC 007, 015	Teac 015, 030, 069
Electrohome 027	Multitech 007, 015, 031, 032	Technics 008
Emerson 008, 009, 010, 013, 020, 023, 027, 034, 041, 042, 047, 049, 057, 062, 065, 067, 068, 070	NEC 002, 014, 016, 030, 046, 061, 064	Ternika 008, 009, 015, 021
Fisher 002, 012, 018, 019, 043, 048, 058	Optimus 006	TMK 067
Funai 015	Panasonic 008, 053, 075, 077	Toshiba 005, 013, 019, 048, 049
GE 000, 007, 008, 032, 053	Pentax 005, 035	Totevision 007, 009
Go Video 007	Pentex Reserch+ 046	Unitech 007
Harman Kardon 014	Philco 008, 029, 053, 056	Vector Research 014, 016
Hitachi 005, 015, 035, 036	Philips 008, 029	Victor 016
Instant Replay 008	Pioneer 005, 016, 033, 050	Video Concepts 014, 016
JC Penney 002, 005, 007, 008, 014, 016, 030, 035, 051, 053	Portland 044, 045, 052	Videosonic 007
JCL 008, 002, 014, 016, 030, 046	ProScan 000	Wards 005, 006, 007, 008, 009, 012, 013, 015, 027, 031, 035
JVC 002, 014, 088, 089	Quartz 002	Yamaha 002, 014, 016, 030, 046
Kenwood 002, 014, 016, 030, 046	Quasar 008, 053	Zenith 011, 017, 026, 079
	Radio Shack/Realist 002, 006, 008, 009, 012, 015, 019, 027, 045, 053	

Cable Box Codes

Anvision 007, 008	NSC 009	Signature 046
Cablestar 007, 008	Oak 016, 038	Sprucer 027
Eagle 007, 008	Osk Sigma 016	Starcom 046
Eastern Int. 002	Panasonic 003, 027, 039, 061, 073, 074	Stargate 2000 058
General Instrument 046	Philips 007, 008, 019, 021, 026, 028, 029, 032, 033, 040, 041	Sylvania 011, 059
GI 004, 005, 015, 023, 024, 025, 030, 036, 067, 068, 069	Pioneer 018, 020, 044, 074, 077	Texscan 011, 059
Hamlin 003, 012, 013, 034, 048	Randtek 007, 008	Tocom 017, 021, 049, 050, 055, 073
Hitachi 037, 043, 046	RCA 000, 027, 066	Unika 031, 032, 041
Jerroid 004, 005, 015, 023, 024, 025, 030, 036, 046, 062, 065	Regal 003, 012, 013	Universal 051, 052
Macom 037, 043	Regency 002, 033	Viewster 007, 008, 019, 021, 026, 028, 029, 032, 033, 040, 041
Magnavox 007, 008, 019, 021, 026, 028, 029, 032, 033, 040, 041	SA 070, 071, 072	Warner Amex 044
	Samsung 044, 003, 022, 063, 064	Zenith 014, 042, 057, 061, 075, 076

DVD Codes

Philips 001
Proscan 002
RCA 002
Toshiba 003
Panasonic 004
Sony 008
Samsung 000

P L A S M A D I S P L A Y P A N E L

Multiple Display Control



Introduction	70
Installation	71
Main Screen	74
Beginning	75
Power Control	77
Input Source Control	79
Aspect Ratio Control	81
Time Control	83
Settings Control	84
Troubleshooting	89
Display setup value for display method when there are several Displays.....	90



Introduction

A multiple display control is an application allowing various displays to be easily and simultaneously operated on a PC. RS232C, a standard of serial communication, is used for the communication between a PC and a display. Therefore, a serial cable should be connected between the serial port on a PC and the serial port on a display. Figure 1 shows connections between a PC and a display.

Notes

- Before using the RS232C control function, confirm whenever each ID of the PDPs that you want to control is set or not, and they are individual each other. If not, first set your ID number. (See page 63 'Setting the multi control' in the owner's instructions of your PDP).
- When controlling more than four PDPs or using an extra cable, not the serial cable which is included in PDP, the MDC maybe operate abnormally.

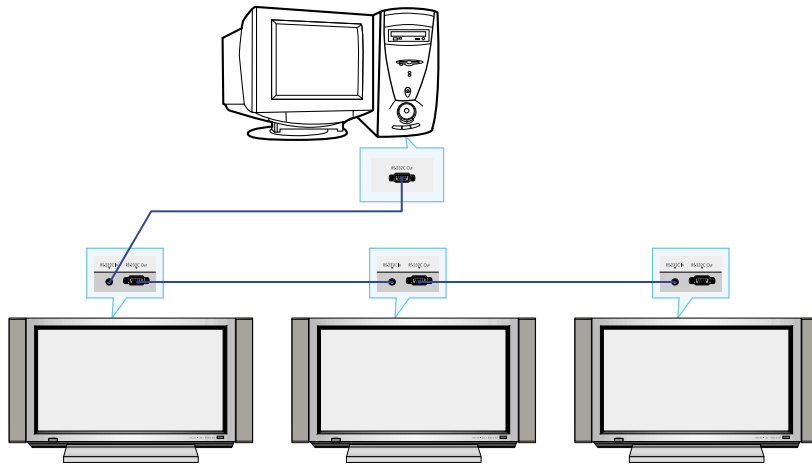

Figure 1. Connections between a PC and a display



Installation

- **Computer Requirements:** Pentium II 64M (at least), Windows 98, ME, or 2000, XP, XP Professional. Resolution 800X600, PC Display 256 color, 4X CD-ROM or higher.
- **Communication Port :** RS-232C Compatible Serial Male Type 9 Pin (Com1).

Note : Samsung warrants that this program can be operated in Samsung PPM42S2 model only. The proper operation of this product will not be guaranteed when users operate this program in other models.

- Click the setup.exe file in CD-ROM, and the following screen appears and then the basic files for setup are copied.

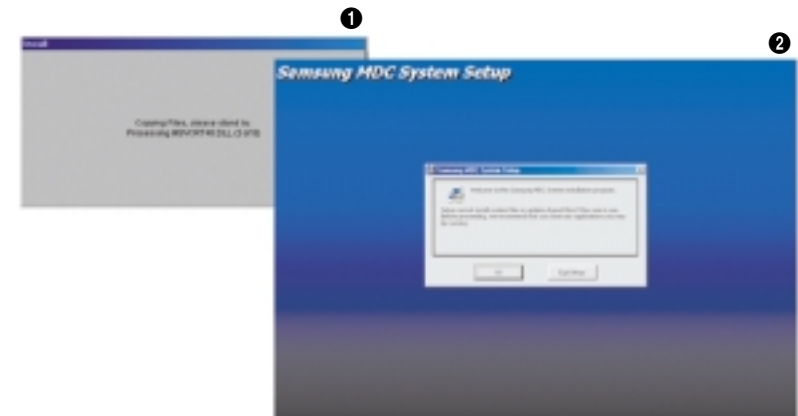

Figure 2-1. Installation Screen

- Select the desired install folder and click on the button to begin setup.

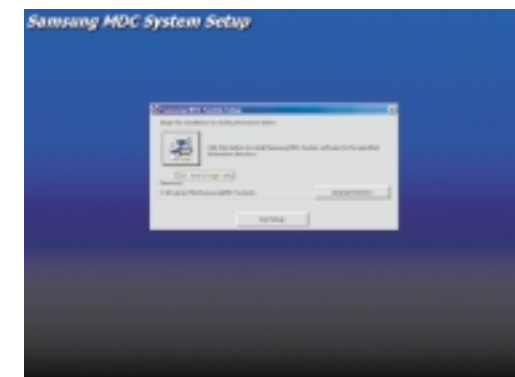

Figure 2-2. Installation Screen



Installation (Continue)

- Select the desired program group and press 'Continue' to continue setup.

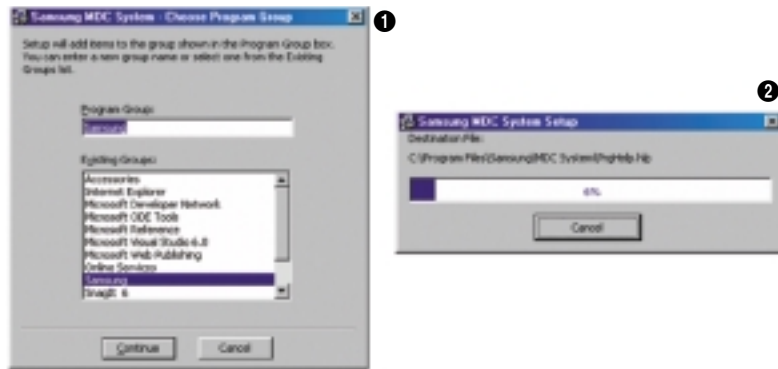

Figure 2-3. Installation Screen

- You may execute the program once installation is complete.

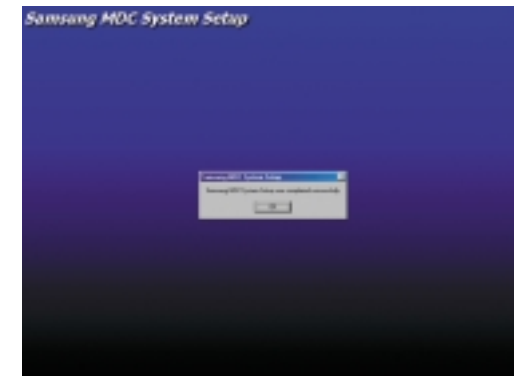

Figure 2-5. Installation Screen

- If the warning 'Version Conflict' appears during installation, it's an indication that the version of the install item conflicts with the system's existing program library. Just press 'Yes' to continue.

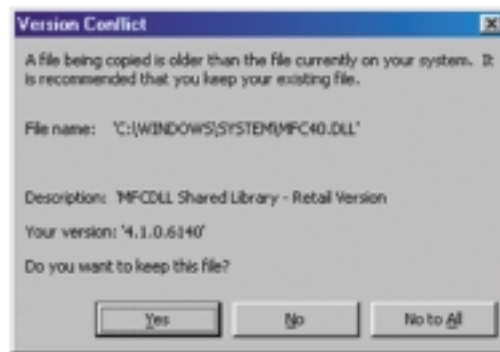

Figure 2-4. Installation Screen



Main Screen

- The program starts operating when entering the following sequence: Start → Program → Multiple Display Control.

Note : The remote control Enable/Disable function operates whether or not the power is On/Off. This applies to all the displays connected to the MDC. However, regardless of the status in which the MDC was shut down, the remote control signal receiving function of all the displays is initialized to Enable when the MDC is closed.

- 1 Main icons : Click the main icons to switch into each screen.
- 2 Display selection : Select a display from Display Selection by marking 'v.'
- 3 Select button : Click Select All, Clear All to select or clear all displays.
- 4 Info grid : Use Info Grid to see the brief information of selected display.
- 5 Control tools : Use Control Tools to control displays.
- 6 Title : The current title to be controlled is displayed.
- 7 Remocon: It allows you to enable or disable the remote control signal receiving function of the display unit.
- 8 Auto Adjustment : Adjusts the picture automatically.

Note : The Auto Adjustment feature operates only in Component2, RGB1, and RGB2.

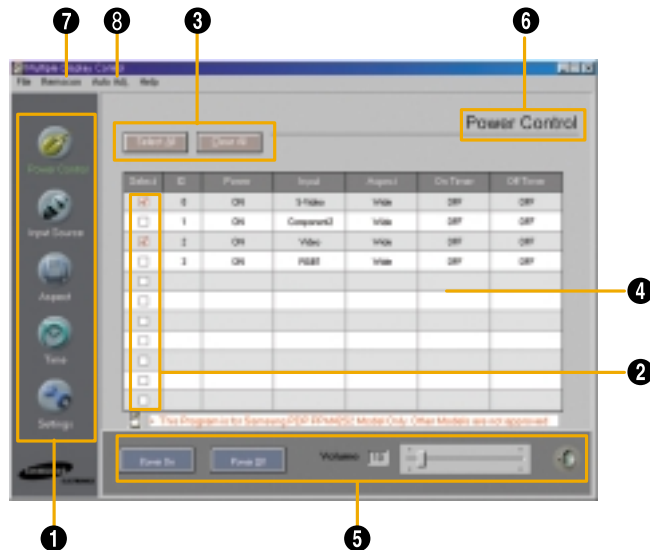

Figure 3-1 Initial Screen

Warning

The remote control receiver's Enable/Disable function operates despite whether the Power is On/Off. This applies to all displays connected to the MDC. However, all displays are initiated with the remote control receiver Enabled despite the status in which the MDC was shut off.



Beginning-Confirming the Port

- The Multiple Display Control uses only Com1. This control operates with neither Com2 nor another port.
- To check which port is installed, enter Control Panel → Device Manager → Ports.
- If another port is installed except the "COM1" port, you can change to "COM1" from the "Device Manager" if you're using Windows 2000 or XP (please refer to the following chapter). For all other operating systems, the change may be made from your PC BIOS Setup.
- Use the Exit menu to end the program. The Help menu shows how to use the program and general information about the program.



Figure 3-2 Device Manager



Beginning-Changing the Port

Note: You can change the port to "Com1" in Windows 2000 or XP. For all other operating systems, the change may be made from BIOS Setup.

- The Multiple Display Control uses only Com1. This control operates with neither Com2 nor another port.
- Enter Control Panel → System → Device Manager → Ports. And then right click to enter Properties → Port Settings Tab → Advanced.
- Select Com1.

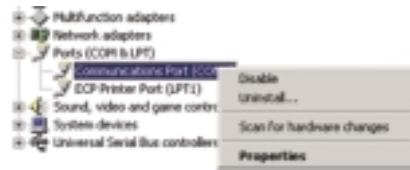

Figure 3-3 Right Mouse Click!

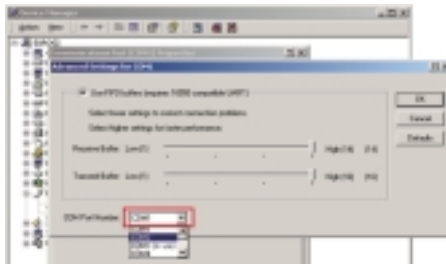

Figure 3-4 Advanced Settings, Choose Com1



Power Control

- Click Power Control of the main icons and the Power Control screen appears.

Info Grid shows some basic information necessary to Power Control.

- 1 Power Status
- 2 Input Source
- 3 Aspect Ratio
- 4 On Timer Status
- 5 Off Timer Status

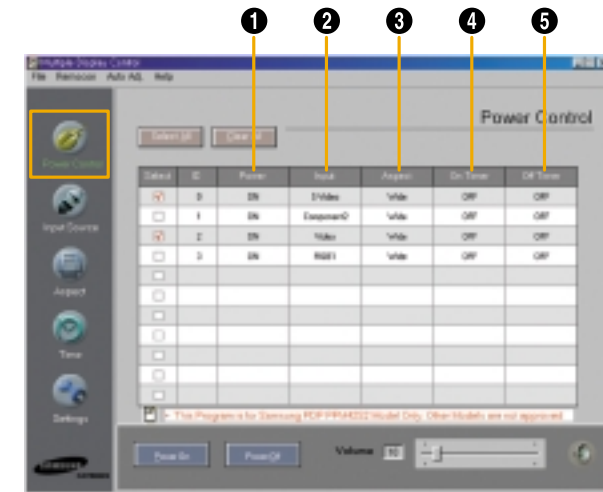

Figure 4-1 Power Control Screen

Displaying the set values of various PDPs.

1. No selection : The default value of the program is displayed.
2. One PDP is selected : The set value of the selected PDP is displayed.
3. One PDP (PDP1) is selected and then another PDP(PDP2) is added : The set value screen on PDP1 is switched into the set value screen on PDP2.
4. 'Select All' is selected to select all PDPs at once : The default value of the program returns.



Plasma Display

Input Source Control

- Click **Select All** or mark 'v' in the check box to select the display you want to control.

Power Control can control some functions of the 'v' marked display.

1 Power On/Off

- Turns On/Off the power of the selected display.
- Power On : Turns on each set at one second interval to prevent the power overload that might occur when many sets turn on at the same time.

2 Volume Control

- Controls the volume of the selected display.
- It receives the volume value of the selected display from the sets and displays it in the slider. (When you release the selection or choose Select All, the value will return to default 10.)

3 Mute On/Off

- Turns On/Off the mute of the selected display.
- When selecting one set at a time, if the relative set is setup on Mute, the Mute will be displayed accordingly. (Default settings will be returned if selection is cancelled or Select All is selected.)

Note: The Volume and Mute functions are available for only the displays are powered ON.
Power Control will operate for all Displays.

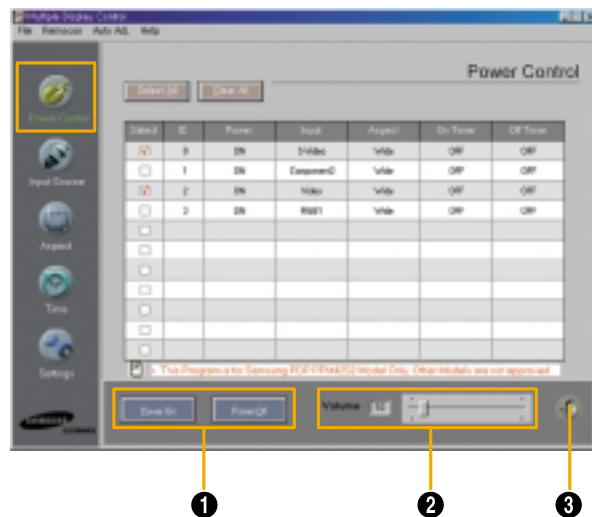

Figure 4-2 Selection Screen of Power Control

- Click **Input Source** of the main icons and the Input Source control screen appears.
- You may only control Displays for which the Power Status is 'ON'.

Info Grid shows some basic information necessary to Input Source control.

1 Power Status

- Shows the power status of the current display.

2 Input Source

- Shows what Input Source is used for the current display.

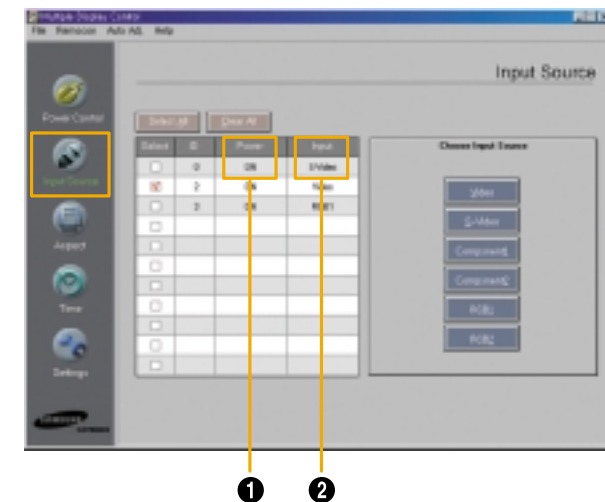

Figure 5-1 Input Source Screen



Plasma Display

Aspect Ratio Control-Video/S-Video

- The Input Source control function is available for only the displays are powered On.
- Click Select All or mark 'v' in the check box to select the display you want to control.

Input Source can control some functions of the 'v' marked display.

- 1 Video**
 - Switches the input source of the selected display into Video.
- 2 S-Video**
 - Switches the input source of the selected display into S-Video.
- 3 Component 1**
 - Switches the input source of the selected display into Component1.
- 4 Component 2**
 - Switches the input source of the selected display into Component2.
- 5 RGB1**
 - Switches the input source of the selected display into RGB1.
- 6 RGB2**
 - Switches the input source of the selected display into RGB2.

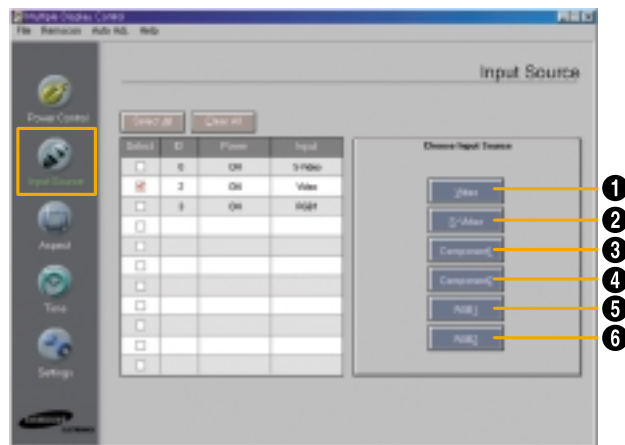

Figure 5-2 Input Source Screen

- Click Aspect of the main icons and the Aspect Ratio control screen appears.
- You may only control Displays for which the Power Status is 'ON'.

Info Grid shows some basic information necessary to Aspect Ratio control.

- 1 Power**
 - Shows the status of power of the current display.
- 2 Aspect**
 - Shows which aspect ratio the current display has.
- 3 Input Source**
 - Shows which input source the current display has.
- 4 Info Grid displays only the display having Video, S-Video, Component 1,2 input source.**
- 5 When clicking Aspect Ratio, the Video, S-Video tab first shows.**
 - The Aspect Ratio Control button can let you control the aspect ratio in Video, S-Video, Component1,2 mode. (The 4:3 mode can't be controlled in Component 2 mode.)
- 6 The Aspect Ratio control button controls Aspect Ratio available for Video, S-Video, Component 1,2.**
- 7 Click RGB1, RGB2 to control Aspect Ratio related to RGB.**

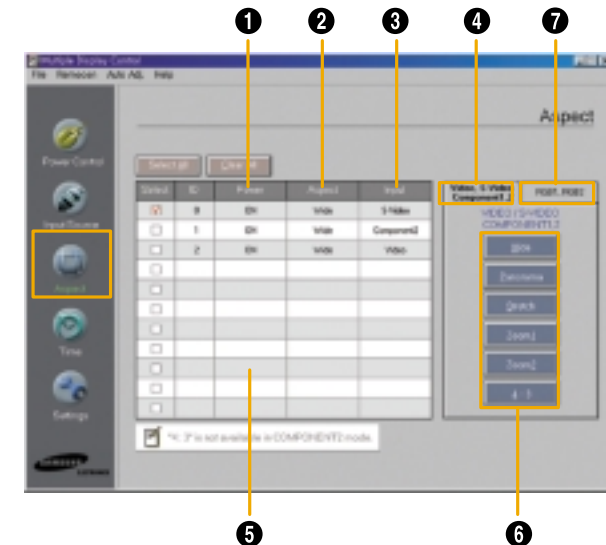

Figure 6-1 Aspect Ratio Screen of Video/S-Video



Aspect Ratio Control-RGB1/RGB2

- Click Select All or mark 'v' in the check box to select the display you want to control.
- You may only control Displays for which the Power Status is 'ON'.

Info Grid shows some basic information necessary to the Aspect Ratio control.

- Click RGB1, RGB2 to control Aspect Ratio related to RGB.
- Info Grid displays only the display having RGB1 or RGB2.
- Click Wide to switch the aspect ratio of the selected display into Wide.
- Click 4:3 to switch the aspect ratio of the selected display into 4:3.

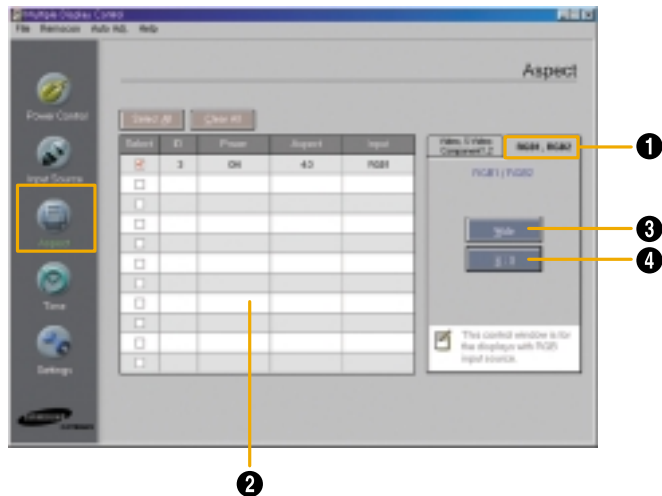

Figure 6-2 Aspect Ratio Screen of RGB1, RGB2.



Time Control

- Click Time of the main icons and the Time control screen appears.
- You may only control Displays for which the Power Status is 'ON'.

Info Grid shows some basic information necessary to the Time control.

- Current Time
 - Set the current time of the selected display. To change the current Time, first change the PC Time.
 - You must change the time setup on your PC to change the time.
- On Time Setup
 - Set the hour, minute of On Time, AM/PM, volume of the selected display.
- Off Time Setup
 - Set the hour, minute of Off Time, AM/PM of the selected display.
- Displays the time in which the system is turned ON according to the On Timer, as well as the On Timer usage status.
- Displays the time in which the system is turned OFF according to the Off Timer, as well as the Off Timer usage status.

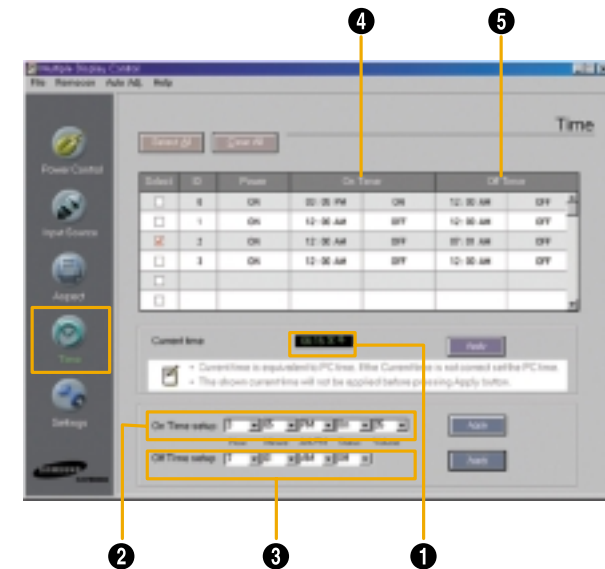

Figure 7. Time control screen of Multiple Display control



Settings Control-Picture

- Click Settings of the main icons and the Settings control screen appears.
- You may only control Displays for which the Power Status is 'ON', and if no item has been selected, the setup will be left on the Factory Default Value.

Info Grid shows some basic information necessary to the Settings control.

When each of functions is selected, the set value of the selected function is displayed on the screen. When 'Select All' is selected, the default value returns. If you change this value in this screen, it switches to CUSTOM in Picture setting mode automatically.

- Picture
 - Control the picture having the Video, S-video, Component 1,2 input source.
- Contrast
 - Adjusts the contrast of the selected display.
- Brightness
 - Adjusts the brightness of the selected display.
- Sharpness
 - Adjusts the sharpness of the selected display.
- Color
 - Adjusts the color of the selected display.
- Tint
 - Adjusts the tint of the selected display.

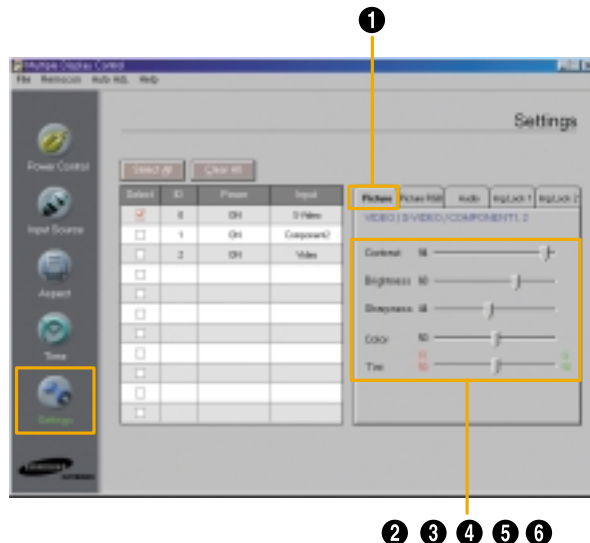

Figure 8-1 Settings Control Screen (Picture)



Plasma Display Settings Control-Picture (RGB)

- Click Settings of the main icons and the Settings control screen appears.
- You may only control Displays for which the Power Status is 'ON', and if no item has been selected, the setup will be left on the Factory Default Value.

Info Grid shows some basic information necessary to the Settings control.

When each of function is selected, the set value of the selected function is displayed on the screen. When 'Select All' is selected, the default value returns. If you change this value in this screen, it switches to CUSTOM in Picture setting mode automatically.

- Picture(RGB)
 - Controls the picture having the RGB1, RGB2 input source.
- Contrast
 - Adjusts the contrast of the selected display.
- Brightness
 - Adjusts the brightness of the selected display.
- Red Gain
 - Adjusts the red gain of the selected display.
- Green Gain
 - Adjusts the green gain of the selected display.
- Blue Gain
 - Adjusts the blue gain of the selected display.



Figure 8-2 Settings Control Screen (RGB Picture)



Settings Control-Audio

- Click Settings of the main icons and the Settings control screen appears.
- You may only control Displays for which the Power Status is 'ON', and if no item has been selected, the setup will be left on the Factory Default Value.

Info Grid shows some basic information necessary to the Settings control.

When each of function is selected, the set value of the selected function is displayed on the screen. When 'Select All' is selected, the default value returns. If you change this value in this screen, it switches to CUSTOM in Sound setting mode automatically.

- 1 Audio**
 - Control the audio of all input sources.
- 2 Treble**
 - Adjusts the treble of the selected display.
- 3 Bass**
 - Adjusts the bass of the selected display.
- 4 Balance**
 - Adjusts the balance of the selected display.

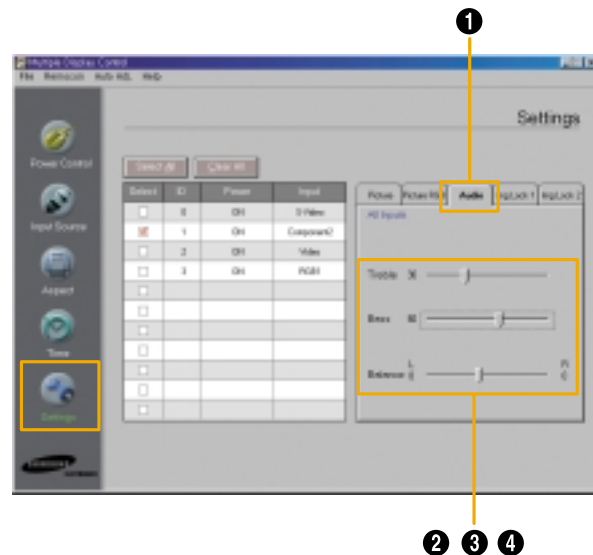

Figure 8-3 Settings Control Screen (Audio)



Plasma Display Settings Control-Image Lock 1 (RGB)

- Click Settings of the main icons and the Settings control screen appears.
- You may only control Displays for which the Power Status is 'ON'.

Info Grid shows some basic information necessary to the Settings control.

- 1 Image Lock 1**
 - Controls the image lock of RGB input source.
- 2 Frequency**
 - Adjusts the frequency of the selected display.
- 3 Phase**
 - Adjusts the phase of the selected display.
- 4 Position**
 - Adjusts the position of the selected display.

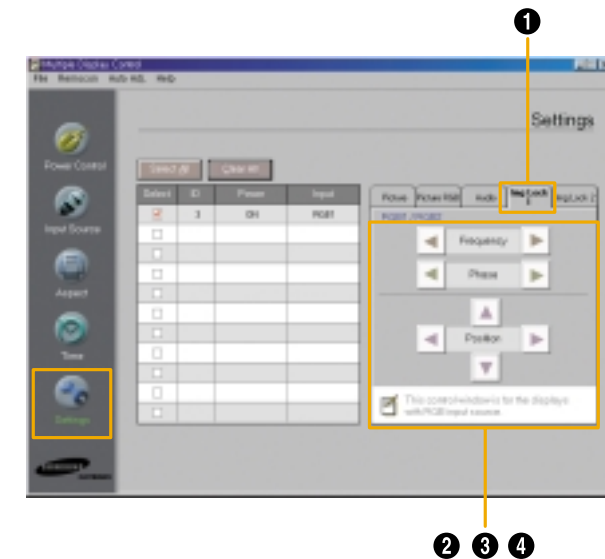

Figure 8-4 Settings Control Screen (Image Lock 1)



Settings Control-Image Lock2 (RGB)

- Click Settings of the main icons and the Settings control screen appears.
- You may only control Displays for which the Power Status is 'ON'.

Info Grid shows some basic information necessary to the Settings control.

- Image Lock 2**
 - Controls the image lock of RGB input source.
- Zoom**
 - Adjusts the zoom of the selected display.
- Panning**
 - Adjusts the panning of the selected display.
(The Panning feature operates only when the picture is expanded.)

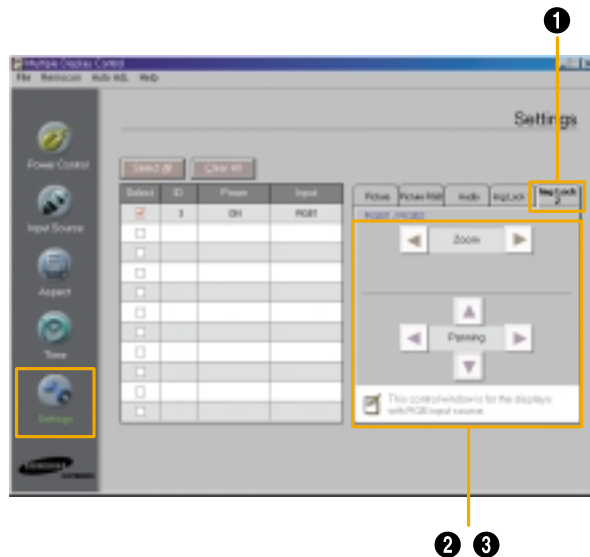

Figure 8-5 Settings Control Screen (Image Lock 2)



Plasma Display

Troubleshooting

- The display you want to control doesn't appear on the power control info grid.
 - Check RS232C is connected to the **Com1** port.
The displays, which have the same Set ID among the connected displays, are not appeared properly in the program.
 - Check the set ID number is within 0 to 10.
(You can adjust the set ID number on the menus of your display.)
The display Set ID should be set to between 0 and 10. If not, the value would be out of the range in MDC system so that the display cannot be controlled. It is ensured that this program can operate up to 4 displays at the same time. It may operate 4 to 10 displays simultaneously but not guarantee proper operation in this model.
- The display you want to control doesn't appear on the other control info grids.
 - Check the display is powered ON. (You can check on the power control info grid.)
 - Check the input source of the display you want to control can be controlled.
- The dialogue box of Figure 9-1 appears repeatedly.
 - Check the display you want to control is marked.
- Both On Timer and Off Timer functions have been set, but a different time is applied.
 - Apply the current time to set the time of each display equal.
- The remote control may not function properly if you disconnect the RS-232C cable or exit from the programs in an irregular manner even with the remote control function is OFF. In this case, rerun the program and turn the remote control function ON to restore normal functions.
- This program might malfunction because of a communicational control between PC and Display or electromagnetic waves from peripherals.
- For further information, contact an authorized Samsung service center.

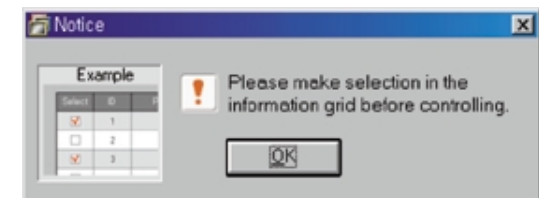

Figure 9-1 Notice Screen



Display setup value for display method when there are several Displays

☐ Display setup value for display method when there are several Displays

- ❶ When no item is selected: displays the Factory Default Value
- ❷ When one Display is selected: displays the setup value for the one item selected
- ❸ When an additional Display (e.g. ID1) is selected while the initial Display (e.g. ID3) has already been selected: the program that had been displaying the setup value for ID1, obtains the setup value for ID3 and displays that value.
- ❹ When all sets have been selected with Select All: returns to the Factory Default Value

P L A S M A D I S P L A Y P A N E L

Appendix



Troubleshooting.....	92
Care and Maintenance	93
Specifications	94



Troubleshooting

Before you call a service technician, please scan this list of problems and possible solutions. It may save you time and money.

Problem	Possible Solution
Poor picture.	Check all wire connections.
The power indicator is blinking.	The monitor is using its power management system. Check the power management utility on your computer.
Your Remote control does not operate the monitor.	Press the "Mode" button to put your remote control in the "Monitor" mode.
The monitor won't turn on.	Make sure the wall outlet is working.
There is no screen image.	Check to see that both the monitor and the source are plugged in and turned on.
The image is too light or too dark.	Adjust the Brightness or Contrast settings.
The image is too large or too small.	Adjust the Size settings.
The message "Check Temp" blinks on the screen and then the picture switches OFF.	The PDP is overheated. Power off the PDP and let it cool for a while.
The message "Check Fan" blinks on the screen and then the picture switches OFF.	The cooling fan of the PDP may have a problem. Contact an authorized service center.
The position and size of picture are distorted.	Adjust the screen correctly referring to "Picture Automatic Adjustment" in page 57.



Care and Maintenance

With proper care, your PDP will give you many years of service. Please follow these guidelines to get the maximum performance from your PDP.

Identifying Problems

- Do not put the PDP near extremely hot, cold, humid or dusty places.
- Do not put the PDP near appliances that create magnetic fields.
- Keep the ventilation openings clear.
- Do not place the PDP on a rough and slanted surface, such as cloth or paper.

Liquids

- Do not place liquids near or on the PDP.

Cabinet

- Never open the cabinet or touch the parts inside.
- Wipe your PDP with a clean, dry cloth. Never use water, cleaning fluids, wax, or chemicals.
- Do not put heavy objects on top of the cabinet.

Temperature

- If your PDP is suddenly moved from a cold to a warm place, unplug the power cord for at least two hours so that moisture that may have formed inside the unit can dry completely.



Specifications



Memo

Exterior design and product specifications are subject to change without prior notice to improve the performance of this product.

This is a Class A system so that it can be used in industrial areas.
(Note : Class A systems are for business use.)

Model	PPM42S2	
Dimensions	Display	1038 (W) X 89 (D) X 635 (H) mm ; 40.90 (W) X 3.50 (D) X 25.00 (H) inches
	Remote Control	54 (W) X 31.5 (D) X 220 (H) mm ; 2.13 (W) X 1.24 (D) X 8.66 (H) inches
Weight	Display	32kg ; 70.55lbs
	Remote Control	150g (including batteries) ; 0.33lbs
Voltage	100-240V~, 50/60 Hz, 4A	
Power Consumption	310 Watts	
Number of Pixels	852(H) x 480(V)	
Screen Size	106 Cm/42 inches	
RGB input	RGB1 : D-SUB 15P RGB2 : BNC (R/G/B/H(CS)/V) VIDEO : ANALOG 0.714V _{pp} / 75Ω (Terminated) SYNC(H,V)	
VIDEO input	VIDEO : 1.0 0.714V _{pp} / 75Ω (BNC) S-VIDEO : Y → 10V _{pp} / 75Ω C → 0.28V _{pp} / 75Ω COMPONENT1 (Y/C _b /C _r) · 480i : Y → 1.0V _{pp} / 75Ω C _b → 0.28V _{pp} / 75Ω C _r → 0.28V _{pp} / 75Ω COMPONENT2 (Y/P _b /P _r) · 480p/720p/1080i: Y → 1.0V _{pp} / 75Ω P _b → 0.28V _{pp} / 75Ω P _r → 0.28V _{pp} / 75Ω	
AUDIO input	VIDEO/S-VIDEO COMPONENT 1/2 PC(RGB1/2)	
AUDIO output	7W + 7W (8Ω)	