



***Blackhawk
Automotive*** TM

Blackhawk Automotive is a Licensed Trade Mark

Made by ©SFA Companies, Kansas City MO

3/4 Ton Heavy Duty Wheel Dolly

Operating Instructions & Parts Manual

BH8075

SFA Companies ©2004

10939 N. Pomona Ave. Kansas City, MO 64153

816-891-6390

sales@blackhawk-automotive.com

- Before using this product, read this manual and follow all its Safety Rules and Operating Instructions

Made in PRC

TABLE OF CONTENTS

Warranty	P2
Save These Instructions	P3
Product Description	P3
Specifications	P3
Safety Instructions	P4
Assembly	P4
Operation	P5
Maintenance	P5
Troubleshooting	P5
Replacement Parts	P6



ONE YEAR LIMITED WARRANTY

For a period of one (1) year from date of purchase, SFA Companies will repair or replace, at its option, without charge, any of its products which fails due to a defect in material or workmanship, or which fails to conform to any implied warranty not excluded hereby.

Performance of any obligation under this warranty may be obtained by returning the warranted product, freight prepaid, to SFA Companies Warranty Service Department, 10939 N. Pomona Ave., Kansas City, MO 64153. Except where such limitations and exclusions are specifically prohibited by applicable law:

- (1) THE CONSUMER'S SOLE AND EXCLUSIVE REMEDY SHALL BE THE REPAIR OR REPLACEMENT OF DEFECTIVE PRODUCTS AS DESCRIBED ABOVE.
- (2) SFA COMPANIES SHALL NOT BE LIABLE FOR ANY CONSEQUENTIAL OR INCIDENTAL DAMAGE OR LOSS WHATSOEVER.
- (3) THE DURATION OF ANY AND ALL EXPRESSED AND IMPLIED WARRANTIES, INCLUDING WITHOUT LIMITATION, ANY WARRANTIES OF MERCHANTABILITY AND FITNESS FOR A PARTICULAR PURPOSE, IS LIMITED TO A PERIOD OF ONE (1) YEAR FROM DATE OF PURCHASE.

Some states do not allow limitations on how long an implied warranty lasts, so the above limitation may not apply to you. Some states do not allow the exclusion or limitation of incidental or consequential damages, so the above limitation or exclusion may not apply to you. This warranty gives you specific legal rights, and you may also have other rights which vary from state to state.

SAVE THESE INSTRUCTIONS

For your safety, read and understand the information contained within. The owner and operator shall have an understanding of this product and safe operating procedures before attempting to use this product. Instructions and Safety information shall be conveyed in the operators native language before use of this product is authorized. Make certain that the operator thoroughly understands the inherent dangers associated with the use and misuse of the product. If any doubt exists as to the safe and proper use of this product as outlined in this factory authorized manual, remove from service immediately.

Inspect before each use. Do not use if broken, bent, cracked or otherwise damaged parts are noted. If the dolly has been or suspected to have been subjected to a shock load (a load dropped suddenly and violently upon it), discontinue use until checked out by qualified personnel. Owners and operators of this equipment shall be aware that the use and subsequent repair of this equipment may require special training and knowledge. It is recommended that an annual inspection be done by qualified personnel and that any missing or damaged parts, decals, warning/ safety labels or signs be replaced with Blackhawk Automotive replacement parts only. Any dolly that appears to be damaged in any way, is worn or operates abnormally shall be removed from service immediately until such time as repairs can be made. Labels and Operator's Manuals are available from the manufacturer.

PRODUCT DESCRIPTION

Blackhawk Automotive Wheel Dolly is designed to facilitate the removal and installation of pneumatic tires and wheel assemblies on trucks, buses and trailers. It is a labor saving device useful in auto shops, bus barns and fleet service.

SPECIFICATIONS

Model	Capacity	Product Size (L X W X H)	Lifting Range	Tilt Range	Net Weight
BH8075	3/4 Ton (1500 Lbs)	39 7/8" X 43" X 33 1/4"	3 1/2" ~ 11 3/4" (12 5/8" w/ext. screw)	-2.5° ~ 10°	131.2 Lbs

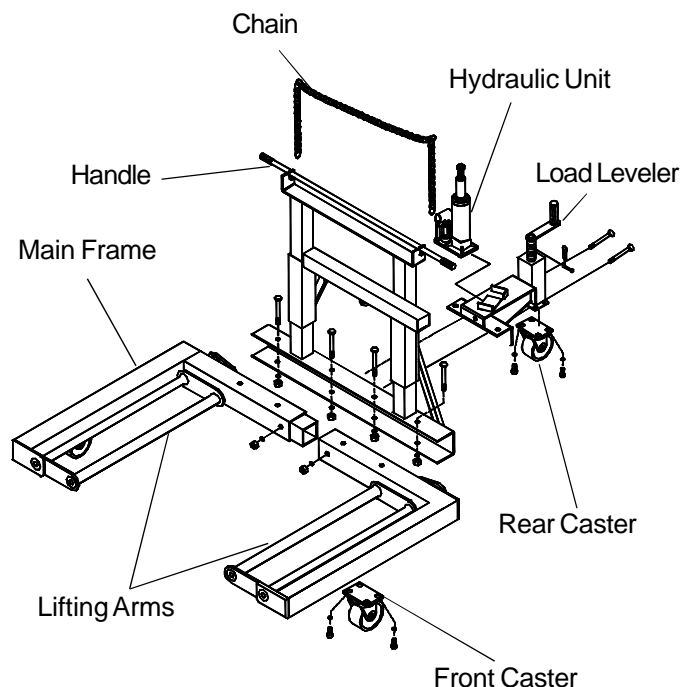

Figure 1 - Model BH8075 Components

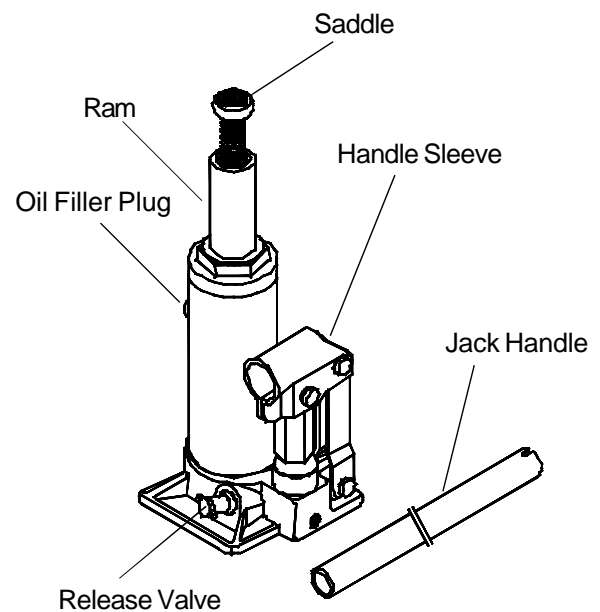

Figure 2 - Model BH8075 Hydraulic Unit Components

SAFETY INSTRUCTIONS (refer to Figure1 for location of components)

BEFORE USE

1. Inspect before each use. Do not use if bent, broken, leaking or cracked components are noted. Ensure the casters and lifting arms move freely. Check and tighten any loose assemblies.
2. Verify that the product and the application are compatible, if in doubt call Blackhawk Automotive Technical Service (816)891-6390.
3. Read, understand and follow vehicle manufacturer's recommended tire change procedures.
4. With hydraulic unit in fully lowered position, locate and remove oil filler plug.
5. Pump 6 to 8 strokes. This will purge the hydraulic system of pressurized air trapped in reservoir. Check fluid level. Proper level is even with filler plug hole.
6. Reinstall oil filler plug.

WARNING

- Read and understand all warnings and instructional material provided on and with this product before use.
- Do not exceed rated capacity.
- Thoroughly familiarize yourself with this product before use.
- Use only on smooth, hard, level surfaces capable of sustaining the load.
- Before moving, lower the load to the lowest possible point and assure that the load is centered and secured with a load restraint device.
- Apply load as close to the vertical position of the lifting arms as possible.
- No alterations shall be made to this product.
- Failure to heed this warning may result in severe injury as well as property damage.

ASSEMBLY (refer to Figure 3)

1. Attach front casters (No. 3) into right main frame (No. 4) and left main frame (No. 18) with M12x25 bolts and washers (No. 1 & 2).
2. Attach rear caster (No. 11) into rear support assembly (No. 12), with M18x20 bolts and washers (No. 9 & 10).
3. Insert left main frame (No. 18) to the right main frame (No. 4).
4. Attach upright assembly (No. 6) and rear support assembly (No. 12) into the main frame assembly with M14x115 bolts, washers and nuts (No. 8, 19 & 5).
5. Attach support link (No. 7) into upright assembly and main frame with bolts, washers and nuts provided.
6. Attach power unit (No. 16) onto the upright assembly.

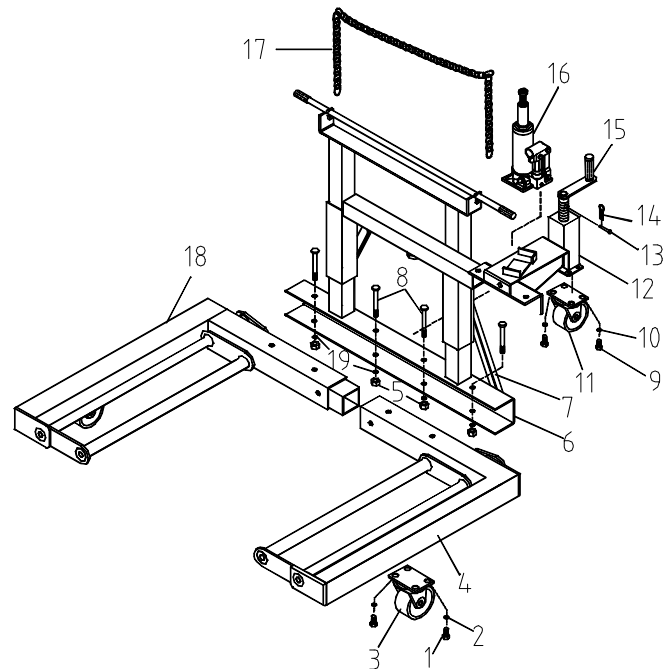

Figure 3 - Assembly Illustration for Model BH8075

OPERATION

1. Set emergency brake, chock tires of diagonally opposed wheel(s) in both directions AND take every precaution necessary to ensure set up is stable and prevent inadvertent vehicle movement.
2. When tire & wheel assembly are ready to remove, position wheel dolly to accept tire & wheel assembly and secure load with restraint.
3. Use jack handle to turn release valve clockwise until tight. DO NOT OVERTIGHTEN. Insert hydraulic unit handle into handle sleeve of hydraulic unit and pump until lifting arms reaches desired height.

Note. Do not use wheel dolly to free a seized up wheel assembly. For typical practice of taking out a seized up wheel assembly, a long metal bar can be used to pry the wheel assembly from the stuck wheel axle. If in doubt, always follow vehicle's manufacturer manual on how to remove tire and wheel assembly.

4. Use load leveler to prepare dolly for moving. Carefully move loaded wheel dolly away from hub.
5. To Install, reverse order.

CAUTION: Before moving loaded Wheel Dolly, always secure the load with provided chain.

MAINTENANCE

Periodically check hydraulic unit fluid level. Level of fluid should be even with filler plug hole. We recommend Hein-Werner HW93291 or equivalent.

Note: Never fill hydraulic unit with alcohol, glycerin, brake fluid, transmission fluid. Damage to jack's load bearing capabilities can result if other than good grade hydraulic jack fluid is used.

TROUBLESHOOTING

Symptom	Possible Causes	Corrective Action
Hydraulic unit will not lift load	<ul style="list-style-type: none">• Release valve not tightly closed• Overload condition	<ul style="list-style-type: none">• Ensure release valve tightly closed• Remedy overload condition
Hydraulic unit bleeds off after lift	<ul style="list-style-type: none">• Release valve not tightly closed• Overload condition• Hydraulic unit malfunction	<ul style="list-style-type: none">• Ensure release valve tightly closed• Remedy overload condition• Contact Blackhawk Tech. Service
Hydraulic unit will not lower after unloading	<ul style="list-style-type: none">• Reservoir overfilled• Linkages binding	<ul style="list-style-type: none">• Drain fluid to proper level• Clean and lubricate moving parts
Poor performance	<ul style="list-style-type: none">• Fluid level low• Air trapped in hydraulic unit system	<ul style="list-style-type: none">• Ensure proper fluid level• With ram fully retracted, remove oil filler plug to let pressurized air escape, rein stall oil filler plug
Hydraulic Unit will not lift to full extension	<ul style="list-style-type: none">• Fluid level low	<ul style="list-style-type: none">• Ensure proper fluid level

REPLACEMENT PARTS (See attached exploded drawing)

When ordering replacement parts, please refer to the model number / serial number found on the product, then give the part number and description.

Available Parts: Please refer to the Parts drawing when ordering parts. Not all components of the wheel dolly are replacement items, but are illustrated as a convenient reference of location and position in the assembly sequence. When ordering parts, give Model number, serial number and description below. Call or write for current pricing: SFA Companies 10939 N. Pomona Ave. Kansas City, MO 64153, U.S.A. Tel:(816)891-6390 Fax:(816)891-6599

E-Mail: sales@blackhawk-automotive.com

Model BH8075

Item #	Part #	Description	Qty.
1	T5900-07-00000	Hydraulic Unit	1
2	T5900-08-00000	Front Caster (3 1/2")	2
3	T5900-09-00000	Rear Caster (5 1/2")	1
4	T5900-10-00000	Chain	1
-	B02-0-2000-0000	Jack Handle (not shown)	1
-	BH8075-L0	Label (not shown)	1
-	BH8075-M0	Owner's Manual	1
-	T5900-99-00000	Hardware Kit (not shown)	all nuts & belts

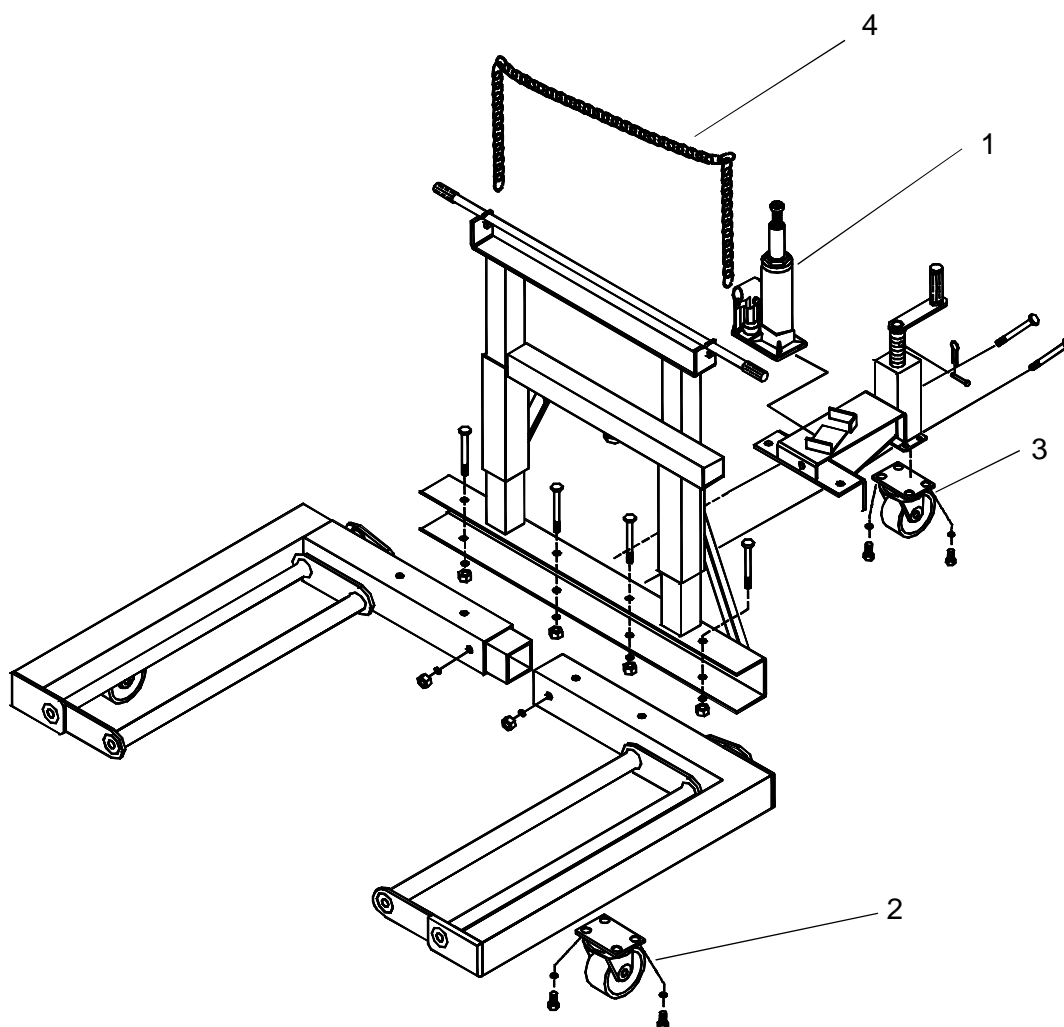

Figure 4 - Replacement Parts Illustration for Model BH8075

[illegible]

This image shows a blank sheet of white paper with horizontal ruling lines. The lines are evenly spaced and run across the width of the page. There are no margins, text, or other markings on the paper.