

MATCH  **LINE**



- **Double window two-tuner PIP** for watching two shows, side by side, without a VCR!
Two separate tuners let you select two shows and display both in windows of equal proportion.
- **Digital comb filter** with digital circuitry clearly separates black and white detail from color data virtually eliminating dot crawl and delivering unmatched, razor-sharp picture performance with 800+ lines of horizontal resolution.
- **Multipoint digital convergence** with 15 points adjustment across the entire screen and brings with it digital accuracy for flawless convergence of red, green, blue guns for a superb picture with no haloes.
- **Virtual Dolby® Surround** allows you to create the sensation of Dolby* Pro-Logic Surround sound with just the front speakers for materials encoded with Dolby Pro-Logic or Dolby Surround.
- **SmartScreen™ (Contrast Enhancement Filter)** filter/protector has been specially formulated by Philips to give better contrast, maximise light output and protect the intricate Lenticular screen.



Let's make things better.



PHILIPS



Other Key Features

- **Digital Prepared Connections**
Supports virtually any digital device on the market through a range of connectors including Component Video, S-Video, and video inputs.
- **MagnaBrite™ Lenses**
Using Delta 77/78 lens, the undisputed industry standard in optics, the MagnaBrite™ Lens system achieves more consistent edge-to-edge brightness and contrast with a dramatically reduced focal length—result is crisp, well-defined large screen images and slim cabinet design.
- **Incredible Surround™**
An exciting psycho-acoustic method of widening the stereo spatial image for full-impact home entertainment.

- **SmartSurf™**
Simplify channel surfing by storing up to ten favourite stations in the Surf™ memory and then surfing only those channels at the touch of a button. Add or delete channels from list through onscreen display.
- **SmartSound Plus™**
Instantly optimize sound to satisfy any program situation. Select from one of four factory settings including movies, music, voice, or personal with a variety of combination of ultra bass, treble, and automatic volume leveling to suit any taste.

- **SmartPicture™**
- **Black Stretch**
- **Blue Stretch**
- **Green Stretch**
- **DNR (Digital Noise Reduction)**
- **ChildLock™**
- **Multilingual Onscreen Display**
- **Subwoofer Output**
- **Center Channel Input**
- **160° wide-angle screen**
- **550 foot lamberts peak brightness**
- **4-speaker system with two 5" woofers and two 2" tweeters**

Technical specifications

Display

- Projection Display : three 7" CRTs
- Visible Diagonal : 50"/127cm
- Viewing Angle : Horizontal 160 degree
- Contrast Filter/Protector
- .72mm Lenticular screen
- Delta 77/78 Lenses

Picture

- Incredible Picture
- Scavem
- Digital Combfilter
- Luminance Transient Improvement
- Colour Transient Improvement
- Digital Noise Reduction
- 3 position Color Temperature
- Histogram
- Skin Tone Correction
- Green Stretch
- Blue Stretch

Sound

- Virtual Dolby Surround
- Incredible Surround
- Bass Boost
- Subwoofer Output
- Center Channel input
- Double Window PiP Headphone sound
- Audio Out - Fixed/Variable
- Sound output - 2 x 15 RMS
- 2 x 2" Tweeters
- 2 x 5" Woofers

Features

- Double Window PiP
- MultiPoint Customer Convergence
- 100 page Teletext (when available) for /69, /79

Ease of Use

- Smart Picture (4 modes)
- Smart Sound (4 modes)
- Multi-language OSD & menu control
- Remote Control
- Sleep timer
- Childlock

Connectivity

- **Rear:** Monitor Out - CVBS + Audio L/R
AV1 in - YUV + CVBS + Audio L/R
AV2 in - CVBS + Y/C + Audio L/R
Antenna input: 75 ohm (Coax)
Subwoofer out (cinch)
Center Channel In (click fits)
- **Side:** AV input:
CVBS + Y/C + Audio L/R
Headphone output with volume (on menu)

Reception

- Tuning system: PLL
- Colour transmission system off-air:
PAL B/G/I/D/K, SECAM B/G/D/K
- A/V connections:
NTSC 3.58/4.43, PAL60
- Stereo sound transmissions systems off-air:
NICAM B/G/I/D/K, 2CS B/G/D/K
- Channel selections:
VHF, UHF, S-Channels, Hyperband

Miscellaneous

- Mains : AC 90-276V, 50/60 Hz
: (except for /93AC160-276V, 50/60 Hz)
- Power Consumption :
- Operating : 235 Max Watt (estimated)
 - Standby : 1 Watt
- Net Weight : 83 Kg (approx)
- Gross Weight : 96 Kg (approx)
- Set Dimension : 1130 x 1476 x 613
(W x H x D mm)
- Box Dimension : 1238 x 1514 x 762
(W x H x D mm)
- Container Loading : 23 sets
(per 40ft)

Carton Contains: 50" Large Screen TV, Universal TV/VCR/DVD/DBS/CBL Remote Control w/Batteries, Operating Instructions, Warranty Information

SmartSound Plus, SmartPicture, SmartSurf, ChildLock, SmartMute, MagnaBrite, Incredible Picture, and Incredible Surround are trademarks of Philips Consumer Electronics Company. As an ENERGY STAR® Partner, Philips has determined that this product meets the ENERGY STAR® guidelines for energy efficiency. dbx is a registered trademark of dbx, Inc. Sunnyvale, CA. 'Dolby' and the double-D symbol are trademarks of Dolby Laboratories.

Audio/Video Jack Panel

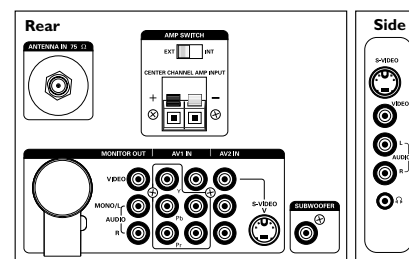

This television receiver provides display of television closed captioning in accordance with §15.119 of the FCC rules

Specifications are subject to change without prior notice
Website address: <http://www.philips-star.com>

Let's make things better.



PHILIPS