

# Quick Use and Setup Guide



**PHILIPS**

## CONTENTS

Important Notice/Warning .....	1
Hooking up the TV .....	1-2
Operating the Television and Remote Control .....	2-4
Using the Installation Features .....	4-6
Using the Picture-in-Picture (PIP) Feature .....	7
Adjusting the Manual Converge Controls.....	8

As an Energy Star® Partner, Philips Consumer Electronics has determined this product meets the Energy Star® guidelines for energy efficiency. Energy Star® is a U.S. registered mark. Using products with the Energy Star® label can save energy. Saving energy reduces air pollution and lowers utility bills.

## IMPORTANT

**This owner's manual is used with several different television models. Not all features (and drawings) discussed in this manual will necessarily match those found with your television set. This is normal and does not require that you contact your dealer or request service.**

**WARNING: TO PREVENT FIRE OR SHOCK HAZARD DO NOT EXPOSE THIS UNIT TO RAIN OR EXCESSIVE MOISTURE.**



## HOOKING UP THE TV

### BEST VIEWING

The major benefit of this projection television is its large viewing screen. To see this large screen at its best, test various locations in the room to find the optimal spot for viewing.

**NOTE:** Be sure to allow a free flow of air to and from the perforated back cover of the set.

To avoid cabinet warping, cabinet color changes, and increased chance of set failure, do not place the TV where temperatures can become excessively hot—for example, in direct sunlight or near a heating appliance.

Magnetic fields, such as those of external speakers, may cause the picture to distort if the speakers are placed too close to the television. Move the magnetic field source away from the TV until there is no picture distortion.

### CABLE TV

This connection WILL supply Stereo sound to the TV.

- 1 Connect the cable TV signal to the ANTENNA IN 75Ω jack on the back of the TV.

**NOTE:** Refer to the sections on TUNER MODE and AUTO PROGRAM on pages 4 and 5 of this guide. Set TUNER MODE to the CABLE option. Run AUTO PROGRAM to store all available cable channels in the TV's memory.

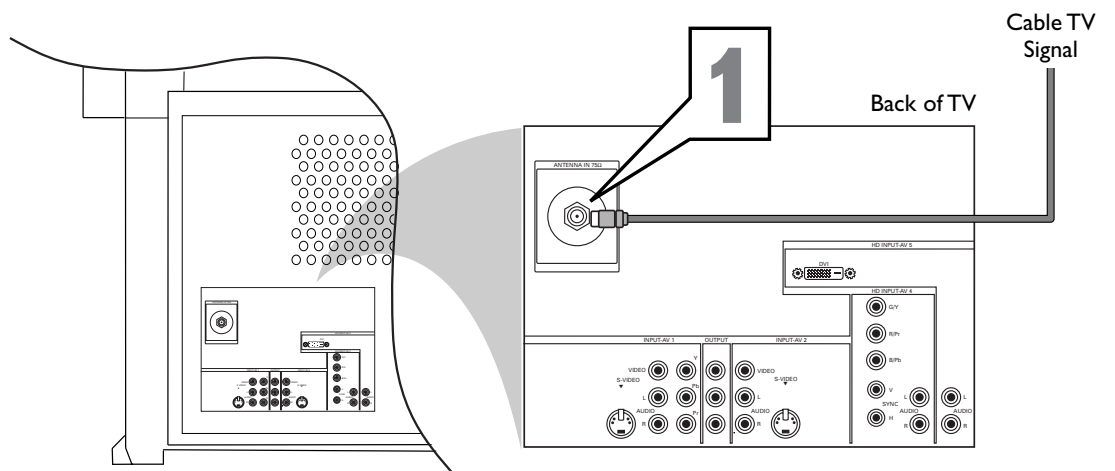

### CABLE BOX WITH RF IN/OUT

This is for example purposes only. The back of your cable box may be labeled somewhat differently.

This connection WILL NOT supply stereo sound to the TV.

- 1 Connect the cable TV signal to the CABLE IN jack on the back of the cable box.
- 2 Connect a coaxial cable (not supplied) to the TO TV jack on the back of the cable box and to the ANTENNA IN 75Ω jack on the back of the TV.
- 3 Be sure to set the Output Channel switch on the back of the cable box to CH 3 or 4, then tune the cable box on the TV to the corresponding channel. Once tuned, change channels at the cable box, not the TV.

**NOTE:** Refer to the sections on TUNER MODE and AUTO PROGRAM on pages 4 and 5 of this guide. Set TUNER MODE to the CABLE option. Run AUTO PROGRAM to store all available cable channels in the TV's memory.

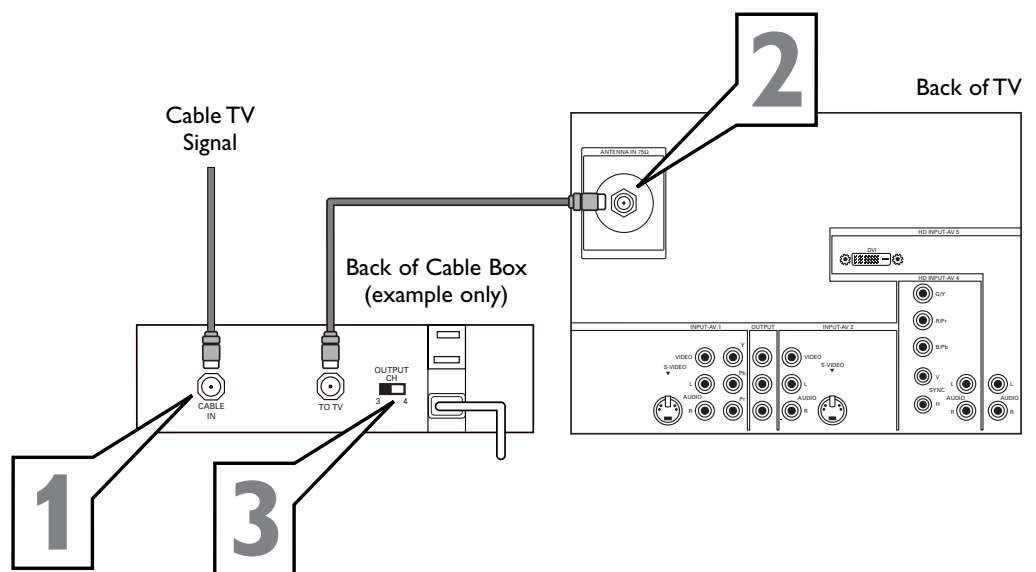

### CABLE BOX WITH A/V OUTPUTS

This is for example purposes only. The back of your cable box may be labeled somewhat differently.

This connection MIGHT supply stereo sound to the TV. Check with your cable TV company.

- 1 Connect the incoming cable TV signal to a signal splitter.
- 2 Connect a coaxial cable to a connector on the signal splitter and to the ANTENNA IN 75Ω jack on the back of the TV.
- 3 Connect a coaxial cable to a connector on the signal splitter and to the CABLE IN jack on the back of the cable box.
- 4 Connect A/V cables to the VIDEO and AUDIO L and R outputs on the back of the cable box and to the AV2 VIDEO and corresponding AUDIO L and R jacks on the back of the TV.
- 5 To view programs from your cable box, plug in the TV, turn it on, and then press the AV button on the remote control as many times as necessary to select the AV2 input source.

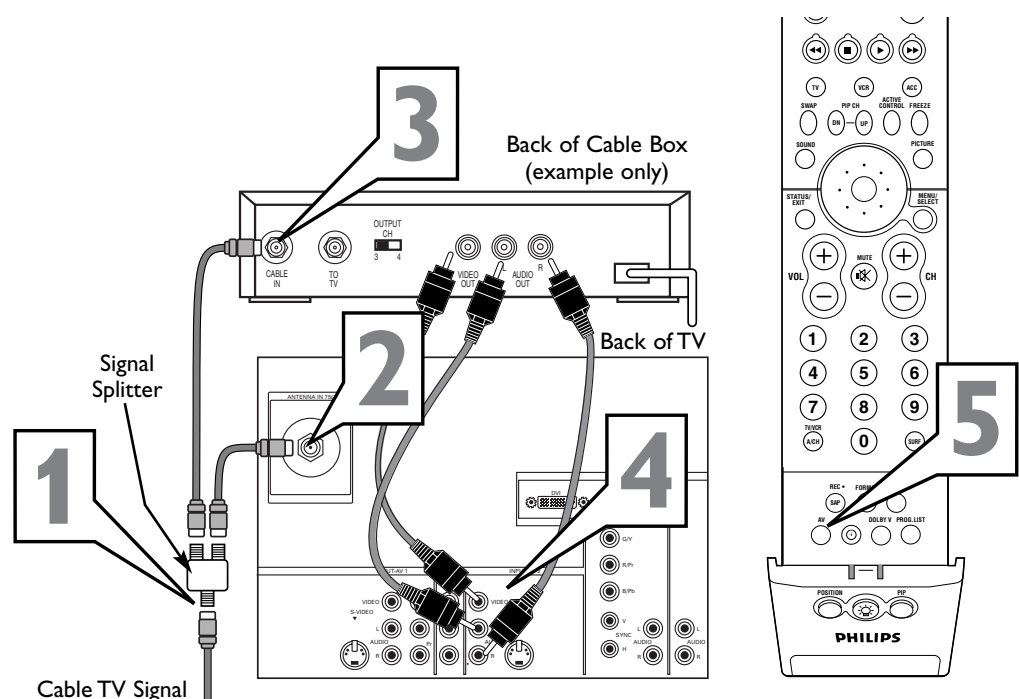



# HOOKING UP THE TV

## ANTENNA TV

This connection WILL supply stereo sound to the TV.

- 1 Connect the antenna signal to the ANTENNA IN 75Ω jack on the back of the TV.

**NOTE:** Refer to the sections on TUNER MODE and AUTO PROGRAM on pages 4 and 5 of this guide. Set TUNER MODE to the ANTENNA option. Run AUTO PROGRAM to store all available cable channels in the TV's memory.

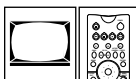
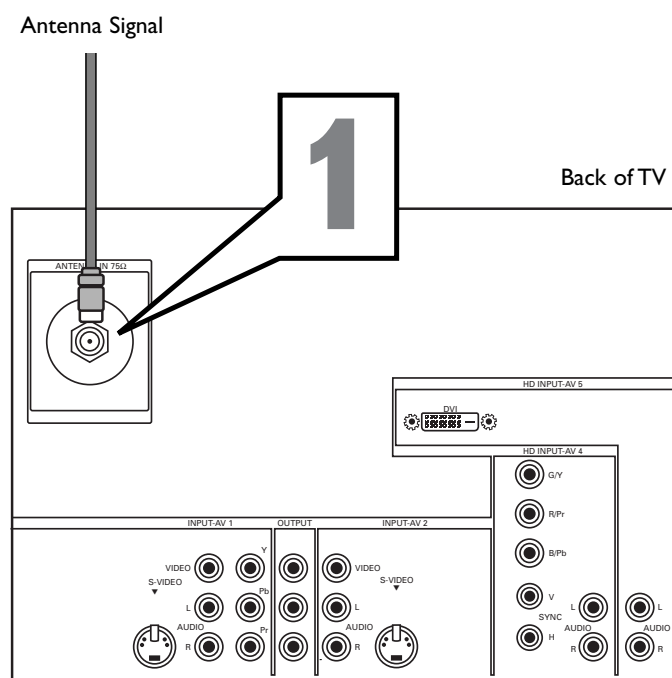

# OPERATING THE TELEVISION AND REMOTE CONTROL

## TELEVISION

### USING THE TV BUTTONS

Should your remote control be lost or broken, you can still change some of the basic picture and sound settings with the buttons on the TV. Follow the steps below to familiarize yourself with the functions of the TV buttons.

- 1 Press **POWER/STANDBY** to turn the TV on (or off). Allow about 10 seconds for the TV to power on.
- 2 Press the **VOL(ume) +** or **-** buttons to decrease or increase the sound level.  
  
Press the **VOLUME +** and **-** buttons simultaneously to display the on-screen menu. After the menu appears, use these buttons to enter submenus and make selections or adjustments. (Use the **CHANNEL** buttons to move up and down in the menu or submenus.) Press both **VOLUME** buttons simultaneously to back out of the on-screen menus.
- 3 Press **SOURCE SELECT** to choose from among the signal inputs you have connected to the TV.
- 4 Press the **CHANNEL** buttons to select TV channels.

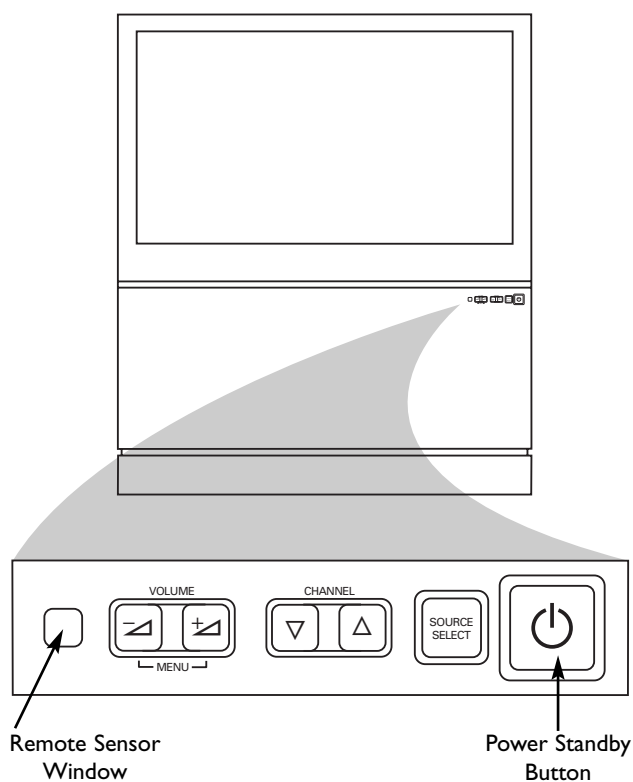

### HELPFUL HINT

You can press any of the buttons on the front of the TV to turn the TV on, but you must press the Power/Standby button to turn the set off.

## REMOTE CONTROL

### INSTALLING BATTERIES

To load the supplied batteries into the remote, follow these steps.

- 1 Gently press and hold the indentation on the back of the remote and slide the battery cover off the remote.
- 2 Place the two "AA" size batteries in the remote's battery case. Ensure that the (+) and (-) ends of the batteries line up correctly with the (+) and (-) inside the case.
- 3 Slide the battery cover back into place.

### POINTING THE REMOTE

Press the **TV mode** button on the remote to ensure that the remote sends its commands to the TV. When operating the remote control, point the remote toward the remote sensor window on the TV.

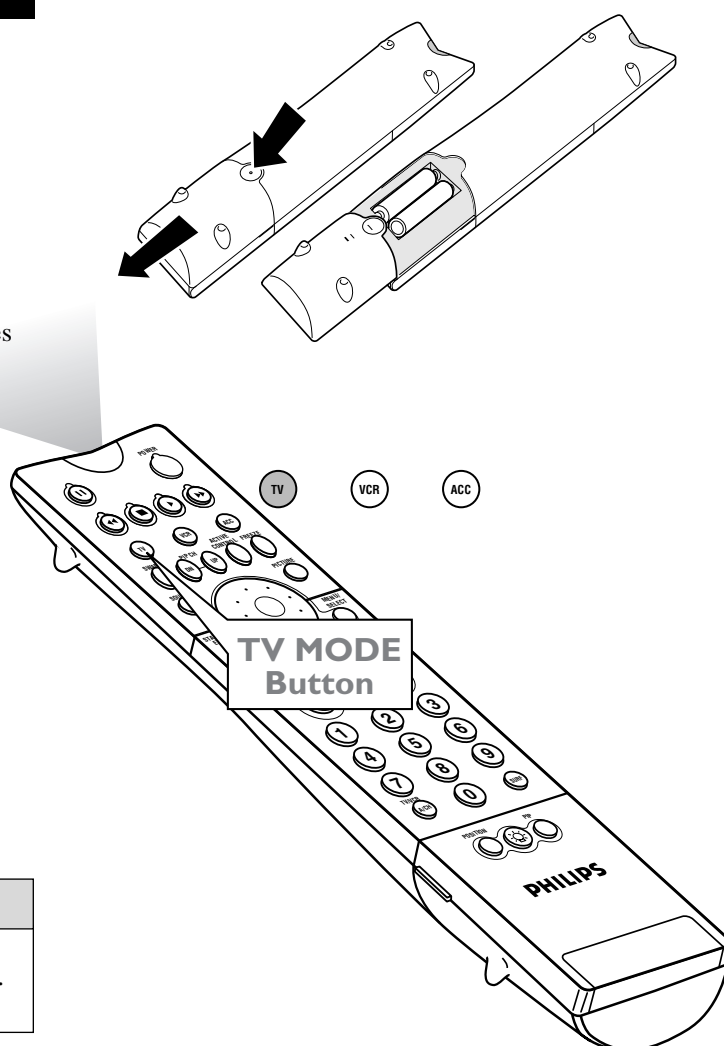

### BATTERY USAGE CAUTION

To prevent battery leakage that may result in injury to you or damage to the remote control:

- Install ALL batteries correctly, + and -, as marked on the unit.
- Do not mix batteries (OLD and NEW or CARBON and ALKALINE, etc.)
- Remove batteries when the remote control is not used for a long time.

**Do not take apart, heat, or put batteries in fire.**

### HELPFUL HINTS

- Be sure to point the remote toward the sensor window on the TV or accessory device you wish to operate.
- Press the correct mode button for the device: TV, VCR, ACC (for accessories other than VCRs).
- Be within about 30 feet (10 meters) of the TV or accessory device you wish to operate.
- Avoid dropping the remote on hard surfaces.
- Do not use harsh chemicals to clean the remote. Use only a soft, lightly moistened cloth.

### ✓ CHECK IT OUT

You can set up your TV remote control to work with accessory devices such as VCRs, DVD players, and cable converter boxes. See pages 18-23 in the *Directions for Use* manual.

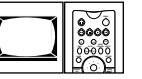

## REMOTE CONTROL

### VCR control buttons

Press to pause, rewind, stop, play, or fast forward a videotape.

### TV • VCR • ACC

(Mode buttons) Press to send remote signals to either the TV, VCR, or other accessory devices such as cable TV converters, satellite receivers, DVDs, or laser disc players. (You may need to program the remote to work accessory devices. See pages 18–23 in the *Directions for Use* manual that came with your TV.)

### PIP buttons: SWAP, PIP CH DN/UP, FREEZE

Press to operate the Picture-in-Picture (PIP) features. See page 7 in this publication for more information on using these buttons.

### Sound

Press to select an AutoSound™ control. (See page 25 in the *Directions for Use* manual.) Choose from three factory-set controls—Voice, Music, and Theatre—and a Personal control that you set according to your own preferences through the on-screen Sound menu. The three factory-set controls will tailor the TV sound so as to enhance the type of program you are watching.

### Status/Exit

Pressing the button once shows the current channel number, name (if set), time (if set), Sleep Timer setting, and sound setting (stereo, mono, SAP, or mute). Pressing the button twice shows the current AutoLock™ settings. Pressing the button once when an on-screen display is showing removes the on-screen display.

### Cursor Ring

Up/Down: allows you to select the next or previous item in the menu. Left/Right: allows you to access the submenus and adjust the settings. When no on-screen displays or menus are present, use the Cursor Ring Left/Right to select a picture format for a video source connected to the ANTENNA, AV1, CVI, AV2, or AV3 (side panel inputs) on the TV.

### Volume +/-

Press to adjust the TV sound level.

### Number Buttons

Press to select TV channels. When selecting single-digit channels, press the number of the desired channel. The TV will pause for a few seconds and then tune to the selected channel.

### TV/VCR

Press while in VCR mode to view the playback of a videotape. Press again to return to TV mode.

### A/CH

Press to alternate between the currently viewed channel and the previously viewed channel.

### Rec ●

Press this button simultaneously with the ► button when in VCR mode to record.

### SAP

Press to select between main sound and SAP (Second Audio Program) when you tune to a program offering SAP. (See page 37 in the *Directions for Use* manual.)

### AV

Press repeatedly to select the different signal sources connected to the TV: TV, AV1, CVI, AV2, AV3 (side jack panel), AV4 and AV5. (See page 24 in the *Directions for Use* manual.)

### Clock

Press to access the on-screen Timer menu, where you can set the time for the TV's clock or set the TV's Timer features, such as channel switchover, power on set, and power off set. (See page 6 in this publication for setting the time manually. See pages 39–43 in the *Directions for Use* manual for information on using the TV's Timer feature.)

### Position

Press to move the PIP picture to any of the four corners of the screen.

### Back Light button

Press to light the buttons on the remote control.

### PIP

Press to turn PIP (picture-in-picture) on or off or control the size of the PIP window. (See page 7 in this publication for more information on PIP.)

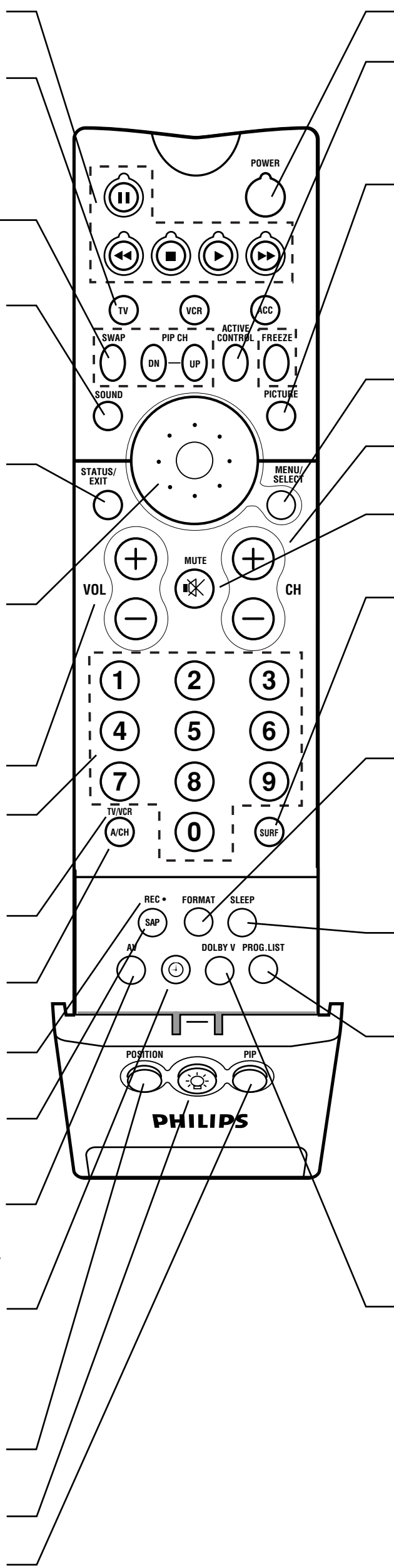

### Power

Press to turn the TV on or off.

### Active Control™

Measures and corrects all incoming signals to provide the best picture-quality settings. (See page 56 in the *Directions for Use* manual.) Press to turn Active Control™ on or off. When Active Control™ is on, it automatically and continuously controls Sharpness and Noise Reduction settings.

### Picture

Press to select an AutoPicture™ control. Choose from four factory-set controls—Movies, Sports, Weak Signal, and Multimedia—and a PERSONAL control that you set according to your own preferences through the on-screen Picture menu. (See page 26 in the *Directions for Use* manual.) The four factory-set controls will enhance the TV picture according to the particular type of program you are watching. It may also be used to enhance pictures with weak signals.

### Menu/Select

Press to display the on-screen menu. Press to return to a higher menu level.

### Channel +/-

Press to select channels in ascending or descending order or cycle through the signal inputs.

### Mute

Press to turn the TV sound off. To restore the sound to its previous level, press the button again. (See pages 17 and 53 in the *Directions for Use* manual.)

### Surf

Press to select previously entered channels. With the TV's AutoSurf™ control, you can place up to 10 favorite channels or sources in memory. Then by pressing the Surf button, you can quickly view the selected channels. (See page 27 in the *Directions for Use* manual that came with the TV to learn how to select a series of your favorite channels using the Surf button.)

### Format

Press to select a picture-format mode for a video source connected to the ANTENNA, AV1, CVI, AV2, or AV3 (side panel) inputs. Each press of the button selects a different mode—4:3, EXPAND 4:3, PANORAMA, WIDE SCREEN, or AUTO. Control the picture format of a video source connected to the HD inputs (AV4 or AV5) with the HD set-top box or progressive-scan-capable DVD player providing the video source.

### Sleep

Press to set the TV to automatically turn itself off after a period of time. Choose 15, 30, 45, 60, 90, 120, 180, or 240 minutes before the TV will automatically turn off. (See page 29 in the *Directions for Use* manual.)

### Program List

Press to display a list of channel numbers and their names. (See the "Tuner Mode," "Auto Program," "Channel Edit," and "Name" sections on pages 4–6 in this guide for setup.) Each channel will appear as a selectable menu item. The current channel will be highlighted as default. Five channels will be listed on screen at one time. Press the Cursor Ring up or down to scroll the list and highlight a channel. Press the Cursor Ring right to tune to the highlighted channel. Channels marked "Skipped" in the Channel Edit control will not appear in the list. Each channel that is being blocked by AutoLock™ will appear with a padlock icon to indicate that the channel is not viewable. (See page 28 in the *Directions for Use* manual.)

### Dolby V

Press to select various factory surround sound listening modes.

#### Dolby\* Virtual (Virtual Dolby Surround) (with Virtual Dolby Surround signals)

Dolby Virtual uses two speakers to simulate the surround effect produced by a multichannel system.

#### Incredible Surround™

- In Stereo sound mode—when Incredible Surround™ is turned on—it seems as though the loudspeakers are spread farther apart from each other.
- In Mono sound mode—when Incredible Surround™ is turned on—enables you to hear a spatial sound effect.

(See page 35 in the *Directions for Use* manual.)

\*Manufactured under license from Dolby Laboratories. "Dolby" and the double-D symbol are trademarks of Dolby Laboratories.

Active Control, AutoPicture, AutoSound, AutoSurf, and Incredible Surround are trademarks of Philips Consumer Electronics. Copyright 2003 Philips Consumer Electronics. All rights reserved.



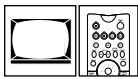

# OPERATING THE TELEVISION AND REMOTE CONTROL

## REMOTE CONTROL

### ADJUSTING OR SETTING MENU OPTIONS

A menu is simply a list of options. You can adjust or set your TV's on-screen menu options by pressing buttons on the remote control. The following steps will familiarize you with how to use the remote control with the on-screen menu.

- 1 Press the TV mode button to ensure that the remote control is in TV mode.
- 2 Press the MENU/SELECT button to bring the menu to the screen. Then, as necessary, press the CURSOR RING DOWN or UP to highlight a menu option. Press the CURSOR RING RIGHT to enter the submenu for the option.
- 3 Within the submenu, press the CURSOR RING DOWN or UP to highlight an option. Based on the submenu you are in, you can press the CURSOR RING RIGHT or LEFT to make an adjustment, select a setting, or enter a list or another submenu. You can return to the submenu from a list by pressing the CURSOR RING LEFT. To go from a submenu to the previous menu, highlight the option at the top of the screen and press the CURSOR RING UP. You can also press MENU/SELECT to return to the previous menu. Press STATUS/EXIT to exit the menu.

**MENU**

- PICTURE
- SOUND
- FEATURES
- INSTALL

TREBLE  
BASS  
BALANCE  
AVL  
INCR-SURROUND

**SOUND SUBMENU**

SOUND

- TREBLE
- BASS
- BALANCE
- AVL
- INCR-SURROUND

Make adjustments or selections within a submenu.

**INSTALL SUBMENU**

INSTALL

- LANGUAGE
- TUNER MODE
- AUTO PROGRAM
- CHANNEL EDIT
- AutoChron

AV3  
AV4  
1  
2  
3

**FEATURES SUBMENU**

FEATURES

- AutoLock
- PIP
- CLOSED CAP
- FORMAT

TIME  
START TIME  
STOP TIME  
CHANNEL  
ACTIVATE

**TIMER SUBMENU**

FEATURES  
TIMER

- TIME
- START TIME
- STOP TIME
- CHANNEL
- ACTIVATE

8:06 PM

Go from one submenu to another and make settings or adjustments.

Also from a Submenu, enter a list to make selections.

### HELPFUL HINTS

- If you don't press any remote buttons, the menu will automatically disappear after about 20 seconds. To bring the menu back, press MENU/SELECT.
- Sometimes not all the menu items are visible on the screen. If more items exist in the menu, a cursor arrow will appear. Also, a bullet will appear for each remaining item, up to a maximum of three. This will help you determine how many items are left in the menu. Keep pressing the CURSOR RING DOWN until you display all items.
- Should your remote become lost or otherwise unavailable for use, you can use the buttons on the front of the TV to access the on-screen menu and make adjustments or settings. See page 2.

## USING THE INSTALLATION FEATURES

### LANGUAGE

The menu LANGUAGE control enables you to set the TV's on-screen menu and on-screen displays to be shown in English, French, or Spanish. Follow the steps in this section to set the control.

- 1 Press the MENU/SELECT button. The on-screen menu appears.
- 2 Press the CURSOR RING DOWN repeatedly until INSTALL is highlighted. Then press the CURSOR RING RIGHT to enter the INSTALL submenu.
- 3 Press the CURSOR RING RIGHT again to highlight the menu LANGUAGE options list.
- 4 Press the CURSOR RING DOWN or UP to select your menu language. Instantaneously, the on-screen displays appear in the language that you choose.
- 5 Press the STATUS/EXIT button to exit the menus.

**INSTALL**

- LANGUAGE
- TUNER MODE
- AUTO PROGRAM
- CHANNEL EDIT
- AutoChron

ENGLISH  
FRANCAIS  
ESPAÑOL

**French**

INSTALLATION

- LANGUE
- TUNER MODE
- PROGRAM-AUTO
- CHANGER CANAL
- AutoChron

FRANCAIS  
ESPAÑOL  
ENGLISH

**Spanish**

INSTALAR

- IDIOMA
- SINTONIZADOR
- AUTO PROG-
- EDITAR CANAL
- AutoChron

ESPAÑOL  
ENGLISH  
FRANCAIS

Make your selection and instantaneously the onscreen display appears in the language you chose.

### HELPFUL HINT

The LANGUAGE control makes only the TV's on-screen menu items appear in English, French, or Spanish text. The control does not change the language of Closed Captioning (CC) text that may be included with programs.

### TUNER MODE

Set the TUNER MODE control according to the type of signal you have connected to the TV—ANTENNA or CABLE. If you select AUTO, the TV will automatically detect the type of signal you have connected.

- 1 Press the MENU/SELECT button. The on-screen menu appears. Press the CURSOR RING DOWN repeatedly until INSTALL is highlighted.
- 2 Press the CURSOR RING RIGHT to enter the INSTALL submenu. Then press the CURSOR RING DOWN once to highlight TUNER MODE.
- 3 Press the CURSOR RING RIGHT to highlight the TUNER MODE options list.
- 4 Press the CURSOR RING DOWN or UP repeatedly until you select the option that matches your signal connection, CABLE or ANTENNA. If you want the TV to determine the type of signal, select AUTO. (You have selected an option when the dot and triangle are next to the option.)
- 5 Press the STATUS/EXIT button to exit the menu.
- 6 Proceed to the section on "Auto Program."

**INSTALL**

- LANGUAGE
- TUNER MODE
- AUTO PROGRAM
- CHANNEL EDIT
- AutoChron

CABLE  
ANTENNA  
AUTO

**INSTALL**

- LANGUAGE
- TUNER MODE
- AUTO PROGRAM
- CHANNEL EDIT
- AutoChron

CABLE  
ANTENNA  
AUTO

### HELPFUL HINT

If you select the Tuner Mode option that matches your signal source rather than AUTO, the time required for AUTO PROGRAM to store channels to the TV's memory can be reduced.

# USING THE INSTALLATION FEATURES



## AUTO PROGRAM

The **AUTO PROGRAM** feature will scan for channels with active broadcast signals and store those channels in the TV's memory. It will tune up to 69 channels for antenna, and up to 125 channels for cable. After you run **AUTO PROGRAM**, you can use the **CH(annel) +/-** buttons to quickly and easily select stations. You can also press the **PROG. LIST** (Program List) button on your remote to see a list of the channels.

- 1** Press the **MENU/SELECT** button. The on-screen menu appears. Then press the **CURSOR RING DOWN** repeatedly until **INSTALL** is highlighted.
- 2** Press the **CURSOR RING RIGHT** to enter the **INSTALL** submenu. Then press the **CURSOR RING DOWN** repeatedly until **AUTO PROGRAM** is highlighted.
- 3** Press the **CURSOR RING RIGHT** to begin the automatic search for channels. The progress of autoprogramming is displayed.
- 4** When the programming is done, press the **STATUS EXIT** button to exit the menu.

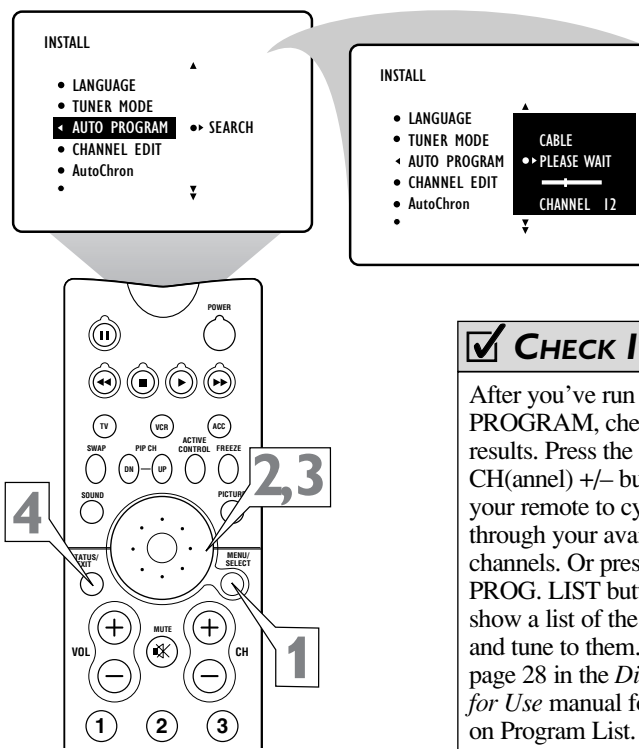

### ✓ CHECK IT OUT

After you've run **AUTO PROGRAM**, check the results. Press the **CH(annel) +/-** buttons on your remote to cycle through your available channels. Or press the **PROG. LIST** button to show a list of the channels and tune to them. See page 28 in the *Directions for Use* manual for more on Program List.

### HELPFUL HINTS

- Philips strongly recommends that you run Auto Program. Otherwise, the TV may not tune the channels properly, resulting in improper pictures.
- If you change signal sources—to a new cable company or from antenna to cable, for example—be sure that Tuner Mode is properly set for the new source. Then run Auto Program again. This will ensure that the channels are correctly stored in the TV's memory.
- If you have made AutoLock™ settings, remember that you must remove any channel blocks before Auto Program will work. (See pages 44–52 in the *Directions for Use* manual.)

## CHANNEL EDIT

This feature allows you to edit or skip channels from the channel list that have bad or weak signals or channels you do not want to watch.

- 1** Press the **MENU/SELECT** button. The on-screen menu appears. Then press the **CURSOR RING DOWN** repeatedly until **INSTALL** is highlighted. Press the **CURSOR RING RIGHT** to enter the **INSTALL** submenu.
- 2** Press the **CURSOR RING DOWN** repeatedly until **CHANNEL EDIT** is highlighted. Then press the **CURSOR RING RIGHT** or **LEFT** to access the **CHANNEL EDIT** list.
- 3** Press the **CURSOR RING UP** or **DOWN** to scroll through the list of channels. Or press the **NUMBER** buttons on your remote control to select a specific channel.
- 4** With the channel you want to edit selected, press the **CURSOR RING RIGHT** to mark the channel as **SKIPPED**. (Channels you mark **SKIPPED** will not appear when you use the **CH[annel] +/-** buttons to change channels while watching TV.)  
When you want to add a channel that has been marked **SKIPPED**, press the **CURSOR RING UP** or **DOWN** to highlight the channel. Then press the **CURSOR RING RIGHT** to remove the word **SKIPPED**.
- 5** Press the **STATUS/EXIT** button to exit the menu.

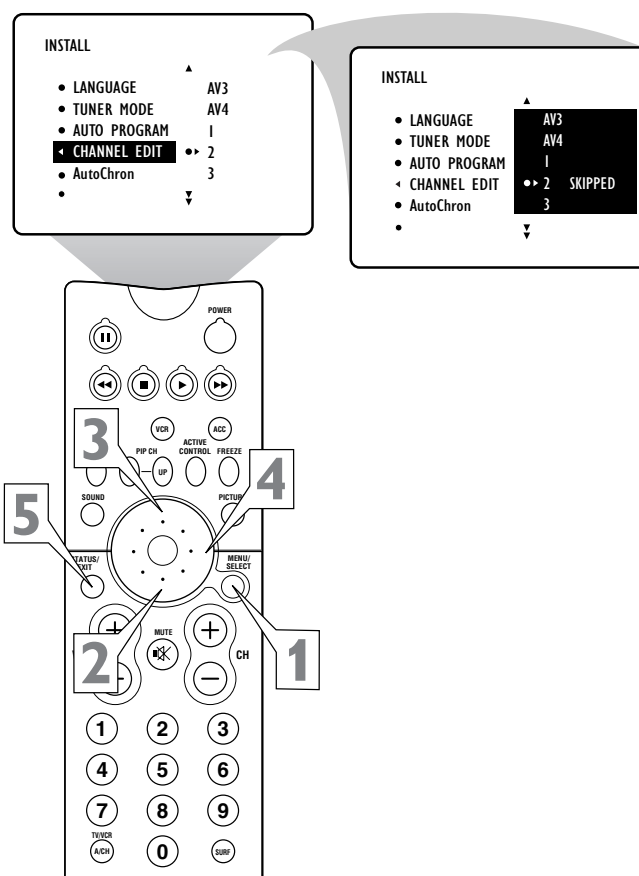

### HELPFUL HINT

Channels that Auto Program (see page 5) determined not to contain active broadcast signals are marked **SKIPPED**.

## AutoChron™

**AutoChron™** gives you the option of setting the time manually or automatically.

### SETTING TIME AUTOMATICALLY

The steps in this section tell you how to set **AutoChron™** to download the time from your PBS station to your TV. After successful setup, **AutoChron™** will automatically maintain the correct time using your PBS station until you set the time manually.

- 1** Press the **MENU/SELECT** button. The on-screen menu appears. Then press the **CURSOR RING DOWN** repeatedly until **INSTALL** is highlighted.
- 2** Press the **CURSOR RING RIGHT** to enter the **INSTALL** submenu. Then press the **CURSOR RING DOWN** repeatedly until **AutoChron** is highlighted.
- 3** Press the **CURSOR RING RIGHT** to enter the **AutoChron SET TIME** area.
- 4** Press the **CURSOR RING RIGHT** again to select **AUTO**. Within a few seconds, a menu containing the time-zone options appears.
- 5** If necessary, press the **CURSOR RING UP** or **DOWN** to highlight your correct time zone. Then press the **CURSOR RING RIGHT**. Within a few seconds, the option of Daylight Savings Time appears on screen.
- 6** If the **Daylight Savings Time** option you want to select is not highlighted, press the **CURSOR RING UP** or **DOWN** to highlight the option. Then press the **CURSOR RING RIGHT** to activate your selection.
- 7** Press the **number buttons** on your remote to enter the channel number for your PBS station (02, 15, or 121, for example). Wait until the TV completes its search. If the time was not found, you will need to locate the correct channel number for your PBS station and input that number.
- 8** Press the **STATUS/EXIT** button to exit the menu.

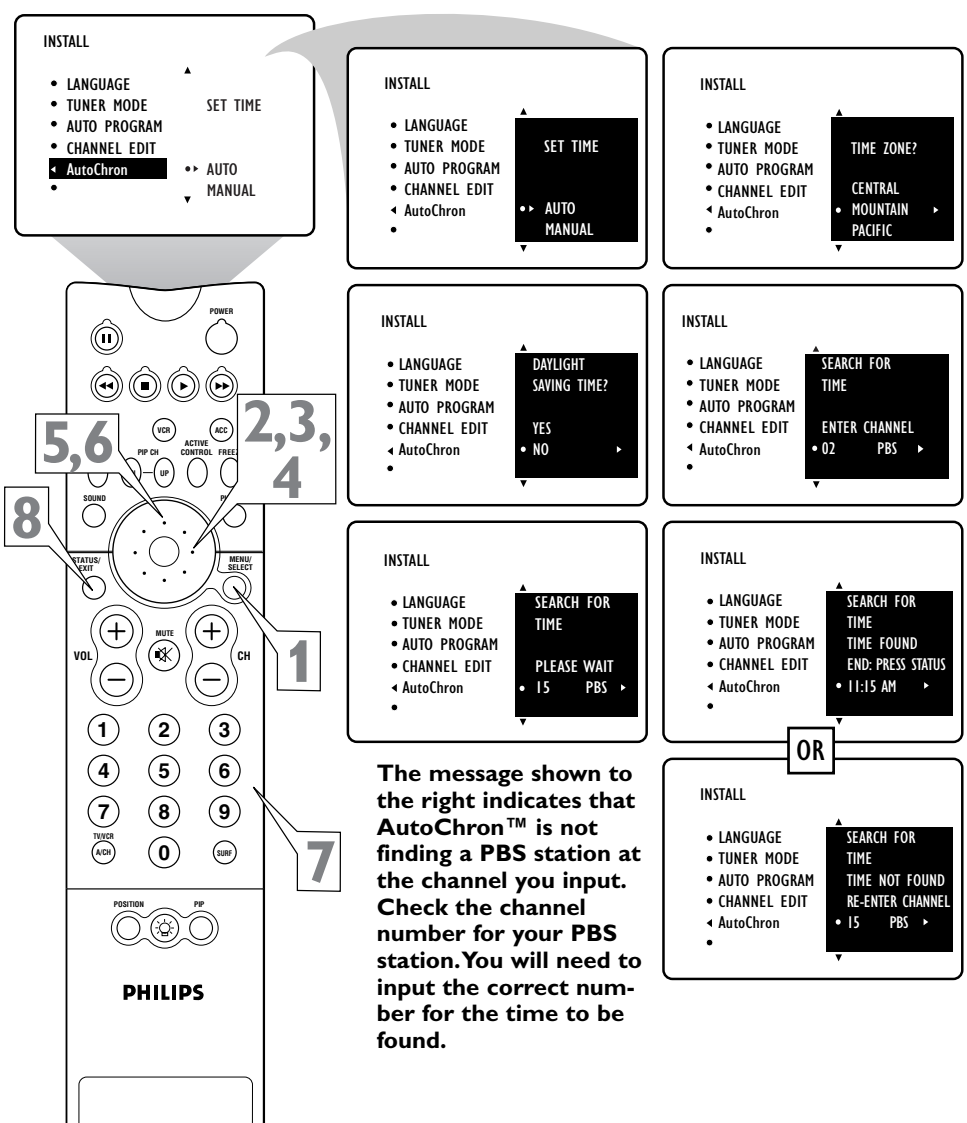

The message shown to the right indicates that **AutoChron™** is not finding a PBS station at the channel you input. Check the channel number for your PBS station. You will need to input the correct number for the time to be found.

# USING THE INSTALLATION FEATURES

## AutoChron™

### SETTING TIME MANUALLY

- Follow steps 1–3 in the section “Setting Time Automatically” on page 5, then press the **CURSOR RING DOWN** to highlight **MANUAL** and **CURSOR RING RIGHT** to enter the **MANUAL** time input area.
- Use the **number buttons** on your remote control to **input the first digit for the time**. You can also press the **CURSOR RING UP** or **DOWN** to select a digit. Press the **CURSOR RING RIGHT** to move to the next digit input slot and input the time.  
If you should need to change a number you have input, you can cursor left or right to the digit input slot to make the correction.
- After you have input the time, press the **CURSOR RING RIGHT** to enter the **AM/PM** area. Then press the **CURSOR RING UP** or **DOWN** to select **AM** or **PM**.
- Press the **STATUS/EXIT** button to exit the menu.

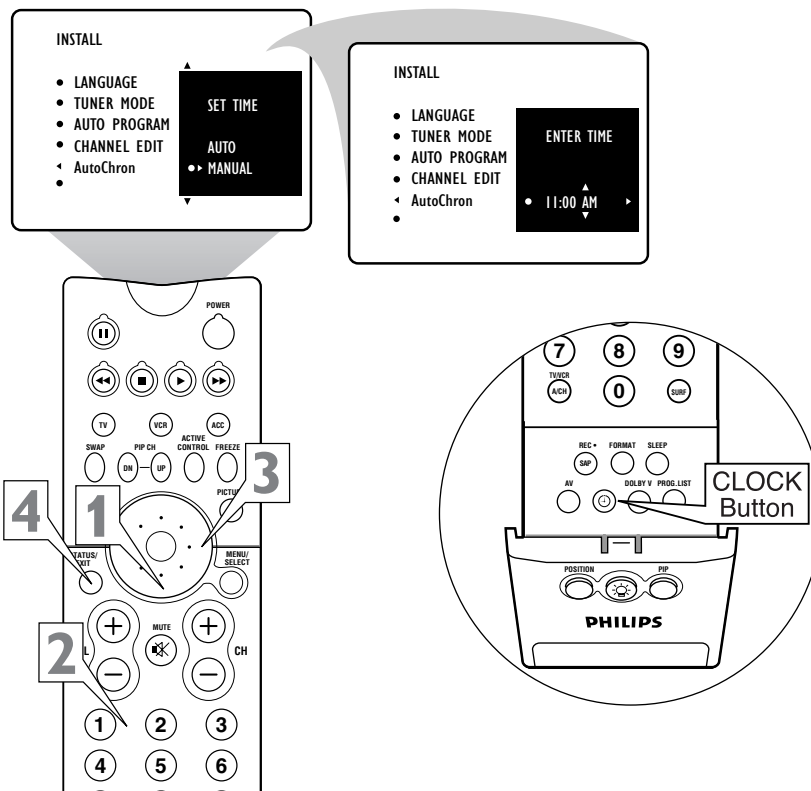

### HELPFUL HINTS

- The **CLOCK** button  on your remote provides another way in which you can set the TV's clock manually.
- After setting the clock, you will be able to access the time by pressing the **STATUS/EXIT** button. Or you can view the time constantly in the upper right-hand corner of the screen by turning the **DISPLAY** control on (see page 40 in the *Directions for Use* manual).

AutoChron is a trademark of Philips Consumer Electronics. Copyright 2003 Philips Consumer Electronics. All rights reserved.

## NAME

The **channel NAME** feature allows you to list the “call” letters of your favorite stations beside their channel numbers when they appear on the screen. The TV has in memory a list of the 50 most popular channel names (NBC, ABC, or FOX, for example). You also can enter a custom name (up to five characters).

- Press the **NUMBER** buttons, the **CH(annel) +/-** buttons, or the **AV** button to select a TV channel or input source to which you want to assign or modify a name.
- Press the **MENU/SELECT** button. The on-screen menu appears. Then press the **CURSOR RING DOWN** repeatedly until **INSTALL** is highlighted. Press the **CURSOR RING RIGHT** to enter the **INSTALL** submenu.
- Press the **CURSOR RING DOWN** repeatedly until the **NAME** control is highlighted. Then press the **CURSOR RING RIGHT** to highlight the **NAME** options area.
- At this point you can choose between options of creating a personal name for the channel or selecting a preset one from a list.

**To create your own personal name for the channel or change a personal name you created previously, press the CURSOR RING RIGHT.** Then press the **CURSOR RING UP** or **DOWN** to select the first character of the name. You can input up to five characters for the name. When finished, press the **MENU/SELECT** button.

Or

**To choose from the list of preset names, press the CURSOR RING UP or DOWN to highlight your choice for the channel name.** Press the **CURSOR RING RIGHT** to select the name. Then press the **MENU/SELECT** button.

- Press the **STATUS/EXIT** button to exit the menu.  
When you press the **STATUS/EXIT** button when no on-screen display is present or change to the channel you've named, the name will appear on screen next to the channel number or signal source name.

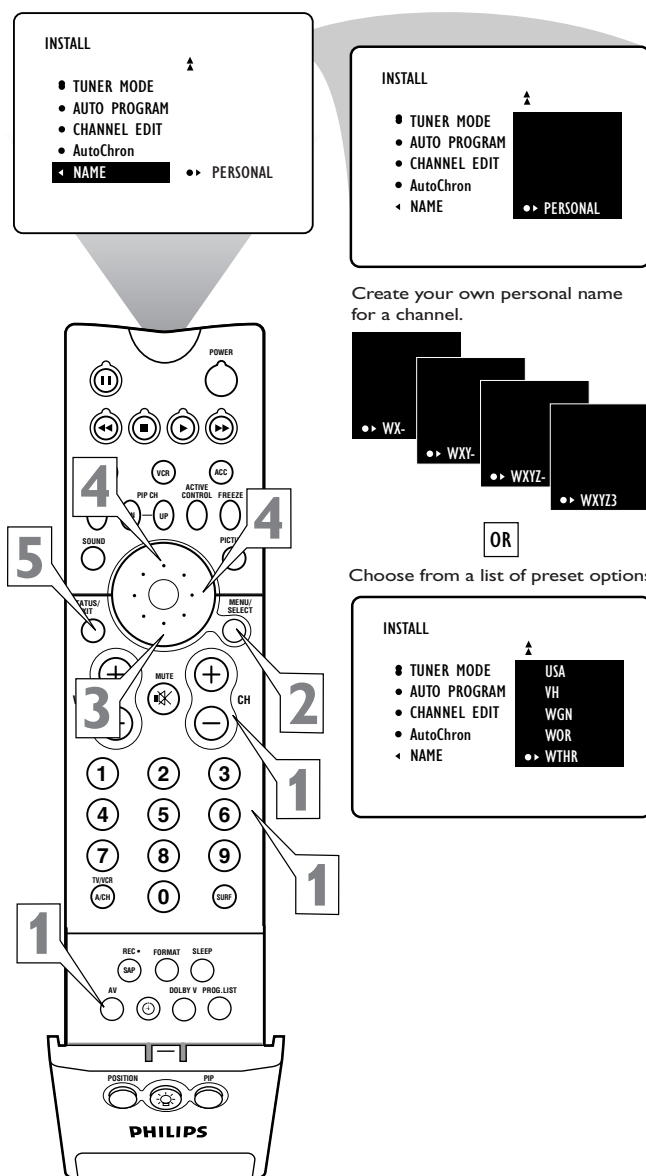

### HELPFUL HINTS

- The five **PERSONAL** name characters you can input may be letters, a dash, or the numbers 0 through 9.
- If you begin inputting a personal name or changing an existing one and decide you'd rather select a name from the preset list, press the **MENU/SELECT** button. This will return you to the **INSTALL** submenu, with **NAME** highlighted. Simply press the **CURSOR RING RIGHT** to highlight the **NAME** options area again and choose a preset name as explained in step 4 to the left.



# USING THE PICTURE-IN-PICTURE (PIP) FEATURE



**P**icture-In-Picture (PIP) is the showing of two pictures on the TV screen at the same time—one main screen picture and one small picture, or PIP. Because your set has two tuners, you can enjoy all the benefits of PIP without using a VCR as a second tuner for your PIP picture. Tune to your favorite show on the main screen with tuner one while scanning other channels with tuner two in the PIP window. Also view the AV1, AV2, or AV3 sources in the PIP window. **NOTE:** CVI cannot be displayed in the PIP window, and AV4 and AV5 do not function with PIP. For information on connecting accessory devices to the AV inputs, see the *Directions for Use* manual that came with your set. Connection information begins on page 6.

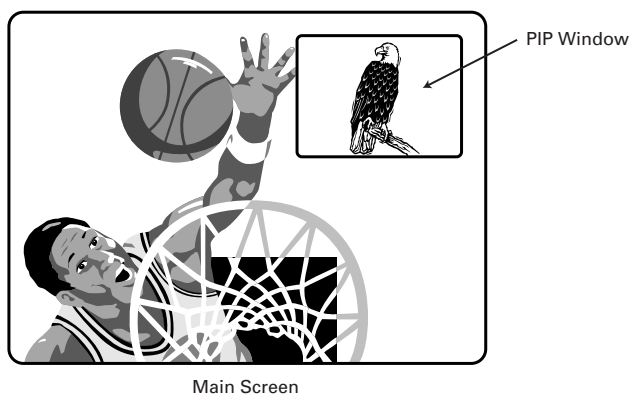

Main Screen

## USING THE PIP BUTTONS

Using the PIP buttons on the remote, you can move the PIP window around and swap it with the main screen. You can also freeze the PIP window picture. Perform the steps below to practice using the PIP buttons.

- 1** Press the **PIP on/off** button to show the PIP window. The window appears in a corner of the TV screen. Press the PIP on/off button again to reduce the PIP window size, and a third time to remove the PIP window from the screen. Press the PIP on/off button again to show the PIP window.
- 2** Press the **PIP CH DN/UP** buttons to tune to channels in the PIP window. If you press and hold the PIP CH UP button for three seconds, the set will automatically perform a forward scan for channels. Press and hold the PIP CH DN button for three seconds, and the set will automatically perform a backward scan for channels. Auto scanning will stop if you press any key, and it will also stop upon reaching the channel at which scanning began.
- 3** Press the **PIP POSITION** button to move the PIP window from corner to corner on the TV screen.
- 4** With PIP on the TV screen, press the **SWAP** button to swap the main and PIP pictures. Press SWAP again to swap the pictures back. **NOTE:** The CVI source is not accessible in the PIP window, so it cannot be swapped between the main screen and PIP.
- 5** Press the **FREEZE** button to stop motion within the PIP window. The FREEZE button allows you plenty of time to write down on-screen information such as phone numbers or addresses.
- 6** Press the **PIP on/off** button, multiple times if necessary, to remove the PIP window from the screen.

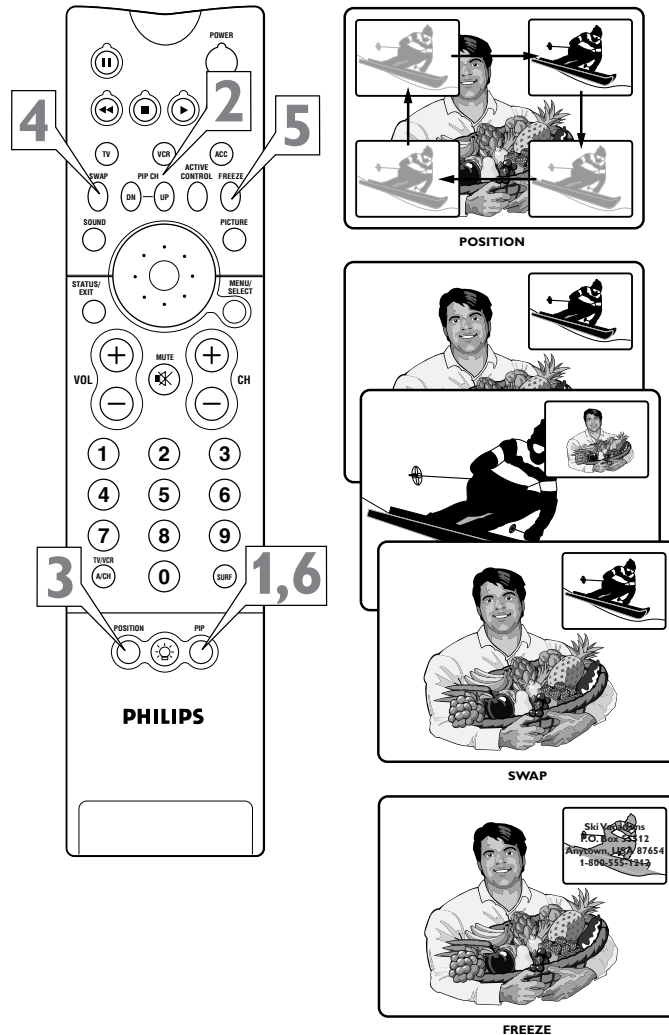

### HELPFUL HINT

When you press the PIP on/off button to show the PIP window, the window will appear where it was located the last time it was displayed.

### WARNING

To prevent uneven picture tube aging, do not leave stationary images on screen for extended periods of time. Vary your picture viewing. See page 60 in the *Directions for Use* manual.

## ADJUSTING PIP TINT AND COLOR

The Picture-in-Picture (PIP) TINT control allows you to adjust the PIP picture to obtain natural skin tones. The COLOR control allows you to fine tune the color.

- 1** Press the **MENU/SELECT** button. The onscreen menu appears. Then press the **CURSOR RING DOWN** twice to highlight FEATURES.
- 2** Press the **CURSOR RING RIGHT** to enter the FEATURES submenu. Then press the **CURSOR RING DOWN** repeatedly until the PIP item is highlighted. Press the **CURSOR RING RIGHT** to enter the PIP submenu.
- 3** Press the **CURSOR RING RIGHT** or **LEFT** to adjust the TINT or COLOR to the desired level.
- 4** Press the **STATUS/EXIT** button to exit the menu.

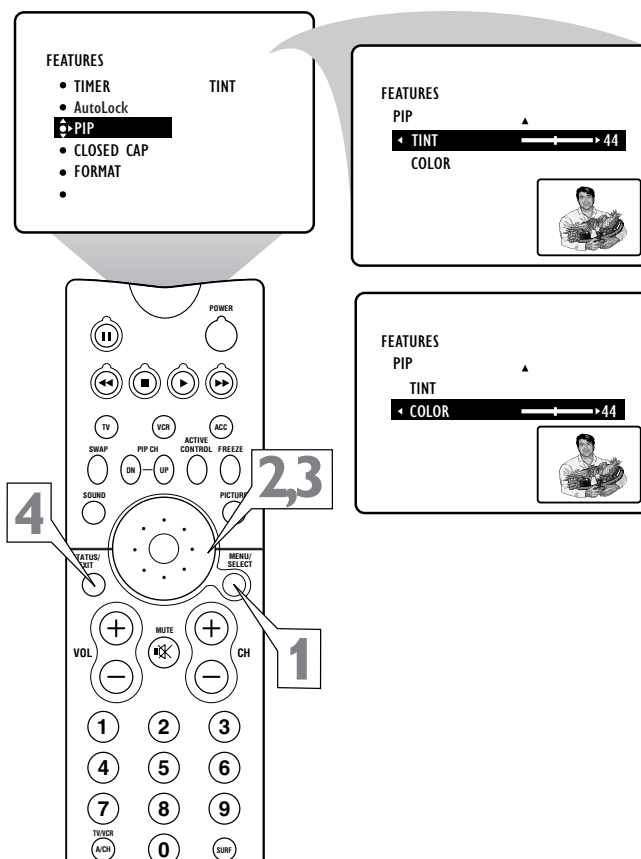



# ADJUSTING THE MANUAL CONVERGE CONTROLS

## CONVERGE RED/BLUE

Bumps and vibrations, moving the set, or the presence of magnetic fields (from speakers, for example) can cause the beams of light coming from the TV's three color projection tubes to become misaligned. The result is color haloes, or outlines, around portions of the picture. If your picture looks okay, there's no need to adjust convergence. If your TV's picture has the color haloes, however, refer to the chart to the right for guidance as to which convergence controls to use, then follow the simple steps below.

Screen Appearance	Actions
Various parts of the picture have red haloes.	Adjust the CONVERGE RED control. Then if any red haloes remain, adjust the MULTIPOINT RED control.
Various parts of the picture have blue haloes.	Adjust the CONVERGE BLUE control. Then if any blue haloes remain adjust the MULTIPOINT BLUE control.

- 1 Press the **MENU/SELECT** button. The menu appears. Press the **CURSOR RING RIGHT** to enter the PICTURE submenu. Then press the **CURSOR RING DOWN** until MANUAL CONVERGE is highlighted.
- 2 Press the **CURSOR RING RIGHT** to enter the MANUAL CONVERGE submenu. If you want to adjust the Red Convergence, press the **CURSOR RING RIGHT** to enter the adjust mode. If you want to adjust the Blue Convergence, press the **CURSOR RING DOWN** to highlight CONVERGE BLUE, then press the **CURSOR RING RIGHT** to enter adjust mode.
- 3 In adjust mode, press the **CURSOR RING RIGHT, LEFT, UP, or DOWN** to adjust the cross hair until the color halo around it is gone. (The adjustment is automatically saved in the TV's memory.) To return to the MANUAL CONVERGE menu, press the **MENU/SELECT** button. To exit the on-screen display, press the **STATUS/EXIT** button.

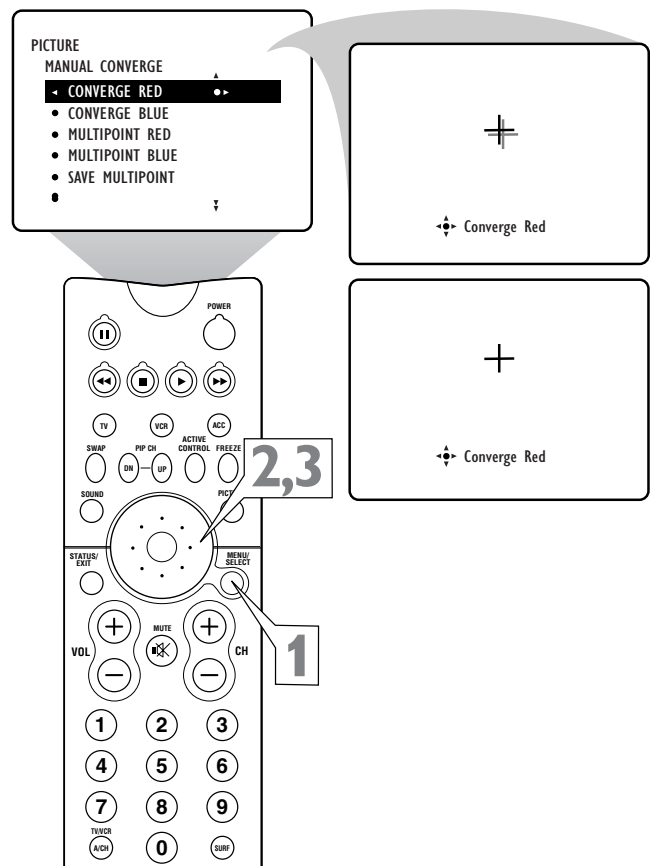

## MULTIPOINT RED/BLUE

The Multipoint Red/Blue Convergence controls enable you to adjust the convergence at specific points on the TV screen. **NOTE:** The on-screen display will leave the screen after 20 seconds of inactivity. If this happens, simply press the MENU/SELECT button to bring the MANUAL CONVERGE submenu back.

- 1 Press the **MENU/SELECT** button. The menu appears. Press the **CURSOR RING RIGHT** to enter the PICTURE menu. Then press the **CURSOR RING DOWN** until MANUAL CONVERGE is highlighted.
- 2 Press the **CURSOR RING RIGHT** to enter the MANUAL CONVERGE submenu. Press the **CURSOR RING DOWN** until MULTIPOINT RED or MULTIPOINT BLUE is highlighted. Then press the **CURSOR RING LEFT** or **RIGHT** to enter Navigate mode.
- 3 Press the **CURSOR RING LEFT, RIGHT, UP, or DOWN** to move to a cross hair that has a color outline. Then press the **STATUS/EXIT** button to enter adjust mode.
- 4 Press the **CURSOR RING LEFT, RIGHT, UP, or DOWN** to adjust the cross hair image until the color outline is gone. Then press the **STATUS/EXIT** button to return to NAVIGATE mode. Repeat steps 3 and 4 until all misaligned cross images have been adjusted.
- 5 After making your adjustments, you must store them in the TV's memory using **SAVE MULTIPOINT**. **NOTE:** If you are not satisfied with the adjustments you just made and want to start over, you can use the **UNDO MULTIPOINT** control. This control allows you to undo the adjustments, but it will work only if you use it before saving.

To save your multipoint adjustments, press the **MENU/SELECT** button. This returns you to the MANUAL CONVERGE menu. Press the **CURSOR RING DOWN** until **SAVE MULTIPOINT** is highlighted. Then press the **CURSOR RING LEFT** or **RIGHT** to store your adjustments in the TV's memory.

OR

To undo the multipoint adjustments you just made, press the **MENU/SELECT** button. This returns you to the MANUAL CONVERGE menu. Press the **CURSOR RING DOWN** until **UNDO MULTIPOINT** is highlighted. Press the **CURSOR RING LEFT** or **RIGHT** to undo the adjustments. Press the **CURSOR RING UP** until **MULTIPOINT RED** or **MULTIPOINT BLUE** is highlighted. Press the **CURSOR RING LEFT** or **RIGHT** to enter Navigate mode. Then Follow steps 3-5 above to make your adjustments again.

OR

To restore the TV's convergence to factory settings, press the **MENU/SELECT** button. This returns you to the MANUAL CONVERGE menu. Press the **CURSOR RING DOWN** until **RESTORE FACTORY** is highlighted. Then press the **CURSOR RING LEFT** or **RIGHT** to restore the TV's convergence to factory settings.

- 6 Press the **STATUS/EXIT** button to exit the submenu.

**HELPFUL HINT**  
If you should experience a power outage before saving your multipoint-convergence settings, your settings will be lost.