

Panasonic®



Operating Instructions Wide LCD TV

Model No. **TX-26LX1M**
TX-32LX1M
TX-26LX1A
TX-32LX1A
TX-26LX1X
TX-32LX1X



The illustration shown is an image.



Please read these instructions before operating your set and retain them for future reference.

English

TQBC0815-1

Dear Panasonic Customer

Welcome to the Panasonic family of customers. We hope that you will have many years of enjoyment from your new LCD TV.

To obtain maximum benefit from your set, please read these Instructions before making any adjustments, and retain them for future reference.

Retain your purchase receipt also, and note down the model number and serial number of your set in the space provided on the back cover of these instructions.

Contents

Warnings and Precautions	3	AUTO TUNE (via front panel)	15
Accessories	5	MANUAL TUNE	16
Fitting remote control batteries	5	MANUAL TUNE (via front panel)	16
Cable cover removal and fitting	6	Channel Allocation	17
How to open the front cover	6	PICTURE	18
How to use the LCD stand	6	SOUND	19
Antenna connection	7	SETUP	20
Audio / video connections	8	Aspect Controls	21
How to connect the Headphones / AV3 terminals ..	8	Still	22
How to connect the Monitor Output		Channel search	22
Terminals to other Equipment	9	Multi window	23
How to connect the AV1 / 2 Input Terminals	9	Photo View mode	24
How to connect the DVD Input Terminals	10	Teletext operation	28
Power On / Off	10	Picture and text	30
Basic controls: front panel and remote control	11	VCR / DVD operation	31
Using the On Screen Displays	12	Stereo / Bilingual Sound Selection	31
LANGUAGE	12	Remote control setting	32
Tuning	13	Troubleshooting	33
TUNING MENU	13	Maintenance	33
Channel Selection	14	Specifications	34
AUTO TUNE	15		

Warnings and Precautions

• This TV set is designed to operate on AC 100-127 / 200-240 V, 50 / 60 Hz.

• To prevent damage which might result in electric shock or fire, do not expose this TV set to rain or excessive moisture. This TV must not be exposed to dripping or splashing water, and objects filled with liquid, such as vases, must not be placed on top of or above the TV.

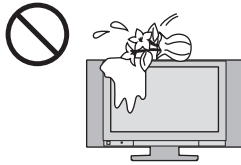

• DO NOT use this unit near water. (Near a bath tub, etc.)

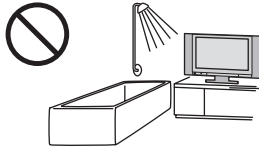

• Unplug the power cord in the event of any malfunction (screen goes blank, no sound, odd sounds, smoke or unusual odours coming from the unit). Unplug the power cord if foreign matter or water falls into the unit, or if the unit is dropped or the cabinet is damaged.

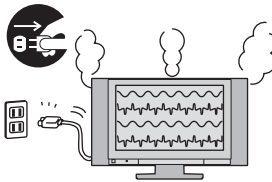

• TAKE CARE NOT to damage the power cord.

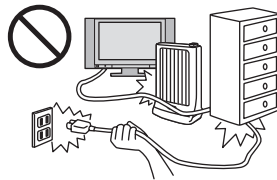

• DO NOT touch the aerial cable and this unit when there is lightning.



• DO NOT use if the power cord or power plug is damaged, or if the plug does not fit tightly into the socket.

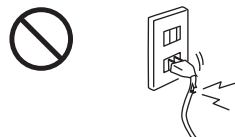

• DO NOT use at a voltage other than indicated.



• DO NOT touch the power plug if your hands are wet.



• Turn the power "Off" before connecting other electrical equipment.

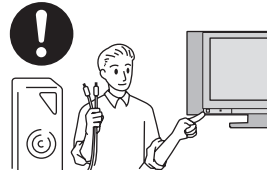

• Ask your sales outlet to install the aerial.

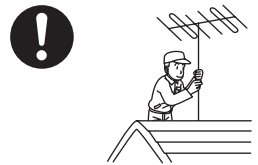

• WARNING : HIGH VOLTAGE!!!

Do not remove the rear cover as live parts are accessible when it is removed. There are no user serviceable parts inside.

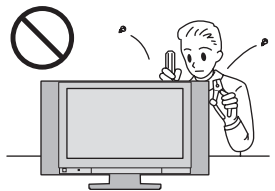

• TV Games / Home Computers

Extended use of TV games or home computers with any television set can cause a permanent 'shadow' on the screen. This type of irreversible LCD panel damage, can be limited by observing the following points:

- Reduce the brightness and contrast levels to a minimum viewing level.
- Do not allow a still picture to be displayed for an extended period, as this can cause a permanent after-image to remain on the LCD TV screen.
- Examples of still pictures include logos, video games, computer images, teletext and images displayed in 4:3 mode.
- This type of LCD panel damage, is not an operating defect, and as such is not covered by the Panasonic warranty.

Warnings and Precautions

- The On / Off switch on this model does not fully disconnect the TV from the mains supply. Remove the mains plug from the wall socket before connecting or disconnecting any leads, or if the TV set is not used for a prolonged period of time.

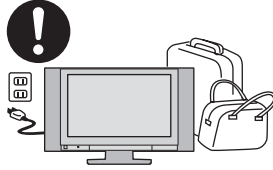

Note:

If the set is not switched off when the TV station stops transmitting, it will automatically go to Standby mode after 30 minutes. This function will not operate when the TV is in AV mode.

Cabinet and LCD panel care

Remove the mains plug from the wall socket. The cabinet and LCD panel can be cleaned with a soft cloth moistened with mild detergent and water. Do not use solutions containing benzol or petroleum.

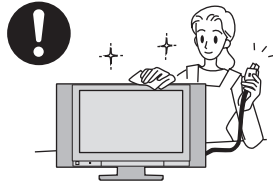

- When ambient temperature is cool, the picture may take a short time to reach normal brightness, but this is not a malfunction. (After brief moment, the picture will have normal brightness.)

- Adequate ventilation is essential to prevent failure of electrical components, we recommend that a gap of at least 10cm is left all around this TV set even when it is placed inside a cabinet or between shelves.

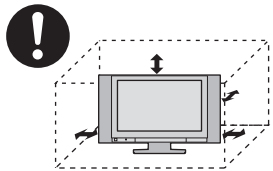

- Avoid exposing the TV set to direct sunlight and other sources of heat. To prevent fire, never place any type of candle or naked flame on top or near the TV set.

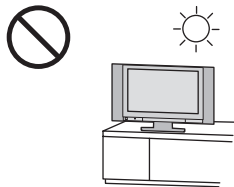

- DO NOT insert foreign objects (metal or easily flammable objects).



- DO NOT stand, or place heavy objects on the unit. Particular care should be taken by families with small children.

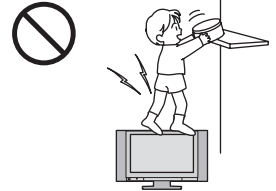

- DO NOT place in an unstable location.



- Place in a safe location.

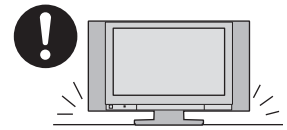

- DO NOT jolt the unit.



Preparation

Receiver Location

Locate for comfortable viewing. Avoid placing where sunlight or other bright light (including reflections) will fall on the screen.

Use of some types of fluorescent lighting can reduce remote control transmitter range.

Adequate ventilation is essential to prevent internal component failure. Keep away from areas of excessive heat or moisture.

To insure optimum picture do not position magnetic equipment (motors, fans, other speakers, etc.) nearby.

Optional External Equipment

The Audio / video connection between components can be made with shielded video and audio cables. For best performance, we recommend 75 Ω coaxial aerial cable is used. Cables are available from your dealer or electronic supply store.

Before you purchase any cables, be sure you know what type of output and input connectors your various components require. Also determine the length of cable you will need.

For optimum quality picture

When the LCD is exposed to light from outdoors or lighting fixtures, high-contrast pictures may not be displayed clearly. Turn off florescent lamps near the LCD and place in a location not exposed to outdoor light.

Accessories

Check that you have the accessories and items shown

Operating Instruction book

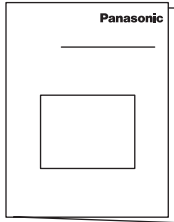

Remote Control Transmitter
(N2QAJB000114)



Batteries for the Remote Control Transmitter
(2 × R6 (AA) size)



AC Plug Adaptor
TX-26LX1X, TX-32LX1X only

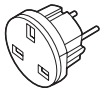

Fitting remote control batteries

1

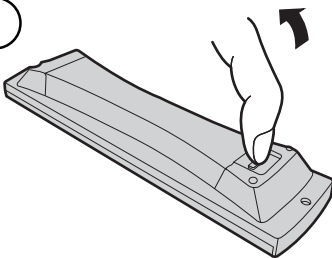

Pull and hold the hook, then open the battery cover.

2

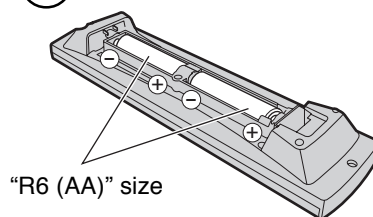

"R6 (AA)" size

Insert batteries - note correct polarity (+ and -).

3

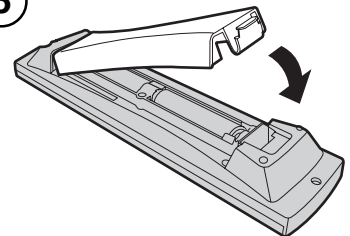

Replace the cover.

Do not use rechargeable (Ni-Cad) batteries.
They are different in shape and performance and may fail to ensure correct operation.

Battery cautions

The incorrect use of batteries can cause electrolyte leakage which will corrode the Remote Control or cause the batteries to burst.

Observe the following precaution:

1. Batteries shall always be replaced as a pair. Always use new batteries when replacing the old set.
2. Do not combine a used battery with a new one.
3. Do not mix battery types (example: "Zinc Carbon" with "Alkaline").
4. Do not attempt to charge, short-circuit, disassemble, heat or burn used batteries.
5. Battery replacement is necessary when remote control acts sporadically or stops operating the TV set.

Cable cover removal and fitting

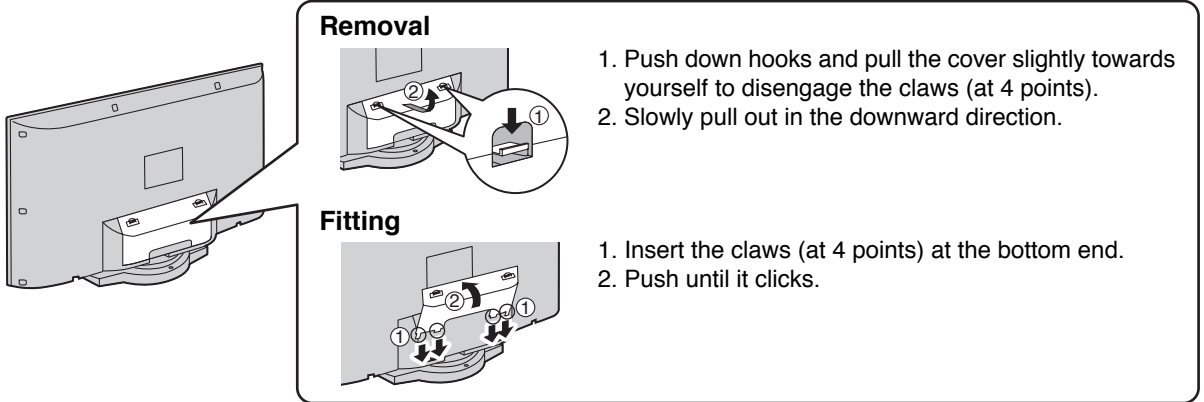

Note:

To avoid interference appearing on the screen, do not bundle the RF cable and mains lead together.

How to open the front cover

Lift up the cover where the mark “△” is shown.

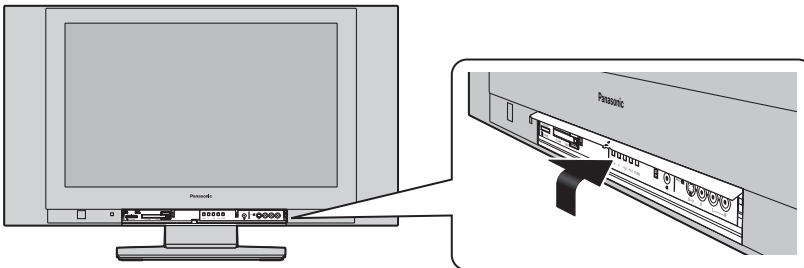

How to use the LCD stand

Adjust the stand to your desired angle. The stand angle can be adjusted between 40 ° right-and-left direction.

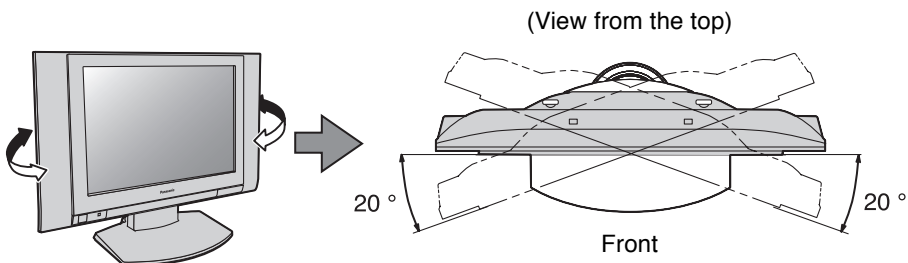

Note:

The stand angle cannot be adjusted forward and backward.

Antenna connection

For proper reception of VHF / UHF channels, an external antenna is required. For best reception, an outdoor antenna is recommended.

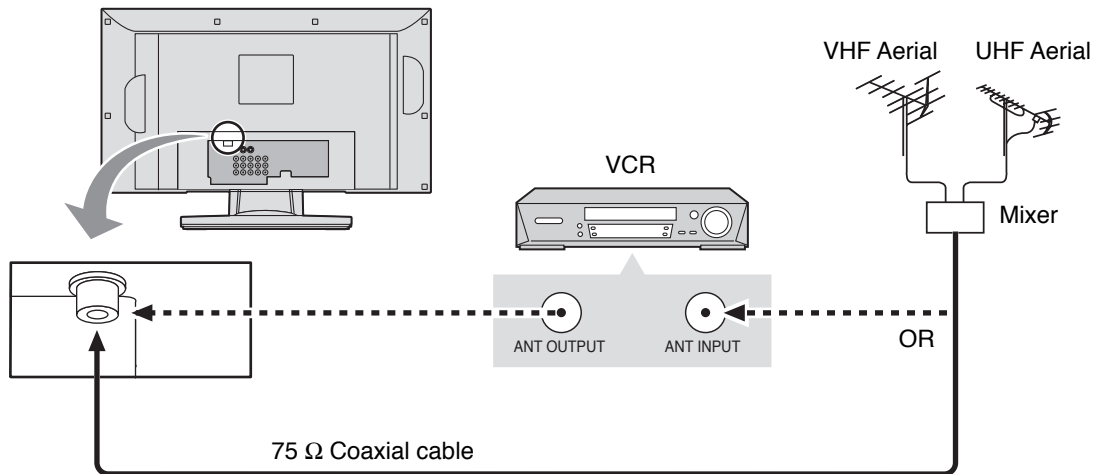

Notes:

- Additional equipment, cables and adapter plugs shown are not supplied with this TV set.
- To obtain optimum quality picture and sound, an Aerial, the correct cable (75 Ω coaxial) and the correct terminating plug are required.
- If a communal Aerial system is used, you may require the correct connection cable and plug between the wall Aerial socket and your TV.
- Your local Television Service Centre or Dealer may be able to assist you in obtaining the correct Aerial system for your particular area and the accessories required.
- Any matters regarding Aerial installation, upgrading of existing systems or accessories required, and the costs incurred, are the responsibility of you, the Customer.

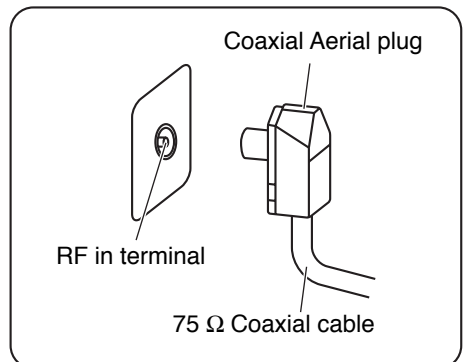

Audio / video connections

It is possible to connect a variety of additional equipment to this TV. The following pages detail how to connect external equipment to the front and rear of the TV.

Once your equipment is connected, use the following procedure to view the input:

Press the **TV/AV** button.

Whilst the on screen selector keys are displayed, press coloured buttons to select the AV source you wish to view.

- Red** button : AV1
- Green** button : AV2
- Yellow** button : AV3
- Blue** button : AV4

The on screen selector keys that appear clear after a few seconds. If you want to select an input when the keys are not shown, press any coloured button and the keys will reappear.

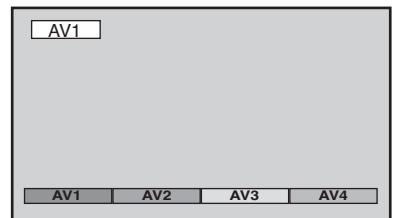
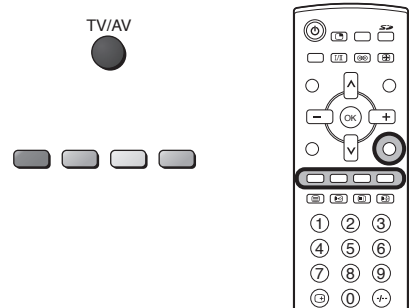

Notes:

- You can also select an AV source using the **TV/AV** button on the front panel of the TV.
Press the **TV/AV** button repeatedly until you reach the AV source you wish to view.
- When a Monaural VCR is used, connect the Monaural Audio cable to the AUDIO L terminal.
- Additional equipment and cables shown are not supplied with this TV set.

How to connect the Headphones / AV3 terminals

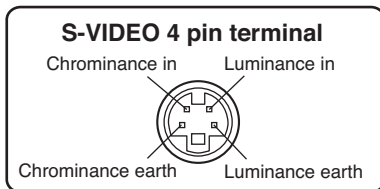

Example of input signal source

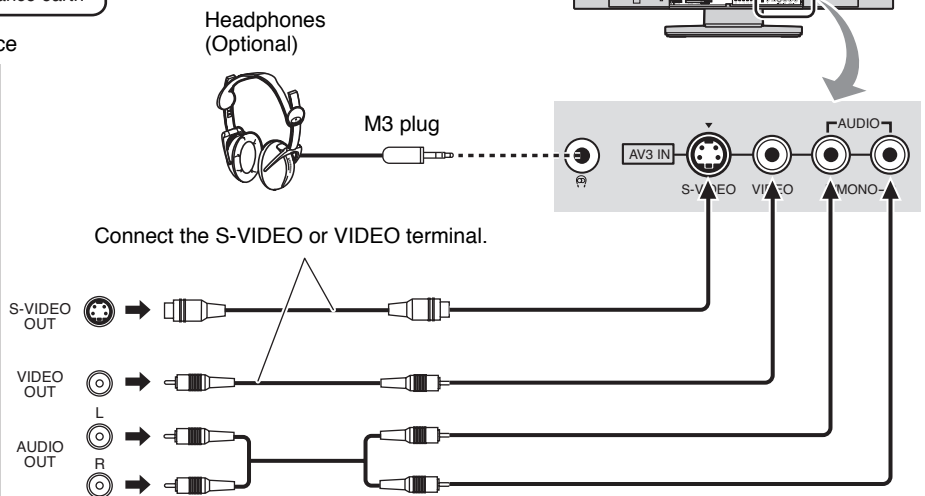
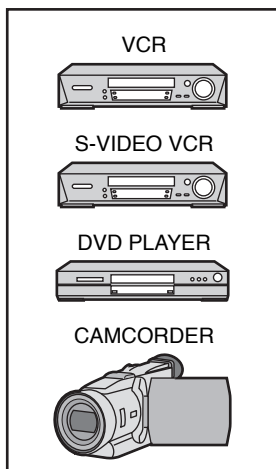

Note:

The volume level of the headphones can be adjusted by selecting "HEADPHONE VOL." from the SOUND menu.

Audio / video connections

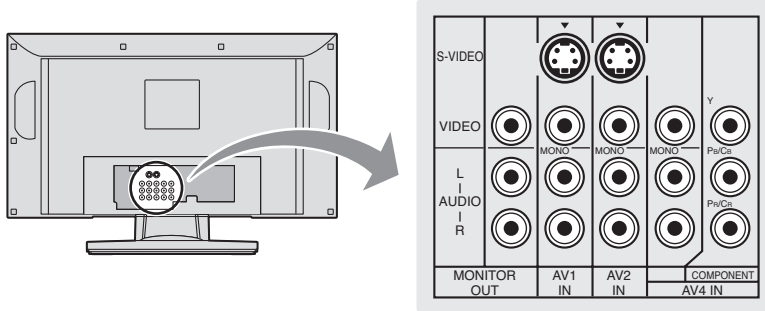

How to connect the Monitor Output Terminals to other Equipment

Example of output signal source

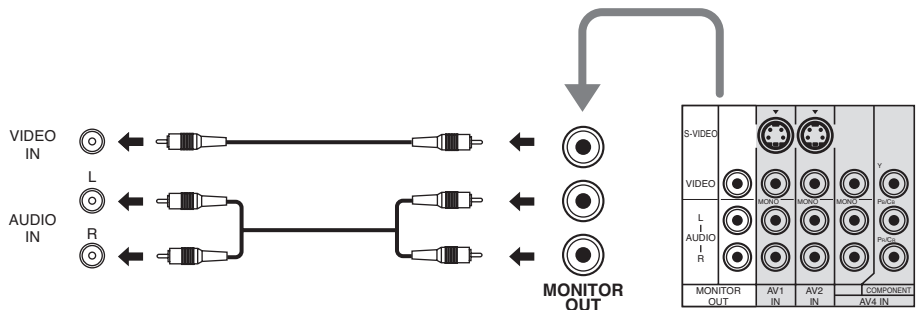
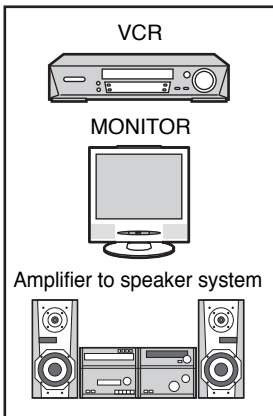

How to connect the AV1 / 2 Input Terminals

Example of input signal source

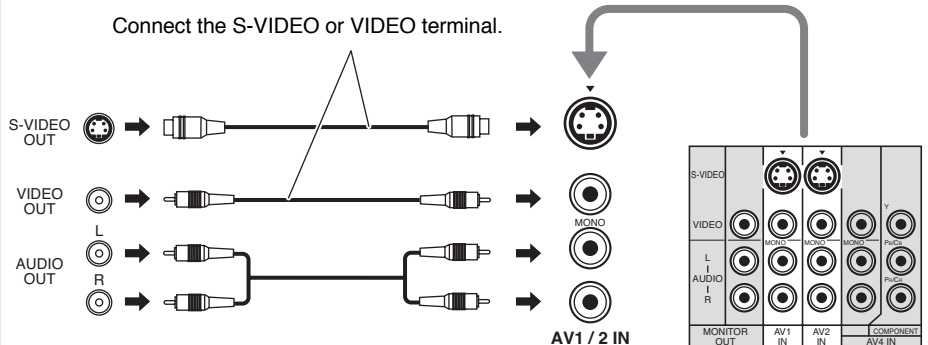
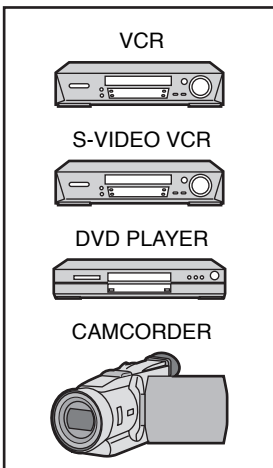

Audio / video connections

How to connect the DVD Input Terminals

Example of input signal source

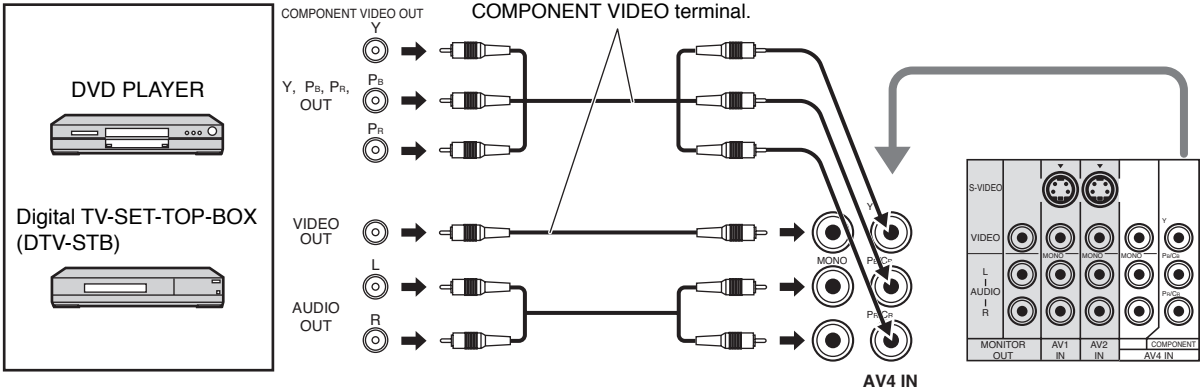

Note:

Component input terminals are used for 525i / p, 625i / p, 1125i / 50 Hz, 1125i / 60 Hz or SMPTE295M standard 1250i signal.

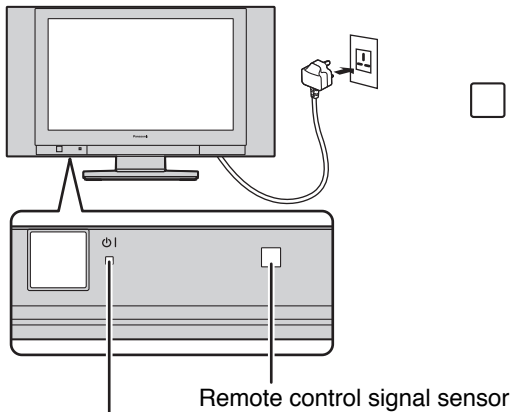

Power On / Off



Connect the mains plug to the wall socket.



Press the  switch on the TV set to turn the set on.

To switch the TV set to Standby mode, press the  button on the remote control. The TV set can be switched on by pressing the  button again if it was in Standby mode.

Notes:

- This TV will still consume some power as long as the mains plug is still inserted into the wall socket.
- The mains plug shown is an example.

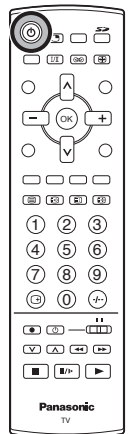

LED Indicator

- Standby : Red
- On : No Light

Basic controls: front panel and remote control

F (Function select)

Displays the On Screen Display functions, use repeatedly to select from the available functions - **VOLUME, BACKLIGHT, CONTRAST, BRIGHTNESS, COLOUR, SHARPNESS, NTSC-TINT (TINT), BASS, TREBLE, BALANCE and TUNING MODE.**

STR (Normalization store)

Used to store tuning and other function settings.

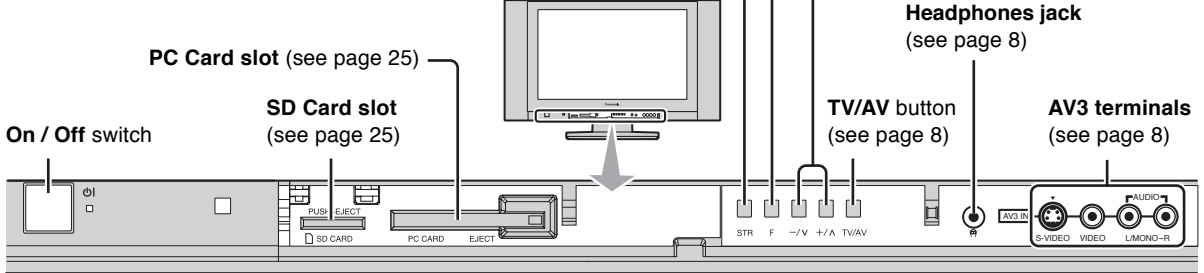

Increases or decreases the programme position by one. When a function is already displayed, press to increase or decrease the selected function. When in **Standby** mode, switches TV **On**.

Standby On / Off

Switches TV **On** or **Off** (Standby mode).

Multi Window

(see page 23)

Sound mute On / Off

Stereo / Bilingual Sound Selection
(see page 31)

R-TUNE button

Press to switch to previously viewed channel or input mode.

Programme Number Selection

Press to select the next higher or lower Programme number.

MENU button

Press to access the **PICTURE, SOUND, SETUP** and **LANGUAGE** menus.
(see page 12, 18-20)

Coloured buttons used for the selection, navigation and operation of various functions.

Teletext button

(see page 28-30)

Text F.P. button

(see page 29)

Text Index / Channel Search

(see page 22, 30)

Recall

Press to display the current system status, for example, Programme number, Channel number, Stereo mode, Aspect mode, Sound menu, Picture menu.

VCR / DVD buttons

(see page 31)

Off timer (see page 20)

Photo View mode button (see page 24-27)

Aspect control button (see page 21)

Surround On / Off (see page 19)

N (Normalize) button

Resets all settings to their default levels.

Volume Adjustment

Press to increase or decrease the sound volume level.

Press to store settings in Sound menu and Tuning menu, or to change between Multi and Single mode during Photo View mode.

Switch between viewing TV or AV input.
(see page 8)

Text Hold / Picture Still (see page 22, 28)

Direct Programme Number CH SELECT = POSITION

You can select the numbers directly by pressing Programme Number button and the two digit Numbers by pressing "Two Digit" and Programme Number buttons. Not available for TX-26LX1A, TX-32LX1A.

Programme Number 8 **8**

Programme Number 12..... **+/-**, **1**, **2**

CH SELECT = DIRECT

You can select the number directly by pressing the corresponding Programme Number button.

Channel Number 8..... **8**

Channel Number 36..... **3**, **6**

Channel Number 124... **1**, **2**, **4**



Using the On Screen Displays

Many features available on this TV can be accessed via the On Screen Display menu system. Use the remote control as shown below to access and adjust features as desired.

The **MENU** button is used to open the main menus and also to return to the previous menu.

The up and down cursor buttons are used to move the cursor and select menus.

The left and right cursor buttons are used to access menus, adjust levels or to select from a range of options.

The **OK** button is used with a number of features to store settings after adjustments have been made or options have been set.

The **TV/AV** button is used to exit the menu system and return to the normal viewing screen.

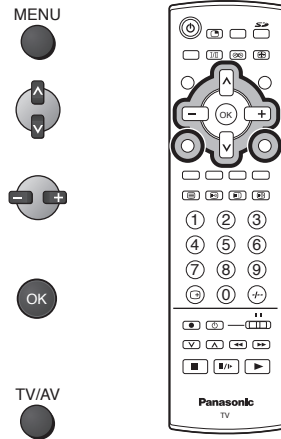

An On Screen Help box is displayed whenever a menu is displayed on the TV. This Help box indicates which buttons on the remote control are used to navigate the menu shown, see above for descriptions of button functions.

ON SCREEN HELP
'Instructions' box



Note:

The Help box is not shown in the menu pictures in this instruction book due to space limitations.



LANGUAGE (Not available for TX-26LX1A, TX-32LX1A)

You can select the On Screen Display language.

Press the **MENU** button.

Move to choose **LANGUAGE**.

Access **LANGUAGE**.

Select the language.

- TX-26LX1M, TX-32LX1M



- TX-26LX1X, TX-32LX1X

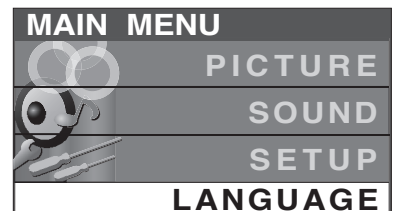
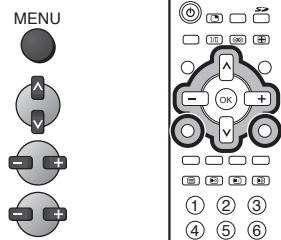
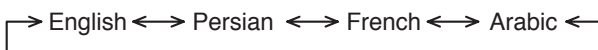

Example: TX-26LX1M, TX-32LX1M

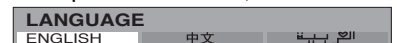

Press the **TV/AV** button at any time to go back to watching TV.



Tuning

TUNING MENU

During TV mode

Press the **MENU** button.

Move to choose **SETUP**.

Access **SETUP**.

Move to choose **TUNING MENU**.

Access **TUNING MENU**.

Move to choose menu option.

Adjust chosen option or access chosen menu.

Press the **TV/AV** button at any time to go back to watching TV.

Pressing the **OK** button after having adjusted some features will store the setting as the default (replacing the factory setting).

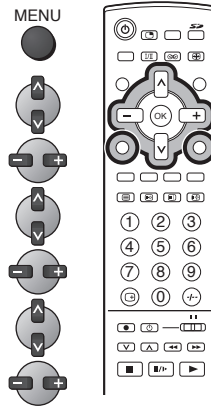

TV/AV

OK

Example: TX-26LX1M, TX-32LX1M

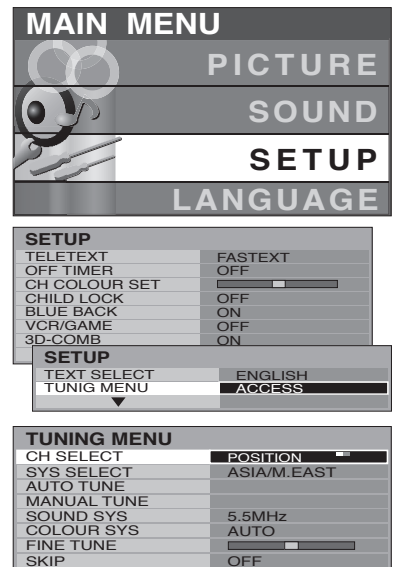

CH SELECT

Not available for TX-26LX1A, TX-32LX1A.

(Channel Selection) Select the most easily viewed channel selection method. See page 14.
POSITION ↔ DIRECT

SYS SELECT

Select the system.

(System Selection)

→ CHINA ↔ HK/UK ↔ ASIA/M.EAST ↔ NZ/INDONES ↔ AUSTRALIA ←
→ JAPAN ↔ CATV ↔ AMERICA ↔ SPECL VER ↔ E.EUROPE ←

SYSTEM SELECT	REGION
CHINA	China
HK/UK	Hong Kong, United Kingdom
ASIA/M.EAST	Malaysia, Singapore, Thailand, Asia countries, Kuwait, Saudi Arabia, United Arab Emirates, Middle East countries, etc.
NZ/INDONES	New Zealand, Indonesia, etc.
AUSTRALIA	Australia
E-EUROPE	CIS, Poland, etc.
SPECL VER	South Africa
AMERICA	USA, Chile, Mexico, Panama, Peru, Philippines, Taiwan, Venezuela, etc.
CATV	USA CATV
JAPAN	Japan

AUTO TUNE

Allows you to automatically retune the TV. Useful if you move house and wish to retune your TV to the local stations. See page 15.

MANUAL TUNE

Allows individual program positions to be tuned, manually. See page 16.

SOUND SYS

(Sound System)

Allows you to change the sound system used for a programme channel.
Choose the required sound system:

→ 4.5 MHz ↔ 5.5 MHz ←
→ 6.5 MHz ↔ 6.0 MHz ←

COLOUR SYS

(Colour System)

Lets you select the correct transmission standard for the transmission signal being received.
See page 20.

→ AUTO ↔ PAL ↔ SECAM ←
→ NTSC 3.58 ↔ NTSC 4.43 ←

FINE TUNE

Use to make small adjustments to the tuning of an individual station (useful for example when weather conditions are affecting reception quality of a program).
To cancel the FINE TUNE, tune again by MANUAL TUNE.

SKIP

It is possible to skip Program Number on which no TV stations are tuned appearing on the screen. The function is only effective when pressing the Program Number up or down button either on the TV set or on the remote control. Under the normal viewing, select the Program Number you would like to skip. Then, access TUNING MENU and set SKIP to ON.

Tuning

Channel Selection (Not available for TX-26LX1A, TX-32LX1A)

Select the most easily viewed channel selection method.

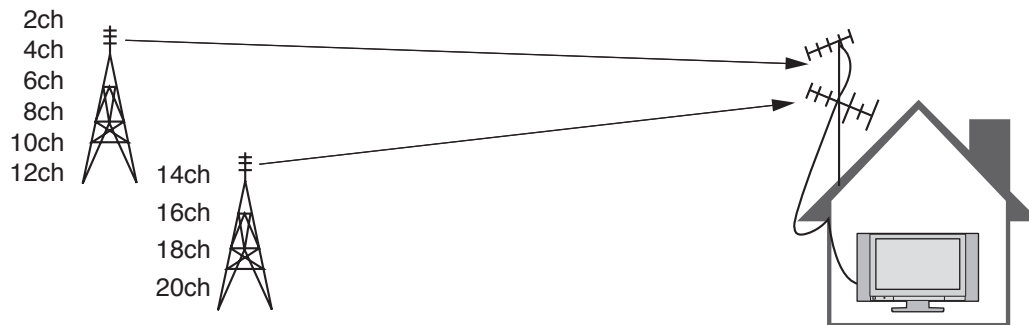

Example

Programme Number	Channel Display	Received Channel
1	2	2
2	4	4
3	6	6
4	8	8
5	10	10
6	12	12
7	14	14
8	16	16
9	18	18
10	20	20

POSITION

When the CH SELECT is on POSITION, and AUTO TUNE is performed, the unit memorises the channels tuned in order from Programme No.1.

Press the ① button to view channel 2.

Press the ② button to view channel 4.

Press the ③ button to view channel 6.

During Position mode various reception channels can be viewed.

Example

Programme Number	Channel Display	Received Channel
1	—	—
2	2	2
3	—	—
4	4	4
5	—	—
6	6	6
7	—	—
8	8	8
9	—	—
10	10	10
⋮	⋮	⋮
20	20	20
⋮	⋮	⋮

DIRECT

When the CH SELECT is on DIRECT, and AUTO TUNE is performed, the unit memorises the Programme Number which is the same as the channel tuned.

This method allows you to select the desired channel by pressing the Channel Display number directly on the remote control to select the station. The Channel Display numbers for the broadcast stations in each region are listed on page 17.

Tuning

AUTO TUNE

AUTO TUNE automatically retunes your TV. This feature is useful if, e.g., you move house and wish to retune your TV to receive the local stations.

➔ Press the **MENU** button.

Move to choose **SETUP**.

Access **SETUP**.

Move to choose **TUNING MENU**.

Access **TUNING MENU**.

Move to choose **AUTO TUNE**.

Access **AUTO TUNE**.

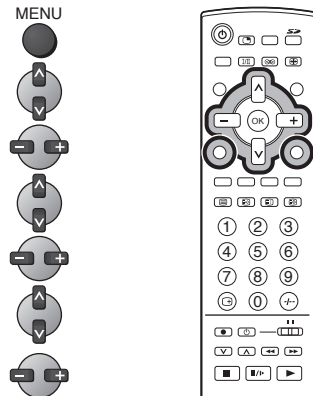

Notes:

- If you proceed with the next step all tuning data will be erased (all stations and their programme positions stored in your TV's memory will be wiped out so the new settings can be stored).
- If you exit the procedure after this point and before **AUTO TUNE** is complete, no station information will be stored. Restart and complete the AUTO TUNE procedure so that the TV is returned.

Press to start **AUTO TUNE**.

The TV will search for, locate, store and then sort into order your local stations.

Once this operation is completed the TV will display the programme now stored on programme position 1.

Press the **TV/AV** button at any time to go back to watching TV (please read the **Notes** in the above procedure).



Example: TX-26LX1M, TX-32LX1M

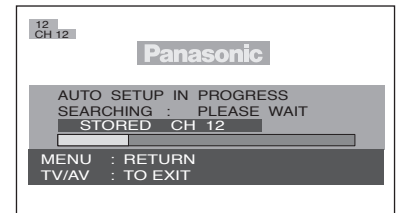

AUTO TUNE (via front panel)

It is also possible to use the control panel buttons on the front of the TV to tune individual programme positions:

Press **F** until **TUNING MODE** is reached.

Press **-/V** or **+/** to access **TUNING MODE**.

Press **F** until **AUTO TUNE** is reached.

Press **-/V** or **+/** to start search.

Press **TV/AV** at any time to exit the TUNING MENU.

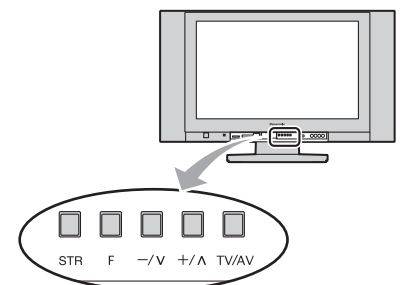

Notes:

- If a clear picture with correct colours cannot be obtained when a Broadcast or AV signal is received, refer to the COLOUR SYS selection on page 13.
- After the AUTO TUNE is finished, press the Programme Number up button to confirm the tuning condition for each Programme Number. If some Programme Numbers are unused, it is possible to skip such Programme Numbers. Please refer to the SKIP function on page 13.

Tuning

MANUAL TUNE

It is possible to retune individual programme positions:

Press the **MENU** button.

Move to choose **SETUP**.

Access **SETUP**.

Move to choose **TUNING MENU**.

Access **TUNING MENU**.

Move to choose **MANUAL TUNE**.

Access **MANUAL TUNE**.

Select the programme position to be tuned.

Press repeatedly until required station is found.

When the desired station is found, press the **OK** button to store. The programme position will flash.

Press the **TV/AV** button at any time to go back to watching TV.

MENU

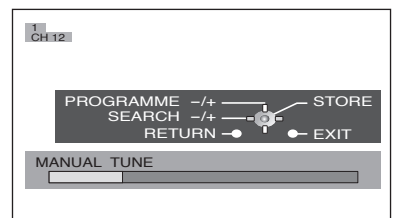
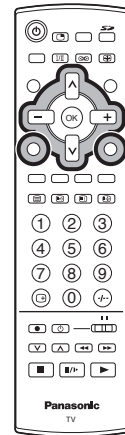

MANUAL TUNE (via front panel)

It is also possible to use the control panel buttons on the front of the TV to tune individual programme positions:

Press **F** until **TUNING MODE** is reached.

Press **-/V** or **+/\A** to access **TUNING MODE**.

Press **F** until **MANUAL TUNE** is reached.

Press **-/V** or **+/\A** to access **MANUAL TUNE**.

Press **TV/AV** to move between Change programme, Search and Change sound system.

Press **-/V** or **+/\A** to change programme position or start search.

When the desired station is found, press **STR** to store.

The programme position will flash.

Repeat above procedure to tune additional programme positions.

Press **F** at any time to exit the TUNING MENU.

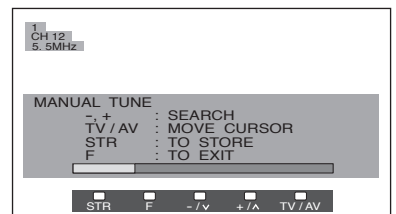
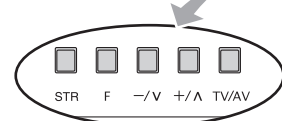
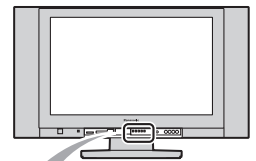

Notes:

- If a clear picture cannot be obtained even when a Broadcast or AV signal is received, refer to the COLOUR SYS selection on page 13.
- After the MANUAL TUNE is finished, press the Programme Number up button to confirm the tuning condition for each Programme Numbers. If some Programme Numbers are unused, it is possible to skip such Programme Numbers. Please refer to the SKIP function on page 13.
- When using a VCR without video and audio input / output terminals, it is convenient to connect the aerial cable as indicated in the instruction manual of VCR and to set the designated channel to Programme No."0". In that case, perform MANUAL TUNE after setting the COLOUR SYS and SOUND SYS in advance. Further, in multi-system VCR, it is more convenient to set the designated channel to several Programme Numbers.

Channel Allocation

SYS SELECT	CHINA	HK/UK	ASIAM.EAST	NZ/INDONES	AUSTRALIA	E.EUROPE	SPECL VER	AMERICA	CATV	JAPAN
CH DISPLAY	RECEIVE CHANNEL									
0	-	-	-	-	-	-	-	-	-	-
1	1	-	-	1	0	1	1	-	1	1
2	2	-	2	2	1	2	2	2	2	2
3	2	-	2	2	2	2	2	2	2	2
4	2	-	2	2	3	2	2	2	2	2
5	2	-	2	2	4	2	2	2	2	2
6	2	-	2	2	5	2	2	2	2	2
7	2	-	2	2	S2	2	2	2	2	2
8	2	-	2	2	2	2	2	2	2	2
9	2	-	2	2	2	2	2	2	2	2
10	2	-	2	2	2	2	2	2	2	2
11	2	-	11	11	2	11	11	11	2	2
12	12	-	12	-	2	12	12	12	2	12
13	13	-	-	-	2	-	13	13	2	13
14	2	-	-	-	2	-	14	14	2	2
15	2	-	-	-	S10	-	-	-	2	2
16	2	-	-	-	6	-	-	-	2	2
17	2	-	-	-	7	-	-	-	2	2
18	2	-	-	-	8	-	-	-	2	2
19	2	-	-	-	9	-	-	-	2	2
20	2	-	-	-	9A	-	-	-	2	2
21	2	21	21	21	10	21	21	2	2	2
22	2	2	2	2	11	2	2	2	2	2
23	2	2	2	2	12	2	2	2	2	2
24	2	2	2	2	S11	2	2	2	2	2
25	2	2	2	2	2	2	2	2	2	2
26	2	2	2	2	2	2	2	2	2	2
27	2	2	2	2	2	2	2	2	2	2
28	2	2	2	2	2	2	2	2	2	2
29	2	2	2	2	2	2	2	2	2	2
30	2	2	2	2	2	2	2	2	2	2
31	2	2	2	2	2	2	2	2	2	2
32	2	2	2	2	2	2	2	2	2	2
33	2	2	2	2	2	2	2	2	2	2
34	2	2	2	2	2	2	2	2	2	2
35	2	2	2	2	2	2	2	2	2	2
36	2	2	2	2	2	2	2	2	2	2
37	2	2	2	2	2	2	2	2	2	2
38	2	2	2	2	2	2	2	2	2	2
39	2	2	2	2	2	2	2	2	2	2
40	2	2	2	2	2	2	2	2	2	2
41	2	2	2	2	2	2	2	2	2	2
42	2	2	2	2	2	2	2	2	2	2
43	2	2	2	2	2	2	2	2	2	2
44	2	2	2	2	2	2	2	2	2	2
45	2	2	2	2	2	2	2	2	2	2
46	2	2	2	2	2	2	2	2	2	2
47	2	2	2	2	2	2	2	2	2	2
48	2	2	2	2	2	2	2	2	2	2
49	2	2	2	2	2	2	2	2	2	2
50	2	2	2	2	2	2	2	2	2	2
51	2	2	2	2	2	2	2	2	2	2
52	2	2	2	2	2	2	2	2	2	2
53	2	2	2	2	2	2	2	2	2	2
54	2	2	2	2	2	2	2	2	2	2
55	2	2	2	2	2	2	2	2	2	2
56	2	2	2	2	2	2	2	2	2	2
57	57	2	2	2	S44	2	2	2	2	2
58	2	2	2	2	20	2	2	2	2	2
59	2	2	2	2	21	2	2	2	2	2
60	2	2	2	2	2	2	2	2	2	2
61	2	2	2	2	2	2	2	2	2	2
62	2	62	62	62	2	62	62	62	62	62
63	2	63	63	63	2	63	63	63	63	C13
64	2	2	2	2	2	2	2	2	2	2
65	2	2	2	2	2	2	2	2	2	2
66	2	2	2	2	2	2	2	2	2	2
67	2	2	2	2	2	2	2	2	2	2
68	2	2	2	2	2	2	2	2	2	2
69	2	69	69	69	2	69	69	69	69	2
70	2	2	2	2	2	2	2	2	2	2
71	2	2	2	2	2	2	2	2	2	2
72	2	2	2	2	2	2	2	2	2	2
73	2	2	2	2	2	2	2	2	2	2
74	2	S'1	S'1	S'1	2	S'1	S'1	2	2	2
75	2	S'2	S'2	S'2	2	2	S'2	2	2	2
76	2	S'3	S'3	S'3	2	2	S'3	2	2	2
77	2	2	2	2	2	2	2	2	2	2
78	2	2	2	2	2	2	2	2	2	2
79	2	2	2	2	2	2	2	2	2	2
80	2	S1	S1	S1	2	S1	S1	2	2	2
81	Z1	S2	S2	S2	2	S2	S2	2	2	2
82	2	2	2	2	2	2	2	2	2	2
83	2	2	2	2	2	2	2	2	2	2
84	2	2	2	2	2	2	2	2	2	2
85	2	2	2	2	2	2	2	2	2	2
86	2	2	2	2	2	2	2	2	2	2
87	2	2	2	2	2	2	2	2	2	2
88	2	2	2	2	2	2	2	2	2	2
89	Z9	S10	S10	S10	2	S10	S10	2	2	2
90	Z10	S11	S11	S11	2	S11	S11	2	2	2
91	Z11	S12	S12	S12	2	S12	S12	2	2	2
92	Z12	S13	S13	S13	2	S13	S13	2	2	2
93	Z13	S14	S14	S14	2	S14	S14	2	2	2
94	Z14	S15	S15	S15	2	S15	S15	2	2	2
95	Z15	S16	S16	S16	2	S16	S16	2	2	2
96	Z16	S17	S17	S17	2	S17	S17	2	2	2
97	Z17	S18	S18	S18	2	S18	S18	2	2	2
98	Z18	S19	S19	S19	2	S19	S19	2	2	2
99	Z19	S20	S20	S20	2	S20	S20	2	99	C49
100	Z20	S21	S21	S21	2	S21	S21	2	100	2
101	2	2	2	2	2	2	2	2	2	2
102	2	2	2	2	2	2	2	2	2	2
103	2	2	2	2	2	2	2	2	2	2
104	2	2	2	2	2	2	2	2	2	2
105	2	2	2	2	2	2	2	2	2	2
106	2	2	2	2	2	2	2	2	2	2
107	2	2	2	2	69	2	2	2	2	2
108	2	2	2	2	2	2	2	2	2	2
109	2	2	2	2	2	2	2	2	2	2
110	2	2	2	2	2	2	2	2	2	2
111	2	2	2	2	2	2	2	2	2	2
112	2	2	2	2	2	2	2	2	2	2
113	2	2	2	2	2	2	2	2	2	2
114	2	2	2	2	2	2	2	2	2	2
115	2	2	2	2	2	2	2	2	2	2
116	2	2	2	2	2	2	2	2	2	2
117	Z37	2	2	2	2	2	2	2	2	2
118	2	2	2	2	2	2	2	2	2	2
119	2	2	2	2	2	2	2	2	2	2
120	2	S41	S41	S41	2	S41	S41	2	2	2
121	2	2	2	2	2	2	2	2	2	2
122	2	2	2	2	2	2	2	2	2	2
123	2	2	2	2	2	2	2	2	2	2
124	2	2	2	2	2	2	2	2	2	2
125	2	2	2	2	2	2	2	2	125	2

PICTURE

Press the **MENU** button.

Move to choose **PICTURE**.

Access **PICTURE**.

Move to choose menu option.

Adjust chosen option or access chosen menu.

Press the **TV/AV** button at any time to go back to watching TV.

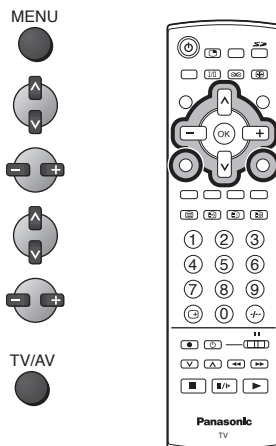

MENU

MENU mode will be memorized for each TV, AV1, AV2, AV3 and AV4 mode.



You can change the level of each Item (BACKLIGHT, CONTRAST, BRIGHTNESS, COLOUR, SHARPNESS, NTSC-TINT, C.TEMP, AI, D.PNR and MPEG NR) for each MENU (DYNAMIC, STANDARD and CINEMA) according to your personal preference.

Example: TX-26LX1M, TX-32LX1M

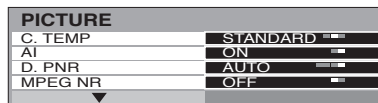
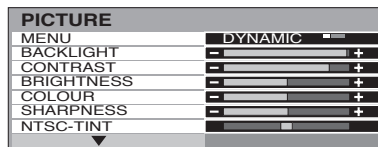
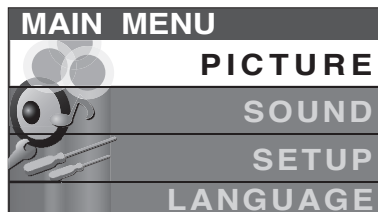

BACKLIGHT, CONTRAST, BRIGHTNESS, COLOUR, SHARPNESS

Increase or decrease the levels of these options according to your personal preference.

NTSC-TINT (TINT)

The picture hue can be adjusted to suit your taste.

Notes:

- When the TV is receiving NTSC signals, NTSC-TINT is displayed and level adjustment is possible.
- When the TV is receiving YUV (60Hz) signals, TINT is displayed and level adjustment is possible.

C.TEMP

Allows you to set the overall colour tone of the picture. Choose from COOL, STANDARD and WARM.

AI

Automatically analyses the incoming picture and processes it to give improved contrast and optimum depth of field.

D.PNR

Automatically reduces unwanted picture noise.

MPEG NR

Reduces MPEG noise.

This function is effective in reducing the digital block noise when viewing DVD, VCD or digital broadcasting. The effect will be changed based on the scene and image.

MPEG Compression technology of the image signal adopted by DVD, VCD or digital broadcasting.

Note:

By pressing the **N** button on the remote control while the PICTURE menu is displayed, the selected menu will be changed to the Normal mode.

Normalization will not occur if the menu is not displayed when the **N** button is pressed.

The Normal mode is the factory preset condition. Returning to this original condition is called "Normalization".

SOUND

Press the **MENU** button.

Move to choose **SOUND**.

Access **SOUND**.

Move to choose menu option.

Adjust chosen option or access chosen menu.

Press the **TV/AV** button at any time to go back to watching TV.

Pressing the **OK** button after having adjusted some features will store the setting as the default (replacing the factory setting).

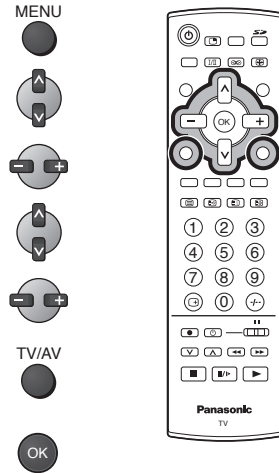

- MENU** MENU mode will be memorized for each TV, AV1, AV2, AV3 and AV4 mode. You can change the level of each Item (VOLUME, BASS, TREBLE, BALANCE, HEADPHONE VOL. and SURROUND) for each MENU (MUSIC, NEWS and CINEMA).
- VOLUME** Increase or decrease output volume.
- BASS** Increase or decrease level to enhance or minimise lower, deeper sound output.
- TREBLE** Increase or decrease level to enhance or minimise sharper, higher sound output.
- BALANCE** The levels of sound between the left and right speakers can be adjusted to suit your listening position.
- HEADPHONE VOL.** Can be adjusted independently of the TV speakers so that everyone can enjoy listening at a level comfortable for them.
- SURROUND** To enjoy a concert hall effect, turn SURROUND to ON. Switching is also possible by pressing the **SURROUND** button. The benefits of SURROUND sound are enormous. You can be completely enveloped in sound; just as if you were at a concert hall or cinema. The SURROUND effect can be obtained without the use of external SURROUND speakers.

Example: TX-26LX1M, TX-32LX1M

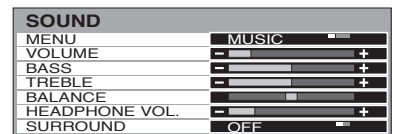
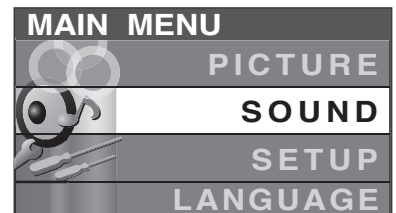

Note:

By pressing the **N** button on the remote control while the SOUND menu is displayed, the selected menu will be changed to the Normal mode.

Normalization will not occur if the menu is not displayed when the **N** button is pressed.

The Normal mode is the factory preset condition. Returning to this original condition is called "Normalization".

SETUP

Press the **MENU** button.

Move to choose **SETUP**.

Access **SETUP**.

Move to choose menu option.

Adjust chosen option or access chosen menu.

Press the **TV/AV** button at any time to go back to watching TV.

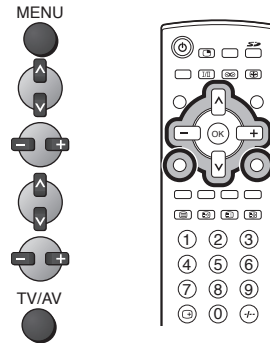

Example: TX-26LX1M, TX-32LX1M

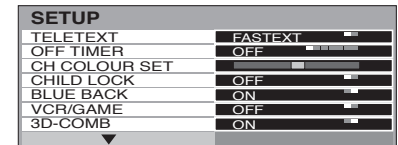
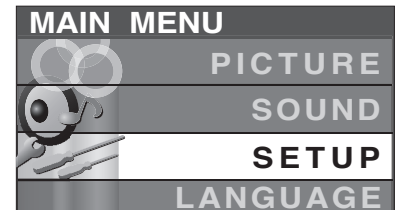

AV mode

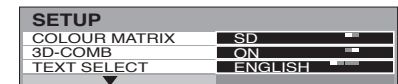
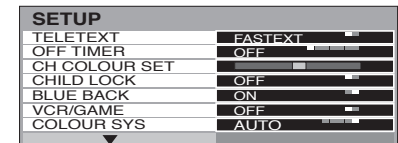

TELETEXT

Allows you to choose 2 modes. See page 28.
 • TX-26LX1A, TX-32LX1A TOP / List
 • other FASTEXT / List

OFF TIMER

Switches the TV off within a preset time which you can choose from between 0 to 90 minutes in 15 minute intervals. Switching is also possible by pressing the **OFF TIMER** button.

CH COLOUR SET

Colour density varying between broadcast channels can be adjusted to three levels for each reception channel.

CHILD LOCK

When ON, picture and sound of the TV/AV mode being viewed will disappear and a Black screen will appear. CHILD LOCK can be set for each programme number and each AV mode.

BLUE BACK

You can choose Blue Back display ON or OFF when there is no signal.

VCR/GAME

Reproduction of irregular signals, such as certain TV games and rental video tapes, may be improved.

COLOUR SYS

(Colour System)

Displayed during **AV** mode. If a clear picture with current colours cannot be obtained when a Broadcast or AV signal is received, this function is used.
 AUTO / PAL / SECAM / NTSC 4.43 / NTSC 3.58

PAL, SECAM and NTSC 3.58 are different colour signal broadcast transmission systems applicable to differing countries. NTSC 4.43 is a trick playback mode used in special VCR's to playback NTSC recorded video tapes through PAL television equipment.

COLOUR MATRIX

Displayed during **AV** mode. Available only with 480p or 575p input signals in a natural colour from digital equipment connected to AV4 Component terminals. Select SD or HD to automatically adjust colour parameters for SD (standard definition) or HD (high definition).

3D-COMB

Occasionally, whilst viewing still or slow moving pictures, colour patterning may be seen. Set 3D-COMB to ON to display sharper and more accurate colours. Displayed only when receiving PAL or NTSC signals. Not displayed during RGB Video, S-Video input and AV4 Component input mode.

TEXT SELECT

Not available for TX-26LX1A, TX-32LX1A. Select character set, so that all characters needed are available for text on teletext pages.
 ENGLISH / CIS / E.EUROPE / PERSIAN

TUNING MENU

Provides access to many other features including SYS SELECT and AUTO TUNE. See page 13. Not displayed during AV mode.

Aspect Controls

The Widescreen TV will allow you to enjoy viewing the picture at its optimum size and aspect, including widescreen cinema format pictures.

Press the **ASPECT** button repeatedly to move through the aspect options:

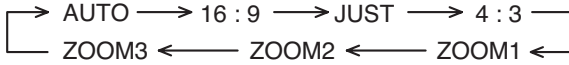

OR

Press the **ASPECT** button. Whilst the on screen selector keys are displayed, use the **Red** or **Green** buttons to move in either direction through the aspect options.

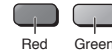
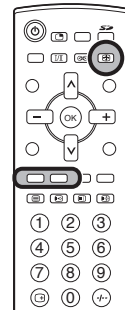

AUTO

AUTO position can be set to 16:9. When a wide screen signal is detected at the Video terminal the TV will select the 16:9 aspect ratio.



AUTO

16 : 9

16:9 will display a true 16:9 (anamorphic) picture with no aspect distortions.

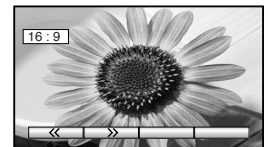

16 : 9

JUST

Use **JUST** when you wish to expand a 4:3 picture to fill the whole screen (rather than watching a programme with black stripes down the left and right sides of the picture). The 4:3 picture will be stretched horizontally so that the image fills the screen, this is done in such a way that the stretching is only obvious at the left and right edges of the screen.

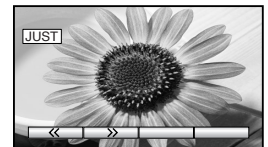

JUST

4 : 3

4:3 will display a 4:3 picture at its standard 4:3 size with no aspect distortions.



4 : 3

ZOOM1

ZOOM1 will display 16:9 or 4:3 pictures with no aspect distortions.

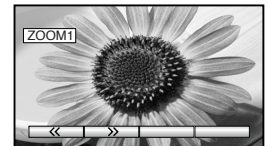

ZOOM1

ZOOM2

ZOOM2 will display 16:9 anamorphic letterbox pictures as a full screen display with no aspect distortions.

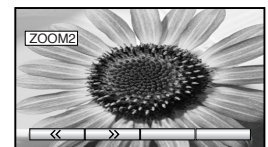

ZOOM2

ZOOM3

ZOOM3 will display 21:9 letterbox pictures as a full screen display with no aspect distortions.
16:9 will display the picture at its maximum size but with slight stretching.

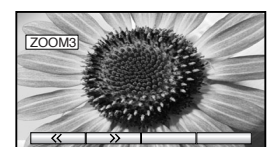

ZOOM3

Still

Press the **STILL** button to freeze the picture.
Press again to return to watching the current programme.

HOLD

STILL

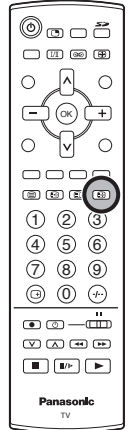

Channel search

Press the **CH SEARCH** button to show freeze-frames of the programmes being broadcast on all of the stored channels. These images are displayed in series, starting from the top left.

The feature cycles through the stored channels until the **CH SEARCH** button is pressed to exit the feature.

Press the **Red** button to select each channel's freeze-frame in turn.

Press the **Green** button to watch the selected channel, exiting the feature.

Press the **Blue** button to watch the current programme, exiting the feature.

INDEX

CH SEARCH

  
Red Green Blue

Channel search

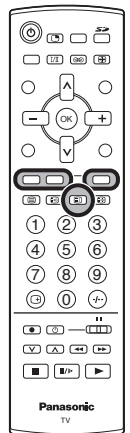
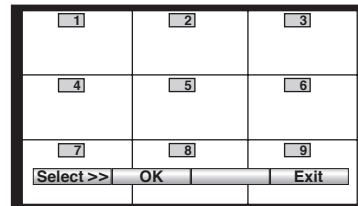

Multi window

Press the **MULTI PIP** button. Whilst the on screen selector keys are displayed, use the **Red** or **Green** buttons to move between the **PIP** (picture in picture) feature, **POP** (picture out of picture) and **PAP** (picture and picture) feature.

Press the **Blue** button to swap the contents of the two windows.

The on screen selector keys that appear for the features clear after a few seconds. If you want to select an operation when the keys are not shown, press the **MULTI PIP** button again and the keys will reappear.

Press the **MULTI PIP** button (whilst the selector keys are displayed) to return to normal viewing.

Notes:

- This TV has one tuner. When the main and sub windows are both TV mode, these are the same TV channel.
- This operation cannot be made during progressive signal or 1080i signal input (Y, PB, PR).

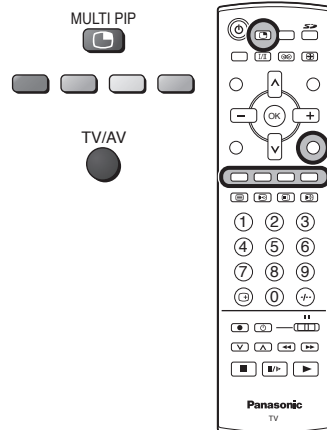

Changing the channels

• Main window

Press the Programme Number button on the remote control.

• Sub window

Press the **MULTI PIP** button. Whilst the on screen selector keys are displayed, press the Programme Number button on the remote control.

Picture in picture mode

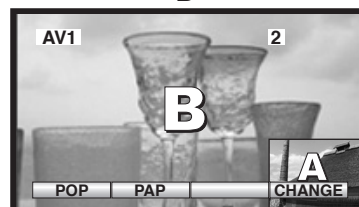
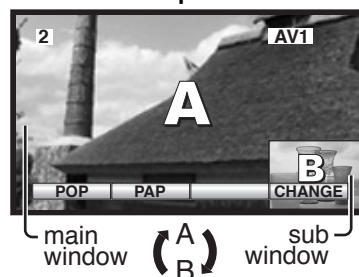

The two pictures have been swapped, the picture in the smaller window has become the main window picture.

Picture out of picture mode

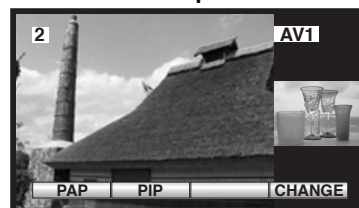

Picture and picture mode



Changing the mode

• Main window

Press the **TV/AV** button to switch between the TV and AV mode.

During the AV mode, press any coloured button. Whilst the on screen selector keys are displayed, press coloured button to select the AV source.

• Sub window

Press the **MULTI PIP** button. Whilst the on screen selector keys are displayed, press the **TV/AV** button to switch between the TV channel and all AV sources in turn.

Photo View mode

Still image data (JPEG) made with a digital camera or digital video camera can be played back using an SD Card / PC Card.

Displayable Image Formats: Baseline JPEG 64 × 64 – 8,192 × 8,192 pixels (sub-sampling 4:2:2 or 4:2:0)

Displayable number of folders: Max 100

Notes:

- Some parts of an image may not be displayed or the image may be displayed on a smaller scale depending on the size of the image.
- Only EXIF standard JPEG images can be displayed on this TV.
- Photo view cannot support over 3,000 JPEG files.
- Cards must be formatted with FAT12 or FAT16 in order to be viewed on this TV.
- Photo view is not compatible with card type hard disk (Micro Drive, Mobile type hard disk).
- Some PC Cards may not be usable.
- Without operations for 5 minutes, Screensaver will start automatically to prevent image retention (except Slide show). To exit, press any button.

Card Data Protection

- Do not remove the card whilst it is being accessed.
- Do not touch the terminals on the back of the SD Card / PC Card.
- Electrical interference, electrostatic discharges and malfunctions of the TV set or card may all result in damage to the card or data loss. It is recommended that any important data also be backed up on a PC.
- Stored data should be periodically backed up as a protection against data corruption, data loss or device malfunction. Please note that our company shall not accept any liability for damage or loss of stored data.
- Before inserting or removing the PC Card, make sure that the TV is turned off. Otherwise, it may damage the unit. Do not insert anything other than the PC Card.

Cautions:

- Always insert card in the correct direction. Failure to do so may result in damage to the card and this set.
- The SD Card and PC Card are precision devices. Do not subject them to excessive pressure or strong impacts.

Warning:

As with any small object, SD Cards can be swallowed by young children. Do not allow children to handle the SD Card. Please remove the SD Card immediately after use.

Folders and Files

Digital cameras that are compliant with DCF specifications use folders with a specific structure. The following diagram shows an example of the folder structure.

Example:

If the Card file hierarchy is displayed on the PC as shown below.

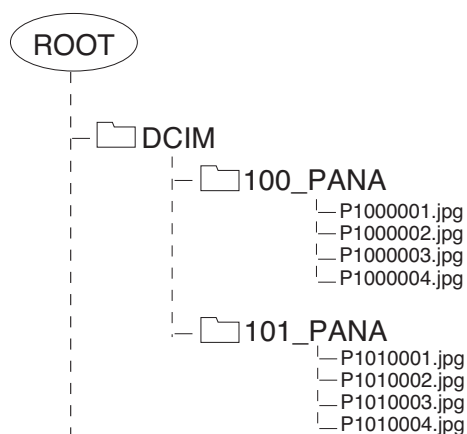

DCIM Folder

The digital camera creates this folder automatically.

100_PANA Folder

Folder names consist of a 3-digit folder number which is followed by five arbitrary characters. Digital camera images are stored within these folders.

JPEG files in the 100_PANA folder are displayed when a Card, which is structured as shown left, is inserted.

Notes:

- The folder name may vary according to the digital camera being used.
- When a directory or file is created, only the characters “A-Z”, “a-z”, “0-9” and “_” are used. Two-byte characters or other special codes shall not be used.

P1000001.JPG: DCF File

File names consist of four arbitrary characters followed by a 4-digit file number. DCF files are image files (normally JPEG files) that have been taken by a digital camera.

Photo View mode

SD Card

Insertion

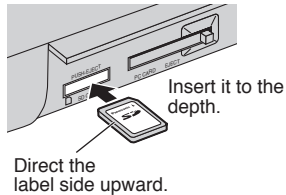

Removal

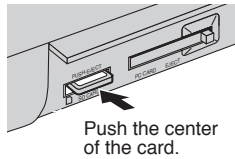

PC Card

Before inserting or removing the PC Card, make sure that the TV is turned off. Otherwise, it may damage the unit. Do not insert anything other than the PC Card.

Insertion

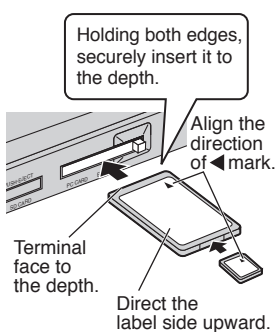

Removal

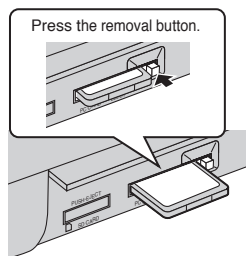

If PC Card cannot be removed
Push in PC Card again, and press the removal button.

Caution

If PC Card adapter is used, remove it together with the adapter.

Compatible Card

SD Card slot	PC Card slot
SD Card	Compact Flash*
Multi Media Card	Smart Media*
miniSD Card	Memory Stick*
	xD Picture Card*
	Flash ATA Card*

- miniSD Card requires miniSD™ adapter.
- The media* listed in the right column above can be read via the PC Card in the PC Card adapter.
- Hard disk PC Cards and other recorded media cannot be used.
- Place the selected media onto the PC Card and then insert into the PC Card Slot.
- When both SD Card and PC Card are inserted, the SD Card contents have priority and will be displayed.
- If the Card is incompatible, "THIS TYPE OF CARD IS NOT SUPPORTED" is displayed on screen. Remove the Card only when Access indication is not displayed.
- If the file is not formatted with FAT12 or FAT16, "THIS TYPE OF FORMAT IS NOT SUPPORTED" is displayed.
- If the JPEG file is corrupted and cannot be decoded, "THIS TYPE OF IMAGE IS NOT SUPPORTED" is displayed.

Notes:

- Insert / remove the SD Card while Card Menu Screen or "CARD IS NOT INSERTED CORRECTLY" is displayed.
- Be sure Access indication is not displayed before Card insertion / removal.
- Before reinserting the SD Card after removing it, wait until "CARD IS NOT INSERTED CORRECTLY" is displayed. If there are Cards in both Card Slots, wait until the Card Menu Screen of the other Slot is displayed and Access indication is no longer displayed before reinserting the Card.
- If the JPEG is modified using a PC, it will not be displayed on the TV.
- It may take long time to display the thumbnail if there are lots of files or if the file size is big.

Press the **SD** button.



The screen below is displayed automatically when a card is inserted. If "CARD IS NOT INSERTED CORRECTLY" appears, confirm that a card is correctly inserted. Press the **SD** button again to exit Photo View mode.

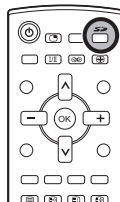

Card Menu Screen

Selected File

Selected File number / Total number of Files

Index Area
12 files are displayed here.

File Data
The information of the selected file (framed in yellow) is displayed.

SD Card Indication
This indication is displayed whilst SD Card is inserted.

PC Card Indication
This indication is displayed whilst PC Card is inserted.

Access Indication
Access is displayed whilst data is read.

Photo View mode

PICTURE

During **Photo View mode**

Press the **MENU** button.

Move to choose **PICTURE**.

Access **PICTURE**.

Move to choose menu option.

Adjust chosen option or access chosen menu.

Press the **TV/AV** button at any time to exit PICTURE.



BACKLIGHT, CONTRAST, BRIGHTNESS, COLOUR, SHARPNESS

Increase or decrease the levels of these options according to your personal preference.

NTSC-TINT The picture hue can be adjusted to suit your taste.

C.TEMP Allows you to set the overall colour tone of the picture. Choose from **COOL**, **STANDARD** and **WARM**.

Example: TX-26LX1M, TX-32LX1M

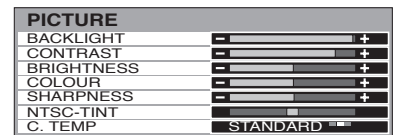
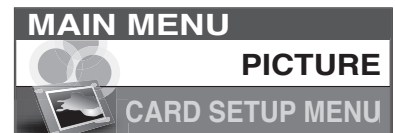

CARD SETUP MENU

During **Photo View mode**

Press the **MENU** button.

Move to choose **CARD SETUP MENU**.

Access **CARD SETUP MENU**.

Move to choose menu option.

Adjust chosen option or access chosen menu.

Press the **TV/AV** button at any time to exit CARD SETUP MENU.



SLIDE SHOW Provides access to Slide Show mode. See page 27.

INTERVAL When the Slide Show, allows you to select the display intervals between 5 to 90 seconds.

SEQUENCE When the Slide Show, allows you to select the **ORDER** or **RANDOM**.

REPEAT When REPEAT is **ON**, the Slide Show repeats automatically.

CARD Select either **SD** or **PC** when both cards are inserted in the slots.

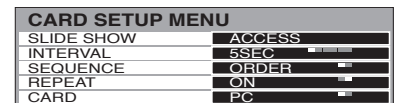
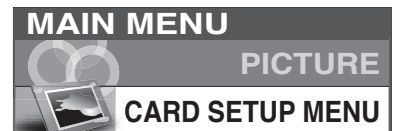

Photo View mode

When you press the **SD** button, thumbnail screen is displayed automatically.
After that you can choose your desirable view mode between the following three modes.

Multi mode

12 images are displayed.

Press to select desired image.

Press the **OK** button to display Single mode.



Example: TX-26LX1M, TX-32LX1M



Single mode

A single image selected from the index area fills the screen.
You can also rotate or magnify the image.

Press to select the next or previous image.

Press the **OK** button to display Multi mode.

Press the **Red** or **Green** button to rotate the image.
Each press rotates images 90°.

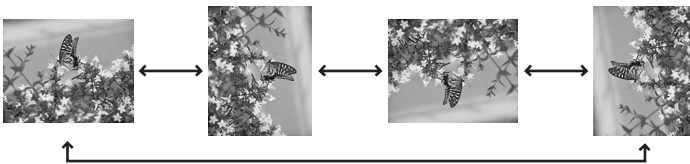
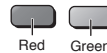

Press the **Yellow** button to magnify the image.
To restore press the **Blue** button.



Slide Show

Images are displayed one after another as a slide show.

To start Slide Show access **CARD SETUP MENU**.
After setting INTERVAL, SEQUENCE and REPEAT, access **SLIDE SHOW**.

When both SD Card and PC Card are inserted, move to choose CARD and select SD or PC before accessing SLIDE SHOW.
See page 26.

Press the **OK** button at any time to return to the Single mode.



CARD SETUP MENU	
SLIDE SHOW	ACCESS
INTERVAL	5SEC
SEQUENCE	ORDER
REPEAT	ON
CARD	PC



CARD SETUP MENU	
SLIDE SHOW	ACCESS
INTERVAL	5SEC
SEQUENCE	ORDER
REPEAT	ON
CARD	PC

Note:

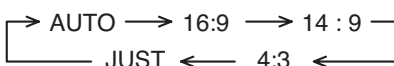
When you are in the Slide Show mode, you can change the Aspect of the image on screen by pressing the **ASPECT** button on the remote control.



Teletext operation

- Teletext features may vary depending on the Broadcasting Companies and is only available if the channel selected is transmitting Teletext.
- Pressing the **MENU** button whilst in Teletext operation will display the backlight function with a white bar and the contrast function with a cyan bar, press  to alter the setting as required.
- Pressing the **MENU** button whilst in Teletext operation will display special function options at the bottom of the screen.
- Pressing the **MENU** button whilst in Teletext operation will display the volume function with a green bar, press  to alter the setting as required.

What is List mode ?

In List mode, four differently coloured page numbers are situated at the bottom of the screen. Each of these numbers can be altered and stored in the TV's memory.

What is FASTEXT or TOP mode?

In FASTEXT or TOP mode, four differently coloured subjects are situated at the bottom of the display. To access more information about one of these subjects, press the appropriately coloured button. This facility enables fast access to information on the subjects shown.

Note:

If Teletext is in use, the aspect ratio is set to 16:9.



TV / Teletext mode

Press the **TV/TEXT** button to switch between the current programme.



Page Selection

Pages can be selected in two ways :

- Press the Up / Down buttons to increase or decrease the page number by one.
- By entering the page number, using 0 - 9 on the remote control.



Full / Top / Bottom

Press the **MENU** button to display special functions, followed by the **Green** button. Press the **Green** button again to expand the **BOTTOM** half. Press again to return to normal (FULL) size.



Reveal

Press the **MENU** button to display special functions, followed by the **Red** button to reveal hidden words e.g., quiz page answers. Press again to hide.



Red / Green / Yellow / Blue buttons

In FASTEXT or TOP mode they correspond to the differently coloured subjects. In List mode they correspond to the differently coloured page numbers.



List Store

In List mode the four page numbers can be altered (programme positions 1 - 25 only). To do this, press one of the four coloured buttons and enter the new page number. Press and hold the **OK** button, the page numbers will change to white indicating that the page is stored.



HOLD

To hold the Teletext page when viewing multi-page information. Press again to return to automatic page update.

Teletext operation

It is not possible to change the programme position when in News flash, Update or Sub Coded Page Access operation.



Favourite Page (F.P.)

Stores a favourite page in memory for instant recall. To store such a page, the TV must be in List mode, and the programme position must be from 1 - 25.

Press the **Blue** button, select the page number, then press and hold the **OK** button. The page number is now stored.

Press **F.P.** to recall this page.

Update Display

Press the **MENU** button to display special functions, followed by the **Yellow** button to view the TV picture whilst searching for a Teletext page (this is not necessary in **picture and text** mode, as the picture is displayed on the left of the screen). When found, the screen will display the page number at the top left. Press the **Yellow** button to view the page.

Press the **TV/TEXT** button again to return to normal TV operation.

News Flash

When a news flash page has been selected, press the **MENU, Yellow** buttons, to view the TV picture. When an update is received, the page number will be displayed on screen.

Press the **Yellow** button to display the News Flash.

Press the **TV/TEXT** button to return to normal TV operation.

Update

Press the **MENU, Yellow** buttons to see the update of information on certain pages.

When an update is received, the page number will be displayed at the top left of the screen.

Press the **Yellow** button to view the page.

Press the **TV/TEXT** button to return to normal TV operation.



Accessing sub pages

When Teletext information exceeds one page, it may take some time for the automatic changing of the sub pages to reach the sub page you require. As each sub page is found its number is displayed at the top of the page so that you may select it; as more sub pages are picked up, the display at the top of the page changes, so that you are always offered the most recently transmitted selection of sub pages.

In Teletext operation, use the following procedure to access sub pages:

If the sub page you want to look at is not yet available, press the **MENU** button (to display special functions) followed by the **Yellow** button to view the TV picture whilst waiting for more sub pages to be found. The sub pages found will be displayed across the top of the screen.

When the sub page you are waiting for is available press the **Yellow** button to return to viewing the Teletext pages, then use the left and right cursor buttons to select the sub page of your choice.

Notes:

- If you do not want to display the on screen selector keys on the TV picture whilst waiting for a sub page to be found, press the **MENU** button to clear the keys from the screen. Press again to redisplay the keys.
- If you have cleared the special function keys from the screen and then used the left and right cursor buttons to select a sub page, whilst still viewing the TV picture, you must press the **MENU** button then the **Yellow** button to display the Teletext page again.

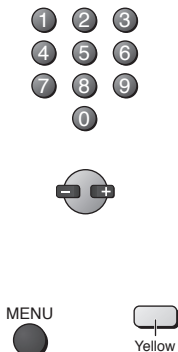

Teletext operation



- If the top of the page indicates that sub pages are being transmitted but the page displayed never changes, then the 'sub page number' is there to show the page contents have been updated, there are no sub pages.

Alternatively, if you know which sub page you require, press the **MENU** button (to display special functions) followed by the **Blue** button; T**** will be displayed where the page number is normally found.

Enter desired sub page number before the T**** disappears.

e.g., to select page 6 enter 0, 0, 0 and 6.

Press the **Yellow** button to view the TV picture whilst waiting for more sub pages to be found. The sub pages found will be displayed across the top of the screen.

When the page is available, press the **Yellow** button to view the page. Regardless of how many pages are found, pressing the **Yellow** button will take you to the sub page which you requested.

Press the **TV/TEXT** button to return to normal TV operation.



INDEX

When in FASTEXT or TOP operation

Press the **INDEX** button to return to the main index page.

Depending on the way information is transmitted, this may have to be pressed more than once to return to the main index page.

Picture and text

Press the **TV/TEXT** button, followed by the **MULTI PIP** button to move between viewing teletext and the picture and text feature. Picture and text lets you see the current programme and a page of teletext side by side.

Whilst using this feature, the remote control affects the teletext page; if you wish to make changes to the programme viewed press the **TV/TEXT** button to return to watching the programme on its own then make the desired changes.

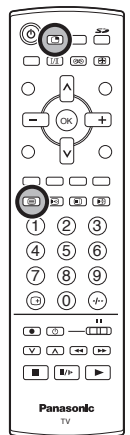

Teletext mode

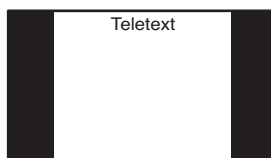

Picture and text mode

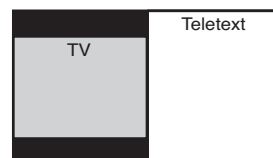

VCR / DVD operation

The Remote Control is capable of operating some functions of selected VCR and DVD (Digital Versatile Disc) equipment. Some VCR and DVD equipment have different functions, so to ensure compatibility please refer to the equipment's instruction book or consult your dealer for details.



Button	Function
	Standby
	VCR / DVD selection switch
	Play
	Stop
	VCR : Fast Forward / Cue DVD : Slow / Search
	VCR : Rewind / Review DVD : Slow / Search
	Pause / Still
	VCR : Programme Number up / down DVD : Skip
	Record

Stereo / Bilingual Sound Selection



When you receive the stereo / bilingual sound system, sound output modes can be selected by pressing the **Stereo / Bilingual Sound Selection** button.

Audio Signal	STEREO	MAIN I	SUB II	MONO
Mode Indicator				

NICAMUsed in New Zealand, Singapore, Hong Kong etc.

Type of broadcast	Regular broadcast (Standard Audio)	Regular + NICAM MONO I (MAIN I)	NICAM STEREO	NICAM DUAL MONO (MAIN I / SUB II)
Mode Indicator	No Indicator $\leftrightarrow \nabla$			

A2(German)Used in Australia, Malaysia etc.

Type of broadcast	Regular broadcast (Standard Audio)	BILINGUAL or DUAL MONO: MAIN I / SUB II	STEREO
Mode Indicator	No Indicator $\leftrightarrow \nabla$		

Notes:

- If the stereo signal is poor or the receiving conditions are not optimum or if STEREO:MONO automatic switching occurs, it is recommended you switch from STEREO to MONO.
- Even when the contents of the receiving signal undergo changes, selection mode is kept intact.
- When the receiving conditions deteriorate, listening will be easier if the mode is set to the MONO position, using the stereo / bilingual sound selection button.
- DUAL, also known as DUAL MONO or as BILINGUAL is not currently transmitted in some countries.

Remote control setting

Remote Control Operation is possible for the Panasonic VCR's and DVD's equipment.
After completion of setting, execute the various operations after pressing the VCR / DVD selection switch.

Switch to select VCR or DVD.

While pressing the VCR / DVD Power button, press the manufacturer code (enter the two digit code), and press the VCR / DVD Stop button.

VCR

Manufacturer	Code
Panasonic/ National	10,11,12,13

DVD

Manufacturer	Code
Panasonic	70, 71

VCR ■■ DVD

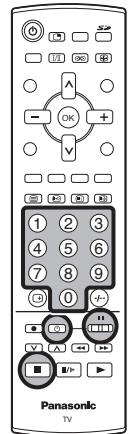

















Notes:

- After setting, execute operation confirmation. If there is no operation, set a different code.
- The respective VCR / DVD code is cancelled when battery has been exchanged. Please set it again.
- Depending on the model, operation of VCR's or DVD's of the manufacturers listed above may not be possible.
- In some cases, new products may not be operative.
- It will not operate with other than the above manufacturers.

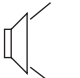
Troubleshooting

If there is a problem with your LCD TV please refer to the table below to determine the symptoms, then carry out the suggested check. If this does not solve the problem, please contact your local Panasonic dealer, quoting the model number and serial number (both found on the rear of the TV).

Symptoms		Checks
Picture	Sound	
 Snowy Picture	 Noisy Sound	Aerial location, direction or connection
 Multiple Image	 Normal Sound	Aerial location, direction or connection
 Interference	 Noisy Sound	Electrical appliances Cars / Motorcycles Fluorescent lights
 Normal Picture	 No Sound	Volume level Sound mute switched on.
 No Picture	 No Sound	TV set to AV mode Not plugged into AC outlet. Not switched on. Picture / Sound controls set at minimum levels. Check if in Standby mode.
 No Colour	 Normal Sound	Colour Controls set at minimum levels. Colour System
 Poor or Distorted Picture	 Weak or No Sound	Retune Channel (s).
 Normal Picture	 Weak or distorted sound	Sound reception may have deteriorated. Sound System
There may be red spots, blue spots and green spots on the screen	 Normal Sound	This is a characteristic of liquid crystal panels and is not a problem. The liquid crystal panel is built with very high precision technology giving you fine picture details. Occasionally, a few non-active pixels may appear on the screen as a fixed point of blue, green, or red. Please note this does not affect the performance of your LCD.

Maintenance

To clean this unit, wipe with a soft, dry cloth.

If the surfaces are extremely dirty, use a soft cloth dipped in soap-and-water solution or a weak detergent solution.

- Use eyeglass cleaner to remove stubborn dirt from the LCD.
- Never use alcohol, paint thinner or benzene to clean this unit.
- Before using chemically treated cloth, read the instructions that came with the cloth carefully.
- Do not wipe the LCD with water.

Wipe the cabinet with a soft cloth.

If the cabinet is heavily soiled, wipe with a well-wrung soft cloth dipped in kitchen cleanser (neutral) diluted with water.

CAUTION:

If water or similar substances get inside the monitor via the liquid crystal panel surface, a malfunction may result.

Neutral
detergent



Specifications

	TX-26LX1M, TX-26LX1A, TX-26LX1X	TX-32LX1M, TX-32LX1A, TX-32LX1X																						
Power Source	AC 100-127 / 200-240 V, 50 / 60 Hz																							
Power Consumption	Average use 100-127 V : 130 W 200-240 V : 129 W Standby condition : 1.8 W Power Off : 1.5 W	Average use 100-127 V : 165 W 200-240 V : 163 W Standby condition : 1.8 W Power Off : 1.5 W																						
LCD	Wide XGA (1,280 × 768 pixels) 15 : 9 aspect ratio LCD panel																							
Screen Size	566.4 mm (W) × 339.8 mm (H)	687.4 mm (W) × 412.4 mm (H)																						
Sound																								
Speaker	φ 8 cm × 2 pcs, φ 4 cm × 2 pcs, 8 Ω																							
Audio Output	20 W (10 W + 10 W)																							
Headphones	M3 (3.5 mm) Jack × 1																							
Receiving Systems / Band name	<table border="1"> <thead> <tr> <th>17 Systems</th> <th>Function</th> </tr> </thead> <tbody> <tr> <td>1 PAL B, G, H</td> <td rowspan="7">Reception of broadcast transmissions and Playback from Video Cassette Tape Recorders</td> </tr> <tr> <td>2 PAL I</td> </tr> <tr> <td>3 PAL D, K</td> </tr> <tr> <td>4 SECAM B, G</td> </tr> <tr> <td>5 SECAM D, K</td> </tr> <tr> <td>6 SECAM K1</td> </tr> <tr> <td>7 NTSC M (NTSC 3.58 / 4.5 MHz)</td> </tr> <tr> <td>8 NTSC 4.43 / 5.5 MHz</td> <td rowspan="6">Playback from Special VCR's</td> </tr> <tr> <td>9 NTSC 4.43 / 6.0 MHz</td> </tr> <tr> <td>10 NTSC 4.43 / 6.5 MHz</td> </tr> <tr> <td>11 NTSC 3.58 / 5.5 MHz</td> </tr> <tr> <td>12 NTSC 3.58 / 6.0 MHz</td> </tr> <tr> <td>13 NTSC 3.58 / 6.5 MHz</td> </tr> <tr> <td>14 SECAM I</td> <td rowspan="4">Playback from Special Disc Players and Special VCR's</td> </tr> <tr> <td>15 PAL 60 Hz / 5.5 MHz</td> </tr> <tr> <td>16 PAL 60 Hz / 6.0 MHz</td> </tr> <tr> <td>17 PAL 60 Hz / 6.5 MHz</td> </tr> </tbody> </table>		17 Systems	Function	1 PAL B, G, H	Reception of broadcast transmissions and Playback from Video Cassette Tape Recorders	2 PAL I	3 PAL D, K	4 SECAM B, G	5 SECAM D, K	6 SECAM K1	7 NTSC M (NTSC 3.58 / 4.5 MHz)	8 NTSC 4.43 / 5.5 MHz	Playback from Special VCR's	9 NTSC 4.43 / 6.0 MHz	10 NTSC 4.43 / 6.5 MHz	11 NTSC 3.58 / 5.5 MHz	12 NTSC 3.58 / 6.0 MHz	13 NTSC 3.58 / 6.5 MHz	14 SECAM I	Playback from Special Disc Players and Special VCR's	15 PAL 60 Hz / 5.5 MHz	16 PAL 60 Hz / 6.0 MHz	17 PAL 60 Hz / 6.5 MHz
17 Systems	Function																							
1 PAL B, G, H	Reception of broadcast transmissions and Playback from Video Cassette Tape Recorders																							
2 PAL I																								
3 PAL D, K																								
4 SECAM B, G																								
5 SECAM D, K																								
6 SECAM K1																								
7 NTSC M (NTSC 3.58 / 4.5 MHz)																								
8 NTSC 4.43 / 5.5 MHz	Playback from Special VCR's																							
9 NTSC 4.43 / 6.0 MHz																								
10 NTSC 4.43 / 6.5 MHz																								
11 NTSC 3.58 / 5.5 MHz																								
12 NTSC 3.58 / 6.0 MHz																								
13 NTSC 3.58 / 6.5 MHz																								
14 SECAM I	Playback from Special Disc Players and Special VCR's																							
15 PAL 60 Hz / 5.5 MHz																								
16 PAL 60 Hz / 6.0 MHz																								
17 PAL 60 Hz / 6.5 MHz																								
Receiving Channels	Regular TV VHF BAND 2-12 (PAL / SECAM B, K1) 0-12 (PAL B AUST.) 1-9 (PAL B N.Z.) 1-12 (PAL / SECAM D) 1-12 (NTSC M Japan) 2-13 (NTSC M USA)	UHF BAND 21-69 (PAL G, H, I / SECAM G, K, K1) 28-69 (PAL B AUST.) 13-57 (PAL D, K) 13-62 (NTSC M Japan) 14-69 (NTSC M USA)	CATV S1-S20 (OSCAR) 1-125 (USA CATV) C13-C49 (JAPAN) S21-S41 (HYPER) Z1-Z37 (CHINA) 5A,9A (AUST.)																					
Aerial - Rear	UHF / VHF																							
Operating Conditions	Temperature : 5 °C - 35 °C Humidity : 5 % - 90 % RH (non-condensing)																							
Connection Terminals																								
AV1 / 2-Rear	VIDEO (RCA Pin Type) S-VIDEO (MINI DIN 4-pin) AUDIO L-R (RCA Pin Type × 2)	1.0 Vp-p (75 Ω) Y:1.0 Vp-p (75 Ω) C:0.286 Vp-p (75 Ω) 0.5 Vrms																						
AV3-Front	VIDEO (RCA Pin Type) S-VIDEO (MINI DIN 4-pin) AUDIO L-R (RCA Pin Type × 2)	1.0 Vp-p (75 Ω) Y:1.0 Vp-p (75 Ω) C:0.286 Vp-p (75 Ω) 0.5 Vrms																						
AV4-Rear	VIDEO (RCA Pin Type) AUDIO L-R (RCA Pin Type × 2) Y P _B / P _R	1.0 Vp-p (75 Ω) 0.5 Vrms 1.0 Vp-p (including synchronization) ±0.35 Vp-p																						
MONITOR OUT	VIDEO (RCA Pin Type) AUDIO L-R (RCA Pin Type × 2)	1.0 Vp-p (75 Ω) 0.5 Vrms																						
Others	SD Card slot × 1, PC Card slot × 1																							
Dimensions (W × H × D)																								
Including TV Stand	844 mm × 571.8 mm × 321 mm	1,000 mm × 651.7 mm × 321 mm																						
TV Set Only	844 mm × 478 mm × 137 mm	1,000 mm × 558 mm × 137 mm																						
Weight	22.5 kg Net	27 kg Net																						

Note:

Design and Specifications are subject to change without notice. Weight and Dimensions shown are approximate.



SD Logo is a trademark.

Customer' Record

The model number and serial number of this product can be found on its rear panel. You should note this serial number in the space provided below and retain this book, plus your purchase receipt, as a permanent record of your purchase to aid in identification in the event of theft or loss, and for Warranty Service purposes.

Model Number

Serial Number

Matsushita Electric Industrial Co., Ltd.Web Site : <http://www.panasonic.co.jp/global/>

© 2004 Matsushita Electric Industrial Co., Ltd. All Rights Reserved.

Printed in Japan
MBS0504S1054