



ACURA

INSTALLATION INSTRUCTIONS

Accessory

**ACURA MUSIC LINK™
(FOR iPod®)**

Application

2007 RDX

Publications No.

BII 32604-34945

Issue Date

MARCH 2007

PARTS LIST

**Acura Music Link Adapter (sold separately)
P/N 08A28-1H1-800**

4 Cushion tapes

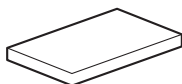

Holder cushion

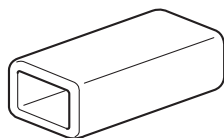

Grommet
(Not used)



8 Wire ties

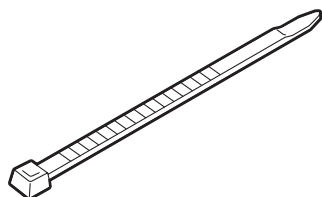

2 Long wire ties

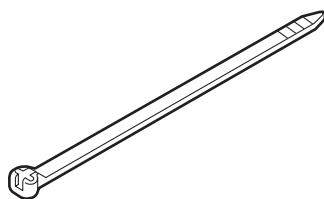

**Acura Music Link Adapter Kit (sold separately)
P/N 08A28-1H2-100**

Acura Music Link unit

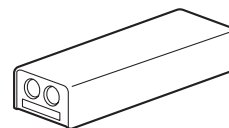

Bus cable

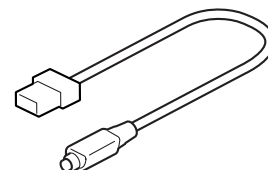

Music Link harness

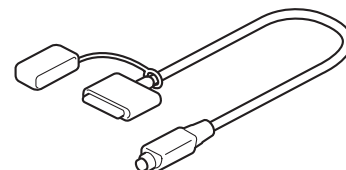

CD-ROM
(for home computer
use only)

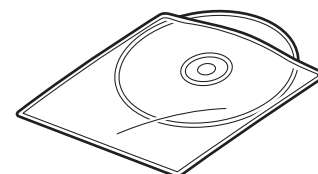

Quick reference guide

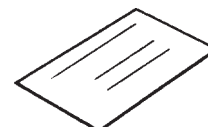

**Y-Harness Adapter (sold separately)
P/N 08A31-0F1-000**

Y-harness adapter

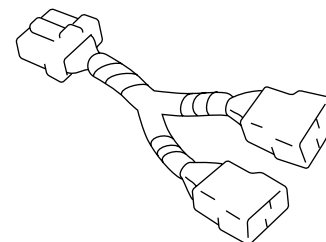

TOOL AND SUPPLIES REQUIRED

#2 Phillips screwdriver

Diagonal cutters

Ratchet

10 mm Socket

Shop towel

Illustration of the Acura Music Link Installed on the Vehicle

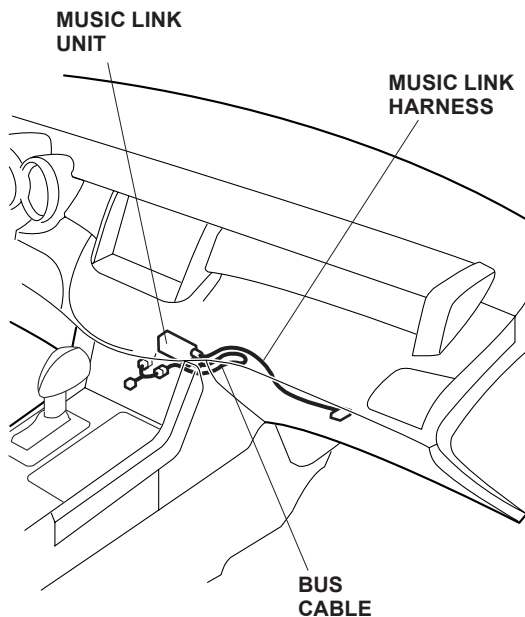

INSTALLATION

Client Information: The information in this installation instruction is intended for use only by skilled technicians who have the proper tools, equipment, and training to correctly and safely add equipment to your vehicle. These procedures should not be attempted by "do-it-yourselfers."

1. Make sure you have the anti-theft code for the radio, then write down the frequencies for the preset buttons.
2. Disconnect the negative cable from the battery.

3. Open and lower the glove box, disconnect the damper, then push in on the side of glove box to open it past the stoppers.

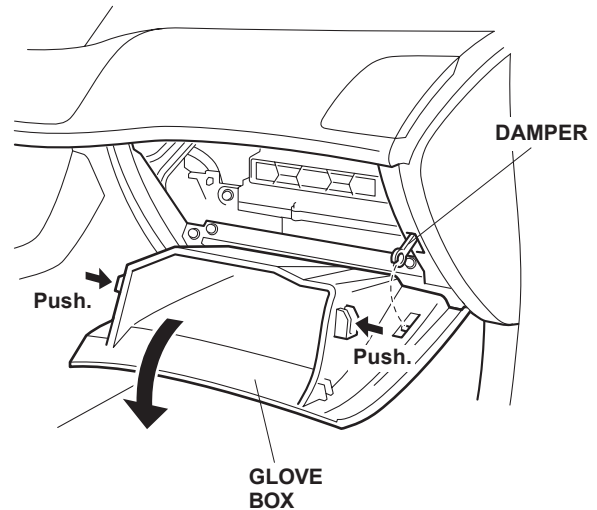

4. Remove the right center console side trim (four clips).

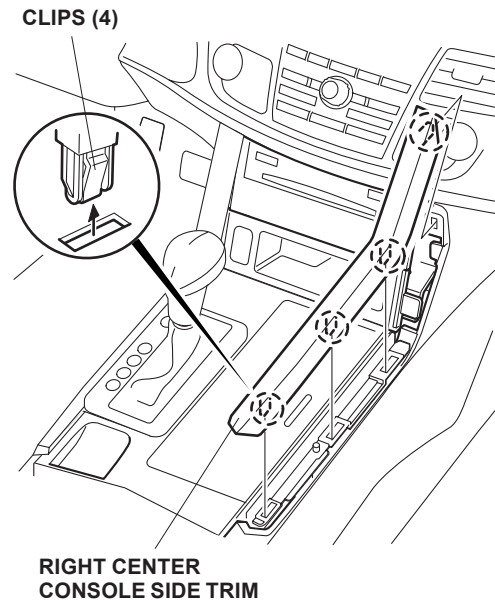

5. Move the shift lever to the N position.

6. Lift up the shift lever trim (six retaining tabs).

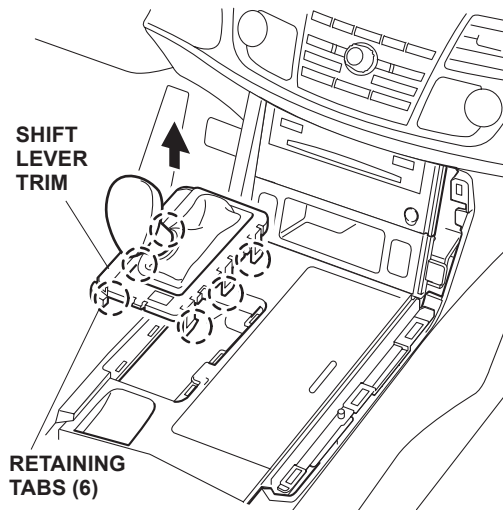

7. Remove the left center console side trim (three clips).

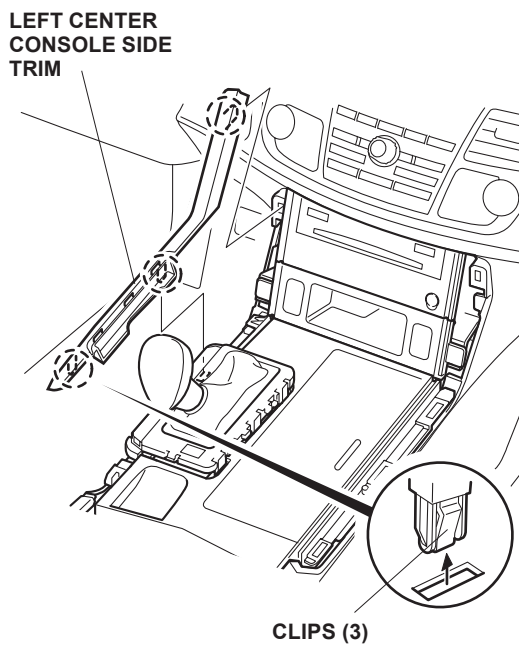

8. Open the center console, then remove the beverage holder (six clips).

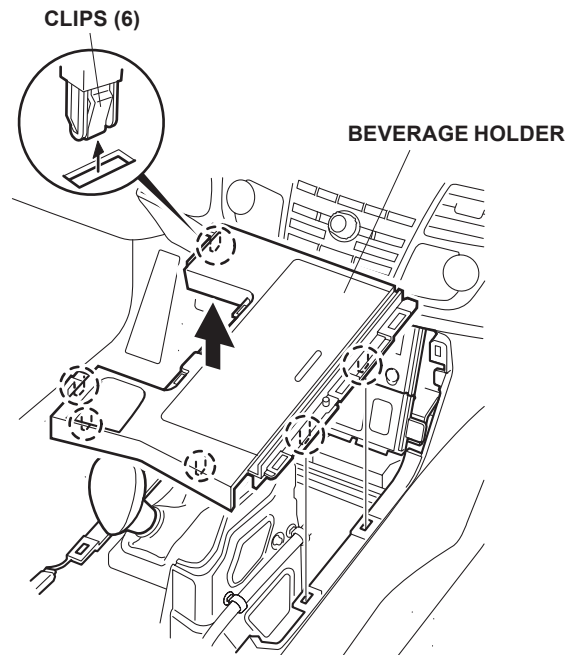

9. Remove the pocket (two self-tapping screws) and three vehicle connectors.

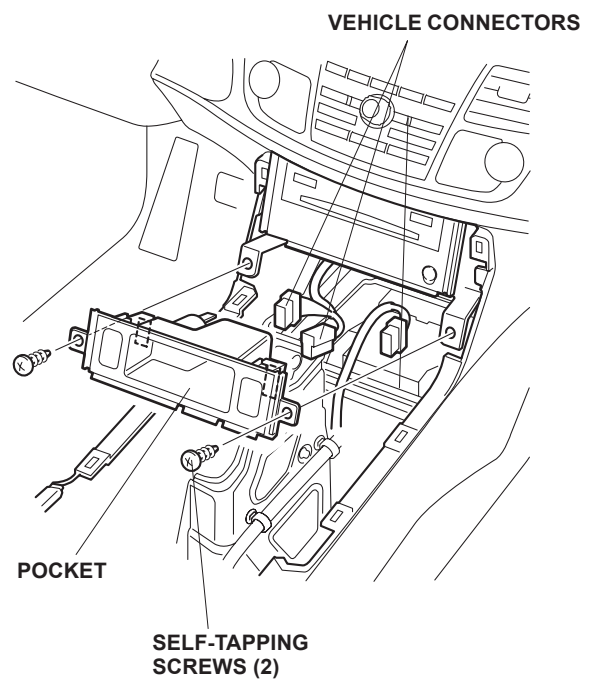

10. To prevent scratching the shift lever and trim, cover them with a shop towel.

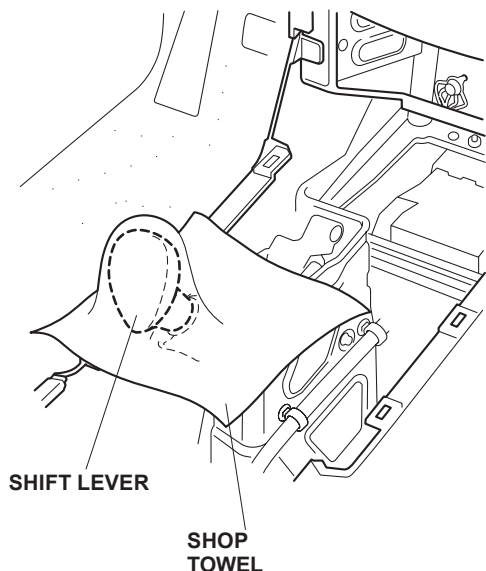

11. Remove the audio unit (four bolts) and disconnect the five vehicle connectors.

NOTE: The antenna connector release is on the side of the connector.

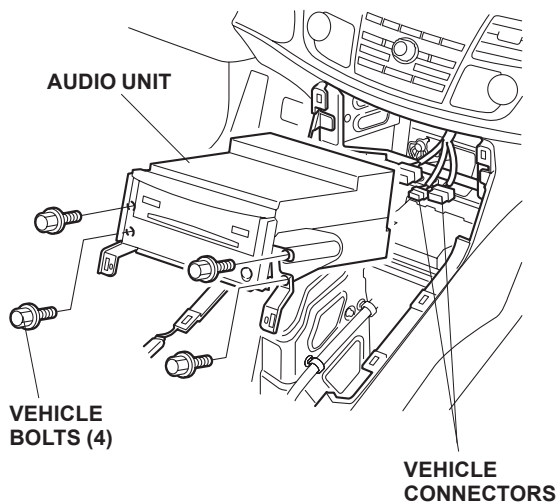

Routing The Harness

12. Insert the Music Link unit into the holder cushion.

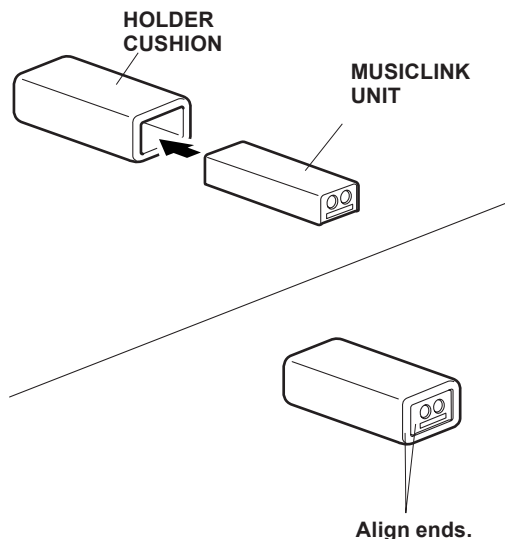

13. Connect the bus cable DIN connector (black) and the Music Link harness DIN connector (white) to the Music Link unit.

NOTE: To avoid connector damage, orient the connectors properly with the flat side up, and insert them straight in (not crooked.) To remove, pull back on the slide collar to release a locking mechanism. Do not pull on the cable, or you can damage it.

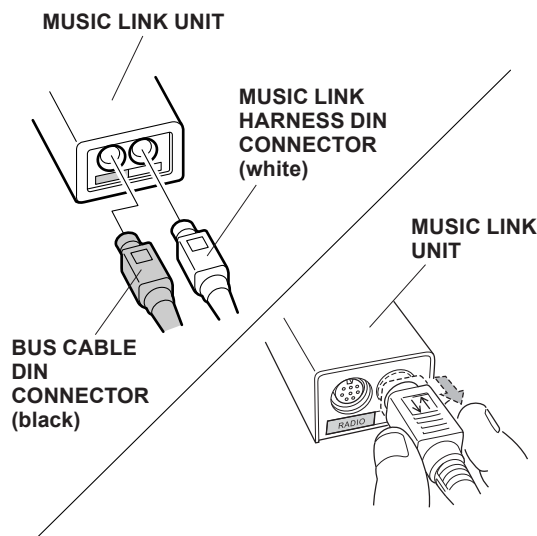

14. Apply a cushion tape around the bus cable DIN connector (black) and Music Link harness DIN connector (white). Secure the Music Link unit to the front side of the vehicle frame using two long wire ties. If the Music Link unit is not in front of the frame there will not be clearance for the radio.

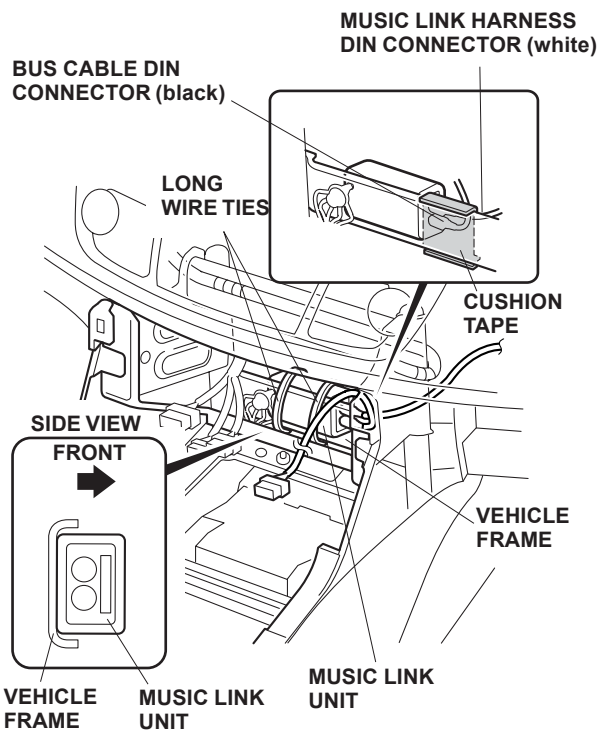

15. Align the Music Link connector with the right side of the glove box opening. Bundle up the Music Link harness and secure it to the vehicle harness with one wire tie.

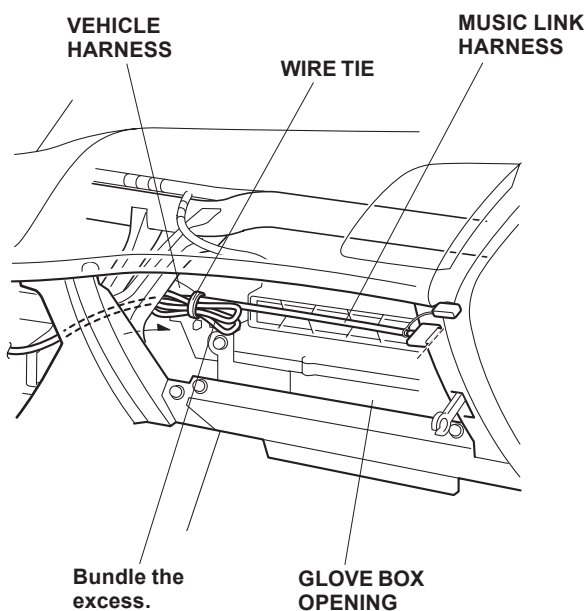

16. Get the Y-harness adapter cable. Connect one end of the bus cable 14-pin connector to the Music Link, and the other vehicle 14-pin connector to the Y-harness adapter connector.

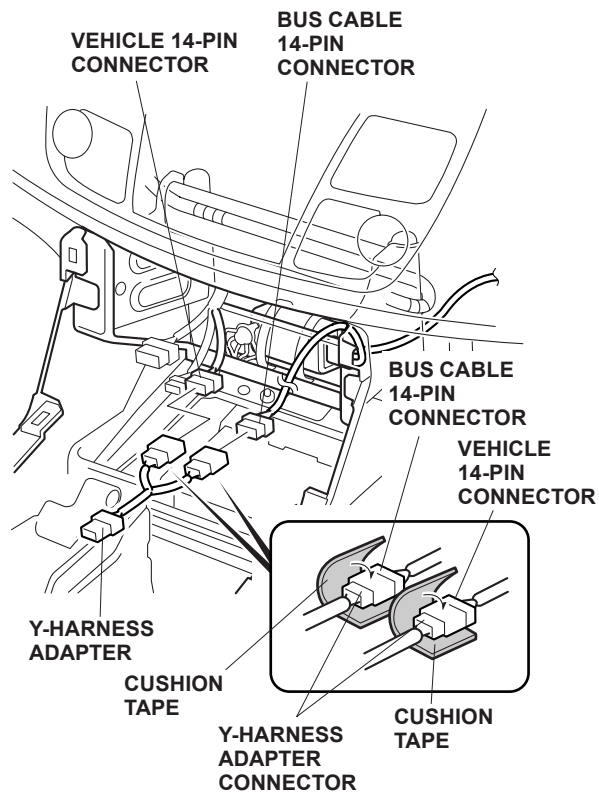

17. Wrap the two connectors with two cushion tapes.
18. Adjust the length of the Y-harness adapter 14-pin connector to the same length of the radio connector so it aligns with the vehicle 17-pin connector.

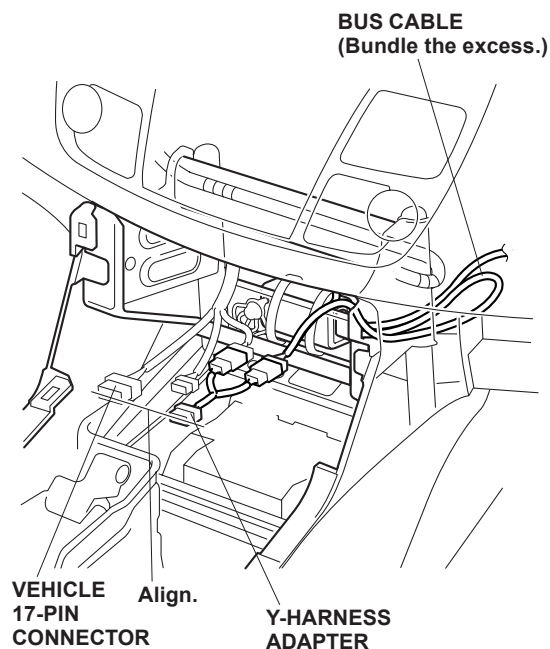

19. Bundle the excess bus cable, and wrap one wire tie around the bus cable.

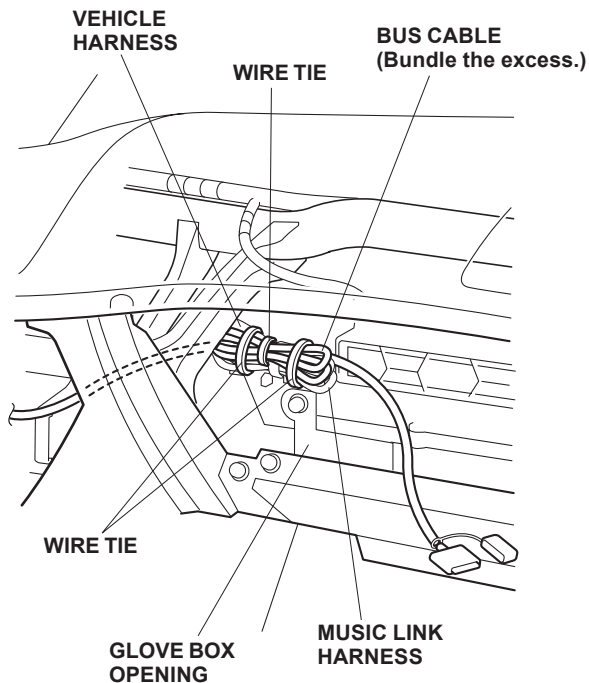

20. Secure the bus cable and Music Link harness to the vehicle harness using two wire ties.
21. Place the audio unit in the center dashboard area and plug the Y-harness adapter connector into the audio unit, then reconnect the audio unit connectors. Reinstall the audio unit using the four vehicle bolts.

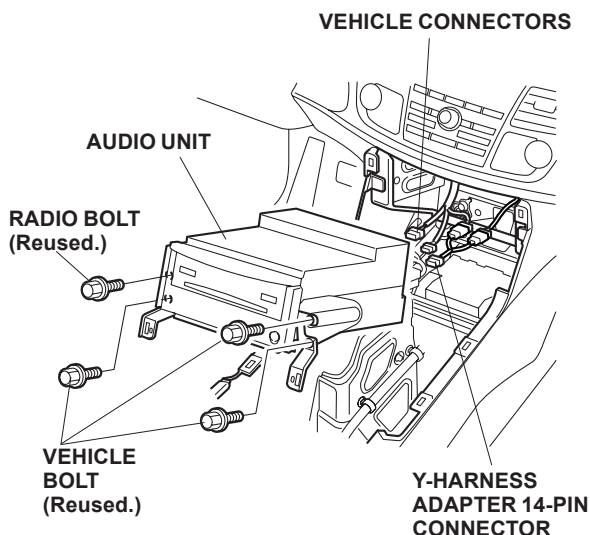

22. Put the Music Link harness in the glove box as shown and position the glove box to its original position. Reconnect the damper to the glove box.

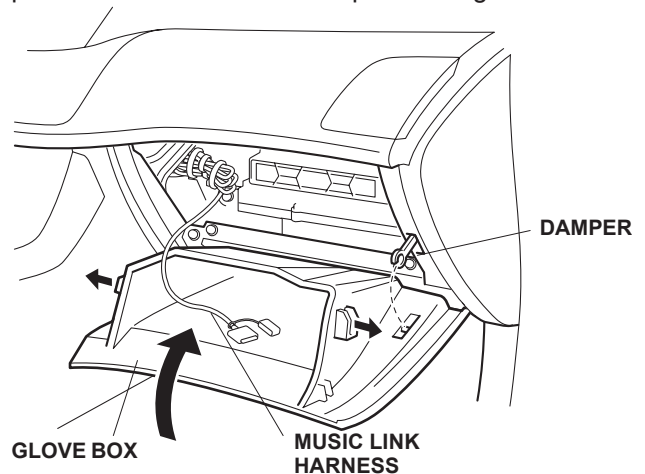

23. Check that all wire harnesses are routed properly and all connectors are plugged in.
24. Reinstall the pocket, the beverage holder, the left and right side trims, and the shift lever trim.
25. Reconnect the negative cable to the battery.
26. If equipped, enter the navigation code.
27. Enter the customer's radio anti-theft code, and reset the radio station presets.
28. Reset the clock.
29. Test the seat heaters.
30. Turn the audio unit ON. Check the CDC EJECT, or CD4 EJECT is shown on the audio unit display while in the CD/AUX or DISC/AUX mode (The Music Link is recognized as a accessory CD changer).
31. Give the CD-Rom disc to your customer. This disc is software for use on home computers, and it also contains an owner's manual.
32. Check the operation of the security system according to the security system user's information provided.

NOTE: When the battery is disconnected, the driver's window AUTO function is disabled.

- Start the engine. Push down on the driver's window switch until the window is fully open.
- Pull up on the driver's window switch to close the window completely, and then hold the switch for 2 seconds or more.
- Lower and raise the driver's window to check the operation of the driver's window AUTO function.