



Battery Docking Station

Quick Installation Guide

Introduction

The *Battery Docking Station* is the perfect portable on-the-go docking station and battery charger with stand.

Key Features and Benefits

- Docking function for synching with iTunes
- Automatically adjusts power output from 2.1A (iPad/iPad 2) to 1A (iPhone/iPod) to provide fast battery charging
- LED power indicator shows battery status
- Compact foldable design makes it convenient for synching & recharging at home, in the office, or on the road
- Portable battery charger provides up to 8 hours of power (iPad/iPad 2), up to 25 hours talk time (iPhone) & up to 100 hours of music playback (iPhone/iPod)

Package Contents

- *Battery Docking Station*
- USB cable
- Quick installation guide

Specifications

- Compatibility: iPad/iPad 2, iPhone3/3Gs/4, iPod Touch3/4, iPod Nano6
- Capacity: 5200mAh Lithium Polymer battery
- Input: 5V, 1A-2.1 (Apple USB power supply) or 500mA (Computer USB port)
- Output: 5V DC, 2.1A/1000mA

Unfolding the Docking Station

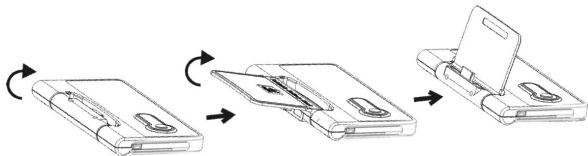

Layout

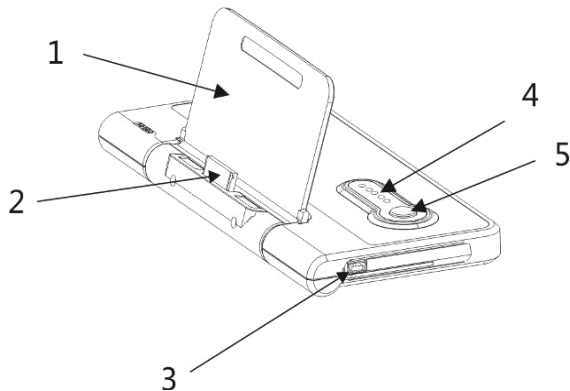

- **Holder (1):** Supports iPad/iPhone/iPod when inserted
- **Apple 30-pin male (2):** Inserts into the iPad/iPhone/iPod
- **Mini USB (3):** Connects to computer USB port via the included USB cable or Apple power adapter for charging or syncing
- **LEDs (4):** Indicates the current charge capacity of the battery
- **Status Button (5):** Press to display the battery charge status, via indicator LEDs

Power Indicator

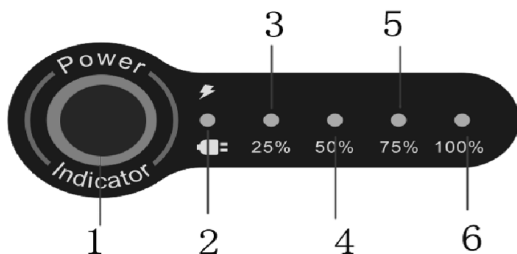

- **Status Button (1):** Press to display the battery charge status, via indicator LEDs
- **Charging LED (2):** This LED will be lit during the charging process when the charge capacity is less than 100%
- **25% (3):** Will be lit when charge capacity is between 25% and 50%
- **50% (4):** Will be lit when charge capacity is between 50% and 75%
- **75% (5):** Will be lit when charge capacity is over 75% but not yet fully charged
- **100% (6):** At 100% charge, LEDs 3, 4, 5, and 6 will be lit, and the Charging LED (2) will be off

Using the Docking Station

Before using the docking station make sure it's battery is fully charged before using. We recommend the first 3 charges to last 10 hours (with Apple power adapter) or 20 hours (with computer USB port) to ensure maximum capacity of the battery.

Charging the Docking Station

The docking station is compatible with 3 kinds of power adapters, Apple 2.1A power adapter, Apple 1000mA power adapter, and Computer USB port via the included USB cable. Charging time varies for each power adapter. Generally, the Apple 2.1A and 1000mA power adapter will fully charge in 6-10 hours. A Computer USB 500mA port will fully charge in 16-20 hours.

Charge iPad/iPhone/iPod - Standalone

When an iPad/iPhone/iPod is inserted into the docking station, it will begin charging automatically, and the docking station's Charging LED will start flashing. The docking station automatically adjusts power output from

2.1A (iPad/iPad 2) to 1A (iPhone/iPod) to provide fast battery charging.

Charge iPad/iPhone/iPod with Apple Power Adapter

When an iPad/iPhone/iPod is inserted into the docking station, it will power on automatically and begin charging. After the iPhone/iPad/iPod is fully charged, the docking station will start charging.

Note: During charging an iPad/iPhone/iPod with Apple power adapter, if the power cable is disconnected, the docking station's battery will not charge the iPad/iPhone/iPod automatically. You need to re-insert the iPad/iPhone/iPod into the docking station.

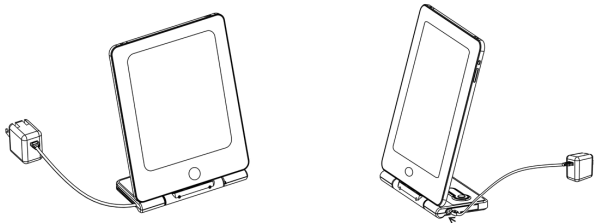

Charge & Sync with Computer USB Port

When connected to the computer by the included USB cable, the iPhone/iPod will sync with the computer and charge at the same time. After the iPhone/iPod is fully charged, the docking station will start charging. When connected to the computer by the included USB cable, the iPad will sync with the computer but will not charge (same as with Apple USB cable).

Note: When charging an iPhone/iPod with the included USB cable, if the USB cable is disconnected, the docking station's battery will not charge the iPhone/iPod automatically. You need to re-insert the iPhone/iPod into the docking station.

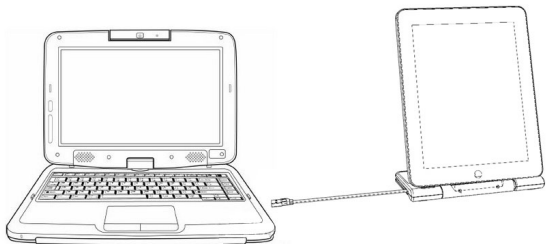

Notes

Notes

Notes

Technical Support and Warranty

QUESTIONS? SIIG's **Online Support** has answers! Simply visit our web site at www.siig.com and click **Support**. Our online support database is updated daily with new drivers and solutions. Answers to your questions could be just a few clicks away. You can also submit questions online and a technical support analyst will promptly respond.

SIIG offers a 2-year manufacturer warranty with this product. This warranty covers the original purchaser and guarantees the product to be free of any defects in materials or workmanship for two (2) years from the date of purchase of the product.

SIIG will, at our discretion, repair or replace (with an identical product or product having similar features and functionality) the product if defective in materials or workmanship. This warranty gives you specific legal rights, and you may also have other rights which vary from state to state. Please see our web site for more warranty details.

If you encounter any problems with this product, please follow the procedures below.

A) If it is within the store's return policy period, please return the product to the store where you purchased from.

B) If your purchase has passed the store's return policy period, please follow the steps below to have the product repaired or replaced.

Step 1: Submit your RMA request.

Go to www.siig.com, click **Support**, then **RMA** to submit a request to [SIIG RMA](#) or fax a request to 510-657-5962. Your RMA request will be processed, if the product is determined to be defective, an RMA number will be issued.

Step 2: After obtaining an RMA number, ship the product.

- Properly pack the product for shipping. All accessories that came with the original package must be included.
- Clearly write your RMA number on the top of the returned package. SIIG will refuse to accept any shipping package, and will not be responsible for a product returned without an RMA number posted on the outside of the shipping carton.
- You are responsible for the cost of shipping to SIIG. Ship the product to the following address:

SIIG, Inc.

6078 Stewart Avenue

Fremont, CA 94538-3152, USA

RMA #: _____

- SIIG will ship the repaired or replaced product via Ground in the U.S. and International Economy outside of the U.S. at no cost to the customer.

About SIIG, Inc.

Founded in 1985, SIIG, Inc. is a leading manufacturer of IT connectivity solutions (including Serial ATA and Ultra ATA Controllers, FireWire, USB, and legacy I/O adapters) that bridge the connection between Desktop / Notebook systems and external peripherals. SIIG continues to grow by adding A/V and Digital Signage connectivity solutions to our extensive portfolio.

SIIG products offer comprehensive user manuals, many user-friendly features, and are backed by an extensive manufacturer warranty. High quality control standards are evident by the overall ease of installation and compatibility of our products, as well as one of the lowest defective return rates in the industry. SIIG products can be found in computer retail stores, mail order catalogs, through major distributors, system integrators, and VARs in the Americas and the UK, and through e-commerce sites.

PRODUCT NAME

Battery Docking Station

**FCC RULES: TESTED TO COMPLY WITH FCC PART 15, CLASS B
OPERATING ENVIRONMENT: FOR HOME OR OFFICE USE**

FCC COMPLIANCE STATEMENT:

This device complies with part 15 of the FCC Rules. Operation is subject to the following two conditions: (1) This device may not cause harmful interference, and (2) this device must accept any interference received, including interference that may cause undesired operation.

THE PARTY RESPONSIBLE FOR PRODUCT COMPLIANCE

SIIG, Inc.

6078 Stewart Avenue

Fremont, CA 94538-3152, USA

Phone: 510-657-8688

Battery Docking Station is a trademark of SIIG, Inc. SIIG and the SIIG logo are registered trademarks of SIIG, Inc. All other names used in this publication are for identification only and may be trademarks of their respective owners.