

# JVC

## LT-Z32FX6 LT-Z32FX60 LT-Z40SX6 LT-Z40SX60

WIDE LCD PANEL TV INSTRUCTIONS

# JVC



LT-Z32FX6

*DynaPiX* **HD**  
Powered by D.L.S.I.

**HDMI**<sup>TM</sup>  
HIGH-DEFINITION MULTIMEDIA INTERFACE

**MaxxBass**<sup>®</sup>



LT-Z40SX6  
LT-Z40SX60

**1**

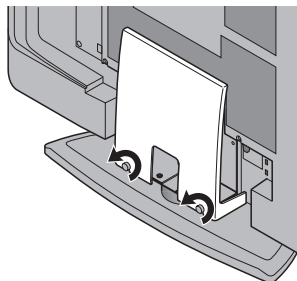

**2**

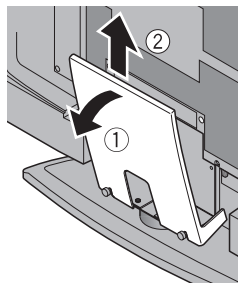

**3**

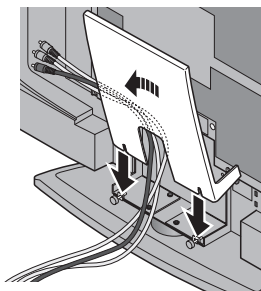

**4**

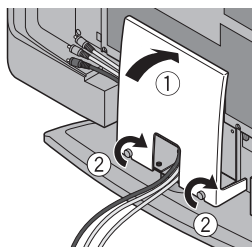

LT-Z32FX6  
LT-Z32FX60

**1**

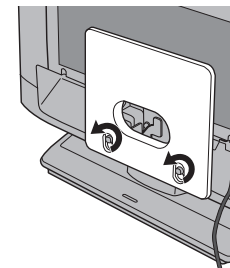

**2**

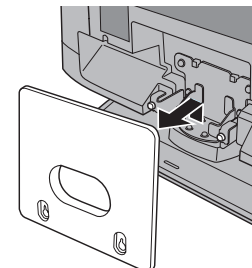

**3**

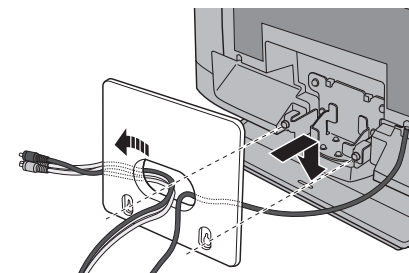

**4**

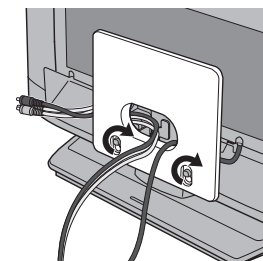

# Expanding the world of beautiful images

ENGLISH

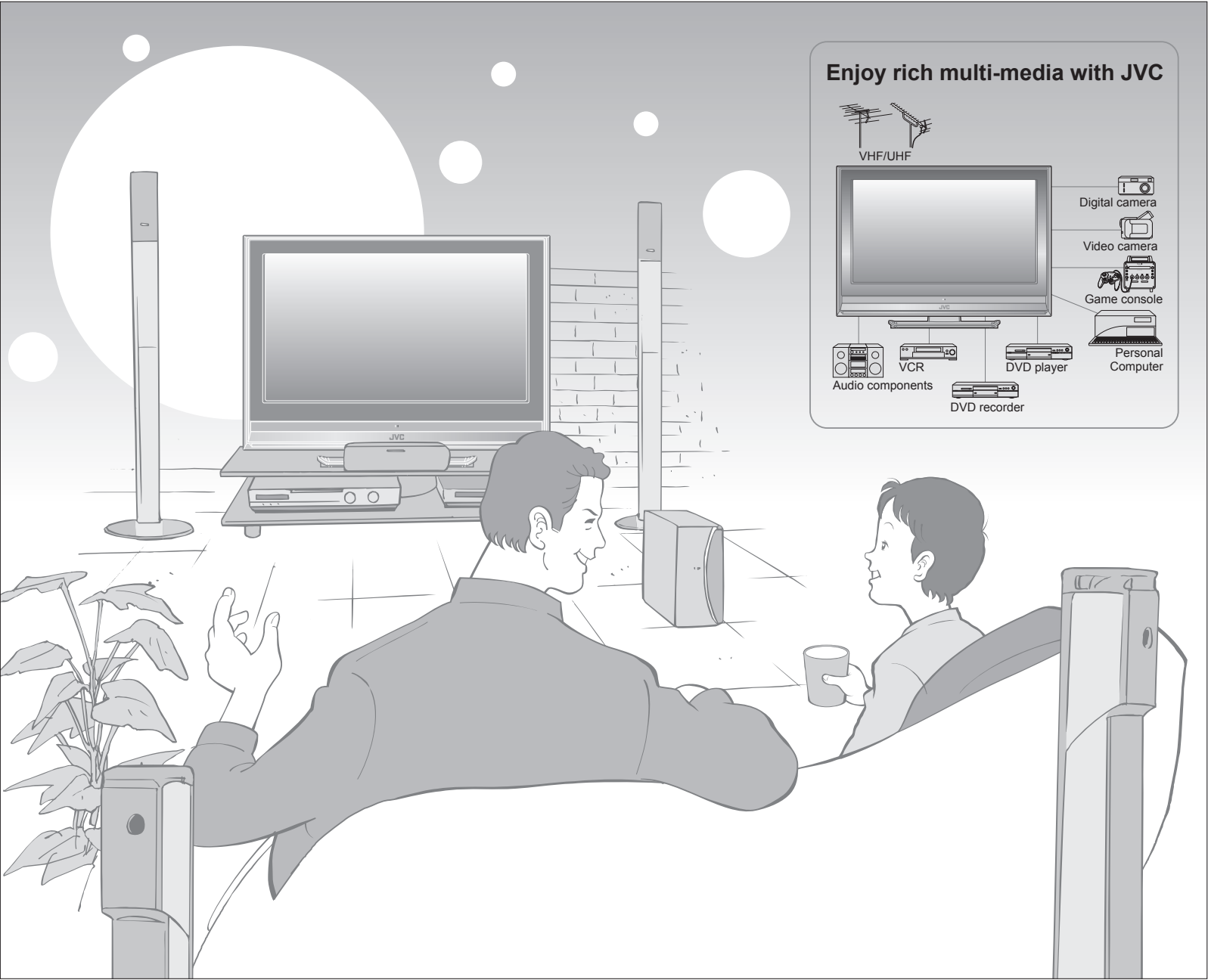

## Contents

### First things first!

- Warning ..... 3

### Getting started

- Names of all the parts ..... 5
- Basic connections ..... 7
- Initial settings ..... 9
- Editing channels ..... 11
  - Registering channels
- Connecting external devices ..... 13

### Let's try it out

- Enjoying your new TV! ..... 15
  - TV / Teletext / Video / etc.
- Watching TV ..... 17
- Viewing teletext ..... 19
- Watching videos / DVDs ..... 21

### Try the advanced features

- Useful functions ..... 23
  - Take a snapshot
  - View and search in multi-picture mode
  - "Sleep Timer" / "Channel Guard"
- Operate JVC recorders and other devices ..... 27

### Just the way you like it

- Customising your TV ..... 29
- Advanced picture adjustment ..... 31
  - Reduce noise / Watch a more natural picture
  - Set the aspect ratio, etc.

### When you have trouble

- Troubleshooting ..... 33
- Technical information ..... 37
- "CH/CC" List ..... 39
- Specifications ..... 40

ENGLISH

IMPORTANT!

PREPARE

USE

SETTINGS

TROUBLE?

# Warning

Please follow all the guidelines below

## Follow this manual regarding setup!

- Connect only to a 110-240V, 50/60Hz AC outlet.

## Do not allow the TV to fall!

- Do not rest your elbows on, or allow children to hang from the TV. There is a risk that the TV will fall and cause injuries.

## When attaching the TV to the wall, use the optional JVC wall mounting unit!

- Consult a qualified technician.
- See the included manual on mounting procedures.
- JVC assumes no responsibility for damage due to improper mounting.

## Never place anything on the TV!

- Placing liquids, naked flames, cloths, paper, etc. on the TV may cause a fire.



## Make enough room for inserting and removing the power plug!

## Place the TV as close to the outlet as possible!

- The main power supply for this TV is controlled by inserting or removing the power plug.

## Never cut or damage the power cord!

- If the AC plug is not the right shape, or the power cord is not long enough, use an appropriate plug adapter or extension cable. (Consult your retailer.)

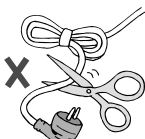

## Never try to repair the TV yourself!

- ➔ If the problem cannot be solved in "Troubleshooting" (P. 33), unplug the power cord and contact your retailer.

## If the TV is damaged or behaving strangely, stop using it at once!

- ➔ Unplug the power cord and contact your retailer.

## Never expose to rain or moisture!

- To prevent fire or electric shock, never allow liquids to enter the unit.



## Never insert objects into the cabinet openings!

- It may cause a fatal electric shock. Take care when children are near.



## Never listen to headphones at high volume!

- It may damage your hearing.

## Unplug the power cord when going out!

- The power buttons on the remote control and the TV unit cannot completely turn off the TV. (Make appropriate arrangements for bedridden people.)

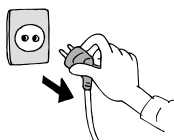

## Never dismantle the rear panel!

- It may cause an electric shock.

## Never obstruct the ventilation holes!

- It may cause overheating or a fire.

## Handle LCD panel with care!

- Use a soft, dry cloth when cleaning.

## Hold the TV so as not to scratch the screen!

- Do not touch the screen when carrying the TV.

## Do not carry the TV on your own!

- In order to prevent accidents, ensure that the TV is carried by two or more people.



■ For more details on installation, usage and safety ➔ Consult your retailer

# Names of all the parts

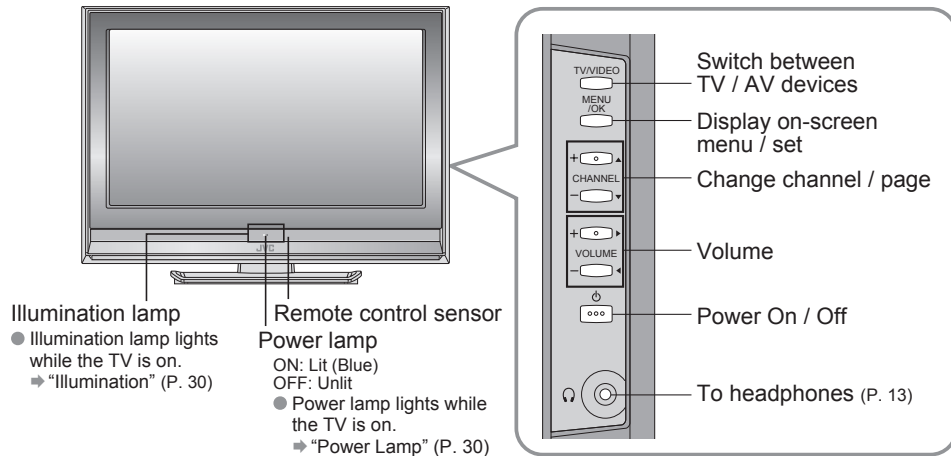

## Remove the terminal cover

LT-Z40SX6, LT-Z40SX60

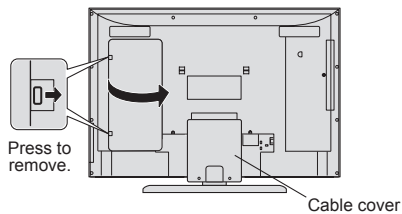

LT-Z32FX6, LT-Z32FX60

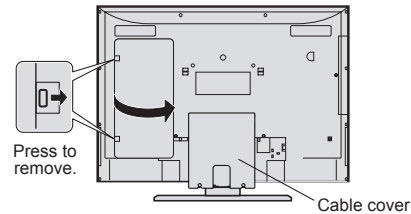

- If the cover cannot be closed due to the cables being in the way  
⇒ Do not force the cover to close (leave it open).
- Connecting terminals on the back of the TV ⇒ Connecting External devices (P. 13)

## Change the direction of TV

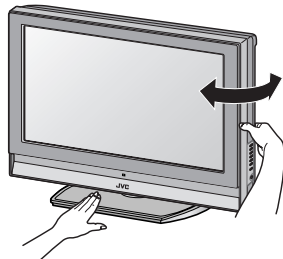

- The LT-Z40SX6, LT-Z40SX60 models differ from illustrations on this page.

## Check accessories

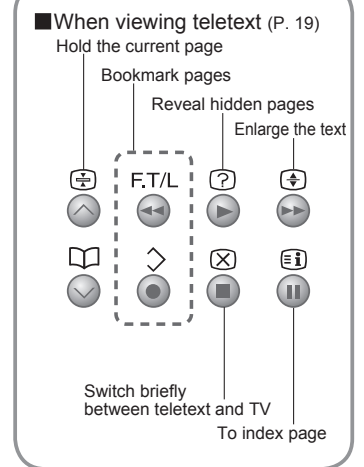
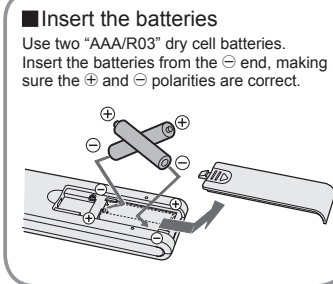
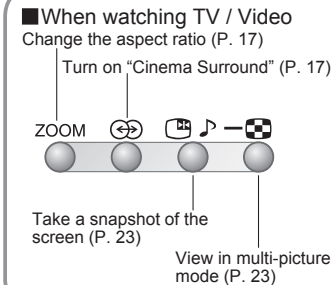
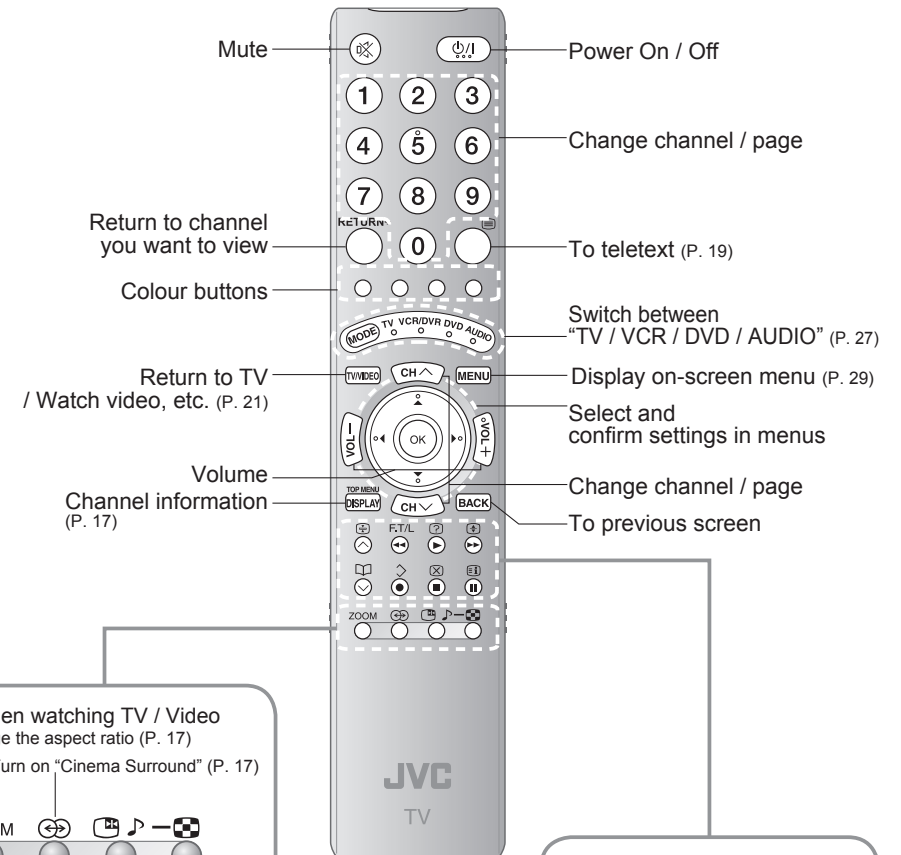
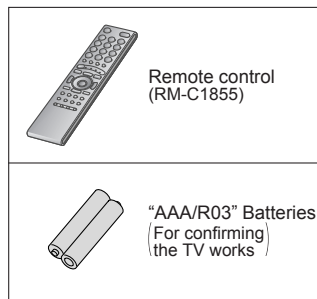

# Basic connections

Please read the user manuals of each device carefully before setup.  
It is necessary to connect an aerial to watch TV.

■ Connect with other devices ➔ "Connecting external devices" (P. 13)

## Connect the aerial

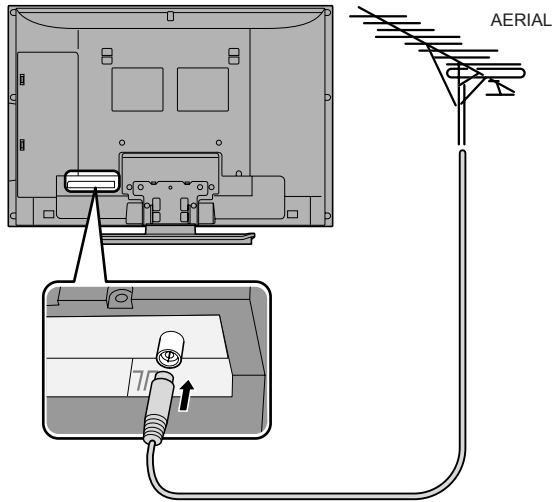

- After all the connections have been made, insert the plug into an AC outlet.

## Connect a VCR / DVD recorder

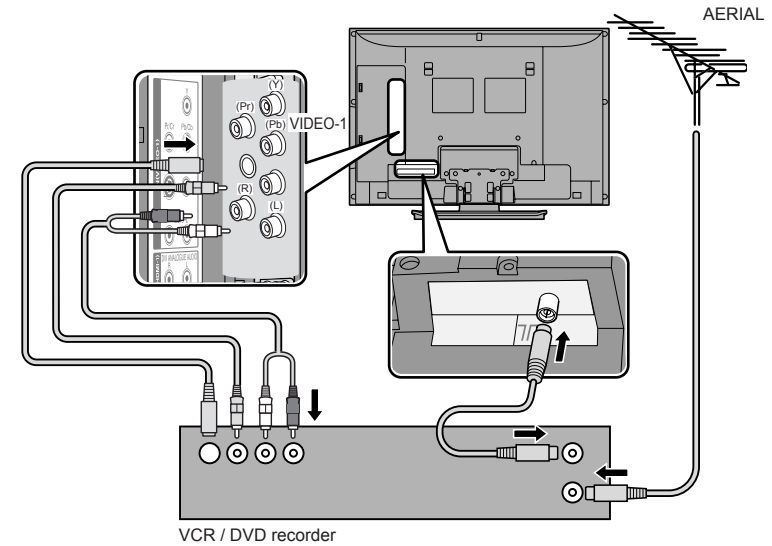

- After all the connections have been made, insert the plug into an AC outlet.
- If both composite and S-VIDEO cables are connected, S-VIDEO will be enable.

## Care when setting

### ■ Power requirements

- Connect the power cord only to a 110-240V, 50/60Hz AC outlet.

### ■ When attaching the TV to the wall, use the optional JVC wall mounting unit

- Consult a qualified technician.
- See the included manual on mounting procedures.
- JVC assumes no responsibility for damage due to improper mounting.
- 200mm × 200mm mount which conforms to VESA standards.

### ■ Installation requirements

- To avoid overheating, ensure the unit has ample room.

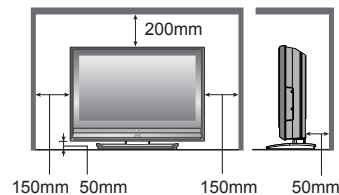

## Tidying the cables

### LT-Z40SX6, LT-Z40SX60

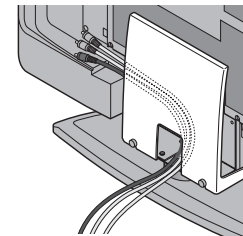

### LT-Z32FX6, LT-Z32FX60

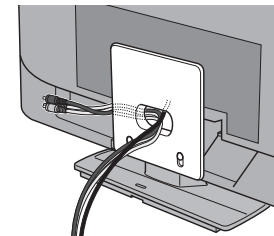

- To remove the cable cover, refer to back of the cover.

# Initial settings

Set the menu language, installation location and automatically register the TV channels.  
These channels can be edited later in "Editing channels" (P. 11).

ENGLISH

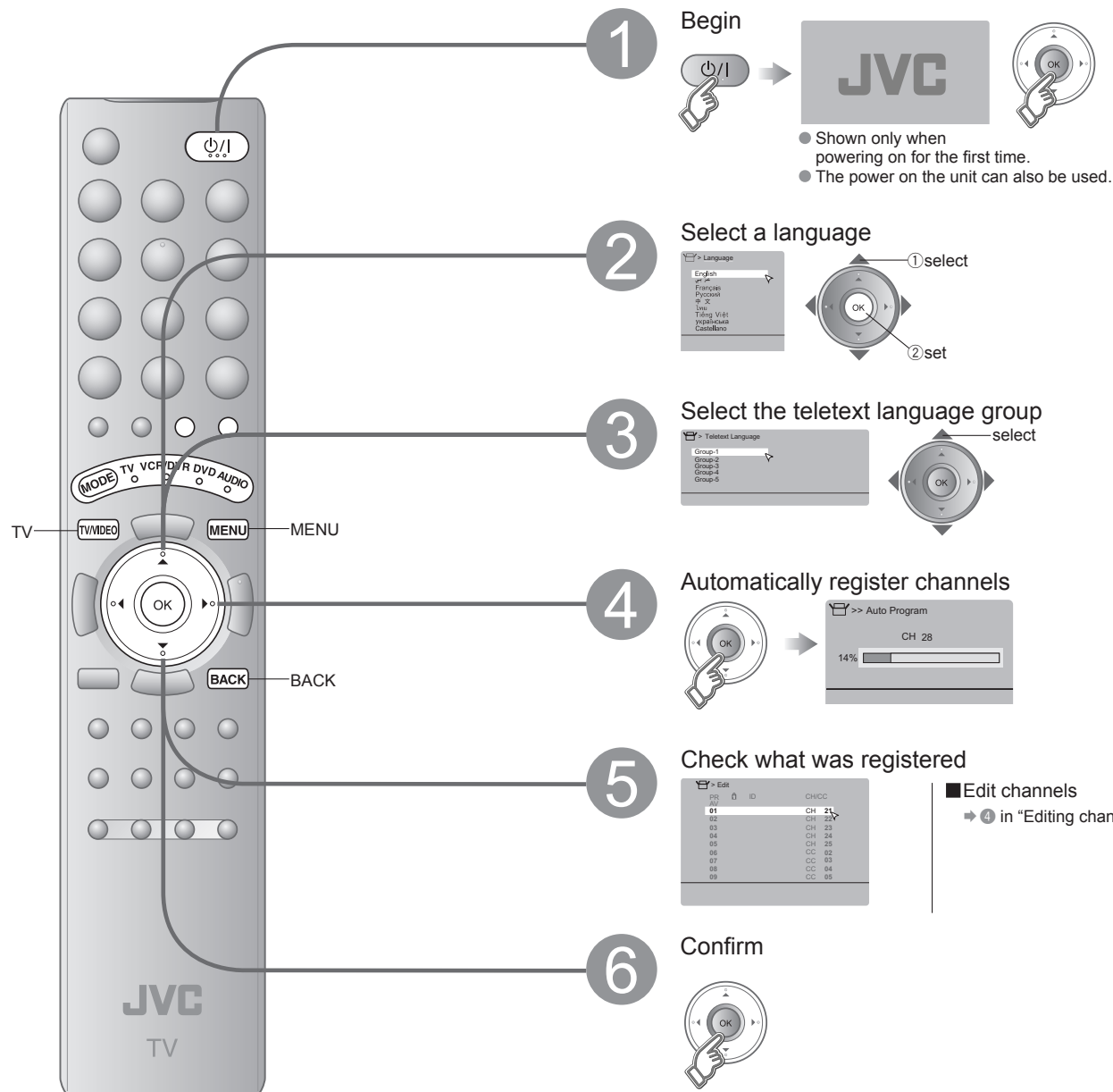

## 1 Begin

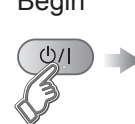

- Shown only when powering on for the first time.
- The power on the unit can also be used.

■ The remote control doesn't work

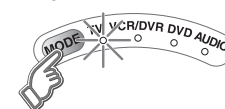

- Confirm the mode is set to "TV".

## 2 Select a language

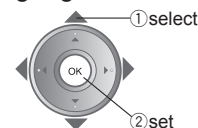
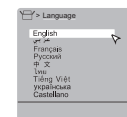

## 3 Select the teletext language group

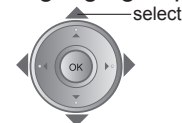

- For the teletext language group
  - ➔ "Language group for teletext" (P. 37)
- If the characters are unreadable.
  - ➔ "Language group for teletext" (P. 37)

## 4 Automatically register channels

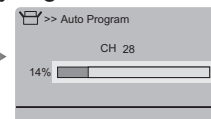

## 5 Check what was registered

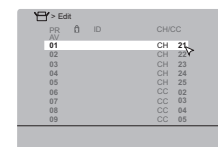

■ Edit channels

- ➔ 4 in "Editing channels" (P. 11)

## 6 Confirm



■ To the previous screen ➔ **BACK**

■ Exit ➔ **MENU**

■ If the "JVC" logo does not appear or if you wish to make changes later  
➔ "Language", "Teletext language" and "Auto Program" (P. 30)

ENGLISH

IMPORTANT!

PREPARE

USE

SETTINGS

TROUBLE?

# Editing channels

Edit the channels registered with "Auto Program" in "Initial settings" (P. 9).

When coming from "Initial settings" (P. 9), skip to ④.



- To the previous screen  
→ **BACK**
- Exit  
→ **MENU**

- 1 Display the menu bar**  
MENU
- 2 Select "Set Up"**  
Set Up
- 3 Select "Edit / Manual"**  
EditManual
- 4 Select a row**  
PR ID CH/CC
- 5 Edit**
- 6 Finish**

Move a channel's position  
**MOVE**

Edit a channel name  
**ID**

Insert a channel  
**INSERT**

Delete a channel  
**DELETE**

Register a new channel  
**MANUAL**

- ① Begin**  
move out
  - ② Select a destination**  
select  
move in
  - ③ Finish**
- ① Begin**  
(red)
  - ② Enter a channel name**  
① enter the first character  
② next column  
set
- ① Begin**  
(green)
  - ② Select a "CH / CC"**  
select  
● "CH/CC" List → (P. 39)
  - ③ Enter a number**  
● Receives the broadcast signal.
- ① Delete**  
(yellow)
- ① Begin**  
(blue)
  - ② Beginning channel search**  
From high frequencies (red) or From low frequencies (green)  
● If you can not receive the channel you want to view, press ► to change the sound system.  
→ "Sound system in your country or region" (P. 37)
  - ③ Set**
- Adjust**  
● Channel fine tuning → (yellow) / (blue)  
● If the picture or sound is unnatural → select a system



# Connecting external devices

You can connect many different devices to the rear panel of the TV.  
Please read the user manuals of each device before setting up.  
(Connecting cables are not supplied with this TV.)

VCR / DVD / other devices

→ : signal direction

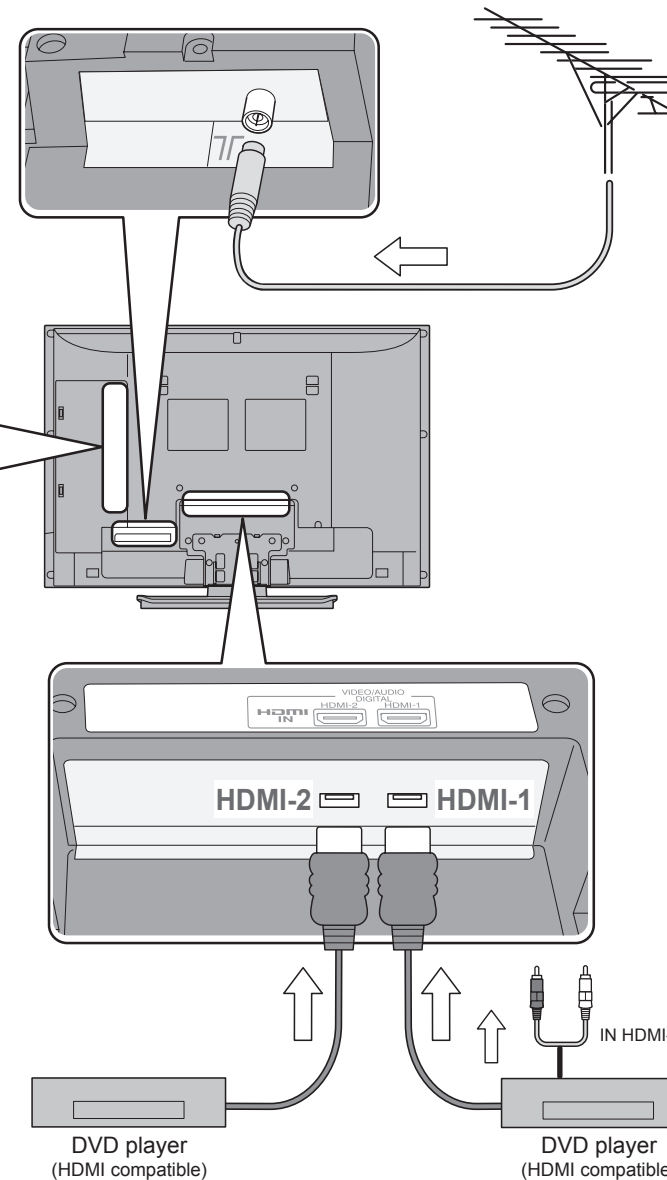
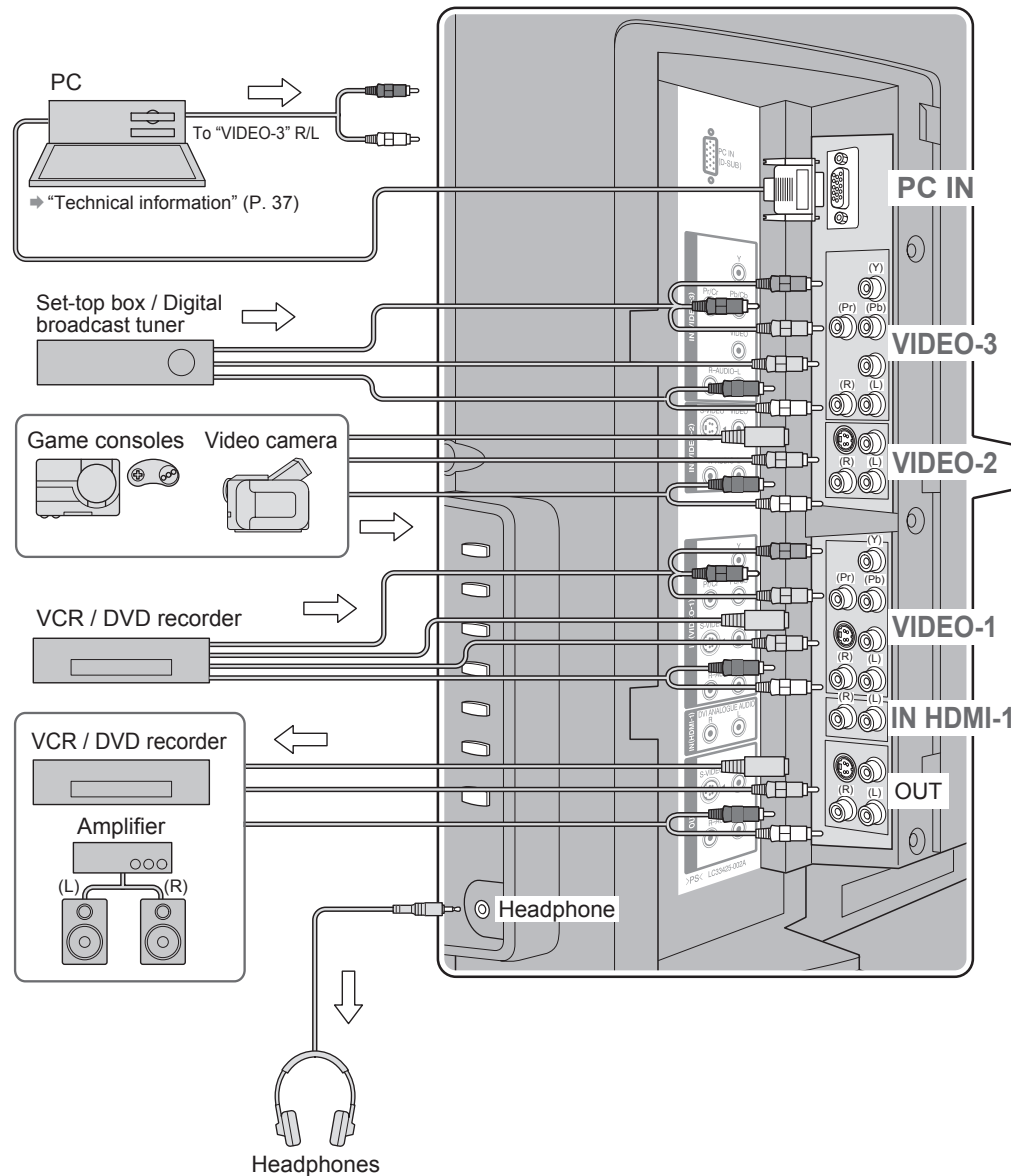

## VIDEO-1 Watching videos

Output ↑	Input ↓
	<ul style="list-style-type: none"> <li>Composite signal / Component signal / S-VIDEO</li> <li>Sound L / R</li> </ul>

- Use Component signal
  - ➔ "Switch between video and component signal" (P. 22)
- Use S-VIDEO
  - ➔ "Using S-VIDEO" (P. 22)

## VIDEO-2 Watching videos

Output ↑	Input ↓
	<ul style="list-style-type: none"> <li>Composite signal / S-VIDEO</li> <li>Sound L / R</li> </ul>

- Use S-VIDEO
  - ➔ "Using S-VIDEO" (P. 22)

## VIDEO-3 Watching DVDs

Output ↑	Input ↓
	<ul style="list-style-type: none"> <li>Composite signal / Component signal</li> <li>Sound L / R</li> </ul>

- Use Component signal
  - ➔ "Switch between video and component signal" (P. 22)

## HDMI-1 Connecting HDMI devices

Output ↑	Input ↓
	<ul style="list-style-type: none"> <li>HDMI signal (P. 38)</li> </ul>

- "HDMI Setting" ➔ (P. 30)
- HDMI-2 input does not support analogue sound.

## OUT

Video and sound signal of a TV channel you are viewing outputs from this terminal

Output ↓
<ul style="list-style-type: none"> <li>Composite signal / S-VIDEO</li> <li>Sound L / R</li> </ul>

- "Using OUT terminal". ➔ (P. 22)

- Connect a "DVI" device to "HDMI-1" ➔ (P. 38)

ENGLISH

IMPORTANT!

PREPARE

USE

SETTINGS

TROUBLE?

# Enjoying your new TV!

ENGLISH

ENGLISH

## Watching TV

PAGE  
17

- View channel information
- Change the aspect ratio
- Enjoy "Cinema Surround"
- Register your favourite channels

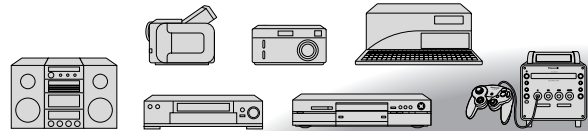
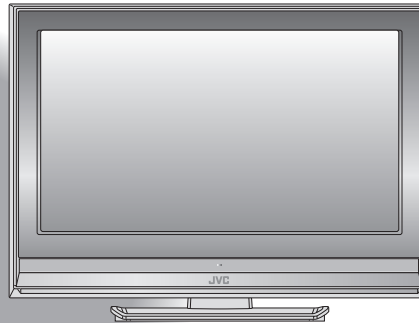
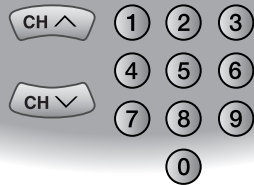

## Watching videos / DVDs

PAGE  
21

- Watch high quality video (S-VIDEO)
- Switch between video and component signal
- PC position adjustment

TV/VIDEO

## Viewing teletext

PAGE  
19

- Enlarge the text
- To the index page
- Hold the current page
- Switch briefly between teletext and TV
- Bookmark your favourite pages
- Reveal hidden pages

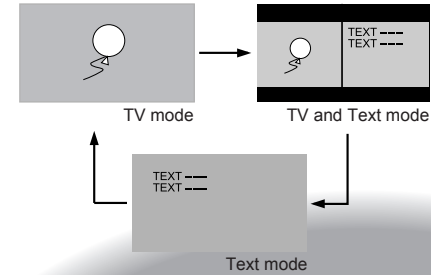

## Personal preferences

PAGE  
29

- Adjust the picture
- Adjust the sound
- Advanced settings (sleep-timer / channel guard, etc.)
- Basic settings (channel settings, etc.)

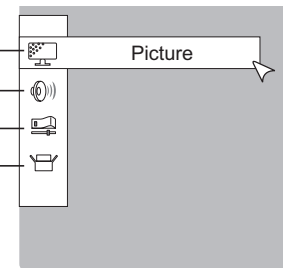

IMPORTANT!

PREPARE

USE

SETTINGS

TROUBLE?

# Watching TV

ENGLISH

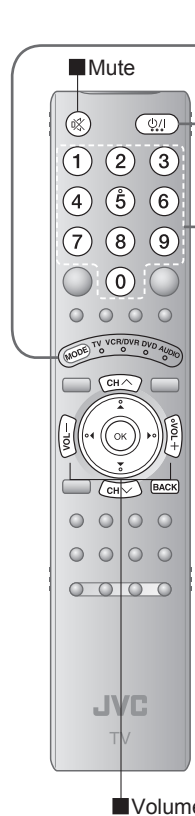

- Set to "TV"**  
Press the **MODE** button. The TV will switch to TV mode.
- Power on**  
Press the **Power** button. The blue power lamp on the TV lights.  
● Press again to turn the screen off and put the TV into standby mode.
- Select a channel**  
Press the **CH** buttons. E.g.  
1 : 0 → 1  
15 : 1 → 5  
● Move up or down a channel  
CH  $\wedge$  up  
CH  $\vee$  down  
● Switch between mono / stereo / bilingual broadcasting  
→ "Stereo / I-IV" (P. 30)

**Note**  
● To completely turn off the TV, unplug the AC plug.

■ Mute  
■ Volume

## Basic operations using the side buttons

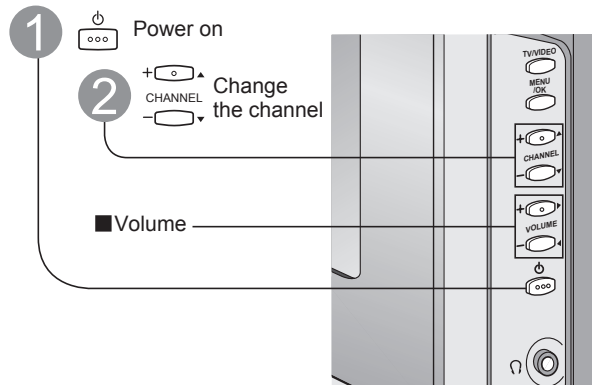

- Power on**  
Press the **Power** button.
- Change the channel**  
Press the **CHANNEL** button.

■ Volume

### Channel information

DISPLAY

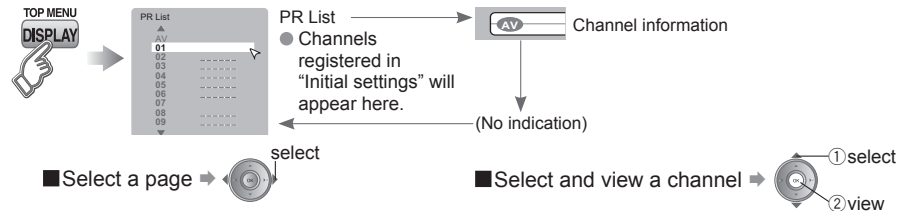

TOP MENU  
DISPLAY

PR List

- Channels registered in "Initial settings" will appear here.

■ Select a page → select

■ Select and view a channel → select  
view

Channel information

(No indication)

### Change the aspect ratio

ZOOM

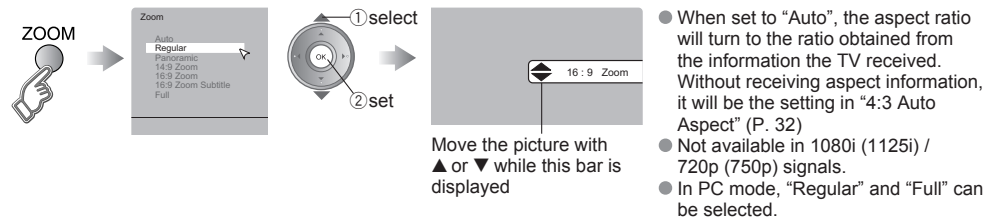

ZOOM

Zoom

- Auto
- Regular
- 14:9 Zoom
- 16:9 Zoom
- 16:9 Zoom Subtitle
- Full

① select  
② set

16:9 Zoom

Move the picture with  $\blacktriangle$  or  $\blacktriangledown$  while this bar is displayed

- When set to "Auto", the aspect ratio will turn to the ratio obtained from the information the TV received. Without receiving aspect information, it will be the setting in "4:3 Auto Aspect" (P. 32)
- Not available in 1080i (1125i) / 720p (750p) signals.
- In PC mode, "Regular" and "Full" can be selected.

### Enjoy ambient sound

CINEMA SURROUND

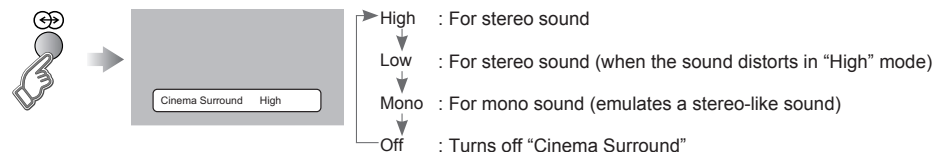

Cinema Surround

High

High : For stereo sound  
Low : For stereo sound (when the sound distorts in "High" mode)  
Mono : For mono sound (emulates a stereo-like sound)  
Off : Turns off "Cinema Surround"

### Emphasize bass sound

MAXXBASS

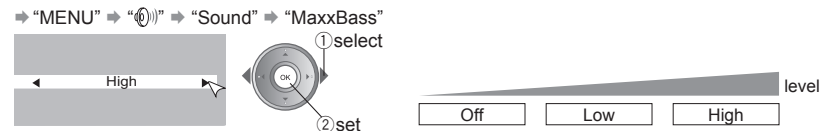

"MENU" → "Sound" → "MaxxBass"

High

① select  
② set

level

Off Low High

### Always return to the channel you want to view

RETURN PLUS

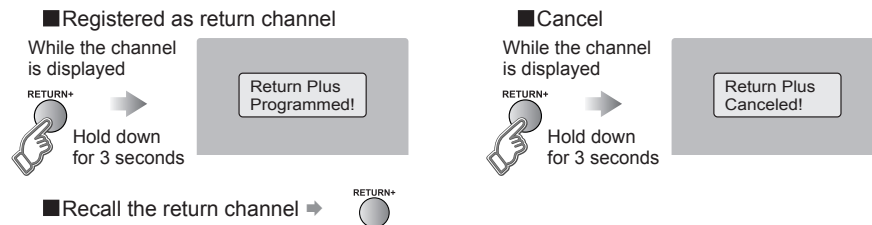

■ Registered as return channel

While the channel is displayed

RETURN+ Hold down for 3 seconds

Return Plus Programmed!

■ Recall the return channel → RETURN+

■ Cancel

While the channel is displayed

RETURN+ Hold down for 3 seconds

Return Plus Canceled!

### Return to the last channel you were viewing

RETURN

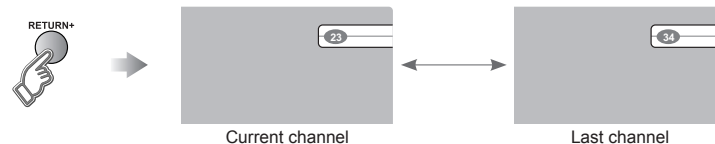

RETURN+

Current channel

Last channel

ENGLISH

IMPORTANT!

PREPARE

USE

SETTINGS

TROUBLE?

# Viewing teletext

This TV can display TV broadcasts and teletext on the same channel in two windows.

ENGLISH

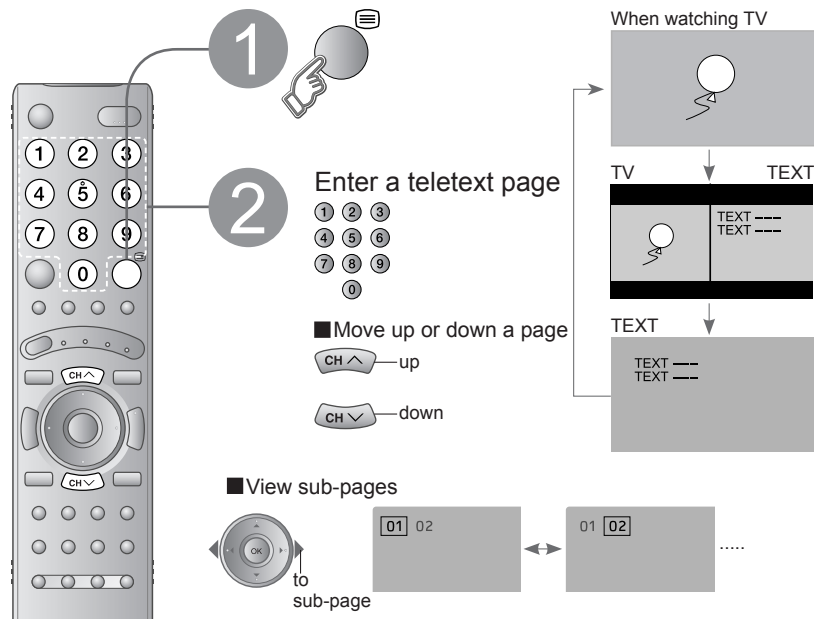

Bookmark  
your favourite  
page  
LIST MODE

- 1 Display your favourites list F.T/L
- 2 Select a coloured button to save your page to (red) (green) (yellow) (blue)
- 3 Enter the number of the page to save
- 4 Save

Recall your favourite page Press the coloured button as in step 2

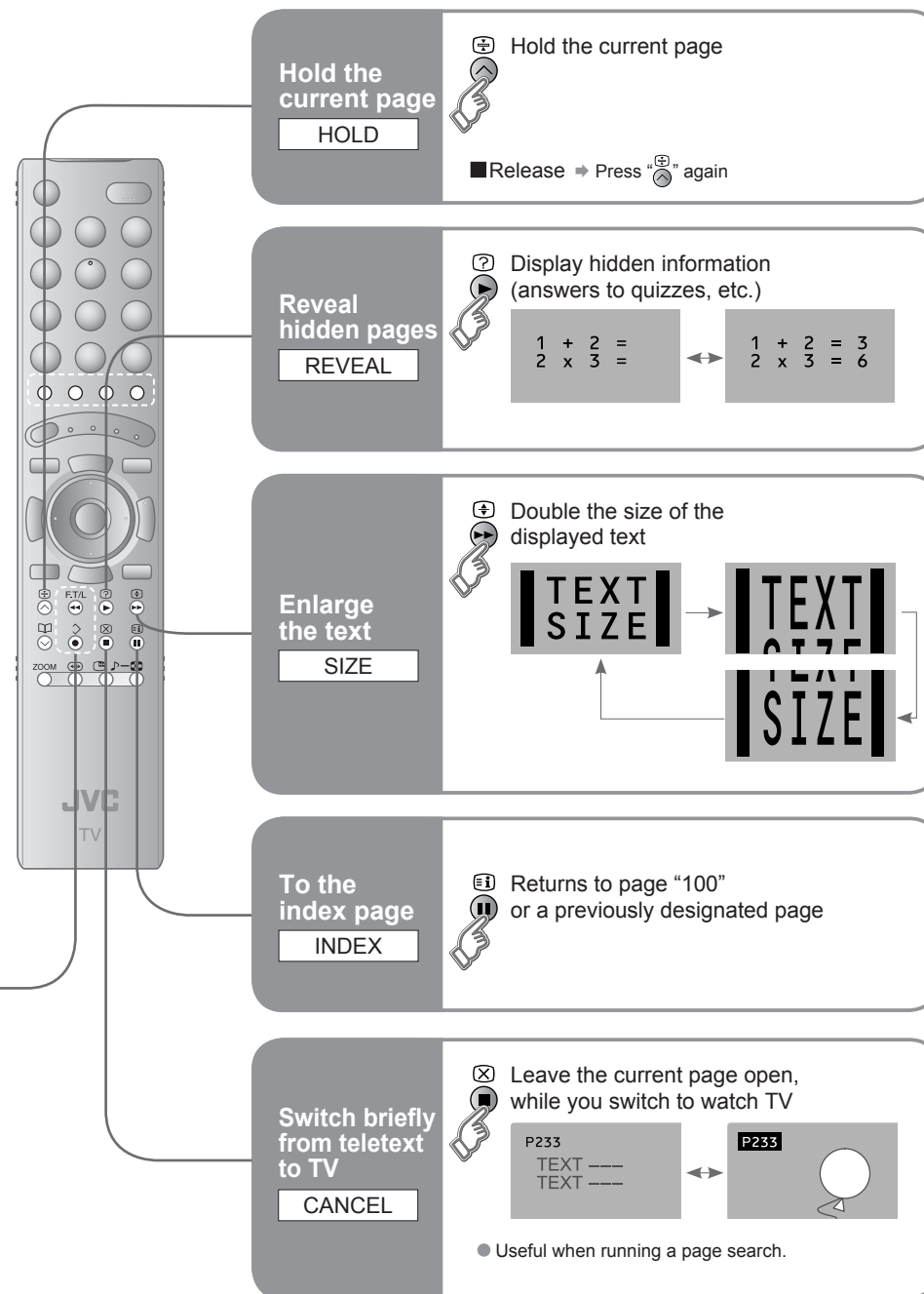

ENGLISH

IMPORTANT!

PREPARE

USE

SETTINGS

TROUBLE?

# Watching videos / DVDs

ENGLISH

- Select the video source**
- Operate the connected device and play a video**  
 ■ Operate JVC recorders and other devices (P. 27)

**Select the video source using the side buttons**

- TV/VIDEO**
- CHANNEL** Select the video source
- MENU/OK**

## PC position adjustment

- Display the menu bar**
- Select "Set Up"**
- Select "PC Position"**  

● Shown only when "PC" is selected.

● Reset position → (blue)

## Switch between video and component signal

- Display the menu bar**
- Select "Set Up"**
- Select "Video-1 Setting" or "Video-3 Setting"**
- Change settings**  

Video : For normal video signal  
 Component : For component video signal

## Using S-VIDEO

- If both composite and S-VIDEO cables are connected, S-VIDEO will be enable.

## Using OUT terminal

- Component and PC signals does not output from this terminal.
- When you are viewing video signal, no signal will output through the S-VIDEO terminal.
- HDMI-1 and HDMI-2 inputs does not output from this terminal.

ENGLISH

IMPORTANT!

PREPARE

USE

SETTINGS

TROUBLE?

# Useful functions

ENGLISH

## Take snapshots of the screen

**FREEZE**

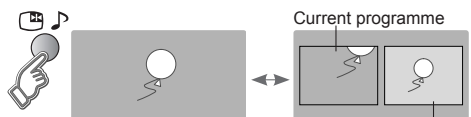

Current programme

Still picture

- **Cancel**
  - ➔ Press **FREEZE** again, or change the channel
- Not available when the SUB-PICTURE is displayed, or when in PC mode.
- You cannot save or export the snapshot.

## Watch in multi-picture mode

**MULTI-PICTURE**

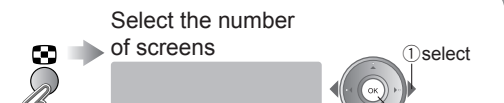

Select the number of screens

1 select

2 set

Selecting "1" returns to normal viewing mode

- Not available in PC mode.

### ■ Watch in dual-picture mode

E.g. You can watch TV and video at the same time.

(For wide aspect ratio signals)



- Switch between the sound sources



- Change the channel

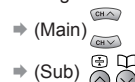

### ■ Select a channel in 12-screen mode

All registered channels are displayed as still images.

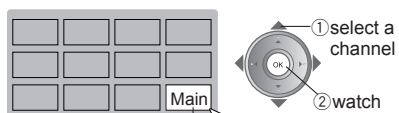

Only the selected frame has a moving picture.

- Move up or down a page
- Not available for HDMI-1 or HDMI-2 input.



## Set a time for the TV to turn itself off

**SLEEP TIMER**

- 1 **MENU**
- 2 **Features**
- 3 **Sleep Timer**
- 4 **Sleep Timer**

1 select "Features"

2 next

1 select "Sleep Timer"

2 next

1 select a time in minutes

2 set

- **Cancel** ➔ Set the time to "0" in step 4

- **Remaining time** ➔ You can confirm the remaining time at step 4, after repeating this process.

- After steps 1 and 2 above

- 3 **Channel Guard**
- 4 **Set ID No.**
- 5 **Channel Guard**
- 6 **Channel Guard**
- 7 **Channel Guard**

select "Channel Guard"

1 enter an "ID No." (a secret number of your choice)

2 to the next column

3 set

select a channel to lock

1 Lock more channels

➔ Repeat steps 5 and 6

- **Release a channel** ➔ Press **FREEZE** again in step 6

- **View a locked channel** ➔ Use the numerical buttons to enter the channel number. When **LOCK** appears, press **FREEZE** and enter your "ID No.". (If you forget your "ID No.", check it in step 4.)

ENGLISH

IMPORTANT!

PREPARE

USE

SETTINGS

TROUBLE?

# Useful functions (continued)

## Register a channel to a button

FAVOURITE CHANNEL

- 1 While the channel is displayed  
Hold down for 3 seconds  
Set 1-4?
- 2 Press the number to register it on  
  
Programmed!  
Disappears after a few seconds

### Recall the favourite channel

- 1
- 2 Press the number you registered  
  
● Customisations (P. 30) to the picture of a favourite channel get saved as well.

### Check your favourite channels

- ➔ Press **TOP MENU** and confirm that the channels you have registered have a beside them

### Delete a favourite channel

- 1 ➔ "MENU" ➔ ➔ "Features" ➔ "Favourite Setting"  
  
select
- 2 delete (blue)

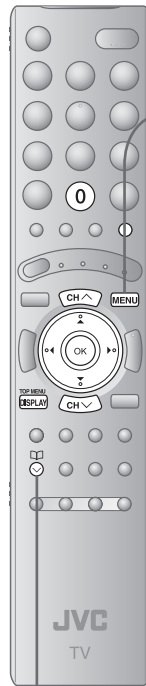

Displays a blue screen and mutes the sound when the signal is weak

BLUE BACK

➔ "MENU" ➔ ➔ "Features" ➔ "Blue Back"

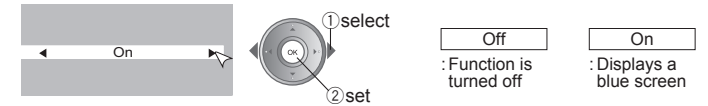

Set the power to turn off if no signal is received and no operation is performed

AUTO SHUTOFF

➔ "MENU" ➔ ➔ "Features" ➔ "Auto Shutoff"

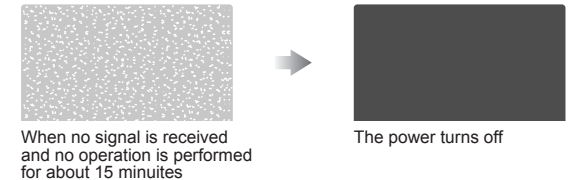
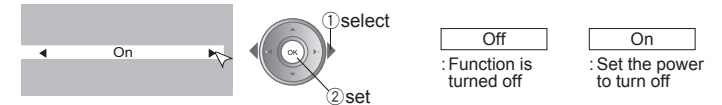

Prevent sudden increase or decrease of sound when changing channels

AI VOLUME

➔ "MENU" ➔ ➔ "Set Up" ➔ "AI Volume"

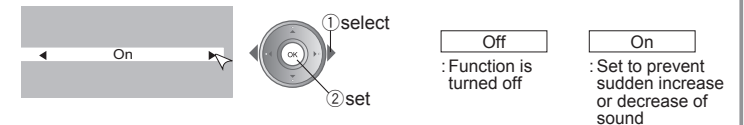



# Operate JVC recorders and other devices

The included remote control can be used to operate JVC recorders and other devices.

ENGLISH

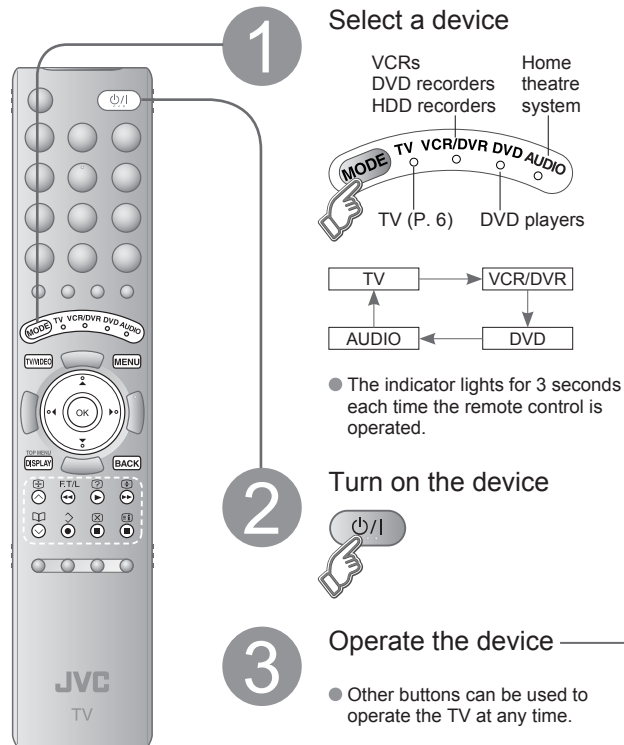

Try changing the remote control code if you cannot operate a recorder.

■ Code A or 1 (Default)

■ Code C or 3



Press and hold



Press and hold

- Confirm the code for your recorder by checking the manual it came with.
- Some models of JVC devices cannot be operated with this remote control.
- JVC DVD recorders and HDD recorders are set to code "C" or "3" by default.

## Note

- If the battery is removed, the remote control code reverts back to code A or 1.

Operate the VCR, DVD recorder or HDD recorder

VCR/DVR

Operate the DVD player

DVD

Operate the home theatre system

AUDIO

■ Operate DVD / HDD recorder menus

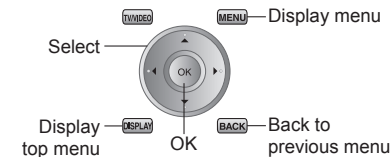

■ Playback / Record etc.

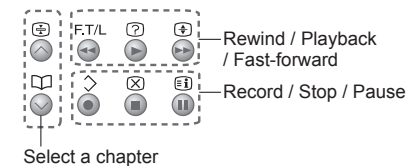

■ Display the subtitle (DVD / HDD recorder mode) → Press "TOP MENU" "DISPLAY"

■ Operate DVD menus

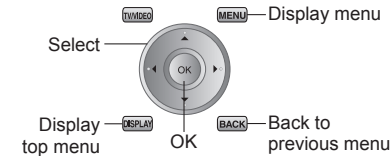

■ Playback etc.

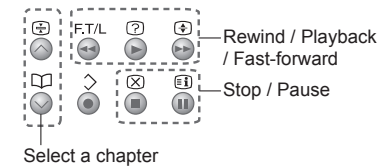

■ Display the subtitle → Press "TOP MENU" "DISPLAY"

■ Operate AUDIO menus

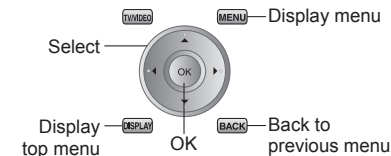

■ Playback etc.

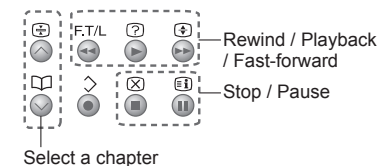

■ Display the subtitle → Press "TOP MENU" "DISPLAY"

■ Mute → Press "MUTE"

■ Volume → Press "VOL + / VOL -"

■ Select a surround mode → Press "SURROUND"

ENGLISH

IMPORTANT!

PREPARE

USE

SETTINGS

TROUBLE?



# Customising your TV

ENGLISH

**1** Display the menu bar

**2** Select a menu

**3** Select an item

**4** Adjust / Configure

■ To the previous screen  
→ **BACK**

■ Exit  
→ **MENU**

● The menu disappears after one minute of inactivity.

■ When adjusting with the sliding-bar

■ When selecting from presets

● Some items have a sub-menu.

Menu	Item	Adjustments / Configurations
Picture	Picture Mode	Picture mode (Bright / Standard / Soft)
	Back Light	Backlight brightness (Darker ⇄ Brighter)
	Contrast	Contrast (Lower ⇄ Higher)
	Bright	Brightness (Darker ⇄ Brighter)
	Sharp	Sharpness (Softer ⇄ Sharper)
	Colour	Colour (Lighter ⇄ Deeper)
	Tint	Tint (Reddish ⇄ Greenish)
	White Balance	Colour temperature (Warm / Mid / Cool)
	Features	Finer picture adjustments (P. 31)
	Stereo / I · II	Mode / Language (O : MONO / ∞ : STEREO / I : SUB1 / II : SUB2 / MONO) (P. 38)
Sound	Bass	Low tones (Weaker ⇄ Stronger)
	Treble	High tones (Weaker ⇄ Stronger)
	Balance	Speaker balance (Left Stronger ⇄ Right Stronger)
	Cinema Surround	Ambience level (High / Low / Mono / Off)
	MaxxBass *1	Emphasize the bass sound (Off / Low / High)
	Voice Enhancer	Sound enhancement technology (On / Off)
Features	Sleep Timer	Timer for turning off the TV (P. 24)
	Channel Guard	Stops children from watching specific channels (P. 24)
	Appearance	Format for displaying the channel number (Type A / Type B)
	Blue Back	Displays a blue screen and mute the sound when the signal is weak or absent (P. 26)
	Child Lock	Disables the front control buttons of the TV
	Auto Shutoff	Set the power to turn off if no signal is received and no operation is performed for about 15 minutes. (P. 26)
	Favourite Setting	Clear favourite channel settings (P. 25)
	Illumination	Lights illumination lamp (P. 5) while the TV is on (Bright / Soft / Off)
Set Up	Power Lamp	Lights power lamp (P. 5) while the TV is on (On / Off)
	Auto Program	Automatically registers channels (P. 10, ③)
	Edit / Manual	Change registered channels or add new ones (P. 11)
	Language	Select a language for on-screen menus (P. 10, ②)
	Video-1 Setting	For use with video players and other devices (P. 22)
	Video-3 Setting	For use with video players and other devices (P. 22)
	AI Volume	Prevent sudden increase or decrease of sound when changing channels (P. 26)
	Teletext Language	Select a language for Teletext programmes (P. 10, ③)
	HDMI Setting	HDMI-1 : Size (1 / 2 / Auto) HDMI-2 : Size (1 / 2 / Auto) Audio (Digital / Analogue / Auto)
	PC Position	PC position adjustment (P. 21)

● Other settings · Change the aspect ratio → “ZOOM” (P. 17)  
· Turn on “Cinema Surround” → “CINEMA SURROUND” (P. 17)

\*1 MaxxBass is a registered trademark of Waves Audio Ltd. in the USA, Japan and other countries.

ENGLISH

IMPORTANT!

PREPARE

USE

SETTINGS

TROUBLE?

# Advanced picture adjustment

By default, the TV automatically adjusts itself for the best picture.

ENGLISH



- Display the menu bar**  
Press **MENU**.
- Select "Picture"**  
Use the **OK** button to select **Picture** from the menu bar.
- Select "Features"**  
Use the **OK** button to select **Features** from the **Picture** menu.
- Select an item**  
Use the **OK** button to select an item from the **Features** menu.  
E.g. "Super DigiPure"
- Change settings**  
Use the **OK** button to select a setting from the **Super DigiPure** menu.  
E.g. "Super DigiPure"
- Finish**  
Press **OK** to finish.

■ To the previous screen  
⇒ **BACK**

■ Exit  
⇒ **MENU**

● The menu disappears after one minute of inactivity.

## Super DigiPure

For natural-looking outlines

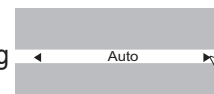

**Off**

: Function is turned off

**Min**

: When the picture loses sharpness

**Max**

: When noise appears

**Auto**

: Automatically adjusts

## Pull Down

For smooth cinema film



**Off**

: Function is turned off

**On**

: Function is always on

**Auto**

: Automatically adjusts

## Colour Management

For natural-looking pictures

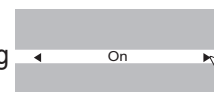

**Off**

: Function is turned off

**On**

: Maintain a natural colour balance

## Picture Management

Fix bright / dark pictures

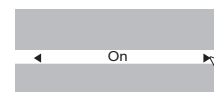

**Off**

: Function is turned off

**On**

: Make it easier to view bright / dark pictures

## Smart Picture

Fix brightness of white areas

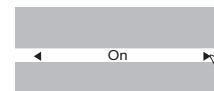

**Off**

: Function is turned off

**On**

: Make it easier to view white areas

● Not available when "Picture Mode" is set to "Bright" (P. 30).

## MPEG Noise Reduction

To reduce MPEG video noise

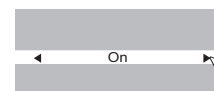

**Off**

: Function is turned off

**On**

: When noise appears

## Colour System

When there is no colour

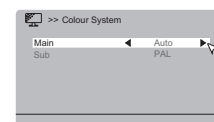

① Select the screen to change settings on

**Main**

**Sub**

: Main picture

: Sub-picture in MULTI-PICTURE mode (P. 23)

② Select the colour system

**PAL**

**SECAM**

**NTSC 3.58**

**NTSC 4.43**

**Auto**

● For colour system in your country or region.

⇒ "Colour system in your country or region" (P. 37)

## 4:3 Auto Aspect

Set a default aspect ratio

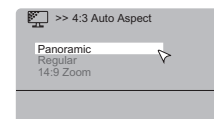

Select a default aspect ratio for Auto in "Zoom" (P. 17)

**Panoramic**

**Regular**

**14:9 Zoom**

16 : 9

4 : 3

14 : 9

ENGLISH

IMPORTANT!

PREPARE

USE

SETTINGS

TROUBLE?

# Troubleshooting

ENGLISH

## Severe noise or snow



- Is the TV connected correctly to the aerial?
  - Change the direction of the aerial.
  - Is the aerial or its cable damaged?
- ➔ Consult your retailer

## Patterns, stripes or noise



- Is the aerial receiving interference from high-voltage power lines or wireless transmitters?
- ➔ Consult your retailer
- Are connected devices too close to the TV?
- ➔ Insert the minimum distance between the aerial and the cause of interference until no interference

## Ghosting

(Doubling of images)



- Are you receiving interference from signals reflected off mountains or buildings?
- ➔ Adjust the direction of your aerial, or change to a good-quality directional aerial

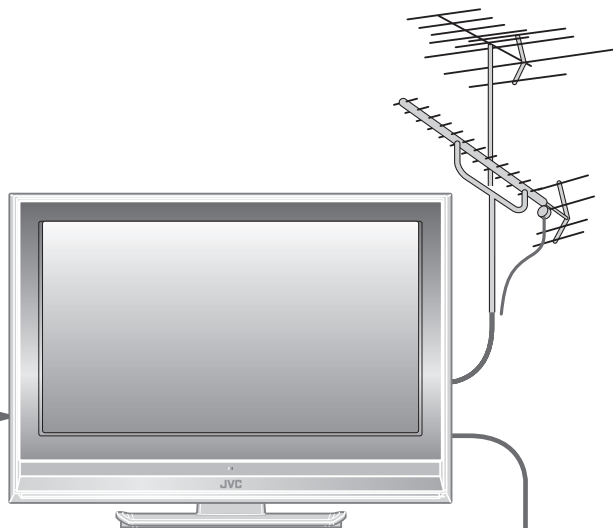

## I can't turn it on!

- Is the power cord connected to the AC outlet correctly?

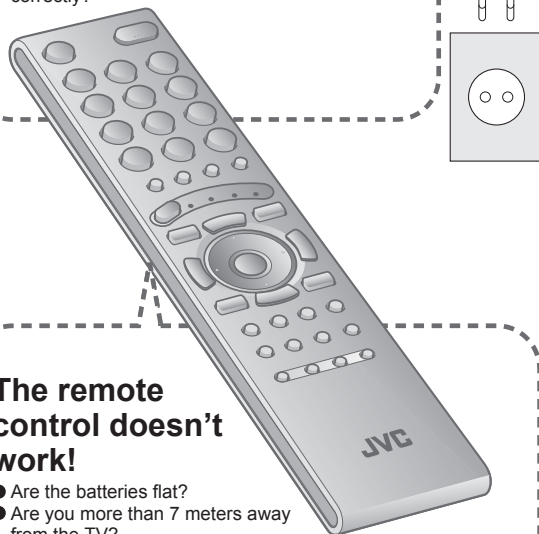

## The remote control doesn't work!

- Are the batteries flat?
- Are you more than 7 meters away from the TV?
- Is the "MODE (TV, VCR/DVR, DVD, AUDIO)" set to "TV"?
- When viewing teletext, the TV menu bar does not appear.
- Depending on the stability of the signal, there may be a time lag when changing channels.

	Problem	Actions	page
Basics	Remote control stops working	● Unplug TV, several minutes later plug it in again.	—
	Front control buttons does not work	● Switch "Child Lock" to "Off".	30
Screen	Aspect ratio changes unintentionally	● Press "ZOOM" to return to your settings.	17
	PC screen alignment is off	● Adjust the "PC position".	21
Picture	Poor picture quality	● Unnatural colour >>> Adjust "Colour" and "Back Light". Check your "Colour System". If "Auto" is selected, select the specific colour system manually.	30 32
		Noise >>> Set to the following functions. Picture Mode : Standard Super DigiPure : Max	30 32
	Strange picture when using an external device	Dull picture >>> Set to the following functions. Picture Mode : Bright Super DigiPure : Min	30 32
		● If the top of the image is distorted, check the video signal quality itself. ● If movement appears unnatural when receiving a signal from a DVD player, etc. with 625p (progressive-scanning), change the output setting of the external device to 625i (interlace-scanning).	— —
	Blue screen appears on the screen	● Switch "Blue Back" to "Off".	26

ENGLISH

IMPORTANT!

PREPARE

USE

SETTINGS

TROUBLE?

# Troubleshooting (continued)

ENGLISH

Problem		Actions	page
Sound	Poor sound	<ul style="list-style-type: none"> <li>Adjust the "Bass" and "Treble".</li> <li>If receiving a poor signal in "Stereo / I-II", switch to "Mono".</li> <li>Adjust the channel reception using "Manual".</li> </ul>	30 30 11
	Wrong screen size	<ul style="list-style-type: none"> <li>Switch "Size" in "HDMI Setting" to "1" or "2".</li> </ul>	30
HDMI	No picture, no sound	<ul style="list-style-type: none"> <li>Use the cable marked with HDMI logo. <b>HDMI</b></li> </ul>	—
	No sound	<ul style="list-style-type: none"> <li>Check if the device is compliant with HDMI.</li> <li>Switch "Audio" in "HDMI Setting" to "Digital" or "Auto" for HDMI devices, or "Analogue" or "Auto" for DVI devices. (Not available for HDMI-2)</li> </ul>	— 30
	Green and distorted screen	<ul style="list-style-type: none"> <li>Wait a little for the signal to stabilize when switching the signal format for an "HDMI" device.</li> </ul>	—
Functions	Some functions do not work	<ul style="list-style-type: none"> <li>It is not a malfunction. Some functions (dark background) in the menu do not work depending on the situation.</li> </ul>	—
	Some inputs cannot be selected in the sub-picture	<ul style="list-style-type: none"> <li>"VIDEO-1 (Component signal)", "VIDEO-3 (Component signal)", "HDMI-1", "HDMI-2" inputs and PC mode cannot be selected in the sub-picture.</li> </ul>	—

Problem		Actions	page
Screen	Black or white dots appear on the screen	<ul style="list-style-type: none"> <li>LCD panels use fine dots ("pixels") to display images. While more than 99.99% of these pixels function properly, a very small number of pixels may not light, or may light all the time. Please understand that this is not a malfunction.</li> </ul>	—
	No picture, no sound	<ul style="list-style-type: none"> <li>Some inputs does not output from OUT terminal</li> </ul>	22

ENGLISH

IMPORTANT!

PREPARE

USE

SETTINGS

TROUBLE?

# Technical information

## Language group for teletext

Group	Languages
Group-1	Turkish, Hungarian, English, German, French, Italian, Spanish, Portuguese, Greek, Swedish, Finnish
Group-2	Polish, Serbian, Croatian, Slovenian, Czech, Slovak, Rumanian, Hungarian, German, French, Italian, Swedish, Finnish
Group-3	Russian, Bulgarian, Lettish, Lithuanian, Estonian, Ukrainian, Serbian, Croatian, Slovenian, Czech, Slovak, English, German
Group-4	Arabic, Czech, Slovak, Hungarian, English, German, French, Italian, Spanish, Portuguese, Swedish, Finnish
Group-5	Farsi, Czech, Slovak, Hungarian, English, German, French, Italian, Spanish, Portuguese, Swedish, Finnish

- If the characters are unreadable. ➔ Select different teletext language group.

## Colour system in your country or region

Area	Country or Region	System
Asia, Middle East	Bahrain, Kuwait, Oman, Qatar, United Arab Emirates, Yemen, etc. Indonesia, Malaysia, Singapore, Thailand, India, etc.	PAL
	China, Vietnam, etc.	
	Hong Kong, etc.	
	Islamic Republic of Iran, Lebanon, Saudi Arabia, etc.	SECAM
	Philippines, Taiwan, Myanmar, etc.	NTSC
Europe	Russia, etc.	SECAM
	Czech Republic, Poland, etc.	PAL
	Germany, Holland, Belgium, etc.	
	UK, etc.	
Oceania	Australia, New Zealand, etc.	PAL
Africa	Republic of South Africa, etc.	PAL
	Nigeria, etc.	
	Egypt, Morocco, etc.	SECAM

## Sound system in your country or region

Area	Country or Region	System
Asia, Middle East	Bahrain, Kuwait, Oman, Qatar, United Arab Emirates, Yemen, etc. Indonesia, Malaysia, Singapore, Thailand, India, etc.	B/G
	China, Vietnam, etc.	D/K
	Hong Kong, etc.	I
	Islamic Republic of Iran, Lebanon, Saudi Arabia, etc.	B/G
	Philippines, Taiwan, Myanmar, etc.	M
Europe	Russia, etc.	D/K
	Czech Republic, Poland, etc.	
	Germany, Holland, Belgium, etc.	B/G
	UK, etc.	I
Oceania	Australia, New Zealand, etc.	B/G
Africa	Republic of South Africa, etc.	I
	Nigeria, etc.	B/G
	Egypt, Morocco, etc.	

## Monoaural sound

Use this function when stereo sound or bilingual sound is hard to hear.

- Set "Stereo / I · II" to "MONO" ➔ (P. 30)

## PC Signals that can be displayed

\*Macintosh\* computers are not supported.  
(Macintosh is a registered trademark of Apple Computer, Inc.)

Resolution	640 x 480 (VGA)	1024 x 768 (XGA)
Vertical frequency (Hz)	60.0	60.0

- If the signal doesn't appear, check that the vertical frequency on the PC is set to "60Hz".

## Connect "DVI" devices

Connect a "DVI" device to "HDMI-1" using "DVI-HDMI" conversion cable. Connect analogue sound output of the DVI device to L and R terminals in IN HDMI-1.

- Set "Audio" in "HDMI Setting" to "Analogue" or "Auto" ➔ (P. 30)
- HDMI-2 input does not support analogue sound (IN HDMI-1).
- HDMI-2 input does not support DVI devices.

# “CH/CC” List

To use the INSERT function (P. 11), find the “CH/CC” number corresponding to the TV's Channel number from this table.

US: The US channel numbers are the channel numbers used in the United States, Philippines, etc.  
CCIR: The CCIR channel numbers are the channel numbers used in the Middle East, Southeast Asia, etc.  
OIRT: The OIRT channel numbers are the channel numbers used in Eastern Europe, Russia, Vietnam, etc.  
AUSTRALIA: The AUSTRALIA channel numbers are the channel numbers used in Australia, etc.

CH	Channel			
	US	CCIR	OIRT	AUSTRALIA
CH 02	US-02	E2	R1	AU-0
CH 03	US-03	E3		AU-1
CH 04	US-04	E4	R2	AU-2
CH 05	US-05	E5	R6	AU-6
CH 06	US-06	E6	R7	AU-7
CH 07	US-07	E7	R8	AU-8
CH 08	US-08	E8	R9	AU-9
CH 09	US-09	E9		
CH 10	US-10	E10	R10	AU-10
CH 11	US-11	E11	R11	AU-11
CH 12	US-12	E12	R12	
CH 13	US-13			
CH 14	US-14, W+29			
CH 15	US-15, W+30			
CH 16	US-16, W+31			
CH 17	US-17, W+32			
CH 18	US-18, W+33			
CH 19	US-19, W+34			
CH 20	US-20, W+35			
CH 21	US-21, W+36	E21		
CH 22	US-22, W+37	E22		
CH 23	US-23, W+38	E23		
CH 24	US-24, W+39	E24		
CH 25	US-25, W+40	E25		
CH 26	US-26, W+41	E26		
CH 27	US-27, W+42	E27		
CH 28	US-28, W+43	E28		
CH 29	US-29, W+44	E29		
CH 30	US-30, W+45	E30		
CH 31	US-31, W+46	E31		
CH 32	US-32, W+47	E32		
CH 33	US-33, W+48	E33		
CH 34	US-34, W+49	E34		
CH 35	US-35, W+50	E35		
CH 36	US-36, W+51	E36		
CH 37	US-37, W+52	E37		
CH 38	US-38, W+53	E38		
CH 39	US-39, W+54	E39		
CH 40	US-40, W+55	E40		
CH 41	US-41, W+56	E41		
CH 42	US-42, W+57	E42		
CH 43	US-43, W+58	E43		
CH 44	US-44, W+59	E44		
CH 45	US-45, W+60	E45		
CH 46	US-46, W+61	E46		
CH 47	US-47, W+62	E47		
CH 48	US-48, W+63	E48		
CH 49	US-49, W+64	E49		
CH 50	US-50, W+65	E50		
CH 51	US-51, W+66	E51		
CH 52	US-52, W+67	E52		
CH 53	US-53, W+68	E53		
CH 54	US-54, W+69	E54		
CH 55	US-55, W+70	E55		
CH 56	US-56, W+71	E56		
CH 57	US-57, W+72	E57		
CH 58	US-58, W+73	E58		
CH 59	US-59, W+74	E59		
CH 60	US-60, W+75	E60		
CH 61	US-61, W+76	E61		
CH 62	US-62, W+77	E62		
CH 63	US-63, W+78	E63		
CH 64	US-64, W+79	E64		
CH 65	US-65, W+80	E65		
CH 66	US-66, W+81	E66		
CH 67	US-67, W+82	E67		
CH 68	US-68, W+83	E68		
CH 69	US-69, W+84	E69		

CC	Channel			
	US	CCIR	OIRT	AUSTRALIA
CC 01		S-1		AU-5
CC 02		S-2		
CC 03		S-3		
CC 04		S-4		
CC 05		S-5		
CC 06		S-6		AU-5A
CC 07		S-7		
CC 08		S-8		
CC 09		S-9		
CC 10		S-10		
CC 11		S-11		
CC 12		S-12		
CC 13		S-13		
CC 14	A	S-14		
CC 15	B	S-15		
CC 16	C	S-16		
CC 17	D	S-17		
CC 18	E	S-18		
CC 19	F	S-19		
CC 20	G	S-20		
CC 21	H	S-21		
CC 22	I	S-22		
CC 23	J	S-23		
CC 24	K	S-24		
CC 25	L	S-25		
CC 26	M	S-26		
CC 27	N	S-27		
CC 28	O	S-28		
CC 29	P	S-29		
CC 30	Q	S-30		
CC 31	R	S-31		
CC 32	S	S-32		
CC 33	T	S-33		
CC 34	U	S-34		
CC 35	V	S-35		
CC 36	W	S-36		
CC 37	W+1	S-37		
CC 38	W+2	S-38		
CC 39	W+3	S-39		
CC 40	W+4	S-40		
CC 41	W+5	S-41		
CC 42	W+6			
CC 43	W+7			
CC 44	W+8			
CC 45	W+9			
CC 46	W+10			
CC 47	W+11			
CC 48	W+12			
CC 49	W+13			
CC 50	W+14			
CC 51	W+15			
CC 52	W+16			
CC 53	W+17			
CC 54	W+18			
CC 55	W+19			
CC 56	W+20			
CC 57	W+21			
CC 58	W+22			
CC 59	W+23			
CC 60	W+24			
CC 61	W+25			
CC 62	W+26			
CC 63	W+27			
CC 64	W+28			
CC 75	X			
CC 76	Y	R3		
CC 77	Z	R4		AU-3
CC 78	Z+1	R5		
CC 79	Z+2			AU-4
CC 95	A-5			
CC 96	A-4			
CC 97	A-3			
CC 98	A-2			
CC 99	A-1			

# Specifications

Main unit		
Model	LT-Z40SX6 LT-Z40SX60	LT-Z32FX6 LT-Z32FX60
Broadcasting systems	B / G / I / D / K / K1 / M (See “Technical information”, P. 37)	
Colour systems	PAL, SECAM, NTSC 3.58/4.43MHz	
Channels and frequencies	VHF low channel (VL) = 46.25 to 140.25 MHz VHF high channel (VH) = 147.25 to 423.25 MHz UHF channel (U) = 431.25 to 863.25 MHz · Receives cable channels in mid band (X to Z+2, S1 to S10), super band (S11 to S20) and hyper band (S21 to S41).	
Sound-multiplex systems	NICAM (I / B / G / D / K), A2 (B / G / D / K)	
Teletext systems	FLOF (Fastext), WST (standard system)	
Power requirements	AC 110 V - 240 V, 50/60Hz	
Audio output (Rated power output)	10 W + 10 W	
Speakers	6.6 cm round x 4	5.0 cm round x 2
Power consumption [standby]	225 W [0.5 W]	121 W [0.4 W]
Screen size (visible area size measured diagonally)	102 cm	80 cm
Dimensions (W x H x D: mm) [without stand]	1000 x 733.8 x 324.4 [1000 x 670.5 x 117.3]	800 x 591.9 x 244.4 [800 x 545 x 126.5]
Weights [without stand]	30.0 kg [24.0 kg]	17.0 kg [15.5 kg]
Accessories	(See “Check accessories”, P. 5)	

Terminals / Connectors				
Terminal name	Terminal type	Signal type (IN)	Signal type (OUT)	Notes
Input terminals	VIDEO-1	RCA connectors x 6 S-VIDEO connector x 1	Composite video, S-video, Analogue component (576i (625i) / 480i (525i), Progressive : 576p (625p) / 480p (525p), HD : 1080i (1125i), 720p (750p) AUDIO L / R	
	VIDEO-2	RCA connectors x 3 S-VIDEO connector x 1	Composite video, S-video, AUDIO L / R	
	VIDEO-3	RCA connectors x 6	Composite video, Analogue component (576i (625i) / 480i (525i), Progressive : 576p (625p) / 480p (525p), HD : 1080i (1125i), 720p (750p) AUDIO L / R	
	HDMI-1	HDMI connector x 1	HDMI (576i (625i) / 480i (525i) / 576p (625p) / 480p (525p), 1080i (1125i), 720p (750p))	
	HDMI-2			
	IN HDMI-1	RCA connectors x 2	AUDIO L / R	
	PC INPUT	D-SUB (15 pins) x 1	Analogue PC signal (P. 38)	
Output terminals	MONITOR OUT	RCA connectors x 3 S-VIDEO connector x 1	Composite video, S-video, Audio L / R	
	Headphone	Stereo mini-jack x 1 (3.5 mm in diameter)	Headphone output	

● We may change the design and specifications without notice.