

# JVC

## WIDE LCD PANEL TV INSTRUCTIONS



LT - 42E10

**HDMI**™  
HIGH-DEFINITION MULTIMEDIA INTERFACE

ENGLISH



### PREPARATION

|   |   |
|---|---|
| Safety precautions.....                   | 2 |
| Remote control buttons and functions..... | 3 |
| Set up and connections.....               | 4 |
| Initial settings.....                     | 6 |
| Registering / Editing channels.....       | 7 |
| Channel Summary.....                      | 7 |
| Operating the menus.....                  | 8 |

### FUNCTIONS

|                             |    |
|-----------------------------|----|
| Picture setting.....        | 9  |
| Sound setting.....          | 11 |
| Useful functions.....       | 13 |
| Viewing Teletext.....       | 15 |
| Viewing Closed Caption..... | 15 |
| Watching Video or DVDs..... | 16 |

### REFERENCE

|                            |    |
|----------------------------|----|
| Technical information..... | 16 |
| Troubleshooting.....       | 18 |
| CH/CC List.....            | 19 |
| Specification.....         | 20 |

GGT0372-001A-H

## Safety precautions

Thank you for buying this JVC LCD panel television.

To make sure you understand how to use your new TV, please read this manual thoroughly before you begin.

- **Follow this manual regarding setup!**
  - Connect only to a 110-240 V, 50/60Hz AC outlet.
- **Make enough room for inserting and removing the power plug!**
- **Place the TV as close to the outlet as possible!**
  - The main power supply for this TV is controlled by inserting or removing the power plug.
- **Never cut or damage the power cord!**
  - If the AC plug is not the right shape, or the power cord is not long enough, use an appropriate plug adapter or extension cable. (Consult your retailer)
- **Unplug the power cord when going out!**
  - The power buttons on the remote control and the TV unit cannot completely turn off the TV. (Make appropriate arrangements for bedridden people.)
- **Do not allow the TV to fall!**
  - Do not rest your elbows on, or allow children to hang from the TV.
  - There is a risk that the TV will fall and cause injuries.
  - Make use of the hole on the back of the stand to prevent the TV from falling easily.
- **If the TV is damaged or behaving strangely, stop using it at once!**
  - Unplug the power cord and contact your retailer.
- **Never place anything on the TV!**
  - Placing liquid, naked flames, cloths, paper, etc. on the TV may cause a fire.
- **Never expose to rain or moisture!**
  - To prevent fire or electric shock, never allow liquids to enter the unit.
- **Never insert objects into the cabinet openings!**
  - It may cause a fatal electric shock.
  - Take care when children are near.
- **Hold the TV so as not to scratch the screen!**
  - Do not touch the screen when carrying the TV.
- **Do not carry the TV on your own!**
  - In order to prevent accidents, ensure that the TV is carried by two or more people.
- **Never insert the power cord by wet hand!**
  - It may cause a fatal electric shock.
- **Keep the TV set away from direct sunlight!**
  - TV set can be damaged.
- **For more details on installation, usage and safety → Consult your retailer.**

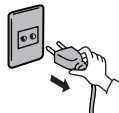

- **Place the TV set in a neat and dry place. Do not place the product close to source of steam, heat, moisture or oil. Because it may cause a fire hazard or electric shock hazard!**
- **Don't touch an external metal part of the TV set!**
  - It may cause an electrocuted.
- **For keep a distance from potential ignition sources to the components or part in side TV set, customer should install TV set with a stand within  $\pm 10$  perpendicularly degree.**
- **Never dismantle the rear panel!**
  - It may cause an electric shock.
- **Never obstruct the ventilation holes!**
  - It may cause overheating or a fire.
- **Handle LCD panel with care!**
  - Use a soft, dry cloth when cleaning.
- **Never try repair the TV yourself!**
  - If the problem cannot be solved in "Troubleshooting" unplug the power cord and contact your retailer.
- **If a television is not positioned in a sufficiently stable location, it can be potentially hazardous due to falling. Many injuries, particularly to children, can be avoided by talking simple precautions such as:**
  - Using cabinets or stands recommended by the manufacturer of the television.
  - Only using furniture that can safely support the television.
  - Ensuring the television is not overhanging the edge of the supporting furniture.
  - Not placing the television on tall furniture (for example, cupboards or bookcases) without anchoring both the furniture and the television to a suitable support.
  - Not standing the television on cloth or other materials placed between the television and supporting furniture.
  - Educating children about the dangers of climbing on furniture to reach the television or its controls.
- **To prevent accidents, firmly attach the TV stands to the TV shelf before using microphone.**
- **Make sure that the subwoofer is in good condition before installing it on the TV.**
  - If the subwoofer has leakage current, it may damage the TV or cause electric shock.

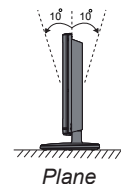

### WARNING:

To prevent the spread of fire, keep candles or other open flames away from this product at all times.



# Remote control buttons and functions

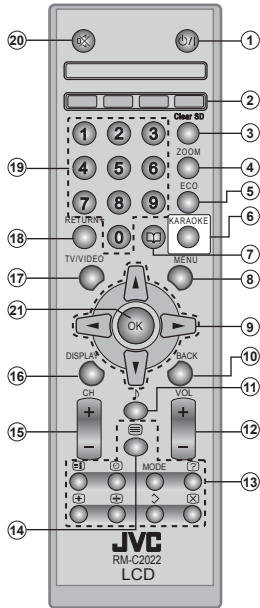

- ① Power On / Off
- ② Colour buttons
- ③ Turn on "Clear SD"
- ④ Turn on "Zoom"
- ⑤ Turn on "Eco Mode"
- ⑥ Turn on "Karaoke"
- ⑦ Favourite channel setting
- ⑧ Display on-screen menu
- ⑨ Operate the menu
- ⑩ To previous screen
- ⑪ Turn on "Sound Meister"
- ⑫ Volume control / Turn off muting
- ⑬ Function for viewing Teletext
- ⑭ To Teletext

- ⑮ Change channel / Page / Hyper Scan
- ⑯ Channel information
- ⑰ Switch between TV / Video input
- ⑱ Return Plus / Return function
- ⑲ Change channel / page
- ⑳ Turn the volume off / on
- ㉑ Turn on "Freeze"

**Zoom :** Change the aspect ratio.

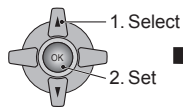
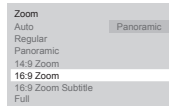

**V-Scroll**

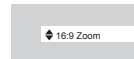

Move the picture with ▼ or ▲ while this bar is displayed.

**Hyper Scan :**

Press and hold . PR changes without changing the picture screen. Once you release the button, the picture of the selected PR will appear.

**Return Plus :** Return to the frequently viewed channel

Return Plus Programmed by select the frequently viewed channel then press and hold .

Return Plus Canceled by press and hold .

**Return :** Return to the previously viewed channel.

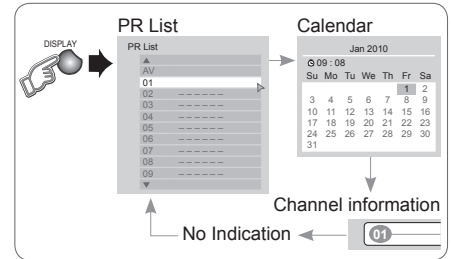

- Insert the batteries
- Use two "AAA/R03" dry cell batteries. Insert the batteries from the ⊖ end, making sure the ⊖ and ⊕ polarities are correct.



## Favourite channel setting.

1. Register the favourite channel



Set 1-4 ?

Press number button (1-4 only)

Press and hold Programmed! will be displayed.

2. Recall the favourite channel



Favourite 1-4 ?

Press number button (1-4 only)

Press

- If the favourite channel has not been registered then "No memory" will be displayed.

## WARNING:

Batteries shall not be exposed to excessive heat such as direct sunshine, fire or the like.



If this symbol is shown, it is only valid in the European Union.

## Set up and connections



### Power lamp

- ON : Lit (Blue)
- OFF : Unlit
- Power lamp lights while the TV is on.
- "Power Lamp" (P. 14)

### Remote control sensor

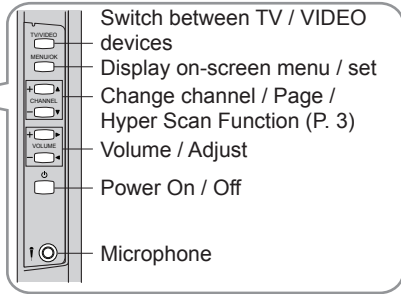

## Care when setting

### Power requirements

- Connect the power cord only to a 110-240V, 50/60Hz AC outlet.

### When attaching the TV to the wall, use the optional JVC wall mounting unit.

- Consult a qualified technician.
- JVC assumes no responsibility for damage due to improper mounting.
- 400 mm x 200 mm mount which conforms to VESA standards.

### Installation requirements

- To avoid overheating, ensure the unit has ample room.

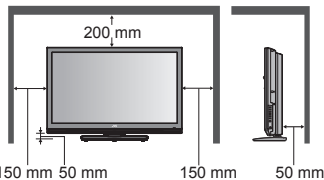

- If the microphone is installed, should be lock it's cable follow picture.

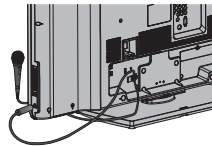

- To prevent the TV from falling thread the belt through the hole on the back of the stand and secure it to the TV rack.

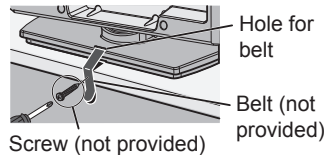

## Connect an aerial and VCR / DVD Player

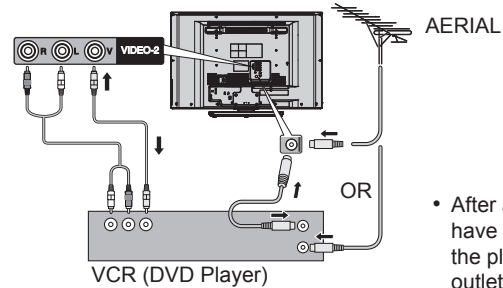

- After all the connections have been made, insert the plug into an AC outlet.

## Stand Assembly

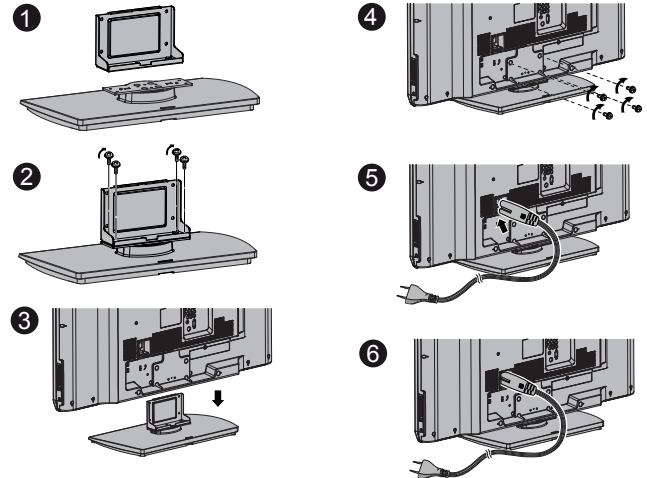

## Set up and connections (continued)

You can connect many different devices to the rear panel of the TV.  
Please read the user manuals of each device before setup.  
(Connecting cables are not supplied with this TV.)

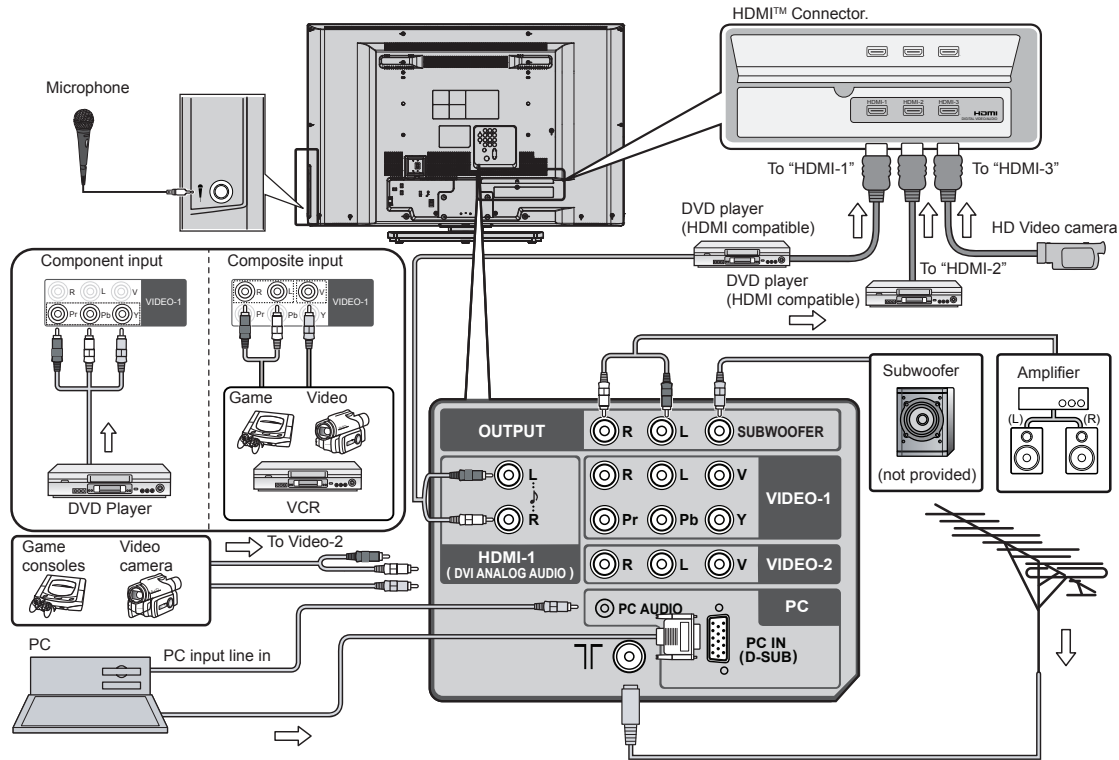

- Check for PC compatibility.  
"PC signals that can be displayed" (P. 17)

### VIDEO-1 Watching videos

| Output | Input  |
|--------|--|
|        | <ul style="list-style-type: none"> <li>• Composite signal / Component signal (P. 20)</li> <li>• Sound L / R</li> </ul> |

- Use Component signal "Video - 1 Setting" (P. 16)

### VIDEO-2 Watching videos

| Output | Input   |
|--------|---|
|        | <ul style="list-style-type: none"> <li>• Composite signal</li> <li>• Sound L / R</li> </ul> |

### HDMI-1 HDMI-2 HDMI-3 } Connecting HDMI devices

| Output | Input   |
|--------|---|
|        | <ul style="list-style-type: none"> <li>• HDMI signal (P. 20)</li> </ul> |

- "HDMI Setting" (P. 16)
- HDMI-2 and HDMI-3 inputs do not support analogue sound.
- Connect a "DVI" device to "HDMI-1" (P.16)
- Please use a High Speed HDMI™ Cable. High Speed HDMI™ Cables are tested to carry an HD signal up to 1080p and higher.

### OUTPUT

Subwoofer and sound signal of a TV channel you are viewing outputs from this terminal

| Output  |
|---|
| <ul style="list-style-type: none"> <li>• Subwoofer signal</li> <li>• Sound L / R</li> </ul> |

# Initial Settings

1 Turn on the TV.



JVC logo appears

- Show only when powering on for the first time.
- The power on the unit can also be used.

MENU → 1 (While the cursor is pointing to Picture menu and hold for 3 seconds.)

2 Select a language.

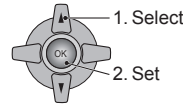
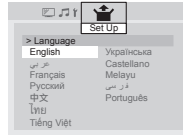

3 Select Country Area.

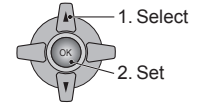
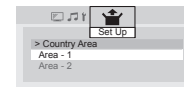

Area-1 : Asia, Middle East, Europe, Oceania, Africa  
Area-2 : South America, Philippines

## If you select Country Area to “Area-1”

4 Select the Teletext language group.

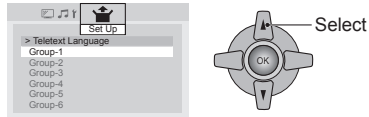

- See “Language group for Teletext” (P. 17).

5 Automatically register channels (Auto Program).

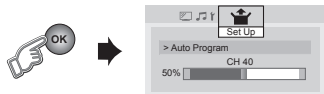

6 Check what was registered.

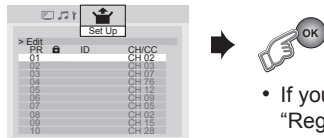

- If you want to edit channel, see “Registering / Editing channels” (P. 7)

## If you select Country Area to “Area-2”

4 Select Air or Cable.

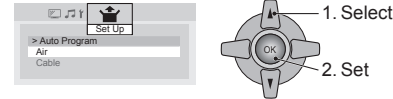

5 Searching for the channels (Auto Program).



6 Check what was registered.

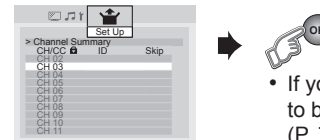

- If you want to set undesired channels to be skipped, see “Channel Summary” (P. 7)

## Registering / Editing channels

This function is available when select Country Area to "Area-1" only.  
You can edit the channel list or register new channel manually.

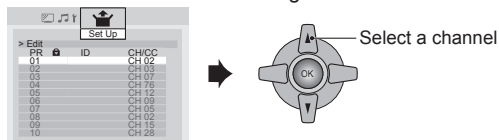

**Move** : Move a channel position.

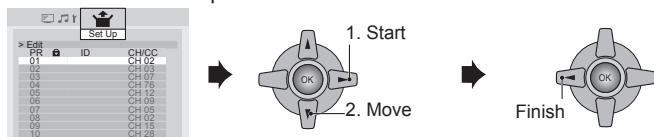

**ID** : Edit a channel name

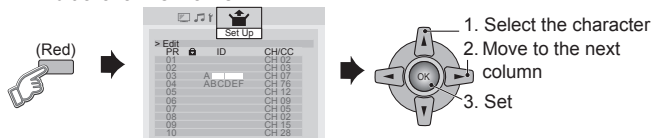

**Insert / Delete** : Insert / Delete a channel

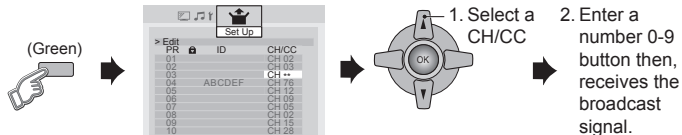

- Delete a channel by press (Yellow) button.
- "CH/CC List" (P. 19)

**Manual** : Register a new channel

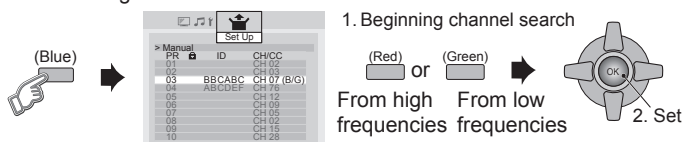

- Channel fine tuning → (Yellow) / (Blue)
- If the picture or sound is unnatural → [TV] for select a system.

## Channel Summary

This function is available when select Country Area to "Area-2" only.  
You can edit the channel list.

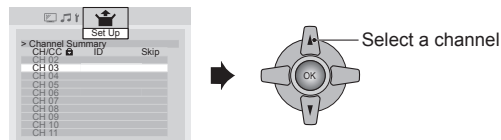

**Skip** : Skip the channel.

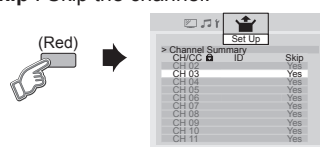

**Cancel** : Cancel the skip channel.

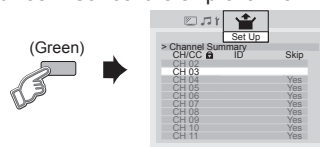

**ID** : Edit a channel name.

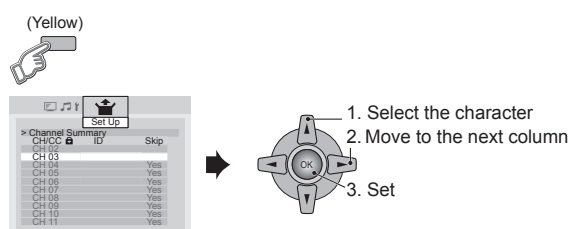

- Channels are to be skipped cannot be selected by the CHANNEL +/- button.
- The skip can be set to all channels of Air (CH02 - CH69) and Cable (CC01 - CC125)

## Operating the menus

You can select the Country Area between Area-1 and Area-2. See in item 3 of "Initial setting" (P. 6)

See the menus location in the below table.

| Set Country Area to "Area-1" |                   |      |
|------------------------------|-------------------|------|
| Top Menu                     | 2nd Menu          | Page |
| <b>Picture</b>               | Picture Mode      | 9    |
|                              | Backlight         | 9    |
|                              | Contrast          | 9    |
|                              | Brightness        | 9    |
|                              | Sharpness         | 9    |
|                              | Colour            | 9    |
|                              | Tint              | 9    |
|                              | White Balance     | 9    |
|                              | Features          | 10   |
|                              | -                 | -    |
| <b>Sound</b>                 | Stereo / I+II     | 11   |
|                              | -                 | -    |
|                              | Sound Meister     | 11   |
|                              | Treble            | 11   |
|                              | Bass              | 11   |
|                              | Surround          | 11   |
|                              | Balance           | 11   |
|                              | Voice Enhancer    | 11   |
|                              | AI Volume         | 11   |
|                              | Subwoofer Out     | 11   |
|                              | Subwoofer Level   | 11   |
|                              | Karaoke           | 11   |
|                              | On Timer          | 13   |
|                              | Sleep Timer       | 13   |
| Calendar                     | 13                |      |
| Channel Guard                | 13                |      |
| Blue Back                    | 14                |      |
| Child Lock                   | 14                |      |
| Auto Shutoff                 | 14                |      |
| Favorite Setting             | 14                |      |
| Power Lamp                   | 14                |      |
| Eco Mode                     | 14                |      |
| <b>Set Up</b>                | Auto Program      | 6    |
|                              | Edit / Manual     | 7    |
|                              | -                 | -    |
|                              | Language          | 6    |
|                              | Video-1 Setting   | 16   |
|                              | Rocket Start      | 14   |
|                              | Teletext Language | 6    |
|                              | HDMI Setting      | 16   |
|                              | PC Setting        | 16   |
|                              | -                 | -    |

| Set Country Area to "Area-2" |                 |      |
|------------------------------|-----------------|------|
| Top Menu                     | 2nd Menu        | Page |
| <b>Picture</b>               | Picture Mode    | 9    |
|                              | Backlight       | 9    |
|                              | Picture         | 9    |
|                              | Brightness      | 9    |
|                              | Detail          | 9    |
|                              | Color           | 9    |
|                              | Tint            | 9    |
|                              | White Balance   | 9    |
|                              | Features        | 10   |
|                              | -               | -    |
| <b>Sound</b>                 | MTS             | 11   |
|                              | Sound Meister   | 11   |
|                              | Treble          | 11   |
|                              | Bass            | 11   |
|                              | Surround        | 11   |
|                              | Balance         | 11   |
|                              | Voice Enhancer  | 11   |
|                              | AI Volume       | 11   |
|                              | Subwoofer Out   | 11   |
|                              | Subwoofer Level | 11   |
|                              | Karaoke         | 11   |
|                              | On Timer        | 13   |
|                              | Sleep Timer     | 13   |
|                              | Calendar        | 13   |
| Channel Guard                | 13              |      |
| Blue Back                    | 14              |      |
| Child Lock                   | 14              |      |
| Auto Shutoff                 | 14              |      |
| Favorite Setting             | 14              |      |
| Power Lamp                   | 14              |      |
| Eco Mode                     | 14              |      |
| <b>Set Up</b>                | Auto Program    | 6    |
|                              | -               | -    |
|                              | Channel Summary | 7    |
|                              | Language        | 6    |
|                              | Video-1 Setting | 16   |
|                              | Rocket Start    | 14   |
|                              | -               | -    |
|                              | HDMI Setting    | 16   |
|                              | PC Setting      | 16   |
|                              | Closed Caption  | 15   |



# Picture setting

## 1. Display "Picture" menu

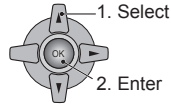
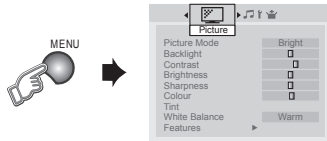

## 2. Select item and setting or adjust

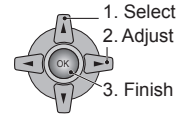
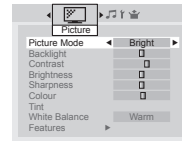

## • To enter an items menu

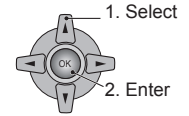

|               |   |
|---------------|---|
| Picture Mode  | <p>You can select a preset picture setting according to your favour.</p> <p><b>Bright</b> : Heightens contrast and sharpness.<br/> <b>Game Mode</b> : Adjust sharpness of the picture when play the game.<br/> <b>Soft</b> : Softens contrast and sharpness.<br/> <b>Standard</b> : Standardize picture adjustment.</p> |
| Backlight     | <p>You can change the backlight brightness.<br/>           Darker ↔ Brighter</p>  |
| Contrast      | <p>You can change the contrast of the picture.<br/>           Lower ↔ Higher</p>  |
| Brightness    | <p>You can change the brightness of the picture.<br/>           Darker ↔ Brighter</p>   |
| Sharpness     | <p>You can change the sharpness of the picture.<br/>           Softer ↔ Sharper</p>   |
| Colour        | <p>You can change the colour of the picture.<br/>           Lighter ↔ Deeper</p>  |
| Tint          | <p>You can change tint only in NTSC.<br/>           Reddish ↔ Greenish</p>  |
| White Balance | <p>You can change the white balance of the picture to better match the type of video being view.</p> <p><b>Cool</b> : Bluish white colour.<br/> <b>Warm</b> : Reddish white colour.<br/> <b>Mid</b> : Normal white colour.</p>  |

## Picture setting (continued)

### Features

#### Finer Picture adjustment

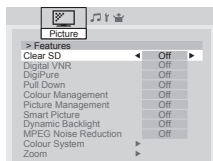

#### Clear SD

: For clearly picture (Off / Mode-1 / Mode-2)  
When Clear SD set to Mode-1 or Mode-2, then Digital VNR, DigiPure, Picture Management and MPEG Noise Reduction cannot operate.

#### Digital VNR

: Reduce the amount of noise in original picture. (Off / On)

#### DigiPure

: For natural - looking outlines (Off / On)

#### Pull Down

: For smooth cinema film (Auto / Off / On)

#### Colour Management

: For natural - looking pictures (Off / On)

#### Picture Management

: Fix bright / dark pictures. (Off / On)

#### Smart Picture

: Make it easier to view white areas. (Off / On)

#### Dynamic Backlight

: Reduce the brightness of the backlight when the screen is dark. (Off / On)

#### MPEG Noise Reduction

: Reduce MPEG video noise. (Off / On)

#### Colour System

: When there is no colour, change the colour system.  
(Area-1 : PAL / SECAM / NTSC 3.58 / NTSC 4.43 / Auto, Area-2 : PAL-M / PAL-N / NTSC / Auto)

#### Zoom

: Change the aspect ratio.

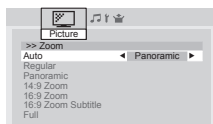

#### Panoramic

16 : 9

#### Regular/Slim

4 : 3

#### 14:9 Zoom

14 : 9

- When 720p or 1080i or 1080p signal is received, "Full", "Slim" and "Panoramic Zoom" can be selected.
- In PC mode, "Regular" and "Full" can be selected.

# Sound setting

1. Display "Sound" menu.

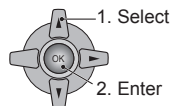
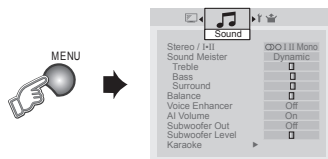

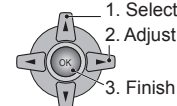
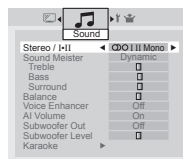

2. Select item and setting or adjust.

- Set Country Area to "Area-1".
- Set Country Area to "Area-2".



|                |  |
|----------------|--|
| Stereo/I+II    | Select the broadcast sound stereo, mono or bilingual language.<br>(○ : Mono / ◐ : Stereo / I : SUB1 / II : SUB2 / Mono)      |
| MTS            | Select the stereo and SAP broadcasted programs.<br>(Stereo : Stereo sound / SAP : Second Audio Programs / Mono : mono sound) |
| Sound Meister  | Ambience (Off / Dynamic / Pure / Living)   |
| Treble         | Compensates high frequencies to widen the frequency band. (Weaker ↔ Stronger)  |
| Bass           | Compensates low frequencies to widen the frequency band. (Weaker ↔ Stronger)   |
| Surround       | Expands the stereo sound naturally. (Narrow ↔ Wide)  |
| Balance        | Speaker balance (Left Stronger ↔ Right Stronger)   |
| Voice Enhancer | Sound enhancement technology. (Off / On)   |
| AI Volume      | Prevent sudden increase or decrease of sound when changing channels. (Off / On)  |

## Sound setting (continued)

|                 |  |
|-----------------|--|
| Subwoofer Out   | <p>Chooses to connect subwoofer. (Off / On)</p> <ul style="list-style-type: none"><li>• Subwoofer to be used must have a built-in amplifier.</li></ul>   |
| Subwoofer Level | <p>Adjusts sound level of your subwoofer. (Lower ↔ Louder)</p> <ul style="list-style-type: none"><li>• When Subwoofer Out set to On, you can adjust Subwoofer Level.</li></ul>   |
| Karaoke         | <p>You can enjoy to reduce the vocals for your own karaoke.</p>   <p><b>Karaoke</b> Chooses to reduce the vocals.</p> <p><b>Off</b> : Normal sound of song</p> <p><b>Mode-1</b> : Only sound of music</p> <p><b>Mode-2</b> : To sing, accompanying with sound of song.</p> <ul style="list-style-type: none"><li>• Karaoke function works only for stereo sound system.</li><li>• If using Karaoke disc, users must choose to remove the vocals from the player.</li></ul> <p><b>Main Volume</b> Adjusts volume level. (Lower ↔ Louder)</p> <p><b>Microphone Volume</b> Adjusts volume level of microphone. (Lower ↔ Louder)</p> <ul style="list-style-type: none"><li>• Microphone Volume is available when plug in microphone.</li><li>• Microphone to be used with the “<b>Karaoke</b>” function of JVC must be of “<b>HIGH GRADE LOW NOISE MICROPHONE CABLE</b>” type; otherwise, noise will result.</li></ul> |

# Useful functions

## 1. Display "Features" menu.

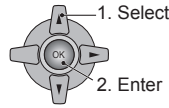
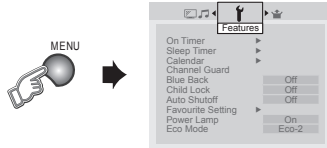

## 2. Select item and setting or adjust.

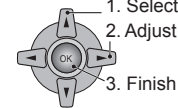
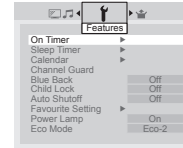

## • To enter an items menu

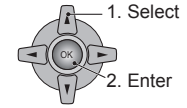

**On Timer**

TV to turn on automatically from standby mode at a set channel and time.

### 1. Select PR channel that you want to watch.

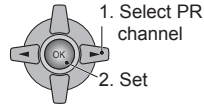
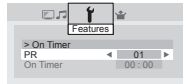

### 2. Set the On time to your desired period at time.

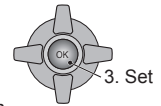
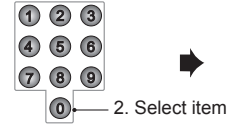
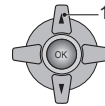

Note : Press for reset time setting.

**Sleep Timer**

TV to turn off automatically to standby mode after a set time.

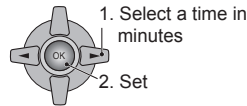
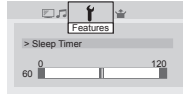

Note : When the remaining elapse is one minute, "Good Night!" appears on the screen.

**Calendar**

Watch calendar, date and time on screen LCD TV.

### 1. Select "Calendar" to On. 2. Set "Time" and "Date".

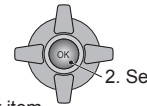
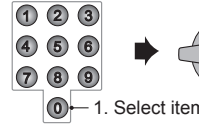

### 3. Set "Position" for adjust screen position.

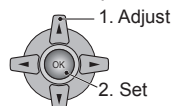
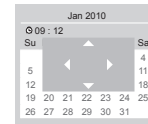

Note : After unplugging the TV, this function will be reset.

**Channel Guard**

Stop children from watching specific channels.

### 1. Select "Channel Guard".

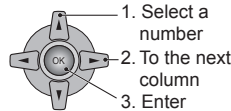

### 2. Select a channel and lock it (🔒 : locked).

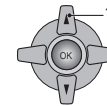
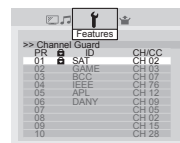



• View a locked channel by use the numerical buttons to enter the channel number. When 🔒 appears, press "DISPLAY" button and enter your "ID No."

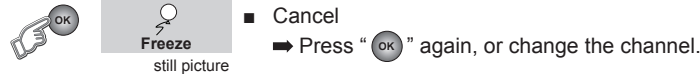





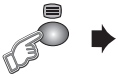

## Useful functions (continued)

|                      |  |
|----------------------|--|
| Blue Back            | Display a blue screen and mute the sound when the signal is weak or absent. (Off / On)   |
| Child Lock           | Disables the side control buttons of the TV. (Off / On)  |
| Auto Shutoff         | Set the power to turn off if no signal is received and no operation is performed for about 15 minute. (Off / On)   |
| Favourite Setting    | <p>Delete the favourite channel that you registered.</p>   |
| Power Lamp           | Power lamp lights while the TV is on. (Off / On) (P. 4)  |
| Eco Mode             | <p>Adjusts picture contrast according to the brightness of your room to reduce power consumption.</p> <p><b>Off</b> : Deactivates the function</p> <p><b>Eco-1</b> : Picture is darkened for the 1st level.</p> <p><b>Eco-2</b> : Picture is darkened for the 2nd level (more than the 1st level).</p> <p><b>Max-Eco</b> : Only sound is available, no picture (this is to save energy in such situation as when you want to listen to the news while doing other house works at the same time).</p> <ul style="list-style-type: none"> <li>- After choosing Eco Mode as Max-Eco, picture will go off in 3 seconds.</li> <li>- When you want the picture to appear again, press any button on the remote control then function will be reset back to "Off".</li> <li>- After unplugging the TV or press "Power off" button, this function will be reset back to "Off"</li> </ul> |
| Freeze               | <p>Take snapshots of the screen.</p>  <ul style="list-style-type: none"> <li>• You cannot save or export the snapshot.</li> <li>• Freeze function is not available for HDMI, PC and Component signal.</li> </ul>   |
| <b>"Set up" Menu</b> |  |
| Rocket Start         | <p>TV can turn on quickly. (Off / On)</p> <p>When Rocket Start is On, power consumption at standby mode will more than normal standby mode.</p>  |

## Viewing Teletext

This function is available when select Country Area to "Area-1" only.  
This TV can display TV broadcasts and Teletext on the same channel in two windows.

- 

- Select a Teletext page by press number button (0-9).
  - Move up or down a page by 

|           |   |
|-----------|---|
| List Mode | <p>Bookmark your favourite page.<br/>MODE (Red) (Green) (Yellow) (Blue)</p>   <p>to bookmark</p> <p>Press number button for enter the number of page.  Save</p> <ul style="list-style-type: none"> <li>• Recall your favourite page by press the colour button.</li> </ul> |
| Hold      |  <p>Hold the current page.</p> <ul style="list-style-type: none"> <li>• Cancel by press this button again.</li> </ul>  |
| Reveal    |  <p>Display hidden information.</p> <ul style="list-style-type: none"> <li>• Example : answer to a quiz, etc.</li> </ul>   |
| Size      |  <p>Double the size of the displayed text.</p>   |
| Index     |  <p>Returns to page "100" or a previously designated page.</p>   |
| Cancel    |  <p>Leave the current page open, while you switch to watch TV.</p> <ul style="list-style-type: none"> <li>• Useful when running a page search.</li> </ul>  |
| Sub-page  |  <p>Display the number of Sub-page.</p> <ul style="list-style-type: none"> <li>• Cancel by press this button again.</li> </ul>  |

## Viewing Closed Caption

Select the input Source.

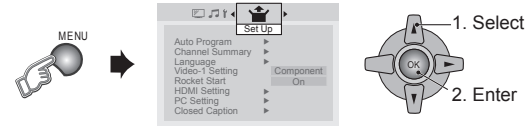
- Select "Set Up".



- Select "Closed Caption"

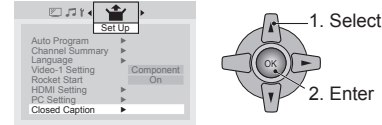

- Select the desired caption or text channel.

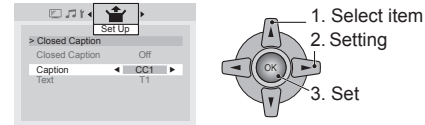

Closed Caption : Select to view close caption or text information.  
(Off / CC / Text)

Caption : Select the desired caption.  
(CC1 / CC2 / CC3 / CC4)

Text : Select the desired text channel.  
(T1 / T2 / T3 / T4)

## Watching Video or DVDs

Select the input Source.



• Operate the connected device and play video.

1. Select "Set Up".

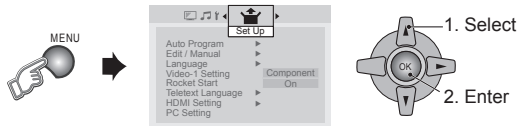

2. Select item.

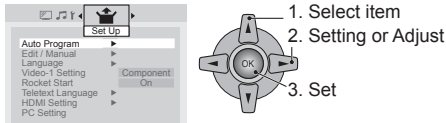

### Video - 1 Setting

Switch between video and component signal.  
(Video / Component)

### HDMI Setting

Setting for HDMI input

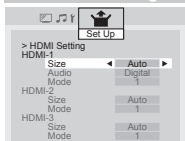

**Size** : Normally set to "Auto." If wrong screen size appears in 480p (525p), change to "1" or "2".

**Audio** : Normally set to "Auto." If no sound, change to "Analogue" or "Digital".

**Mode** : If no picture, change to "1" or "2".

### PC Setting

Setting for PC input

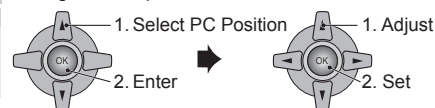

**PC Position** : Adjust screen position.

**Phase** : Sets the focus of screen.

**Pixel** : Adjusts the horizontal feature of screen.

## Technical information

### Connect "DVI" devices

Connect a "DVI" device to "HDMI" using "DVI-HDMI" conversion cable. Connect analogue sound output of the DVI device to L and R terminals in HDMI-1.

- Set "Audio" in "HDMI Setting" to "Analogue" or "Auto"
- HDMI-2 and HDMI-3 input does not support analogue sound (IN HDMI-1).
- HDMI-2 and HDMI-3 input does not support DVI devices.

### What is "Full Native" ?

- With the full HD LCD display and "Full Native", you can enjoy full native HD resolution of 1920 x 1080. It exposes flaws in the video that were hidden when viewing on "Full".



Full



Full Native

- The illustrations are emphasised to make clear differences between "Full" and "Full Native".
- Dark bar or noise may appear at the edges of the screen when viewing in "Full native" for some videos. This is resulted from the signal itself, not due to TV malfunction.



## Technical information (continued)

### Language group for Teletext

| Group   | Languages  |
|---------|--|
| Group-1 | Turkish, Hungarian, English, German, French, Italian, Spanish, Portuguese, Greek, Swedish, Finnish                         |
| Group-2 | Polish, Serbian, Croatian, Slovenian, Czech, Slovak, Rumanian, Hungarian, German, French, Italian, Swedish, Finnish        |
| Group-3 | Russian, Bulgarian, Lettish, Lithuanian, Estonian, Ukrainian, Serbian, Croatian, Slovenian, Czech, Slovak, English, German |
| Group-4 | Arabic, Czech, Slovak, Hungarian, English, German, French, Italian, Spanish, Portuguese, Swedish, Finnish                  |
| Group-5 | Farsi, English, French, Turkish  |
| Group-6 | Lettish, Lithuanian, Estonian, Ukrainian, Czech, Slovak, English, German, Serbian, Croatian, Slovenian                     |

- If the characters are unreadable. ➔ Select different Teletext language group. (P. 6)

### PC Signals that can be displayed

- If the signal doesn't appear, check that the vertical frequency on the PC is set to "60Hz".

|                         |                                  |
|-------------------------|----------------------------------|
| Resolution              | 640 x 480(VGA) / 1024 x 768(XGA) |
| Vertical frequency (Hz) | 60.0                             |

### What is "Clear SD"

LCD picture is unstable due to a large number of signal noise. Such noise appears extensively especially when an LCD displays SD signals. Clear SD mode resolves disadvantage for better picture quality.



No use "Clear SD"



Use "Clear SD"

### Sound and Colour system in your country or region

| Area              | Country or Region  | System | System |       |
|-------------------|--|--------|--------|-------|
| Asia, Middle East | Bahrain, Kuwait, Oman, Qatar, United Arab Emirates, Yemen, Indonesia, Malaysia, Singapore, Thailand, India, etc. | B/G    | PAL    |       |
|                   | China, Vietnam, etc.   | D/K    |        |       |
|                   | Hong Kong, etc.  | I      |        |       |
|                   | Islamic Republic of Iran, Lebanon, Saudi Arabia, etc.  | B/G    |        | SECAM |
|                   | Philippines, Taiwan, Myanmar, etc.   | M      |        | NTSC  |
| Europe            | Russia, etc.   | D/K    | SECAM  |       |
|                   | Czech Republic, Poland, etc.   | B/G    | PAL    |       |
|                   | Germany, Holland, Belgium, etc.  |        |        |       |
| UK, etc.          | I  |        |        |       |
| Oceania           | Australia, New Zealand, etc.   | B/G    | PAL    |       |
|                   | Republic of South Africa, etc.   | I      |        |       |
| Africa            | Nigeria, etc.  | B/G    | PAL    |       |
|                   | Egypt, Morocco, etc.   |        | SECAM  |       |
|                   | Argentina, Paraguay, Uruguay   | N      |        |       |
| South America     | Brazil   | M      | PAL    |       |
|                   | Chile, Peru, Colombia, Venezuela, Ecuador, etc.  | M      | NTSC   |       |
|                   | Bolivia  |        |        |       |

## Troubleshooting

If a problem occurs when you are using the TV, check the below troubleshooting guide before calling for repair.

| Severe noise or snow   | Page  | Poor picture quality  | Page  |
|--|-------|---|-------|
| Check the aerial cable and TV connections .  | P. 4  | Unnatural colour >> Adjust "Colour" and "Backlight"   | P. 9  |
| Check the direction of the aerial.   | P. 4  | Check "Colour System". If "Auto" is selected.   | P. 10 |
| Check the aerial or its cable damaged or not.  | --    | Select the specific colour system manually.   |       |
| <b>Patterns, stripes or noise</b>  |       | Noise >> Set to the following functions.  |       |
| Interference caused by devices such as an amplifier, personal computer, or a hair drier, Move it away from TV.   | --    | Picture Mode : Standard   | P. 9  |
|  |       | DigiPure : On   | P. 10 |
| <b>Ghosting (Doubling of images)</b>   |       | Dull picture >> Set to the following functions.   |       |
| Interference occurs caused by signal reflection from mountains or building. Try to adjust the aerial's direction or use another antenna.   | --    | Picture Mode : Bright   | P. 9  |
|  |       | DigiPure : On   | P. 10 |
| <b>Cannot turn it on</b>   |       | <b>Poor sound</b>   |       |
| Ensure the power cord is connected to the AC outlet correctly.   | --    | Adjust the "Bass" and "Treble".   | P. 11 |
|  |       | If receiving a poor signal in "Stereo/I-II" switch to "Mono".   | P. 11 |
| <b>Cannot operate the remote control.</b>  |       | Adjust the channel reception using "Manual".  | P. 7  |
| The batteries may be exhausted. Replace with new batteries.  | --    | <b>For HDMI signal, wrong screen size in 480p (525p).</b>   |       |
| Ensure that you are operation the remote control at less than 7 meters from the front of your TV.  | --    | Switch "Size" in "HDMI Setting" to "1" or "2".  | P. 16 |
| <b>Remote control stops working</b>  |       | <b>For HDMI signal, green and distorted screen</b>  |       |
| Unplug TV, several minutes later plug it in again.   | --    | Wait a little for the signal to stabilize when switching the signal format for an "HDMI" device.  | --    |
| <b>Side control buttons do not work</b>  |       | <b>For HDMI signal, No picture / No sound</b>   |       |
| Switch "Child Lock" to "Off".  | P. 14 | Use the cable marked with HDMI logo.  | P. 5  |
| <b>Aspect ratio changed unintentionally</b>  |       | Check if the device is compliant with HDMI.   | P. 16 |
| Press "  " button to return to your settings.   | P. 10 | Switch "Audio" in "HDMI Setting" to "Digital" or "Auto" for HDMI devices, or "Analogue" or "Auto" for DVI devices.  |       |
| <b>PC screen alignment is off</b>  |       | <b>Some functions do not work.</b>  |       |
| Adjust the "PC Position" in "PC Setting" of Set Up menu.   | P. 16 | It is not a malfunction. Some functions (dark background) in the menu do not work depending on the situation.   | --    |
| <b>Blue screen appears on the screen</b>   |       | <b>Black or white dots appear on the screen.</b>  |       |
| Switch "Blue Back" to "Off".   | P. 14 | LCD panels use fine dots ("pixels") to display images. While more than 99.99% of these pixels function properly, a very small number of pixels may not light, or may light all the time. It is not a malfunction. | --    |
| <b>Strange picture when using an external device</b>   |       | <b>No picture, No sound</b>   |       |
| If the top of the image is distorted, check the video signal quality itself.   | --    | Some input do not output from OUT terminal.   | --    |
| If movement appears unnatural when receiving a signal from a DVD player, etc. with 625p (progressive-scanning), change the output setting of the external device to 625i (interlace-scanning). | --    | <b>Subwoofer, No sound</b>  |       |
|  |       | May be signal source is not low frequency bass signal.  | --    |
|  |       | Check subwoofer cable connected correctly.  |       |
|  |       | <b>Feedback sound symptoms</b>  |       |
|  |       | Keep the microphone away from the TV's speakers.  | --    |
|  |       | <b>Echo</b>   |       |
|  |       | Lower the sound level in "Microphone Volume" in order to prevent the echo.  | --    |

## CH / CC List

To use the Insert function (P. 7), find the “CH/CC” number corresponding to the TV’s channel number from this table.

- US: The US channel numbers are the channel numbers used in the United States, Philippines, etc.  
 CCIR: The CCIR channel numbers are the channel numbers used in the Middle East, Southeast Asia, etc.  
 OIRT: The OIRT channel numbers are the channel numbers used in Eastern Europe, Russia, Vietnam, etc.  
 AUSTRALIA: The AUSTRALIA channel numbers are the channel numbers used in Australia, etc.

| CH    | Channel     |      |      |           |
|-------|-------------|------|------|-----------|
|       | US          | CCIR | OIRT | AUSTRALIA |
| CH 02 | US-02       | E2   | R1   | AU-0      |
| CH 03 | US-03       | E3   |      | AU-1      |
| CH 04 | US-04       | E4   | R2   | AU-2      |
| CH 05 | US-05       | E5   | R6   | AU-6      |
| CH 06 | US-06       | E6   | R7   | AU-7      |
| CH 07 | US-07       | E7   | R8   | AU-8      |
| CH 08 | US-08       | E8   | R9   | AU-9      |
| CH 09 | US-09       | E9   |      |           |
| CH 10 | US-10       | E10  | R10  | AU-10     |
| CH 11 | US-11       | E11  | R11  | AU-11     |
| CH 12 | US-12       | E12  | R12  |           |
| CH 13 | US-13       |      |      |           |
| CH 14 | US-14, W+29 |      |      |           |
| CH 15 | US-15, W+30 |      |      |           |
| CH 16 | US-16, W+31 |      |      |           |
| CH 17 | US-17, W+32 |      |      |           |
| CH 18 | US-18, W+33 |      |      |           |
| CH 19 | US-19, W+34 |      |      |           |
| CH 20 | US-20, W+35 |      |      |           |
| CH 21 | US-21, W+36 | E21  |      |           |
| CH 22 | US-22, W+37 | E22  |      |           |
| CH 23 | US-23, W+38 | E23  |      |           |
| CH 24 | US-24, W+39 | E24  |      |           |
| CH 25 | US-25, W+40 | E25  |      |           |
| CH 26 | US-26, W+41 | E26  |      |           |
| CH 27 | US-27, W+42 | E27  |      |           |
| CH 28 | US-28, W+43 | E28  |      |           |
| CH 29 | US-29, W+44 | E29  |      |           |
| CH 30 | US-30, W+45 | E30  |      |           |
| CH 31 | US-31, W+46 | E31  |      |           |
| CH 32 | US-32, W+47 | E32  |      |           |
| CH 33 | US-33, W+48 | E33  |      |           |
| CH 34 | US-34, W+49 | E34  |      |           |
| CH 35 | US-35, W+50 | E35  |      |           |
| CH 36 | US-36, W+51 | E36  |      |           |
| CH 37 | US-37, W+52 | E37  |      |           |
| CH 38 | US-38, W+53 | E38  |      |           |
| CH 39 | US-39, W+54 | E39  |      |           |
| CH 40 | US-40, W+55 | E40  |      |           |
| CH 41 | US-41, W+56 | E41  |      |           |
| CH 42 | US-42, W+57 | E42  |      |           |
| CH 43 | US-43, W+58 | E43  |      |           |
| CH 44 | US-44, W+59 | E44  |      |           |
| CH 45 | US-45, W+60 | E45  |      |           |
| CH 46 | US-46, W+61 | E46  |      |           |
| CH 47 | US-47, W+62 | E47  |      |           |

|       |             |     |  |  |
|-------|-------------|-----|--|--|
| CH 48 | US-48, W+63 | E48 |  |  |
| CH 49 | US-49, W+64 | E49 |  |  |
| CH 50 | US-50, W+65 | E50 |  |  |
| CH 51 | US-51, W+66 | E51 |  |  |
| CH 52 | US-52, W+67 | E52 |  |  |
| CH 53 | US-53, W+68 | E53 |  |  |
| CH 54 | US-54, W+69 | E54 |  |  |
| CH 55 | US-55, W+70 | E55 |  |  |
| CH 56 | US-56, W+71 | E56 |  |  |
| CH 57 | US-57, W+72 | E57 |  |  |
| CH 58 | US-58, W+73 | E58 |  |  |
| CH 59 | US-59, W+74 | E59 |  |  |
| CH 60 | US-60, W+75 | E60 |  |  |
| CH 61 | US-61, W+76 | E61 |  |  |
| CH 62 | US-62, W+77 | E62 |  |  |
| CH 63 | US-63, W+78 | E63 |  |  |
| CH 64 | US-64, W+79 | E64 |  |  |
| CH 65 | US-65, W+80 | E65 |  |  |
| CH 66 | US-66, W+81 | E66 |  |  |
| CH 67 | US-67, W+82 | E67 |  |  |
| CH 68 | US-68, W+83 | E68 |  |  |
| CH 69 | US-69, W+84 | E69 |  |  |

| CC    | Channel |      |      |           |
|-------|---------|------|------|-----------|
|       | US      | CCIR | OIRT | AUSTRALIA |
| CC 01 |         | S-1  |      | AU-5      |
| CC 02 |         | S-2  |      |           |
| CC 03 |         | S-3  |      |           |
| CC 04 |         | S-4  |      |           |
| CC 05 |         | S-5  |      |           |
| CC 06 |         | S-6  |      | AU-5A     |
| CC 07 |         | S-7  |      |           |
| CC 08 |         | S-8  |      |           |
| CC 09 |         | S-9  |      |           |
| CC 10 |         | S-10 |      |           |
| CC 11 |         | S-11 |      |           |
| CC 12 |         | S-12 |      |           |
| CC 13 |         | S-13 |      |           |
| CC 14 | A       | S-14 |      |           |
| CC 15 | B       | S-15 |      |           |
| CC 16 | C       | S-16 |      |           |
| CC 17 | D       | S-17 |      |           |
| CC 18 | E       | S-18 |      |           |
| CC 19 | F       | S-19 |      |           |
| CC 20 | G       | S-20 |      |           |
| CC 21 | H       | S-21 |      |           |
| CC 22 | I       | S-22 |      |           |
| CC 23 | J       | S-23 |      |           |

|       |      |      |    |      |
|-------|------|------|----|------|
| CC 24 | K    | S-24 |    |      |
| CC 25 | L    | S-25 |    |      |
| CC 26 | M    | S-26 |    |      |
| CC 27 | N    | S-27 |    |      |
| CC 28 | O    | S-28 |    |      |
| CC 29 | P    | S-29 |    |      |
| CC 30 | Q    | S-30 |    |      |
| CC 31 | R    | S-31 |    |      |
| CC 32 | S    | S-32 |    |      |
| CC 33 | T    | S-33 |    |      |
| CC 34 | U    | S-34 |    |      |
| CC 35 | V    | S-35 |    |      |
| CC 36 | W    | S-36 |    |      |
| CC 37 | W+1  | S-37 |    |      |
| CC 38 | W+2  | S-38 |    |      |
| CC 39 | W+3  | S-39 |    |      |
| CC 40 | W+4  | S-40 |    |      |
| CC 41 | W+5  | S-41 |    |      |
| CC 42 | W+6  |      |    |      |
| CC 43 | W+7  |      |    |      |
| CC 44 | W+8  |      |    |      |
| CC 45 | W+9  |      |    |      |
| CC 46 | W+10 |      |    |      |
| CC 47 | W+11 |      |    |      |
| CC 48 | W+12 |      |    |      |
| CC 49 | W+13 |      |    |      |
| CC 50 | W+14 |      |    |      |
| CC 51 | W+15 |      |    |      |
| CC 52 | W+16 |      |    |      |
| CC 53 | W+17 |      |    |      |
| CC 54 | W+18 |      |    |      |
| CC 55 | W+19 |      |    |      |
| CC 56 | W+20 |      |    |      |
| CC 57 | W+21 |      |    |      |
| CC 58 | W+22 |      |    |      |
| CC 59 | W+23 |      |    |      |
| CC 60 | W+24 |      |    |      |
| CC 61 | W+25 |      |    |      |
| CC 62 | W+26 |      |    |      |
| CC 63 | W+27 |      |    |      |
| CC 64 | W+28 |      |    |      |
| CC 75 |      | X    |    |      |
| CC 76 |      | Y    | R3 |      |
| CC 77 |      | Z    | R4 | AU-3 |
| CC 78 |      | Z+1  | R5 |      |
| CC 79 |      | Z+2  |    | AU-4 |
| CC 95 | A-5  |      |    |      |
| CC 96 | A-4  |      |    |      |
| CC 97 | A-3  |      |    |      |
| CC 98 | A-2  |      |    |      |
| CC 99 | A-1  |      |    |      |

# Specification

## Main unit

| Model   | LT-42E10   |  |
|---|--|--|
| Broadcasting systems                                      | Area-1   | B / G / I / D / K / M  |
|   | Area-2   | M / N  |
| Colour systems  | Area-1   | PAL / SECAM / NTSC 3.58 / NTSC 4.43  |
|   | Area-2   | NTSC / PAL-M / PAL-N   |
| Channels and frequencies                                  | Area-1   | VHF low channel (VL) = 46.25 to 140.25 MHz<br>VHF high channel (VH) = 147.25 to 423.25 MHz<br>UHF channel (U) = 431.25 to 863.25 MHz |
|   | Area-2   | VHF low channel (VL) = 55.25 to 127.25 MHz<br>VHF high channel (VH) = 133.25 to 361.25 MHz<br>UHF channel (U) = 367.25 to 801.25 MHz |
|   | Receives cable channels in mid band (X to Z+2, S1 to S10), super band (S11 to S20) and hyper band (S21 to S41) |  |
| Sound-multiplex systems                                   | NICAM (I / B / G / D / K), A2 (B / G / D / K)  |  |
| Teletext systems  | FLOF (Fastext), WST (World System Teletext)  |  |
| Power requirements  | AC 110 V - 240 V, 50/60Hz  |  |
| Audio output<br>(Rated power output)                      | 10 W + 10 W  |  |
| Speakers  | (4 cm x 16 cm) x 2   |  |
| Power consumption<br>[standby]                            | 161 W<br>[1.0 W]   |  |
| Screen size<br>(visible area size<br>measured diagonally) | 106.7 cm   |  |
| Dimensions<br>(W x H x D: mm)<br>[without stand]          | 1014.8 x 698.4 x 296<br>[1014.8 x 646.9 x 108.7]   |  |
| Weights<br>[without stand]                                | 20.5 kg<br>[18.5 kg]   |  |
| Accessories   | Power cord x 1<br>Remote control unit : RM-C2022 x 1<br>AAA/R03 dry cell battery x 2<br>Screw x 8              |  |

## Terminals / Connectors

| Terminal name    | Terminal type | Signal type (IN)                      | Signal type (OUT)  |  |
|------------------|---------------|---------------------------------------|--|--|
| Input terminals  | VIDEO-1       | RCA connectors x 6                    | Composite video, Analogue component 576i (625i) / 480i (525i),<br>Progressive : 576p (625p) / 480p (525p),<br>HD : 1080i (1125i), 720p (750p) / 1080p (1125p)<br>Audio L / R |  |
|                  | VIDEO-2       | RCA connectors x 3                    | Composite video, Audio L / R   |  |
|                  | HDMI-1        | HDMI connector x 1                    | HDMI<br>576i (625i) / 480i (525i) / 576p (625p) / 480p (525p),<br>720p (750p) / 1080p (1125p) / 1080i (1125i)  |  |
|                  | HDMI-2        |                                       |  |  |
|                  | HDMI-3        |                                       |  |  |
|                  | IN HDMI -1    | RCA connectors x 2                    | Audio L/R  |  |
|                  | PC INPUT      | D-SUB (15 pins) x 1                   | Analogue PC signal   |  |
|                  | PC AUDIO      | PC-IN (3.5 pin jack) x 1              | Audio  |  |
|                  | Microphone    | mini-jack x 1<br>(3.5 mm in diameter) | Microphone input   |  |
| Output terminals | MONITOR OUT   | RCA connectors x 3                    | Subwoofer,<br>Audio L / R  |  |

- We may change the design and specifications without notice.
- HDMI, the HDMI Logo, and High-Definition Multimedia Interface are trademarks or registered trademarks of HDMI Licensing LLC in the United States and other countries.

# JVC