

The Insignia logo, featuring the word "INSIGNIA" in a bold, dark blue, sans-serif font. A small white semi-circle is positioned below the letter "I".

## 40"/46" 1080p LED-LCD HDTV

# QUICK SETUP GUIDE

NS-40E560A11/NS-46E560A11

# Thank You

for purchasing this fine Insignia television.  
We hope you enjoy the quality and reliability  
of this product for years to come.

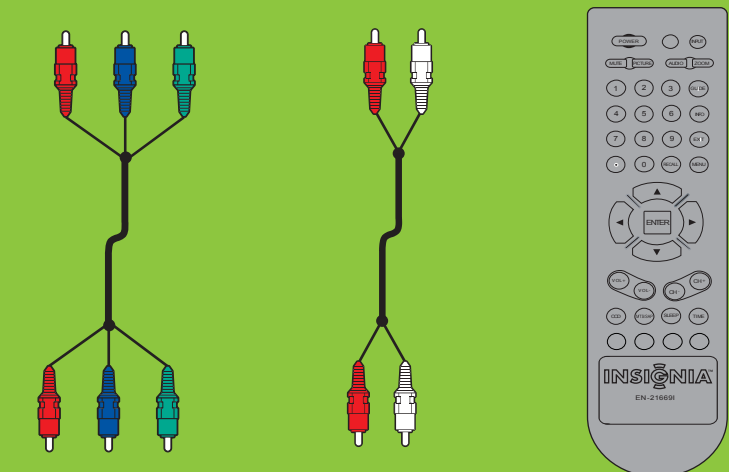

## Component cable

## Audio cable

Remote control  
and 2 AAA  
batteries

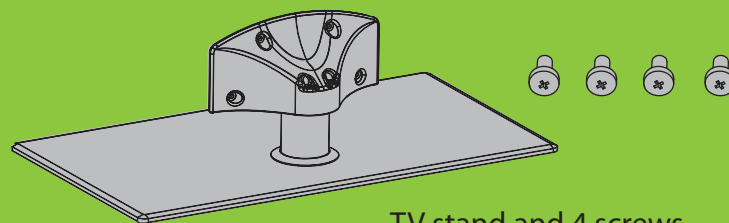

TV stand and 4 screws

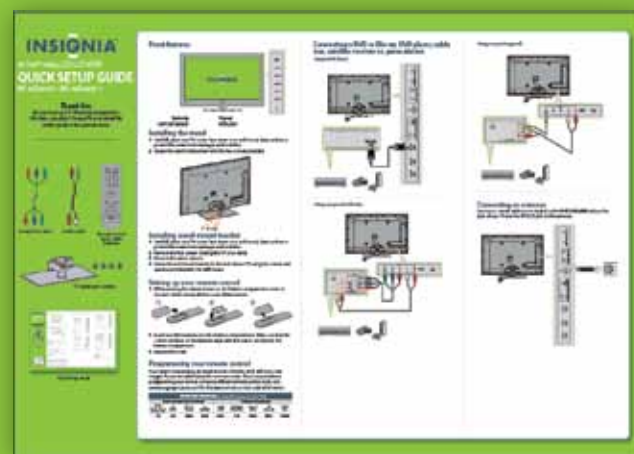

## Quick Setup Guide





## Front features



## Remote control sensor

Power indicator

**Note:**

To turn on your TV using the  (power) button on your TV, press  twice. The presses must be within five to seven seconds of each other. The first time you press , the button labels appear on the screen. The second time you press , your TV turns on.

## Installing the stand

- 1 Carefully place your TV screen face-down on a cushioned, clean surface to protect the screen from damages and scratches.
- 2 Secure the stand to the screen with the four screws provided.

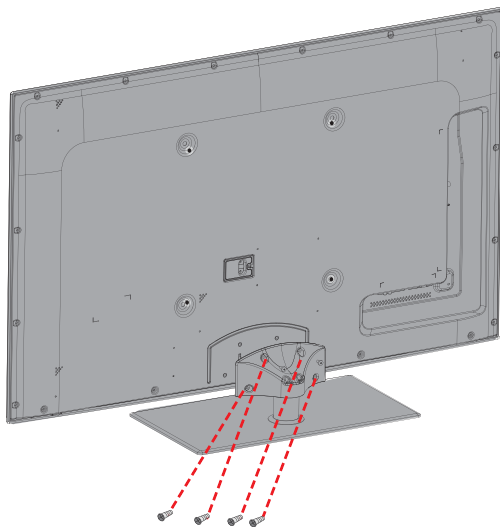

## Installing a wall-mount bracket

- 1 Carefully place your TV screen face-down on a cushioned, clean surface to protect the screen from damages and scratches.
- 2 Remove the four screws holding the TV to its stand.
- 3 Remove the stand column.
- 4 Secure the wall-mount bracket to the back of your TV using the screws and spacers provided with the wall mount.

## Setting up your remote control

- 1 While pressing the release button on the battery compartment cover on the back of the remote, lift the cover off the remote.

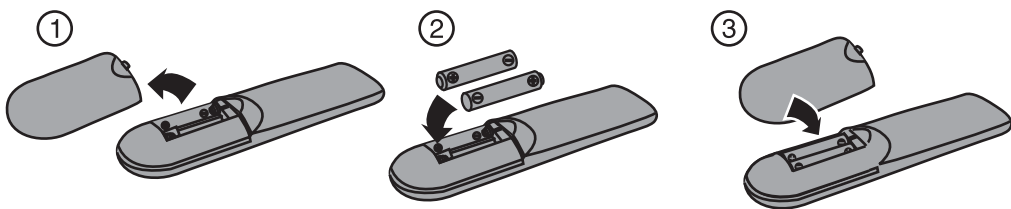

- 2 Insert two AAA batteries into the battery compartment. Make sure that the + and – symbols on the batteries align with the + and – symbols in the battery compartment.
- 3 Replace the cover.

## Programming your remote control

To program your existing universal remote control to work with your new Insignia TV, see the table below for common codes. If you have problems programming your remote or need a different remote control code, visit [www.insigniaproducts.com](http://www.insigniaproducts.com) for the latest remote control code information.

## Connecting a DVD or Blu-ray DVD player, cable box, satellite receiver or, game station

### Using HDMI (best)

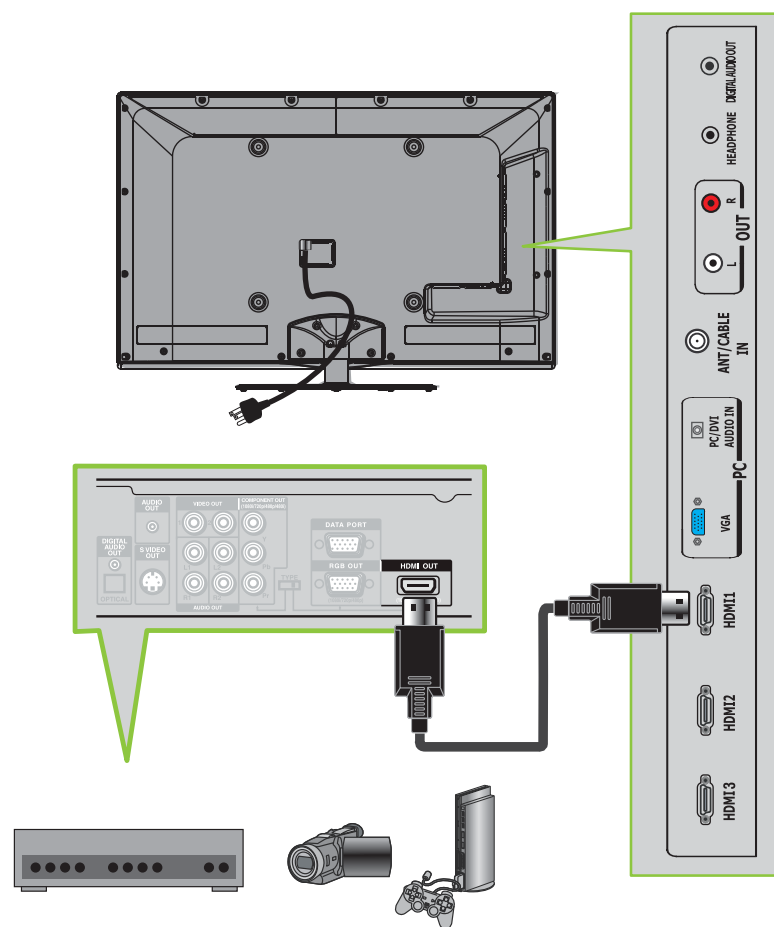

### Using component (better)

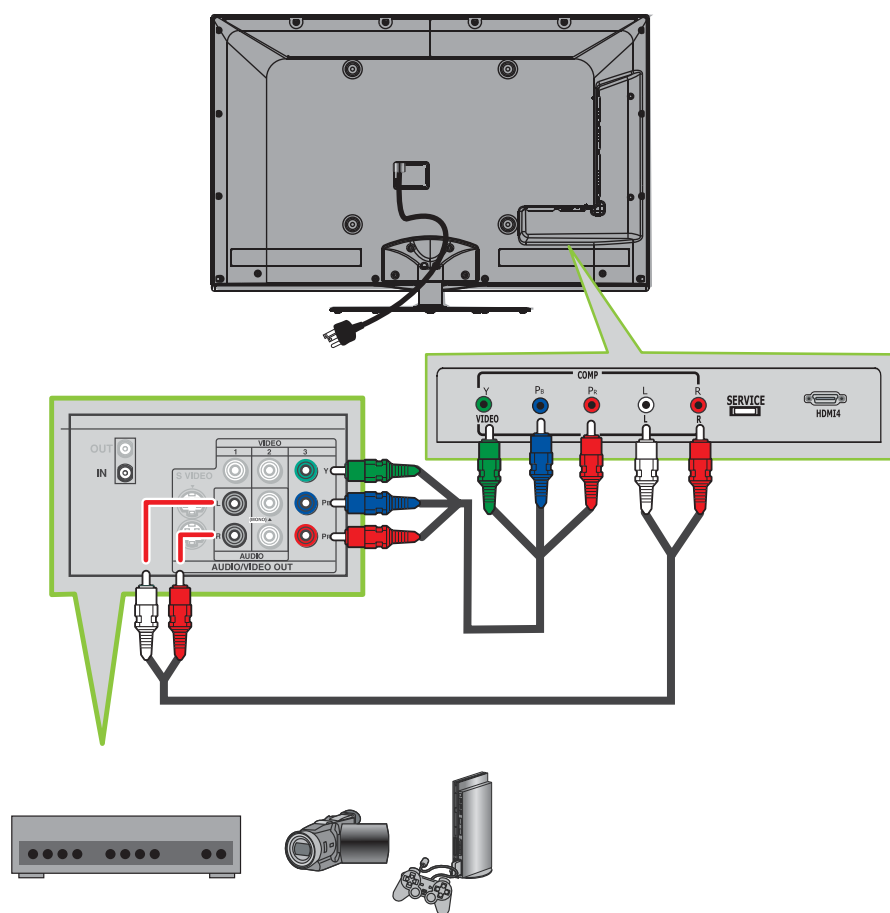

### Using composite (good)

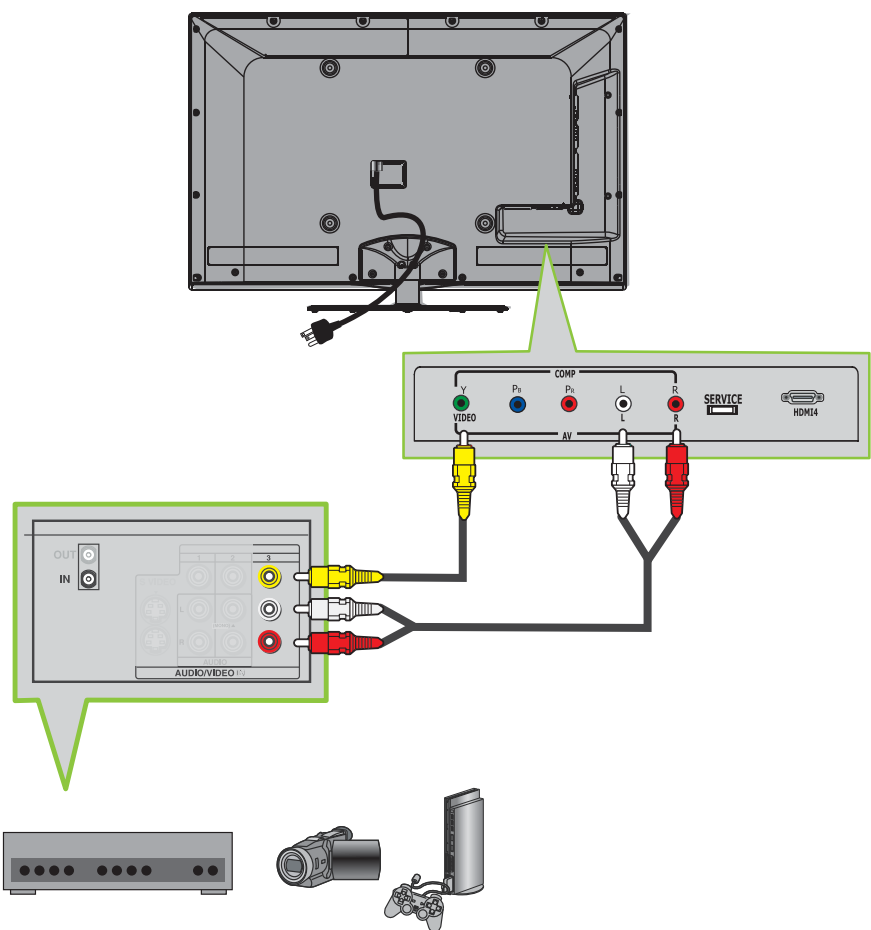

## Connecting an antenna

Connect a coaxial cable (not included) to the **ANT/CABLE IN** jack on the back of your TV and the RF OUT jack on the antenna.

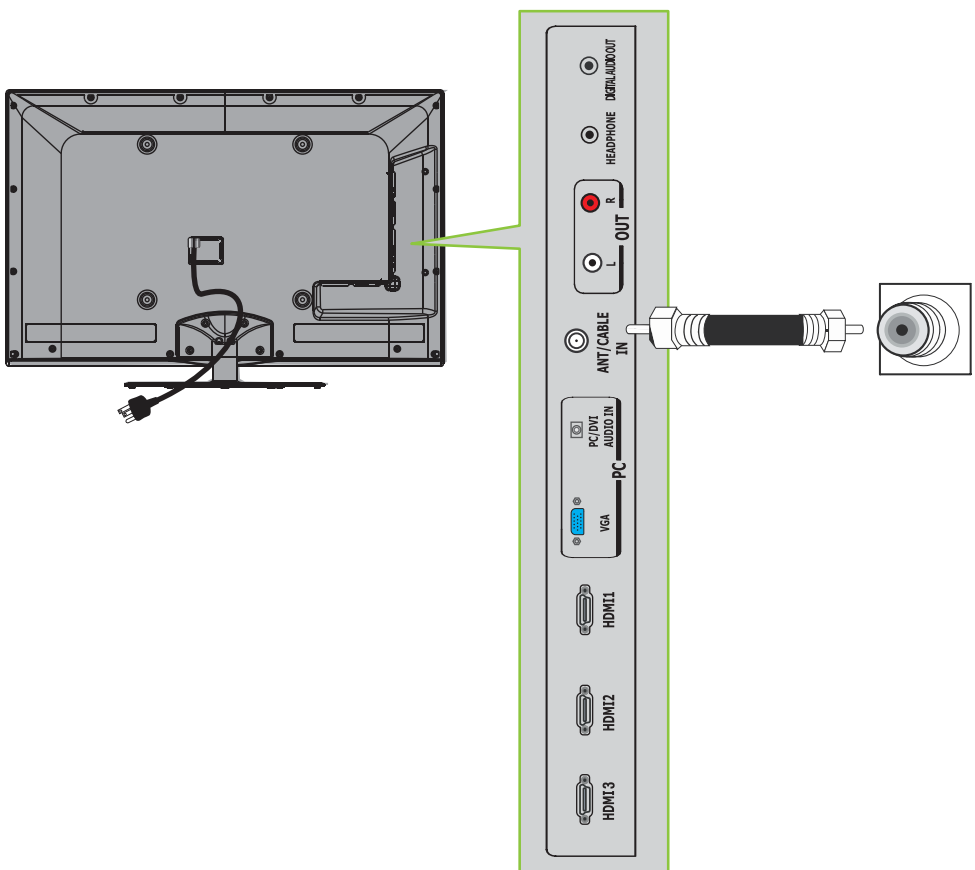

## Connecting a Home Theater System

Using digital audio

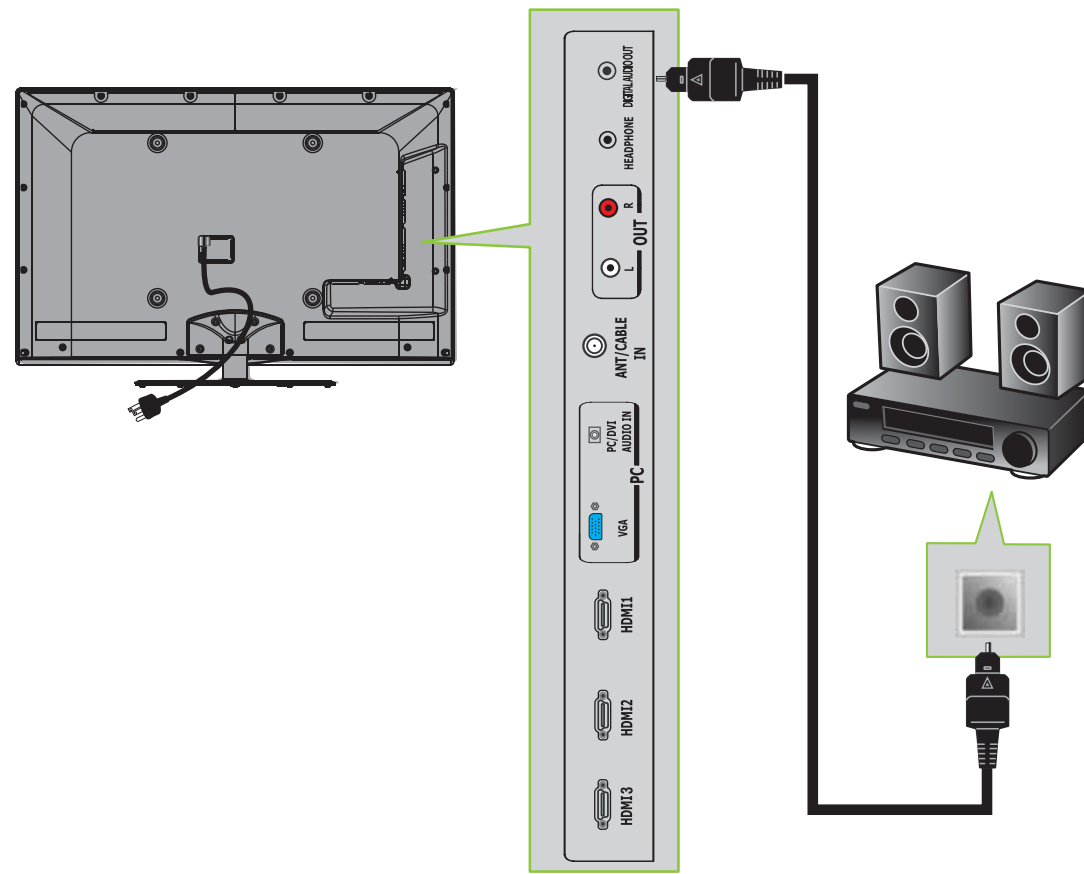

## Connecting power

Plug the AC power cord into a power outlet.

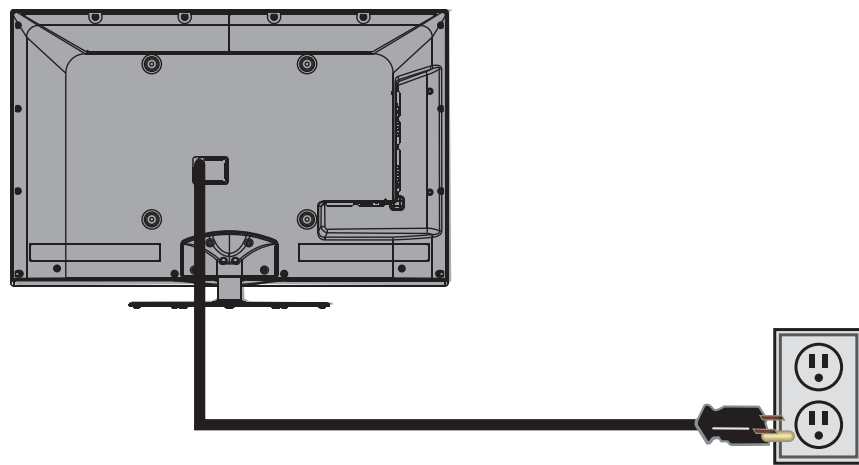

## Turning on your TV for the first time

- 1 Connect the power cord to a power outlet, then press **POWER** (power) on the remote control. The power indicator blinks red, then turns off and the *Choose your menu language* screen opens.
- 2 Press **▲** or **▼** to highlight the language you want, then press **ENTER**. The *Choose your TV Picture Mode* screens opens.
- 3 Press **▲** or **▼** to highlight **Home Mode** (recommended) or **Retail Mode**, then press **ENTER**. If Home Mode is selected, the *Choose your TV source* screen opens.
- 4 Press **▲** or **▼** to highlight the TV signal source you want, then press **ENTER**. If you chose **Antenna** or **Cable**, your TV automatically scans for channels.  
Note: To stop the auto channel search, press **EXIT**.
- 5 To watch TV, press the TV input source button on your remote control.

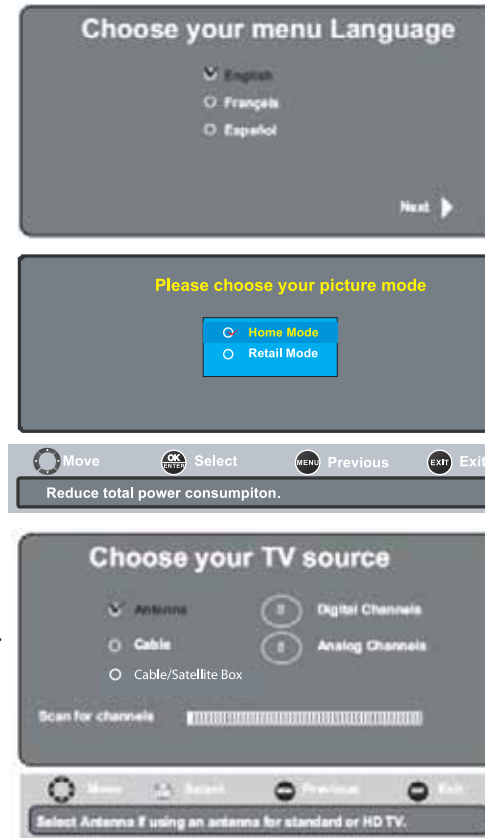

## Setting time and date

- 1 Press **MENU**. The on-screen menu opens.
- 2 Press **▲** or **▼** to highlight **SETTINGS**, then press **ENTER** to open the *Settings* menu.
- 3 Press **▲** or **▼** to highlight **Time**, then press **ENTER**. The *Settings-Time Settings* menu opens.  
From this menu, you can:  
Set the date and time  
Set Time Zone.  
Set Sleep Timer.



## Selecting the video input source

- Press **INPUT**, press **▲** or **▼** to highlight a source, then press **ENTER**. You can also press **INPUT** cycle directly.

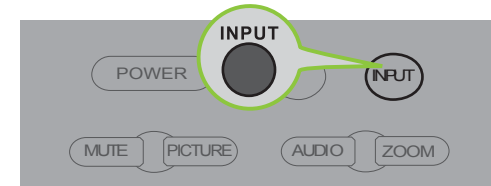
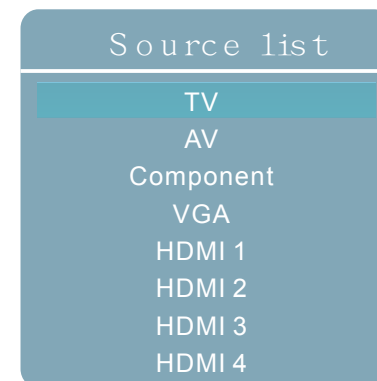

## Adjusting the volume

- Press **VOL+** or **VOL-** to change the volume.
- Press **MUTE** to turn off the sound.

## Selecting a channel

- To move to a different channel in the channel list, press **CH+** or **CH-**.  
OR
- Enter the channel number directly using the number buttons.

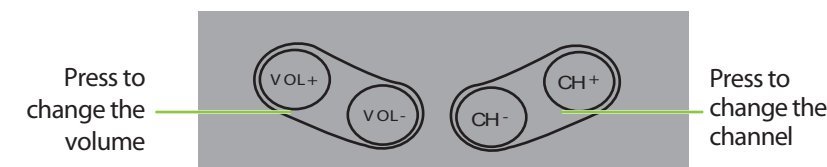

## Viewing channel information

- Press **INFO** to view an information banner. The information banner shows the current program information such as channel number, video input source, and resolution.
- Digital mode information—Displays the channel number, station name, channel label, broadcast program name, TV rating, signal type, audio information, resolution, CC mode, current time, and current program start and end times.
- Analog mode information—Displays channel number, channel label (if preset), signal type, audio information, and resolution.
- Press **GUIDE** to show the digital program guide, which may view a list of available programs, program times, and program summaries, depending on the information provided by the broadcaster.



## On-screen menu overview

### PICTURE menu (TV mode)

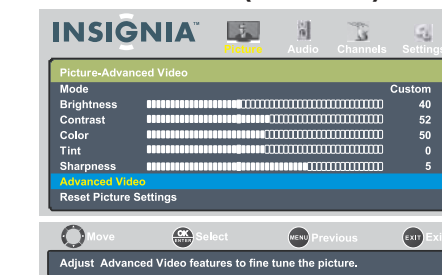

### AUDIO menu (TV mode)

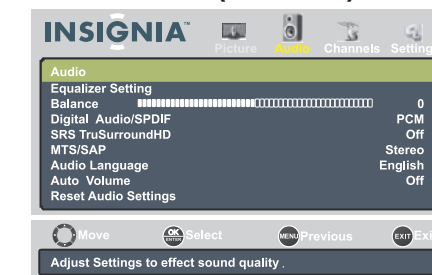

### CHANNEL menu (TV mode)



### SETTINGS menu (TV mode)

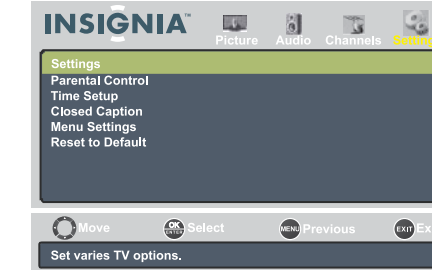

## Navigating menus with your remote control

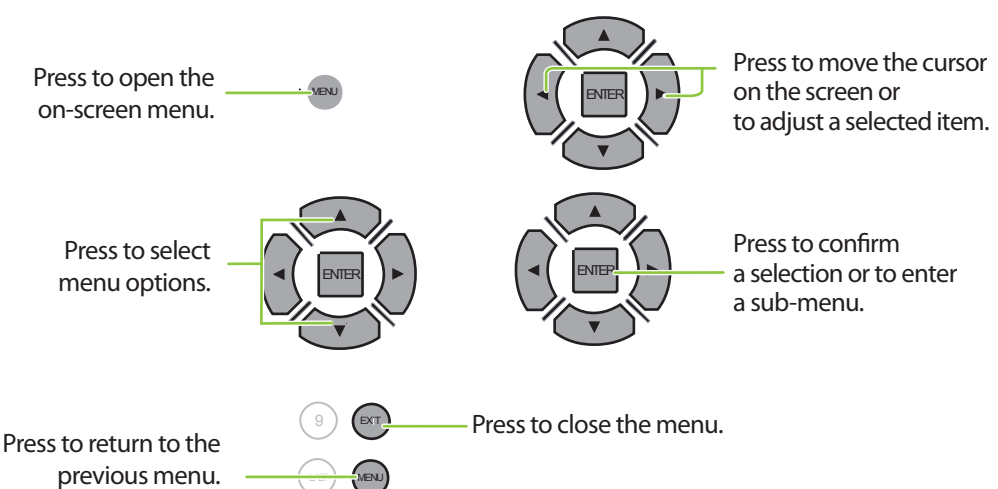

# INSIGNIA™

## Two-year limited warranty

See your *User Guide* or visit [www.insigniaproducts.com](http://www.insigniaproducts.com) for details.

## Need additional help?

See your *User Guide*! This comprehensive guide includes everything from basic how-to steps to more advanced features. Check out our **online community forum** at [www.insigniaproducts.com](http://www.insigniaproducts.com) for helpful information from other Insignia TV owners.

## We're here for you

[www.insigniaproducts.com](http://www.insigniaproducts.com)

For customer service, call:

**877-467-4289 (U.S./Canada markets)**

**01 800-926-3000 (Mexico market)**

Distributed by Best Buy Purchasing, LLC  
7601 Penn Avenue South, Richfield, MN USA  
55423-3645

Best Buy Imports, S. de R.L. de C.V. Av. Santa Fe 485,  
Segundo Piso, Colonia Cruz Manca, Programa Parcial de  
Desarrollo Santa Fe, Delegación Cuajimalpa, Distrito  
Federal, México 05349

RFC#BBI0802114Q2

© 2010 BBY Solutions, Inc.

All rights reserved. INSIGNIA is a trademark of BBY Solutions, Inc. Registered in some countries. All other products and brand names are trademarks of their respective owners.