

46" LCD TV 1080p

QUICK SETUP GUIDE

DX-46L261A12

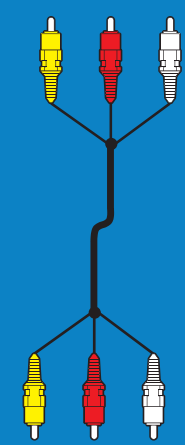

Composite cable

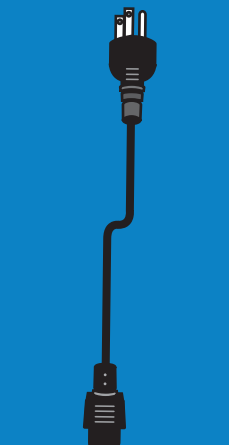

AC power cord



Remote control and 2 AAA batteries

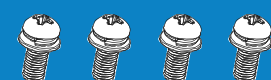

TV stand and 4 screws (M5, 8 mm)

Front features

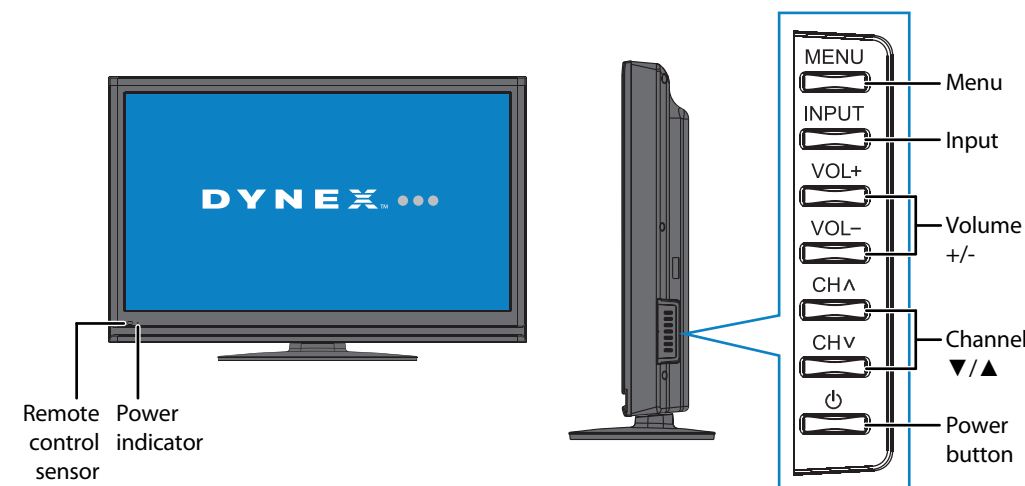

Installing the stand

- 1 Carefully place your TV screen face-down on a cushioned, clean surface to protect the screen from damages and scratches.
- 2 Align the stand to the TV and secure it to the stand column with the screws provided.

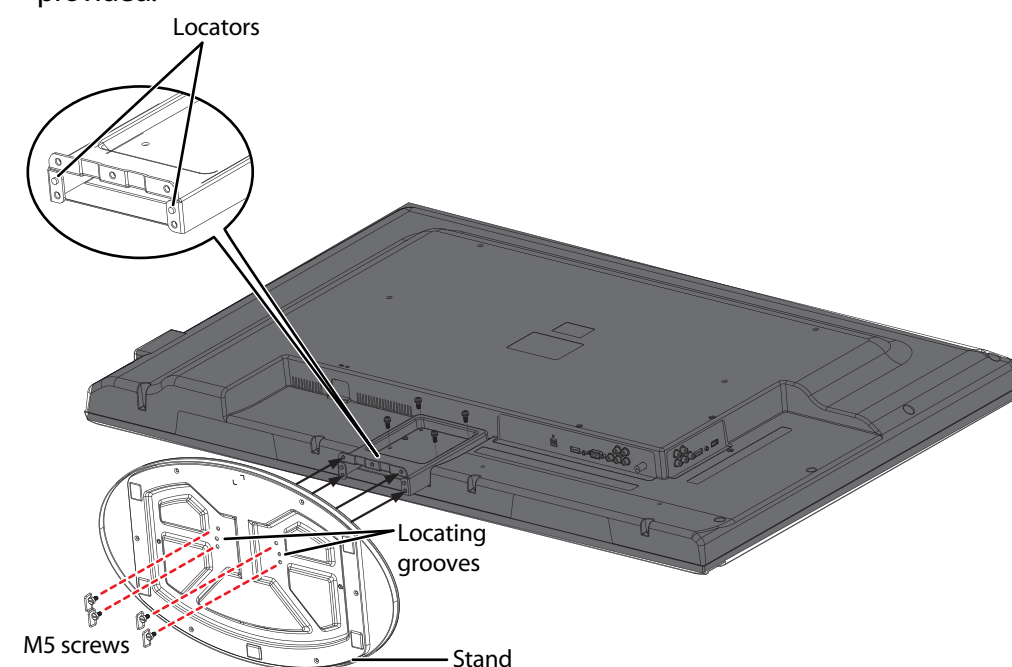

Installing a wall-mount bracket

- 1 Carefully place your TV screen face-down on a cushioned, clean surface to protect the screen from damages and scratches.
- 2 Remove the screws that secure the base to the stand, then remove the base.
- 3 Remove the screws that secure the stand column, then remove the column.
- 4 Attach the wall-mount bracket to your TV using the mounting holes on the back of your TV. See the instructions that came with the wall-mount bracket for information about how to correctly hang your TV.

Warning

This apparatus is intended to be supported by a UL Listed wall mount bracket.

Identifying cables

Your TV has several connection types for connecting devices. For the best video quality, connect a device to the best available connection.

| Connection type | Video quality | Cable connector |
|----------------------------------|---------------|-----------------|
| HDMI video/audio | Best | |
| OR | | |
| Component video and analog audio | Better | |
| OR | | |
| Composite video and analog audio | Good | |

You can use an HDMI jack to connect a DVI device to your TV. You need to attach an HDMI-to-DVI adapter to the end of the HDMI cable that connects to the DVI device's jack.

Connecting a DVD or Blu-ray DVD player, cable box, satellite receiver, or game station

Using HDMI (best)

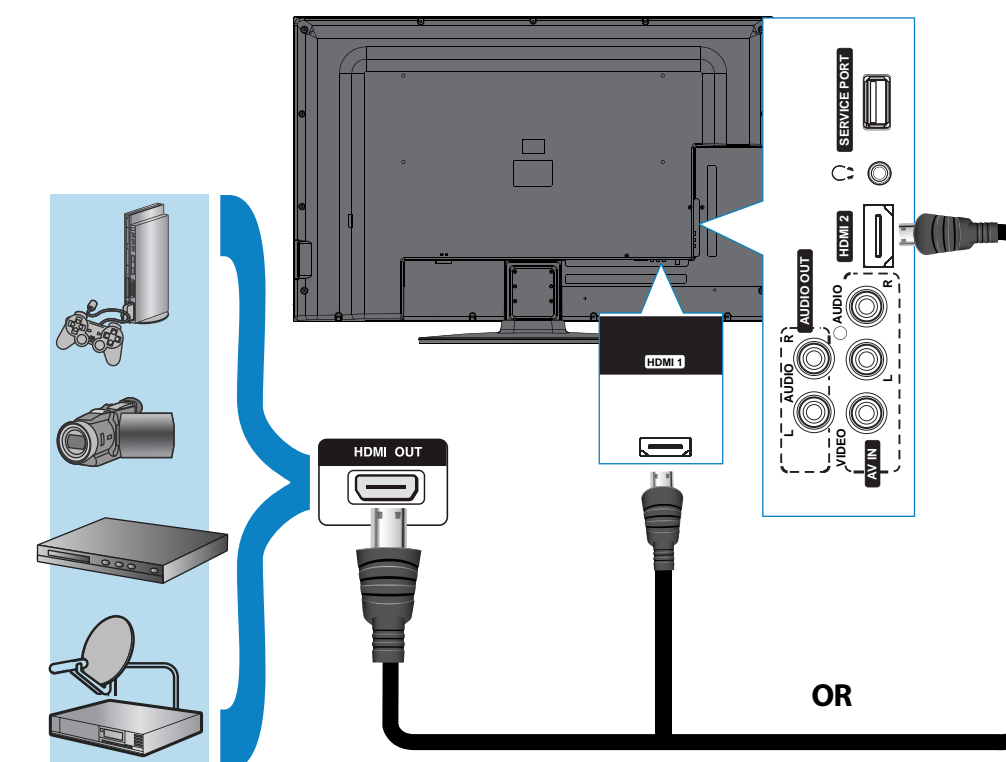

Using component cables (better)

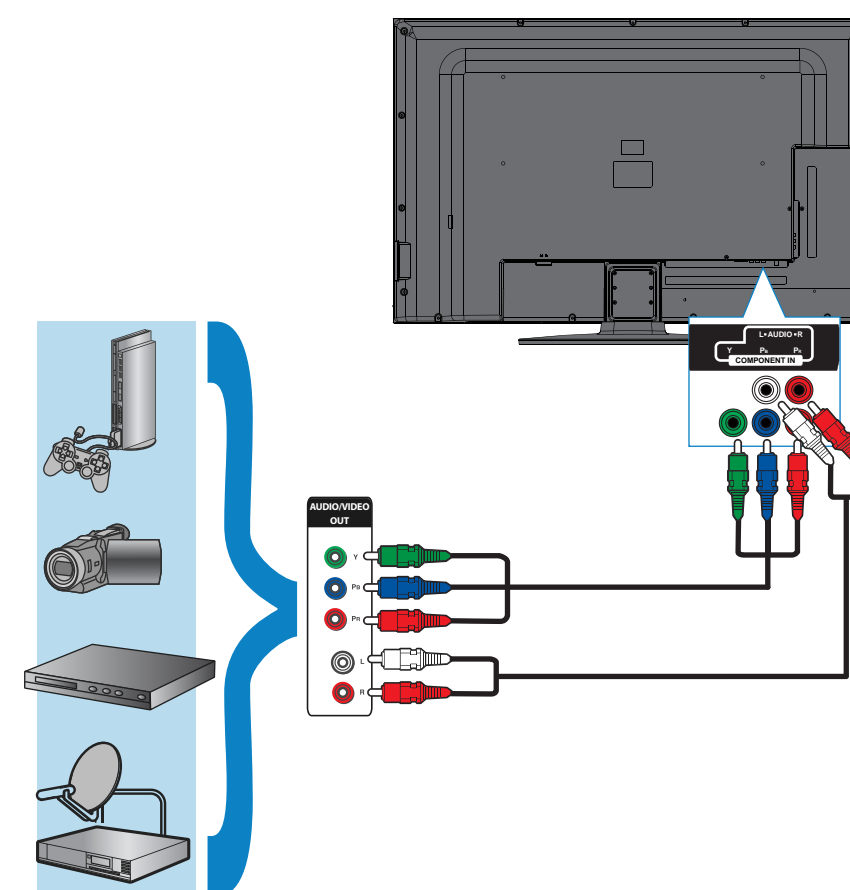

Using composite cables (good)

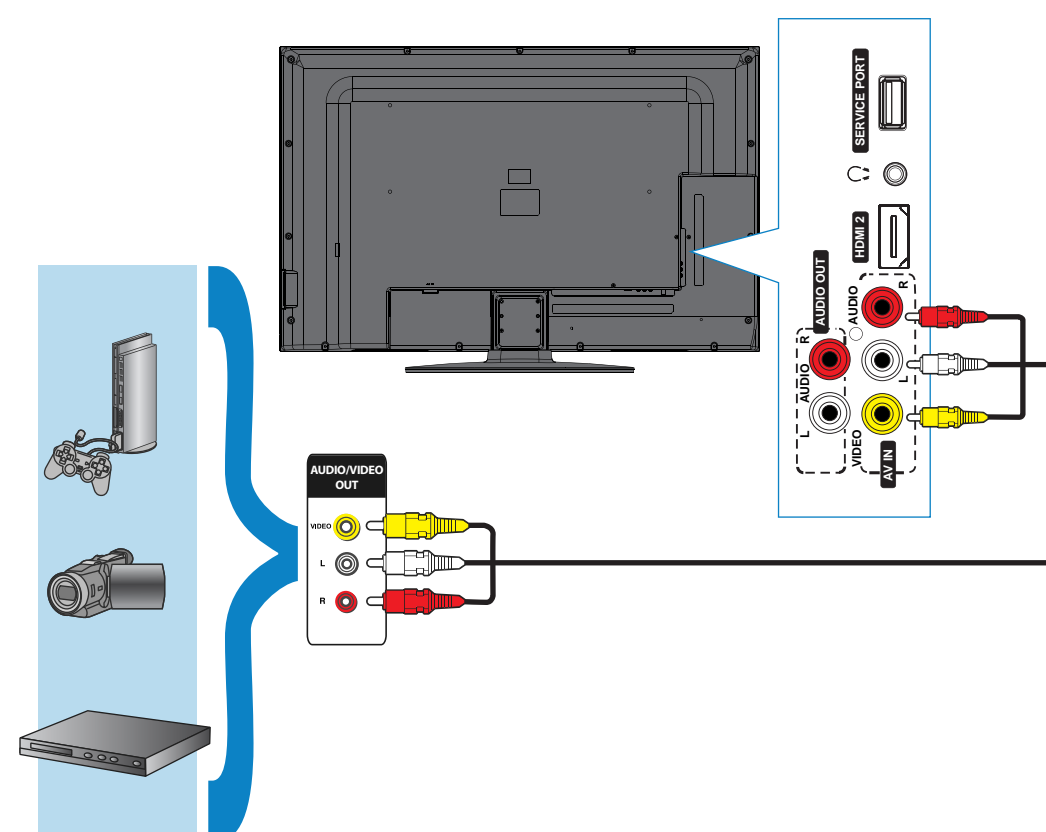

Connecting an antenna/cable wall jack

Connect a coaxial cable (not included) to the ANT/CABLE IN jack on the back of your TV and to the Antenna/Cable wall jack.

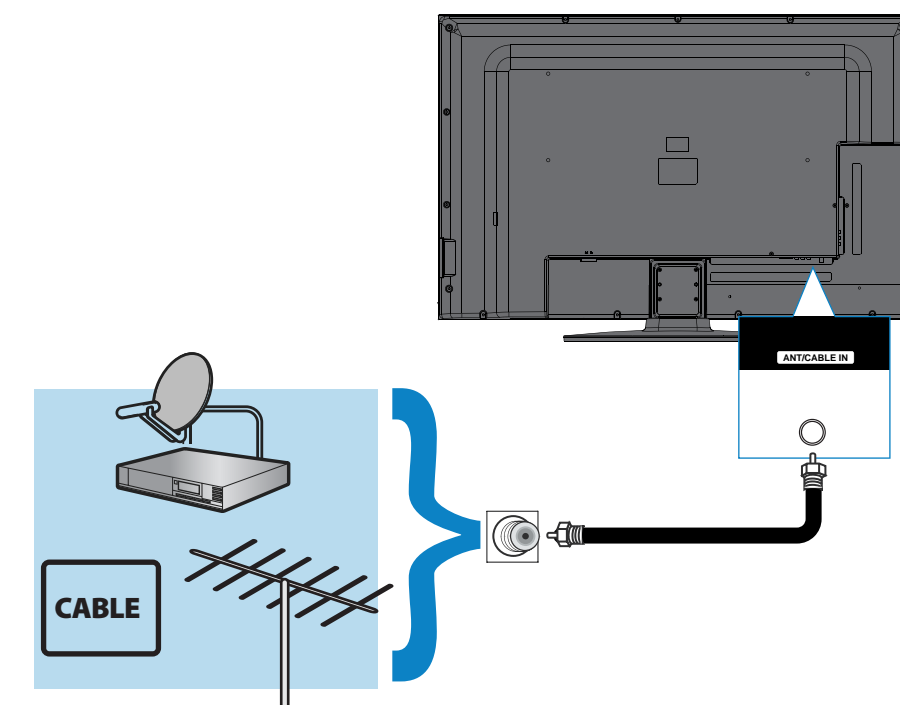

Connecting a Home Theater System

Using Digital Optical audio

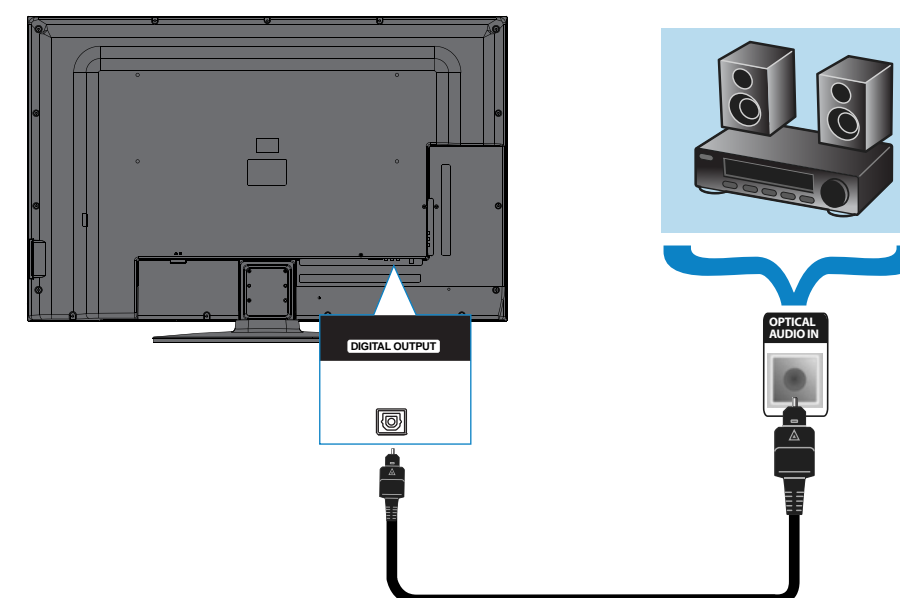

Using Analog audio

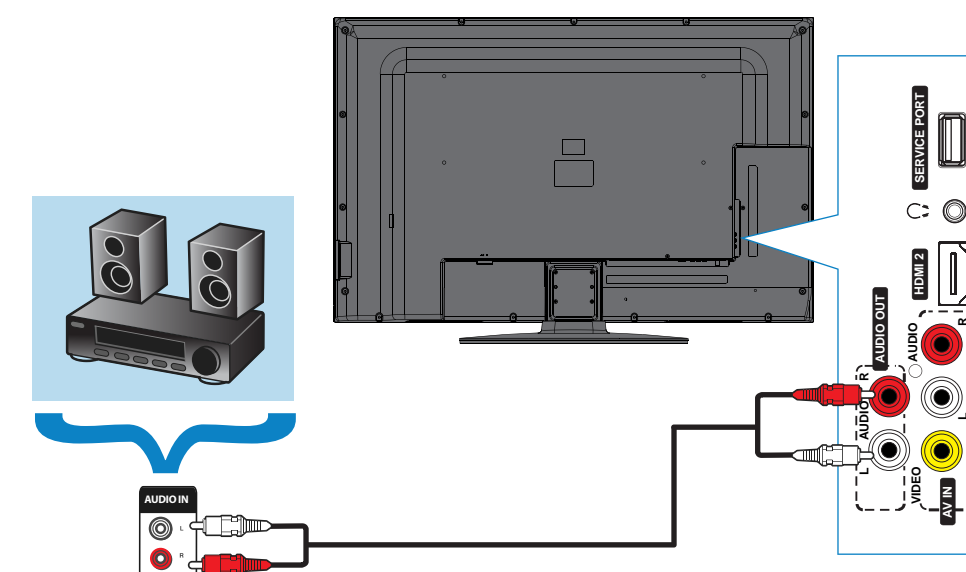

Connecting a home theater system with multiple devices

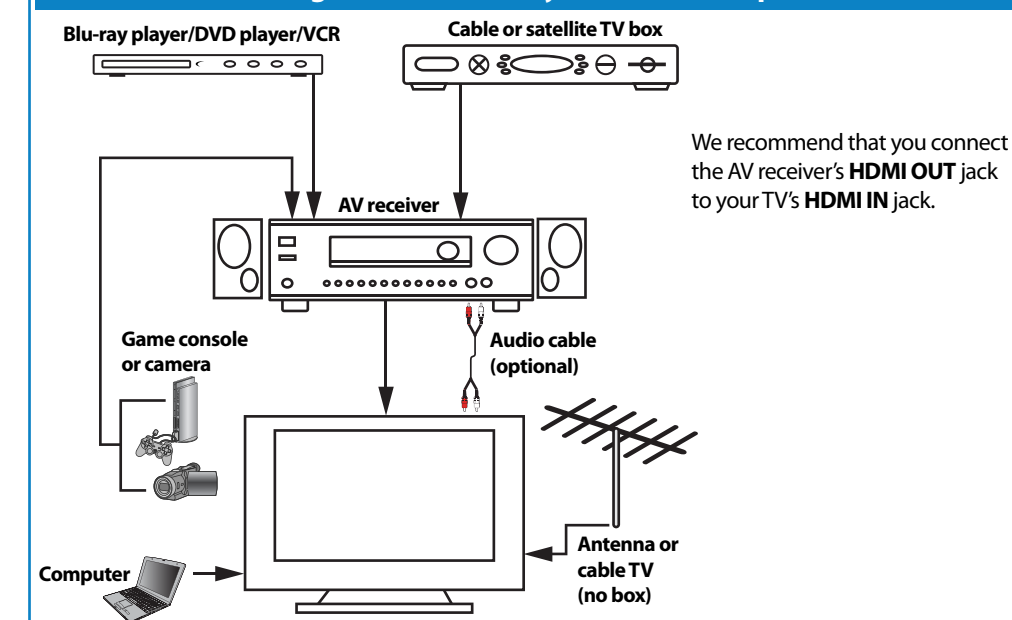

Setting up and using your remote control

- 1 Press the release button on the back of the remote to remove the battery compartment cover.
- 2 Insert two AAA batteries into the battery compartment. Make sure that the + and - symbols on the batteries match the + and - symbols in the battery compartment.
- 3 Replace the cover.

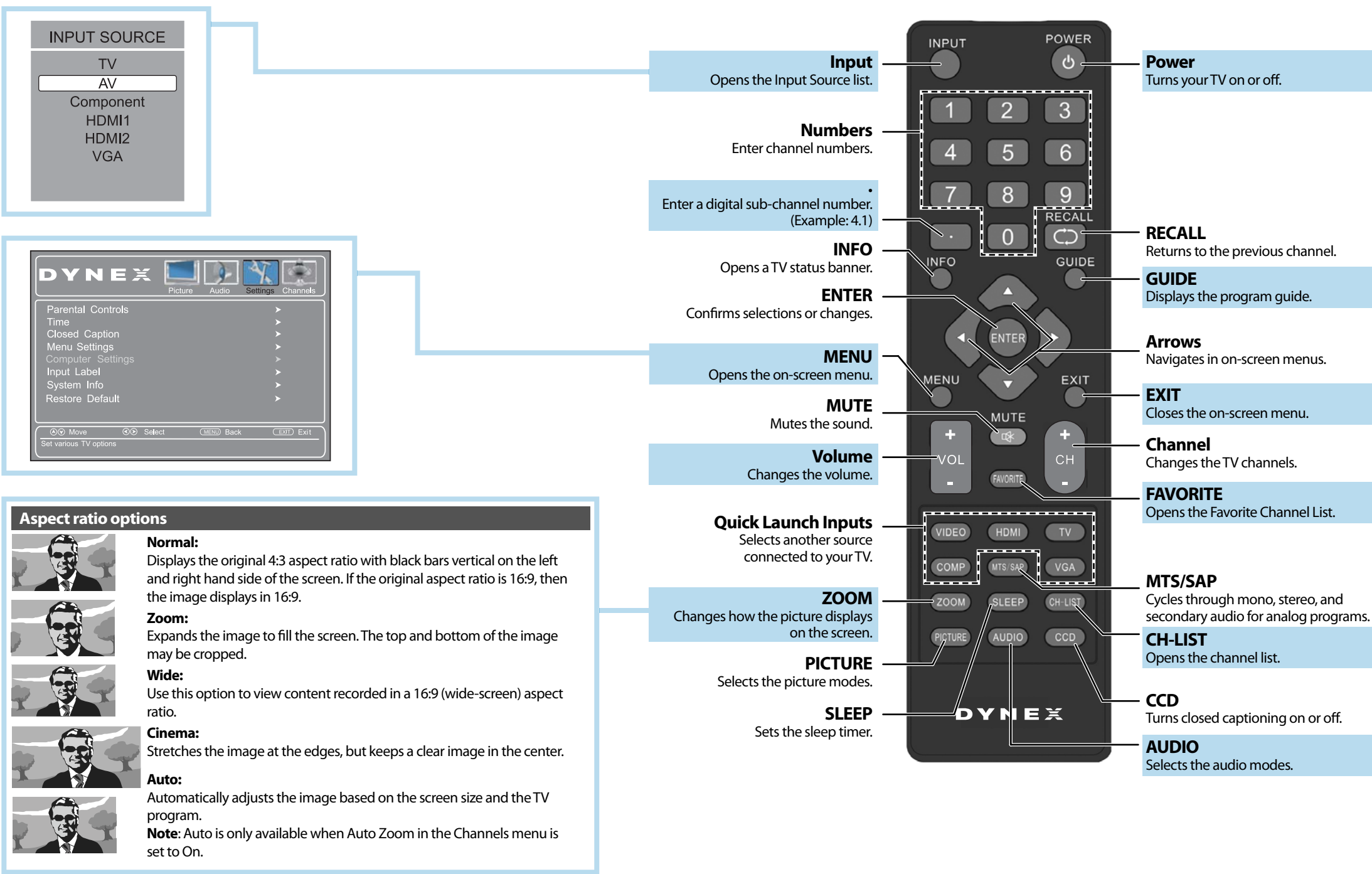
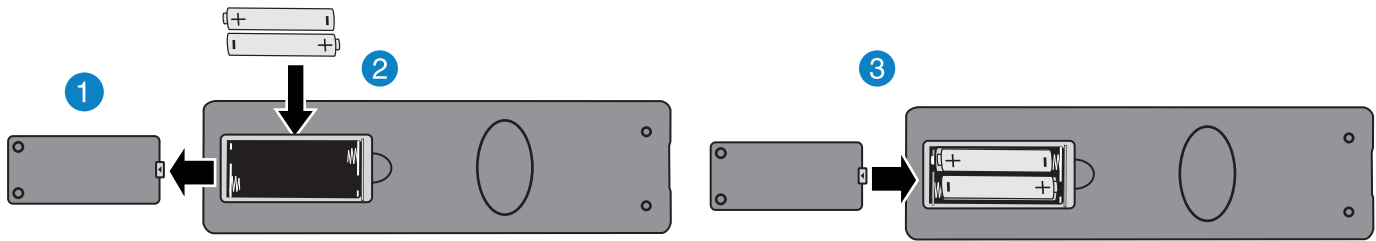

Programming your remote control

To program your universal remote control to work with your new Dynex TV, see the table for common codes. If you have problems programming your remote or need a different remote control code, visit <http://www.dynexproducts.com/remotecodes> for the latest remote control code information.

| Universal remote TV codes | | | | | | | | | | | | |
|---------------------------|------------|-----|---|---|---|---|------------|--|--------------|---------------------------------------|------|------------|
| Universal remote controls | | | | Cable/Satellite/Set-top box | | | | | | | | |
| One for All | Philips | RCA | Sony | Cablevision | Charter | Comcast | Cox | DirectTV | Dish Network | Time Warner | TiVo | Verizon |
| 0054 | 0198, 0490 | 135 | 068, 069, 078, 096, 100, 164, 168, 229, 026 | 068, 069, 078, 096, 100, 164, 168, 229, 026 | 2002, 1204, 1423, 1517, 0171, 1963, 0463, 1463, 0842, 1326, 167, 415, 424, 450, 456, 461, 507, 523, 567, 577, 586 | 10171, 11204, 11326, 11463, 11517, 11641, 11780, 11785, 11892, 11963, 12002 | 1326, 1463 | 10171, 11204, 11326, 11517, 11564, 11641, 11963, 12002 | 720 | 400, 450, 461, 456, 10463, 1463, 0463 | 0091 | 0198, 0490 |

Connecting power

Plug the AC power cord into the **AC IN** jack on the back of your TV, then plug the other end of the cord into a power outlet.

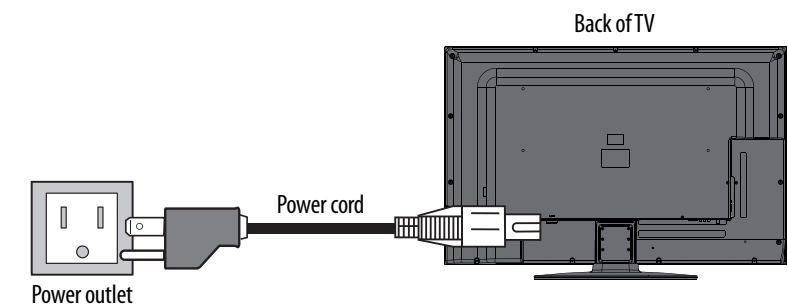

Turning on your TV for the first time

- 1 Connect the power cord to your TV and to a power outlet, then press **Power**. The *Choose Your Menu Language* screen opens.
- 2 Press **Up** or **Down** to highlight a language, then press **ENTER**. The *Choose Your Time Setting* screen opens with Mode highlighted.
- 3 Press **Left** or **Right** to select **Auto** or **Manual**. If you select **Auto**, the date and time are set automatically from a digital TV signal. If you select **Manual**, you can manually set the date and time. Press **ENTER**. The *Choose Your Picture Mode* screen opens.
- 4 Press **Up** or **Down** to highlight **Home Mode** or **Retail Mode**, then press **ENTER**. If you select **Retail Mode**, a message asks you to confirm your selection. Select **Yes** or **No**. **Retail Mode** is not an energy-saving mode. The *Choose Your TV Source* screen opens.
- 5 Press **Up** or **Down** to highlight **Antenna**, **Cable**, or **Cable/Satellite box**. If you select **Antenna** or **Cable**, your TV scans for available channels. The scan may take several minutes. **If you select Cable/Satellite box, your TV does not scan for channels.**
- 6 To watch TV, press **TV** on the remote control.

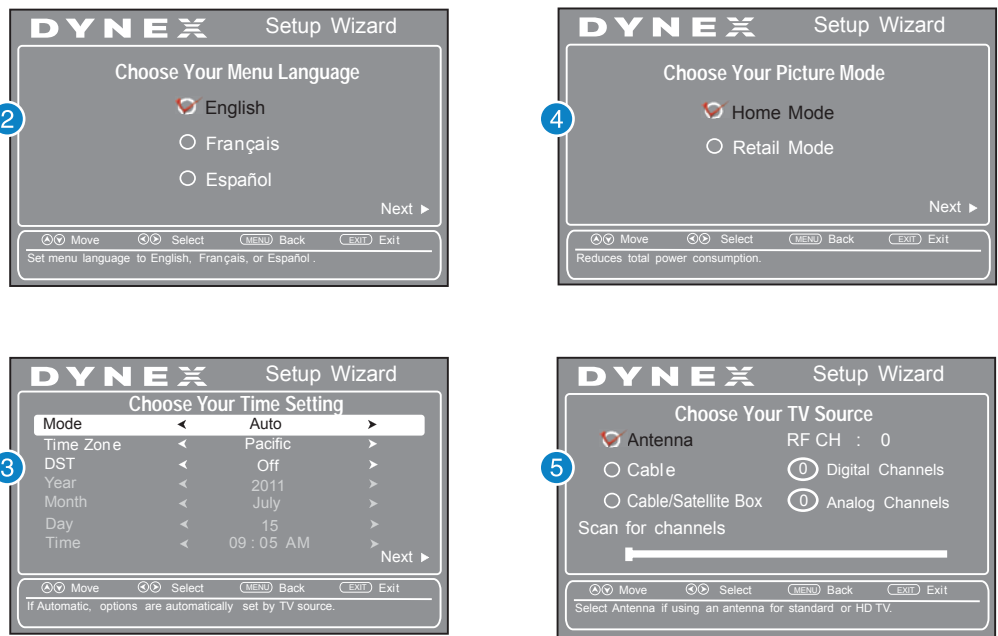

DYNEX

One-year limited warranty

Visit www.dynexproducts.com for details.

Need additional help?

See your **User Guide**! This comprehensive guide includes everything from basic how-to steps to more advanced features. Go to www.dynexproducts.com, click **Support & Service**. Enter your model number in the **Search** field, then press **Enter**. Click **Support/Downloads**.

We're here for you

www.dynexproducts.com
For customer service, call:
800-305-2204 (U.S./Canada markets)

Distributed by Best Buy Purchasing, LLC
7601 Penn Avenue South, Richfield, MN USA 55423-3645
© 2011 BBY Solutions, Inc., All Rights Reserved.
DYNEX is a trademark of BBY Solutions, Inc. Registered in some countries. All other products and brand names are trademarks of their respective owners.

WE ARE GOING GREEN!

A copy of your *User Guide* is not provided in the box but is available online.

Go to www.dynexproducts.com, click **Support & Service**. Enter your model number in the **Search** field, then press **Enter**. Click **Support/Downloads**.



ENGLISH 11-0313