

24" LED-LCD TV QUICK SETUP GUIDE

DX-24E150A11

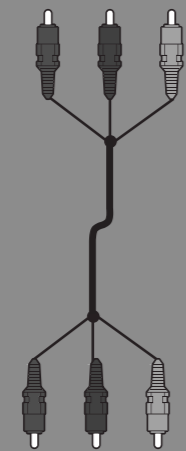

Remote control and 2 AAA batteries



Composite video cable



TV stand and screws

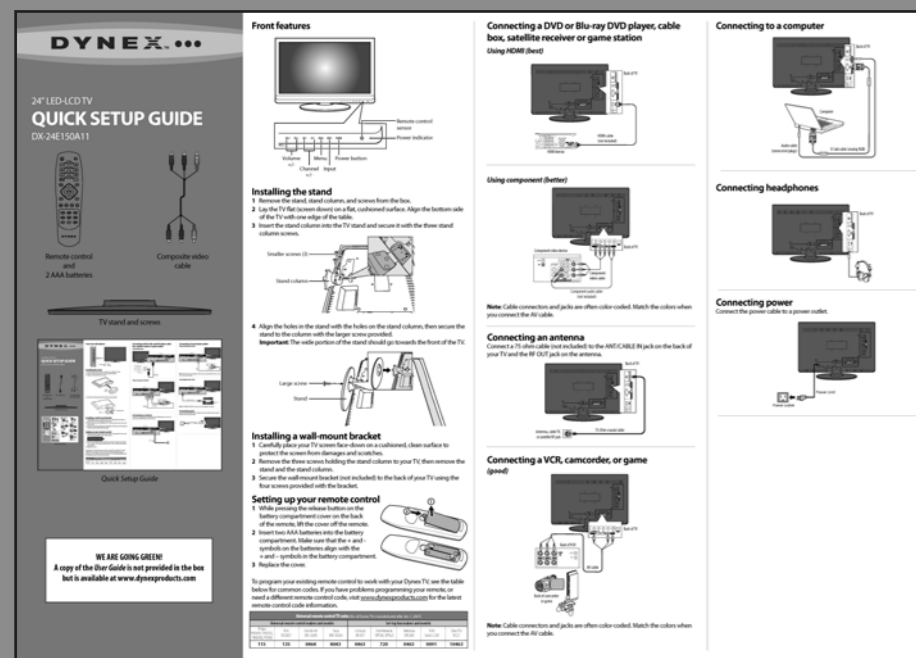

Quick Setup Guide

WE ARE GOING GREEN!
A copy of the *User Guide* is not provided in the box but is available at www.dynexproducts.com

Front features

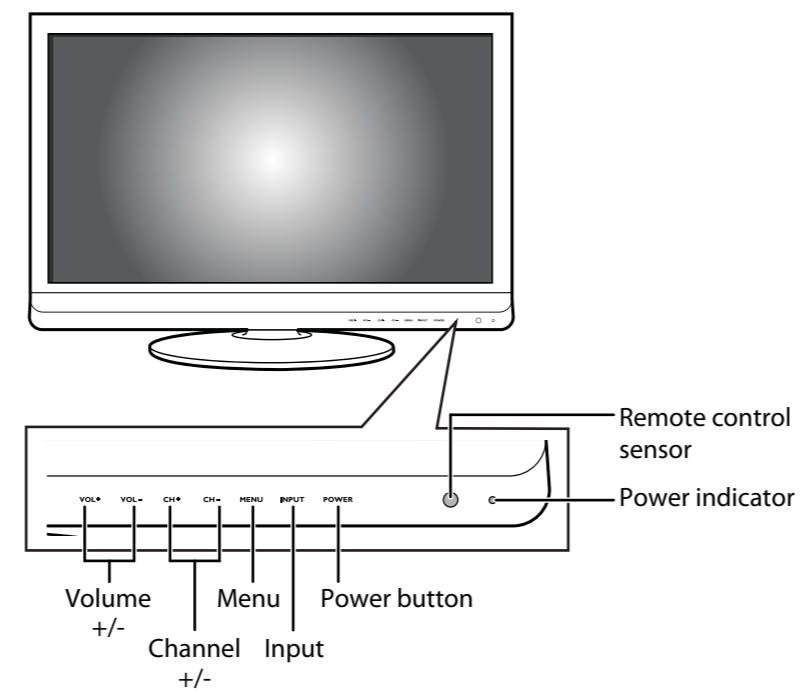

Installing the stand

- 1 Remove the stand, stand column, and screws from the box.
- 2 Lay the TV flat (screen down) on a flat, cushioned surface. Align the bottom side of the TV with one edge of the table.
- 3 Insert the stand column into the TV stand and secure it with the three stand column screws.

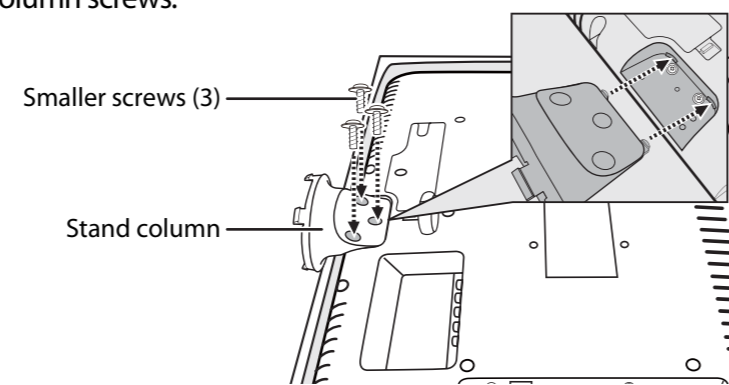

- 4 Align the holes in the stand with the holes on the stand column, then secure the stand to the column with the larger screw provided.
- Important:** The wide portion of the stand should go towards the front of the TV.

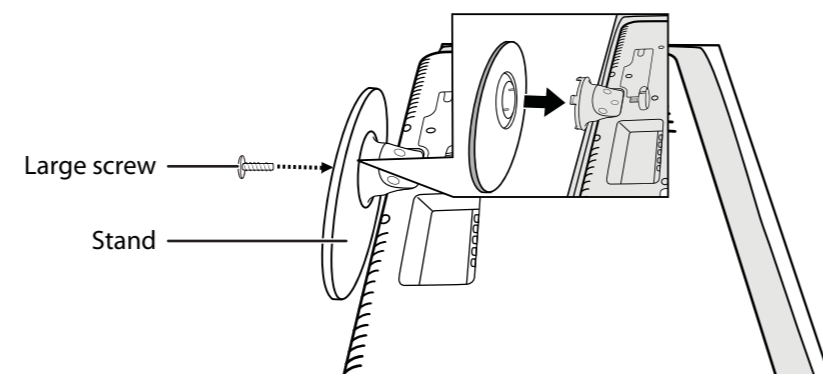

Installing a wall-mount bracket

- 1 Carefully place your TV screen face-down on a cushioned, clean surface to protect the screen from damages and scratches.
- 2 Remove the three screws holding the stand column to your TV, then remove the stand and the stand column.
- 3 Secure the wall-mount bracket (not included) to the back of your TV using the four screws provided with the bracket.

Setting up your remote control

- 1 While pressing the release button on the battery compartment cover on the back of the remote, lift the cover off the remote.
- 2 Insert two AAA batteries into the battery compartment. Make sure that the + and - symbols on the batteries align with the + and - symbols in the battery compartment.
- 3 Replace the cover.

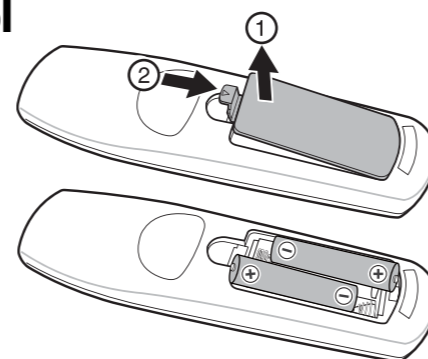

To program your existing remote control to work with your Dynex TV, see the table below for common codes. If you have problems programming your remote, or need a different remote control code, visit www.dynexproducts.com for the latest remote control code information.

Universal remote control TV codes (for all Dynex TVs manufactured after Jan. 1, 2007)										
Universal remote control makers and models				Set-top box makers and models						
Philips PHDV05, PH1SD55, PMDV08, PDV08	RCA RCU807	One for All URC-6690	Sony RM-VL600	Comcast M1057	Dish Network VIP508, VIP622	Motorola DRC800	TIVO Series 3, HD	DirectTV RC23		
115	135	0464	8043	0463	720	0463	0091	10463		

Connecting a DVD or Blu-ray DVD player, cable box, satellite receiver or game station

Using HDMI (best)

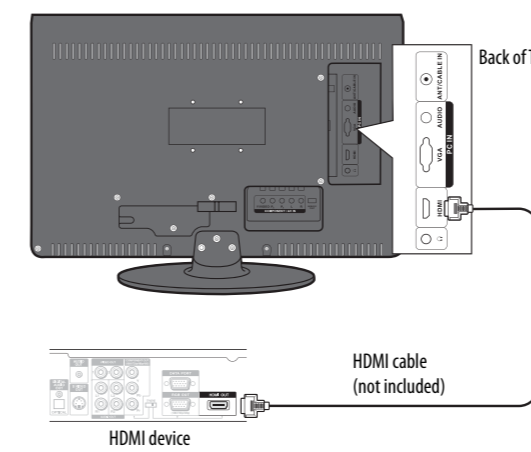

Using component (better)

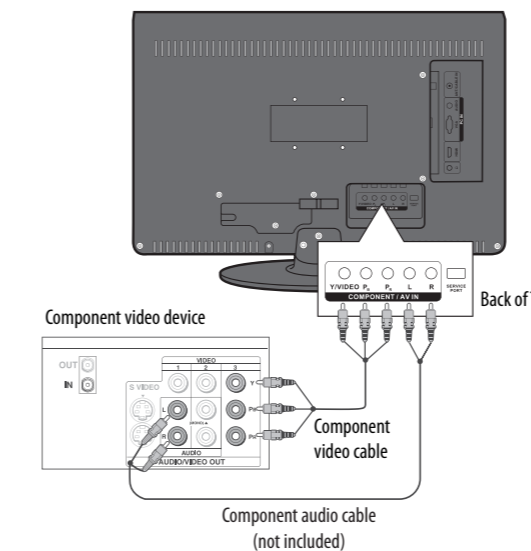

Note: Cable connectors and jacks are often color-coded. Match the colors when you connect the AV cable.

Connecting an antenna

Connect a 75 ohm cable (not included) to the ANT/CABLE IN jack on the back of your TV and the RF OUT jack on the antenna.

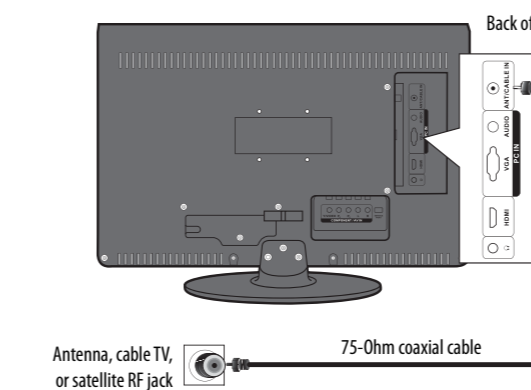

Connecting a VCR, camcorder, or game (good)

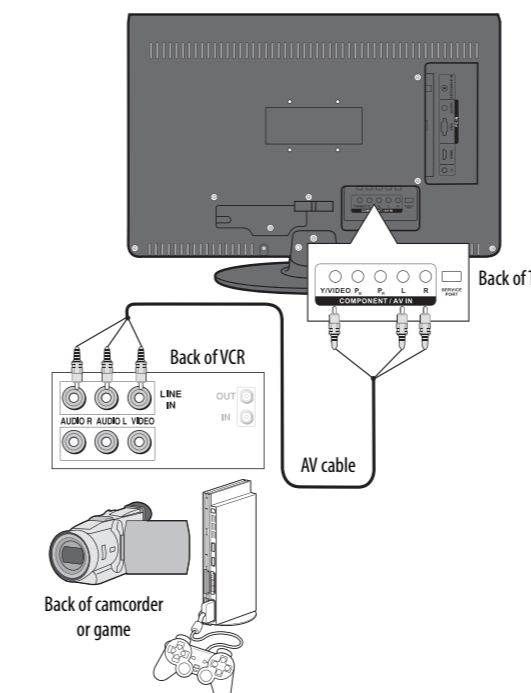

Note: Cable connectors and jacks are often color-coded. Match the colors when you connect the AV cable.

Connecting to a computer

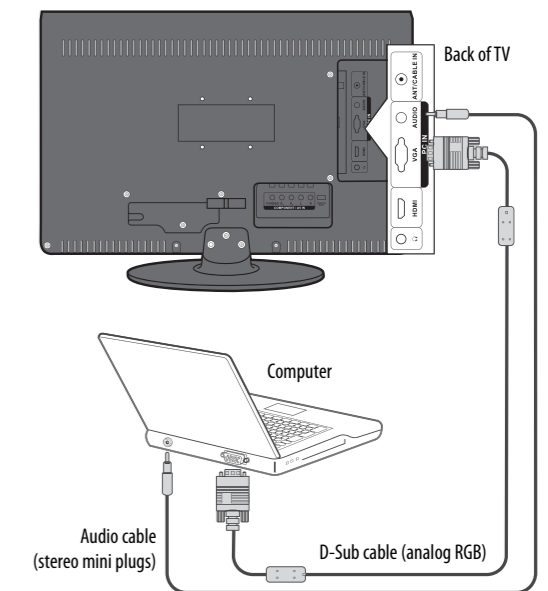

Connecting headphones

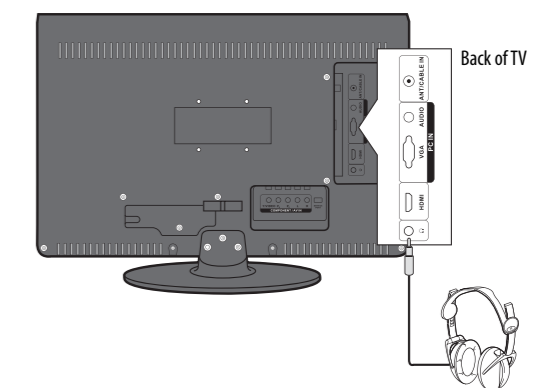

Connecting power

Connect the power cable to a power outlet.

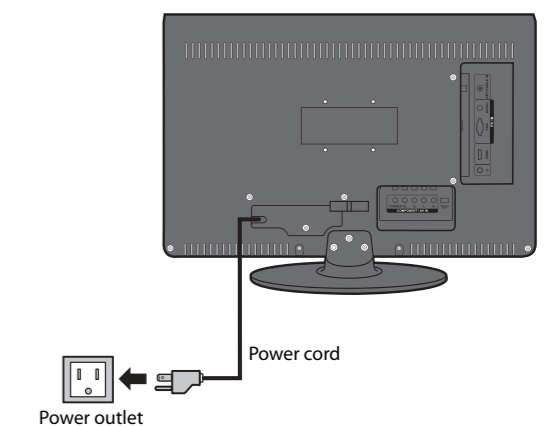

Turning on your TV for the first time

1 Plug in your TV and turn it on. The initial *Setup Wizard* opens.



2 Press **▲** or **▼** to select the menu language you want, then press **ENTER**. The *Time* screen opens.

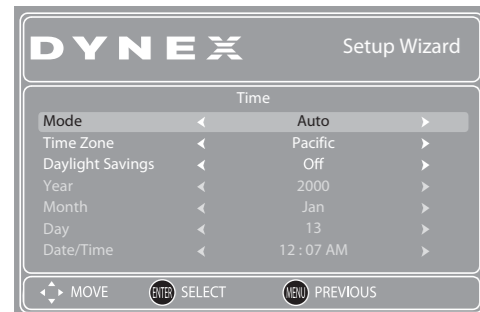

3 Press **▲** or **▼** to highlight **Mode**, then press **◀** or **▶** to select **Manual** (to set the date and time manually), or **Auto** (the date and time are automatically set by the TV signal source, based on the time zone you select).

4 Press **▲** or **▼** to highlight **Time Zone**, then press **◀** or **▶** to select your time zone. You can select **Pacific, Alaska, Hawaii, Atlantic, Eastern, Central**, or **Mountain**.

5 If your viewing area observes daylight savings time, press **▲** or **▼** to highlight **Daylight Savings**, then press **◀** or **▶** to select **On**.

6 If you selected **Manual** mode, make the settings as follows:

- Press **▲** or **▼** to highlight **Year, Month, or Day**, then press **◀** or **▶** to adjust the setting.
- Set the time by pressing **▲** or **▼** to highlight **Date/Time**, then press **◀** or **▶** to highlight the **hour, minute, or AM/PM** field. Press **▲** or **▼** to adjust the setting.

7 Press **ENTER**. The *Choose your Picture Mode* screen opens.

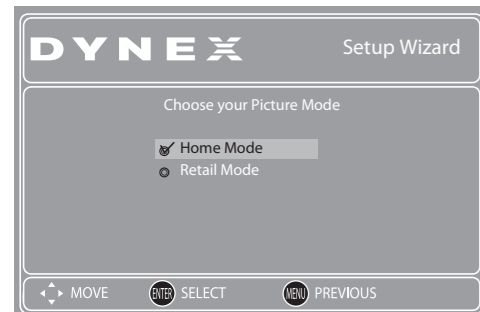

8 Press **▲** or **▼** to select **Home Mode** or **Retail Mode**, then press **ENTER**.

If you select **Home Mode**, the *Choose your TV source* screen opens.

-OR-
If you select **Retail Mode**, a message stating "Are you sure you want Retail mode? Since in this mode Energy saving is not realized." appears. Select **Yes** to proceed or **No** to exit.

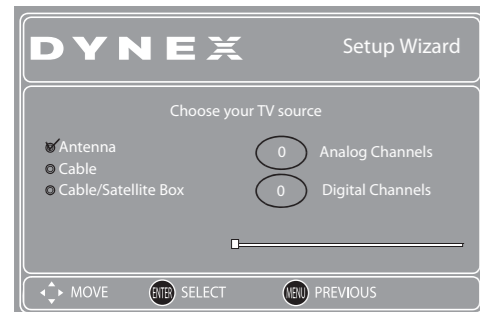

9 Press **▲** or **▼** to select **Antenna, Cable, or Cable/Satellite Box**, depending on the type of connection you have.

- If you are using an antenna for a standard or HD TV signal, select **Antenna**.
- If your cable is connected directly to the TV (without a tuner box), select **Cable**.
- If your cable is connected to your TV through a tuner box, select **Cable/Satellite Box**.

10 Press **▶** when you have made your selection. The channel scan screen opens.

If you selected **Antenna** or **Cable**, your TV automatically scans for available channels in your area and stores the channel information in the channel list. This may take several minutes. While scanning, the TV displays a progress report.

- OR -

If you selected **Cable/Satellite Box**, the auto scan is not necessary and the screen will ask you to select the correct input source for your set top box. Press **EXIT** to close the menu.

11 Select the corresponding video input source through the *INPUT SOURCE* menu.

Selecting the video input source

1 Turn on your TV, then press the **INPUT** key on the remote, or the **INPUT** button on the TV. The *Source List* menu opens.

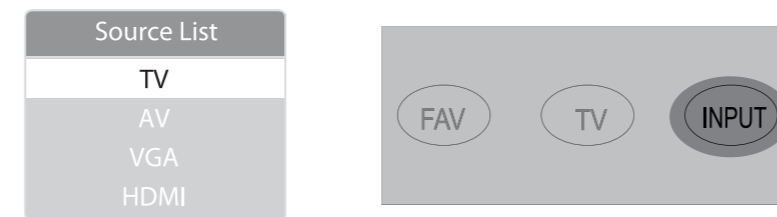

2 Press **▲** or **▼** to highlight the video source, then press **ENTER**. You can also select the input source using the following remote control buttons:

- **TV**—Press to switch to **TV** mode.

Adjusting the volume

- Press **VOL+** or **VOL-** to change the volume.
- Press **MUTE** to turn off the sound.

Selecting a channel

- To move to a different channel in the channel list, press **CH▲** or **CH▼**.
- OR
- Enter the channel number directly using the number buttons.

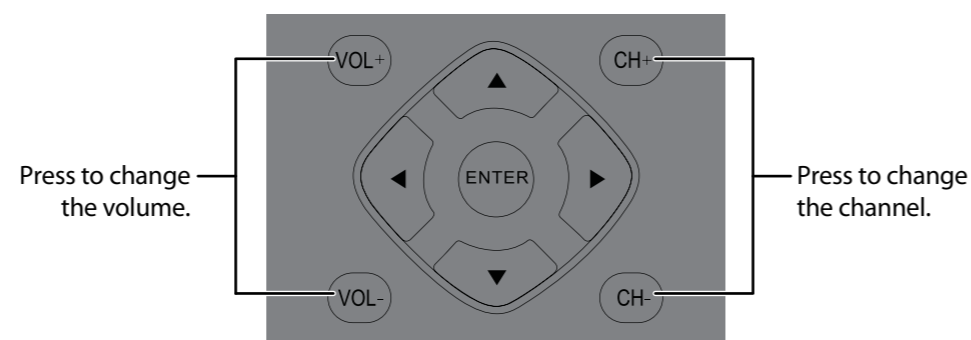

Viewing channel information

- Press **INFO** to view an information banner. The information banner shows the current program information such as channel number, video input source, and resolution.
 - Digital mode information—Displays the channel number, station name, channel label, broadcast program name, TV rating, signal type, audio information, resolution, CC mode, current time, and current program start and end times.
 - Analog mode information—Displays channel number, channel label (if preset), signal type, audio information, and resolution.
- Press **GUIDE** to show the digital program guide, which may view a list of available programs, program times, and program summaries, depending on the information provided by the broadcaster.

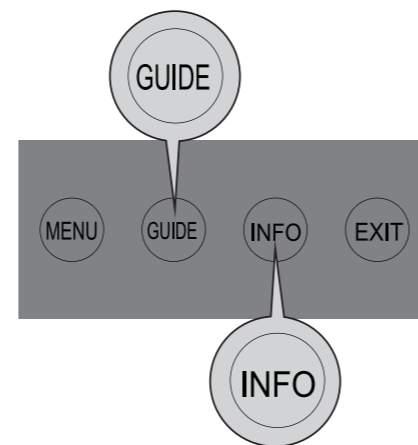

On-screen menu overview

PICTURE menu

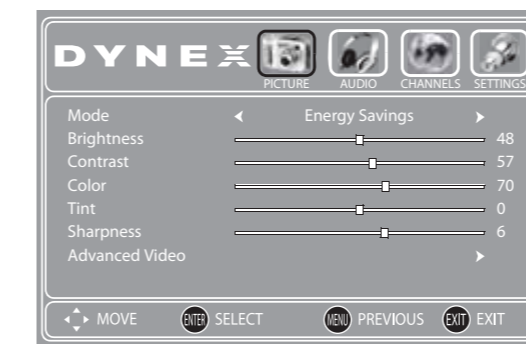

AUDIO menu

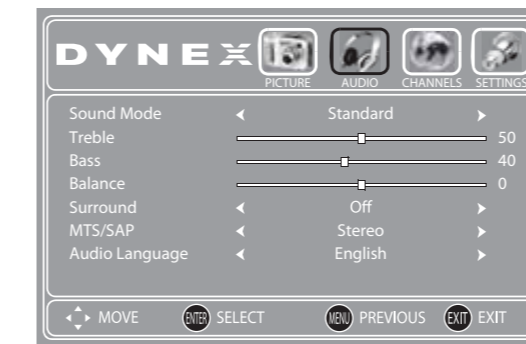

SETUP menu



CHANNEL menu



Navigating menus with your remote control

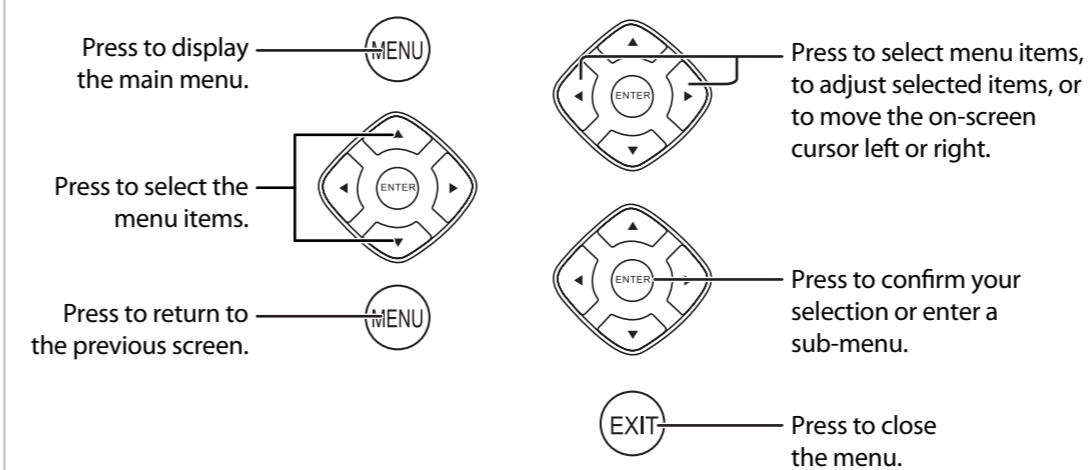

DYNEX™

One-year limited warranty

Visit www.dynexproducts.com for details.

Need additional help?

See your **User Guide**! This comprehensive guide includes everything from basic how-to steps to more advanced features. Go to www.dynexproducts.com to download a copy of your *User Guide*.

We're here for you

www.dynexproducts.com

For customer service, call:

800-305-2204 (U.S./Canada markets)

01 800-926-3020 (Mexico market)

Distributed by Best Buy Purchasing, LLC

7601 Penn Avenue South, Richfield, MN USA 55423-3645
Best Buy Imports, S. de R.L. de C.V. Av. Santa Fe 485, Segundo Piso, Colonia Cruz Manca, Programa Parcial de Desarrollo Santa Fe, Delegación Cuajimalpa, Distrito Federal, México 05349
RFC#BBI0802114Q2

© 2010 BBY Solutions, Inc., All Rights Reserved.

DYNEX is a trademark of BBY Solutions, Inc. Registered in some countries. All other products and brand names are trademarks of their respective owners.