



myPDFmanuals

You can read the recommendations in the user guide, the technical guide or the installation guide for SONY KDL-40EX720. You'll find the answers to all your questions on the SONY KDL-40EX720 in the user manual (information, specifications, safety advice, size, accessories, etc.). Detailed instructions for use are in the User's Guide.

User manual SONY KDL-40EX720
User guide SONY KDL-40EX720
Operating instructions SONY KDL-40EX720
Instructions for use SONY KDL-40EX720
Instruction manual SONY KDL-40EX720

SONY

4-269-995-12(1)

LCD
Digital Colour TV
Operating Instructions

Getting Started
Using Your BRAVIA TV
Network Setup
Additional Information

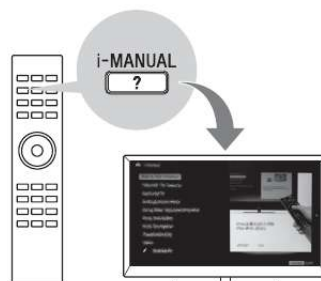

BRAVIA

KDL-55EX72x / 46EX72x / 46EX52x / 46CX52x / 40EX72x / 40EX52x / 40CX52x / 37EX72x
KDL-32EX72x / 32EX52x / 32EX42x / 32CX52x / 26EX32x / 24EX32x / 22EX32x



[Your user manual](#)
[SONY KDL-40EX720](#)

Manual abstract:

Please confirm with your local dealer if you can receive a DVB-T signal where you live or ask your cable provider if their DVB-C cable service is suitable for integrated operation with this TV. · Your cable provider may charge a fee for their services, or require you to agree to its terms and conditions of business. · This TV set complies with DVB-T and DVB-C specifications, but compatibility with future DVB-T digital terrestrial and DVB-C digital cable broadcasts are not guaranteed. · Some Digital TV functions may not be available in some countries/areas and DVB-C cable may not operate correctly with some providers. For a list of compatible cable providers, refer to the support web site: <http://support.sony-europe.com/TV/DVBC/> · The "x" that appears in the model name corresponds to a numeric digit, related to design, colour or TV system. · Instructions about "Installing Wall Mount Bracket" are included within this TV's instructions manual. · The illustrations used in this manual may differ depending on your TV model. · The illustrations of the remote used in this manual are of the RM-ED044 unless otherwise stated.

· Before operating the TV, please read "Safety Information" (page 31). Retain this manual for future reference. FUSE FUSE How to replace the fuse Open the fuse compartment with a blade screwdriver, and replace the fuse. Please refer to the illustration that actually equipped with the product. 2 GB TV Wireless System Regulation Information For Customers in Italy s with respect to private use, by the Legislative Decree of 1.

8.2003, no. 259 ("Code of Electronic Communications"). In particular Article 104 indicates when the prior obtainment of a general authorization is required and Art. 105 indicates when free use is permitted; s with respect to the supply to the public of the RLAN access to telecom networks and services (e.

g. TV wireless system), by the Ministerial Decree 28.5.2003, as amended, and Art. 25 (general authorization for electronic communications networks and services) of the Code of electronic communications Precautions Viewing the TV · Some people may experience discomfort (such as eye strain, fatigue, or nausea) while watching 3D video images or playing stereoscopic 3D games. Sony recommends that all viewers take regular breaks while watching 3D video images or playing stereoscopic 3D games. The length and frequency of necessary breaks will vary from person to person. You must decide what works best. If you experience any discomfort, you should stop watching the 3D video images or playing stereoscopic 3D games until the discomfort ends; consult a doctor if you believe necessary. You should also review (i) the instruction manual of any other device or media used with this television and (ii) our website (<http://www.sony-europe.com/myproduct>) for the latest information. The vision of young children (especially those under six years old) is still under development. Consult your doctor (such as a pediatrician or eye doctor) before allowing young children to watch 3D video images or play stereoscopic 3D games. Adults should supervise young children to ensure they follow the recommendations listed above. · Do not use, store, or leave the 3D Glasses or the battery near fire, or in places with a high temperature, e.g., in direct sunlight, or in sun-heated cars. · When using the simulated 3D function, please note that the displayed image is modified from the original due to the conversion done by this television. · View the TV in moderate light, as viewing the TV in poor light or during long period of time, strains your eyes.

· When using headphones, adjust the volume so as to avoid excessive levels, as hearing damage may result. For Customers in Norway Use of this radio equipment is not allowed in the geographical area within a radius of 20 km from the centre of Ny-Ålesund, Svalbard. For Customers in Cyprus The end user must register the RLAN (or WAS or WiFi) devices in the Department of Electronic Communications (P.I. 365/2008 and P. I. 267/2007). P.I. 365/2008 is the Radiocommunications (Categories of Stations Subject to General Authorization and Registration) Order of 2008. P.I.

· When using headphones, adjust the volume so as to avoid excessive levels, as hearing damage may result. For Customers in Norway Use of this radio equipment is not allowed in the geographical area within a radius of 20 km from the centre of Ny-Ålesund, Svalbard. For Customers in Cyprus The end user must register the RLAN (or WAS or WiFi) devices in the Department of Electronic Communications (P.I. 365/2008 and P. I. 267/2007). P.I. 365/2008 is the Radiocommunications (Categories of Stations Subject to General Authorization and Registration) Order of 2008. P.I.



[Your user manual](#)
[SONY KDL-40EX720](#)