

Facsimile with Cordless Phone

Quick Reference Guide



KX-PW37CL

KX-PW37CL has one portable handset.

KX-PW47CL has two portable handsets.

KX-PW57CL has three portable handsets.

Model No.
KX-PW37CL
KX-PW47CL
KX-PW57CL

Thank you for purchasing a Panasonic facsimile.

Table of Contents

Finding the controls	2
Installations and connections	4
Setting the date and time	8
Setting your facsimile telephone number	8
Setting your logo	9
Automatic dialing on the main unit	10
Automatic dialing on the portable handset	11
Intercom between portable handsets	12
Sending faxes	13
Receiving faxes	14
Operating the built-in answering device	16
Using the hand scanner	17
Individual e-mail services	22
Specifications	Back cover

- This guide explains some basic features and operations, but not all of them. For further details, see the Japanese operating instructions.
- This product is designed for use in Japan.
Panasonic cannot provide service for this product if used outside Japan.
- Any details given in this guide are subject to change without notice.

Finding the controls

Main unit (control panel)

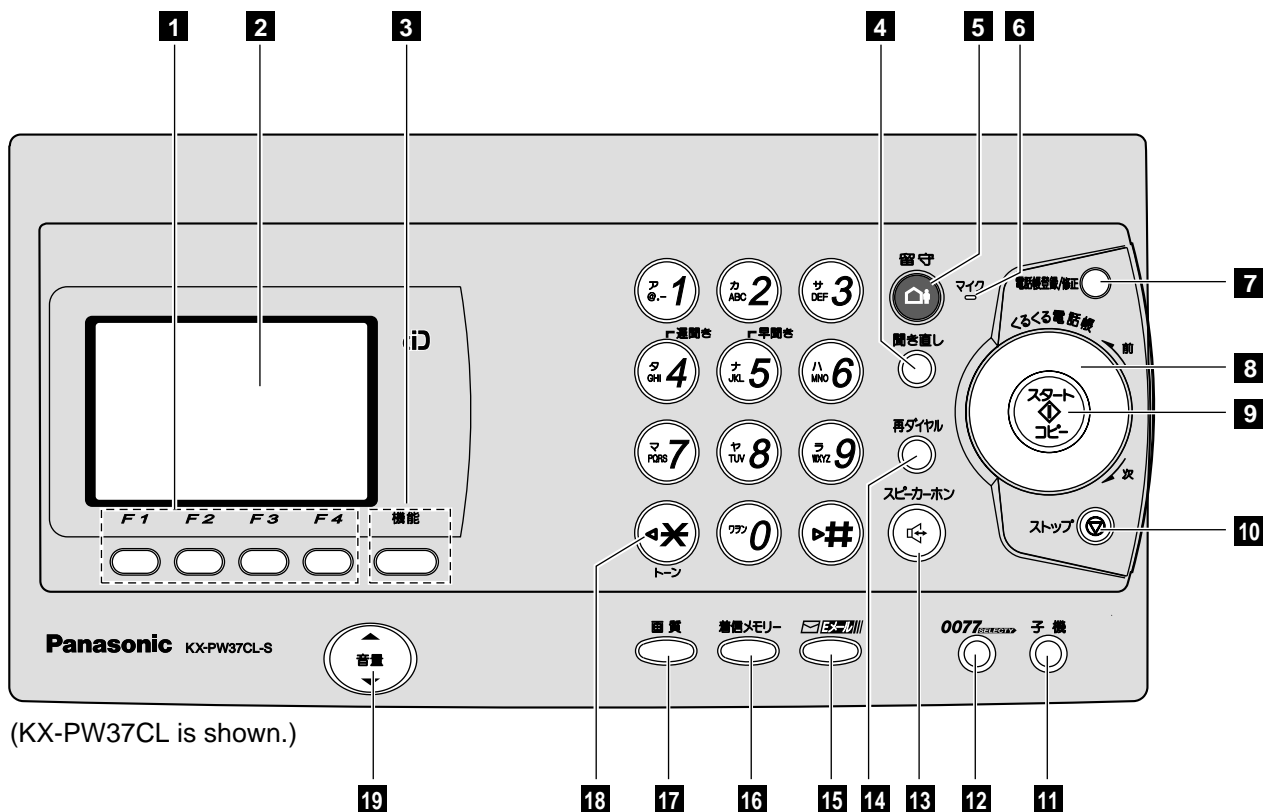

(KX-PW37CL is shown.)

- 1 Multi-operation** buttons refer to the function displayed on the display panel.
- 2 Liquid crystal display**
- 3 Function** button initiates programming.
- 4 Replay** button plays back recorded messages.
- 5 Auto Answer** button
 - light on: answering device activated.
 - light off: used as a regular telephone.
- 6 Microphone**
- 7 Phonebook** button stores and edits information (phone numbers, names etc.) into the telephone directory.
- 8 Search Dial** searches the directory or displays programming features.
- 9 Start/Copy** button starts faxing or copying.
- 10 Stop** button
- 11 Intercom** button
- 12 77 SELECTY** button & indicator accesses 77 SELECTY services.
- 13 Speakerphone** button
- 14 Redial/Pause** button
- 15 E-Mail** button & indicator
- 16 Call Memory** button & indicator stores the caller ID of incoming calls.
- 17 Resolution** button selects the resolution when faxing or copying.
- 18 Tone** button switches to tone dialing.
- 19 Volume** button adjusts ringer, speaker and handset volume.

Finding the controls

Portable handset

How to use **key**

電話帳 To search in the directory.

再ダイヤル To redial the last number dialed.
To insert a pause.

音量 To adjust the volume.

Speakerphone

Microphone
(Do not cover the microphone while talking.)

LCD (with back light)

Displays battery strength, telephone numbers etc.

① Portable handset number
② Displayed when entering characters for the telephone directory, etc.
③ Function menu that is controlled by F_1 or F_2 .
④ Battery strength

How to use F_1 F_2 **buttons**

F_1 and F_2 buttons refer to the function displayed on the bottom of the display. They function differently depending on the mode.

Dial buttons

To switch to Tone dialing mode.

To change settings.

Charge indicator

Charging Red
Full Off

How to use **key**

外線 To make/answer calls.

文字切替 To page the main unit or another portable handset.
 内線 To change the character input mode.

切 To end a call.
To end or exit from editing or other operations.

保留 To put a call on hold.
To start a search in the Number Display log.

クリアー For call waiting service users.
 キャッチ To clear letters/numbers.

ファクス To receive faxes.

スピーカーホン To use the speakerphone.

増設 Used when installing additional portable handsets.

Hand scanner

Battery indicator
(Shows the amount of battery power left)

Operation indicator
(Shows the condition of the scanner)

Delete button
(To delete the scanned contents)

Memory indicator
(Shows the amount of memory being used)

Resolution button **Scanning width button**

To start or stop scanning

Installations and connections

Installing the ink film

- 1** Press the control panel open button (1) to open the control panel (2).

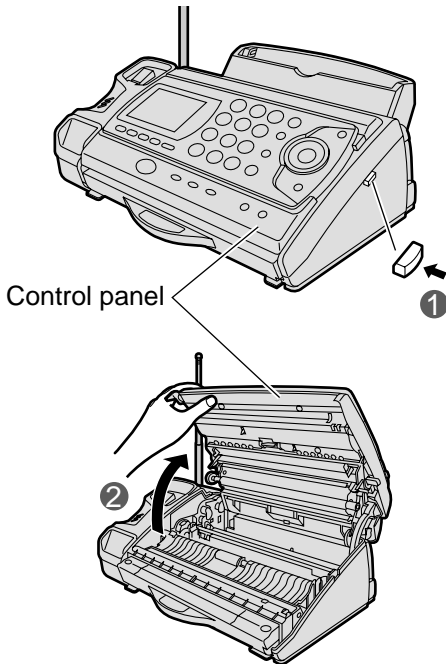

- 2** Take out the ink film from the bag, and find the "T" shaped gear (blue).

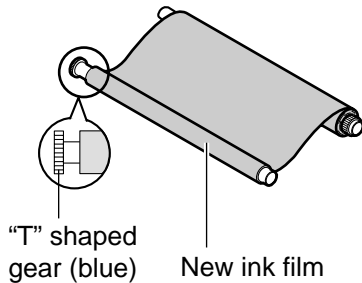

- 3** Hold the ink film like in the picture below.

- 1 Insert the blue core into the right slot of the main unit.
- 2 Insert the "T" shaped gear (blue) into the left slot of the main unit.

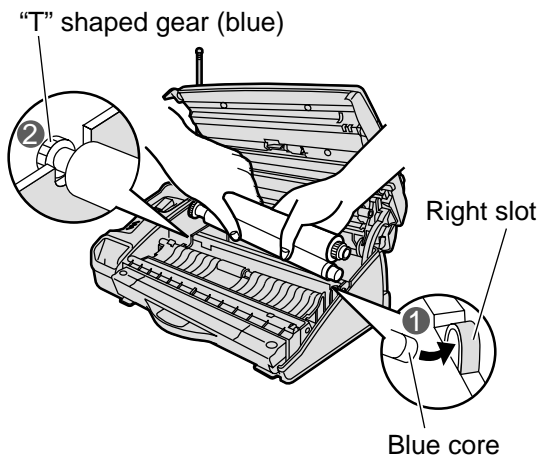

- 4** Insert the white core into the slots shown in the picture below.

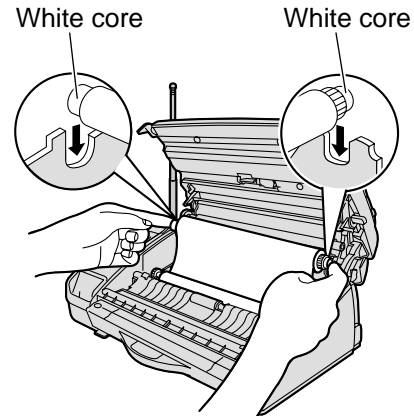

- 5** If the ink film is slack, tighten it by winding the gear.

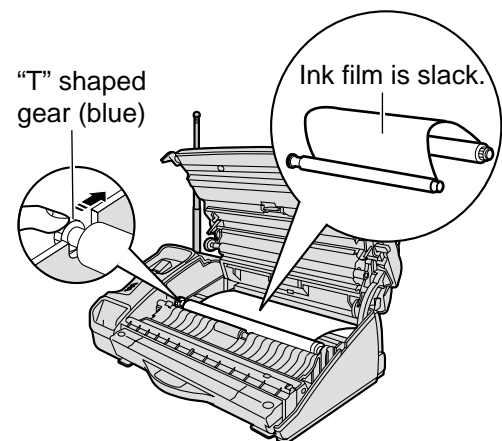

- 6** Close the control panel by pressing down on both sides.
- Make sure to close the control panel until it locks.

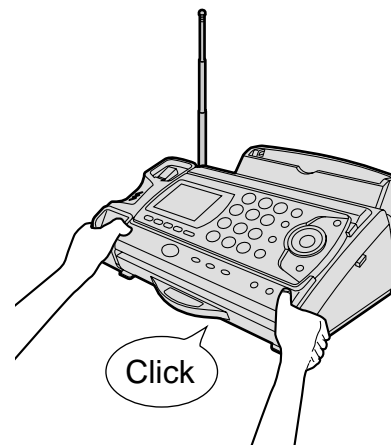

Installations and connections

Installing recording paper (A4 size)

1 Install the recording paper tray.

- 1 Insert the left tab on the recording paper tray into the left slot of the main unit.
- 2 Insert the right tab into the right slot of the main unit.

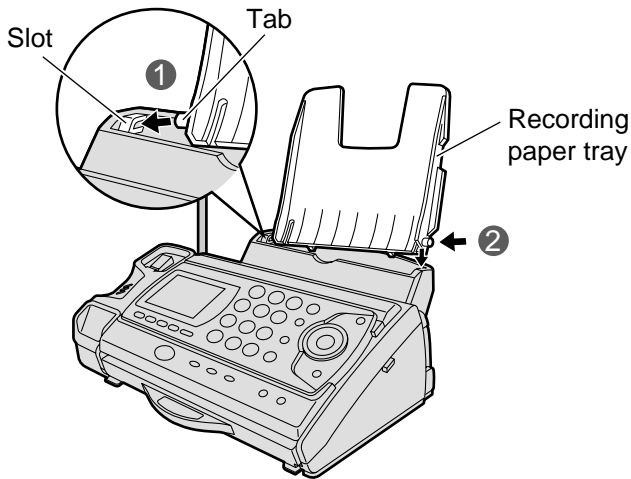

2 Open the paper entrance cover until it locks.

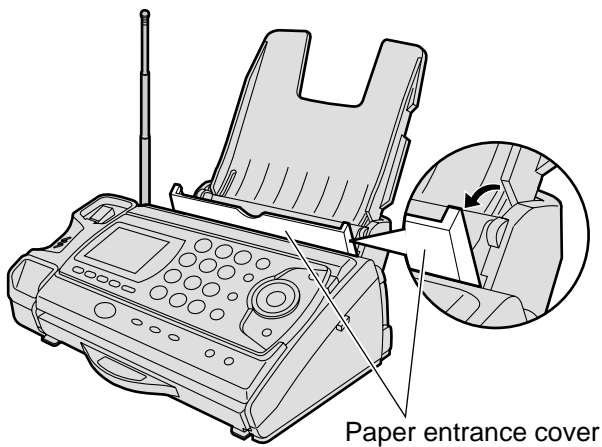

3 Fan the stack of recording paper (A4 size) and insert it into the recording paper tray.

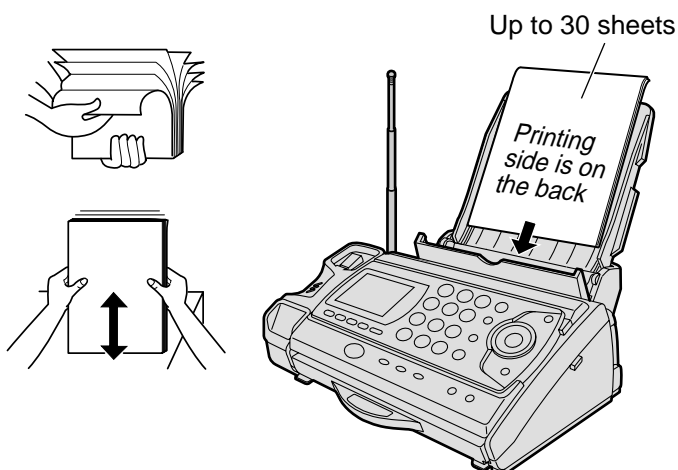

4 Close the paper entrance cover by leaning it back.

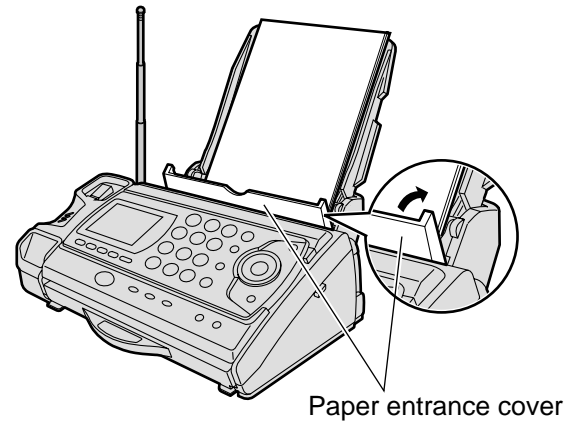

5 Install the recording paper cover on the recording paper tray by sliding it down from the top.

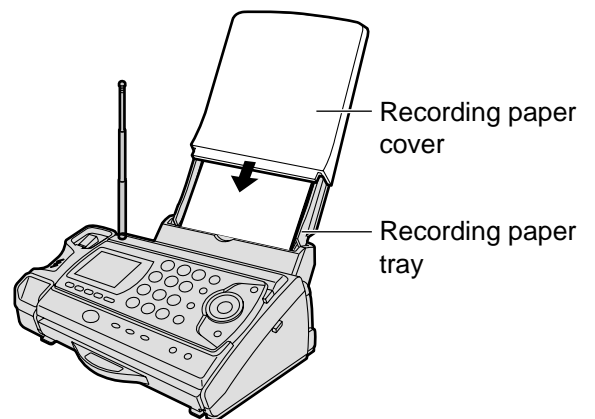

Recording paper cover

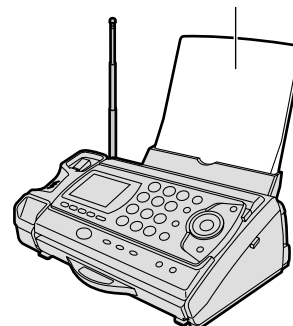

Installations and connections

Connecting the main unit

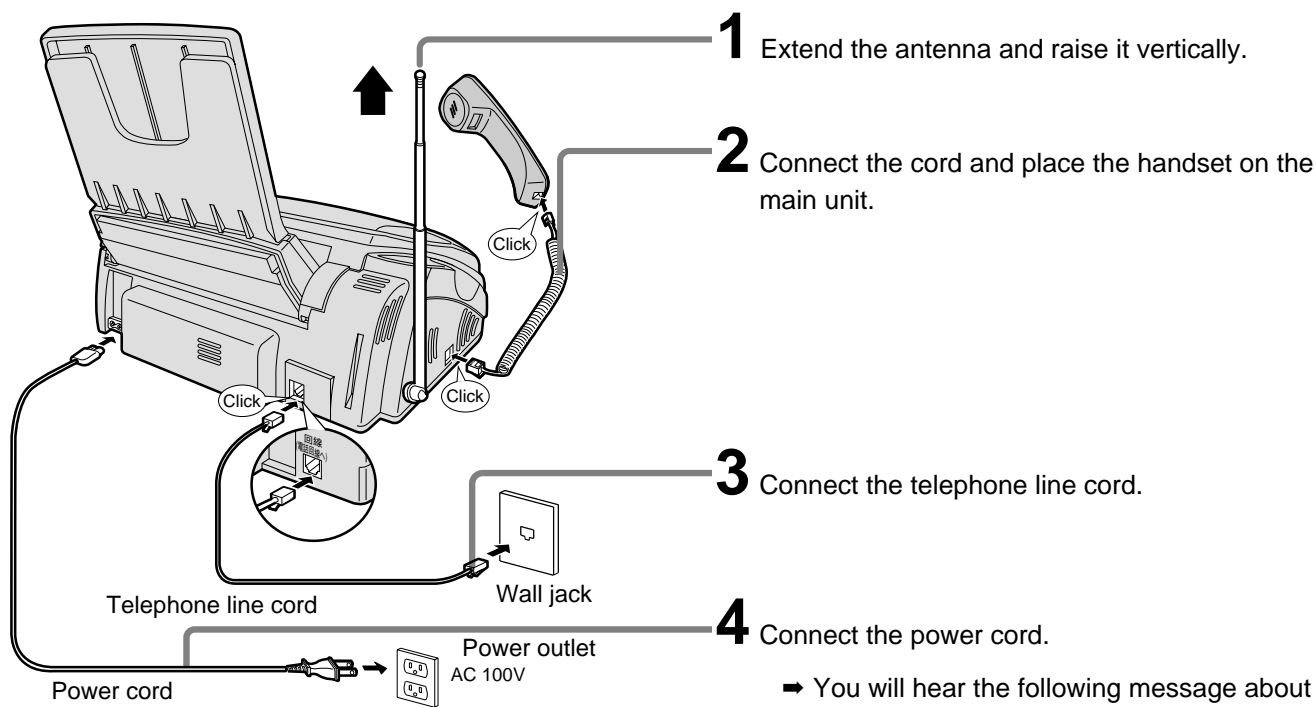

- 1 Extend the antenna and raise it vertically.
- 2 Connect the cord and place the handset on the main unit.
- 3 Connect the telephone line cord.
- 4 Connect the power cord.

➔ You will hear the following message about KDDI's 77 SELECTY service in Japanese.

Thank you for purchasing a Panasonic facsimile. This unit will automatically select using KDDI's "0077" long distance call service. If you do not want to use this service, press "機能 (Function)", "0077 (77 SELECTY)", and "#". Then, please make sure the "0077 (77 SELECTY indicator)" is turned off.

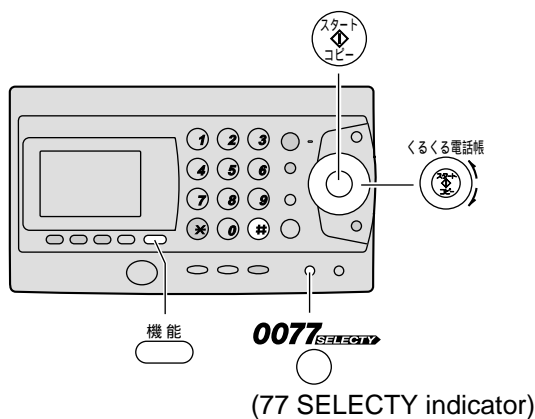

- 5 Decide if you want to subscribe to "77 SELECTY" service. If you press (Start) or leave the unit for about 2 minutes, the unit automatically starts to set up for "77 SELECTY" service. If you do not want to subscribe to this service, see the message in step 4 for instructions.



This unit will automatically select the dialing mode (Tone/Pulse).



Subscribing to "77 SELECTY"

An automatic online setup will start in an hour.

➔ After the online setup is completed, 77 SELECTY indicator will light in green to show that 77 SELECTY service is ready to be used.

During the online setup, your telephone number will be sent to KDDI.

Installations and connections

Setting up the portable handset

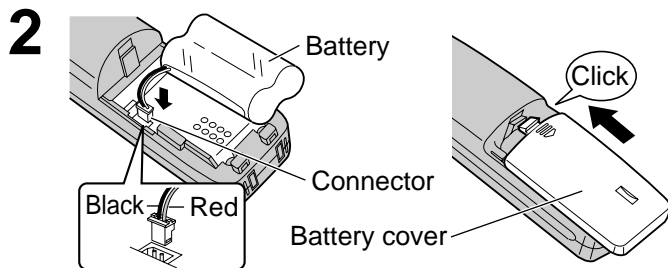
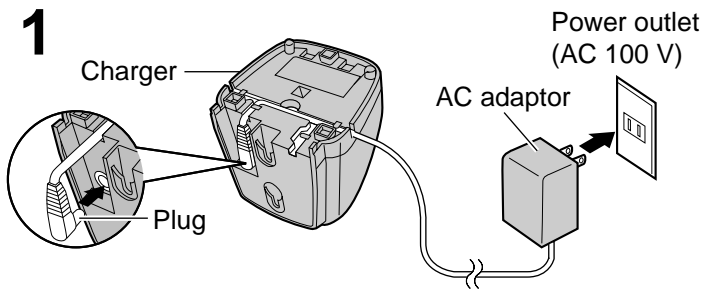

3 Charge the battery in the charger for 10 hours.

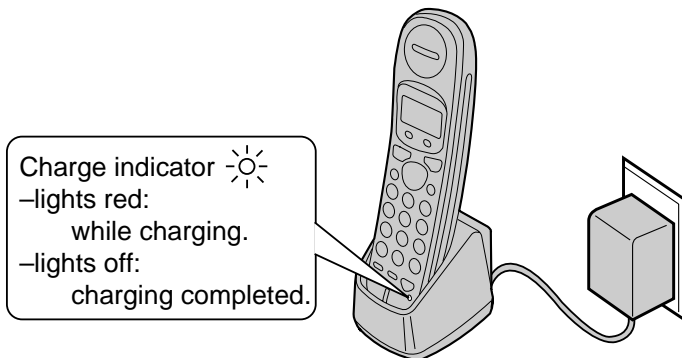

- After your Panasonic battery is fully charged, it will last up to about 7 hours of conversation.

Setting up the hand scanner

1 Press down the knob of the hand scanner, and pull out the hand scanner from the main unit.

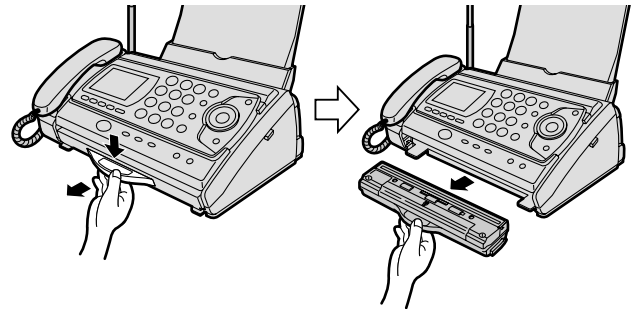

2 Slide open the battery cover by slightly pushing  part.

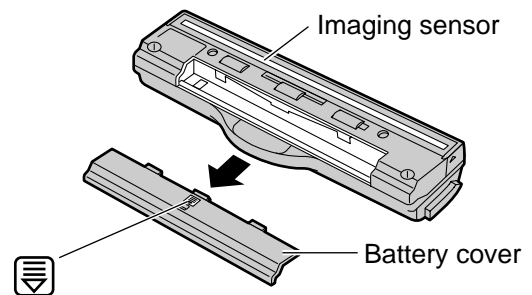

3 Connect the battery to the hand scanner, and close the battery cover.

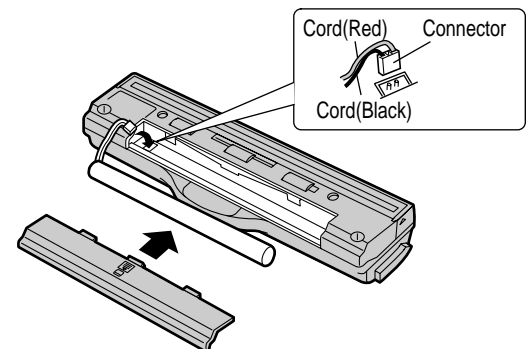

4 Insert the hand scanner, and charge the battery for 10 hours.

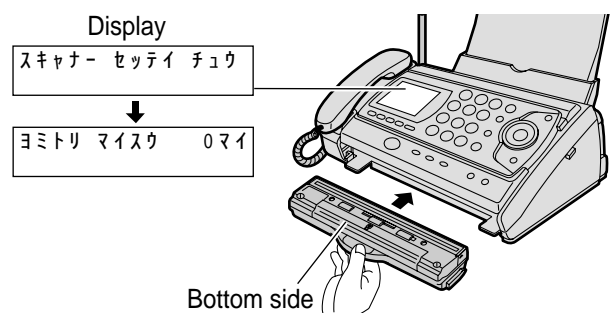

- The hand scanner battery is charged when the hand scanner is inserted into the main unit.

Setting the date and time

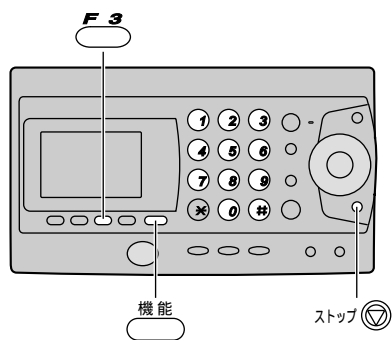

1 Press (Function).

キノウ トウロク モード
[クルクル]

2 Press .

Example: 2000年01月01日
[トウロク]
Cursor

3 Enter the correct year/month/day.

Example: Nov. 3, 2000

Press .

2000年11月03日
[トウロク]

4 Press (Register).

シ`コク 00:00
[トウロク]

5 Enter the correct hour/minute in a 24-hour clock entry.

Example: 15:45 (3:45 PM)

Press .

シ`コク 15:45
[トウロク]

6 Press (Register).

トウロク シマシタ



2000年11月03日
[トウロク]

7 Press (Stop).

11月 3日 15:45
ヨウケン ロクオン 00ケン

Setting your facsimile telephone number

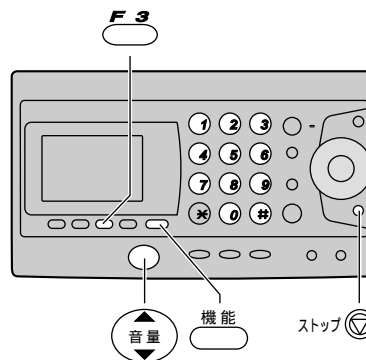

1 Press (Function).

キノウ トウロク モード
[クルクル]

2 Press .

TEL=
Cursor

3 Enter your facsimile telephone number, up to 20 digits.

Example: 098 765 43 ..

TEL=8 765 43 ..

The (Space) button replaces the digit with a space.

4 Press (Register).

トウロク シマシタ



TEL=098 765 43 ..

5 Press (Stop).

Setting your logo

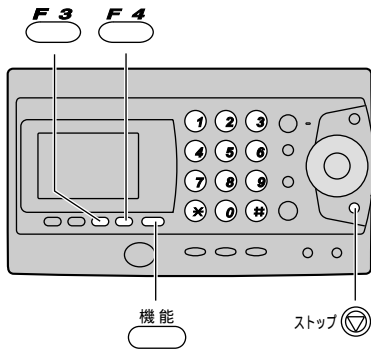

1 Press **機能** (Function).

キノウ トウロク モード
[クルクル]

2 Press **#002**.

ナマエ=

3 Enter your logo, up to 30 characters, using the dial keypad.

- To enter English characters easily, press **文字切替** (Character input mode) repeatedly and select “英” (English input mode).
- For details, see below.

Example: Micah

1. Press **6** once.

ナマエ=M
Cursor

2. Press **4** six times.

ナマエ=Mi

3. Press **2** six times.

ナマエ=Mic

4. Press **#** to move the cursor to the next space and press **2** four times.

ナマエ=Mic a

5. Press **4** five times.

ナマエ=Micah

4 Press **登録** (Register).

トウロク シマシタ



ナマエ=Micah

5 Press **ストップ** (Stop).

Character input and command key table

Character	Pressing the dial keys will select a character as shown below.		
	“カナ” Katakana	“英” English	“数” Numbers
Dial key 1	アイウエオアイウエオ	@ . - _ & \$ ¥ % + = ~ ^	1
2	カキクケコ	A B C a b c	2
3	サシスセソ	D E F d e f	3
4	タチツテトッ	G H I g h i	4
5	ナニヌネノ	J K L j k l	5
6	ハヒフヘホ	M N O m n o	6
7	マミムメモ	P Q R S p q r s	7
8	ヤユヨヤユヨ	T U V t u v	8
9	ラリルレロ	W X Y Z w x y z	9
0	ワヲン ` 〃 〃 〃 〃	、 〃 ! ? / - * # , ; : ` ' " () [] { } < > 「 」	0
Command keys	文字切替 (Main unit), 文字切替 (Portable handset)		Used to change the character input mode.
	# (Main unit), 右 (Portable handset)		Used to move the cursor to the right.
	* (Main unit), 左 (Portable handset)		Used to move the cursor to the left.
	クリア (Main unit), クリア (Portable handset)		Used to delete a character.
	スペース (Main unit), 右 (Portable handset)		Used to insert a space.

- When entering e-mail address, the small letters are displayed before the capital letters.
- When entering e-mail address, you can not enter the following symbols: ` 〃 - ` ` 「 」

Automatic dialing on the main unit

Storing names and telephone numbers in the search dial

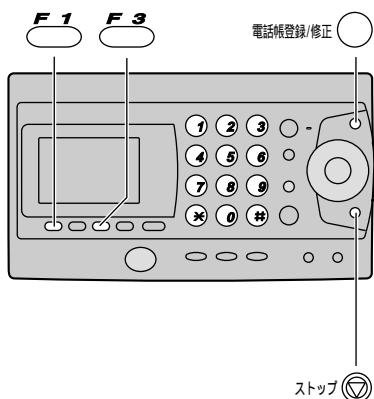

1 Press (Phonebook).

- “XXX” shows the remaining station numbers you can store.
- You can program up to 150 stations, including 5 pre-programmed stations.

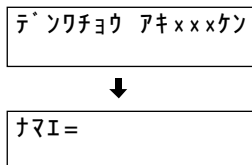

2 Enter the name, up to 12 characters (see the table on page 9 for instructions).

3 Press (Register).

4 Enter the telephone number, up to 30 digits.
• To correct a mistake, press (Clear).

5 Press (Register).

6 If necessary, enter the group number (1–9).

7 Press (Register).

- To program other items, repeat steps 2–7.

8 Press (Stop) to exit the program.

Making a voice call using the search dial

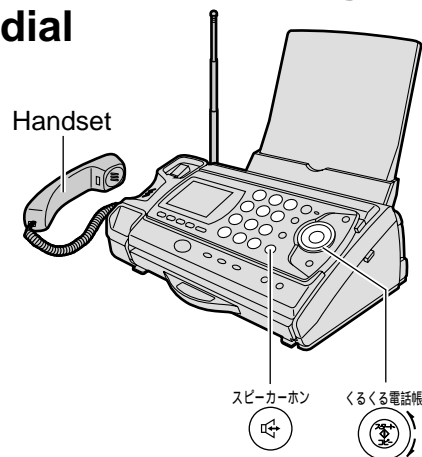

1 Rotate the (Search dial) until the desired name is displayed.

2 Lift the handset or press (Speakerphone).

Editing a stored name or number

1 Rotate the (Search dial) until the desired name is displayed.

2 Press (Phonebook).

- If you do not need to edit the name, skip to step 4.

3 Edit the name (see the table on page 9 for instructions).

4 Press (Register).

- If you do not need to edit the telephone number, skip to step 6.

5 Enter the correct telephone number.

6 Press (Register).

- If you do not need to change the group number, skip to step 8.

7 If necessary, enter the correct group number.

8 Press (Register).

Automatic dialing on the portable handset

Storing names and telephone numbers in the search dial

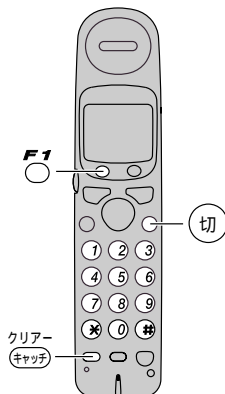

1 Press (Register).

- "XXX" shows the remaining station numbers you can store.
- You can program up to 150 stations, including 5 pre-programmed stations.

テ	ン	ワ	チ	ヨ	ウ	ト	ウ	ロ	ク
ア	キ	×	×	×	ケ	ン			
ナ	マ	エ	?						

2 Enter the name, up to 12 characters (see the table on page 9 for instructions).

3 Press (Register).

4 Enter the telephone number, up to 30 digits.

- To correct a mistake, press (Clear).

5 Press (Register).

6 If necessary, enter the group number (1–9).

7 Press (Register).

- To program other items, repeat steps 2–7.

8 Press (Off) to exit the program.

Making a voice call using the search dial

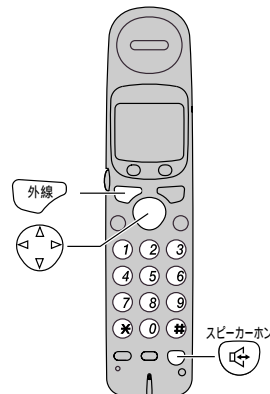

1 Press (Phonebook).

2 Press repeatedly until the desired name is displayed.

3 Press (Talk) or press (Speakerphone).

Editing a stored name or number

1 Press (Phonebook).

2 Press repeatedly until the desired name is displayed.

3 Press (Edit).

4 Press .

- If you do not need to edit the name, skip to step 6.

5 Edit the name (see the table on page 9 for instructions).

6 Press (Register).

- If you do not need to edit the telephone number, skip to step 8.

7 Enter the correct telephone number.

8 Press (Register).

- If you do not need to change the group number, skip to step 10.

9 If necessary, enter the correct group number.

10 Press (Register).

Intercom between portable handsets

A 2-way intercom is available between 2 portable handsets.
 (For KX-PW37CL users: An optional handset is needed when using this feature.)

Making an intercom call

1 Press  and the desired portable handset number (1 to 4).





コキカン ヨビ*タ*シ

コキカン ツウワ

2 Start talking.

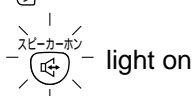
1. Press and hold  (Talk) until a beep sounds.



2. Start talking while holding down  (Talk).

- Keep holding down  (Talk) until you finish talking.



コキカン ツウワ
ソウワ

3. Release  (Talk) after you finish talking.

コキカン ツウワ

3 Listen to the response.



コキカン ツウワ
シ*ユワ



コキカン ツウワ

4 If you want to continue the conversation, repeat steps 2 and 3.

5 Press  (Off) to end the intercom call.

Answering an intercom call

1



コキカン チャクシン

コキカン ツウワ

2 Listen to the caller.



コキカン ツウワ
シ*ユワ





コキカン ツウワ

3 Respond to the caller.

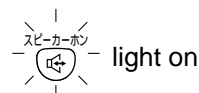
1. Press and hold  (Talk) until a beep sounds.



2. Start talking while holding down  (Talk).

- Keep holding down  (Talk) until you finish talking.



コキカン ツウワ
ソウワ

3. Release  (Talk) after you finish talking.

コキカン ツウワ



4 If you want to continue the conversation, repeat steps 2 and 3.

5 Press  (Off) to end the intercom call.

Sending faxes

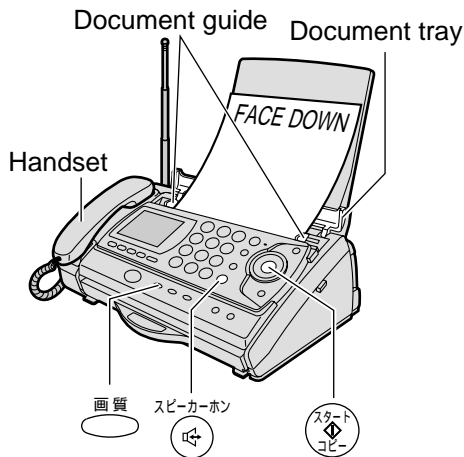

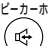
Sending a fax manually

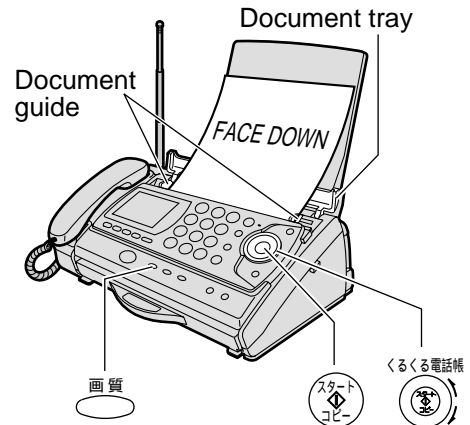

- 1 Open the document tray, and adjust the width of the document guides to the size of the document.
- 2 Insert the document (up to 5 pages) FACE DOWN until a single beep is heard.
- 3 If necessary, press  (Resolution) repeatedly to select the desired setting (see below).
- 4 Lift the handset or press  (Speakerphone).
- 5 Dial the fax number.
- 6 When a fax tone is heard, press  (Start).
- 7 Replace the handset if you are using it.
 - The unit will start fax transmission.

Sending a fax using the search dial



- 1 Open the document tray, and adjust the width of the document guides to the size of the document.
- 2 Insert the document (up to 5 pages) FACE DOWN until a single beep is heard.
- 3 If necessary, press  (Resolution) repeatedly to select the desired setting (see below).
- 4 Rotate the  (Search dial) until the desired name is displayed.
- 5 Press  (Start).
 - The unit will start fax transmission.

To select the resolution

Select the desired resolution according to the type of document, by pressing  (Resolution).

カ` シツ=フツウ

(Standard) for printed or typewritten originals with normal-sized characters.

カ` シツ=チイサイ

(Fine) for originals with minute printing.

カ` シツ=シャシン

(Photo) for originals containing photographs.

Receiving faxes

Receiving a fax manually (AUTO ANSWER off)

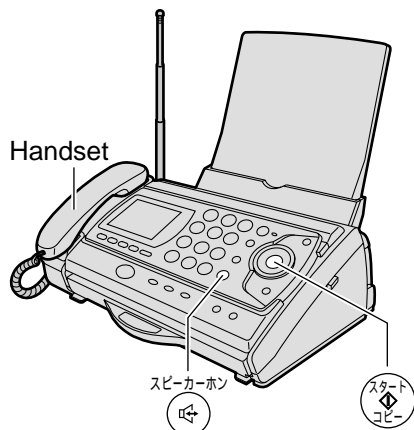

Using the main unit:

- 1** When you hear a ring, lift the handset or press スピーカーホン (Speakerphone) to answer the call.
- 2** When:
 - document reception is required,
 - a fax calling tone (slow beep) is heard, or
 - no sound is heard,
 press スタートコピー (Start).
- 3** Replace the handset if you are using it.
 - The unit will start fax reception.

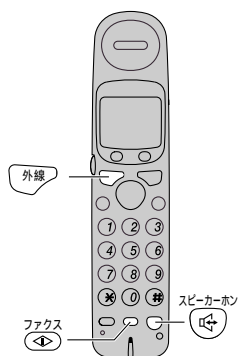

Using the portable handset:

- 1** When you hear a ring, press 外線 (Talk) or スピーカーホン (Speakerphone) to answer the call.
- 2** When:
 - document reception is required,
 - a fax calling tone (slow beep) is heard, or
 - no sound is heard,
 press ファクス (Fax reception).
 - The main unit will start fax reception.

Setting ANSWER mode

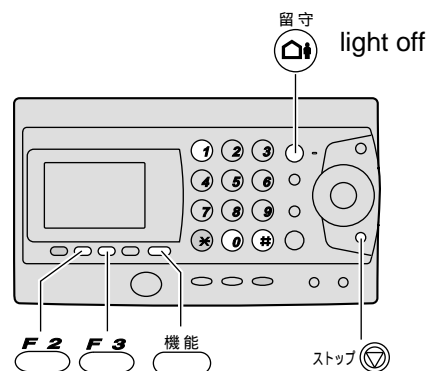

If the 留守 (Auto answer) light is on, turn it off by pressing 留守.

When AUTO ANSWER mode is off, the unit provides two types of receiving modes: “テ`ソウワセ`ン” (Telephone) mode and “FAX`ワセ`ン” (Fax/Telephone) mode.

Telephone mode (テ`ソウワセ`ン) –Pre-selected setting:

Select this mode when you plan to answer the calls yourself. When receiving calls, you have to answer all calls manually.

Fax/Telephone mode (FAX`ワセ`ン):

Select this mode when you are near the unit and want to use it to receive voice calls yourself and fax calls automatically. Change the setting if you want to use this mode.

1. Press 機能 (Function).

2. Press # 1 1 0.

サ`イタク=テ`ソウワセ`ン
[セ`ンタク, トウロク]

means “Telephone mode”

3. Press 選択 F2 (Select).

サ`イタク=FAX`ワセ`ン
[セ`ンタク, トウロク]

means “Fax/Telephone mode”

4. Press 登録 F3 (Register).

5. Press ストップ (Stop).

Receiving faxes

Receiving a fax automatically (AUTO ANSWER on)

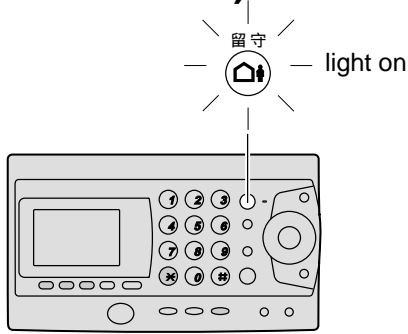

1 If the (Auto answer) light is off, turn it on by pressing .

2 When receiving a call, the unit will receive a fax document or record a voice message automatically depending on the caller's request.

Recording your own greeting message

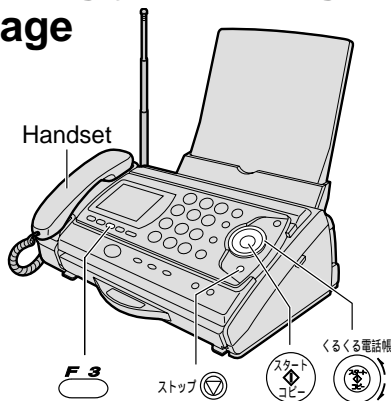

You can record your own greeting message. When receiving a call, it will be played to callers instead of the pre-recorded Japanese greeting message.

1 Press (Record).

2 Rotate the (Search dial) until the following is displayed.

オウトウ ロクオン
ジ ユワキヲ トツテクダ サイ

3 Lift the handset.

4 Press (Start).

5 Record your greeting message, up to 16 seconds, using the handset.

6 Press (Stop).

7 Replace the handset.

- Your greeting message will be played back automatically.

Setting AUTO ANSWER mode

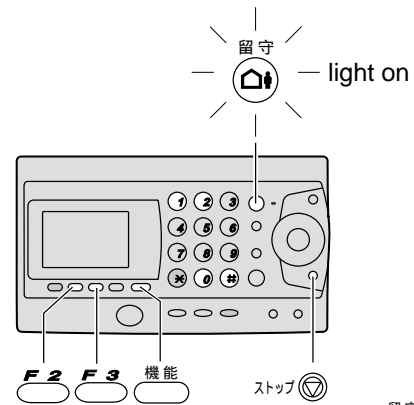

AUTO ANSWER mode will work when the (Auto answer) light is on.

AUTO ANSWER mode provides three types of receiving modes: "FAX / ルステ`ン" (Fax/Answering device) mode, "FAX センヨウ" (Fax only) mode and "ルステ`ンセンヨウ" (Answering device only) mode.

Fax/Answering device mode (FAX / ルステ`ン)

–Pre-selected setting:

Select this mode when you want to receive all voice and fax calls automatically.

Fax only mode (FAX センヨウ):

Select this mode when you wish to use the unit only as a fax machine.

Answering device only mode (ルステ`ンセンヨウ):

Select this mode when you wish to use the unit only as a telephone answering device.

Change the setting if you want to use the fax only mode or answering device only mode.

1. Press (Function).

2. Press .

ルス=FAX/ルステ`ン
[センタク, トウロク]

means "Fax/Answering device mode"

3. Press (Select) repeatedly.

ルス=FAXセンヨウ
[センタク, トウロク]

means "Fax only mode"

ルス=ルステ`ンセンヨウ
[センタク, トウロク]

means "Answering device only mode"

4. Press (Register).

5. Press (Stop).

Operating the built-in answering device

Activating the answering device

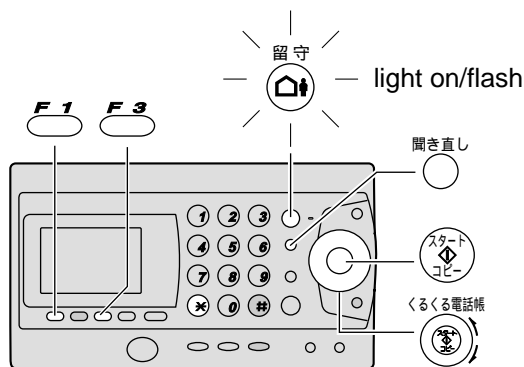

1 Turn the (Auto answer) light on by pressing .

2 When receiving a call, a greeting message will be played and the unit will record a voice message.
 • To record your own greeting message, see page 15.

Listening to recorded messages

When new messages are recorded, the (Auto answer) light will flash.

Press to listen to recorded messages.

Listening to all of the recorded messages

Press (Replay).

Erasing a specific message

1 Press (Erase) while listening to the message you want to erase.

2 Press .

Erasing all of the recorded messages

1 Press (Record).

2 Press , then press .

Erasing your own greeting message

1 Press (Record) and rotate the (Search dial) until the following is displayed.

アウトウ ショウキョ
[クルクル, スタート]

2 Press , then press .

• The pre-recorded Japanese greeting message will be played when you receive a call.

Operating the answering device from a remote location

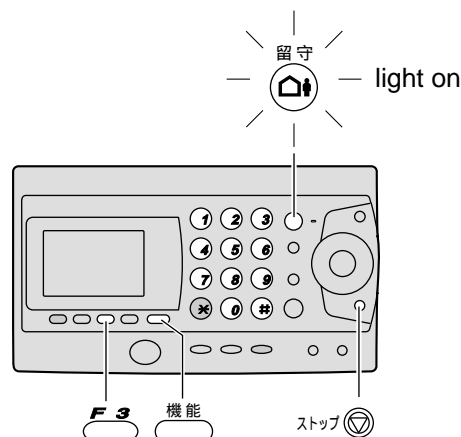

Preparation: Programming the remote operation ID

1. Press (Function).
2. Press .
3. Enter any 4-digit number (remote operation ID) except * or #.
4. Press (Register).
5. Press (Stop).

Operation: Listening to a recorded message from a remote location

Turn the (Auto answer) light on before you go out. Remote operations are available only from a touch tone telephone.

1. Call your unit.
2. Enter the remote operation ID during the greeting message.
3. Press or wait 4 seconds.
 - Only the new recorded messages will be played back.
 - To listen to all the recorded messages, press after the new messages have been played back.

Using the hand scanner

Scanning a document

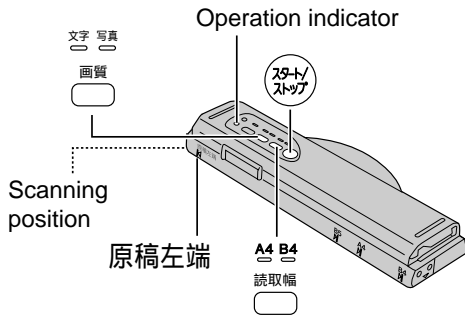

- 1** Press down the knob of the hand scanner, and pull out the scanner from the main unit. Then, turn it over.

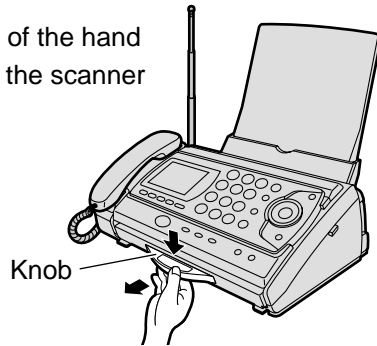

- 2** Press (Resolution) repeatedly to select the desired resolution.

- Resolution types
 - 文字 (Letter: For documents that consist of letters)
 - 写真 (Photo: For documents containing photographs, etc.)

- 3** Press (Scanning width) repeatedly to select the desired width.

- Scanning width types
 - A4 (Within 208mm)
 - B4 (Within 252mm)

- 4** Place the scanning position and the 原稿左端 (Document's left end) on the document.

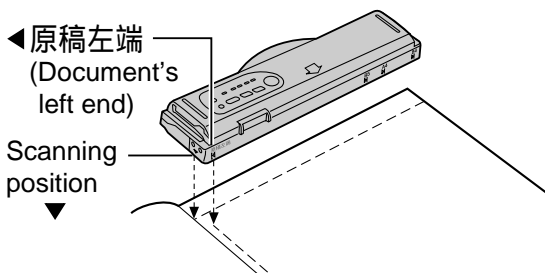

- 5** Press (Start).

- You will hear a beep, and the operation indicator will light green after about 1 or 2 seconds. You can start scanning after the operation indicator lights green.

- 6** Press the hand scanner against the document, and move it slowly towards the direction of the arrow (↓).

- When it is scanning properly, the operation indicator will flash green.
- For the proper scanning speed for different resolution types, see “Scanning speed and memory capacity” on the bottom of this page.

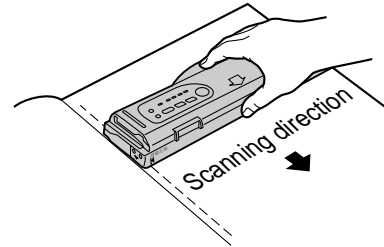

- 7** After scanning the document, press (Stop).

- 8** Insert the hand scanner in the main unit.

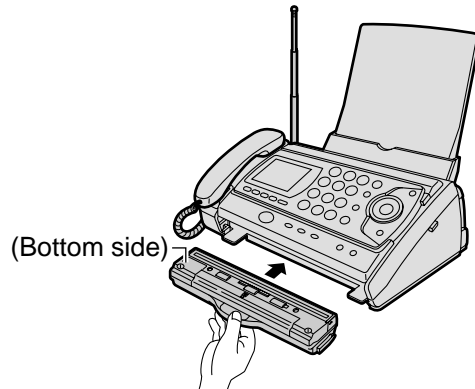

The number of scanned pages is displayed.

ヨミトリ マイスウ マイ
[クルクル, スタート]

Scanning speed and memory capacity

When the (Letter) indicator lights on, the resolution type automatically changes according to the scanning speed.

Resolution indicator	Scanning speed	Resolution type	Memory capacity
<input type="button" value="文字"/> (Letter) light on	50mm/ 1 sec	Fine	Approx. 10 pages (document paper size-A4, 700 letters)
	100mm/ 1 sec	Standard	Approx. 20 pages (document paper size-A4, 700 letters)
<input type="button" value="写真"/> (Photo) light on	25mm/ 1 sec	-	Approx. 1 page (document paper size-A4, photo)

Using the hand scanner

Operation indicator and warning beep

When scanning documents, check the operation indicator light.

Operation Indicator	Warning Beep	Situation	Remedy
Green light Slow flash	No beep	The document is being scanned properly. (Fine letter mode)	
Green light Fast flash	No beep	The document is being scanned properly. (Standard letter mode)	
Green light ON	No beep	The hand scanner has temporarily stopped during scanning. You did not move the hand scanner for more than 30 seconds, so it has stopped scanning automatically.	To start scanning again, press  (Start).
Red light ON	No beep	The hand scanner is being moved quickly. (The document is being scanned.)	Move it more slowly.
Red light ON	1 beep	The hand scanner is being moved too quickly. (Some parts of the document may not be scanned, or the scanned contents may be too compressed.)	Move it more slowly.
Light OFF	3 beeps	The scanner memory is full. (The memory indicator green light will flash fast.)	Delete the contents scanned in the scanner (See page 21).
		You have scanned a document that is more than 1.5m in length as 1 page.	Scan the document as 2 pages or more.
Light OFF	No beep	The scanner is not in operation.	

Memory indicator

Shows the amount of scanner memory being used.

Memory indicator (green light)	Memory used
OFF	0%
ON	~ 66%
Flash slow	~ 99%
Flash fast	100%

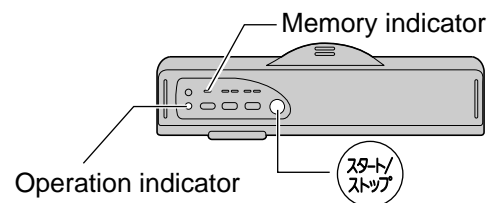

Using the hand scanner

Printing all pages of scanned content

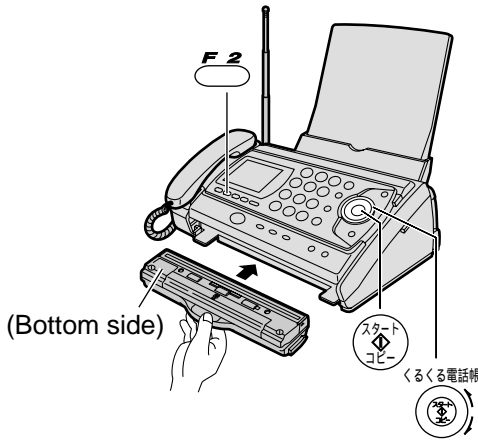

- 1 Insert the hand scanner in the main unit or press (Scanner).

Example: 10 pages

ヨミトリ	マイスウ	10マイ
[クルクル]	[スタート]	

The number of scanned pages is displayed.

- 2 Rotate the (Search dial) until the following is displayed.

イッカツ	インジ
[クルクル]	[スタート]

- 3 Press (Start).

トウハ	イ =A4	A4
[スタート]		[スタート]

- 4 Press (Start).

- Printing will start.

インジ	チュウ	1マイメ
-----	-----	------

Printing a specific page of scanned content

- 1 Insert the hand scanner in the main unit or press (Scanner).

Example: 10 pages

ヨミトリ	マイスウ	10マイ
[クルクル]	[スタート]	

The number of scanned pages is displayed.

- 2 Rotate the (Search dial) until the following is displayed.

ハ	-ジ	シテイ	インジ
[クルクル]	[スタート]		

- 3 Press (Start).

カイシ	ハ	-ジ	=01
[スウジ]	[トウロク]		

- 4 Enter the number of the first page that you want to print using 2 digits.

Example: page 7

カイシ	ハ	-ジ	=07
[スウジ]	[トウロク]		

- To correct a mistake, press (Clear).

- 5 Press (Register).

シュウリョウ	ハ	-ジ	=07
[スウジ]	[トウロク]		

- 6 Enter the number of the last page that you want to print using 2 digits.

Example: page 10

シュウリョウ	ハ	-ジ	=10
[スウジ]	[トウロク]		

- To correct a mistake, press (Clear).

- 7 Press (Register).

トウハ	イ =A4	A4
[スタート]		[スタート]

- 8 Press (Start).

- Printing will start.

インジ	チュウ	7マイメ
-----	-----	------

Using the hand scanner

Fax sending all pages of scanned content

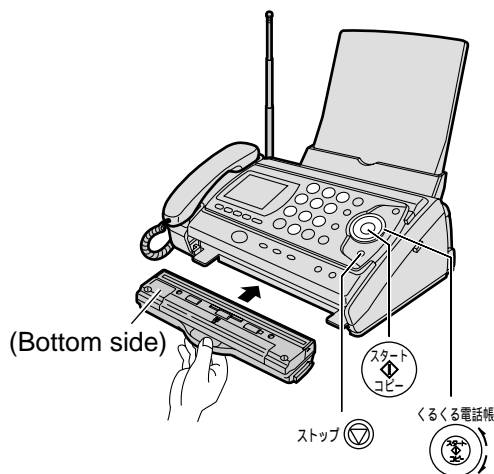

1 Insert the hand scanner in the main unit or press (Scanner).
Example: 10 pages

ヨミトリ	マイスウ	10マイ
[クルクル, スタート]		

 The number of scanned pages is displayed.

2 Rotate the (Search dial) until the following is displayed.

イッカツ	ソウシン
[クルクル, スタート]	

3 Press (Start).

ハ`ンゴ`ウ?

4 Dial the fax number.
Example: 09876543-

09876543`

5 Press (Start).
 • The unit will start fax transmission.

スキャナ-ソウシン 1マイメ

Fax sending a specific page of scanned content

1 Insert the hand scanner in the main unit or press (Scanner).
Example: 10 pages

ヨミトリ	マイスウ	10マイ
[クルクル, スタート]		

 The number of scanned pages is displayed.

2 Rotate the (Search dial) until the following is displayed.

ハ`-ジ`	シテイ	ソウシン
[クルクル, スタート]		

3 Press (Start).

カイシ	ハ`-ジ`=01
[スウジ`, トウロク]	

4 Enter the number of the first page that you want to send using 2 digits.
Example: page 7

カイシ	ハ`-ジ`=07
[スウジ`, トウロク]	

• To correct a mistake, press (Clear).

5 Press (Register).

シュウリョウ	ハ`-ジ`=07
[スウジ`, トウロク]	

6 Enter the number of the last page that you want to send using 2 digits.
Example: page 10

シュウリョウ	ハ`-ジ`=10
[スウジ`, トウロク]	

• To correct a mistake, press (Clear).

7 Press (Register).

ハ`ンゴ`ウ?

8 Dial the fax number.
Example: 09876543-

09876543`

9 Press (Start).
 • The unit will start fax transmission.

スキャナ-ソウシン 7マイメ

Using the hand scanner

Deleting all pages of scanned content

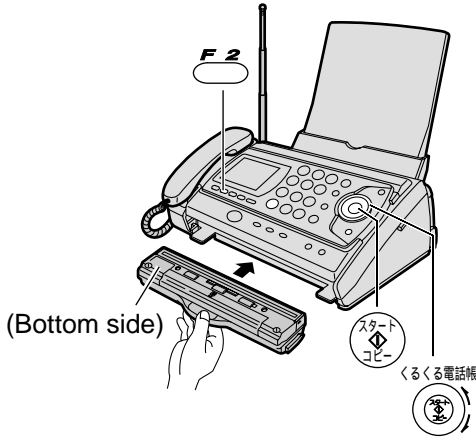

1 Insert the hand scanner in the main unit or press (Scanner).

Example: 10 pages

ヨミトリ	マイスウ	10マイ
[クルクル, スタート]		

The number of scanned pages is displayed.

2 Rotate the (Search dial) until the following is displayed.

イッカツ	ショウキョ
[クルクル, スタート]	

3 Press (Start).

スハ ^テ	ショウキョシマスカ?
ハイ=*	イイエ=#

4 Press .
• Deleting will start.

ショウキョ	シマシタ
-------	------

↓

ヨミトリ	マイスウ	0マイ
------	------	-----

Deleting the last page of scanned content

1 Press (Erase) until a beep is heard (Approx. 2 secs).
• The last page will be deleted.

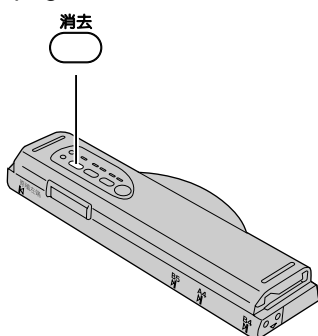

Deleting a specific page of scanned content

1 Insert the hand scanner in the main unit or press (Scanner).

Example: 10 pages

ヨミトリ	マイスウ	10マイ
[クルクル, スタート]		

The number of scanned pages is displayed.

2 Rotate the (Search dial) until the following is displayed.

ハ [°] -ジ [*]	シテイ	ショウキョ
[クルクル, スタート]		

3 Press (Start).

カイシ	ハ [°] -ジ [*] =01
[スウジ [*] , トウロク]	

4 Enter the number of the first page that you want to delete using 2 digits.

Example: page 7

カイシ	ハ [°] -ジ [*] =07
[スウジ [*] , トウロク]	

• To correct a mistake, press (Clear).

5 Press (Register).

シュウリョウ	ハ [°] -ジ [*] =07
[スウジ [*] , トウロク]	

6 Enter the number of the last page that you want to delete using 2 digits.

Example: page 10

シュウリョウ	ハ [°] -ジ [*] =10
[スウジ [*] , トウロク]	

• To correct a mistake, press (Clear).

7 Press (Register).

ショウキョ	シマスカ?
ハイ=*	イイエ=#

8 Press .
• Deleting will start.

ショウキョ	シマシタ
-------	------

↓

ヨミトリ	マイスウ	6マイ
[クルクル, スタート]		

Individual e-mail services

Using the e-mail services

Kyushu Matsushita Electric Co., Ltd. (hereafter called "KME") offers individual information services, such as e-mail.

Your fax machine with e-mail features will be able to send an e-mail to another party's personal computer (PC) or another e-mail fax machine anywhere in the world through the Internet. Also, you will be able to receive an e-mail from them.

To access the Internet using your fax machine, you have to subscribe to the following services beforehand.

- 77 SELECTY services offered by the KDDI, and
- Individual information services offered by KME.

When the **0077^{SELECTY}** indicator is off, you need to activate the service. Please refer to "Setting up 77 SELECTY services" in the right column.

Important:

- If your fax machine is connected to a home telephone system or a private branch exchange (PBX) system, these services are not available.

Application fee and call charges

KDDI 0077^{SELECTY} services	Registration fee	Free
KME information services	Registration fee	¥500
	Call charge	¥10/minute (8 am-11 pm) ¥8.5/minute (11 pm-8 am)
	Information service fee	¥5/30 s

- As of Nov. 2000.
- Tax not included.

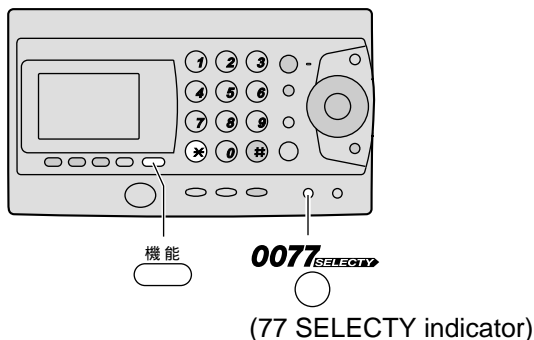

KME information services

The following services are available with your fax machine. A call charge and information service fee will be applied.

- Fax e-mail sending (page 24)
- Text e-mail sending (page 24)
- Voice e-mail sending (page 25)
- Storing another party's e-mail address (free of charge) (page 26)
- E-mail reception and printing (page 27)
- Voice e-mail listening (page 27)
- Others

Note:

- KME plans to add new information services and the information service fee is subject to change. KME will announce them by e-mail to its customers.
- For the PC user to view your fax e-mail or to hear your voice e-mail sent from your fax machine, the following PC software will be required.
 - E-mail software that can read the MIME format
 - TIFF viewer software
 - WAV sound player software and sound system

Setting up 77 SELECTY services

- 1 Press **機能** (Function).
 [キノウ トウロク モード
 [クルクル]]
- 2 Press **0077^{SELECTY}**.
 [77セレクトイ=アリ
 [*=アリ, #=ナシ]]
- 3 Press *****.
 [トウロク シマシタ
 ↓
 KDDIハ レンラク シマス]

- Your telephone number will be sent to KDDI.
- After about 1 minute, an online data communication will start between your unit and KDDI. After the communication has been completed, the **0077^{SELECTY}** indicator will turn green.

Note:

- Please contact KDDI Customer Service Center at 0077 772 (dial toll free) 9 am-9 pm in the following case:
 - If you are subscribing to NTT's discount service plan. (It may become ineffective by selecting 77 SELECTY services.)

Individual e-mail services

Subscribing to KME information services

- 1** Confirm that the **0077**  indicator is green.
- If the indicator is off, change the setting for 77 SELECTY (see page 22).

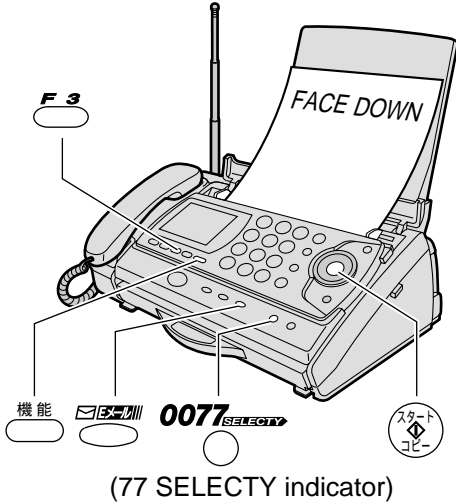

- 2** Fill in the included application form.

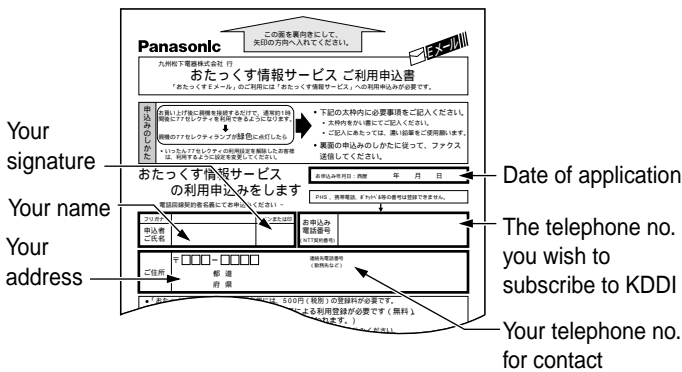

- 3** Press  (Function).

- 4** Press  (E-mail).

- 5** Press  (Start).

- Your telephone number will be displayed.

- 6** Press  (Register).

- 7** Insert the application form FACE DOWN.

- 8** Press  (Start).

- The unit will start fax transmission.
- After the fax transmission is completed, the following report will be printed.

Example:

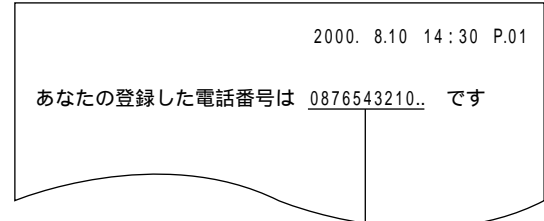

Confirm your telephone number.

- 9** After approx. 5 minutes, the unit will ring, and a data communication will start automatically between your unit and KME.

- If you answer this call, hang up immediately and wait for a while until the communication is completed.

- 10** When the communication is completed, a user registration form will be printed.

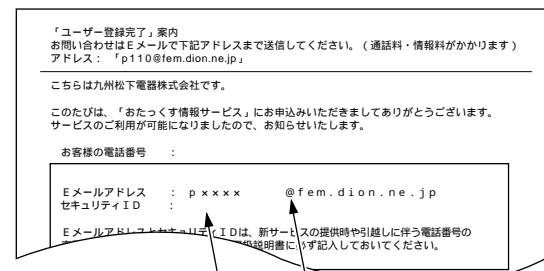

Your e-mail address
Your security ID code

- Please save the address and ID code for future reference.

- 11** Press  (E-mail).

- 12** Press  (Start).

- A information service guide will be printed.

Sending a fax e-mail

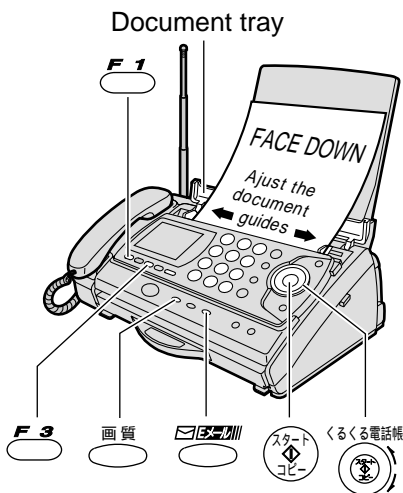

- 1** Open the document tray, and adjust the width of the document guides to the size of the document.
- 2** Insert the document (up to 5 pages) FACE DOWN until a single beep is heard.
- 3** If necessary, press (Resolution) repeatedly to select the desired setting (see page 13).
- 4** Press (E-mail).
- 5** Press (Start).
 - The display will show the last e-mail address you entered. To delete this address, press (Clear) for 2 or more seconds.
- 6** Enter the desired e-mail address (see the table on page 9 for instructions).
 - You can enter the address by rotating the (Search dial), then pressing (Register). To store an address, see page 26.
- 7** Press (Register).
 - The display will show the last title you entered. To delete this title, press (Clear) for 2 or more seconds.
- 8** Enter the title of your fax e-mail, up to 32 characters (see the table on page 9 for instructions).
- 9** Press (Register).

Sending a text e-mail

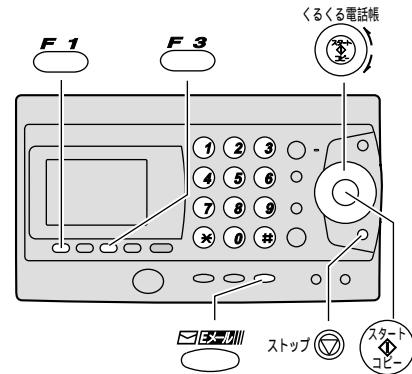

- 1** Press (E-mail).
- 2** Rotate the (Search dial) until the following is displayed.

モシ	メール	ソウジン
[クルクル, スタート]		
- 3** Press (Start).
 - The display will show the last e-mail address you entered. To delete this address, press (Clear) for 2 or more seconds.
- 4** Enter the desired e-mail address (see the table on page 9 for instructions).
 - You can enter the address by rotating the (Search dial), then pressing (Register). To store an address, see page 26.
- 5** Press (Register).
 - The display will show the last title you entered. To delete this title, press (Clear) for 2 or more seconds.
- 6** Enter the title of your e-mail, up to 32 characters (see the table on page 9 for instructions).
- 7** Press (Register).
 - The display will show the last message you entered. To delete this message, press (Clear) for 2 or more seconds.
- 8** Enter your e-mail message, up to 200 characters (see the table on page 9 for instructions).
- 9** Press (Register).

Sending a voice e-mail

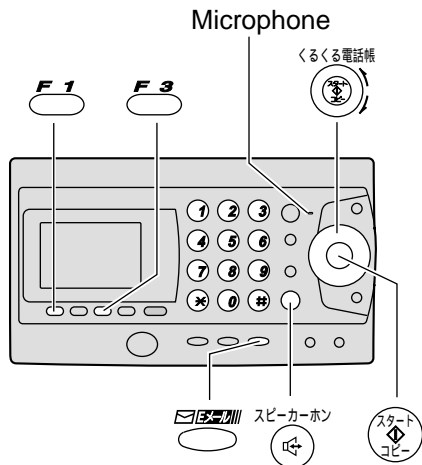

1 Press  (E-mail).



2 Rotate the  (Search dial) until the following is displayed.

オンセイ	エメール	ソウシン
[クルクル, スタート]		

3 Press  (Start).

- The display will show the last e-mail address you entered. To delete this address, press  (Clear) for 2 or more seconds.

4 Enter the desired e-mail address (see the table on page 9 for instructions).

- You can enter the address by rotating the  (Search dial), then pressing  (Register). To store an address, see page 26.

5 Press  (Register).

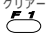
- The display will show the last title you entered. To delete this title, press  (Clear) for 2 or more seconds.

6 Enter the title of your e-mail, up to 32 characters (see the table on page 9 for instructions).

7 Press  (Register).

- An announcement about how to record will be heard.

8 Record your voice message up to 60 seconds, following voice guidance, using the microphone or the handset.

9 Press  (Speakerphone) to finish recording, or replace the handset if you are using it.

Individual e-mail services

Storing another party's e-mail address in the search dial

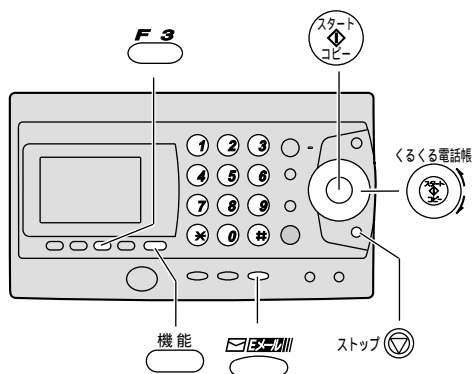

- 1 Press **機能** (Function).
- 2 Press **E-mail** (E-mail).
- 3 Rotate the **くるくる電話帳** (Search dial) until the following is displayed.

アト`レス	チョウ	トウロク
[クルクル, スタート]		
- 4 Press **スタート/コピー** (Start).
- 5 Enter the name, up to 12 characters (see the table on page 9 for instructions).
- 6 Press **登録 F3** (Register).
- 7 Enter the e-mail address, up to 60 characters (see the table on page 9 for instructions).
- 8 Press **登録 F3** (Register).
 - To program other items, repeat steps 5–8.
 - You can store up to 30 stations.
- 9 Press **ストップ** (Stop) to exit the program.

Editing a stored e-mail address

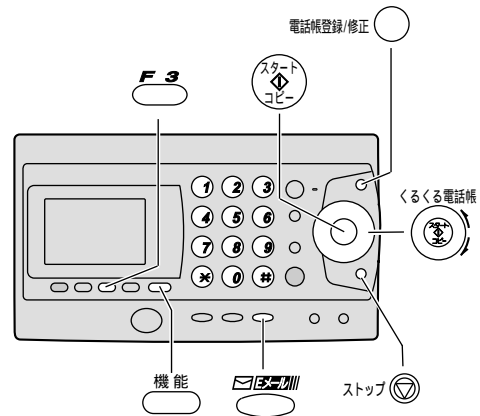

- 1 Press **機能** (Function).
- 2 Press **E-mail** (E-mail).
- 3 Rotate the **くるくる電話帳** (Search dial) until the following is displayed.

アト`レス	チョウ	カクニン
[クルクル, スタート]		
- 4 Press **スタート/コピー** (Start).
- 5 Rotate the **くるくる電話帳** (Search dial) until the desired name is displayed.
- 6 Press **電話帳登録/修正** (Phonebook).
 - If you do not need to edit the name, skip to step 8.
- 7 Edit the name (see the table on page 9 for instructions).
- 8 Press **登録 F3** (Register).
 - If you do not need to edit the e-mail address, skip to step 10.
- 9 Edit the e-mail address (see the table on page 9 for instructions).
- 10 Press **登録 F3** (Register).
- 11 Press **ストップ** (Stop).

Individual e-mail services

Receiving and printing an e-mail

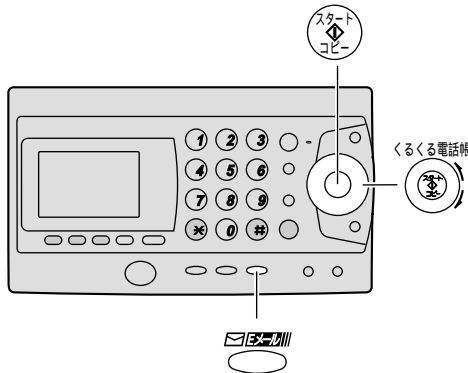

1 Press  (E-mail).

2 Press  (Start).

- If there is an e-mail you have not viewed yet:

エメール ツウシン チュウ
ツウシン チュウ

The unit will print the received e-mail.

- If there is no e-mail:

ミシ ュシンエメール 0ケン

Press  (Stop).

The file formats recognized by your fax machine are:

- JPEG
- TIFF
- BMP
- TXT
- WAV
- ~. doc
- ~. xls
- ~. ppt
- ~. pdf

(as of Nov. 2000)

Listening to a received voice e-mail in an attached file

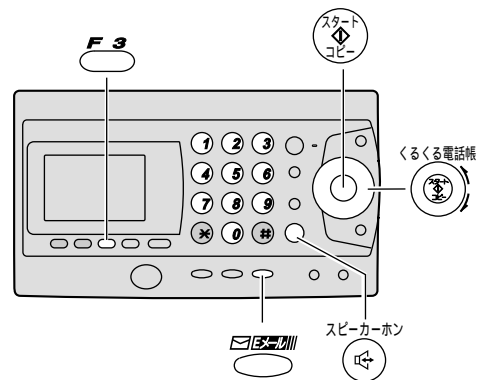

1 Press  (E-mail).

2 Rotate the  (Search dial) until the following is displayed.

オンセイ エメール シュウシン
[クルクル, スタート]

3 Press  (Start).

4 Enter the document number with 4 digits.

- See the example below about document number.

5 Press  (Register).

6 Listen to an announcement through the speaker or the handset.

7 Listen to the voice message following voice guidance.

8 Press  (Speakerphone) to finish listening, or replace the handset if you are using it.

Note:

- You can hear a voice in WAV format only.
- Voice data will be saved for 1 week in the server after the e-mail has been received.

Example of received e-mail document:

受信日時：2000/03/10 18:41 合計1ページ
 タイトル：連絡
 送信日時：2000/03/10 18:40:05
 差出人：p x x x x @fem.dion.ne.jp
 宛先：p x x x x @fem.dion.ne.jp
 同報宛先：p x x x x @fem.dion.ne.jp
 文書番号：0001 ← Document number

Specifications

KX-PW37CL/ PW47CL/PW57CL	Main unit	Portable handset	Battery charger	Hand scanner
Power supply	AC 100 V (50 Hz/60 Hz)	Ni-Cd battery (Part no. KX-FAN37) DC 2.4 V, 600 mAh	AC adaptor (Part no. PFAP1009) AC 100 V (50 Hz/60 Hz) DC 7.5 V, 100 mA	Ni-Cd battery (Part no. KX-FAN38) DC 3.6 V, 600 mAh
Power consumption	Transmission: Approx. 17W Reception: Approx. 18W Copy: Approx. 20W Stand by: Approx. 1.7W Maximum(*1): Approx. 120W		• Charging: Approx. 1.1W • Stand by: Approx. 0.4W	
Dimensions (H x W x D)	Approx. 139 x 344 x 262 mm (without projections) Approx. 378 x 344 x 310 mm (recording paper tray installed)	Approx. 181x44x40 mm	Approx. 72x72x90 mm	Approx. 35x274x81 mm (without projections)
Mass (Weight)	Approx. 3.9 kg (10 m ink film installed)	Approx. 170 g (battery installed)	Approx. 77g	Approx. 340 g (battery installed)
Operating environment	5 °C – 35 °C, 45 % – 85 % RH (Relative Humidity)			

KX-PW37CL/ PW47CL/PW57CL	Main unit	Hand scanner
Applicable line	Public Switch Telephone Network (Tone/Pulse), F-Net, NCC Lines	
DC resistance	320 Ω (*2)	
Compatibility	G3 compatible	
Document size	B4-A5(Max.257 mm in width, Max. 800 mm in length)	
Effective scanning size	252 mm (B4) 208 mm (A4)	Max. 252 mm (B4)
Effective printing size	202 mm (A4 size plain paper)	
Transmission time	Approx. 15 s/page (Original mode) (*3)	
Modem speed	9,600 / 7,200 / 4,800 / 2,400 bps; Automatic fallback	
Halftone level	64-level	
Scanning density	Horizontal: 8 pels/mm Vertical: 7.7 lines/mm (Fine/Photo), 3.85 lines/mm (Standard)	Horizontal:8 pels/mm Vertical: 7.7 lines/mm
Scanner type	CCD image sensor	CCD image sensor
Printer type	Thermal transfer printing on plain paper	
Data compression system	Modified Huffman (MH), Original mode	
Recording paper size	A4: 210 mm x 297 mm (Plain paper)	
Answering device	Greeting message: Digital recording system (up to 16 sec) Pre-recording greeting message ICM Recording: Digital recording system (Approx. 18 min. in total) (*4)	
Memory capacity	Max. Approx. 50 pages (Only receiving fax etc.) (*5) Max. Approx. 18 min. (Only Recording message) (*4)	20 pages Text (Standard) (*5) 10 pages Text (Fine) (*5) Approx. A4 1 page (Photo)
Talk time during power failure	After the hand scanner battery has been charged for about 10 hours: • Successive talk time :Approx. 90 min. • Standby time :Approx. 10 hours	

*1 When copying a 100% black document.

*2 If you cannot make a call due to DC resistance, consult your dealer.

*3 Transmission speed is based on an A4-size document of 700 characters sent in standard resolution at 9,600 bps. The actual transmission speed depends upon the contents of the page, resolution, telephone line conditions and capability of the other party's machine.

*4 If there is a silent pause, the total recording time will be longer.

*5 The memory capacity is based on an A4-size document of 700 characters.