



# REPLACING THE MAIN POWER PANEL

To ensure that Human Touch® products are repaired in a manner that is fully consistent with the practices used during the manufacturing process, Human Touch requires that all product repairs are performed using only factory-new parts and in accordance with these product repair instructions.

SERVICE LEVEL: 2

**Tools Required:** Phillips-head screwdriver, utility blade, flat-head screwdriver.

SAVE ALL REMOVED PARTS FOR USE DURING REASSEMBLY

## REMOVING THE MAIN POWER PANEL

1. Power off the chair then unplug it. 
2. Using a utility blade, peel the label off the main power panel, located on the left-hand side of the chair (Fig.1).  
Note: Be sure to record the serial number that is printed on the power panel label before discarding it.  
The serial number is required for warranty service.
3. Using a Phillips-head screwdriver, remove the two screws that secure the power panel to the chair (Fig.1).
4. Using a flat-head screwdriver, pry the panel out of the chair enough to expose the connectors, then disconnect the connectors (Fig.2).
5. Remove the power panel from the chair (Fig.3).

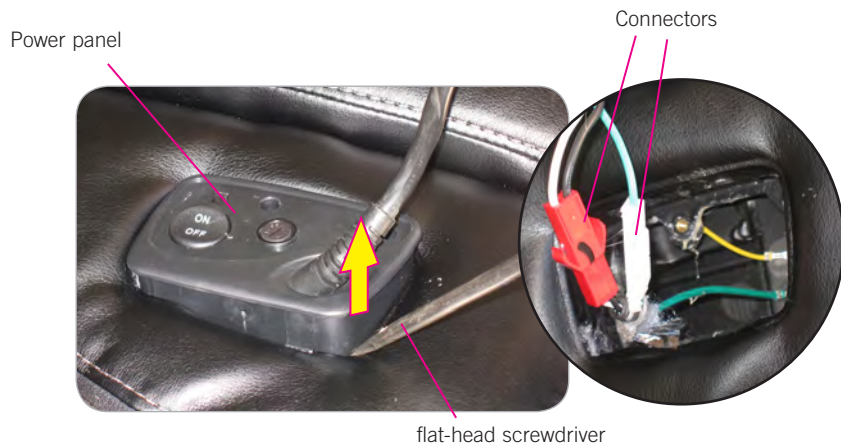
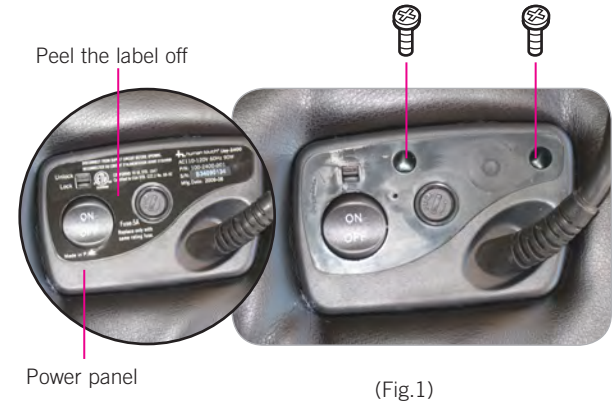

(Fig.2)

(Fig.3)

## INSTALLING THE NEW POWER PANEL

1. Connect the new power panel connectors to the corresponding connectors on the side of the chair (Fig.4).
2. Insert the power panel into the opening in the side of the chair, then press firmly until the power panel face plate is flush with the chair upholstery (Fig.5).
3. Using a Phillips-head screwdriver, replace the two screws to secure the power panel to the chair (Fig.6).
4. Carefully apply the new power panel label to the power panel, smoothing it with your fingers.

Connect the connectors

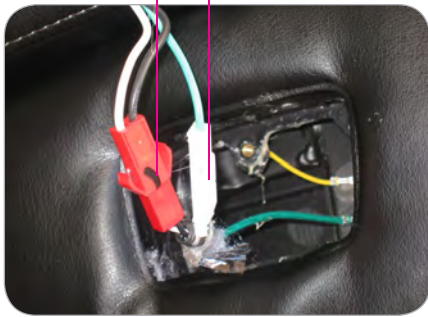

(Fig.4)

New power panel



(Fig.5)

New power panel

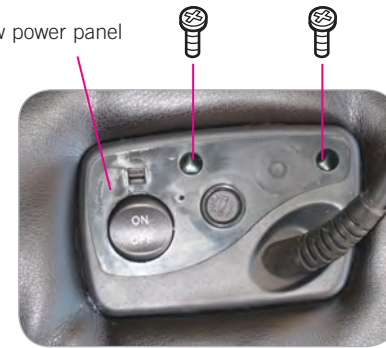

(Fig.6)

Apply new label

