

DVD Micro Theatre

MCD289

Register your product and get support at

www.philips.com/welcome

User manual

Manuel d'utilisation

Manual del usuario

Benutzerhandücher

Gebruikershandleidingen

Manuale per l'utente

Användarhandböckerna

Brugermanual



PHILIPS

Important notes for users in the U.K.

Mains plug

This apparatus is fitted with an approved 13 Amp plug. To change a fuse in this type of plug proceed as follows:

- 1 Remove fuse cover and fuse.
- 2 Fix new fuse which should be a BS1362 3 Amp, A.S.T.A. or BSI approved type.
- 3 Refit the fuse cover.

If the fitted plug is not suitable for your socket outlets, it should be cut off and an appropriate plug fitted in its place.

If the mains plug contains a fuse, this should have a value of 3 Amp. If a plug without a fuse is used, the fuse at the distribution board should not be greater than 3 Amp.

Note: The severed plug must be disposed of to avoid a possible shock hazard should it be inserted into a 13 Amp socket elsewhere.

How to connect a plug

The wires in the mains lead are coloured with the following code: blue = neutral (N), brown = live (L).

- As these colours may not correspond with the colour markings identifying the terminals in your plug, proceed as follows:
 - Connect the blue wire to the terminal marked N or coloured black.
 - Connect the brown wire to the terminal marked L or coloured red.
 - Do not connect either wire to the earth terminal in the plug, marked E (or \perp) or coloured green (or green and yellow).

Before replacing the plug cover, make certain that the cord grip is clamped over the sheath of the lead - not simply over the two wires.

Copyright in the U.K.

Recording and playback of material may require consent. See Copyright Act 1956 and The Performer's Protection Acts 1958 to 1972.

Italia

DICHIARAZIONE DI CONFORMITA'

Si dichiara che l'apparecchio MCD289 Philips risponde alle prescrizioni dell'art. 2 comma 1 del D.M. 28 Agosto 1995 n. 548.

Fatto a Eindhoven

Philips Consumer Electronics
Philips, Glaslaan 2
5616 JB Eindhoven, The Netherlands

Norge

Typeskilt finnes på apparatens underside.

Observer: Nettbryteren er sekundert innkopleet. Den innebygde nettdelen er derfor ikke frakopleet nettet så lenge apparatet er tilsluttet nettkontakten.

For å redusere faren for brann eller elektrisk støt, skal apparatet ikke utsettes for regn eller fuktighet.

CAUTION

Use of controls or adjustments or performance of procedures other than herein may result in hazardous radiation exposure or other unsafe operation.

VAROITUS

Muiden kuin tässä esitettyjen toimintojen säädön tai asetusten muutto saattaa altistaa vaaralliselle säteilylle tai muille vaarallisille toiminnoille.

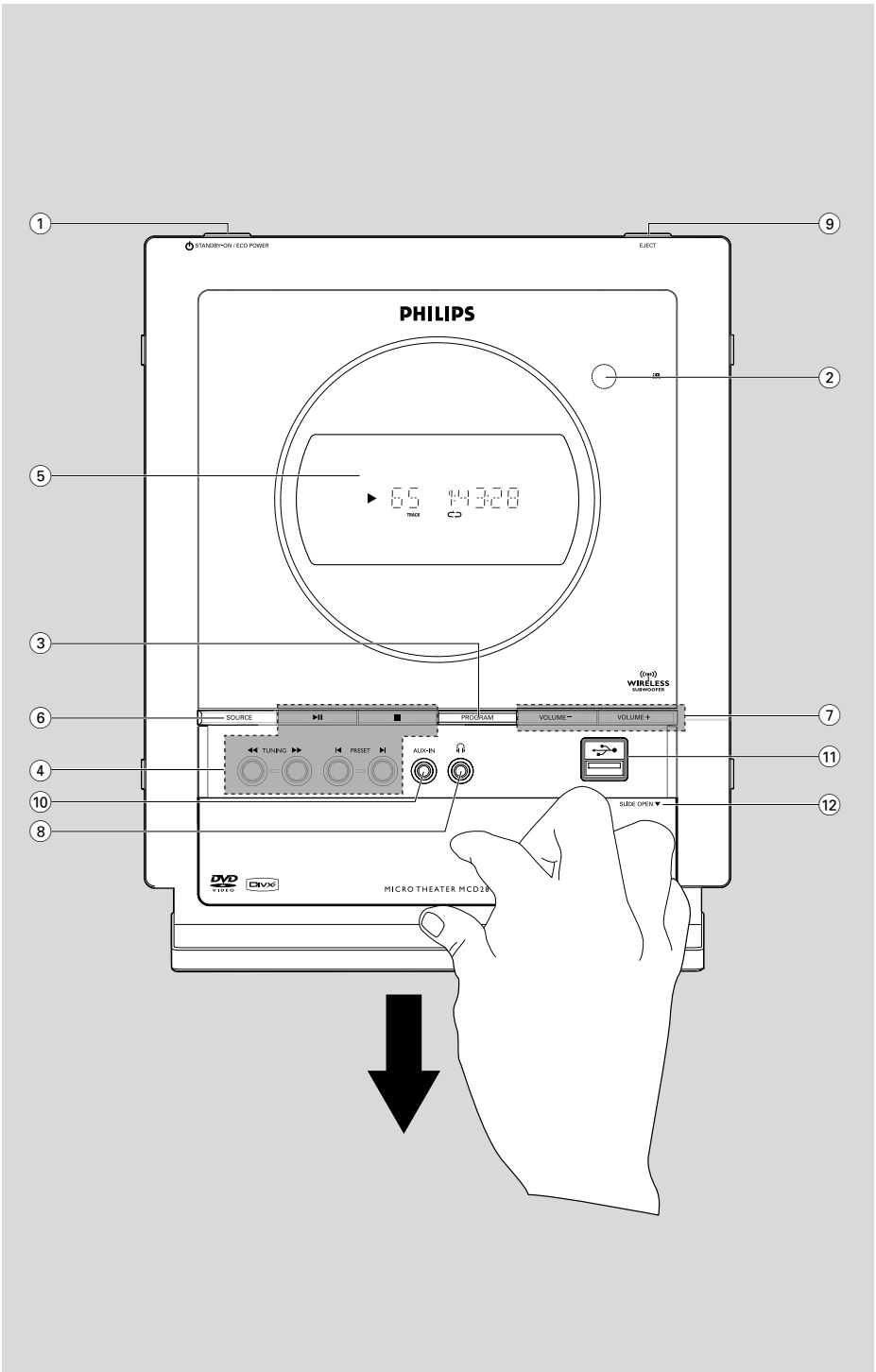

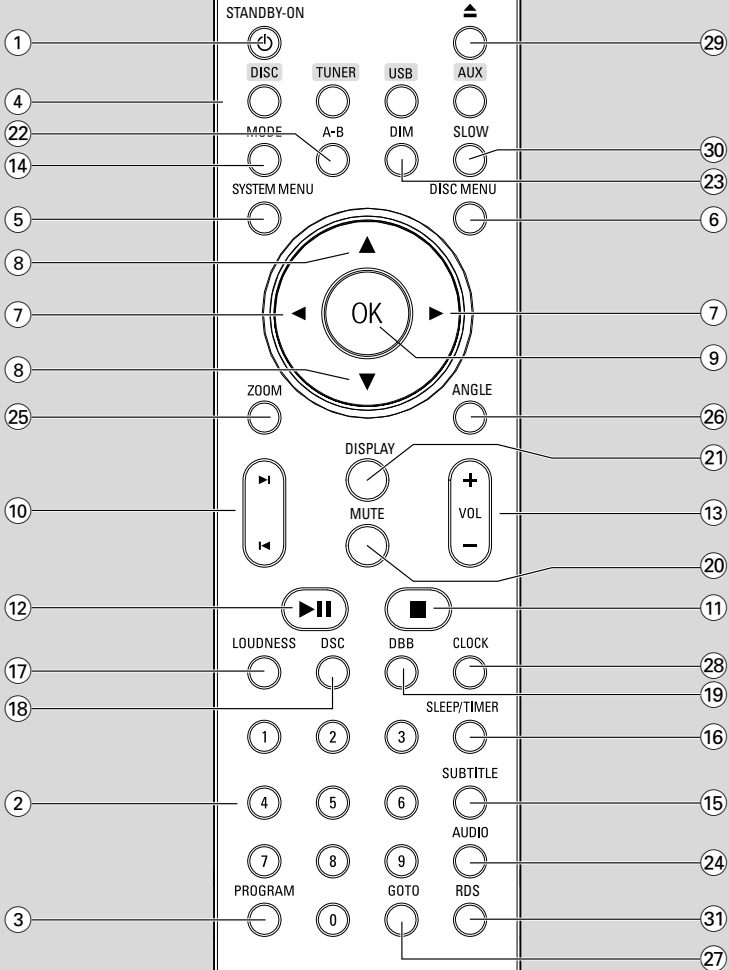

DK

Advarsel: Usynlig laserstråling ved åbning når sikkerhedsafbrydere er ude af funktion. Undgå udsættelse for stråling.

Bemærk: Netafbryderen er sekundært indkoblet og afbryder ikke strømmen fra nettet. Den indbyggede netdel er derfor tilsluttet til lysnettet så længe netstikket sidder i stikkontakten.

S

Klass 1 laserparat

Varning! Om apparaten används på annat sätt än i denna bruksanvisning specificerats, kan användaren utsättas för osynlig laserstrålning, som överskrider gränsen för laserklass 1.

Observera! Stömbrytaren är sekundärt kopplad och bryter inte strömmen från nätet. Den inbyggda nätdelen är därför ansluten till elnätet så länge stickproppen sitter i vägguttaget.

SF

Luokan 1 laserlaite

Varoitus! Laitteen käyttäminen muulla kuin tässä käyttöohjeessa mainitulla tavalla saattaa altistaa käyttäjän turvallisuusluokan 1 ylittävälle näkymättömälle lasersäteilylle.

Oikeus muutoksiin varataan. Laite ei saa olla alttiina tippu-ja roiskevedelle.

Huom. Toiminnanvalitsin on kytketty toisiopuolelle, eikä se kytke laitetta irti sähköverkosta. Sisäänrakennettu verkko-osa on kytkettyinä sähköverkkoon aina silloin, kun pistoke on pistorasiassa.

Manufactured under license from Dolby Laboratories.

"Dolby", "Pro Logic" and the double-D symbol are trademarks of Dolby Laboratories.

This product incorporates copyright protection technology that is protected by method claims of certain U.S. patents and other intellectual property rights owned by Macrovision Corporation and other rights owners. Use of this copyright protection technology must be authorized by Macrovision Corporation, and is intended for home and other limited viewing uses only unless otherwise authorized by Macrovision Corporation. Reserve engineering or disassembly is prohibited.

DivX, DivX Certified, and associated logos are trademarks of DivX Networks, Inc and are used under license.



Windows Media is a trademark of Microsoft Corporation.

Index

English 8

Français 32

Español 57

Deutsch 82

Nederlands 97

Italiano 122

Svenska 147

Dansk 171

English

Français

Español

Deutsch

Nederlands

Italiano

Svenska

Dansk

Contents

General Information

Discs for playback	10
Region Codes	10
Supplied accessories	10
Environmental information	10
Care and safety information	10~11
Hearing Safety	11

Installation

Step 1: Connecting speakers	12
Connecting the wireless subwoofer	12
Step 2: FM antenna connection	12
Step 3: Connecting TV	12~13
Using A/V OUT jack	13
Using S-Video In jack	13
Using Component Video jacks (Y Pb Pr)	13
Step 4: Placing the set and speakers	14
Step 5: Connecting the power supply	14
Optional: Connecting additional equipment	14
Listening to the playback of a non-USB device	14
Connecting a USB device or memory card	14

Controls

Controls on the system	15
Controls on the remote control	15~16

Preparations

Step 1: Using the remote control	17
Using the Remote Control to operate the Player	17
Step 2: Setting the clock	17
Step 3: Setting video preference	17~18
Setting up Progressive Scan feature	17
To deactivate Progressive manually	17~18
Step 4: Setting language preference	18

Basic Functions

Switching the system on/off	19
Switching the system to Eco Power Standby mode	19
Power-saving automatic standby	19
Sound Control	19
DBB (Dynamic Bass Boost)	19
DSC (Digital Sound Control)	19
LOUDNESS	19
Volume control	19
Dimming the display screen	19

Disc Operations

Playing discs	20
Using the disc menu	20
Basic playback controls	20
Pausing playback	20
Selecting a track/chapter/title	20
Resuming playback from the last stopped point	20
Zoom	20
Different play modes: SHUFFLE and REPEAT	20
Repeat A-B	20
Slow Motion	21
Forward/Reverse Searching	21
Time search & search by chapter/track number	21
Information display during playback	21
Special disc features	21
Playing a Title	21
Camera Angle	21
Changing the Audio Language	21
Changing the Audio Channel	21
Subtitles	21
Playing MP3/WMA/JPEG Picture disc	21
General operation	21
Special JPEG features	22
Zoom picture	22
Playback with multi-angles	22
Playing a DivX disc	22

System Menu Options

Basic operations	23
GENERAL SETUP PAGE	23
TV DISPLAY	23
OSD LANGUAGE	23
SCREEN SAVER	23
DIVX(R) VOD registration code	23
AUDIO SETUP PAGE	23~24
ANALOG AUDIO SETUP	23
DIGITAL AUDIO SETUP	23
DOLBY DIGITAL SETUP	23
3D	23
HDCD	23
NIGHT MODE	24
VIDEO SETUP PAGE	24
COMPONENT	24
TV MODE	24
PICTURE SETTING	24
PREFERENCE PAGE	24
PARENTAL	24
DEFAULT	24
PASSWORD SETUP	24

Radio Reception

Tuning to radio stations	25
Programming radio stations	25
Automatic programming	25
Manual programming	25
Tuning to preset radio stations	25
RDS	25
Setting the RDS clock	25

External Sources

Using a USB mass storage device	26
---------------------------------------	----

Clock/Timer

Clock setting	27
Timer setting	27
Sleep timer setting	27

Specifications	28
-----------------------------	----

Troubleshooting	29~31
------------------------------	-------

Disposal of your old product

Your product is designed and manufactured with high quality materials and components, which can be recycled and reused.

When this crossed-out wheeled bin symbol is attached to a product it means the product is covered by the European Directive 2002/96/EC



Please inform yourself about the local separate collection system for electrical and electronic products.

Please act according to your local rules and do not dispose of your old products with your normal household waste. The correct disposal of your old product will help prevent potential negative consequences for the environment and human health.

General Information

Congratulations on your purchase and welcome to Philips!

To fully benefit from the support that Philips offers, register your product at www.philips.com/ welcome.

Discs for playback

Your DVD System will play:

- Digital Video Discs (DVDs)
- Video CDs (VCDs)
- SuperVideo CDs (SVCDs)
- Digital Video Discs + Rewritable (DVD+RW)
- Compact Discs (CDs)
- Picture (Kodak, JPEG) files on CDR(W)
- Windows Media Audio (WMA)
- DivX(R) disc on CD-R(W):
- DivX 3.11, 4.x and 5.x
- Supported MP3-CD format.
- ISO 9660 / UDF format
- Max. title/album name –10 characters
- Max. title number plus album is 255.
- Max. nested directory is 8 levels.
- The max. album number is 32.
- The max. MP3 track number is 999.
- Supported sampling frequencies for MP3 disc: 32 kHz, 44.1 kHz, 48 kHz.
- Supported Bit-rates of MP3 disc are: 32, 64, 96, 128, 192, 256 (kbps).

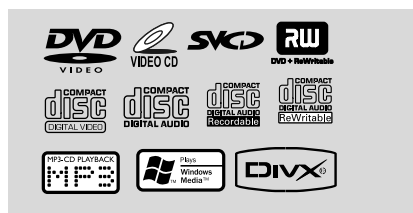

The following formats can't be supported

- The files like *.VMA, *.AAC, *.DLF, *.M3U, *.PLS, *.WAV,
- The discs recorded under Joliet format

Region Codes

DVDs must be labeled as shown below in order to play on this DVD system. You cannot play discs that are labeled for other regions.



Notes:

- For mixed mode discs, only one mode will be selected for playback according to the recording format.
- If you are having trouble playing a certain disc, remove the disc and try a different one. Improperly formatted discs will not play on this system.

Supplied accessories

- A/V cord (R/W/Y)
- FM wire antenna
- 1 X certified power adapter (Brand name: PHILIPS, Model No.: GFP451DA-2419-1 Input: 100-240V ~ 50/60Hz 1.2A Output: 24V === 1.9A)
- Stand
- Remote Control and two AAA batteries
- This instruction booklet and a quick start guide

Environmental information

All unnecessary packaging has been omitted. We have tried to make the packaging easy to separate into three materials: cardboard (box), polystyrene foam (buffer) and polyethylene (bags, protective foam sheet).

Your system consists of materials which can be recycled and reused if disassembled by a specialised company. Please observe the local regulations regarding the disposal of packaging materials, exhausted batteries and old equipment.

Care and safety information

Avoid high temperatures, moisture, water and dust

- Do not expose the system, batteries or discs to humidity, rain, sand or excessive heat (caused by heating equipment or direct sunlight).
- No objects filled with liquids, such as vases, shall be placed on the apparatus.
- No naked flame sources, such as lighted candles, should be placed on the apparatus.
- The apparatus shall not be exposed to dripping or splashing.

Avoid condensation problem

- The lens may cloud over when the player is suddenly moved from cold to warm surroundings, making it impossible to play a disc. Leave the player in the warm environment until the moisture evaporates.

Do not block the vents

- Do not operate the system in an enclosed cabinet and allow about 10 cm (4 inches) of free space all around the player for adequate ventilation.
- The ventilation should not be impeded by covering the ventilation openings with items, such as newspapers table-cloths, curtains, etc.

Cleaning the cabinet

- Use soft cloth slightly moistened with a mild detergent solution. Do not use a solution containing alcohol, spirits, ammonia or abrasives.

Cleaning discs

- To clean a CD, wipe it in a straight line from the center towards the edge using soft and lint-free cloth. A cleaning agent may damage the disc.
- Write only on the printed side of a CDR(W) and only with a soft felt-tipped pen.
- Handle the disc by its edge. Do not touch the surface.



Finding a suitable location

- Place the player on a flat, hard, stable surface.
- Install this unit near the AC outlet and where the AC power plug can be reached easily.

Hearing Safety

Listen at a moderate volume.

- Using headphones at a high volume can impair your hearing. This product can produce sounds in decibel ranges that may cause hearing loss for a normal person, even for exposure less than a minute. The higher decibel ranges are offered for those that may have already experienced some hearing loss.
- Sound can be deceiving. Over time your hearing "comfort level" adapts to higher volumes of sound. So after prolonged listening, what sounds "normal" can actually be loud and harmful to your hearing. To guard against this, set your volume to a safe level before your hearing adapts and leave it there.

To establish a safe volume level:

- Set your volume control at a low setting.
- Slowly increase the sound until you can hear it comfortably and clearly, without distortion.

Listen for reasonable periods of time:

- Prolonged exposure to sound, even at normally "safe" levels, can also cause hearing loss.
- Be sure to use your equipment reasonably and take appropriate breaks.

Be sure to observe the following guidelines when using your headphones.

- Listen at reasonable volumes for reasonable periods of time.
- Be careful not to adjust the volume as your hearing adapts.
- Do not turn up the volume so high that you can't hear what's around you.
- You should use caution or temporarily discontinue use in potentially hazardous situations.
- Do not use headphones while operating a motorized vehicle, cycling, skateboarding, etc.; it may create a traffic hazard and is illegal in many areas.

Installation

IMPORTANT!

- The type plate is located at the rear of the system.
- Before connecting the AC power cord to the wall outlet, ensure that all other connections have been made.
- Never make or change any connections with the power switched on.

Step 1: Connecting speakers

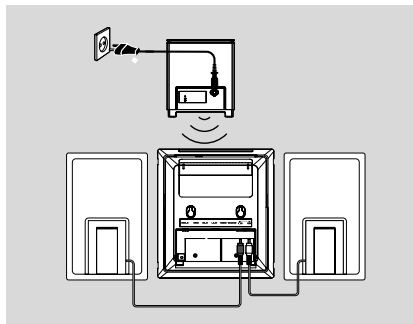

- 1 Place the main set with the front side facing down on a flat and firm surface. Then remove the detachable cover on the back of the set to expose the terminals available for connection.
- 2 Connect the two front speaker cables to the **SPEAKERS** terminals: right speaker to "RIGHT" and left speaker to "LEFT".

Notes:

- Ensure that the speaker cables are correctly connected. Improper connections may damage the system due to short-circuit.
- For optimal sound performance, use the supplied speakers.
- Do not connect more than one speaker to any one pair of +/- speaker terminals.
- Do not connect speakers with an impedance lower than the speakers supplied. Please refer to the SPECIFICATIONS section of this manual.

Connecting the wireless subwoofer

- Power on both the main set and subwoofer.
→ Wireless connection will set up automatically.

In case the wireless connection fails due to conflict or strong interference etc., you may need the following procedures for manual pairing:

- 1 In standby mode, press and hold **▶||** on the set for three seconds.
→ "PAIRING" flashes on the display screen.
- 2 Press and hold the **PAIR** button on the rear of the subwoofer for three seconds.
→ The LED indicator on the subwoofer flashes.

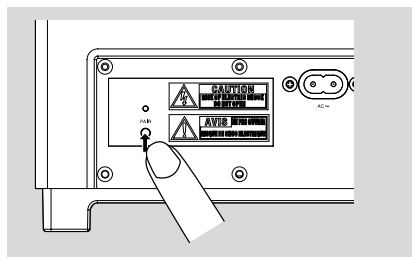

- If the connection succeeds, the display shows "PAIR OK".
- If the connection fails or the connection cannot be set up successfully within 60 seconds, the display shows "PAIR FAIL".

Notes:

- The wireless connection will be disconnected automatically after power-off.
- See "Basic Functions - Switching the system to Eco Power Standby mode" for how to switch between Eco Power Standby mode and standby mode.

Step 2: FM antenna connection

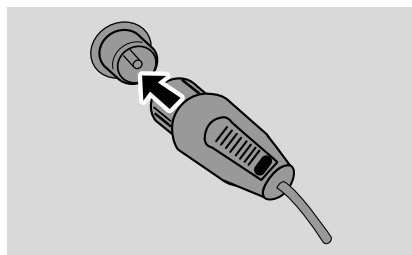

- Connect the supplied FM antenna to the **FM AERIAL** terminal.

Step 3: Connecting TV

IMPORTANT!

- You only need to make one video connection from the following options, depending on the capabilities of your TV.

– Connect the DVD system directly to the TV.

Using A/V OUT jack

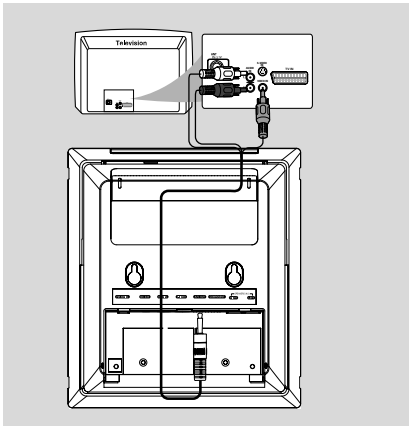

- 1 Connect the end of the supplied AV cord with only one connector to the **A/V OUT** jack of the DVD system.
- 2 For the other end, connect the video output connector (yellow) to the video input jack (or labeled as A/V In, CVBS, Composite or Baseband) on the TV. To hear the sound of this DVD system through your TV, connect the audio connectors (white/ red) to the audio input jacks on the TV.

Using S-Video In jack

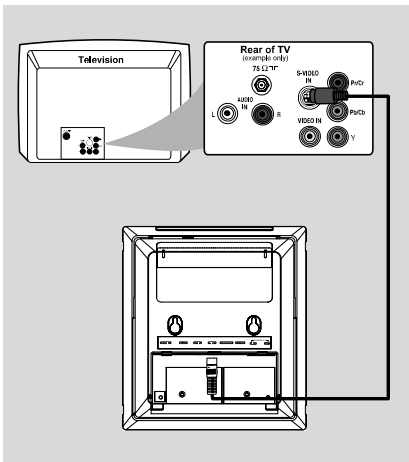

- 1 Use the S-Video cable (not supplied) to connect the system's **S-VIDEO** jack to the S-Video input jack (or labeled as Y/C or S-VHS) on the TV set.

Using Component Video jacks (Y Pb Pr)

IMPORTANT!

– The progressive scan video quality is only possible when using Y Pb Pr, and a progressive scan TV is required.

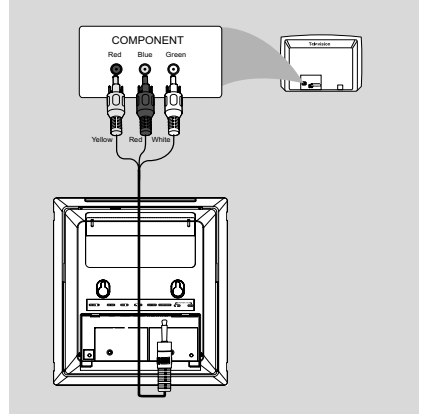

- 1 Use the supplied AV cord (red/white/yellow) to connect the **COMPONENT** jack to the corresponding Component video input jacks (or labeled as Y Pb/Cb Pr/Cr or YUV) on the TV: yellow connector to the red jack, red connector to the blue jack, white connector to the green jack.
- 2 If you are using a Progressive Scan TV (TV must indicate Progressive Scan or ProScan capability), to activate TV Progressive Scan, please refer to your TV user manual. For DVD system Progressive Scan function, see "Preparations-Setting up Progressive Scan feature".

Note:

– If your TV does not support Progressive Scan, you will not be able to view the picture.

Press **SYSTEM MENU** on the remote to exit the system menu and then **DISC** and "1" to exit progressive scan.

Installation

Step 4: Placing the set and speakers

- 1 After finishing all rear connections, mount the detachable cover on the back of the set until hearing a click to avoid cable clutter:

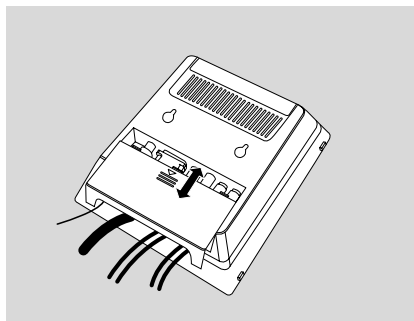

- 2 Align the side marked **PRESS▼** of the stand to the slots at the bottom of the set.

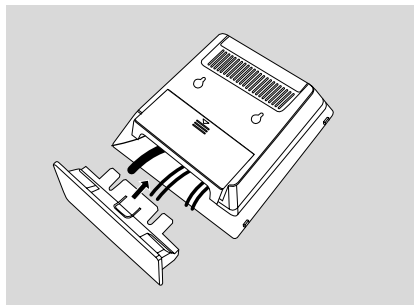

- 3 Push the stand down into the slots until you hear a click.
- 4 Place the set upright on the desktop with the support of the stand.
- 5 Extend the bracket on the back of each front speaker as shown so that the front speakers can stand firmly on the desktop.
- 6 Place the subwoofer on the floor near an AC outlet.

Note:

– To remove the stand from the set, while pressing down **PRESS▼**, pull the stand out from the slots.

Step 5: Connecting the power supply

After everything is connected properly, plug in the AC power cord and adapter to the power outlet.

Never make or change any connection with the power switched on.

Optional: Connecting additional equipment

Listening to the playback of a non-USB device

- Connect the system's **AUX-IN** jack to the **AUDIO OUT** jacks on another audio/visual device (such as a VCR, Laser Disc player or cassette desk) using a "single-to-double" cinch cable (with one end providing a 3.5" connector for connection to the **AUX-IN** jack while the other end providing two white/red connectors for connection to the other device's AUDIO OUT jacks).

Connecting a USB device or memory card

IMPORTANT!

– Before connecting the USB plug, first slide down the movable baffle as shown on Page 3 to expose the  jack.

- Insert the USB device's USB plug into the  socket on the set.

for the devices with USB cables:



- 1 Insert one plug of the USB cable (not supplied) to the  socket on the set.
- 2 Insert the other plug of the USB cable to the USB output terminal of the USB device.

for the memory card:

- 1 Insert the memory card into a card reader (not supplied).
- 2 Use a USB cable (not supplied) to connect the card reader into the  socket on the set.



Controls on the system

- ① **ECO POWER/STANDBY ON** 
 - to switch the system on or to Eco power/normal standby mode.
- ② **iR sensor**
 - infrared sensor for remote control.
- ③ **PROGRAM**
 - DVD/VCD/CD/MP3-CD/USB: enters the program menu.
 - Picture CD: during playback, to select a slide show mode.
 - Tuner: programs preset radio stations.
- ④ **Mode Selection**
 - In DISC/USB mode, to stop playback or clear a program. for Demo (*on the system only*) to activate/deactivate the demonstration.
 - ▶▶ In DISC/USB mode, to start or interrupt playback.

PRESET  

Disc/USB: skips to the previous/next chapter/ title/track.

Tuner: selects a preset radio station.

TUNING  

Tuner



 - press to tune to a lower/higher radio frequency gradually.
 - press and hold, then release the key to start automatic search for a radio frequency downward/upward.

Disc/USB

 - searches fast backward/forward.
- ⑤ **Display screen**
 - to view the current status of the system.
- ⑥ **SOURCE**
 - to select the respective sound source :TUNER, DISC, USB or AUX.
- ⑦ **VOLUME +/-**
 - adjusts the volume upward/downward.
 - adjusts the hours and minutes in clock/timer setting mode.
 - selects a source in timer setting mode.
- ⑧ 
 - to connect a headphone.

- ⑨ **EJECT**
 - ejects a disc from the disc loader.
- ⑩ **AUX-IN**
 - connects an external non-USB device.
- ⑪  **USB DIRECT**
 - jack for the external USB mass storage device.
- ⑫ **SLIDE OPEN** ▼
 - slides down to expose some buttons and jacks on the front panel.

Controls on the remote control

- ① **STANDBY-ON** 
 - to switch the system on or to Eco power/normal standby mode.
- ② **Numeric Keypad (0-9)**
 - inputs a track/title/chapter number of the disc.
- ③ **PROGRAM**
 - DVD/VCD/CD/MP3-CD/USB: enters the program menu.
 - Picture CD: during playback, to select a slide show mode.
 - Tuner: programs preset radio stations.
- ④ **SOURCE**
 - to select the respective sound source: DISC, TUNER, USB or AUX.
- ⑤ **SYSTEM MENU** (disc mode only)
 - to enter or exit the system menu bar.
- ⑥ **DISC MENU** (disc mode only)
 - DVD/VCD: enters or exits the disc contents menu.
 - VCD2.0: switches the playback control mode on or off.
- ⑦  
 - Tuner
 - press to tune to a lower/higher radio frequency gradually.
 - press and hold, then release the key to start automatic search for a radio frequency downward/upward.
 - Disc/USB
 - searches fast backward/forward.
 - In DISC mode, to select a movement direction in the disc menu or system menu bar.

* = Press and hold the button for more than three seconds.

Controls

- ⑧ ▲/▼
– In DISC mode, to select a movement direction in the disc menu or system menu bar.
- ⑨ OK
– to exit or confirm the selection.
- ⑩ ◀/▶
– Disc: skips to the previous/next chapter/title/track.
– Tuner: selects a preset radio station.
- ⑪ ■
– In DISC/USB mode, to stop playback or clear a program.
- ⑫ ▶||
– In DISC/USB mode, to start or interrupt playback.
- ⑬ VOL +/-
– adjusts the volume upward/downward.
– adjusts the hours and minutes in clock/timer setting mode.
– selects a source in timer setting mode.
- ⑭ MODE
– selects various repeat modes or the shuffle play mode for a disc.
- ⑮ SUBTITLE
– selects a subtitle language.
- ⑯ SLEEP/TIMER
Standby mode
– sets time for switching on the system automatically.
Power-on mode
– sets the sleep timer function (auto off).
- ⑰ LOUDNESS
– enables or disables automatic loudness adjustment.
- ⑱ DSC
– selects different types of preset sound equalizer settings (CLASSIC, JAZZ, ROCK, POP or FLAT; for DVD: NORMAL, CONCERT, DRAMA, ACTION or SCI-FI).
- ⑲ DBB
– enables or disables bass enhancement.
- ⑳ MUTE
– to interrupt or resume sound reproduction.
- ㉑ DISPLAY
– displays information on TV screen during playback.
- ㉒ A-B
– for VCD/CD/USB: to repeat a specific section within the same track.
– for DVD: to repeat a specific section in a disc.
- ㉓ DIM
– selects different levels of brightness for the display screen.
- ㉔ AUDIO
for VCD
– sets Stereo, Mono-Left or Mono-Right sound mode.
for DVD
– selects an audio language.
- ㉕ ZOOM
– DVD/VCD/Picture CD: enlarges or reduces a picture or active image on the TV screen.
- ㉖ ANGLE
– selects a DVD camera angle.
- ㉗ GOTO
– In DISC mode, to fast search in a disc by entering a time, title, chapter or track.
- ㉘ CLOCK
Standby mode
*– sets the system clock.
Playback mode
– displays the system clock.
- ㉙ ▲
– ejects a disc from the disc loader.
- ㉚ SLOW
– selects different slow playback modes for a VCD/SVCD/DVD.
- ㉛ RDS
For tuner
– displays RDS information.

Notes for remote control:

- **First, select the source you wish to control by pressing one of the source select keys on the remote control (DISC or TUNER, for example).**
- **Then select the desired function (▶||, ◀, ▶| for example).**

* = Press and hold the button for more than three seconds.

IMPORTANT!

– Make sure to complete the preparation procedures before operating the system.

Step 1: Using the remote control

- 1 Open the battery compartment.
- 2 Insert two AAA batteries following the indications (+/-) inside the compartment.
- 3 Close the cover.

Using the Remote Control to operate the Player

- 1 Aim the Remote Control directly at the remote sensor (IR) on the front panel.
- 2 Do not put any objects between the Remote Control and the DVD Player while operating the DVD Player.

Step 2: Setting the clock

- 1 Go to Standby mode.
- 2 Press and hold **CLOCK** on the remote control. → "CLOCK SET" is displayed briefly. Then, the hour digits flash on the display screen.
- 3 Press **VOLUME +/- (VOL +/-)** on the remote control) to set the hours.
- 4 Press **CLOCK** again. → The minute digits flash on the display screen.
- 5 Press **VOLUME +/- (VOL +/-)** on the remote control) to set the minutes.
- 6 Press **CLOCK** to confirm the clock setting.

Notes:

- This system only supports 24-hour mode.
- The clock setting will be erased when the system is disconnected from the power supply.
- The system will exit clock setting mode if no button is pressed within 30 seconds.

Step 3: Setting video preference

IMPORTANT!

– Make sure you have completed all the necessary connections. (See "Connections-Connecting TV".)

- 1 In stop mode or during playback, press **SYSTEM MENU**.
- 2 Press **◀/▶/▲/▼** on the remote control to toggle through the functions and select your preferential option.
 - Move to **PREFERENCE PAGE** and press **▼**.
 - Move to one of the following and press **▶**.

– Setting TV TYPE

Allows you to select the colour system matching the connected TV set. The options include "PAL" (Wide screen mode), "MULTI" and "NTSC".



Note:

The format you select must be available on the disc. If it is not, the setting for TV Type will not affect the picture during playback.

To exit the menu

Press **SYSTEM MENU** again.

Setting up Progressive Scan feature (for Progressive Scan TV only)

- 1 Turn on your TV.
- 2 Turn off your TV progressive scan mode or turn on interlaced mode (refer to your TV user manual).
- 3 Press **ECO POWER/STANDBY-ON**  (**STANDBY-ON**  on the remote control) to turn on the DVD player.
- 4 Select the correct Video Input channel. → The DVD background screen appears on the TV.
- 5 Press **SYSTEM MENU**.
- 6 Press **◀/▶** repeatedly to select **"VIDEO SETUP PAGE"**.

Preparations

- 7 Select **"TV MODE"** to **"P-SCAN"**, then **OK** to confirm.
→ The instruction menu appears on the TV.

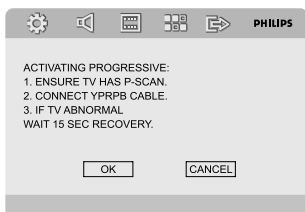

- 8 Press **◀/▶** to highlight OK in the menu and press **OK** to confirm.

There will be a distorted picture on your TV at this state until you turn on the progressive scan mode on your TV.

- 9 Turn on your TV progressive scan mode (refer to your TV user manual).
→ The below menu appears on the TV.

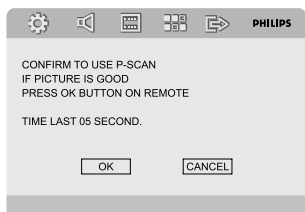

- 10 Press **◀/▶** to highlight OK in the menu and press **OK** to confirm.
→ The setup is complete now and you can start enjoy the high quality picture.

To deactivate Progressive manually

- **When the distorted sign still appears on the TV**, it may be due to the connected TV does not accept progressive signals, and progressive is set by mistake. You must reset the unit to interlace format.
- 1 Turn off your TV progressive scan mode or turn on to interlaced mode (refer to your TV user manual).

- 2 Press **SYSTEM MENU** on the remote to exit the system menu and then **DISC** and "1" to exit progressive scan.
→ The DVD blue background screen will appear.

Step 4: Setting language preference

- 1 In stop mode or during playback, press **SYSTEM MENU**.
- 2 Press **◀/▶/▲/▼** on the remote control to select your preferred option.

→ Move to **GENERAL SETUP PAGE** or **PREFERENCE PAGE** and press **▼**.
→ Move to one of the following and press **▶**.

OSD LANGUAGE (On-Screen Display)
Switches the display language on the TV screen. Select the language from the displayed list.

AUDIO (DVD only)
Switches the display language of the sound track. Select the language from the displayed list.

SUBTITLE (DVD only)
Switches the display language of the subtitle. Select the language from the displayed list.

DISC MENU (DVD only)
Select the language for the DVD menu.

When the selected language is not recorded in the DVD, one of the recorded languages will be selected automatically (except for OSD). You can reset all the DVD settings except for Rating.



If the language selected is not available on the disc, the original language designated by each disc will be selected.

- 3 Press **▲/▼** to select a language and press **OK**.
- 4 Repeat **steps 2~3** for other settings.



To exit the menu

Press **SYSTEM MENU** again.



Switching the system on/off

- Press **ECO POWER/STANDBY-ON**  (**STANDBY-ON**  on the remote control).
→ "HELLO" is displayed briefly. The system will switch to the last selected source.
- Press **DISC, TUNER, USB** or **AUX** on the remote.
→ The system will switch to the selected source.

To switch the system to standby mode

- Press **ECO POWER/STANDBY-ON**  (**STANDBY-ON**  on the remote control).
→ The interactive sound settings, last selected source and tuner presets will be retained in the player's memory.

Switching the system to Eco Power Standby mode

- Press **ECO POWER/STANDBY-ON**  in the active mode.
→ The system enters Eco power standby (the ECO POWER LED is on) or normal standby with clock display.
- The volume level (up to a maximum volume level of 12), interactive sound settings, last selected mode, source and tuner presets will be retained in the player's memory.
- If the system is normal standby with clock display, press and hold **ECO POWER/STANDBY-ON**  for 3 seconds or more to switch to Eco power standby or vice versa.

Power-saving automatic standby

As a power-saving feature, the system will automatically switch to Standby mode if you do not press any buttons within 15 minutes after a disc has stopped playing.

Sound Control

DBB, DSC and LOUDNESS sound features cannot be activated at the same time.

DBB (Dynamic Bass Boost)

DBB enhances the bass response.

- Press **DBB** on the remote to enable/disable DBB feature.

→ Some discs might be recorded in high modulation, which causes a distortion at high volume. If this occurs, switch off DBB or reduce the volume.

DSC (Digital Sound Control)

DSC provides a different type of preset sound equalizer setting.

- Press **DSC** on the remote repeatedly to select: CLASSIC, JAZZ, ROCK, POP or FLAT (for DVD: NORMAL, CONCERT, DRAMA, ACTION or SCI-FI).

LOUDNESS

LOUDNESS feature enables the system to automatically increase the treble and bass sound effect at low volume (the higher the volume, the lower the treble and bass increase).

- Press **LOUDNESS** on the remote to enable or disable LOUDNESS feature.
→  icon appears/disappears after this feature is enabled/disabled.

Volume control

Press **VOLUME +/- (VOL +/-)** on the remote control) to increase or decrease the volume level.

→ "VOLUME xx" is displayed on the display panel. "xx" denotes the volume level.

To listen through the headphone

- Connect the headphone plug to the  socket on the front panel of the DVD player.
→ The speakers will be muted.

To switch off the volume temporarily

- Press **MUTE** on the remote control.
→ Playback will continue without sound and "MUTING" flashes.
- To activate sound reproduction, you can:
 - press **MUTE** again;
 - adjust the volume controls;
 - change source.

Dimming the display screen

- Press **DIM** repeatedly to select different levels of brightness for the display screen.

Disc Operations

Playing discs

- 1 Insert a disc into the slot loader:
 - Make sure the label side is facing you.
 - Make sure you have removed any other disc from the slot loader.
- 2 Playback will start automatically (depending on the disc type).
 - If a disc menu appears on the TV, see "Using the Disc Menu".
 - If the disc is locked by parental control, you must enter your four-digit password.
- 3 At any time, simply press **■** to stop playback.

Using the disc menu

For disc with Table Of Contents, a menu may appear on the TV screen once you load the disc.

To select a playback feature or item

- Use **◀/▶/▲/▼** and **OK** or **Numeric Keypad (0-9)** on the remote.
 - Playback will start automatically.

To access or exit the menu

- Press **DISC MENU** on the remote.

For VCD with Playback Control (PBC) feature (version 2.0 only)

PBC playback allows you to play Video CDs interactively, following the menu on the display.

- During playback, press **DISC MENU**.
 - If PBC was ON, it will switch to OFF and continue playback.
 - If PBC was OFF, it will switch to ON and return to menu screen.

Basic playback controls

Pausing playback (DVD/VCD/CD/MP3/WMA)

- 1 During playback, press **▶II**.
 - Playback will pause and sound will be muted.
- 2 Press **▶II** again to resume.

Selecting a track/chapter/title (DVD/VCD/CD/MP3/WMA)

- 1 Press **PRESET** **◀/▶** during playback to go to the previous or next chapter/title/track.
- 2 To go directly to any chapter/ title/track, enter the chapter/ title/track number using the **Numeric Keypad (0-9)**.

Resuming playback from the last stopped point (DVD/VCD/CD/MP3/WMA)

- In stop mode and when a disc has not been removed, press **▶II**.

To cancel resume mode

- In stop mode, press **■** again.

Zoom (DVD/VCD/JPEG)

Zooming allows you to enlarge or reduce the video image during playback.

- 1 Press **ZOOM** repeatedly to enlarge or reduce the playback video image.
- 2 Press **◀/▶/▲/▼** to pan across the TV screen.

Different play modes: SHUFFLE and REPEAT (DVD/VCD/CD/MP3/WMA)

- Press **MODE** repeatedly to choose a repeat mode during playback.

Repeat A-B (DVD/VCD/CD/MP3/WMA)

- 1 Press **A-B** at your chosen starting point.
- 2 Press **A-B** again at your chosen end point.
 - The section A and B can be set only within the same chapter/track.
 - The section will now repeat continuously.
- 3 To exit the sequence, press **A-B** again.
 - "A-B" is displayed on the TV screen.

Slow Motion (DVD/VCD)

- 1 Press **SLOW** on the remote control during playback to select the required forward speed: 1/2, 1/4, 1/8 or 1/16.
→ Sound will be muted.
- 2 To return to normal speed, press **▶II**.

Forward/Reverse Searching (DVD/VCD/CD)

- 1 Press **TUNING** **◀◀/▶▶** (**◀/▶** on the remote control) during playback to select the required speed: X2, X4, X8, X16 or X32 (backward or forward).
→ Sound will be muted.
- 2 To return to normal speed, press **▶II**.

Time search & search by chapter/track number (DVD/VCD/CD/MP3/WMA)

- 1 Press **GOTO** until the time or chapter/track edit box appears.
- 2 Enter hours, minutes and seconds from left to right in the time edit box using the **Numeric Keypad (0-9)** on the remote.
OR
Enter your desired chapter/track number in the chapter/track edit box using the **Numeric Keypad (0-9)** on the remote.

Information display during playback (DVD/VCD/CD/MP3/WMA)

- During playback, press **DISPLAY** to show disc information on the TV screen.

Special disc features

Playing a Title (DVD)

- 1 Press **DISC MENU**.
→ The disc title menu appears on the TV screen.
- 2 Use **◀/▶/▲/▼** to select a play option.
- 3 Press **OK** to confirm.

Camera Angle (DVD)

- Press **ANGLE** repeatedly to select different desired angle.

Changing the Audio Language (for DVD recorded with multiple languages)

- Press **AUDIO** repeatedly to select different audio languages.

Changing the Audio Channel (for VCD only)

- Press **AUDIO** to select the available audio channels provided by the disc (Mono Left, Mono Right or Stereo).

Subtitles (DVD)

- Press **SUBTITLE** repeatedly to select different subtitle languages.

Playing MP3/WMA/JPEG Picture disc

General operation

- 1 Load an MP3/WMA/JPEG disc.
→ A data disc menu appears on the TV screen and playback starts automatically from the first track (file).
- 2 Press **◀** to move to the album (folder) column on the left of the TV screen, then use **▲/▼** to select an album (folder) and press **OK** to open it.
- 3 Press **▶** to move to the track (file) column on the right of the TV screen and then use **▲/▼** to highlight a track (file); or directly use the Numeric Keypad (0-9) to input a track (file) number.
- 4 Press **OK** to confirm.
→ The playback will start from the selected track (file) to the end of the album (folder).

Disc Operations

Special JPEG features

Zoom picture (JPEG)

- During playback, press **ZOOM** repeatedly to display the picture with different scales (2x, 3x, 4x, 1/2x, 1/3x or 1/4x).
- Use ◀/▶/▲/▼ to view the zoomed picture.

Playback with multi-angles (JPEG)

- During playback, press ◀/▶ to rotate the picture on the TV screen.

Playing a DivX disc

This DVD player supports the DivX movie playback that you download from your computer onto a CD-R/RW (see "System Menu Options-DIVX(R) VOD registration code" for more information).

- 1 Load a DivX disc and press ▶|| to start playback.
 - 2 If the DivX movie contains external subtitles, the subtitle menu will appear on the TV screen for your selection.
- In this case, pressing **SUBTITLE** on the remote control will turn on or off the subtitle.
 - If multilingual subtitles are embedded on the DivX disc, pressing **SUBTITLE** will change the subtitle language during playback.

Note:

- Subtitle files with the following filename extensions (.srt, .smj, .sub, .ssa, .ass) are supported but do not appear on the file navigation menu.
- The subtitle filename have to be the same as the filename of the movie.

System Menu Options

Basic operations

- 1 Press **SYSTEM MENU** to enter the Setup Menu.
- 2 Press **◀/▶** to select a page to be set.
- 3 Press **▲/▼** to highlight an option.
- 4 Enter its submenu by pressing **▶** or **OK**.
- 5 Move the cursor by pressing **▲/▼** to highlight the selected item.
→ In cases of value setting, press **▲/▼** to adjust values.
- 6 Press **OK** to confirm.

To return to the upper-level menu

- Press **◀**.

To exit from the menu

- Press **SYSTEM MENU** again.
→ The settings will be stored in the player's memory even if the player is switched off.

Note:

- Some of the features in the System Menu Options are described in "Getting Started".

GENERAL SETUP PAGE

TV DISPLAY

Set the aspect ratio of the DVD Player according to the TV you have connected.

- **4:3 PAN SCAN**: If you have a normal TV and want both sides of the picture to be trimmed or formatted to fit your TV screen.
- **4:3 LETTER BOX**: If you have a normal TV. In this case, a wide picture with black bands on the upper and lower portions of the TV screen will be displayed.
- **16:9**: If you have a wide-screen TV.

SCREEN SAVER

This function is used to turn the screen saver on or off.

- **ON**: In STOP, PAUSE or No DISC mode, if no actions are performed about 3 minutes, the screen saver will be activated.
- **OFF**: Screen saver is disabled.

DIVX(R) VOD registration code

- 1 In '**GENERAL SETUP PAGE**', press **▲ ▼** to highlight DIVX(R) VOD, then press **▶** or **OK** to enter its submenu and press **OK** again to confirm.
→ The registration code will appear.
- 2 Press **OK** to exit.
- 3 Use the registration code to purchase or rent the videos from DivX® VOD service at www.divx.com/vod. Follow the instructions and download the video onto a CD-R for playback on this DVD player.

Notes:

- All the downloaded videos from DivX® VOD can only be played back on this DVD player.
- Time search feature is not available during DivX movie playback.

AUDIO SETUP PAGE

ANALOG AUDIO SETUP

- **LT/RT**: Selects the mixed sound output mode.
- **STEREO**: Selects the ordinary stereo sound output.

DIGITAL AUDIO SETUP

- **OFF**: Turns off the SPDIF output.
- **SPDIF/RAW**: If you have connected your system to a multi-channel decoder/receiver.
- **PCM only**: Only if your receiver is not capable of decoding multi-channel audio.

DOLBY DIGITAL SETUP

- **STEREO**: Left mono sound will send output signals to Left speaker and Right mono sound will send output signals to Right speaker.
- **L-MONO**: Left mono sound will send output signals to Left speaker and Right speaker.
- **R-MONO**: Right mono sound will send output signals to Left speaker and Right speaker.

3D

- **OFF, CONCERT, LIVING ROOM, HALL, BATHROOM, CAVE, ARENA and CHURCH**.

HD CD

- **OFF, 44.1K and 88.2K**.

System Menu Options

NIGHT MODE

→ **ON**: Select this to level out the volume. This feature is only available for movies with Dolby Digital mode.

→ **OFF**: Select this when you want to enjoy the surround sound with its full dynamic range.

VIDEO SETUP PAGE

COMPONENT

This setting is not required if you are using the **VIDEO** jack (yellow) to connect the DVD micro system to your TV.

→ **S-VIDEO**: Select this if you have connected the DVD micro system to your TV using S-Video jack.

→ **Pr/Cr Pb/Cb Y**: Select this if you have connected the DVD micro system to your TV using Component video jacks.

TV MODE

Selects interlace or P-SCAN video output mode when **Pr/Cr Pb/Cb Y** is selected.

→ **PROGRESSIVE** and **INTERLACE**.

PICTURE SETTING

This menu helps you to set the video quality.

PREFERENCE PAGE

PARENTAL

- ① Press ▲/▼ to highlight "RATING".
- ② Enter its submenu by pressing ►.
- ③ Use ▲/▼ to highlight a rating level for the disc inserted.
 - DVDs that are rated above the level you selected will not play unless you enter your four-digit password and choose a higher level rating.

DEFAULT

Setting the "DEFAULT" function will reset all options and your personal settings to the factory defaults and all your personal settings will be erased.

PASSWORD SETUP

PASSWORD MODE

This feature is used to enable/disable password by selecting "ON"/"OFF".

PASSWORD

Enter your four digit password when a hint is displayed on the screen. The default password is 1234.

External Sources

Using a USB mass storage device

By connecting a USB mass storage device to the Hi-Fi system, you can enjoy the device's stored music through the powerful speakers of Hi-Fi system.

Playing a USB mass storage device Compatible USB mass storage devices

With the Hi-Fi system, you can use:

- USB flash memory (USB 2.0 or USB1.1)
- USB flash players (USB 2.0 or USB1.1)
- memory cards (requires an additional card reader to work with this Hi-Fi system)

Note:

– *In some USB flash players (or memory devices), the stored contents are recorded using copyright protection technology. Such protected contents will be unplayable on any other devices (such as this Hi-Fi system).*

Supported formats:

- USB or memory file format FAT12, FAT16, FAT32 (sector size: 512 bytes)
- MP3 bit rate (data rate): 32-320 Kbps and variable bit rate
- WMA v9 or earlier
- Directory nesting up to a maximum of 8 levels
- Number of albums/ folders: maximum 99
- Number of tracks/titles: maximum 999
- ID3 tag v2.0 or later
- File name in Unicode UTF8 (maximum length: 128 bytes)

The system will not play or support the following:

- Empty albums
- Non-supported file formats are skipped.
 - AAC, WAV, PCM audio files
 - DRM protected WMA files
 - WMA files in Lossless format

How to organize your MP3/WMA files on the USB mass storage device

This Hi-Fi system will browse the MP3/WMA files in the folders/sub-folders/titles order:

Organize your MP3/WMA files in different folders or subfolders as required.

Notes:

- *If you have not organized MP3/WMA files into any albums on your disc, an album "00" will be automatically assigned for all those files.*
- *Make sure that the file names of MP3 files end with .mp3. and the file names of WMA files end with .wma.*
- *For DRM protected WMA files, use Windows Media Player 10 (or later) for conversion. Visit www.microsoft.com for details about Windows Media Player and WM DRM (Windows Media Digital Rights Management).*

- 1 Check the USB device has been properly connected. (See Installation: Connecting an additional appliance).
- 2 Press **SOURCE** once or more to select USB (or **USB** on the remote control). **NO AUDIO** appears if no audio file is found in the USB device.
- 3 Play the USB's audio files as you do with the albums/tracks on a CD (See Disc Operations).

Notes:

- *For compatibility reasons, the album/track information may differ from what it is displayed through flash players' music management software.*
- *File names or ID3 tags will be displayed as — if they are not in English.*

Clock setting

See "Preparations-Step 2: Setting the clock".

Timer setting

- The system can be used as an alarm clock, whereby the last selected source is switched on at a set time (one time operation). The clock time needs to be set first before the timer can be used.
- ① In standby mode, press and hold **SLEEP/TIMER** on the remote control for more than three seconds.
→ "TIMER SET" is displayed briefly. Then, the hour digits flash on the display panel.
- ② Press **VOLUME +/-** (**VOL +/-** on the remote control) to set the hours and **SLEEP/TIMER** to confirm.
→ The minute digits flash on the display panel.
- ③ Press **VOLUME +/-** (**VOL +/-** on the remote control) to set the minutes and **SLEEP/TIMER** to confirm.
→ "TUN", "TV" or "USB" flashes.
- ④ Press **VOLUME +/-** (**VOL +/-** on the remote control) to select your desired source.
- ⑤ Press **SLEEP/TIMER** to complete the setting.
→ Display shows .

To deactivate the timer

- Press **SLEEP/TIMER** again.
→  disappears.



Sleep timer setting

The sleep timer enables the system to switch off by itself after a set period of time.

- ① Press **SLEEP/TIMER** on the remote control repeatedly to select a preset time.
→ The selections are as follows (time in minutes):
OFF → 15 → 30 → 45 → 60 → 75 → 90 →
105 → 120 → OFF
→ "SLEEP xx" or "SLEEP OFF" is displayed.
"xx" is the time in minutes.

- ② When you reach the desired length of time, stop pressing **SLEEP/TIMER**.
→ Display shows zz .

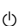
To deactivate the sleep timer

- Press **SLEEP/TIMER** repeatedly until "OFF" is displayed, or press **ECO POWER/STANDBY-ON**  (**STANDBY-ON**  on the remote control).
→ zz disappears.

Specifications

Amplifier

Rated output power 2 x 20W + 50W RMS
Frequency response (L/R) 180 - 20000Hz
(Subwoofer) 50 - 180Hz
Signal to noise ratio > 65dB
Aux input 1V RMS 20kohm

Disc

Laser type Semiconductor
Disc diameter 12cm/8cm
Video decoding MPEG-1 / MPEG-2 / Divx
Video DAC 12Bits
Signal system PAL / NTSC
Video format 4:3 / 16:9
Video S/N > 48dB
Audio DAC 24Bits / 96kHz
Total harmonic distortion < 0.1% (1kHz)
Frequency response 4Hz - 20kHz (44.1kHz)
..... 4Hz - 22kHz (48kHz)
..... 4Hz - 24kHz (96kHz)
S/N ratio > 65dB

Tuner

FM tuning range 87.5 - 108MHz
Tuning grid 50KHz
Sensitivity
– Mono, 26dB S/N ratio 5uV
– Stereo, 46dB S/N ratio 100uV
Selectivity > 28dB
Image rejection > 25dB
Total harmonic distortion < 3%
Signal to noise ratio > 55dB

Speakers

Speaker impedance (L/R) 4 ohm
(Subwoofer) 8 ohm
Speaker driver (L/R) 3"
(Subwoofer) 5"
Frequency response 50 - 16000 Hz

General information

Total output power 2 x 25W + 50W RMS
AC power 220V - 230V, 50Hz / 60Hz
Operation Power Consumption 35W
Standby Power Consumption < 4W
Eco standby Power Consumption 1W
Composite Video Output 1.0Vp-p, 75ohm
S-Video Output 1.0Vp-p, 75ohm
Coaxial Output 0.5Vpp ± 0.1Vpp 75ohm
Headphone output 2 X 15mW, 32ohm
USB direct Version 2.0
Wireless Subwoofer Connection ... 2.4GHz, AFH

Dimensions (W x H x D)

– Main unit 200 x 250 x 110mm
– Main speaker 140 x 220 x 33mm (each)
– Subwoofer 170 x 197 x 302mm

Weight

– With packing 8kg
– Main unit 1.45kg
– Main speaker 0.4kg (each)
– Subwoofer 3.3kg

Specifications subject to change without prior notice

WARNING

Under no circumstances should you try to repair the system yourself, as this will invalidate the warranty. Do not open the system as there is a risk of electric shock.

If a fault occurs, first check the points listed below before taking the system for repair. If you are unable to remedy a problem by following these hints, consult your dealer or Philips for help.

Problem	Solution
No power.	<ul style="list-style-type: none"> ✓ Check if the AC power cord is properly connected.
“NO DISC” is displayed.	<ul style="list-style-type: none"> ✓ Check if the disc is inserted upside down. ✓ Wait until the moisture condensed at the lens has cleared. ✓ Replace or clean the disc, see “Maintenance”. ✓ Use a readable disc or correctly recorded format MP3-CD.
No picture.	<ul style="list-style-type: none"> ✓ Select the appropriate video input mode on the TV set. ✓ Check if the TV set is switched on. ✓ Check the video connection. ✓ Check if the system is securely connected. ✓ If the progressive scan feature is activated but the connected TV does not support progressive signals or the cables are not connected accordingly, see “Preparations-Setting up Progressive Scan feature” for proper progressive scan setup or deactivate the progressive scan feature as below: <ol style="list-style-type: none"> 1) Turn off your TV progressive scan mode or turn on to interlaced mode. 2) Press SYSTEM MENU on the remote control to exit the system menu and then DISC and 1 to exit progressive scan.
Distorted or poor picture.	<ul style="list-style-type: none"> ✓ Sometimes a slight picture distortion may appear. This is not a malfunction. ✓ Clean the disc.
The aspect ratio of the screen cannot be changed even though you have set the TV shape.	<ul style="list-style-type: none"> ✓ The aspect ratio is fixed on the DVD disc. ✓ The aspect ratio may not be changed for some TV systems.

Troubleshooting

Problem	Solution
The DVD player does not start playback.	<ul style="list-style-type: none">✓ Insert a readable disc.✓ Check the disc type, color system and region code.✓ Clean the disc.✓ Place the disc with the playback side down.✓ Press SYSTEM MENU to turn off the setup menu.✓ Cancel the parental control rating function or change the rating level.✓ Moisture has condensed inside the system. Remove the disc and leave the system turned on for about an hour.
The DVD player does not respond when buttons are pressed.	<ul style="list-style-type: none">✓ Disconnect the power plug from the jack, and insert again.
The language for the sound or subtitle cannot be changed when playing a DVD.	<ul style="list-style-type: none">✓ Multi-language sound or subtitle is not recorded on the DVD.✓ Changing the language for the sound or subtitle is prohibited on the DVD.
No image is output when a function is selected.	<ul style="list-style-type: none">✓ Make sure the component is connected correctly.✓ Press the correct function button for the input source.
Sound cannot be heard or is of poor quality	<ul style="list-style-type: none">✓ Adjust the volume.✓ Disconnect the headphones.✓ Check that the speakers are connected correctly.✓ Check if the stripped speaker wire is clamped.✓ If the system is in pause, slow motion or fast forward/reverse mode, press ► to resume the normal play mode.✓ Make sure the MP3-CD was recorded within 32-256 kbps bit rate with sampling frequencies at 48 kHz, 44.1 kHz or 32 kHz.✓ Ensure that the DTS disc also supports Dolby Digital output.
Poor radio reception.	<ul style="list-style-type: none">✓ If the signal is too weak, adjust the antenna or connect an external antenna for better reception.✓ Increase the distance between the System and your-TV set or VCR.

Problem	Solution
<p>Left and right sound outputs are reversed.</p>	<ul style="list-style-type: none"> ✓ Check the speaker connections and location.
<p>The remote control does not function.</p>	<ul style="list-style-type: none"> ✓ Point the remote control at the remote control sensor of the unit. ✓ Reduce the distance to the player. ✓ Remove any possible obstacles. ✓ Replace the batteries with a new ones. ✓ Check that the battery is loaded correctly.
<p>Wireless connection with the subwoofer fails</p>	<ul style="list-style-type: none"> ✓ Ensure that the subwoofer is powered on. ✓ The distance between the main set and subwoofer may exceed the maximum range of wireless communication. Move the subwoofer closer to the main set. ✓ Obstacles may exist between the main set and subwoofer: Remove the obstacles. ✓ Strong interference may exist. Ensure there is no strong interference that may impair the communication between the main set and subwoofer. ✓ If the problem remains, see "Installation - Step 1: Connecting speakers - Connecting the wireless subwoofer" for manual pairing.
<p>The timer is not working</p>	<ul style="list-style-type: none"> ✓ Set the clock correctly.
<p>The Clock/Timer setting is erased</p>	<ul style="list-style-type: none"> ✓ Power has been interrupted or the power cord has been disconnected. Reset the clock/timer.
<p>Unable to select Progressive Scan.</p>	<ul style="list-style-type: none"> ✓ Check that the output of the video signal is switched to 'Pr/Cr Pb/Cb Y'.
<p>Some files on the USB device are not displayed.</p>	<ul style="list-style-type: none"> ✓ Check if the number of folders exceeds 99 or the number of titles exceeds 999.
<p>"DEVICE NOT SUPPORTED" scrolls on the display.</p>	<ul style="list-style-type: none"> ✓ Remove the USB mass storage device or select another source.

Meet Philips at the Internet
<http://www.philips.com>

English

Français

Español

Deutsch

Nederlands

Italiano

Svenska

Dansk

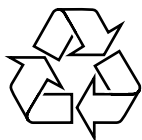

MCD289

